

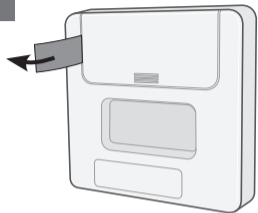
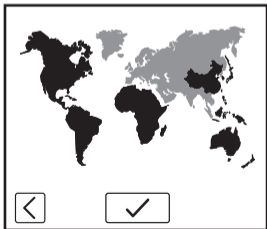
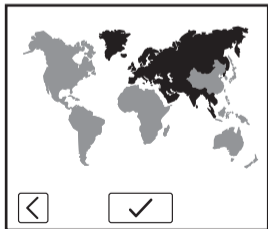
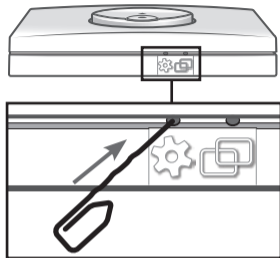
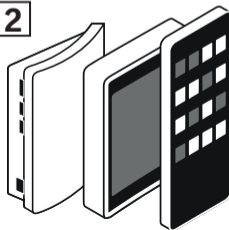

A**B**

2 VELUX®

C**1****2**

VELUX® 3

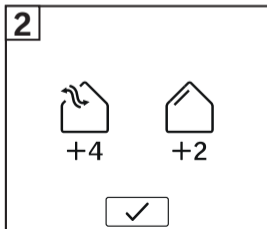
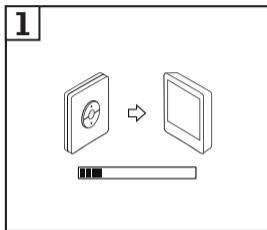
D

4 VELUX®

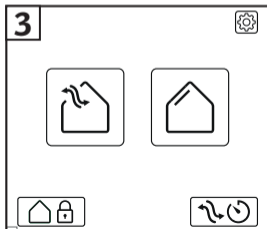
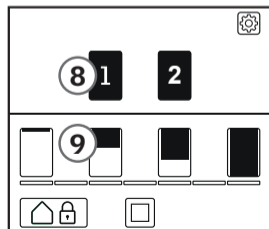
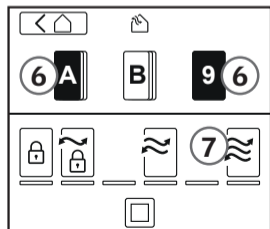
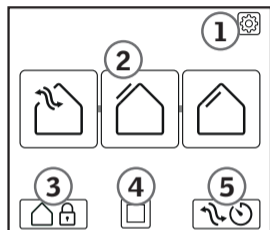
**E**

VELUX® 5

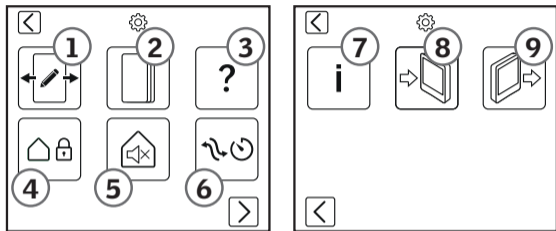
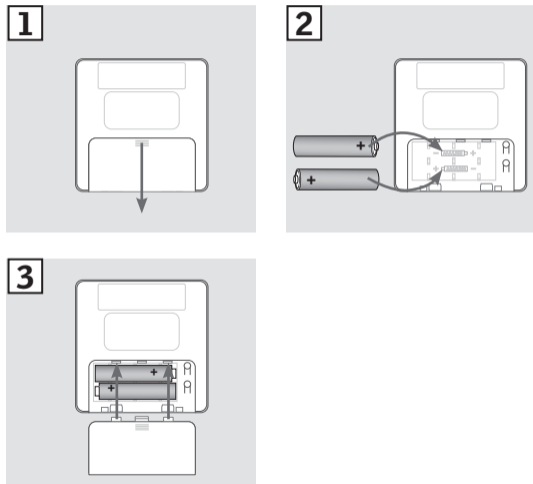
F**G**

H

1

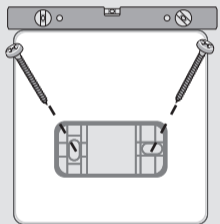

Ø 4 mm

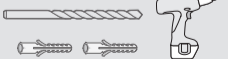

2

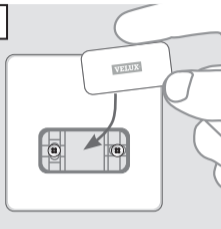

3

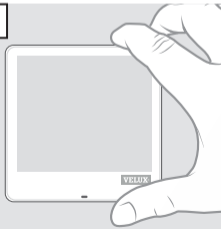

pp 10-283



pp 284-318

English	12-23	Magyar	154-163
Deutsch	24-33	Norsk	164-173
Français	34-43	Polski	174-183
Dansk	44-53	Português	184-193
Nederlands	54-63	Română	194-203
Italiano	64-73	Русский	204-213
Español	74-83	Slovenščina	214-223
Bosanski/ Hrvatski/ Srpski	84-93	Slovensky	224-233
Български	94-103	Srpski	234-243
Česky	104-113	Suomi	244-253
Eesti	114-123	Svenska	254-263
Hrvatski	124-133	Türkçe	264-273
Latviski	134-143	Українська	274-283
Lietuvių	144-153		

Read directions for use carefully before operating and keep them for future reference.

Please also see Important Information and Declaration of Conformity.

A Remove the tab.

B Select region.

C Select a control already in use and prepare product transfer:

1 VELUX INTEGRA® wall switch KLI 310/311/312/313:

Prepare product transfer by briefly pressing the gear button. The product will now run briefly back and forth for confirmation.

2 VELUX controls VELUX ACTIVE with NETATMO / KLR 200 / KLR 300 / KLF 200 / KLG 300:

Scan the QR code to get information on how to prepare product transfer (velux.com/touchhelp).

Note: If no control is available, you can also scan the QR code for help.

- D**
- 1** Start product transfer to VELUX Touch.
 - 2** Number of transferred products per category.
 - 3** VELUX Touch is ready for use.

E VELUX Touch - Basic operation

- 1** Settings
- 2** Product category (Window/Exterior sunscreening/
Interior sunscreening)
- 3** Lock your home
- 4** Stop product
- 5** Start Ventilation timer
- 6** Select group/product (Group A and Window 9
selected)
- 7** Select position (closed/secured
ventilation/25%/50%/75%/100%)
- 8** Select group/product (Sunscreening 1 and 2
selected)
- 9** Select position
(up/10%/25%/37%/50%/75%/100%)

F VELUX Touch – Settings

- ① Edit products (change order/delete product)
- ② Edit groups (group members/group names)
- ③ Help
- ④ Edit Lock your home
- ⑤ Edit Silent operation
- ⑥ Edit Ventilation timer
- ⑦ About VELUX Touch
- ⑧ Add products (import)
- ⑨ Copy VELUX Touch (export)

G VELUX Touch - Replacement of batteries
(type AAA, 1.5 V, non-rechargeable Alkaline or Carbon Zinc)

H VELUX Touch - Fitting to the wall
with magnetic holder

IMPORTANT INFORMATION

Read instructions carefully before installation and operation. Keep instructions for future reference and hand them over to any new user.

Safety

- VELUX Touch control pad KLR 300 can be used by persons (aged 8 years and above) with sufficient experience and knowledge if they have been given instruction concerning safe use and understand the hazards involved. Cleaning and user maintenance must not be done by unsupervised children.
- Children must not play with the control pad.

- The control pad must be installed at a height below 2 m, and it is recommended to place it in the room where the window and its electrical products have been installed.

Product

- The control pad is for indoor use only.
- The control pad has been designed for use with genuine VELUX INTEGRA® products.
- Radio frequency band: 868 MHz.
- Radio frequency range: up to 100 m free field. Depending on building construction, the indoor range is approx 10 m. However, constructions with reinforced concrete, metal ceilings and plaster walls with steel members may reduce the range.
- Expected battery lifetime: Up to 2 years.

- Disabling the rain sensor while the window is open implies a risk of rain water entering the building.
- The packaging must be disposed of in accordance with national regulations.
-  The product, including batteries if any, is regarded as electrical and electronic equipment and contains hazardous materials, components and substances. The crossed out wheeled bin symbolises that electrical and electronic equipment waste must not be disposed of together with household waste. It must be collected separately at recycling stations or other collection sites or retrieved directly from households to increase the possibilities of recycling, reuse and utilisation of electrical and electronic equipment waste. By sorting electrical and electronic equipment waste with this symbol, you contribute to reducing the volume of incinerated or buried waste and to reducing any negative impact on human health and the environment. Further information can be obtained from the local municipality's technical administration or from your VELUX sales company.

- If batteries can be removed, product and batteries must be disposed of separately.

Maintenance and service

- The control pad requires a minimal amount of maintenance. The surface may be cleaned with a soft, damp cloth.
- **CAUTION:** Risk of explosion if battery is replaced by an incorrect type.
- If you have any technical questions, please contact your VELUX sales company, see telephone list or www.velux.com.



io-homecontrol® provides advanced and secure radio technology that is easy to install. io-homecontrol® labelled products communicate with each other, improving comfort, security and energy savings.

www.io-homecontrol.com



DECLARATION OF CONFORMITY

We herewith declare that VELUX Touch control pad
KLR 300 (BM-RC015)

- is in conformity with the Radio Equipment Directive 2014/53/EU and the RoHS Directive 2011/65/EU,
- has been manufactured in accordance with the harmonised standards EN 62368-1(2014), EN 300220-2 v3.1.1 (2017), EN 300328 v2.2.2 (2019), EN 301489-3 v2.1.1 (2017), EN 60335-2-103(2015), EN 62233(2008), EN 55035(2017) and EN 55032(2015) and
- has been assessed in accordance with the harmonised standard EN 50581(2012).

When the above-mentioned control pad is used with other VELUX INTEGRA® products in accordance with instructions and requirements, the total system complies with the essential requirements of the Directives 2006/42/EC, 2014/30/EU, 2014/35/EU and 2014/53/EU of the European Parliament and Council.

VELUX A/S:
(Jens Aksel Thomsen, Advanced Certification Specialist)

Ådalsvej 99, DK-2970 Hørsholm.

DoC 940438-00

We herewith declare that VELUX Touch control pad
KLR 300 (BM-RC015)

- is in conformity with the Radio Equipment Regulations 2017 (S.I. 2017/1206) and the Restriction of the Use of Certain Hazardous Substances in Electrical and Electronic Equipment Regulations 2012 (S.I. 2012/3032),
- has been manufactured in accordance with the UK designated standards EN 62368-1(2014), EN 300220-2 v3.1.1 (2017), EN 300328 v2.2.2 (2019), EN 301489-3 v2.1.1 (2017), EN 60335-2-103(2015), EN 62233(2008), EN 55035(2017),EN 55032(2015) and
- has been assessed in accordance with the UK designated standard EN 50581(2012).

When the above-mentioned control pad is used with VELUX INTEGRA® products in accordance with instructions and requirements, the total system complies with the essential requirements of the Supply of Machinery

(Safety) Regulations 2008 (S.I. 2008/1597), Electrical Equipment (Safety) Regulations 2016 (S.I. 2016/1101), Electromagnetic Compatibility Regulations 2016 (S.I. 2016/1091) and Radio Equipment Regulations 2017 (S.I. 2017/1206).

On behalf of our local representative:

VELUX Company Ltd.

Woodside Way, Glenrothes East, Fife, KY7 4ND

United Kingdom

VELUX A/S:
(Jens Aksel Thomsen, Advanced Certification Specialist)

Ådalsvej 99, DK-2970 Hørsholm.

DoC 940438-00