

User Guide

Preliminary, 2015-10-02



USER GUIDE

Revision History

Version	Date	Changes
00	2015-10-02	Preliminary

1 OVERVIEW

Appearance



Accessories



Rubber case

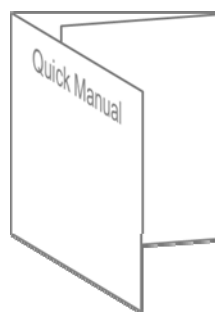

Quick Manual

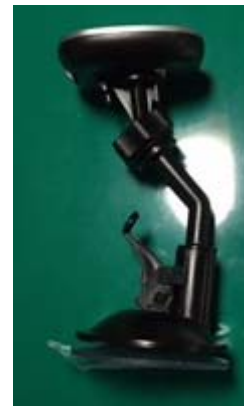

Vehicle Mounts

2 SPECIFICATIONS

PHYSICAL

Dimension(WxLxH)	117.3 x 65.8 x 17.1mm
Weight	90g
Indication	Power on LED(Blue), Charging LED(Red), Tagging LED (Blinking Blue)
Battery	700mAh
Continuous Time	5 hours
Standby Time	24 hours
Charging Time	2 hours

RFID PERFORMANCE

RFID Reader Chip	PHYCHIPS PR9200
Air Protocol	EPCglobal Class 1 Gen 2 / ISO 18000-63 (formerly 18000-6C)
Interface	Apple Lightning Connector
OS	Apple iOS 7.0
Output Power	316mW(25dBm) for US, EU and Korea band 200mW(23dBm) for Japan band
RFID Read Distance	Up to 1.0m (depend on tags)
Antenna	Circularly Polarized Antenna
RFID Function	Read, Write, Lock, Kill

USER ENVIRONMENT

Operating Temp	Discharge (-10 to 45°C), Charge (0 to 45°C)
Storage Temp	-20 to 60°C (1 month), -20 to 45°C (3 month), -20 to 20°C (1 year)
Relative Humidity	5 to 95% humidity noncondensing

REGULATORY

RFID	FCC Part 15 Subpart C 247, EN 302 208, KCC 2013-1, KCC 2012-102, ARIB STD T107
EMI/EMC	EN 301 409-1, EN 301 409-3, EN61000-3-2, EN61000-3-3, KN 301 409-1/3, KN61000-4-2/3/4/5/6/11
Electrical Safety	EN 60950-1

LIMITED WARRANTY

The lithium-ion battery capacity is dropping linearly to 80% over 300 cycles. A charge cycle means using all of the battery's capacity, but that doesn't necessarily mean a full charge and discharge. The lithium-ion battery in RFID reader should not be replaced by the user. Contact where you buy it.

2.1 Charging

Vehicle mounts and RFID reader are shown below.



To charge the device, mounting the device to the vehicle mounts.

Note:

When the user connects the device with iPhone during the charging, the device can charge itself and the device simultaneously.



When charging is finished, LED shall be turned off.



3 HOW TO USE DEVICE

Install the vehicle mount to your vehicle as shown below.



Connect iPhone to device as shown below.



Note:

This product is intended for use in vehicle mounting
Please do not use this product for portable use

4 HOW TO USE APPLICATION

4.1 How to install application in your iPhone

Once iPhone is connected to lightning connector, there will be pop-up to choose whether to start App or not as picture above. If App is not installed, there will be a sign to download it from App-store. When you accept the alarm, the App will be launched.

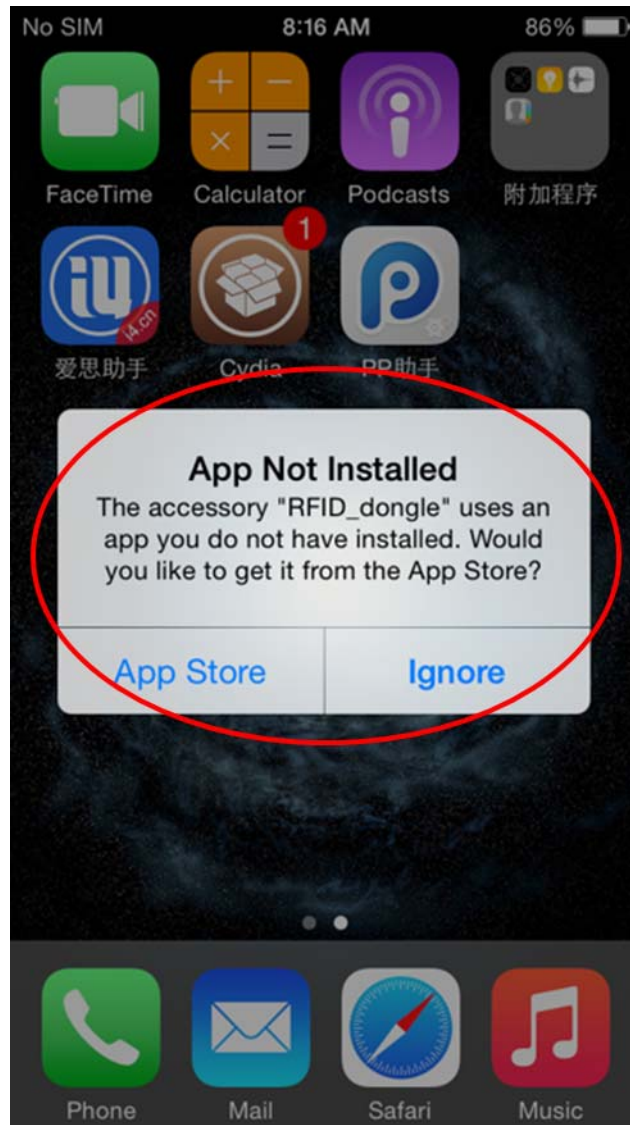

4.2 Launching the App

If iPhone and dongle device is connected properly, '**Unplugged**' will be changed to '**Plugged**'. And setting, read, clear, battery and stop button will be active.

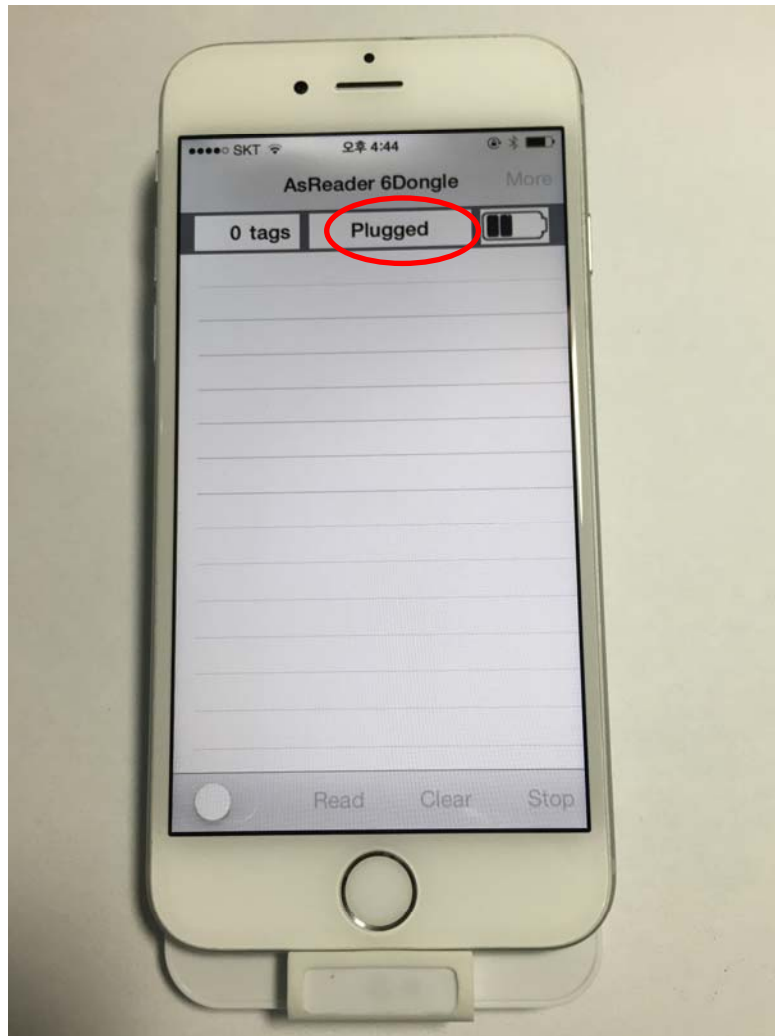



4.3 Main Display

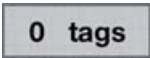

- Switch: Turn on or off the Reader
- Read Button: Start to read "Tag EPC"
- Clear Button: Remove Read Record
- Stop Button: Stop Tag Reading
- Display: Show Tag Read Record

4.4 Status Bar

	The number of tags displayed
	RFID READER Status <ul style="list-style-type: none">- Unplugged: RFID READER is not inserted into headset jack.- Plugged: RFID READER is inserted into headset jack.- Connected: RFID READER is connected to app.
	Battery gauge

4.5 Tag Read

1. Switch the button to "On"
2. Touch **Read** button to inventory tag continuously
 - A. PC + EPC will appear.
3. Touch **Stop** button to finish inventory tag
4. Touch **Clear** button to clear the list of tags.

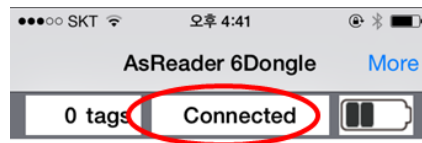

5 CAUTION

5.1 Safety Information

1. Do not disassemble or repair arbitrarily but contact where you buy when RFID READER is in trouble.
2. Do not use chemical substance(alcohol, benzene, detergent etc) and water to clean RFID READER
3. Please avoid vibrations and shocks. Please place in a safe place when not in use.
4. Please avoid high/low temperature and high humidity.
5. Please turn RFID READER off in explosive area as there may be danger due to electric wave.
6. Please use medical device(pacemaker, hearing aid etc) which is blocked from RF energy.
7. Please stop using RFID READER and consult a medical expert in case of any allergic reactions and side effect.

5.2 Operation

The device can be used over 20cm from the user.
This product is intended for use in vehicle mounting
Please do not use this product for portable use

1. The device will be automatically off from following situations.
2. When receives a phone call, the device automatically turn off the power.
3. Include a message, something pop-up by certain Apps.
4. When switching from Barcode App to other App or pressing Home button.
5. When pressing power button or the display automatically turns off to sleep mode or App display disappears or the display is covered by Pop-up, it will automatically off the App.

5.3 RF Exposure Information

This equipment complies with FCC radiation exposure limits set forth for an uncontrolled environment. This equipment must be installed and operated with minimum distance of 20cm between the radiator and your body. This transmitter module is authorized only for use in device where the antenna may be installed such that 20 cm may be maintained between the antenna and users.”

5.4 Compliance Information

FCC Information

Note: This equipment has been tested and found to comply with the limits for CLASS B digital device, pursuant to Part 15 of FCC Rules. These limits are designed to provide reasonable protection against harmful interference when the equipment is operated in a commercial environment. This equipment generates, uses and can radiate radio frequency energy and, if not installed and used in accordance with the instructions, may cause harmful interference to radio communications. However, there is no guarantee that interference will not occur in a particular installation. If this equipment does cause harmful interference to radio or television reception, which can be determined by turning the equipment off and on, the user is encouraged to try correcting the interference by one or more of the following measures:

1. Reorient or relocate the receiving antenna.



USER GUIDE

2. Increase the separation between the equipment and receiver.
3. Connect the equipment into an outlet on a circuit different from that to which receiver is connected.
4. Consult the dealer or experienced radio/TV technician for help.

This device complies with part 15 of the FCC Results. Operation is subject to the following two conditions :

1. This device may not cause harmful interface, and
2. This device must accept any interference received, including interference that may cause undesired operation.

WARNING

Changes or modifications not expressly approved by the manufacturer could void the user's authority to operate the equipment.

CE Information

This device is in compliance with the essential requirements and other relevant provisions of directive 1999/5/EC.

Japanese Radio Law

本機器は、電波法第 38 条の 24 第 1 項の規定に基づく認証を行ったものであることを証する。

FCC Information

This device complies with part 15 of the FCC Results. Operation is subject to the following two conditions :

- (1) This device may not cause harmful interface, and
- (2) This device must accept any interference received, including interference that may cause undesired operation.

Note: This equipment has been tested and found to comply with the limits for CLASS B digital device, pursuant to Part 15 of FCC Rules. These limits are designed to provide reasonable protection against harmful interference when the equipment is operated in a commercial environment This equipment generates, uses and can radiate radio frequency energy and, if not installed and used in accordance with the instructions, may cause harmful interference to radio communications. However, there is no guarantee that interference will not occur in a particular installation. If this equipment does cause harmful interference to radio or television reception, which can be determined by turning the equipment off and on, the user is encouraged to try correct the interference by one or more of the following measures:

- 1.1. Reorient or relocate the receiving antenna.
- 1.2. Increase the separation between the equipment and receiver.
- 1.3. Connect the equipment into an outlet on a circuit different from that to which receiver is connected.
- 1.4. Consult the dealer or experienced radio/TV technician for help.

WARNING

Changes or modifications not expressly approved by the manufacturer could void the user's authority to operate the equipment.

"CAUTION : Exposure to Radio Frequency Radiation.

This equipment complies with FCC radiation exposure limits set forth for an uncontrolled environment. This equipment must be installed and operated with minimum distance of 20cm between the radiator and your body. This transmitter module is authorized only for use in device where the antenna may be installed such that 20 cm may be maintained between the antenna and users."