

Nominal
31.75 mm

Nominal
107.95 mm

6.35 mm rad

CAUTION: To comply with FCC RF exposure limits, this device must be restricted to 50% transmit duty cycle. This radio is approved for occupational use only or must meet occupational use requirements. See Owners' Manual for specific operating requirements.

CAUTION: To comply with FCC RF exposure limits, this device must be restricted to 50% transmit duty cycle. This radio is approved for occupational use only or must meet occupational use requirements. See Owners' Manual for specific operating requirements.

LABEL COLOR: MAT SILVER

TEXT COLOR: BLACK

FONT: ARIAL 8 PT

MATERIAL: POLYESTER .002 INCHES THICK

NOTES:

1. THIS DRAWING IS FOR REFERENCE ONLY. ARTWORK IS TO BE CREATED BY VENDOR USING THE ELECTRONIC FILE SHOWN BELOW. WHICH IS SUPPLIED AND ARCHIVED IN THE "INTRALINK/LABELS" DIRECTORY AT COM-NET ERICSSON IN LYNCHBURG.
2. IMAGE SETTER OUTPUT TO BE HIGH RES. (2500 DPI) EMULSION SIDE DOWN.
3. FCC AND INDUSTRY CANADA NUMBERS CALLED FOR ON 1301-KDR 103 154 Uen.

MARKING DRAWING

Com-Net Ericsson

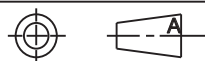

Prepared (also subject responsible if other)

PHIL JONES

Referenser - References

CAD: CorelDRAW 9
FILE: 4-1424-KRD103154-RA.cdr
DRAWING RULES: 1011-386
TOLERANCE:
DOCUMENT SIZE: A
SCALE: 1:1
UNITS: mm

Approved

(M FULK)

Date

2001-01-26

Rev

PA3

Product name

PANTHER 300M FCC EXPOSURE COMPLIANCE LABEL

Document No

4/1424-KRD 103 154

Sheet

1 (1)

