

**CONFIDENTIAL**  
The contents of this document is the property of Hitachi Metals Ltd. and may not be communicated to any other party in any form without the prior written contents of Hitachi Metals Ltd.

<b>P/N</b>	<b>SMA-S080C</b>	<b>DATE.</b>	<b>'03-12-17</b>	
<b>DWN.</b>	<b>H. Aoyama</b>	<b>DATA-No.</b>	<b>2MT43463</b>	<b>3</b>

# *Small Ceramic Chip Antennas* *for Model RD5130*

*Measurement Data of SMA-S080C*

P/N	SMA-S080C	DATE.	'03-12-17
DWN.	H. Aoyama	DATA-No.	2MT43463 3

## 1. Target Specification

Size (L x W x H)	16mm x 7mm x t5mm
Frequency Range	824 - 894MHz
Band width (Typ.) (VSWR<2.5)	70MHz
Peak Gain	-3 dBi Typ.
Input Impedance	50 Ohm Typ.

## 2. Shape and Size

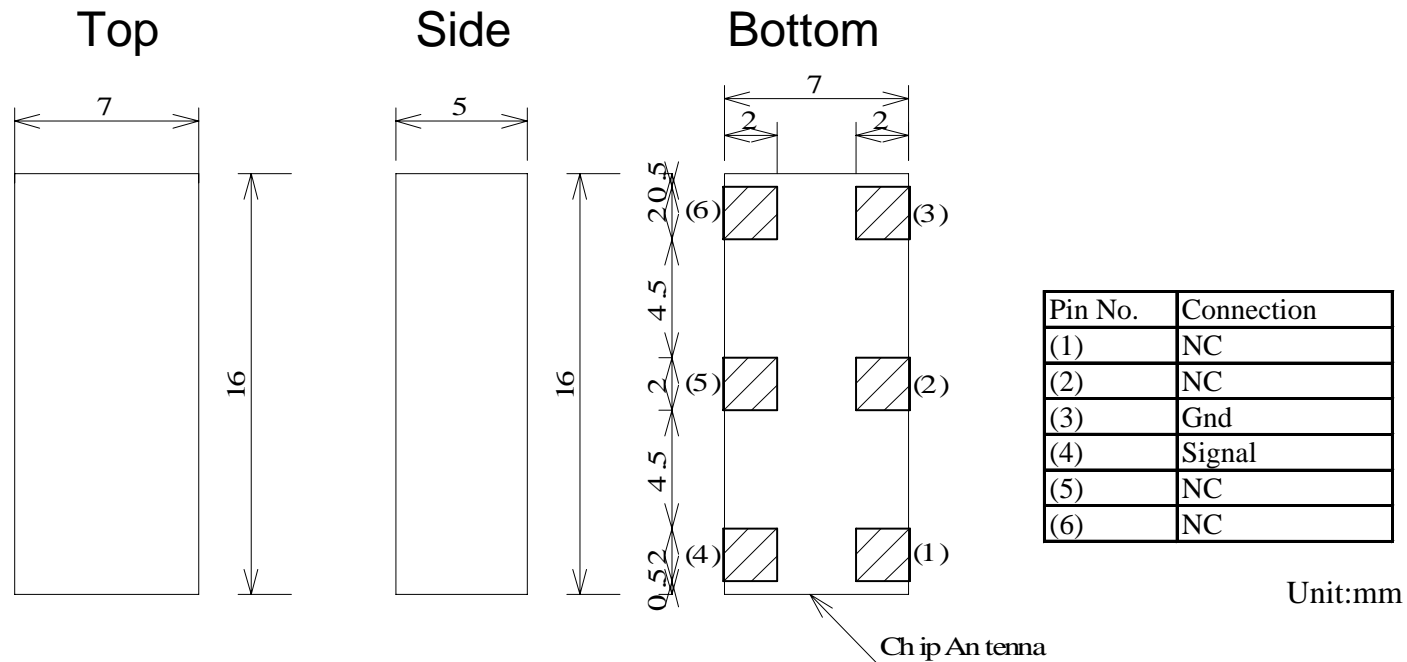

P/N	SMA-S080C	DATE.	'03-12-17
DWN.	H. Aoyama	DATA-No.	2MT43463 3

### 3. Foot Pattern

**Parts Side**

**Back Side**

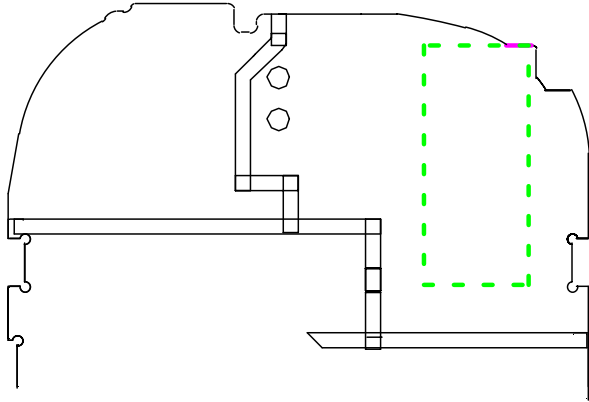
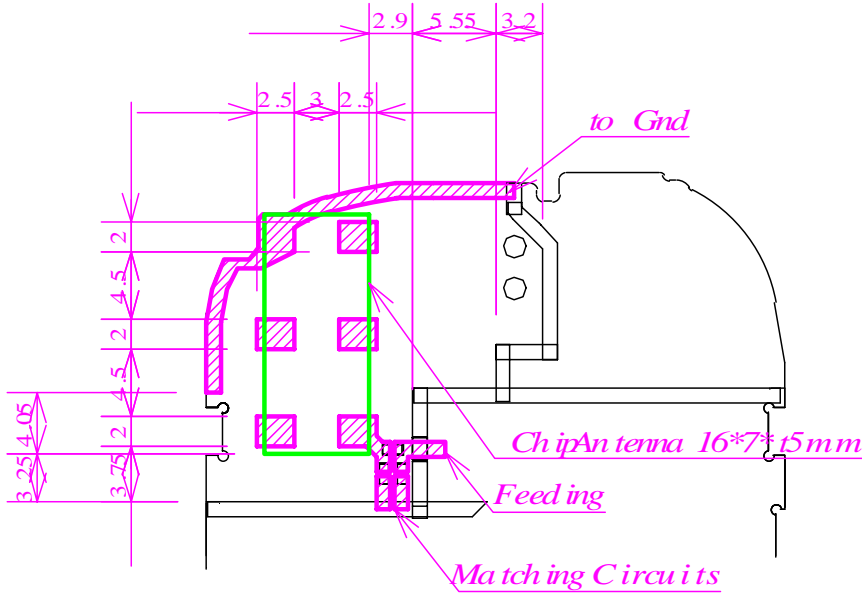

Shaded Area is Conductor

P/N	SMA-S080C	DATE.	'03-12-17
DWN.	H. Aoyama	DATA-No.	2MT43463 3

## 4. VSWR

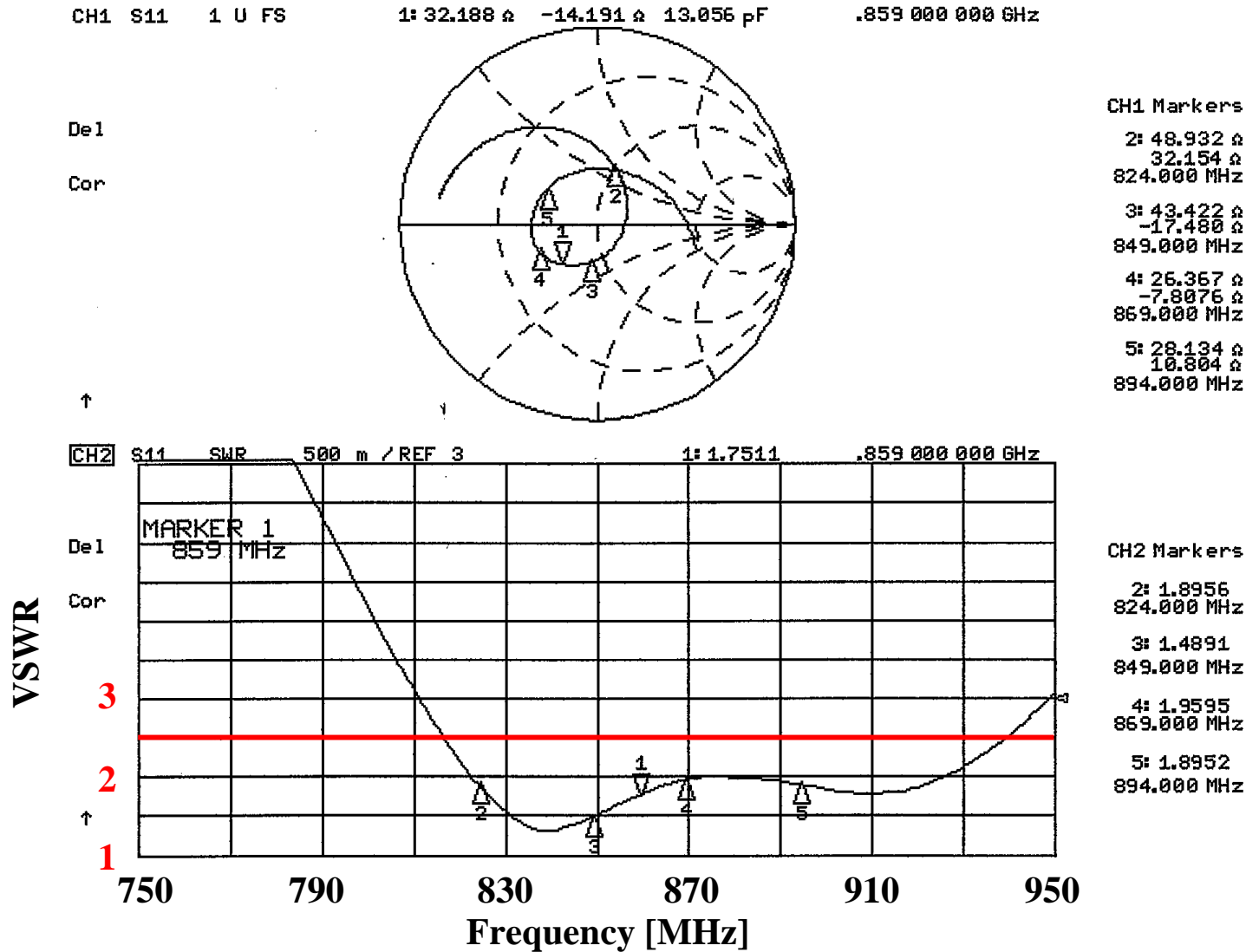

P/N	SMA-S080C	DATE.	'03-12-17
DWN.	H. Aoyama	DATA-No.	2MT43463 3

## 5. Antenna Gain

