



**COMPANY NAME:** NMB TECHNOLOGIES, INC.  
**EUT:** RT3602  
**WORK ORDER NUMBER:** 2000383  
**FCC ID:** AQ6-3602

## **16 LABELING INFORMATION**

---

### **16.1 LABEL**

**Please see the following attached page.**

APPLICATION		REVISION			FL1724
NEXT ASSY	USED ON	LTR	DESCRIPTION	DATE	APPROVED
125909-XXX	125909-XXX	01	ENGINEERING RELEASE VR	6/27/00	KS
125910-XXX	125910-XXX	02	AGENCY CHANGE VR	7/20/00	KS
125912-XXX	125912-XXX	03	REVISED, ADDED FCC STATMENT VR	8/8/00	KS
125913-XXX	125913-XXX				

FCC ID : AQ6-3602  
MODEL NO. : RT3602 V:5STW  
PART NO. : 7002737 BARCODE  
SERIAL NO. : MDDYXXXX BARCODE

Microsoft, Windows, and the Windows logo are registered trademarks of Microsoft Corporation in the United States and/or other countries.

THIS DEVICE COMPLIES WITH PART 15 OF THE FCC RULES. OPERATION IS SUBJECT TO THE FOLLOWING TWO CONDITIONS: (1) THIS DEVICE MAY NOT CAUSE HARMFUL INTERFERENCE AND (2) THIS DEVICE MUST ACCEPT ANY INTERFERENCE RECEIVED, INCLUDING INTERFERENCE THAT MAY CAUSE UNDESIRED OPERATION.

  
  

5 VDC 75mA MAX.

COMPLIES WITH CANADIAN ICES-003 CLASS B

WARNING: IMPROPER OR PROLONGED KEYBOARD USE MAY RESULT IN INJURY.

MADE IN THAILAND

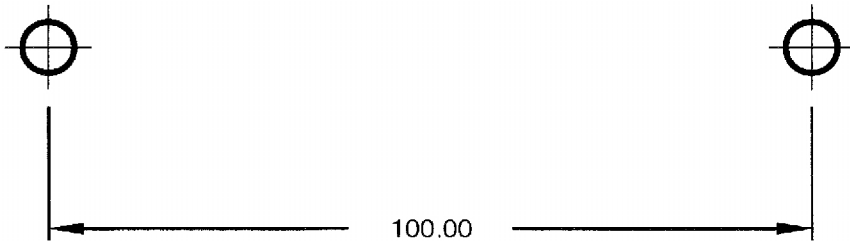

UNLESS OTHERWISE SPECIFIED DIMENSIONS ARE IN   MM FRACTIONS DECIMALS ANGLES  X/X±           .XX± 0.25   X°± .XXX±	APPROVALS		DATE		<div>NMB TECHNOLOGIES CORPORATION</div>						
	DRAWN	Rennie Santiago	6/27/00								
	CHKED	Victor Ramirez	6/27/00		TITLE  ARTWORK, KEYBOARD ID  (MILLENIUM) - GATEWAY						
	APPRVD	Koji Sudo	6/28/00								
<u>Notice of Proprietary Property</u> The information contained herein is the trade secret and confidential property of NMB (USA), inc. or its subsidiaries. The possessor agrees to maintain this document in strict confidence and is prohibited from copying, distributing, revealing or publishing it in whole or in part without the express permission of NMB (USA), inc. or its subsidiaries.				SIZE		CODE IDENT NO.		DRAWING NO.		REV.	
DO NOT SCALE DRAWING				A		27233		126074		03	
				SCALE    1/1		CC:    00094		SHEET   1   OF   1			



**COMPANY NAME:** NMB TECHNOLOGIES, INC.  
**EUT:** RT3602  
**WORK ORDER NUMBER:** 2000383  
**FCC ID:** AQ6-3602

## **16.2 LABEL LOCATION**

**Please see the following attached page.**

Location of FCC Label

