

# INSTALLATION INSTRUCTIONS

## WFSM WIFI Single Relay Smart Switch Module

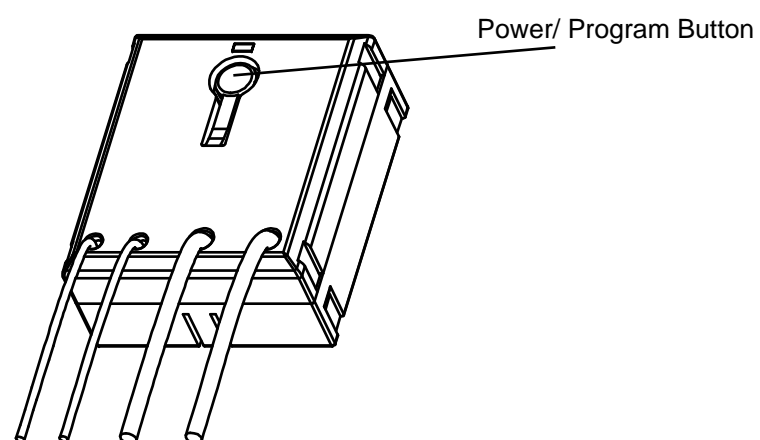

### ◆ SPECIFICATIONS

Voltage.....	120-277VAC, 50/60Hz
Maximum Load requirement.....	10A
Wireless Type.....	2.4GHz
Protocol.....	IEEE 802.11b/g/n
System Requirements.....	Android 4.1 or higher, iOS 8 or higher
Indoor Use Operating Temperature.....	32°F~104°F(0°C~40°C) Type 1.B action, operating control

### ◆ FEATURES

- You can control lights, fans, humidifiers, Air conditioner, and any small appliances in accordance with the Smart Switch Module's specifications.
- You can Turns your devices on or off at any time or any where have Internet using the free Tuya Smart App on your smartphone.
- You can efficiently conserve energy and save money while using this Smart Switch Module.
- Compatible with the Amazon Echo, the free Tuya app compatible with any Android (4.1 and higher) or iOS (iOS 8 and higher) smartphone.

### ◆ DESCRIPTION

The WFSM Plug is our industry's first WIFI Single Relay Smart Switch Module, which can make our life more convenient. This Smart Switch Module can be controlled by manual or you can through App to remote control turn on/off light, countdown and make weekly plan after connect 2.4GHz WIFI .

### ◆ INSTALLATION

### Simple Wiring Diagram: Fig1

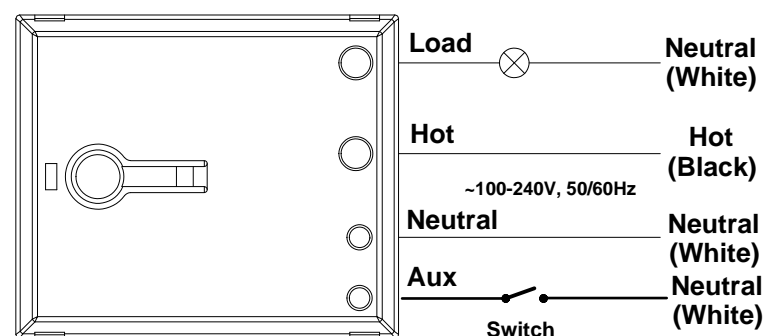

### 3-way Circuits Wiring Diagram: Fig2

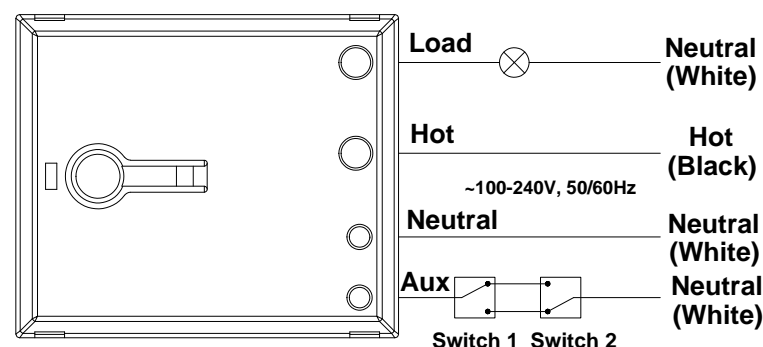

### IMPORTANT NOTE ABOUT 3-WAY CIRCUITS

The term "3-way circuit" refers to a circuit with two switches and one load (light) like you find at the top and bottom of a stairway. There are many ways to physically wire a 3-way circuit and it is important to understand how the circuit you wish to upgrade to WIFI device is wired. One of the ways, the of WFSM to wire a 3-way switch 2(Fig2), then wire to 3-way switch, and then wire to the Neutral. Although very common and by no means a standard, it is the easiest to convert to WIFI device. with this type of circuit, WFSM is seting behind the switch 2. Do not change the wiring of switch1. Please note that both switch 1 and switch 2 must be 3-way switch.

**Please consult an electrician if you have trouble indentifying the type of wiring circuit you wish to convert or if you do not feel confident in your ability to convert the circuit to WIFI device.**

1. WARNING : To avoid fire, shock, or death. Turn off power at circuit breaker or fuse and test that power is off before wiring.
2. Remove wall plate and switch mounting screws.
3. Carefully remove the switch from the switch box.
4. Disconnect the wiring from the existing switch.
5. Connect the WFSM module as shown in the wiring diagram
6. Check connections to be sure they are tight and no bare conductors are exposed.
7. Insert the WFSM module into the box first, then wire the existing switch.
8. Attach the wall plate.
9. Restore power at the circuit breaker and test the system.

### ◆ OPERATIONS

#### Manual Control

The Power/ Program Button or connected switch on the WFSM smart switch module allows the user to:

1. Manually turn ON the Module: press and release the program button or toggle the connected switch. The Blue LED indicator will turn ON, and the appliance will turn ON.
2. Manually turn OFF the Module: press and release the program button toggle the connected switch. The Blue LED indicator will turn ON, and the appliance will turn OFF.

#### Connected Switch Control

Toggle the connected switch to turn on and off three times and repeat the operation two times after waiting above 10 seconds. When the load lamp turn on and off twice and then turn off that means you can connect the WIFI .

#### Tuya Smart App Control

1. Download Tuya Smart app from the App Store or Google Play.



OR scan  
QR code



2. Connect mobile device to your 2.4GHz WIFI network. Please note this Smart outlet can only be connected to 2.4GHz network.



3. Launch Tuya and follow the in-app instructions to connect the WIFI outlet to your network.

a. Login the Tuya

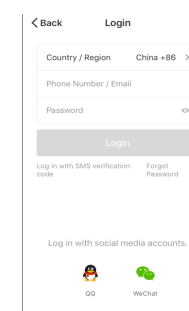

b. Click the " Add Device "

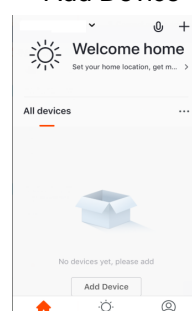

c. Click the " All device "

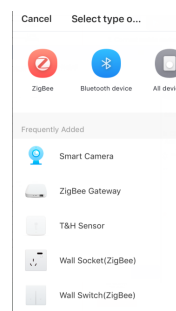

d. Select the "Electrical outlet"

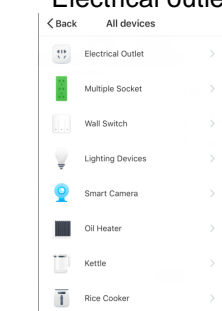

# INSTALLATION INSTRUCTIONS

d. Click the bottom button

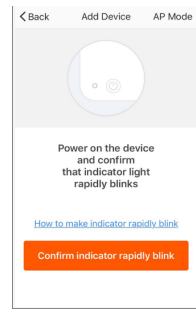

e. Enter your wifi password

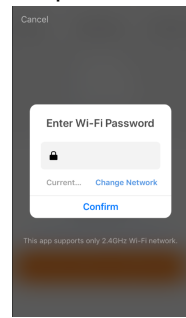

f. Finished

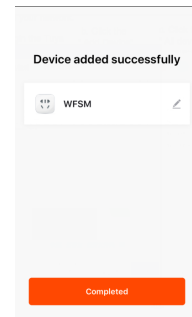

4. When the device is finished add, this WIFI Outlet can be opened, closed, countdown, making weekly plan and can check the electric quantity.

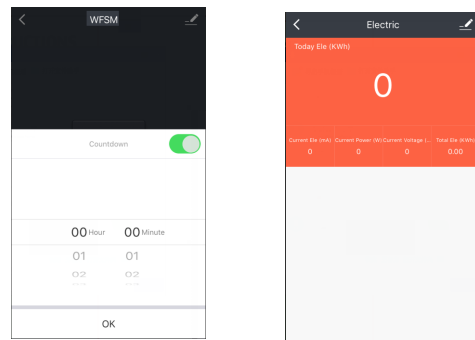

## Please Note:

- In the process of adding device, you must correctly select the router's WIFI device name and fill in the correct WIFI password, otherwise the device will not be able to add successfully.
- This WIFI Outlet can only be paired with one phone device. If you want multiple phones to control the WIFI Outlet, click the "profile" then chose the " Device Sharing".

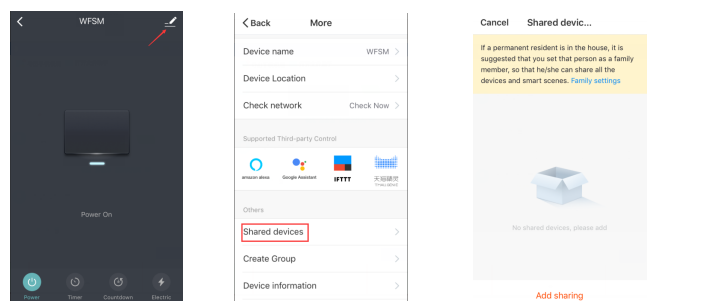

3. When the device fail to add in the App, please try to enter the AP mode. When power is reconnected after the interruption, press and hold the program button 5 seconds until the LED indicator in quick blinks. Or connect the toggle switch, turn on/off 3 times in 3 seconds then after 10 seconds turn on/off twice, the LED indicator in quick blinks after that repeat the above operation again then the LED indicator in slowly blinks that means successfully enter in AP mode.

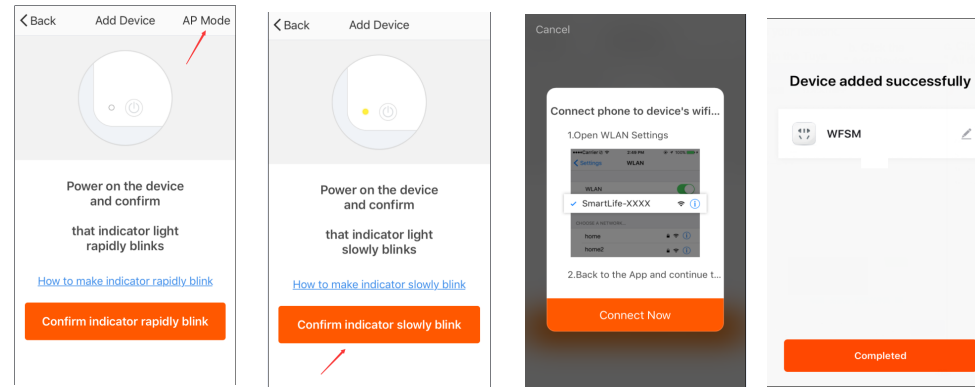

## OPERATION AND LED INDICATION

When power is reconnected after the interruption, press and hold the program button 5 seconds until the LED indicator in quick blinks. Or connect the toggle switch, turn on/off 3 times in 3 seconds then after 10 seconds turn on/off twice, the LED indicator in quick blinks.

**Quick Blinking Green:** Connecting to the network.

**Slow Blinking Green:** AP mode.

**Green bright after 2 seconds off:** Connected to the network.

**Soild Green:** Network normally or in standby mode.

**Solid Blue:** The WIFI Smart Switch is switched on.

**Off Blue:** The WIFI Smart Switch is switched off.

please note that: turn off-on-off-on-off that is connecting to the network .

Turn off-on-off-on that is entering AP mode.

## Restoring Factory Defaults

Press and hold the program button 5 seconds until the LED indicator in quick blinks. Or connect the toggle switch, turn on/off 3 times in 3 seconds then after 10 seconds turn on/off twice, the LED indicator in quick blinks.

## FCC COMPLIANCE STATEMENT

### Federal Communication Commission Interference Statement

The equipment has been tested and found to comply with the limits for a class B Digital Device, pursuant to part 15 of the FCC Rules. These limits are designed to provide reasonable protection against harmful interference in a residential installation. This equipment uses, generates and can radiate radio frequency energy and, if not installed and used in accordance with the instruction, may cause harmful interference to radio communication. However, there is no guarantee that interference will not occur in a particular installation. If this equipment does cause harmful interference to radio or television reception, which can be determined by turning the equipment off and on, the user is encouraged to try to correct the interference by one or more of the following measures:

- Reorient or relocate the receiving antenna.
- Increase the separation between the equipment and receiver.
- Connect the equipment into an outlet on a circuit different from that to which the receiver is connected.
- Consult the dealer or an experienced radio/TV technician for help.

### FCC Caution:

This device complies with Part 15 of the FCC Rules. Operation is subject to the following two conditions: 1. This device may not cause interference, and 2. This device must accept any interference received, including interference that may cause undesired operation.

### FCC Radiation Exposure Statement:

This equipment complies with FCC radiation exposure limits set forth for an uncontrolled environment. This equipment should be installed and operated with minimum distance 20cm between the radiator & your body.

RF Exposure: A distance of 20 cm shall be maintained between the antenna and users, and the transmitter module may not be co-located with any other transmitter or antenna.

### Non-modification Statement:

Any changes or modifications not expressly approved by the party responsible for compliance could void the user's authority to operate this equipment.

### ISED Statement

This device contains licence-exempt transmitter(s)/receiver(s) that comply with Innovation, Science and Economic Development Canada's licenceexempt RSS(s) . Operation is subject to the following two conditions:

- (1) This device may not cause interference, and
- (2) This device must accept any interference, including interference that may cause undesired operation of the device.

Le présent contient des émetteurs / récepteurs exemptés de licence conformes aux RSS (RSS)d'Innovation, Sciences et Développement économique Canada.

L'exploitation est autorisée aux deux conditions suivantes:

- (1) l'appareil ne doit pas produire de brouillage, et
- (2) l'utilisateur de l'appareil doit accepter tout brouillage radioélectrique subi, même si le brouillage est susceptible d'en compromettre le fonctionnement.

### Radiation Exposure Statement

This equipment complies with Canada radiation exposure limits set forth for an uncontrolled environment. This equipment should be installed and operated with minimum distance 20cm between the radiator & your body.

### Déclaration d'exposition aux radiations

Cetéquipementestconforme Canada limitesd'exposition aux radiations dans un environnement non contrôlé. Cetéquipementdoitêtreinstallé et utilisé à distance minimum de 20cm entre le radiateur et votre corps.

## WARRANTY INFORMATION

Our company warranties its products to be free of defects in materials and workman-ship for a period of two (2) years. There are no obligations or liabilities on the part of our company for consequential damages arising out of or in connection with the use or performance of this product or other indirect damages with respect to loss of property, revenue, or profit, or cost of removal, installation or reinstallation.