

## Device Installation Guide

### Option 1 : On wall directly

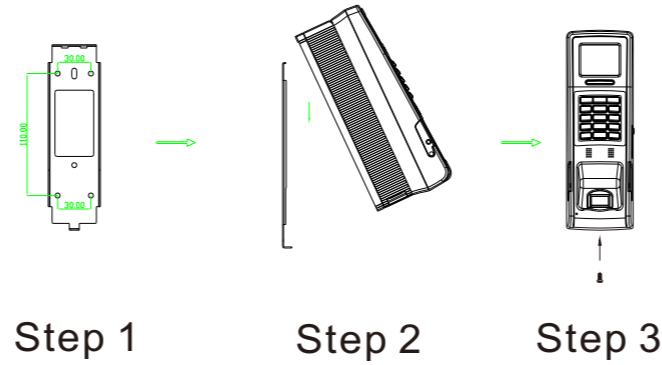

- Step 1: Screw stainless steel plate according to the 4 holes marked on the drawing, choose right size of screws by different walls
- Step 2: Insert installing device aimed to stainless steel plate.
- Step 3: Fasten this screw on the bottom.

### Option 2 : The cassette (86x86) on wall

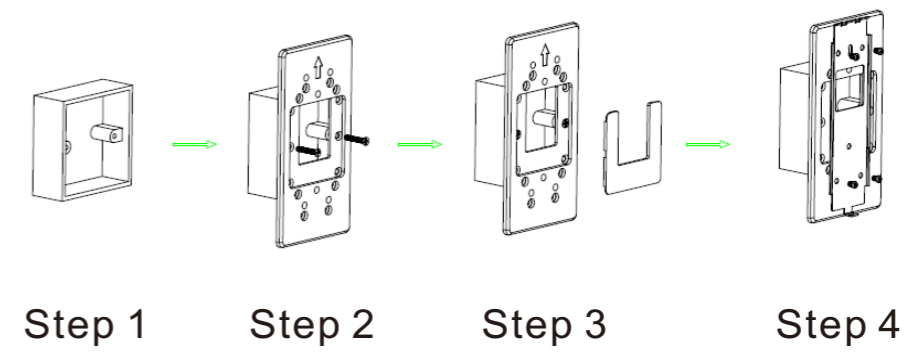

- Step 1: Cassette (86\*86)
- Step 2: Screw fixing board to cassette, choose the right size of screws by different cassettes.
- Step 3: Cover the fixing board.
- Step 4: Screw stainless steel plate to fixing board, then install device on the stainless steel plate.

## Introduction for Function and Technical Data

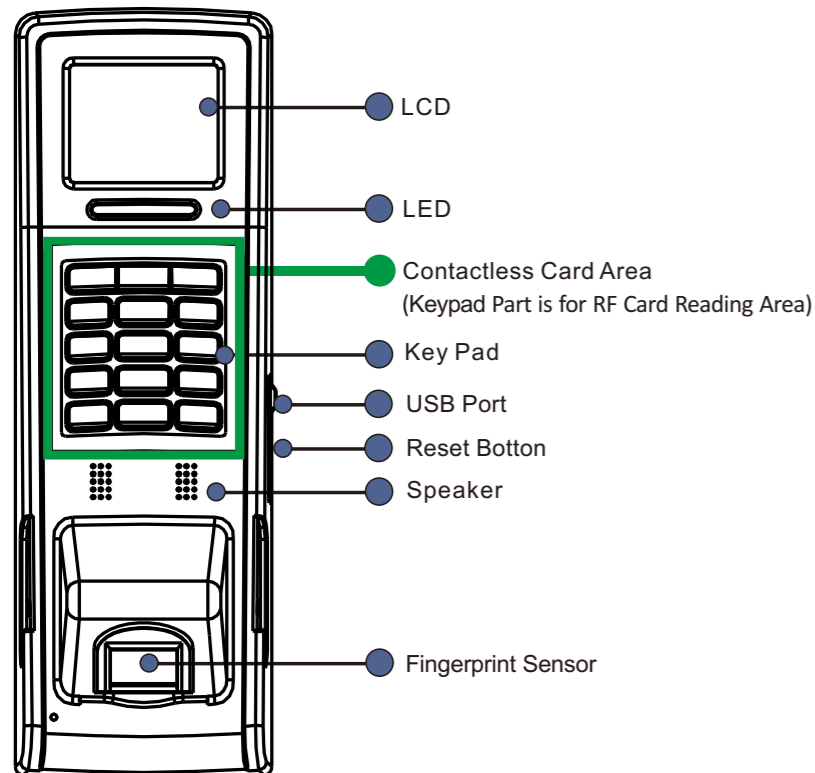

List	Quantity
Mini-Gate biometric access control	1
Fixing board A (plastic)	1
Fixing board B (plastic)	1
Screw (PM4X5)	4+2
Screw (PWM3X5)	1
Screw (FM 2X6)	2
Power Adapter (DC 12V/1.5A)	1
RJ45 Network Port Connector	1
DC12V Power Connector	1
L spanner	1
Mini-Gate User Manual	1

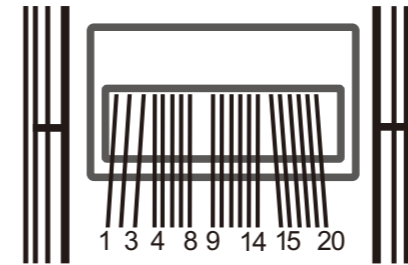

Type	No	Name	Color
Relay	1	Relay 12V+	Yellow
	2	Relay-	Orange
	3	GND(Relay GND)	Black
	4	Wiegand_In_D1/LED_input	Brown
Wiegand	5	Wiegand_In_D0	Purple
	6	GND(Wiegand GND)	Black
	7	Wiegand_Out_D1	White
	8	Wiegand_Out_D0	Green
RS485 Power	9	P_GND(Safety GND)	Yellow&Green
	10	GND(RS485 GND)	Black
	11	RS485+	Blue
	12	RS485-	Gray
	13	GND(Power GND)	Black
	14	Power_In(12V)	Red
Ethernet	17	RX-	Blue
	18	RX+	Green
	19	TX-	White
	20	TX+	Yellow
	21	UART For GPRS Module	7 PIN_Female_Connector
	22		
	23		
24			
25			
26			
27			

- Model: ACD100P-CB
- Processor: SAM9G45@400MHz, Processor
- Memory: 128 MB DDR/ 128MB Flash
- Expansion Memory: Micro SD(2GB for default configuration)
- LCD Display: 1.8" TFT Color LCD
- LED Indicator: Multi-color × 3
- Keypad: 3 X 5 keypad
- Audio: Beep
- PC Port: USB2.0
- Built-in Relay Control: 1
- Power supply: 12V DC/1.5A
- Current: 450mA @ 12V
- Operating Temperature: 0 ~ 45° C
- Storage Temperature: 0 ~ 45° C
- Fingerprint Sensor: Cogent CSD100, 500dpi Optical Sensor, (FBI Certified)
- Matching Speed: 1:1 ≤ 1.2s, 1:N ≤ 2s (N ≤ 5000)
- FRR: 1%
- FAR: 0.001%
- Matching Security Grade: Lower, Middle, High (Configurable)
- Acceptable Fingerprint Rotation: +/-15 degree (Default)

# Module and Function Guide

## Standard Mode

### Time Setting



Date  YYYY  MM  DD

Time  HH  MM  SS

### Lightness Setting

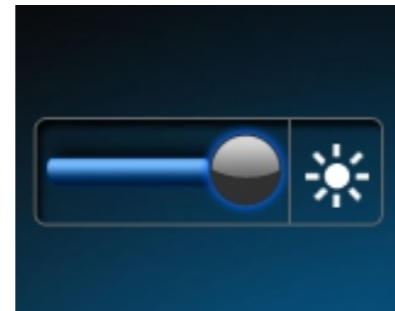

### Network Setting

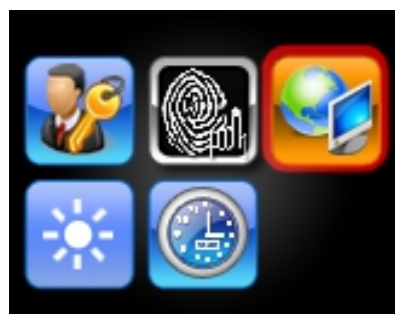

IP  .  .  .

Mask  .  .  .

Gateway  .  .  .

Server IP  .  .  .

Server Port

Local Port

## Advanced Mode

### Administrator Setting and User Setting



Note:  
Factory Default: Administrator user ID:"1"; Pin #:"1".  
This will be invalid after new admin setup.  
"User setting" should be changed to "admin setting"

### Add Administrator

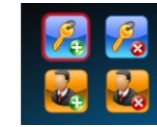

Admin ID:

Pin #:

Pin # again:

### Delete Administrator

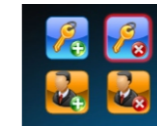

Admin ID:

### Add User

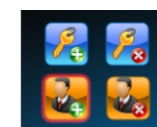

User ID:

### Delete User

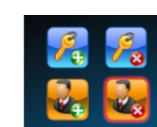

User ID:

### Fingerprint Mode

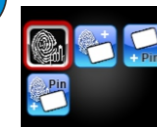

For fingerprint identify, select this mode.

### Fingerprint + Card Mode

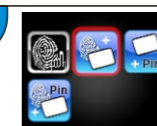

For fingerprint + card identify, select this mode.

### Card + PIN Mode

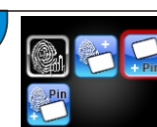

For card + pin identify, select this mode.

### Fingerprint + Card + PIN Mode

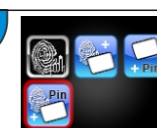

For fingerprint + card + pin identify, select this mode.

### Mode Setting



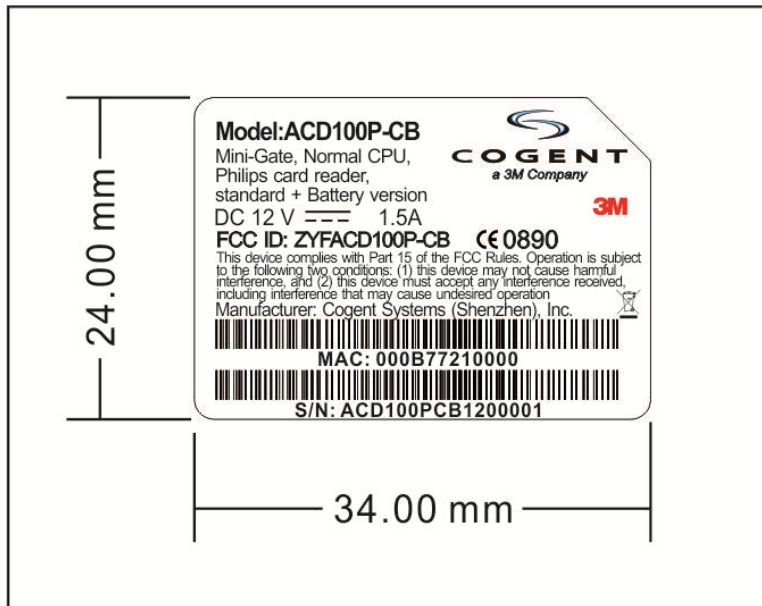

## FCC Statements

changes or modifications not expressly approved by the party responsible for compliance could void the user's authority to operate the equipment.

This equipment has been tested and found to comply with the limits for a Class B digital device, pursuant to Part 15 of the FCC Rules. These limits are designed to provide reasonable protection against harmful interference in a residential installation. This equipment generates, uses and can radiate radio frequency energy and, if not installed and used in accordance with the instructions, may cause harmful interference to radio communications. However, there is no guarantee that interference will not occur in a particular installation.

If this equipment does cause harmful interference to radio or television reception, which can be determined by turning the equipment off and on, the user is encouraged to try to correct the interference by one or more of the following measures:

- Reorient or relocate the receiving antenna.
- Increase the separation between the equipment and receiver.
- Connect the equipment into an outlet on a circuit different from that to which the receiver is connected.
- Consult the dealer or an experienced radio/TV technician for

**Remark: 1 USB port is used to firmware upgrade purpose, without loading.**

**2 This device is installed on the wall. And the all the ports are in the wall. People can't touch.**

**3 CAUTION**

**Risk of explosion if battery is replaced by an incorrect type.**

**Dispose of used batteries according to the instructions.**