

GENEVA SOUND SYSTEM  
MODEL XS

01	Manual - English
05	Bedienungsanleitung - Deutsch
09	Mode d'emploi - Français
13	Manual del usuario - Español
17	Manuale dell'utente - Italiano
21	Handleiding - Nederlands
25	Brugervcejledning - Dansk
29	Användar Manual - Svenska
33	Bruksanvisning - Norsk
37	Käyttöohje - Suomi
41	Manual do usuário - Português



## IMPORTANT SAFETY INSTRUCTIONS

1. Read these instructions
2. Keep these instructions
3. Heed all warnings
4. Follow all instructions
5. Do not use this device near water.
6. Only clean with a dry cloth.
7. Do not block any vents. Install in accordance with the manufacturer's instructions.
8. Do not install near any heat sources such as radiators, heaters, stoves, or other devices (including amplifiers) that produce heat.
9. Do not defeat the safety purpose of the polarized or grounding-type plug. A polarized plug has two blades with one wider than the other. A grounding type plug has two blades and a third grounding prong. The wide blade or the third prong are provided for your safety. If the provided plug does not fit into your outlet, consult an electrician for replacement of the obsolete outlet.
10. Protect the power cord from being walked on or pinched particularly at the plugs, convenience receptacles, and the point where they exit from the device
11. Only use attachments/accessories specified by the manufacturer.
12. Use only with the cart, stand, tripod, bracket, or table specified by the manufacturer, or sold with the device. When a cart is used, use caution when moving the cart/device combination to avoid injury from tip-over.
13. Unplug this device during lightning storms or during long periods of disuse.
14. Refer all servicing to qualified service personnel. Servicing is required when the device has been damaged in any way, such as power-supply cord or plug damages, liquid has been spilled or objects have fallen into the device, the device has been exposed to rain or moisture, does not operate normally, or has been dropped.
15. Do not install this equipment in a confined or built-in space such as a book case or similar unit, and maintain well-ventilated conditions. The ventilation should not be impeded by covering the vents with items such as newspaper, table-cloths, curtains etc.
16. **WARNING:** Please refer the information on exterior bottom enclosure for electrical and safety information before installing or operating the device
17. **WARNING:** To reduce the risk of fire or electric shock, do not expose this device to rain or moisture. The device should not be exposed to dripping or splashing and objects filled with liquids, such as vases, should not be placed on the apparatus.
18. **CAUTION:** Danger of explosion if battery is incorrectly replaced. Only replace with the same or equivalent type.
19. **WARNING:** The battery (battery or batteries or battery pack) should not be exposed to excessive heat such as sunshine, fire or the like.
20. **WARNING:** The direct plug-in adapter is used as a cut-off device, the cut-off device should remain readily operable.
21. **Correct Disposal of this product.** This marking indicates that this product should not be disposed with other household wastes throughout the EU. To prevent possible harm to the environment or human health from uncontrolled waste disposal, recycle it responsibly to promote the sustainable reuse of material resources. To return your used device, please use the return and collection systems or contact the retailer where the product was purchased. They can take this product for environmental safe recycling.

**CAUTION:** Risk of explosion if battery is replaced incorrectly.

Replace only with a battery of the correct type and model number (Geneva Sound System, Model XS Replacement Battery).

**Operating Temperatures:** The recommended operating temperature range for the Geneva Sound System is 5..40 degrees Celsius / 41..104 degrees Fahrenheit.

Use the original power adapter: Only use the supplied original power adapter to power and charge the Geneva Sound System. Other power adapters might look similar, but using them could result in electric shock and could damage the Geneva Sound System.

In case of an electrostatic discharge of at least +/- 4 kV the unit may malfunction and will require to powered off and on again.



## LABEL LOCATION

The product labels, FCC information and safety related markings are located in the battery compartment of the Geneva Sound System and the power adapter.

## FCC REGULATIONS

**Warning:** Changes or modifications to this unit not expressly approved by the party responsible for compliance could void the user's authority to operate the equipment.

**\*NOTE:** This equipment has been tested and found to comply with the limits for a Class B digital device, pursuant to Part 15 of the FCC Rules. These limits are designed to provide reasonable protection against harmful interference in a residential installation. This equipment generates, uses and can radiate radio frequency energy and, if not installed and used in accordance with the instructions, may cause harmful interference to radio communications. However, there is no guarantee that interference will not occur in a particular installation.

If this equipment does cause harmful interference to radio or television reception, which can be determined by turning the equipment off and on, the user is encouraged to try to correct the interference by one or more of the following measures:

- Reorient or relocate the receiving antenna.
  - Increase the separation between the equipment and receiver.
  - Connect the equipment into an outlet on a circuit different from that to which the receiver is connected.
  - Consult the dealer or an experienced radio/TV technician for help.
- AC/DC Adapter with one of ferrite ring must be used with this unit to ensure compliance with the Class B FCC limits.

Modifications not expressly approved by the manufacturer could void the user's authority to operate the equipment under FCC rules.

FCC ID: ZXX-MODELXS

"ZXX": Grantee Code, assigned by the FCC.

## RECYCLING

This product can be recycled. Products bearing this symbol must NOT be thrown away with normal household waste. At the end of the product's life, take it to a collection point designated for recycling of electrical and electronic devices. Find out more about return and collection points through your local authority.

The European Waste Electrical and Electronic Equipment (WEEE) Directive was implemented to dramatically reduce the amount of waste going to landfills, thereby reducing the environmental impact on the planet and on human health. Please act responsibly by recycling used products. If this product is still usable, consider giving it away or selling it.

Used batteries: Please dispose of used batteries properly, following the local regulations. Do not place the battery in fire.



**CE 0979**

Hereby, G-Lab GmbH, declares that this Model XS is in compliance with the essential requirements and other relevant provisions of Directive 1999/5/EC. The declaration of conformity may be consulted at request to G-Lab GmbH, Zurich, Switzerland or on <http://genevalab.com>. Geneva\* is a registered trademark of G-Lab GmbH.

Apple, iPod, iPhone and iPad are trademarks of Apple Computer, Inc. registered in the U.S. and other countries.

The trademark "EmbracingSound" is owned by Embracing Sound Experience AB.

The Bluetooth® word mark and logos are registered Trademarks owned by Bluetooth SIG, Inc.

© 2011 G-Lab GmbH. All rights reserved. Under the copyright laws, this manual may not be copied, in whole or in part, without the written consent of G-Lab GmbH.

Geneva Sound System, Model XS, User Manual, Version v1.0-A, 8/2011

# GETTING STARTED

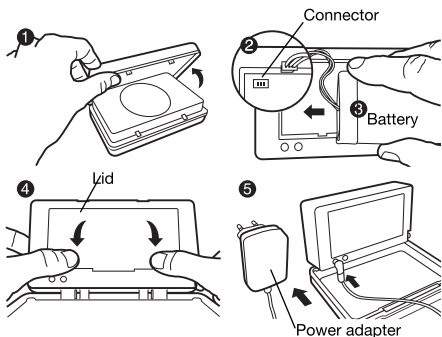

## Inserting the Rechargeable Battery

1. Open the case and turn your Model XS so you can access the battery compartment on the back.
2. Plug the battery cable into the small white connector in the upper left corner of the battery compartment.
3. Place the battery into the back compartment. Carefully fold the cable next to the battery.
4. Take the lid and push it until it snaps in.

## Charging the Battery

5. Once the battery is in place, plug the power adapter cord into your Model XS ("DC 5.5V").

## Turning the Power On

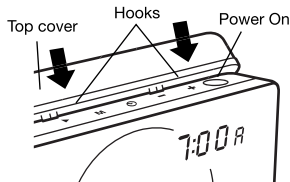

1. Open the case.
2. Insert the two hooks of the top cover into the Model XS.

When the Model XS is not in the correct position, it will automatically turn off to save battery power.

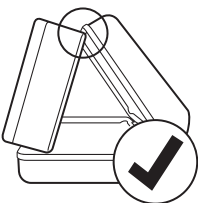

Correct position

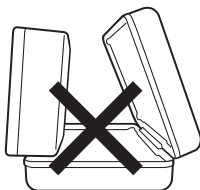

Turns off automatically

# OVERVIEW

You can play music from the following sources:

- FM Radio
- Mobile phone or computer via Bluetooth
- Other devices with a Line-In cable

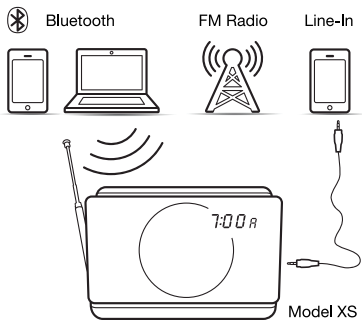

## Model XS

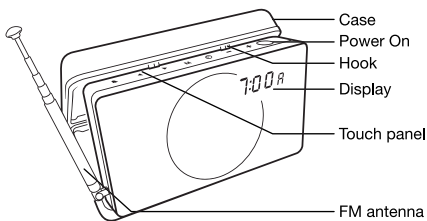

## Included Accessories

- Power adapter
- Line-In cable
- Protective bag
- User manual

## Touch Panel

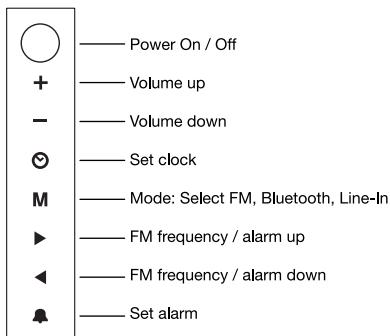

## USING THE MODEL XS

### FM Radio

1. Touch **M** until the display shows an FM frequency, for example "103.2".
2. Select an FM station with ◀ and ▶:
  - Use a single touch: change frequency by 0.1 MHz.
  - Hold down for a short time: automatically search for another station.

For optimal reception extend the built-in antenna.

### Bluetooth

Mobile phones and computers with Bluetooth can connect to the Model XS and play music.

The mobile phone or computer must support Bluetooth A2DP. Detailed guides on various devices with Bluetooth A2DP can be found at [www.genevalab.com](http://www.genevalab.com), select "Support".

### Initial Setup ("pairing") With iPhone®

1. Touch the **M** key until the display shows "Blue".
2. Select "settings" on your iPhone®. Select "General / Bluetooth". Turn on Bluetooth. New Bluetooth devices are discovered automatically. After a few seconds "Geneva XS Sound System (Not Paired)" will appear.
3. Select "Geneva XS Sound System". The phone is now connecting ("pairing") to the Model XS.
4. If the phone asks for a PIN: enter "0000" (four zeros).
5. Now you can play music on an iPhone® App "iPod" and listen to it on the Model XS.

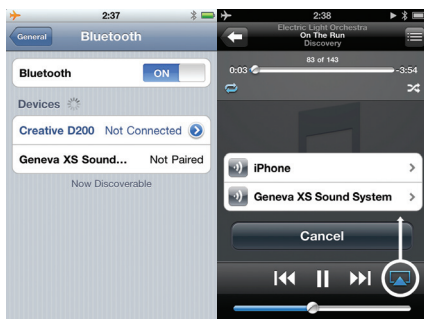

Setting on iPhone®

Playing music with App "iPod"

### Playing Music

Most phones connect automatically to the Model XS after the initial setup ("pairing").

1. Touch the **M** key on your Model XS until the display shows "Blue".
2. Play music on the mobile phone, music will start playing on Model XS automatically after a few seconds.

Initial setup ("pairing") with other devices. See detailed guides at [www.genevalab.com](http://www.genevalab.com), select "Support".

### Line-In

Not all audio devices have Bluetooth. Model XS also connects via a 3.5 mm / 1.8" stereo input.

1. Connect one end of the supplied Line-In cable to the audio device (headphone or Line-Out plug).
2. Connect the other end of the cable to the Line-In plug on the back of Model XS Ⓞ.
3. Touch **M** until the display shows "Line".

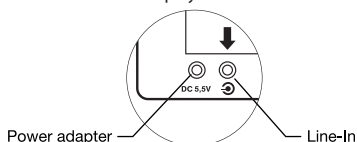

### Alarm

#### Setting the Alarm

1. Turn on Model XS, then touch ⚙: a blinking "A" appears on the display.
2. Set the desired alarm time using ◀ and ▶.
3. Touch ⚙ again to save the alarm time. "A" indicates alarm is now on.

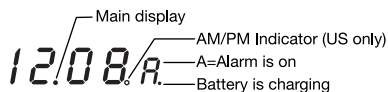

#### Turning the Alarm On And Off

Turn off Model XS, then touch any key on the touch panel to toggle the alarm. "A" on the display indicates the alarm is on.

#### Muting the Alarm

Touch any key on the touch panel to mute the alarm. The alarm will automatically turn off after 20 minutes if no key on the touch panel is touched.

#### Selecting the Alarm Sound

There are two alarm sounds: FM radio and a beeping sound. If you set the alarm and the current mode is FM, the FM radio will play when the alarm goes off. Otherwise the beeping sound is used.

#### Setting the Clock

1. Turn on Model XS, then touch Ⓞ. The letter "C" starts blinking on the display.
2. Use ◀ and ▶ to set the current time.
3. Touch Ⓞ to complete the procedure.

#### AM/PM Display: US Version Only

The dot to the right of the minute digits indicates AM or PM:

- Off: AM
- On: PM

## TROUBLESHOOTING

The Model XS will not turn on, the display shows "low" and "batt". "low" and "batt" means low battery. Connect the power adapter to the Model XS and the battery will begin charging. You can use the Model XS right away. The Model XS will not turn on, nothing happens. If the battery is very low, there is too little power to turn on the display, even if the power adapter is connected. Model XS can be turned on after it has been connected for a few to the power adapter.

Why is the Model XS turning off after a while?

After one minute the device will automatically turn itself off, when it is not in the correct position (see figure in "Turning the Power On").



The Model XS does not turn on when I touch the  button.

Touch  with one finger only. Don't touch the rest of the touch panel with other fingers. The touch panel works properly when used with one finger only.

After turning on, the Model XS turns itself quickly off and on again.

Model XS automatically self-calibrates the touch panel for a second time. This is the correct behavior and is nothing to worry about.

What is the PIN for a Bluetooth connection?

The PIN is: 0000 (4 zeros). Not all computers or mobile phones require a pin code during the initial setup (pairing).

Why is my mobile phone not connecting?

You will find more detailed information on various mobile phones on the Support pages at [www.genevalab.com](http://www.genevalab.com).

I have an unreliable connection with dropouts when listening via Bluetooth.

- Move the mobile phone closer to the Model XS.
- Move away or turn off other wireless devices that can disturb a Bluetooth connection (for example WLAN / Wifi, other mobile phones etc.).

How do I know if the battery is charging?

A small dot on the lower right of the display blinks slowly if the battery is being charged.

The sound output seems too low.

Turn the volume on the mobile phone or audio device up.

How can I check the battery charge?

A dot on the lower right corner of the display shows the battery status:

- On: battery fully charged.
- Slow blink: battery charging.
- Fast blink: battery low.

If the battery is low, the display will also show "low" and "batt". In this case the Model XS will automatically turn off, but it still has enough power to show the time for a while.

Why is the unit louder when it is connected to a power adapter?

When the Model XS is battery powered, the maximum volume is limited to maximize battery life.

Why is the alarm not working when the case is closed?

The alarm does not work in this position because the device power is off. However, the clock is still running.

How do I change the battery?

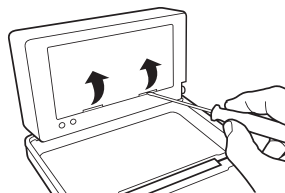

1. Carefully open the battery lid with a flat top screwdriver.
2. Remove the used battery and replace it with a new one.

Only use an original XS battery replacement from Geneva! You can order the battery at [www.genevalab.com](http://www.genevalab.com).

3. Insert the new battery while following the instructions under "Getting started" in this manual.

## SUPPORT

More information, troubleshooting, etc.

Select "Support" at [www.genevalab.com](http://www.genevalab.com).

### Service and Repair

If the product is damaged and needs repair, please contact your dealer. Visit [www.genevalab.com](http://www.genevalab.com) to find a dealer in your area.

### Warranty

See the specific terms for your country at [www.genevalab.com](http://www.genevalab.com).