

INSIGNIA™

USER GUIDE

Bluetooth Stereo Turntable

NS-BTST21

v1
R3



Before using your new product, please read these instructions to prevent any damage.

Contents

IMPORTANT SAFETY INSTRUCTIONS	2
Package contents	4
Setting up your turntable.....	4
Installing the platter.....	4
Attaching and adjusting the counterweight.....	6
Features	9
Top view.....	9
Side view	10
Front view	11
Using your turntable	11
Playing a record.....	11
Listening to music using Bluetooth speakers.....	13
Listening to music through the RCA jacks	14
Replacing the stylus (Part number: Audio-Technica ATN3600L).....	15
Adjusting the anti-skating control	16
Cleaning your turntable	17
Troubleshooting	17
General.....	17
PHONO Player	17
Bluetooth.....	18
Specifications	18
Legal notices.....	20
ONE-YEAR LIMITED WARRANTY	21

IMPORTANT SAFETY INSTRUCTIONS

- 1 Read these instructions – All the safety and operating instructions should be read before this product is operated.
- 2 Keep these instructions–The safety and operating instructions should be retained for future reference.
- 3 Heed all warnings–All warnings on the appliance and in the operating instructions should be adhered to.
- 4 Follow all instructions – All operating and use instructions should be followed.
- 5 Do not use this apparatus near water – The appliance should not be used near water or moisture – for example, in a wet basement or near a swimming pool, and the like.
- 6 Clean only with a dry cloth.
- 7 Do not block any ventilation openings. Install in accordance with the manufacturer’s instructions.

- 8 Do not install near any heat sources such as radiators, heat registers, stoves, or other apparatus (including amplifiers) that produce heat.
- 9 Protect the power cord from being walked on or pinched particularly at the plugs, convenience receptacles, and at the point where they exit from the apparatus.
- 10 Only use attachments/accessories specified by the manufacturer.
- 11 Use only with the cart, stand, tripod, bracket, or table specified by the manufacturer, or sold with the apparatus. When a cart or rack is used, use caution when moving the cart/apparatus combination to avoid injury from tip-over.
- 12 Unplug the apparatus during lightning storms or when unused for long periods of time.
- 13 Refer all servicing to qualified personnel. Servicing is required when the apparatus has been damaged in any way, such as power supply cord or plug is damaged, liquid has been spilled or objects have fallen into the apparatus, has been exposed to rain or moisture, does not operate normally, or has been dropped.



	CAUTION	
RISK OF ELECTRIC SHOCK		
DO NOT OPEN		
AVERTISSEMENT :		
RISQUE DE CHOC ÉLECTRIQUE—NE PAS OUVRIR		

- This lightning flash with arrowhead symbol within an equilateral triangle is intended to alert the user to the presence of non-insulated “dangerous voltage” within the product’s enclosure that may be of sufficient magnitude to constitute a risk of electric shock.

WARNING: To reduce the risk of electric shock, do not remove cover (or back) as there are no user-serviceable parts inside. Refer servicing to qualified personnel.

- The exclamation point within an equilateral triangle is intended to alert the user to the presence of important operating and maintenance instructions in the literature accompanying the appliance.
- 14 This equipment is a Class II or double insulated electrical appliance. It has been designed in such a way that it does not require a safety connection to electrical earth.
 - 15 The plug is used as the disconnect device. The disconnect device shall remain readily operable.
 - 16 **WARNING:** To reduce the risk of fire or electric shock, do not expose this apparatus to rain or moisture. The apparatus shall not be exposed to dripping or splashing and that no objects filled with liquids, such as vases, shall be placed on apparatus.
 - 17 The use of the equipment in a moderate climate.
 - 18 The ventilation should not be impeded by covering the ventilation openings with items such as, newspapers, tablecloths, curtains, etc.



- 19 No naked flame sources, such as lighted candles, should be placed on the apparatus.
- 20 The symbol with \sim indicates AC voltage.
- 21 **CAUTION:** These servicing instructions are for use by qualified service personnel only. To reduce the risk of electric shock, do not perform any servicing other than that contained in the operating instructions unless you are qualified to do so.
- 22 **WARNING:** Please refer to the information on the exterior back enclosure for electrical and safety information before installing or operating the apparatus.
- 23 Do not defeat the safety purpose of the polarized or grounding plug. A polarized plug has two blades with one wider than the other. A grounding plug has two blades and a third grounding prong. The wide blade or the third prong is provided for your safety. If the provided plug does not fit into your outlet, consult an electrician for replacement of the obsolete outlet.
- 24 **CAUTION:** For pluggable equipment, the socket-outlet shall be easily accessible.

Package contents

- Bluetooth Stereo Turntable
- Turntable mat
- 45 RPM adapter
- RCA audio cable
- AC power cord
- Two belts (one installed and one spare)
- *User Guide*

Setting up your turntable

Installing the platter

Note: The belt is preinstalled on the bottom of the metal platter.

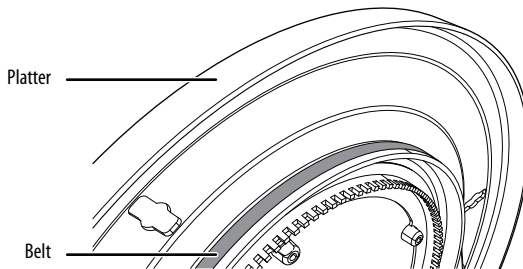

- 1 Make sure that the belt is not twisted, then use your thumb to stretch the belt until it reaches the round hole in the platter.

Note: Make sure that you place the belt on the **metal** track and not on the section with teeth.

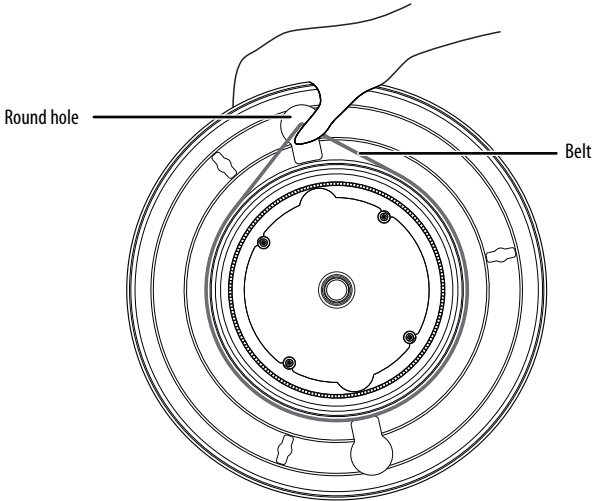

- 2 Still holding the belt, flip the platter over, then insert the platter onto the spindle in the center of your turntable.
- 3 Align the round hole in the platter with the pulley and use your finger to hook the belt onto the pulley.

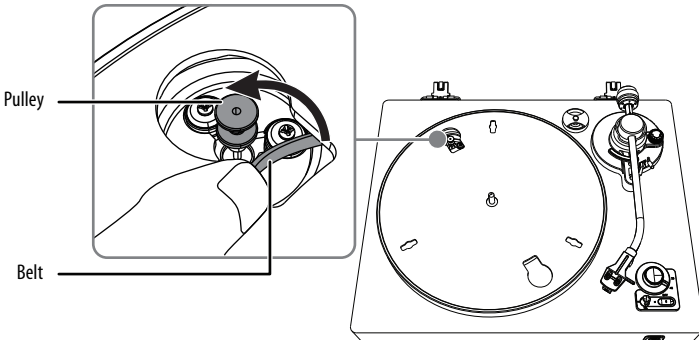

- 4 Place the turntable mat on the platter.

Note: When you want to take out the platter from the turntable, remove the mat first, then grasp the platter and pull it upward. This is especially important if you are shipping your turntable to prevent the platter from shaking.

Attaching and adjusting the counterweight

The counterweight on the tone arm adjusts the needle pressure. If the pressure is too much, sound is distorted. If the pressure is too little, track skipping happens more frequently.

- 1 Hold the counterweight with the black number ring on the counterweight towards you, then slightly push the counterweight into the end of tone arm. When you hear a click, the counterweight has been installed correctly.

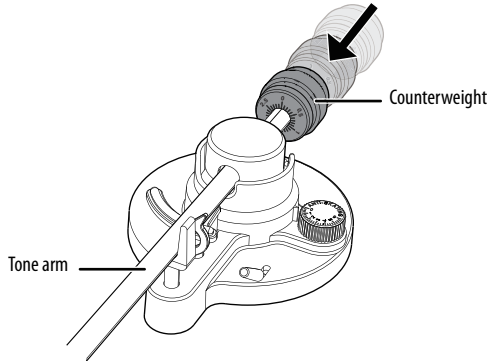

- 2 Remove the stylus cover.

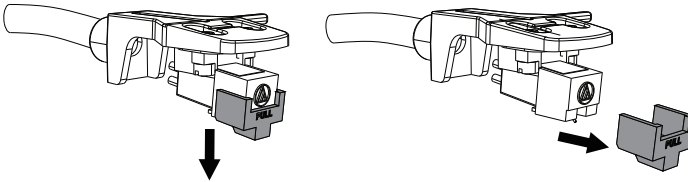

- 3 Set the **Anti-Skating** control to **0** (zero).

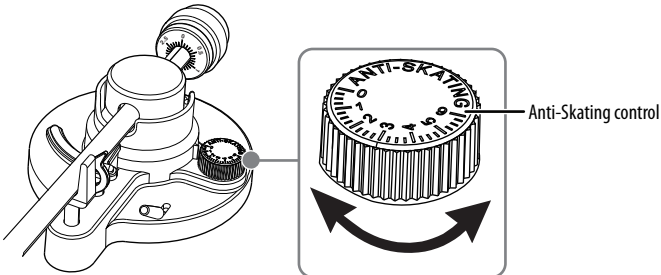

- 4 Release the tone arm lock, push the lifting rod forward so that the tone arm leaves the base, then push the tone arm left to the position above the turntable.

CAUTION: Make sure that the needle does not contact any part of the of your turntable.

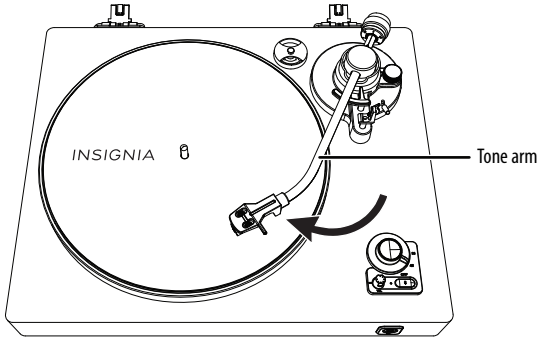

- 5 Turn the counterweight so that the tone arm is horizontal. You can move the counterweight forward or backward on the tone arm.

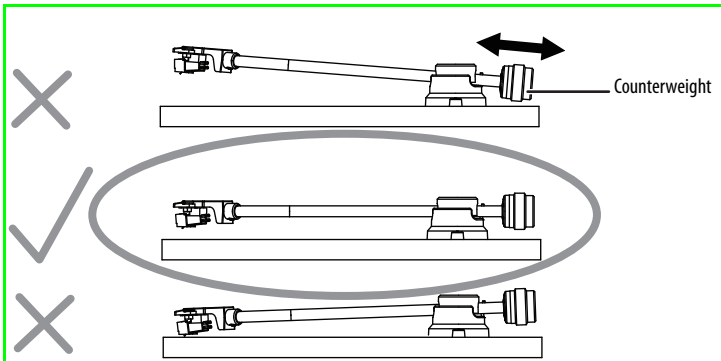

- 6 Hold the metal counterweight at the back of the tone arm.

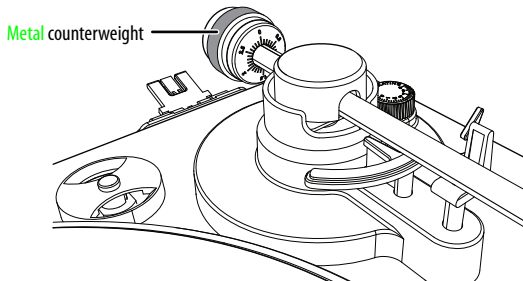

- 7 Hold the metal counterweight to keep it from moving, then carefully rotate the front black number ring so that 0 is in the 12 o'clock position.

Note: Do not turn the metal counterweight. The black number ring turns separately.

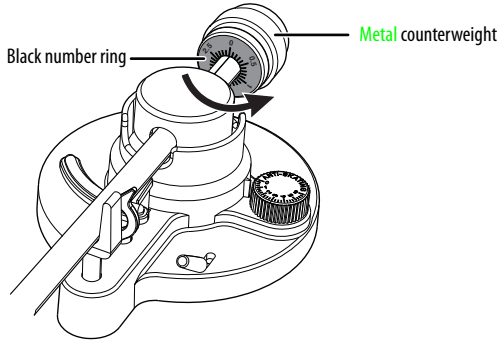

- 8 Hold both the metal counterweight and black number ring together and rotate them counter-clockwise so that 2.5 on the dial is in the 12 o'clock position. This adjustment sets the tone arm to 2.5 grams of downward force (the recommended tracking weight) for this needle.

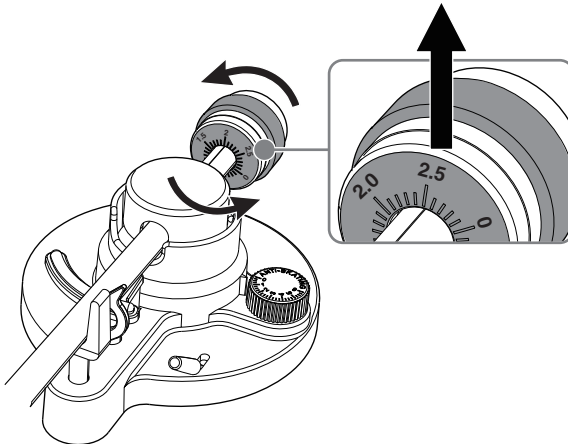

Features

- Works with both 33 1/3 and 45 RPM (adapter included) 12-inch records to play a variety of music
- High-quality replaceable **ATN3600L stylus** are durable enough for everyday use
- Die-cast aluminum record platter with felt mat supports wobble-free positioning
- Removable plastic cover protects your vinyl records from dust and debris
- Bluetooth technology with auto connect and **memory last audio devices**
- 3.5 mm headphone jack lets you listen to music through headphones
- Four vibration-absorbing feet help reduce skipping
- 4.9 ft (1.5 m) power cord allows for flexible placement options

Top view

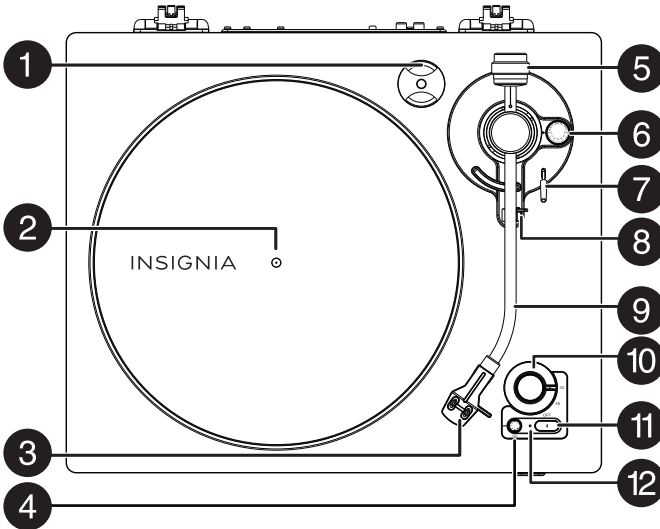

#	ITEM	DESCRIPTION
1	45 RPM adapter	Snap into a 45 RPM record so that it fits the spindle.
2	Spindle	Place a record onto the spindle to play.
3	Headshell and cartridge	Generates sound from a playing record.
4	Volume	Turn to adjust the volume (except for line-in mode).
5	Counterweight	Turn to adjust the needle pressure.
6	Anti-Skating control	Turn to adjust the inward tracking forces that occur with certain pick-up when the stylus nears the center of the record.

#	ITEM	DESCRIPTION
7	Tone arm lifter	Push forward and back to raise and lower tone arm.
8	Tone arm rest holder	Place the tone arm on this holder with it is not in use.
9	Tone arm	Holds the stylus that produces sound from the record.
10	RPM selector switch	Turn to select the record type (33 or 45) or OFF to turn off your turntable. (The default OFF .)
11	Bluetooth pairing button	Press and hold for two seconds to start Bluetooth pairing. When pairing is turned on, press to start searching for your Bluetooth speakers or headphones. The Bluetooth indicator blinks red and blue until a link is made. After you connect to a Bluetooth speaker, your turntable automatically reconnects to the speaker each time you turn on your turntable and set it to 33 or 45 RPM.
12	Status indicator	Displays status. <ul style="list-style-type: none"> Solid red indicates the is power on and Bluetooth is in standby. Solid blue indicates Bluetooth is connected. Blinking red and blue indicates Bluetooth is in pairing mode. Blinking blue indicates Bluetooth is disconnected or connecting to the last device.

Side view

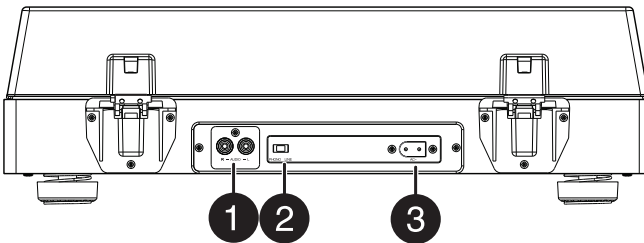

#	ITEM	DESCRIPTION
1	L/R AUDIO out jacks	Plug the included RCA audio cable into these jacks. Match red to red and white to white.
2	Phono/Line switch	Toggle to the left to select PHONO IN or toggle to the right to select LINE IN . Your turntable has a built-in PHONO equalizer function. You can use your turntable even if you don't have a PHONO amplifier or connectible equipment with a built-in PHONO amplifier.
3	AC power jack	Plug the AC power cord into this jack and into a power outlet.

Front view

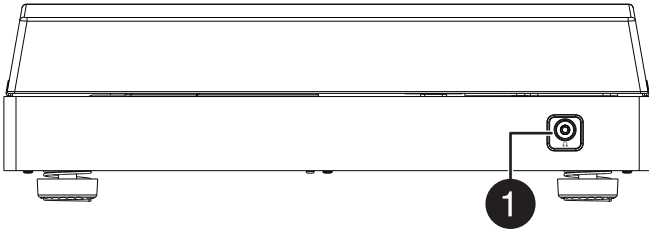

#	ITEM	DESCRIPTION
1	Headphone jack	Plug headphones into this jack. If you have a Bluetooth speaker connected , the speaker is not muted.

Using your turntable

The top cover helps prevent dust from settling on your turntable. We recommend that use the top cover when you are playing records or when not using your turntable.

Playing a record

- 1 Gently open the top cover.

Note: Be careful not to pinch your finger when opening or closing the top cover.

- 2 Place a vinyl record on the turntable.

Note: When playing a 45 RPM record, use the included 45 RPM adapter.

- 3 Select the appropriate speed by turning the RPM selector switch to 33 or 45.

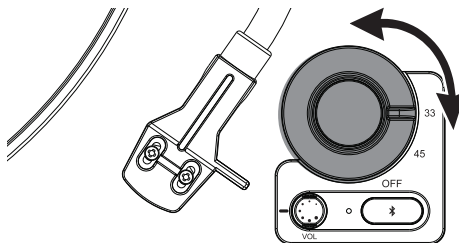

- 4 Remove the tone arm-rest holder to release the tone arm.

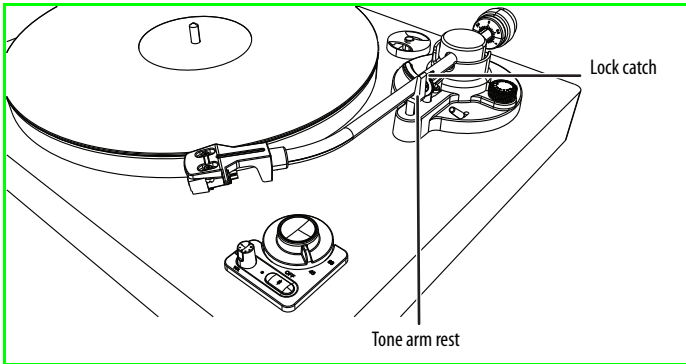

- 5 Push the tone arm lifter forward to raise the tone arm.

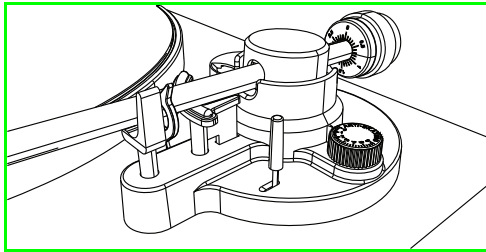

- 6 Gently push the tone arm to the left over the turntable.

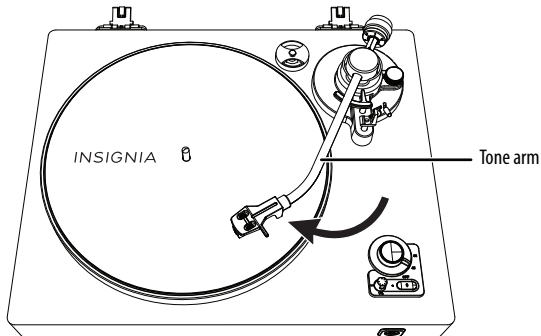

- 7 Push the tone arm lifter backward to lower the tone arm so that the stylus touches the record and starts to play.

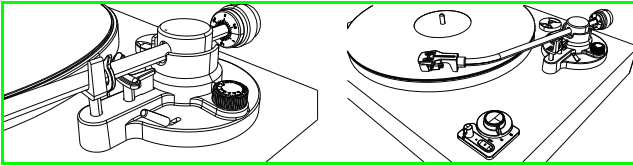

- 8 To pause or stop playing, push the tone arm lifter forward to raise the tone arm.

Note: When the end of the record is reached, the tone arm and rotation stop.

- 9 When playing is complete, push the tone arm lifter forward to raise the tone arm, then move the arm back to the tone arm rest. Push the tone arm lifter down to lower the tone arm.

Notes:

- Closing the top cover helps prevent dust from settling on the turntable.
- Always relock the tone arm clip before transporting your turntable.
- Do not place anything on top of the turntable cover, especially while playing a record.

Listening to music using Bluetooth speakers

- 1 Turn the switch to your record type, **33** or **45**.
- 2 Put your Bluetooth speaker in pairing mode.

Note: Make sure that Bluetooth is on any devices in the vicinity that will automatically connect to your speaker.

- 3 On the turntable, press **and hold** the **⌘** (Bluetooth pairing) button **for two seconds** to turn the Bluetooth transmitter on.

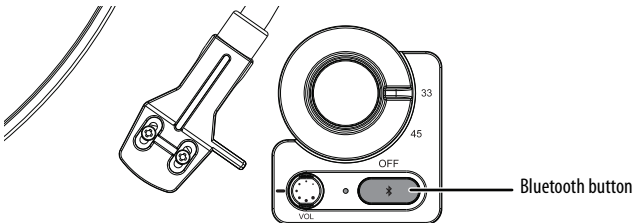

While searching, the Bluetooth indicator flashes red and blue.

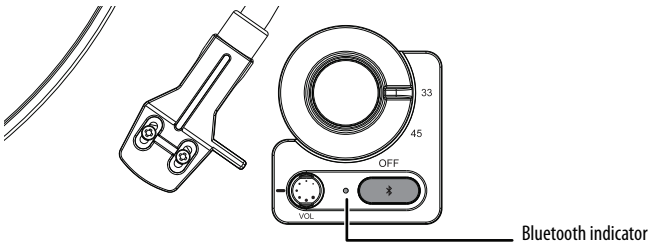

When connected successfully, the Bluetooth indicator lights solid, and your turntable sounds a tone.

Notes:

- If your turntable fails to connect with your speaker, the Bluetooth indicator lights red. Press the **↻** button one more time to reconnect with your Bluetooth speaker.
- The effective distance between your Bluetooth device and your turntable is **33 ft. (10 m)**.
- Make sure that you remove any obstacle between your Bluetooth speaker and your turntable to make sure that the sound is clear.

- 4 To disconnect from Bluetooth, press and hold the **↻** button for **five seconds** until the **status indicator lights red**.
- 5 To reset Bluetooth, press and hold the **↻** button for 10 seconds until the status indicator lights red and blinks five times.

Listening to music through the RCA jacks

- 1 Plug the red and white connectors on the included RCA cable into the **L/R AUDIO** jacks on the back of your turntable, red to red and white to white.

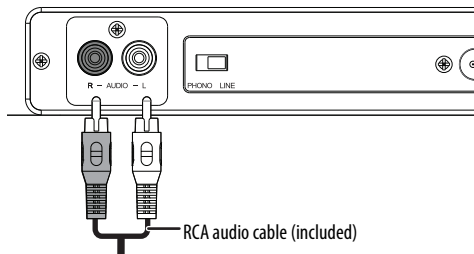

- 2 Plug the other end of the cable into your speakers, red to right speaker and white to left speaker.

- 3 Toggle the **Phono/Line** switch to select the output mode.

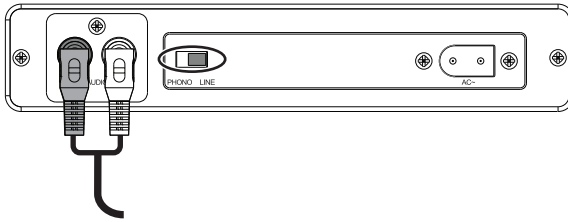

CONNECTED DEVICE	SWITCH POSITION
Device with PHONO input	PHONO
Device without PHONO input	LINE

Note: The volume knob doesn't adjust the volume of the external speaker when using the RCA cable.

Replacing the stylus (Part number: Audio-Technica ATN3600L)

The stylus should last about 300 hours under normal use. However, we recommend that you replace the stylus as soon as you notice a change in sound quality. Prolonged use of a worn-out stylus can damage records.

- 1 Turn the RPM selector switch to OFF to turn off the power.
- 2 Remove the stylus by pulling it downward and forward at the same time.

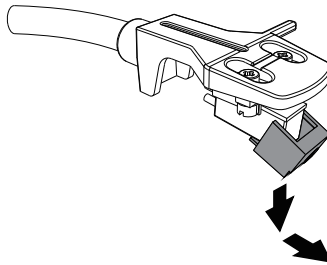

- 3 Push new stylus upwards until the tip locks into place.

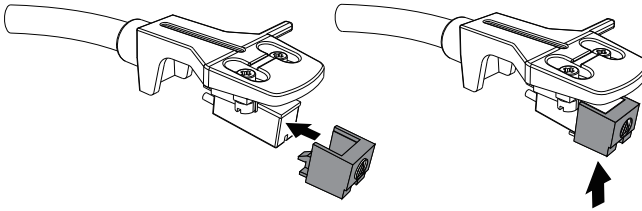

CAUTIONS:

- Do not remove or bend the stylus.
- Do not touch the needle to avoid injury your hand.
- Keep out of reach of children.

Adjusting the anti-skating control

Anti-skating applies a small outward force to the tone arm, counteracting the tendency of the tone arm to move inward toward the center of the record. When you initially set up your turntable, set the anti-skate adjustment control knob to the same setting as the tracking force dial. Refer to the specification for the needle pressure value in the instructions.

In case of substantial use of back-cueing, scratching, or reverse-direction operation, you may prefer to use less, or no, anti-skate compensation.

Where is the specification for the needle pressure value? Which instructions?

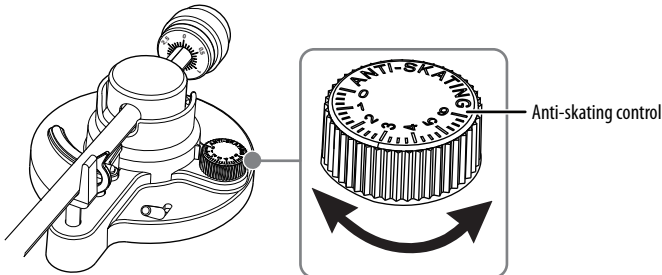

Notes:

- When you adjust the **Anti-Skating** knob, leave the tone arm and balance weight alone to prevent damaging the stylus.
- If a record can't playback entire tracks, we recommend you reset the anti-skating control to **0** (zero).

Cleaning your turntable

- Only use a clean, dry cloth.
- Never use chemicals, detergents, or abrasives.
- When you're not using your turntable, place the dust cap under it to prevent dust or other dirt from getting onto your turntable.

CAUTION: Do not spill any liquid on the turntable. This will damage your turntable. If something happens to spill onto the turntable, immediately wipe it clean with a soft, clean cloth.

If something spills on the turntable, how do you remove it? With a damp cloth?

Troubleshooting

Check this list for a possible troubleshooting solution before calling for service.

General

PROBLEM	SOLUTION
My turntable doesn't turn on.	<ul style="list-style-type: none"> • Make sure that the power cord is connected to your turntable and a working power outlet.
I don't hear sound from the speakers.	<ul style="list-style-type: none"> • Increase the volume on the turntable. • Make sure that the sound source matches your turntable's output. • If you are using the RCA jacks, make sure that the RCA cable is connected correctly and securely.
The sound is noisy.	<ul style="list-style-type: none"> • Turn off appliances (like a TV) near your turntable. • Move your turntable farther away from nearby appliances.
My turntable is on, but doesn't respond.	<ul style="list-style-type: none"> • Remove the power cord and all power supply devices, wait one minute, then plug your turntable back into the power outlet.

PHONO Player

PROBLEM	SOLUTION
The sound is noisy when I use my turntable for a period of time.	<ul style="list-style-type: none"> • Replace the stylus.
A record doesn't fit on the spindle.	<ul style="list-style-type: none"> • Make sure that the record is a 33 or 45 RPM record. Your turntable doesn't play 78 RPM records

Bluetooth

PROBLEM	SOLUTION
My turntable won't pair with a Bluetooth device.	<ul style="list-style-type: none"> • Press and hold the ⌘ (Bluetooth pairing) button for two seconds to make sure that your turntable is switched to transmitting mode. • Make sure that your Bluetooth speaker is turned on and in Bluetooth mode. See the instructions that came with your Bluetooth speaker. • Move your Bluetooth speaker closer to your turntable.
Bluetooth pairing failed.	<ul style="list-style-type: none"> • Make sure that your Bluetooth speaker is not connected to another Bluetooth device. If it is connected to another device, turn off the device or delete the Bluetooth connection name from your speaker's list of devices. • Make sure that your Bluetooth speaker uses BQB-certified receive.

Specifications

Designs and specifications are subject to change without notice.

General

Dimensions (H × W × D)	5 × 16.9 × 14.56 in. (12.8 × 42.8 × 37 cm)
Weight	9.9 lbs. (4.5 kg)
Power requirements	AC 120 V ~ 60 Hz
Power consumption	5 W

Record player

Motor	DC servo motor
Drive system	Belt drive
Speeds	33-1/3 rpm, 45 rpm
Wow flutter	Less than 0.25% (WTD)
S/N ratio	50 dB
Cartridge type	Moving magnetic cartridge
Cartridge	ATN3600L
RCA OUT	200-280 mV (5 cm/sec at 1 KHz-10 dB)
PHONO out	3-4 mv (5 cm/sec at 1 KHz-10dB)

Bluetooth

Bluetooth version	Bluetooth V5.0
Bluetooth supports	2.1+EDR, AFH, HFP, A2DP, ACRCP profiles
Bluetooth frequency range	2.402GHz-2.480GHz
Operating distance	33 ft. (10 m)

Legal notices

FCC Part 15

This device complies with Part 15 of the FCC Rules. Operation of this product is subject to the following two conditions: (1) this device may not cause harmful interference, and (2) this device must accept any interference received, including interference that may cause undesired operation.

This equipment has been tested and found to comply within the limits for a class B digital device, pursuant to Part 15 of the FCC Rules. These limits are designed to provide reasonable protection against harmful interference in a residential installation. This equipment generates, uses, and can radiate radio frequency energy and, if not installed and used in accordance with the instructions, may cause harmful interference to radio communications. However, there is no guarantee that interference will not occur in a particular installation. If this equipment does cause harmful interference to radio or television reception, which can be determined by turning the equipment off and on, the user is encouraged to try to correct the interference by one or more of the following measures:

- Reorient or relocate the receiving antenna.
- Increase the separation between the equipment and receiver.
- Connect the equipment into an outlet on a circuit different from that to which the receiver is connected.
- Consult the dealer or an experienced technician for help.

FCC warning

Changes or modifications not expressly approved by the party responsible for compliance with the FCC Rules could void the user's authority to operate this equipment.

FCC RF Radiation Exposure Statement Caution: This equipment complies with FCC radiation exposure limits set forth for an uncontrolled environment.

Deleted Canadian statement.

ONE-YEAR LIMITED WARRANTY

Definitions:

The Distributor* of Insignia branded products warrants to you, the original purchaser of this new Insignia-branded product ("Product"), that the Product shall be free of defects in the original manufacturer of the material or workmanship for a period of one (1) year from the date of your purchase of the Product ("Warranty Period").

For this warranty to apply, your Product must be purchased in the United States or Canada from a Best Buy branded retail store or online at www.bestbuy.com or www.bestbuy.ca and is packaged with this warranty statement.

How long does the coverage last?

The Warranty Period lasts for 1 year (365 days) from the date you purchased the Product. Your purchase date is printed on the receipt you received with the Product.

What does this warranty cover?

During the Warranty Period, if the original manufacture of the material or workmanship of the Product is determined to be defective by an authorized Insignia repair center or store personnel, Insignia will (at its sole option): (1) repair the Product with new or rebuilt parts; or (2) replace the Product at no charge with new or rebuilt comparable products or parts. Products and parts replaced under this warranty become the property of Insignia and are not returned to you. If service of Products or parts are required after the Warranty Period expires, you must pay all labor and parts charges. This warranty lasts as long as you own your Insignia Product during the Warranty Period. Warranty coverage terminates if you sell or otherwise transfer the Product.

How to obtain warranty service?

If you purchased the Product at a Best Buy retail store location or from a Best Buy online website (www.bestbuy.com or www.bestbuy.ca), please take your original receipt and the Product to any Best Buy store. Make sure that you place the Product in its original packaging or packaging that provides the same amount of protection as the original packaging.

To obtain warranty service, in the United States and Canada call 1-877-467-4289. Call agents may diagnose and correct the issue over the phone.

Where is the warranty valid?

This warranty is valid only in the United States and Canada at Best Buy branded retail stores or websites to the original purchaser of the product in the country where the original purchase was made.

What does the warranty not cover?

This warranty does not cover:

- Customer instruction/education
- Installation
- Set up adjustments
- Cosmetic damage
- Damage due to weather, lightning, and other acts of God, such as power surges
- Accidental damage
- Misuse
- Abuse
- Negligence
- Commercial purposes/use, including but not limited to use in a place of business or in communal areas of a multiple dwelling condominium or apartment complex, or otherwise used in a place of other than a private home.
- Modification of any part of the Product, including the antenna
- Display panel damaged by static (non-moving) images applied for lengthy periods (burn-in).
- Damage due to incorrect operation or maintenance

- Connection to an incorrect voltage or power supply
- Attempted repair by any person not authorized by Insignia to service the Product
- Products sold "as is" or "with all faults"
- Consumables, including but not limited to batteries (i.e. AA, AAA, C etc.)
- Products where the factory applied serial number has been altered or removed
- Loss or Theft of this product or any part of the product
- Display panels containing up to three (3) pixel failures (dots that are dark or incorrectly illuminated) grouped in an area smaller than one tenth (1/10) of the display size or up to five (5) pixel failures throughout the display. (Pixel based displays may contain a limited number of pixels that may not function normally.)
- Failures or Damage caused by any contact including but not limited to liquids, gels or pastes.

REPAIR REPLACEMENT AS PROVIDED UNDER THIS WARRANTY IS YOUR EXCLUSIVE REMEDY FOR BREACH OF WARRANTY. INSIGNIA SHALL NOT BE LIABLE FOR ANY INCIDENTAL OR CONSEQUENTIAL DAMAGES FOR THE BREACH OF ANY EXPRESS OR IMPLIED WARRANTY ON THIS PRODUCT, INCLUDING, BUT NOT LIMITED TO, LOST DATA, LOSS OF USE OF YOUR PRODUCT, LOST BUSINESS OR LOST PROFITS. INSIGNIA PRODUCTS MAKES NO OTHER EXPRESS WARRANTIES WITH RESPECT TO THE PRODUCT, ALL EXPRESS AND IMPLIED WARRANTIES FOR THE PRODUCT, INCLUDING BUT NOT LIMITED TO ANY IMPLIED WARRANTIES OF AND CONDITIONS OF MERCHANTABILITY AND FITNESS FOR A PARTICULAR PURPOSE, ARE LIMITED IN DURATION TO THE WARRANTY PERIOD SET FORTH ABOVE AND NO WARRANTIES, WHETHER EXPRESS OR IMPLIED, WILL APPLY AFTER THE WARRANTY PERIOD. SOME STATES, PROVINCES AND JURISDICTIONS DO NOT ALLOW LIMITATIONS ON HOW LONG AN IMPLIED WARRANTY LASTS, SO THE ABOVE LIMITATION MAY NOT APPLY TO YOU. THIS WARRANTY GIVES YOU SPECIFIC LEGAL RIGHTS, AND YOU MAY ALSO HAVE OTHER RIGHTS, WHICH VARY FROM STATE TO STATE OR PROVINCE TO PROVINCE.

Contact Insignia:

1-877-467-4289

www.insigniaproducts.com

INSIGNIA is a trademark of Best Buy and its affiliated companies.

*Distributed by Best Buy Purchasing, LLC

7601 Penn Ave South, Richfield, MN 55423 U.S.A.

©2021 Best Buy. All rights reserved.

INSIGNIA™

www.insigniaproducts.com

1-877-467-4289 (U.S. and Canada) or 01-800-926-3000 (Mexico)

INSIGNIA is a trademark of Best Buy and its affiliated companies.

Distributed by Best Buy Purchasing, LLC

7601 Penn Ave South, Richfield, MN 55423 U.S.A.

©2021 Best Buy. All rights reserved.

V1 ENGLISH
20-0442