

<Photographs of EUT>

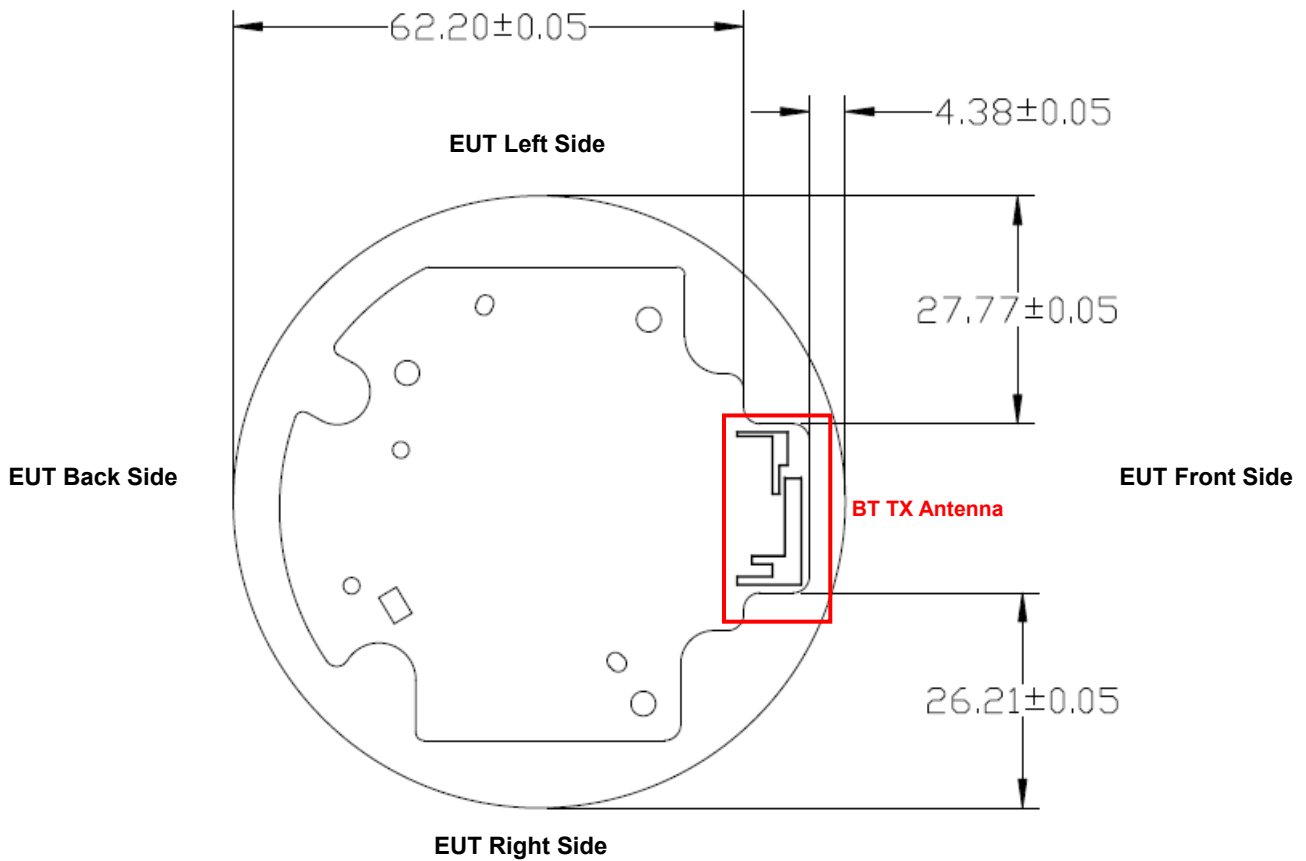

<Antenna Location>



<EUT Bottom View>

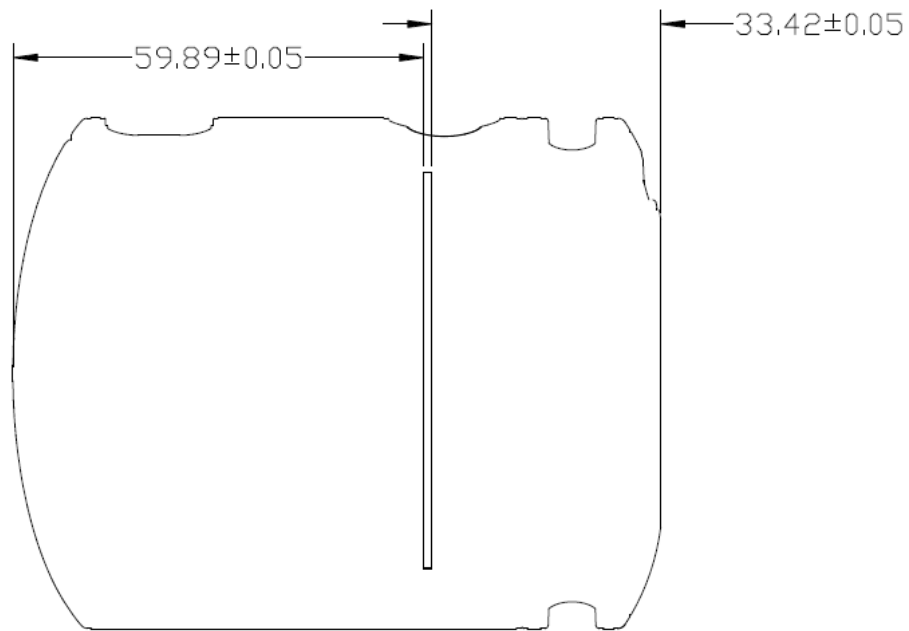

<EUT Rear View>

The separation distance for antenna to edge:

Antenna	To Front Face (mm)	To Rear Face (mm)	To Left Side (mm)	To Right Side (mm)	To Top Side (mm)	To Bottom Side (mm)
BT	4.38	62.2	175	22	59.89	33.42

<Photographs of SAR Setup>





BUREAU
VERITAS

FCC SAR Test Report



Top Side of EUT with 0 cm Gap



Bottom Side of EUT with 0 cm Gap