



表格编号: TCLAV-C4-4075001
版本: v 6.9
表格修订日期: 2019-09-06

物料编号: 72-SHNE00-QSGB2
内 容: QSG
型 号: SHINE
图纸版本号: V1.0
是否含美国走向: 是
日 期: 2020-11-21
美工制作人: 宋瑶

此文件及附页属公司机密文件, 版权属通力电子控股有限公司所有, 任何人未经允许不得复制、抄袭。任何部门如有需求, 须向通力电子研发申请。
These files are confidential documents in company. The copyright totally belongs to Tonly electronic holdings Limited. Anybody who are unauthorized is forbidden to copy and plagiarize the files. Any Department must get permission from the Tonly R&D if they need to use them.

ART WORK FORM

(密级: C级)

品牌名称 (BRAND NAME): SHINE

文档提供 (FROM): TCL

工艺说明 (尺寸单位: 毫米 (mm)):

02/49/54/55/56/57/59/67/79 类:

部品	XXXX
工艺、颜色	
成型及颜色 (直接注塑颜色)	N/A
喷油及颜色	N/A
丝印颜色 /移印颜色	N/A
电镀/真空镀 及颜色	N/A
烫金及颜色	N/A
镭 雕	N/A
其他工艺	N/A
备 注	N/A

74/89 类:

印刷方式	XXXX
备 注	N/A

76 类:

印刷方式	XXXX
表面工艺	N/A
样板需求	<input type="checkbox"/> 签正式样板 <input type="checkbox"/> 签彩稿样板 <input type="checkbox"/> 基础机型彩盒样板参考料号: 76-XXXXXX-XXXXX
备 注	N/A

70/72/99 (说明书光盘) 类:

语言种类	XXXX
材 质	封面: 80g书纸 内页: 80g书纸
尺 寸	长: 400mm 宽: 100mm
印刷方式	单黑印刷
表面工艺	XXXX
装订方式	风琴折
页 数	8P
备 注	N/A

71 类:

表纸材质	型号: xx 厚度: xx
胶水材质	型号: xx 是否可移: xx
尺 寸	长: xx 宽: xx
印刷方式	xx
表面工艺	XXXX
打印方式	xxx
粘贴位置	xx
材质库编码	N/A
样板需求	<input type="checkbox"/> 需要签样 <input type="checkbox"/> 不需要签样 <input type="checkbox"/> 参考料号: 71-XXXXXX-XXXXX
<input type="checkbox"/> UPC/ <input type="checkbox"/> EAN/ <input type="checkbox"/> JAN	N/A
备 注	增加型号, 删除蓝牙信息

制作要求 (* FOR ALL):

- 条码扫描等级达到C级以上;
- 美国走向必须满足CP65要求;
- 必须满足RoHS2.0、REACH要求;
- 必须符合TCL通力《公司环境管理物质标准》要求;
- QR Code的制作或打印过程中需选择模型2 (M2);
- 所用油墨必须达到TCL质量部门检测标准;
- 胶袋材质、胶袋上透气孔的大小、位置以结构认可书为准;
- PE材质的胶袋其上面的丝印内容整体长度可允许3mm误差;
- 珍珠棉等材质的胶袋其上面的丝印内容整体长度可允许5mm误差;

* FOR HUAWEI:

- 满足无卤要求;
- 满足不含有邻苯二甲酸盐要求。

* FOR SAMSUNG:

- VD类产品需满足三星的SS要求, AI类产品需满足三星SA要求。

* FOR SONY:

- 禁止使用SS-00259中规定的1级环境管理物质。
- 再生树脂、被覆线材必须从索尼的绿色伙伴认定供应商处采购。

Get Ready to Shine

Bathroom Assistant Manual

SHINE

Model: SHINE-BA-01

1



Before You Begin

Download the Shine Bathroom App



The app is available to download for free from the App Store or Google Play. You can get links to download the app at www.shinebathroom.com/shineapp

2

Quick Start Guide



1 Download the Shine Bathroom App

Download the Shine Bathroom App and create your account to get started. Follow the on-screen instructions to complete the setup of your Bathroom Assistant.



2 Clean Toilet Bowl Rim

Using the supplied wipe, clean the rim of your toilet bowl. It is important to have a clean surface to attach the spray bar to. Allow the rim to dry for 3 minutes.

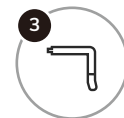

3 Attach Spray Bar & Water Sensor

This pre-measured pod is what helps us create our powerful cleaning solution. A single pod should provide enough cleaning solution for an entire month.



4 Power On Device

Twist the battery into the unlock position and remove the protective film. Afterwards, power on the device by twisting the battery into the lock position, the LEDs will light up.

3

Inside the Box

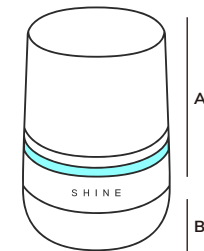

(A) Assistant Body (x1)

(B) Battery (x1)

(C) Spray Bar (x1)

(D) Water Sensor (x1)

(E) Cleaning Pod (x3)

Assistant Lid (x1)

Spray Tubing (x1)

Adhesive Tab (x1)

Alcohol Wipe (x1)

User Manual (x1)

BEFORE YOU BEGIN:

Download the Shine Bathroom App from the App Store (iOS) or Google Play (Android) and create an account using the email address you used to purchase your device. Once you've created and verified your account, the app will take you through the steps below to set up your new device.

4

Setup Instructions

1. Remove the Bathroom Assistant and accessories from the box.

Carefully remove the packing materials, being careful not to pull on the Water Sensor or Spray Bar as they're attached to the Bathroom Assistant. Remove the Bathroom Assistant and accessories and place them on a flat surface.

2. Place and install the Bathroom Assistant and Water Sensor (D).

You can place the Bathroom Assistant anywhere near your toilet, your only limitation is the length of the Spray Bar tubing and Water Sensor cable. Take the Water Sensor and clip it onto the outside of your toilet's water inlet pipe (it's the line typically found under the tank coming from the floor or wall).

Carefully wipe down the center backside of your toilet's rim with the included alcohol wipe. Let the area dry for at least 3 minutes before continuing.

3. Install the Spray Bar (C). Peel away the backing on the double-sided tape and position the Spray Bar where you want to mount it. Securely install by firmly pressing the Spray Bar down on the rim of the toilet for **30 seconds**.



Optimal placement is the middle on the backside of your toilet rim (see black oval in diagram). You can place the Spray Bar anywhere in the back quarter of the toilet bowl rim and still be effective.

4. Remove the Battery and peel away protective film; replace Battery to turn on the device.

On the side of the device, you'll see two lock icons—rotate the battery while holding the Assistant Body to line up the “unlocked” icon with the line on the battery below it. Remove the protective film, and then rotate the battery pack back into the “locked” position. The device should light up indicating it's on and ready to pair.

5. Fill the Bathroom Assistant with water. Using a measuring or drinking cup, add 1,000 ml of water through the opening at the top. The water level should be above the vents in the center column.

6. Open the Shine Bathroom App and create an account to finish the setup process. You will complete the setup process by following the directions in the app.

Certain features of the Bathroom Assistant require a compatible mobile device and active Shine App customer account. For example, scheduling toilet cleaning times requires an active account and a compatible mobile device. The Shine Bathroom Assistant requires a Wi-Fi Network and a compatible mobile device. Minimum OS requirements are available at shop.shinebathroom.com/pages/req. Availability and performance of certain features and services are service-, device-, and network-dependent and may not be available in all areas. Subscription(s) may be required, and additional terms, conditions and/or charges may apply. The Shine Bathroom Assistant is optimized for official Shine Cleaning Pods only. All features, functionality, and other product specifications are subject to change without notice or obligation. © Shine Bathroom Technologies, Inc. Shine Bathroom, Shine Bathroom Assistant, SAM (Shine Automation Manager), and their respective logos are trademarks of Shine Bathroom Technologies, Inc. Other trademarks and trade names are those of their respective owners. All rights reserved. For compliance and certification information including technical data, FCC statements, and individual country notices visit the following website <http://www.shinebathroom.com/compliance>.

Operating Information:

Recommended Battery Charging Temperature Range:
5-35°C (Conducive to Cell Protection)

Product Temperature Range:
0 - 45°C (For Water Pump Operation)

Storage Temperature:
-10 - 60°C

Support

Need help getting started? Have questions about your device? Our team is ready to answer any questions and help get you going with your Bathroom Assistant.

Email Us

team@shinebathroom.com

Chat With Us

Available at www.shinebathroom.com

Call or Text Us

+1 (805) 272 - 7600

Call, Message, and Data rates may apply.

Mounts & Accessories

See the latest mounts and accessories for your Bathroom Assistant by visiting www.shinebathroom.com today.



FCC Statement

This equipment has been tested and found to comply with the limits for a Class B digital device, pursuant to part 15 of the FCC Rules. These limits are designed to provide reasonable protection against harmful interference in a residential installation. This equipment generates, uses and can radiate radio frequency energy and, if not installed and used in accordance with the instructions, may cause harmful interference to radio communications. However, there is no guarantee that interference will not occur in a particular installation. If this equipment does cause harmful interference to radio or television reception, which can be determined by turning the equipment off and on, the user is encouraged to try to correct the interference by one or more of the following measures:

- Reorient or relocate the receiving antenna.
- Increase the separation between the equipment and receiver.
- Connect the equipment into an outlet on a circuit different from that to which the receiver is connected.
- Consult the dealer or an experienced radio/TV technician for help.

FCC Radiation Exposure Statement

This device complies with FCC radiation exposure limits set forth for an uncontrolled environment and it also complies with Part 15 of the FCC RF Rules. This equipment must be installed and operated in accordance with provided instructions and the antenna(s) used for this transmitter must be installed to provide a separation distance of at least 20 cm from all persons and must not be co-located or operating in conjunction with any other antenna or transmitter. End-users and installers must be provided with antenna installation instructions and consider removing the no-collocation statement.

This device complies with Part 15 of the FCC Rules. Operation is subject to the following two conditions:

- (1) this device may not cause harmful interference, and
- (2) this device must accept any interference received, including interference that may cause undesired operation.

Caution!

Any changes or modifications not expressly approved by the party responsible for compliance could void the user's authority to operate the equipment.

Canada Statement

This device contains licence-exempt transmitter(s)/receiver(s) that comply with Innovation, Science and Economic Development Canada's licence-exempt RSS(s). Operation is subject to the following two conditions:

- (1) This device may not cause interference.
- (2) This device must accept any interference, including interference that may cause undesired operation of the device.

L'émetteur/récepteur exempt de licence contenu dans le présent appareil est conforme aux CNR d'Innovation, Sciences et Développement économique Canada applicables aux appareils radio exempts de licence. L'exploitation est autorisée aux deux conditions suivantes :

- 1) L'appareil ne doit pas produire de brouillage;
- 2) L'appareil doit accepter tout brouillage radioélectrique subi, même si le brouillage est susceptible d'en compromettre le fonctionnement.

The device meets the exemption from the routine evaluation limits in section 2.5 of RSS 102 and compliance with RSS-102 RF exposure, users can obtain Canadian information on RF exposure and compliance.

Le dispositif rencontre l'exemption des limites courantes d'évaluation dans la section 2.5 de RSS 102 et la conformité à l'exposition de RSS-102 rf, utilisateurs peut obtenir l'information canadienne sur l'exposition et la conformité de rf.

This transmitter must not be co-located or operating in conjunction with any other antenna or transmitter. This equipment should be installed and operated with a minimum distance of 20 centimeters between the radiator and your body.

Cet émetteur ne doit pas être Co-placé ou ne fonctionnant en même temps qu'aucune autre antenne ou émetteur. Cet équipement devrait être installé et actionné avec une distance minimum de 20 centimètres entre le radiateur et votre corps.

This appliance can be used by children aged from 8 years and above and persons with reduced physical, sensory or mental capabilities or lack of experience and knowledge if they have been given supervision or instruction concerning use of the appliance in a safe way and understand the hazards involved. Children shall not play with the appliance. Cleaning and user maintenance shall not be made by children without supervision.

The instructions for appliances having a part of **class III construction** supplied from a **detachable power supply unit** shall state that the appliance is only to be used with the power supply unit provided with the appliance. The instructions for **class III appliances** shall state that it must only be supplied at safety extra low voltage corresponding to the marking on the appliance. This instruction is not necessary for battery-operated appliances if the battery is a

primary battery or secondary battery charged outside of the appliance.

The instructions shall give information regarding charging. The instructions for appliances incorporating batteries that are intended to be replaced by the user shall include the following:

– the type reference of the battery; – the orientation of the battery with regard to polarity; – the method of replacing batteries; – details regarding safe disposal of used batteries; – warning against using non-rechargeable batteries; – how to deal with leaking batteries.

Instructions for appliances containing non User-replaceable batteries shall state the substance of the following:

The appliance contains batteries that are only replaceable by skilled persons.

Instructions for appliances containing non-replaceable batteries shall state the substance of the following:

This appliance contains batteries that are non-replaceable.

Replacement:

The instructions shall contain the quantity and details of the electrolyte to be used and details of the chemical reactions that occur in the electrolyser.