

225°

amped|wireless
High Power AC1200 Plug-In
Wi-Fi Range Extender

Model: REC22P
Designed in the USA. Assembled in Taiwan.

Web Menu:
<http://setup.ampedwireless.com>

Default Settings:
2.4GHz SSID: Amped_REC22P_2.4
5.0GHz SSID: Amped_REC22P_5.0

WPS PIN: 75309770

To Reset Settings:
Hold RESET for 5-10 sec

Input Power Rating:
110-120Vac-60Hz 7A

FCC ID: ZTT-REC22P IC: 10233A-REC22P

This device complies with Part 15 of the FCC Rules.
Operation is subject to the following two conditions:
(1) this device may not cause harmful interference, and
(2) this device must accept any interference received,
including interference that may cause undesired operation.



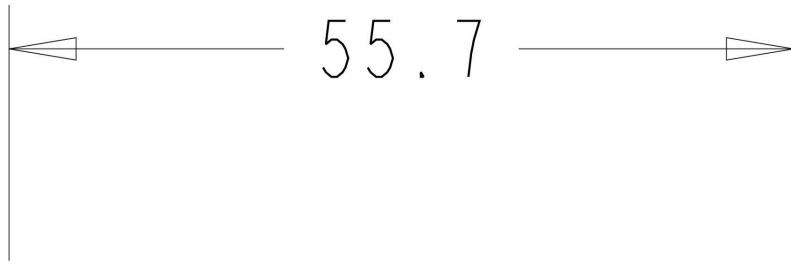
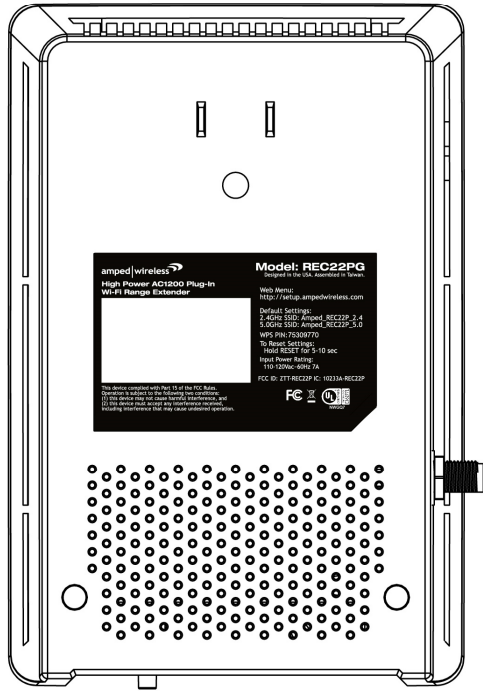

55.7



31.7

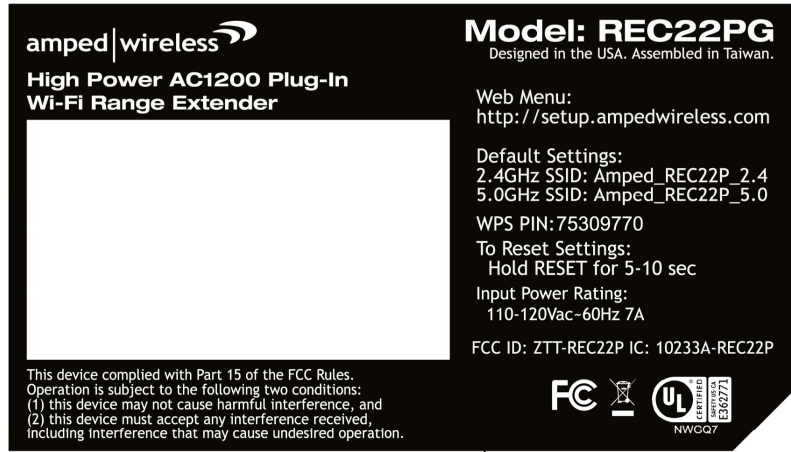

Model: REC22PG

Designed in the USA. Assembled in Taiwan.

amped|wireless
High Power AC1200 Plug-In
Wi-Fi Range Extender

Web Menu:
<http://setup.ampedwireless.com>

Default Settings:
2.4GHz SSID: Amped_REC22P_2.4
5.0GHz SSID: Amped_REC22P_5.0

WPS PIN: 75309770

To Reset Settings:
Hold RESET for 5-10 sec

Input Power Rating:
110-120Vac-60Hz 7A

FCC ID: ZTT-REC22P IC: 10233A-REC22P

This device complies with Part 15 of the FCC Rules.
Operation is subject to the following two conditions:
(1) this device may not cause harmful interference, and
(2) this device must accept any interference received,
including interference that may cause undesired operation.

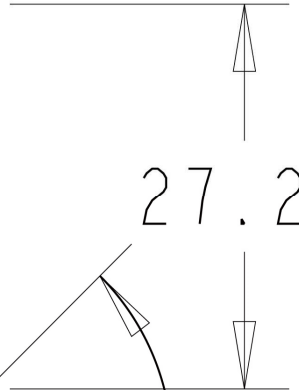

27.29

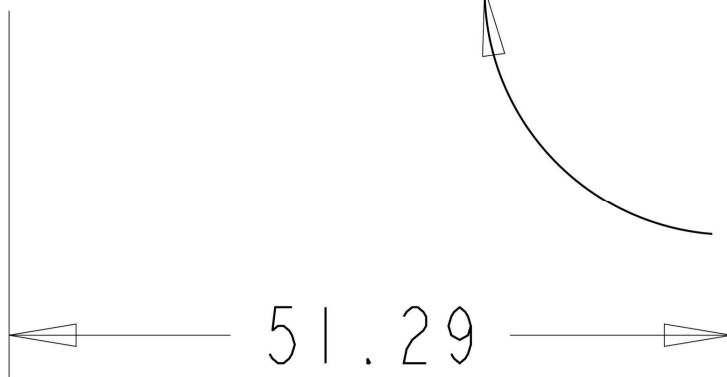

51.29

225°