

Age:14+

4-AXIS AEROCRAFT INSTRUCTION MANUAL



Attention:

- 1、This 4-axis aerocraft is suitable for indoor/outdoor flying, but make sure the outdoor wind force is not more than grade 4.
- 2、It adopts 2.4G frequency band; with long controlled distance; allow some helicopters to fly in the same area without any interference. Besides, players can control it to move forward/backward, turn left/right, left/right sideways fly.
- 3、Please read this manual carefully before using and keep it properly for future reference.

ALL PARTS INCLUDED:

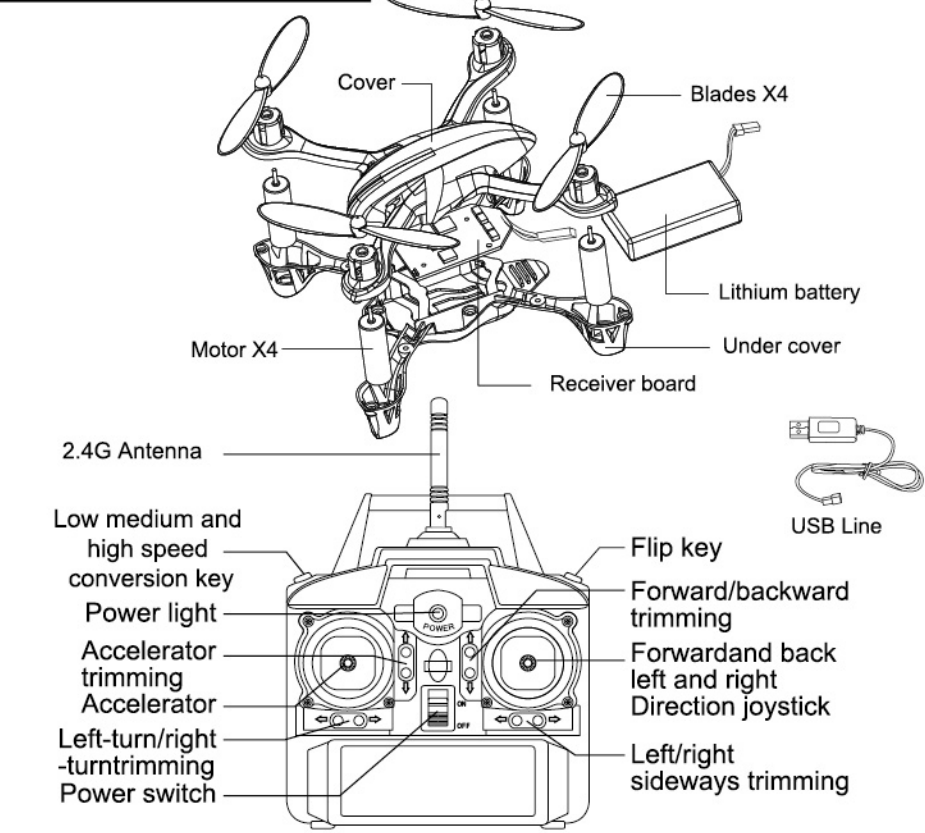

TRANSMITTER BATTERY INSTALLATION

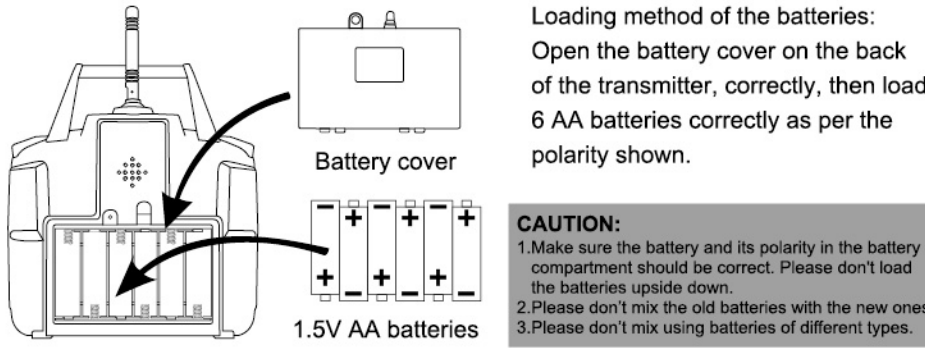

Aircraft battery charge

The lithium battery of the vehicle as shown removed from the battery holder and disconnect the power plug, USB charger plug into the power Brain USB jack, after charging plug of the charger lithium battery plug is connected, the LED lights when charging, charging is completed When the LED is off, the charging time of approximately 45 minutes.

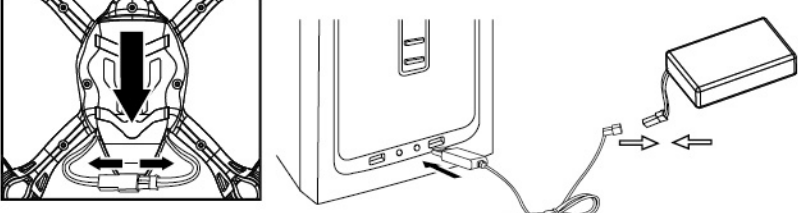

THE RELATED NOTES ABOUT LITHIUM BATTERY'S USAGE

- In the case of misuse, the batteries' charging may cause fire, body hurt and property loss. Players must be aware of the risks of using this product. Manufacturers, retailers and dealers do not bear any responsibility once accidents occur, so please carefully read the safety guidelines and charging instructions before operating.
- Once the batteries' electrolyte come into your eyes, do not rub, but wash them with clean water and seek medical care immediately.
- Please remove the plug immediately if you find out the peculiar smell, noise and smog.
- Please comply with the following requirements strictly, or it may cause fire, electric shock or explosion.
- Charge
 - Please use the charger from original factory to ensure your safety using.
 - Do not charge the dilant/outworn batteries.
 - Do not overcharge the battery. Please pull out the charger once the battery is fully charged.
 - Do not charge it next to the inflammables or on the surface of electro-conductive objects. You should observe the battery at all times.
 - Do not charge the batteries which are still not cool on the surface. Otherwise, it would cause expansion and even fire accident.
- The charging temperature should be between 0℃ and 40℃.

Use and storage

- Do not pack the broken batteries with the plastic bag.
- Do not insert/take out the batteries when the product is being operated.
- Do not over-expose or over-impact the batteries.
- The dilant/outworn batteries are forbidden to use.
- Children are prohibited from touching the batteries.
- Do not throw the batteries into the fire or make it touch with the liquid.
- Batteries are not allowed to be thrown into the microwave oven or pressure tank.
- Do not dismantle, drill or cut the batteries.

- Do not clean the charger with menstruum, industrial alcohol and other flammable solvent.
- The power supply terminal is not to be short circuited. Avoid touching the electrolyte in the battery, which is bad for your health.
- Please store the product at room temperature. The extreme temperature is not suggested.
- Do not place the product near the heat source.
- Please remove the batteries when you do not operate the product.
- Pull out the charger when you do not charge the battery.
- Recycle
 - Do not deal with the related equipment as daily rubbish. The damaged/unusable batteries should be put into the designated container.
 - This equipment is composed of electronic elements and batteries. For the electronics garbage, please dispose them according to the special requirements.
 - Please familiarize yourself with the local garbage disposal method.

HOW TO CONTROL

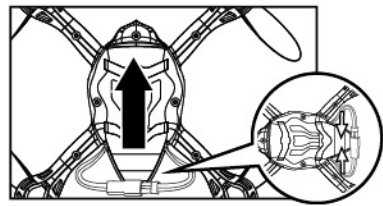

WARNING ⚠
If the aerocraft hasn't been used for a long time, please disconnect the battery wire from the circuit board.

1. the aircraft power cord with battery power cord by the method shown Correctly connected, the aircraft set flat on the ground, board LEDs Do not move the body flashing.
2. About 6 seconds, the operation of the throttle stick to the bottom, and then The power switch to the "NO" position, and then the throttle control Lever to maximum and then to the bottom, so that the remote control and flight On completion of the frequency, the aircraft can be operated.
3. Aircraft on the open space before and after the flight before Direction of and behind the vehicle on himself.

Important: aircraft white blades end to the forward direction, the aircraft black blades end for the backward direction.

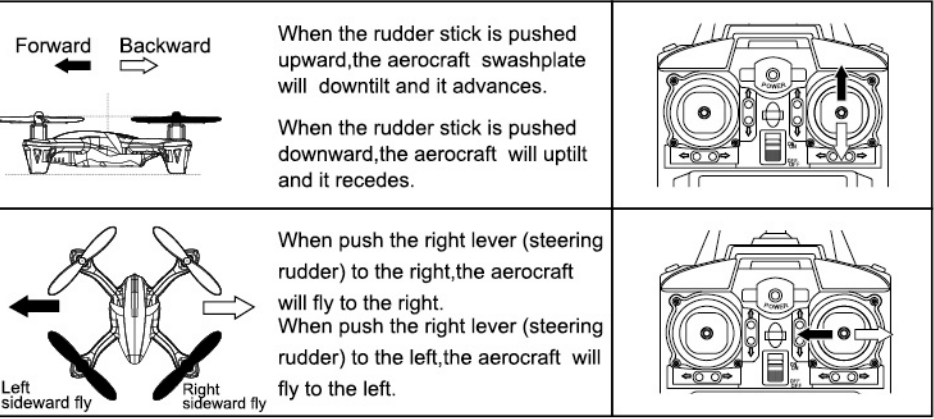
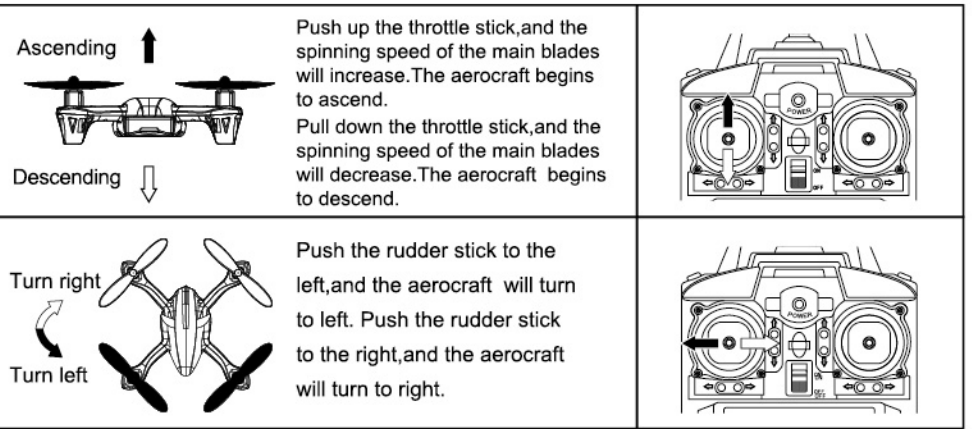

NOTICE Push the throttle level slowly; please press the trimming buttons when the aerocraft hovers or leans to different directions in the air.

Attention: When the aerocraft ascends to 30cm high, it will suffer the "ground effect" and its performance will become unstable.

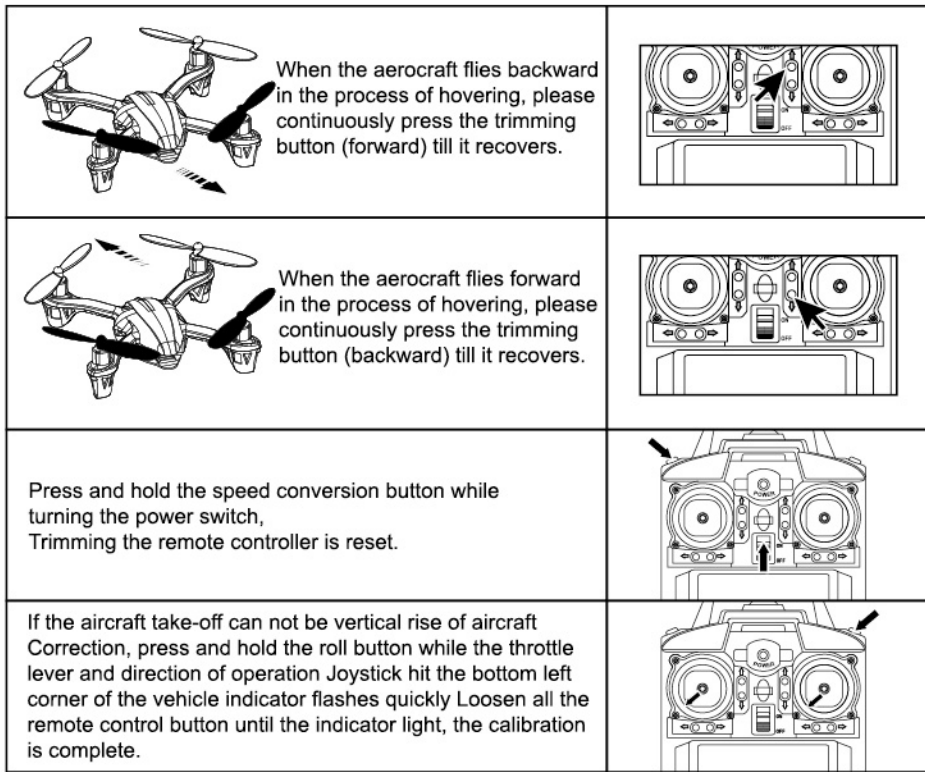
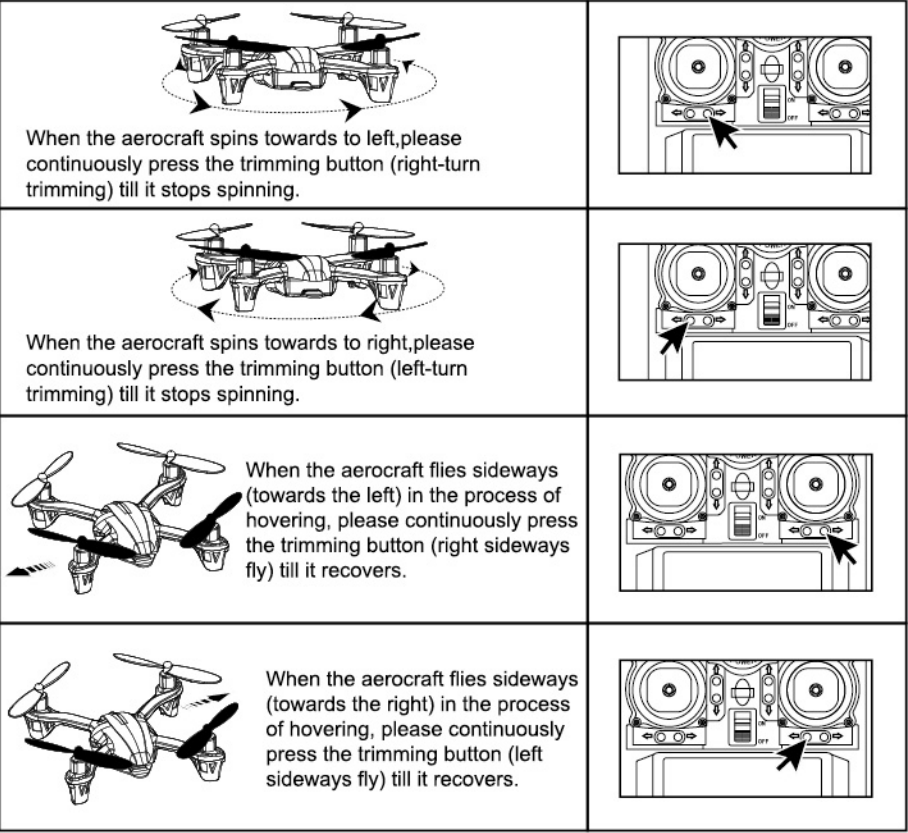

FLYING ENVIRONMENT:

1. Indoor flying: choose a wide place without barriers, pets and people.
2. Outdoor flying: choose the warm, sunny or windless weather.

NOTICE:

- ① Do not fly in extreme temperatures. Flying in extreme temperatures may affect the performance and damage the product.
- ② Do not fly in windy days. The performance and the control of the aerocraft will be affected by winds. Windy condition may cause the missing and damage of the helicopter.

FLYING PRACTICE

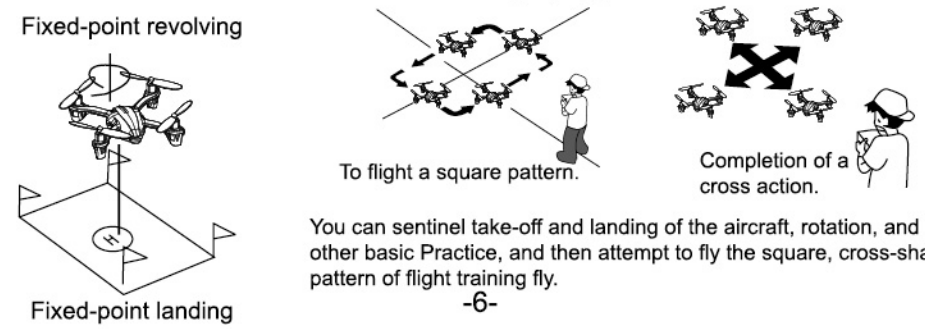

3D FLIP FLYING

Players can control it to perform some breathtaking operations when mastering the basics. First, fly it to the height of 3m. Second, press the flip key and push the right rudder to the end (in one direction), and then loosen it: the aerocraft turns over.

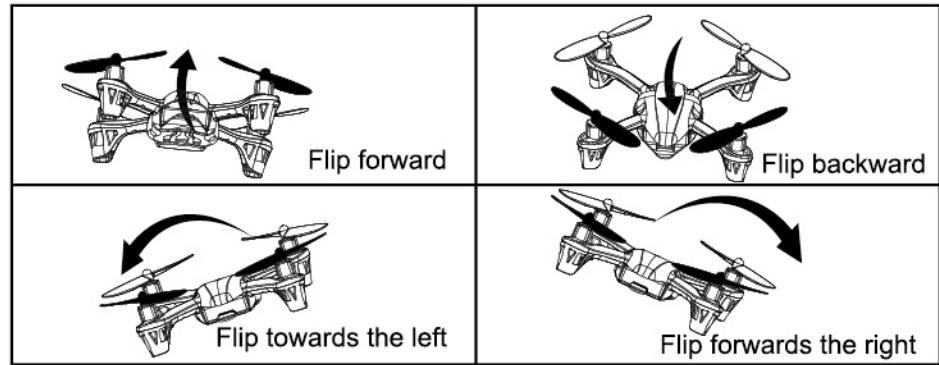

PROBLEMS AND SOLUTIONS

PROBLEMS	CAUSES	SOLUTIONS
Transmitter not working	1.The transmitter switch is on"OFF"	1.Turn on the transmitter
	2.Install the batteries improperly	2.Check with the pole indications and reinstall the batteries again
	3.Batteries are completely consumed	3.Replace with new batteries
Control failure	1.The transmitter switch is on"OFF"	1.Turn on the transmitter
	2.The aerocraft battery no connection	2.The aerocraft battery in the correct orientation connection
	3.Too strong wind force	3. Do not fly under the environment of windy as too strong wind may cause flying limitation to the aerocraft or it may hamper your controlling or flying.
Ascending failure	1.The rotation of main blades is too slow 2.The fuselage battery is well consumed	1.PUsh up the throttle stick 2.Recharge the fuselage battery
Landing too soon	The throttle stick is pulled down too fast	Pull down the throttle stick slowly to perform a smooth landing
Out of control	Beyond the effective controlling distance	Make sure there is no transmitter with the same frequency is used with in the radius of 30 meters.

PRECAUTIONS:

- 1.The remote controlled distance will be shorten when the power (aerocraft or transmitter) is insufficient.
- 2.It is difficult to take off or fly not high when aerocraft's power is insufficient.
- 3.When the aerocraft is damaged, please repair it in time and stop operating, or it may lead to injury.
- 4.If you do not use the transmitter for a long time, please remove the batteries to avoid the batteries' leakage.
- 5.Do not drop the transmitter from the high altitude or crash it badly, otherwise, it will shorten the transmitter's using life.

ACCESSORIES FIGURE

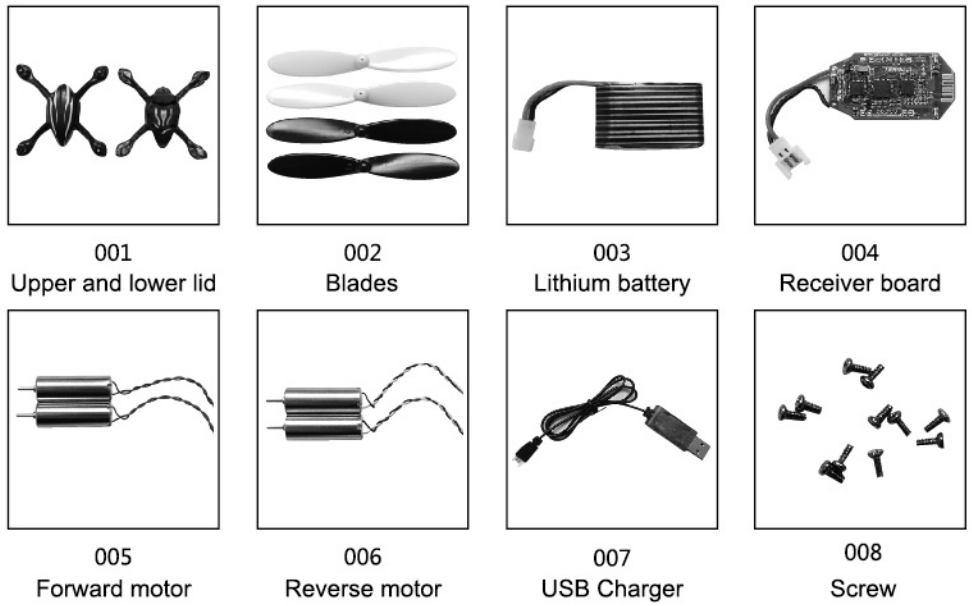

User Manual

Note:

This equipment has been tested and found to comply with the limits for a Class B digital device, pursuant to Part 15 of the FCC Rules. These limits are designed to provide reasonable protection against harmful interference in a residential installation. This equipment generates, uses and can radiate radio frequency energy and, if not installed and used in accordance with the instructions, may cause harmful interference to radio communications. However, there is no guarantee that interference will not occur in a particular installation.

If this equipment does cause harmful interference to radio or television reception, which can be determined by turning the equipment off and on, the user is encouraged to try to correct the interference by one or more of the following measures:

- Reorient or relocate the receiving antenna.
- Increase the separation between the equipment and receiver.
- Connect the equipment into an outlet on a circuit different from that to which the receiver is connected.
- Consult the dealer or an experienced radio/TV technician for help.

The manufacturer is not responsible for any radio or TV interference caused by unauthorized modifications to this equipment such modifications could void the user authority to operate the equipment.

Changes or modifications not expressly approved by the party responsible for compliance could void the user's authority to operate the equipment.

This device complies with Part 15 of the FCC Rules. Operation is subject to the following two conditions: (1) This device may not cause harmful interference, and (2) This device must accept any interference received, including interference that may cause undesired operation.

Warning: Changes or modifications to this unit not expressly approved by the party responsible for compliance could void the user's authority to operate the equipment.