

FM-8898 - Instruction Manual

Multifunction Wireless Headphones

Features

- Multifunction wireless headphones
- Radio FM built-in
- Microphone built in receiver
- Room monitoring feature
- Possible to use as wired headphones (without battery)
- Frequency response 20Hz – 20KHz
- Receiver powered from battery or power adaptor (not included)
- Transmission frequency: 88.3 MHz
- Receiver frequency range: 88-108MHz
- Weight: 173g (without battery)

Package Includes

- Receiver
- Headphones
- USB power cable
- Jack-jack audio cable
- Cinch-jack audio cable

NOTE. Batteries are not included

Preparation

1. Insert 2 AAA batteries according to polarity marks (+/-) to the compartment located in left “L” earphone.
2. Use volume knob (2) to switch headphones ON. If power LED (5) is lighting – batteries has been installed correctly and are in good condition.
3. You can power receiver in 3 ways: from USB port in computer (use attached USB power cable), from external 4,5V power adaptor (not included in the set) from 2 AAA batteries. Choose one of ways
4. If You decided to use external power insert power plug into power socket (10).
5. If You decided to use batteries, insert 2 AAA alkaline batteries to the compartment located on the bottom of receiver. Remember about polarity marks.

IMPORTANT. Do not use external power or USB power, when batteries are inserted in receiver.

1st remove the batteries.

IMPORTANT. Use only alkaline batteries.

Parts Identification



Headphones

1. Battery compartment
2. Volume control and
3. Scan button (SCAN)
4. Reset button (RESET)
5. Power indicator power switch

Receiver

6. Audio socket
7. Power indicator (front)
8. Power and function switch
9. Microphone socket (MIC)
10. Power socket 4,5V DC
11. Microphone (MIC)
12. Output audio cable
13. Battery compartment (bottom)

Operation

Wireless headphones

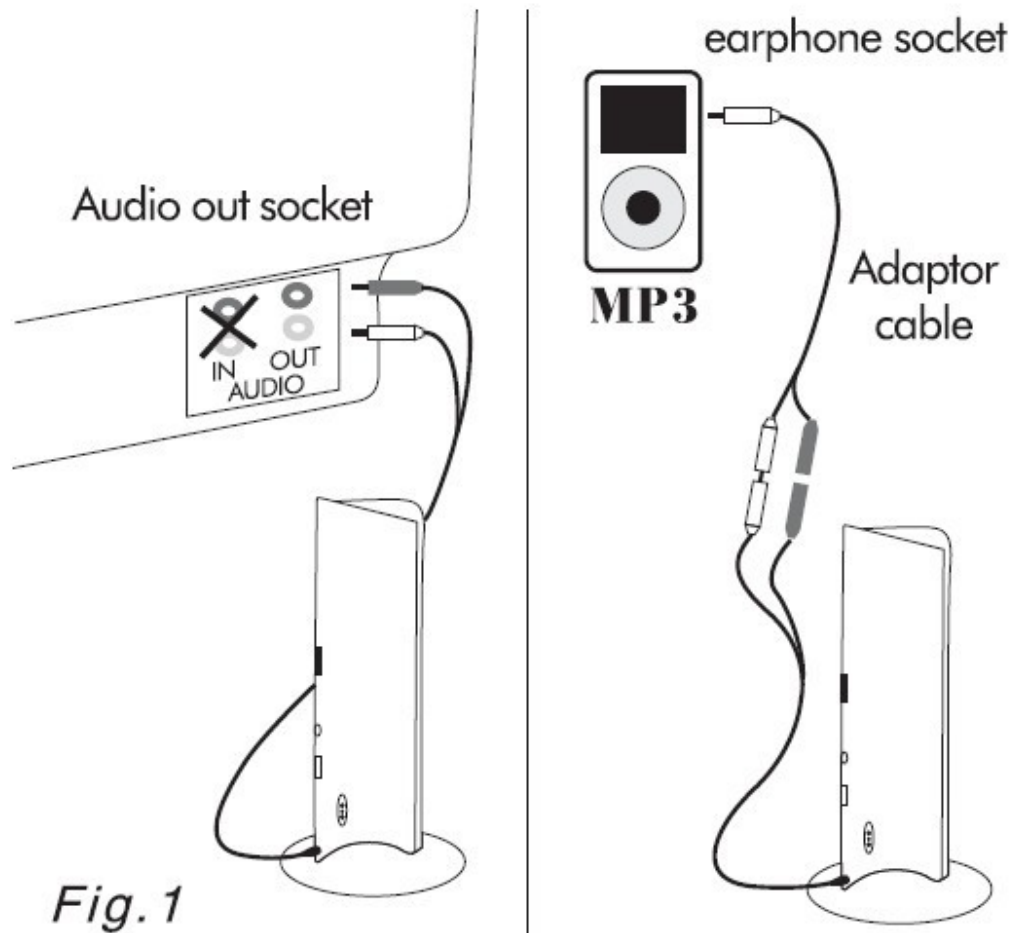

Set receiver function switch to WIRELESS HEADPHONE position. Connect as shown on picture "Fig.1". Switch ON the headphones with power/volume switch. Push RESET button and then SCAN button.

Wireless headset (for PC net audio chat)

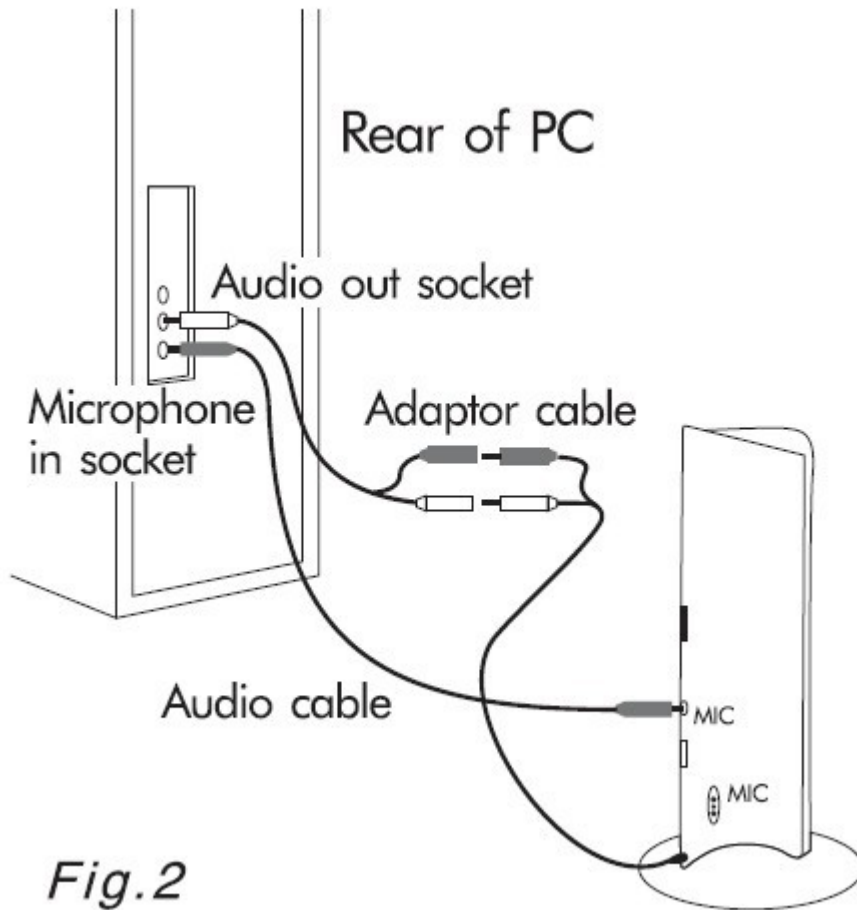

Fig.2



Fig.3

Set receiver function switch to AUDIO CHAT position. Connect as shown on picture “Fig.2” including microphone cable to microphone socket in the computer. Place the receiver close to speaking person (about 1 meter) and aim microphone “Fig.3”. Switch ON the headphones with power/ volume switch. Push RESET button and then SCAN button.

Monitoring

This mode require battery power for the receiver. Set receiver function switch to MONITORING position. Place receiver close the person You want to monitored (np. elderly peoples, kids). Switch ON the headphones with power/volume switch. Push RESET button and then SCAN button.

Listening radio FM

For listening radio FM receiver is useless. Switch ON the headphones with power/volume switch. Push RESET button and then SCAN button. Radio will automatically find active radio channel. To change the station (frequency) push SCAN button again. When the top frequency will be reached, please push RESET button and SCAN to begging from the start of the frequency scale.

Wired headphones

Wired headphones



Fig. 4

For using headphones as wired the receiver is useless. Use the audio cable (jack to jack) to connect headphones to sound source. Battery power in headphones is not necessary.

Note. Always switch off receiver and headphones when not used to save battery.

FCC Part 15

This device complies with Part 15 of the FCC Rules. Operation of this product is subject to the following two conditions:

- (1) this device may not cause harmful interference, and
- (2) this device must accept any interference received, including interference that may cause undesired operation.

This equipment has been tested and found to comply within the limits for a class B digital device, pursuant to Part 15 of the FCC Rules. These limits are designed to provide reasonable protection against harmful interference in a residential installation. This equipment generates, uses, and can radiate radio frequency energy and, if not installed and used in accordance with the instructions, may cause harmful interference to radio communications. However, there is no guarantee that interference will not occur in a particular installation. If this equipment does cause harmful interference to radio or television reception, which can be determined by turning the equipment off and on, the user is encouraged to try to correct the interference by one or more of the following measures:

- Reorient or relocate the receiving antenna.
- Increase the separation between the equipment and receiver
- Connect the equipment into an outlet on a circuit different from that to which the receiver is connected.
- Consult the dealer or an experienced technician for help.

FCC warning

Changes or modifications not expressly approved by the party responsible for compliance with the FCC Rules could void the user's authority to operate this equipment.