

# BLE FIT SENSOR INSTALLATION INSTRUCTIONS

## ( B121-039 / TPM104 )

### FCC Statement:

This device complies with part 15 of the FCC Rules. Operation is subject to the following two conditions:

(1) This device may not cause harmful interference, and

(2) this device must accept any interference received, including interference that may cause undesired operation.

NOTE: This equipment has been tested and found to comply with the limits for a Class B digital device, pursuant to part 15 of the FCC Rules. These limits are designed to provide reasonable protection against harmful interference in a residential installation.

This equipment generates, uses and can radiate radio frequency energy and, if not installed and used in accordance with the instructions, may cause harmful interference to radio communications. However, there is no guarantee that interference will not occur in a particular installation.

If this equipment does cause harmful interference to radio or television reception, which can be determined by turning the equipment off and on, the user is encouraged to try to correct the interference by one or more of the following measures:

—Reorient or relocate the receiving antenna.

—Increase the separation between the equipment and receiver.

—Connect the equipment into an outlet on a circuit different from that to which the receiver is connected.

—Consult the dealer or an experienced radio/TV technician for help.

Changes or modifications not expressly approved by the party responsible for compliance could void the user's authority to operate the equipment.

### ISED Statement:

This device contains licence-exempt transmitter(s) that comply with Innovation, Science and Economic Development Canada's licence-exempt RSS(s). Operation is subject to the following two conditions:

(1) this device may not cause interference,

(2) this device must accept any interference, including interference that may cause undesired operation of the device.

L'émetteur exempt de licence contenu dans le présent appareil est conforme aux CNR d'Innovation, Sciences et Développement économique Canada applicables aux appareils radio exempts de licence. L'exploitation est autorisée aux deux conditions suivantes :

(1) L'appareil ne doit pas produire de brouillage;

(2) L'appareil doit accepter tout brouillage radioélectrique subi, même si le brouillage est susceptible d'en compromettre le fonctionnement.

### NCC statement: LP0002低功率射頻器材技術規範\_章節3.8.2

取得審驗證明之低功率射頻器材，非經核准，公司、商號或使用者均不得擅自變更頻率、加大功率或變更原設計之特性及功能。

低功率射頻器材之使用不得影響飛航安全及干擾合法通信；經發現有干擾現象時，應立即停用，並改善至無干擾時方得繼續使用。

前述合法通信，指依電信管理法規定作業之無線電通信。

低功率射頻器材須忍受合法通信或工業、科學及醫療用電波輻射性電機設備之干擾。

## Please follow installation procedures below.

### Important:

Each time the TPMS sensor is changed or disassembled, it is MANDATORY to replace the TPMS sensor washer, nut, screw, and valve core accessories (use only CUB service component kits designed for TPMS sensor) to ensure proper sealing.

### For Clamp-In Metal Valve Sensors:

1. Insert sensor, metal valve stem and valve stem screw into wheel. Hold in place by hand. Loosely screw into place so sensor drop angle can be adjusted. From outside wheel, put on valve stem nut.
2. While holding sensor down against wheel bottom, hand tighten the nut. With torque wrench, tighten the nut to 4.0Nm.
3. Holding sensor down against wheel bottom, with torque wrench, tighten valve stem screw to 2.0Nm and place the plastic cap.

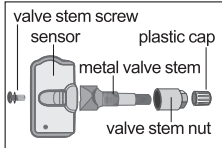

Clamp-In Assembly

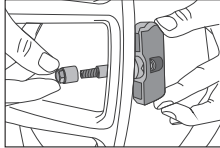

Step 1

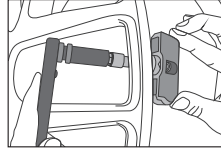

Step 2

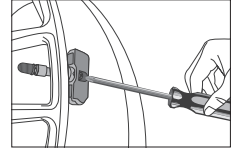

Step 3

### Warranty:

CUB warrants that the TPMS sensor shall be free from defects in workmanship and material during warranty period.

CUB does not assume any liability in case of faulty, incorrect installation of the product, or by using other products causing TPMS sensor malfunction on the part of customer or user.

Always check our website for detail installation procedures, safety information and warranty policy.

