

# Description of E-Label on the LM-W319

## ※ FCC ID is Applied by E-Label On the device

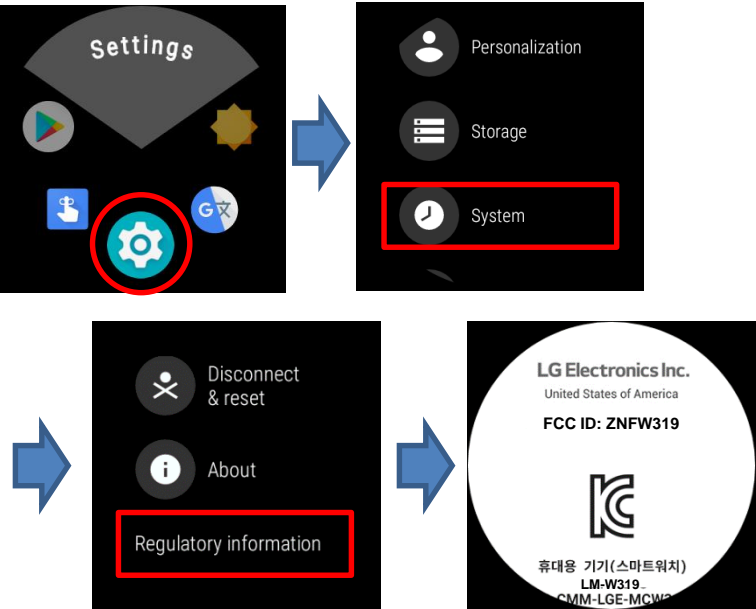

Setting Menu	
Step 1	Select Settings
Step 2	Select System
Step 3	Select Regulatory Information

## ※ Instruction of E-Label on the user Manual

- Regulatory information (FCC ID, E-labeling, etc.)**
1. Press and hold the **Power Key** until the apps list appears.
  2. Tap **Settings** > **System** > **Regulatory information** to get regulatory information.

## ※ FCC ID is Applied on packaging Label

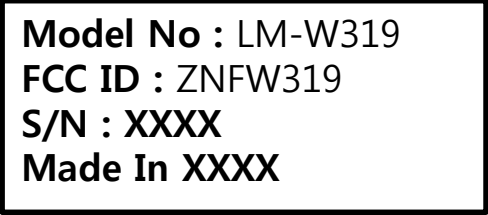

### Note!

We, LG Electronics MobileComm USA, state that at the time of purchase, the FCC ID is readily and physically visible to the purchaser on the packaging Label per 2.925(d). So, The FCC ID will be able to survive normal shipping and handling so it is visible for inspection at the time of import. We have programmed the e-label and it is not able to be modified by any third party. Also, SIM Card in is not required to access the FCC ID number.