

Antenna and Device Information

Antenna Distance

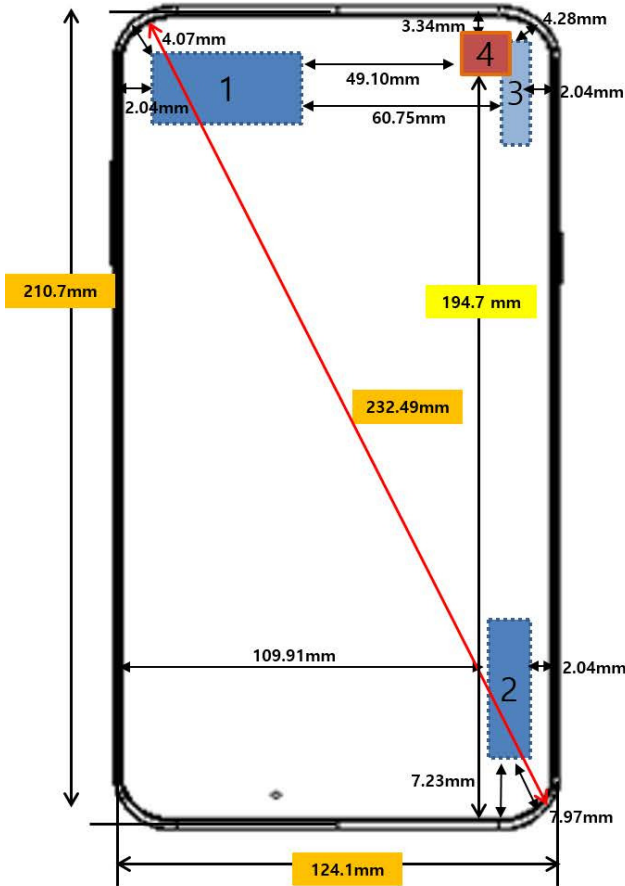

TOP View

Antenna	Mode	Band
1	LTE	LTE B1 / B26/ B41 TX, RX
2	LTE	LTE B1 / B26 / B41 RX
3	GPS/Glonass	GPS/Glonass RX
4	WIFI	2.4GHz/5GHz
	BT	2.4GHz

***Note : LTE B1, 26, 41 is Non-US band**

SAR Test Setup Photographs

■ **Test Setup Photo (Body All)**



■ **Test Setup Photo (Rear)**

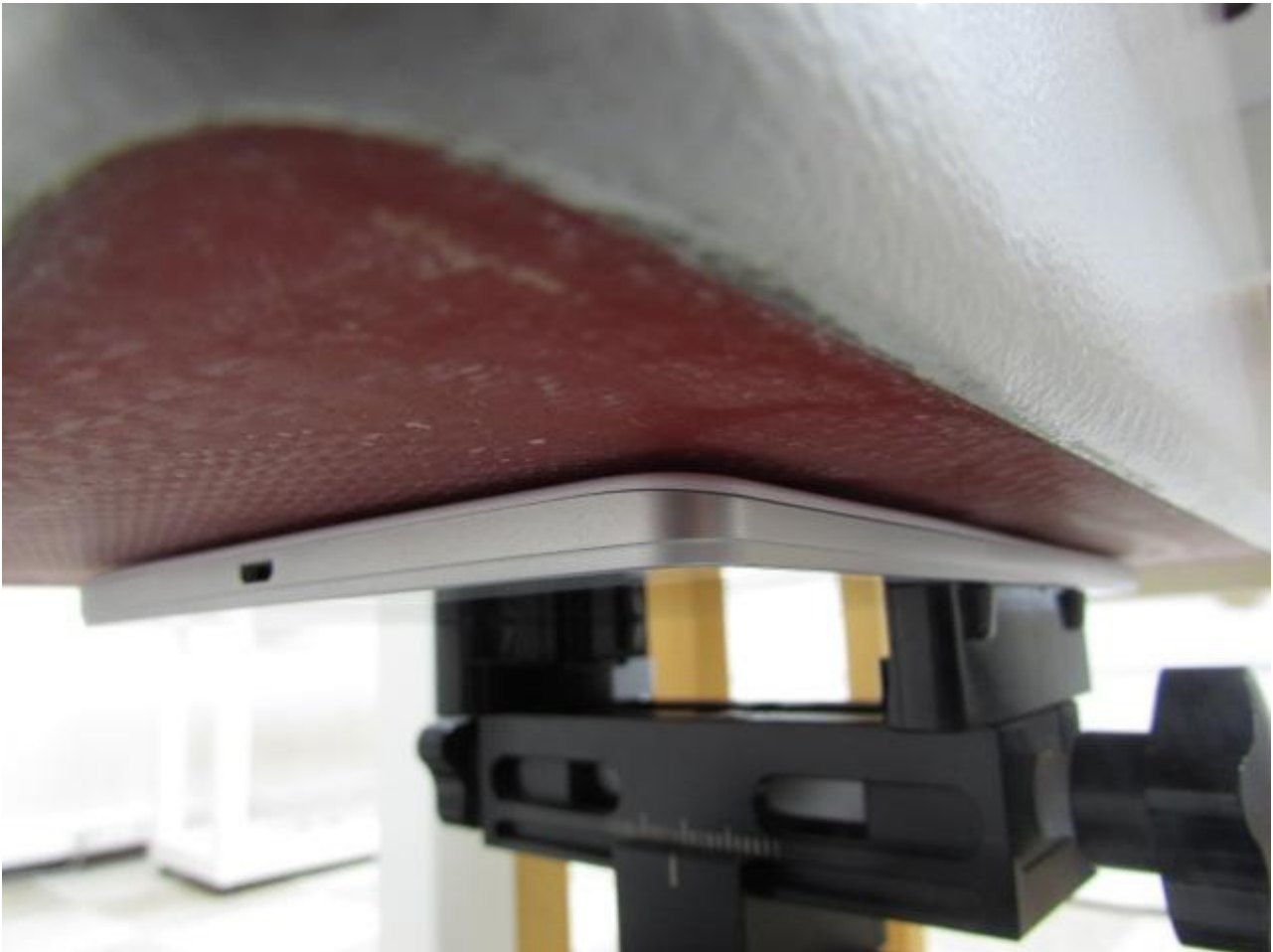

[Distance of 0 cm from the EUT]

■ **Test Setup Photo (Right)**



[Distance of 0 cm from the EUT]

■ **Test Setup Photo(Top)**



[Distance of 0 cm from the EUT]