



USER GUIDE

LG-G360

РУССКИЙ

УКРАЇНСЬКА

ҚАЗАҚША

ENGLISH



052

MFL69197101 (1.0)

www.lg.com

User Guide

ENGLISH

- Some content and illustrations may differ from your device depending on the region, service provider, software version, or OS version, and are subject to change without prior notice.
- Always use genuine LG accessories. The supplied items are designed only for this device and may not be compatible with other devices.
- Available accessories may vary depending on your region, country or service provider.
- Copyright ©2015 LG Electronics, Inc. All rights reserved. LG and the LG logo are registered trademarks of LG Group and its related entities. All other trademarks are the property of their respective owners.

Table of contents

Guidelines for safe and efficient use	4	Camera	25
Getting to know your phone	13	Image viewer.....	26
Phone overview	13	Voice recorder	26
Installing the SIM Cards	15	Media player.....	27
Turning Your Phone On/Off	17	My Stuff.....	27
Calls	18	Organizer	28
Making a call	18	Using your calculator	28
Making a call from your contacts	18	Setting your alarm	28
Answering and rejecting a call	18	Using the calendar.....	28
Using the speakerphone	19	Adding a note	28
Viewing your call logs.....	19	Games & SNS.....	28
Contacts	20	Applications	29
Searching for a contact.....	20	Profiles	30
Adding a new contact.....	20	Bluetooth	31
Messaging	21	Power.....	31
Sending a message	21	Visibility.....	31
Entering text.....	21	My device.....	31
T9 mode ( Abc).....	21	Search audio device	31
Abc mode	22	My name	32
123 mode	22	Advanced	32
Inserting symbols	22	Settings	33
Changing the language.....	22	Display	33
Message folders.....	23	Phone.....	33
E-mail	23	Call.....	34
Multimedia	25	Restore settings.....	35
FM radio	25	Dual SIM setting	36

Data Accounts	36
Network settings	36
Data Settings	36
Accessories.....	37
Troubleshooting	38

Guidelines for safe and efficient use

Please read these simple guidelines. Not following these guidelines may be dangerous or illegal.

Should a fault occur, a software tool is built into your device that will gather a fault log. This tool gathers only data specific to the fault, such as signal strength, cell ID position in sudden call drop and applications loaded. The log is used only to help determine the cause of the fault. These logs are encrypted and can only be accessed by an authorized LG Repair centre should you need to return your device for repair.

Product care and maintenance

WARNING

Only use batteries, chargers and accessories approved for use with this particular phone model. The use of any other types may void any approval or warranty applying to the phone and may be dangerous.

- Do not disassemble this unit. Take it to a qualified service technician when repair work is required.
- Repairs under warranty, at LG's discretion, may include replacement parts or boards that are either new or reconditioned, provided that they have functionality equal to that of the parts being replaced.
- Keep away from electrical appliances such as TVs, radios and personal computers.
- The unit should be kept away from heat sources such as radiators or cookers.
- Do not drop.
- Do not subject this unit to mechanical vibration or shock.
- Switch off the phone in any area where you are required to by special regulations. For example, do not use your phone in hospitals as it may affect sensitive medical equipment.

- Do not handle the phone with wet hands while it is being charged. It may cause an electric shock and can seriously damage your phone.
- Do not charge a handset near flammable material as the handset can become hot and create a fire hazard.
- Use a dry cloth to clean the exterior of the unit (do not use solvents such as benzene, thinner or alcohol).
- Do not charge the phone when it is on soft furnishings.
- The phone should be charged in a well ventilated area.
- Do not subject this unit to excessive smoke or dust.
- Do not keep the phone next to credit cards or transport tickets; it can affect the information on the magnetic strips.
- Do not expose the phone to liquid or moisture.
- Use accessories like earphones cautiously.
- Do not use, touch or attempt to remove or fix broken, chipped or cracked glass. Damage to the glass display due to abuse or misuse is not covered under the warranty.
- Your phone is an electronic device that generates heat during normal operation. Extremely prolonged, direct skin contact in the absence of adequate ventilation may result in discomfort or minor burns. Therefore, use care when handling your phone during or immediately after operation.
- If your phone gets wet, immediately unplug it to dry off completely. Do not attempt to accelerate the drying process with an external heating source, such as an oven, microwave or hair dryer.
- The liquid in your wet phone, changes the colour of the product label inside your phone. Damage to your device as a result of exposure to liquid is not covered under your warranty.

Efficient phone operation

Electronics devices

All mobile phones may receive interference, which could affect performance.

- Do not use your mobile phone near medical equipment without requesting permission. Avoid placing the phone over pacemakers, for example, in your breast pocket.
- Some hearing aids might be disturbed by mobile phones.
- Minor interference may affect TVs, radios, PCs etc.
- Use your phone in temperatures between 0 °C and 40 °C, if possible. Exposing your phone to extremely low or high temperatures may result in damage, malfunction, or even explosion.

Road safety

Check the laws and regulations on the use of mobile phones in the area when you drive.

- Do not use a hand-held phone while driving.
- Give full attention to driving.
- Pull off the road and park before making or answering a call if driving conditions so require.
- RF energy may affect some electronic systems in your vehicle such as car stereos and safety equipment.
- When your vehicle is equipped with an air bag, do not obstruct with installed or portable wireless equipment. It can cause the air bag to fail or cause serious injury due to improper performance.
- If you are listening to music whilst out and about, please ensure that the volume is at a reasonable level so that you are aware of your surroundings. This is of particular importance when near roads.

Avoid damage to your hearing



To prevent possible hearing damage, do not listen at high volume levels for long periods.

Damage to your hearing can occur if you are exposed to loud sound for long periods of time. We therefore recommend that you do not turn on or off the handset close to your ear. We also recommend that music and call volumes are set to a reasonable level.

- When using headphones, turn the volume down if you cannot hear the people speaking near you, or if the person sitting next to you can hear what you are listening to.

NOTE: Excessive sound pressure from earphones and headphones can cause hearing loss.

Glass Parts

Some parts of your mobile device are made of glass. This glass could break if your mobile device is dropped on a hard surface or receives a substantial impact. If the glass breaks, do not touch or attempt to remove it. Stop using your mobile device until the glass is replaced by an authorised service provider.

Blasting area

Do not use the phone where blasting is in progress. Observe restrictions and follow any regulations or rules.

Potentially explosive atmospheres

- Do not use your phone at a refueling point.
- Do not use near fuel or chemicals.
- Do not transport or store flammable gas, liquid or explosives in the same compartment of your vehicle as your mobile phone or accessories.

In aircraft

Wireless devices can cause interference in aircraft.

- Turn your mobile phone off before boarding any aircraft.
- Do not use it on the ground without permission from the crew.

Children

Keep the phone in a safe place out of the reach of small children. It includes small parts which may cause a choking hazard if detached.

Emergency calls

Emergency calls may not be available on all mobile networks. Therefore you should never depend solely on your phone for emergency calls. Check with your local service provider.

Battery information and care

- You do not need to completely discharge the battery before recharging. Unlike other battery systems, there is no memory effect that could compromise the battery's performance.
- Use only LG batteries and chargers. LG chargers are designed to maximise the battery life.
- Do not disassemble or short-circuit the battery.
- Keep the metal contacts of the battery clean.
- Replace the battery when it no longer provides acceptable performance. The battery pack may be recharged hundreds of times before it needs replacing.
- Recharge the battery if it has not been used for a long time to maximise usability.
- Do not expose the battery charger to direct sunlight or use it in high humidity, such as in the bathroom.
- Do not leave the battery in hot or cold places, as this may deteriorate battery performance.
- There is risk of explosion if the battery is replaced with an incorrect type.
- Dispose of used batteries according to the manufacturer's instructions. Please recycle when possible. Do not dispose as household waste.
- If you need to replace the battery, take it to the nearest authorised LG Electronics service point or dealer for assistance.
- Always unplug the charger from the wall socket after the phone is fully charged to save unnecessary power consumption of the charger.
- Actual battery life will depend on network configuration, product settings, usage patterns, battery and environmental conditions.
- Make sure that no sharp-edged items such as animal's teeth or nails, come into contact with the battery. This could cause a fire.

Open Source Software Notice Information

To obtain the source code under GPL, LGPL, MPL, and other open source licenses, that is contained in this product, please visit <http://opensource.lge.com>.

In addition to the source code, all referred license terms, warranty disclaimers and copyright notices are available for download.

LG Electronics will also provide open source code to you on CD-ROM for a charge covering the cost of performing such distribution (such as the cost of media, shipping, and handling) upon email request to opensource@lge.com. This offer is valid for three (3) years from the date on which you purchased the product.

DECLARATION OF CONFORMITY

Hereby, **LG Electronics** declares that this **LG-G360** product is in compliance with the essential requirements and other relevant provisions of Directive **1999/5/EC**. A copy of the Declaration of Conformity can be found at <http://www.lg.com/global/support/cedoc/cedoc>

Contact office for compliance of this product :

LG Electronics Inc.

EU Representative, Krijgsman 1,
1186 DM Amstelveen, The Netherlands

Ukraine Restriction of Hazardous Substances

The equipment complies with requirements of the Technical Regulation, in terms of restrictions for the use of certain dangerous substances in electrical and electronic equipment.



Disposal of your old appliance

- 1 All electrical and electronic products should be disposed of separately from the municipal waste stream via designated collection facilities appointed by the government or the local authorities.
- 2 The correct disposal of your old appliance will help prevent potential negative consequences for the environment and human health.
- 3 For more detailed information about disposal of your old appliance, please contact your city office, waste disposal service or the shop where you purchased the product.



Disposal of waste batteries/accumulators

- 1 This symbol may be combined with chemical symbols for mercury (Hg), cadmium (Cd) or lead (Pb) if the battery contains more than 0.0005% of mercury, 0.002% of cadmium or 0.004% of lead.
- 2 All batteries/accumulators should be disposed separately from the municipal waste stream via designated collection facilities appointed by the government or the local authorities.
- 3 The correct disposal of your old batteries/accumulators will help to prevent potential negative consequences for the environment, animal and human health.
- 4 For more detailed information about disposal of your old batteries/accumulators, please contact your city office, waste disposal service or the shop where you purchased the product.

Getting to know your phone

Phone overview

Navigation keys

Use for quick access to phone functions.

(up) :

- Long press up key : Media Player

- Short press up key : Calendar

(down) :

- Long press down key : Calculator

- Short press down key : Write message

(left) :

- Long press left key : My Stuff

- Short press left key : Alarm clock

(right) :

- Long press right key : Voice recorder

- Short press right key : FM radio

Send key

You can dial a phone number and answer incoming calls.

SIM Switch Key

Dual SIM key choose which SIM card you're going to use.

Long press to view Multi SIM settings.

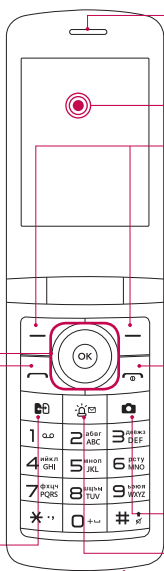

Earpiece

Display screen

Soft keys

Each of these keys performs the functions indicated by the text on the display immediately above them.

End/Power key

- Ends or rejects a call.
- Returns to the home screen when you use the menu.
- Long press to turn On/Off your phone.

Camera key

Hotline SMS service key

Microphone

Charger/USB port

NOTE: This is due to the design. Your phone did not completely flip open because it flips open at a certain angle only.

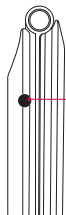

Headset Jack

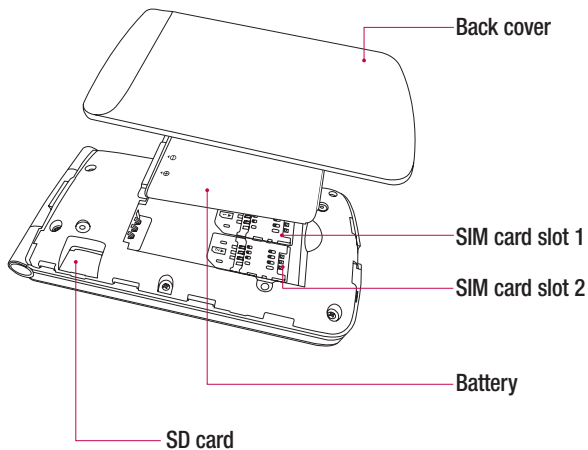

Back cover

SIM card slot 1

SIM card slot 2

Battery

SD card

Installing the SIM Cards

When you subscribe to a cellular network, you are provided with a SIM card loaded with your subscription details, such as your PIN, any optional services available and many others.

Important!

- The SIM card can be easily damaged by scratches or bending, so be careful when handling, inserting or removing the card. Keep all SIM cards out of the reach of small children.
- 1 Remove the back cover as shown in figure.

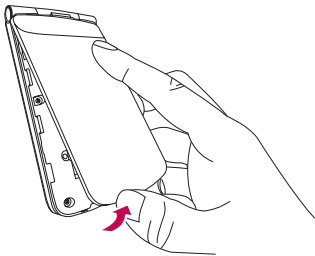

- 2 Make sure the gold contact area on the card is facing downwards.

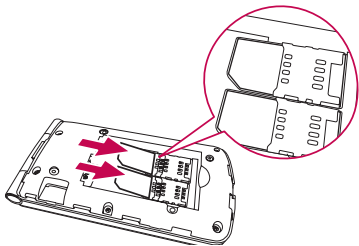

3 Insert your battery.

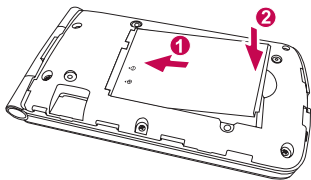

4 Replace the back cover.

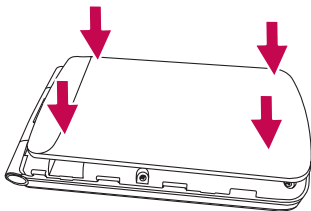

Charging the phone

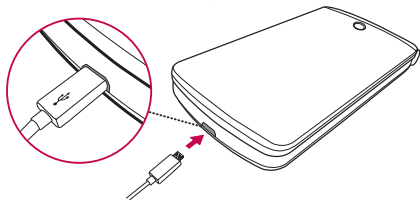

- Insert the charger and plug it into an electrical outlet.
- To maximize the battery lifetime, ensure that the battery is fully charged before you use it for the first time.



WARNING

Use only LG-approved chargers, batteries, and cables. When using unapproved chargers or cables, it may cause slow battery charging, or pop up the message regarding slow charging. Or, unapproved chargers or cables can cause the battery to explode or damage the device, which are not covered by the warranty.

Turning Your Phone On/Off

You can power the phone On or Off by pressing and holding the **End/Power key**.

Making a call

- 1 Enter the number using the keypad. To delete a digit press **Clear**.
- 2 Press  to initiate the call.
- 3 To end the call, press .

TIP!

To control the volume during a call, press the Up/Down navigation keys.

Making a call from your contacts

- 1 Select **Contacts** from the home screen.
- 2 Using the keypad, enter the first letter of the contact you want to call and scroll through the Contacts.
- 3 Press  to begin the call.

TIP!

To scroll through your contacts, use the Up/Down navigation keys.

Answering and rejecting a call

When your phone rings, press  to answer the call.

While your phone is ringing, select **Silent** to mute the ringing.

Press  or select **Silent** then **Reject** to reject the incoming call.

TIP!

- You can change the settings on your phone to answer your calls in different ways.
- Press **Menu > Settings > Call > Advanced settings > Answer mode** and choose **Any key** or **Auto answer when headset mode**.

Using the speakerphone

During in call, you can activate speakerphone by pressing RSK (H-Free) and you can use the handset in hands-free mode.

If the speakerphone is active, press RSK (H-Held) again to resume normal handset conversation mode.

Viewing your call logs

Press **Menu** and choose **Logs**.

- **All calls** – Displays the lists of all three types (Received/Dialled/Missed calls) by time. This option lets you view the details of last 60 calls.
- **Missed calls** – This option lets you view the unanswered calls.
- **Received calls** – This option lets you view the incoming calls.
- **Dialled calls** – This option lets you view the outgoing calls (called or attempted).
- **Call duration** – Allows you to view the duration of your last call, dialled calls, received calls and reset all.
- **Text msg. counter** – Allows you to count the number of messages sent and received from the phone.
- **Data information** – Allows you to view the information of last sent, last received, all sent, all received and reset counter.

Searching for a contact

- 1 Select **Contacts** from the home screen.
- 2 Using the keypad enter the first letter of the contact you want to call.
- 3 Press Up/Down navigation keys to scroll through the contacts.

Adding a new contact

- 1 Select **Contacts** from the home screen.
- 2 Choose **Add new contact**.
- 3 Select **To SIM** or **To Phone** and Press **OK**.
- 4 Then enter the Name, Number & details of your new contact, select **Options** then choose **Save**.

Sending a message

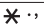
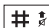
- 1 Press **Menu**, select **Messaging**, select **Write message** and choose **Text Message** or **Multimedia Message**.
- 2 A new message editor will open with the first field for recipients and second field for message content.
- 3 Enter your recipients by either entering manually or from Options choose **Add recipient** to enter from phonebook. If you want to add more recipients, press  key in recipient field.
- 4 Enter your message using either the T9 predictive mode or Abc manual mode or 123 mode. You can switch text input modes by pressing the  key.

Entering text

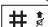

You can enter alphanumeric characters using the phone's keypad. The following text input methods are available in the phone: T9 mode ( Abc), Abc mode and 123 mode. To change modes, press the  key.

NOTE: Some fields may allow only one text input mode (e.g. telephone number in address book fields).

T9 mode (Abc)

T9 mode ( Abc) uses a built-in dictionary to recognise words you're writing based on the key sequences you press. Simply press the number key associated with the letter you want to enter, and the dictionary will recognise the word once all the letters are entered.

Using the T9 mode (S) Abc

- 1 When you are in the T9 predictive text input mode, start entering a word by pressing keys  to . Press one key per letter.
 - If the word is still incorrect after typing completely, press the left & right navigation keys to scroll through the other word options.
 - If the desired word is missing from the word choices list, add it by using the Abc mode.
- 2 Enter the whole word.
 - To delete letters, press **Clear**.

Abc mode

This mode allows you to enter letters by pressing the key labelled with the required letter once, twice, three or four times until the letter is displayed.

123 mode

Type numbers using one keystroke per number. You can also add numbers while remaining in letter modes by pressing and holding the desired key.

Inserting symbols

If you want to insert symbols, press the  key, then you can choose a symbol. And in some editors you can press **Options**, go to **Insert symbol**.

Changing the language

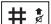
There are two ways to change the writing language from the writing screen. You can press **Options**, go to **Writing language** and then set the language you want or long press  key in editor.

Message folders

Press **Menu**, select **Messaging**. And select the folder you want.

Inbox – You will be alerted when you have received messages. They will be stored in Inbox.

Drafts – If you don't have time to finish writing a message, you can save what you have written so far in here.

Outbox – This is a temporary storage folder used while messages are being sent.

Sent messages – After sending out the message, the text message is saved in the Sent folder.

Message settings – Your message settings are pre-defined so that you can send messages immediately. If you would like to change the settings, you can do this using the settings options.

Conversations – Inbox, Outbox and Sent messages are shown together grouped by the recipients.

NOTE: If you want Inbox, Outbox and Sent messages instead of Conversations, then go to **Message Settings**, select **Conversations** and choose **Off**.

E-mail

Setting up your e-mail

You can stay in touch on the move using e-mail on your phone. It's quick and simple to set up a POP3 or IMAP4 e-mail account.

- 1 Press **Menu** and choose **E-mail**.
- 2 The first time you open the E-mail, you need to setup an email account. A setup wizard opens to help you add an e-mail account.
- 3 Follow the pop up instruction and enter the information required.

NOTE:

- While doing email operations you may get certificate error.
From Options choose Install and give any name and save this certificate. The certificate import happens successfully.
- Please set correct Date and Time before you use Email.

FM radio

Your phone has an FM radio feature so you can tune into your favourite stations and listen on the move.

Searching for stations

- 1 Press **Menu** and select **FM radio**.
- 2 Select **Options** and choose **Auto search**. You can also use the left and right navigation keys to increase/decrease the frequency.

NOTE: Insert the earphone into the headset connector in order to listen to the radio and keep the good radio reception.

Camera

Taking a photo

- 1 Press **Menu** and choose **Camera**.
- 2 Holding the phone and point the lens towards the subject of the photo.
- 3 Press **OK** key to take a photo.

The following options will appear at the bottom of the screen by pressing left soft key.

White balance – The white balance ensures any the white areas in your video are realistic. To enable your camera to adjust the white balance correctly, you may need to determine the light conditions. Choose from Auto, Daylight, Tungsten, Fluorescent, Cloudy or Incandescent.

Effects – Set the Effects as Normal, Grayscale, Sepia, Sepia green, Sepia blue or Colour invert.

Adv. settings – Allows to choose from Storage, Image quality, Contrast, Shutter sound, Anti-flicker and Restore default.

Shooting a video

- 1 Press **Menu** and choose **Camera**.
- 2 Press **down navigation key** to convert into the video mode.
- 3 Point the lens towards the subject of the video and press **OK** key to start recording.
- 4 A timer will appear at the bottom of left-side.
- 5 Press **OK** key to stop recording and select the **right soft key** to save.

Adv. settings – Allows to choose from Storage, Video quality, Contrast, Record audio, Anti-flicker and Restore default.

NOTE: You can adjust the zoom scale by using the left and right navigation keys. The zoom scale ranges from Level 1 to Level 4.

Image viewer

This menu allows you to pictures and videos that are captured with camera. You can access the following options by pressing **Options: View, Send, Use as, Rename, Delete, Sort by, Details** and **Storage**. In Use as, you can choose from **Wallpaper, Power on display, Power off display** and **Caller picture**.

Voice recorder

You can use Voice recorder to record voice memos or other sounds.

- 1 Press **Menu** and choose **Voice recorder**.
- 2 Press **up navigation key** to begin recording.
- 3 Press **Pause** to pause recording, **Cont.** to continue recording.
- 4 Choose **Stop** to end the recording.

NOTE: After recording, you can access the following options by pressing **Options: New record, Play, Append, Rename, Delete, List, Settings** and **Send**. In Use as, you can choose the Incoming call ringtone.

Media player

This menu allows you to play audio and video files. You can also manage play lists. Choose from **Now playing, All songs, All videos** and **Music playlists**.

My Stuff

You can store multimedia files in your phone's memory so you have easy access to all your audio, photos and videos. You can also save your files to a memory card. Using a memory card allows you to free up space in your phone's memory. By touching **My Stuff**, you can open a list of the folders that store all your multimedia files.

Using your calculator

The calculator provides the basic arithmetic functions: addition, subtraction, multiplication and division.

Setting your alarm

You can set up to 5 alarms to invoke on a specified time.

Using the calendar

When you enter this menu, a calendar appears. A square cursor is located on the current date. You can move the cursor to another date using the navigation keys.

Adding a note

You can register your own notes here.

Games & SNS

Allows you to access the various games like Brain Challenge 4 or Diamond Twister 2 and SNS like Facebook or Twitter.

Applications

Allows you to access preloaded games to keep you amused when you have time to spare. Press **Menu** and select **Applications**. Choose **My games & apps**.

Profiles

You can adjust and customize the phone profile for different events or environments.

- **General** – Ring tone and key tone volume are set to normal.
- **Silent** – Ring tone is disabled and Silent mode is activated.
- **Meeting** – Ring tone is disabled and Vibrate is activated.
- **Outdoor** – Ring tone and key tone volume are set to maximum.
- **My style** – Ringtone and key tone are set as you desired.

Bluetooth

Your phone has built-in Bluetooth wireless technology, which makes it possible for you to connect your phone wirelessly to other Bluetooth devices such as a handsfree device, PC, laptop, or other phones. The devices registered in your phone can only be connected one at a time (To make a connection to the same type of device or change Bluetooth preferences, disconnect the existing device first).

Power

Allows you to turn your Bluetooth functionality on or off.

Visibility

Allows you to set your device to be visible to other Bluetooth devices. Choose from **Permanent visible**, **Temporary visible** or **Off**.

My device

Allows you to view the list of all devices that are paired with your phone.

Search audio device

Allows you to search for and add new audio devices.

My name

Allows you to edit the name of your device.

Advanced

Choose from **Audio path**, **Storage**, **Sharing permission** and **My address**.

Display

This menu allows you to configure your display settings.

- **Wallpaper** – Allows you to set a picture as your background.
- **Power on display** – Allows you to set a picture as your background when the phone turns on.
- **Power off display** – Allows you to set a picture as your background when the phone turns off.
- **Show date and time** – Allows you to show the date and time on the idle screen.

Phone

Enjoy the freedom of adapting how your phone works for your own style.

- **Date & Time** – You can set functions relating to the date and time.
- **Language** – You can change the language for the display texts in your phone. This change will also affect the Language Input mode.
- **Security** – Allows you to protect the features and settings of your phone. Choose from SIM security, Phone security, Certificate manager and Anti-theft mobile tracker.
- **Schedule power on/off** – Allows you to set up time for the phone automatically power on or off. Once the time is set by you, the phone will power on or off automatically at the time specified.
- **Preferred writing language** – You can set the desired languages.
- **SOS service** – When SOS service is turned on, send the emergency SMS by press and holding the '9' key on your keypad in idle screen, SOS mode will now be turned on. The SOS messages will be sent to the phone number(s)

listed in Recipient list. While SOS mode is active, incoming calls by them will be automatically accepted. To exit SOS mode, on the idle screen push the end key and select Yes.

- **Emergency Notice** – Once this feature is Set ON, Message will be sent to Emergency contact(s), when Emergency call is dialled or when Phone is in non-usage for certain duration. This may incur additional charges.
- **Hotline SMS** – Hotline SMS sends SMS with text as defined by the user to recipients. Users can send SMS also by using hotkey and user is allowed to customize it.
- **Encoding** – You can choose from ASCII, ISO-8859-1 and Windows-1252.
- **Auto update time** – Allows you to set the phone to automatically update the time and date according to the current local time zone.
- **Flight mode** – You can use this function to switch the flight mode on. You will not be able to make calls, send messages when flight mode is switched on.
- **Misc. settings** – You can set the brightness of the LCD backlight.

Call

You can set the menu relevant to a call.

SIM1/ SIM2 settings

- **Caller ID** – Select Hide ID or Send ID or set be network caller ID info.
- **Call waiting** – Select Active or cancel call waiting.
- **Call divert** – Select methods for diverting calls.
- **Call barring** – Choose a barring password for all outgoing calls, outgoing international, outgoing international except to home country, all incoming calls, or incoming when abroad.

Cost save mode – Every contact is added along with assigned SIM when adding in phone book. During Calling, matching operator SIM is identified and the operation is completed using the matching operator SIM. This makes possible to use benefit from using same operator. To use Cost save mode feature, make sure the feature is On
[Settings > Call > Cost save mode]

NOTE: Cost save mode doesn't work during in-call.

Smart call divert – Smart call divert activates call waiting and call forward for both SIMs. when you are in-call with SIM1 or SIM2 call are forwarded to SIM1 and vice versa.

Advanced settings

- **Auto redial** – Choose the switch ON or OFF.
- **Call time reminder** – Choose the Off, Single or Periodic.
- **Reject by SMS** – Choose the switch ON or OFF.
- **Answer mode** – You can change the settings on your phone to answer your calls in different ways.
- **Fake call** – This is a useful function for avoiding awkward situation politely. You can call yourself by setting the time in fake call menu.
- **Hearing Aid** – Hearing Aid increases volume levels in call. Volume will be increased only in receiver mode. Not applicable for Speaker, Headset and Bluetooth path

NOTE: Fake call can be activated or deactivated from idle screen using shortcut code ##*#.

Restore settings

You can restore and restart the phone by inputting the phone password.

Dual SIM setting

You can see two Network Signal icons on the left-top of the screen when you insert two SIM-Card. To Activate/Deactivate the SIM card, Go to **Menu > Dual SIM settings**.

Data Accounts

Pre defined APN, Homepage, IP Address, Port settings have been given for all operators of targeted countries. Data account settings are used to launch Opera, Facebook, Twitter and any other network based apps, which uses data connection.

Network settings

You can select a network that will be registered either automatically or manually.

Data Settings

These settings let you control the cellular settings for your phone that enables you to connect to internet, send MMS and email and download java games.

Accessories

These accessories are available for use with the your phone. **(Items described below may be optional.)**

- **Travel adaptor**
- **Battery**

NOTE:

- Always use genuine LG accessories. The supplied items are designed only for this device and may not be compatible with other devices.
- The items supplied with the device and any available accessories may vary depending on the region or service provider.

NOTE: For better performance, Please upgrade the Mobile phone SW on PC with Operating system higher than Windows XP

Troubleshooting

This chapter lists some problems you might encounter when using your phone. Some problems require you to call your service provider, but most are easy to fix yourself.

Message	Possible causes	Possible corrective measures
SIM card error	There is no SIM card in the phone or it is inserted incorrectly.	Make sure that the SIM card is correctly inserted.
No network connection/ Dropped network	Signal is weak or you are outside the carrier network.	Move toward a window or into an open area. Check the network operator coverage map.
	Operator applied new services.	Check whether the SIM card is more than 6~12 months old. If so, change your SIM card at your network provider's nearest branch. Contact your service provider.

Message	Possible causes	Possible corrective measures
Codes do not match	To change a security code, you will need to confirm the new code by re-entering it.	If you forget the code, contact your service provider.
	The two codes you have entered do not match.	
Calls not available	Dialling error	New network not authorized.
	New SIM card inserted.	Check for new restrictions.
	Pre-paid charge limit reached.	Contact service provider or reset limit with PIN2.
Phone cannot be switched on	On/Off key pressed too briefly.	Press the On/Off key for at least two seconds.
	Battery is not charged.	Charge battery. Check the charging indicator on the display.

Message	Possible causes	Possible corrective measures
Charging error	Battery is not charged.	Charge battery.
	Outside temperature is too hot or cold.	Make sure phone is charging at a normal temperature.
	Contact problem	Check the charger and its connection to the phone.
	No voltage	Plug the charger into a different socket.
	Charger defective	Replace the charger.
	Wrong charger	Use only original LG accessories.
No sound	Vibration mode	Check the settings status in the sound menu to make sure you are not in vibration or silent mode.

Body-worn Operation

This device was tested for typical body-worn operations with the back of the phone kept 0.59 inches (1.5 cm) from the body. To comply with FCC RF exposure requirements, the phone must be kept 0.59 inches (1.5 cm) from the body without any reference to a particular side or edge.

Belt-clips, holsters and similar accessories containing metallic components may not be used. Body-worn accessories that cannot maintain 0.59 inch (1.5 cm) separation distance between the user's body and the back of the phone, and have not been tested for typical body-worn operations may not comply with FCC RF exposure limits and should be avoided.

FCC Part 15.19 statement

This device complies with part 15 of FCC rules. Operation is subject to the following two conditions:

(1) This device may not cause harmful interference, and (2) this device must accept any interference received, including interference that may cause undesired operation.

FCC Part 15.21 statement

Changes or Modifications that are not expressly approved by the manufacturer could void the user's authority to operate the equipment.

FCC Part 15.105 statement

This equipment has been tested and found to comply with the limits for a class B digital device, pursuant to Part 15 of the FCC Rules. These limits are designed to provide reasonable protection against harmful interference in a residential installation. This equipment generates uses and can radiate radio frequency energy and, if not installed and used in accordance with the instructions, may cause harmful interference to radio communications. However, there is no guarantee that interference will not occur in a particular installation. If this equipment does cause harmful interference or television reception, which can be determined by turning the equipment off and on, the user is encouraged to try to correct the interference by one or more of the following measures:

- Reorient or relocate the receiving antenna.
- Increase the separation between the equipment and receiver.
- Connect the equipment into an outlet on a circuit different from that to which the receiver is connected.
- Consult the dealer or an experienced radio/TV technician for help.



CE0168