



LG 306G

Guía del Usuario

ESPAÑOL



ENGLISH

User Guide

LG 306G

MFL68006601 (1.0)



Congratulations on your purchase of the advanced and compact LG 306G phone by LG, designed to operate with the latest digital mobile communication technology.

Some of the contents in this manual may differ from your phone depending on the software of the phone or your service provider.



Copyright ©2013 LG Electronics, Inc. All rights reserved. LG and the LG logo are registered trademarks of LG Group and its related entities. All other trademarks are the property of their respective owners.

# Contents

<b>Getting to know your phone</b> .....	<b>4</b>	Serial Number .....	26
Device components.....	4	SIM Number .....	26
Installing the SIM Card and Battery .....	6	Code Entry Mode .....	26
Charging your phone .....	10	<b>In-Call Menu</b> .....	<b>27</b>
Installing a memory card .....	11	During a Call .....	27
Icon Glossary .....	13	<b>Your Home Screen</b> .....	<b>29</b>
<b>Connecting to Networks and Devices</b> .....	<b>15</b>	Home Screen .....	31
Connect to Wi-Fi .....	15	<b>Contacts</b> .....	<b>35</b>
Connecting to Bluetooth Devices	16	Contact List.....	35
<b>General Functions</b> .....	<b>17</b>	Add New .....	35
Making a Call.....	17	Groups.....	36
Answering a Call.....	18	Speed Dial.....	37
Adjusting the Volume .....	18	<b>Messages</b> .....	<b>39</b>
Setting Profiles.....	19	Create Message.....	39
Entering Text.....	20	Inbox .....	43
<b>Prepaid</b> .....	<b>25</b>	Drafts.....	44
Add Airtime .....	25	Outbox.....	44
Buy Airtime .....	25	Message Settings.....	45
My Phone Number .....	25	Email .....	47
My Airtime Info .....	25	<b>Multimedia</b> .....	<b>50</b>
Airtime Display.....	25	Games & Apps .....	50
		Facebook.....	50

Camera.....	50	Touch .....	77
<b>Music Player.....</b>	<b>55</b>	Accessibility .....	77
Music Player.....	55	Sound Settings.....	78
<b>Utilities.....</b>	<b>60</b>	Bluetooth .....	80
Audio .....	60	<b>Accessories .....</b>	<b>84</b>
Pictures.....	60	<b>For Your Safety.....</b>	<b>85</b>
Video .....	60		
Voice Recorder.....	61		
Calendar.....	62		
Notepad .....	63		
Tasks.....	64		
Stopwatch.....	65		
Calculator.....	66		
Tip Calculator .....	66		
Unit Converter.....	66		
Alarm .....	67		
File Manager.....	68		
<b>Browser.....</b>	<b>70</b>		
<b>Settings .....</b>	<b>72</b>		
Display .....	72		
Phone.....	73		
Call.....	76		

# Getting to know your phone

## Device components

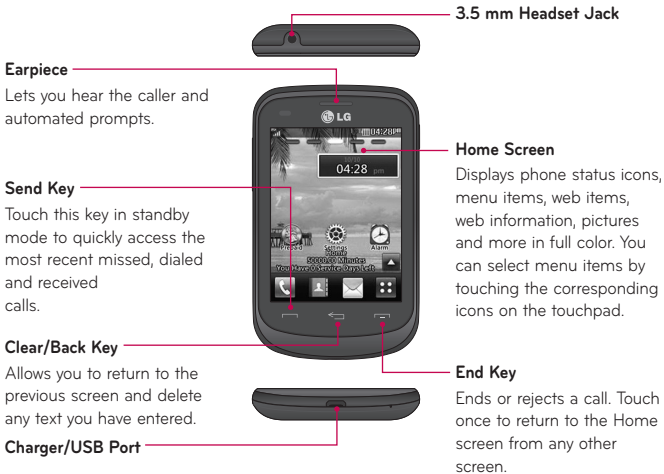

### Volume Keys

- On the Home screen: Allows you to set the Ringtone volume. Hold the Volume Down Key to toggle the Vibration Mode On and Off.
- During a call: Allows you to change the Earpiece volume.
- When playing music: Allows you to change the music volume.

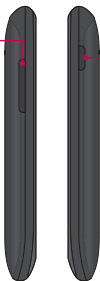

### Power/Lock Key

- Powers your phone on/off by pressing and holding the key.
- Turns your screen on and off and locks it.



## Getting to know your phone

### Installing the SIM Card and Battery

#### Remove the back cover

Hold the phone on your hand firmly. With the other hand, lift the back cover using the fingertip cutout located at the bottom of the cover to remove it.





## Remove the battery

Use the fingertip cutout at the bottom of the battery compartment to lift the battery out.

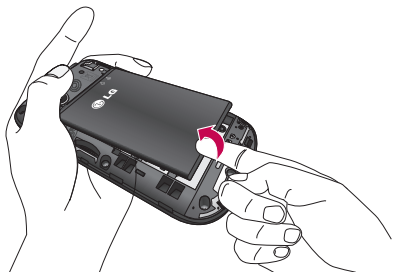

## Getting to know your phone

### ⚠ WARNING

Do not remove the battery when the phone is switched on, as this may damage the phone.

### Install the SIM card

Slide the SIM card into the SIM card slot. Make sure that the gold contact area on the card is facing downward. To remove the SIM card, pull it gently in the opposite direction.

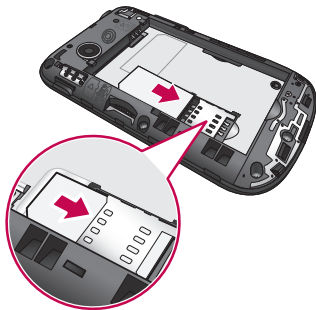

## Install the battery

Insert the top of the battery first into the top edge of the battery compartment. Ensure that the battery contacts align with the terminals on the phone. Press the bottom of the battery down until it clicks into place.

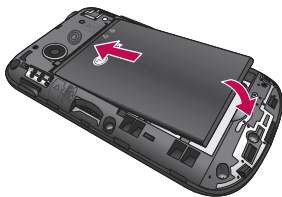

## Install the back cover

Align the back cover over the battery compartment and press it down until it clicks into place.



## Getting to know your phone

### Charging your phone

Locate the Charger/USB Port at the bottom of your phone. Insert the charger connector to the phone (ensure that the USB icon on the connector is facing up) and then plug the other end into the wall socket. Your phone will need to be charged until you receive a 'Battery Full' notification.

**Important!** You should insert the battery before charging.

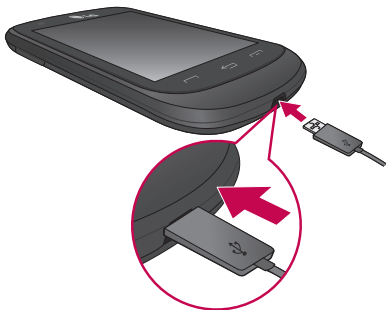

**NOTE:** Always unplug the charger from the wall socket after the phone is fully charged to save unnecessary power consumption of the charger.

**⚠ WARNING**

Use of unauthorized accessories could damage your phone and void your warranty.

## Installing a memory card

You can expand the available memory space on your phone by using a microSD™ memory card. Your phone supports up to a 32 GB microSD™ memory card.

**Note:** A 4 GB microSD™ memory card is included with your phone.

1. Remove the back cover and locate the microSD™ card slot.
2. Gently insert the microSD™ card with the gold contact area facing downwards.

## Getting to know your phone

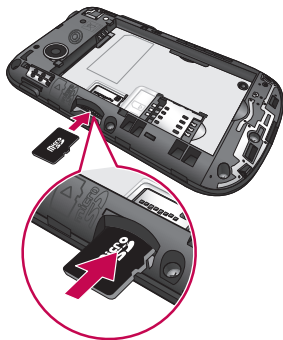









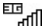



### 3. Replace the back cover.









**NOTE:** If your memory card has existing content it will automatically be filed in the correct folder. For example, videos will be accessible from the Videos folder. If your memory card has protected content (i.e. content such as songs or graphics with Digital Rights Management copywriting loaded from another device), they will not be accessible. You may need to reformat the memory card prior to using it with this device.

## Icon Glossary

The table below describes various display indicators or icons that appear on the phone's display screen.

Icon	Description
	Network signal strength (number of bars will vary)
	No network signal
	Battery empty
	New text message
	New email
	An alarm is set
	Ring profile in use
	Silent profile in use
	Calendar event with Alarm is set
	Bluetooth is active
	The browser is active
	Vibration mode
	Ring after Vibration mode

## Getting to know your phone

Icon	Description
	Ring and Vibration mode
	Speakerphone
	Call in Progress
	Voicemail
	Battery Full
	Battery Charging
	Airplane Mode
	Wi-Fi is connected





## Connecting to Networks and Devices

With Wi-Fi, you can use high-speed Internet access within the coverage of the wireless access point (AP).

Enjoy wireless Internet using Wi-Fi, without extra charges.

### Connect to Wi-Fi

1. From the Home screen, touch  then swipe the screen to the left and touch .
2. Drag  to the right to turn on Wi-Fi to connect to available Wi-Fi networks.
3. Choose the Wi-Fi network you want to connect to. If you see , you need to enter a password to connect.



#### NOTE

- If you are outside the Wi-Fi coverage area and choose 3G connection, additional charges may apply.
- If your phone goes into sleep mode when connected to Wi-Fi, the Wi-Fi connection is automatically disabled.
- In this case, if your phone has access to 3G data, it may connect to the 3G network automatically and additional charges may apply.
- Your phone supports WEP, WPA/WPA2-PSK security.
- If your Wi-Fi service provider or network administrator sets encryption for network security, enter the key into the pop-up window. If encryption is not set, this pop-up window is not shown. Obtain the key from your Wi-Fi service provider or network administrator.

# Connecting to Networks and Devices

## Connecting to Bluetooth Devices

### To turn Bluetooth on or off

1. From the Home screen, touch  then swipe the screen to the left and touch .
2. Drag  to the right or left to turn the function on or off.

### Pairing with a Bluetooth device

1. Access the Bluetooth menu and turn the Bluetooth function on.
2. Touch **Search New Device**.
3. Touch the device you want to pair with.
4. Depending on the type of device you will have to enter a passcode, verify matching passcodes, or the device will pair automatically.

### Changing your phone's name





1. Access the Bluetooth menu and turn the Bluetooth function on.
2. Touch **My Bluetooth Info**, then touch **My Device Name**.
3. Enter the desired name and touch **Set**.

### Making your phone visible to other devices



1. Access the Bluetooth menu and turn the Bluetooth function on.
2. Touch **My Bluetooth Info**, then touch **My Device Visibility**.
3. Set the desired option.

# General Functions



## Making a Call

1. Make sure your phone is powered on.
2. Touch  and enter a phone number using the dial pad. To edit a number, simply touch  to erase one digit at a time.
  - ▶ Touch and hold  to erase the entire number.
3. Touch the **Send Key**  to call the number. Or touch  on the touch pad.

## Dialing a Number from your Recent Calls

1. Touch the **Send Key**  and the most recent missed, dialed and received phone calls will be displayed.
2. Select the desired number.
3. Touch the **Send Key**  or touch .

## Making International Calls

1. When using the dial pad, touch and hold .
2. Enter the country code, area code and the phone number.
3. Touch the **Send Key**  to call the number. Or touch .

## Ending a Call

When you have finished a call, touch the **End Key** .

## General Functions









### Making a Call from the Contacts

You can store frequently called names and phone numbers in the SIM card as well as in your Contacts.

You can dial a number by simply selecting a name in the Contacts List and touching the **Send Key** .

### Answering a Call

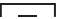
When you receive a call, the phone rings and the phone icon appears on the screen. If the caller can be identified, the caller's phone number (or name if stored in your Contacts) is displayed.

1. Touch the **Send Key** , touch , or swipe  in any direction. If Any Key has been set as the Answer Mode, you can also use the **Clear/Back Key**  to answer a call. However, the **End Key** , **Volume Keys**  and **Power/Lock Key**  cannot be used to answer a call.
2. End the call by touching the **End Key** . To decline a call, you can touch  or swipe  in any direction.

**NOTE:** You can answer a call while using other functions or features.

### Adjusting the Volume

If you want to adjust the earpiece volume during a call, use the Volume Keys of the phone. From the Home screen, you can adjust the ring volume using the Volume Keys.

## Setting Profiles

Press either of the Volume Keys to set a sound profile. You can adjust the ringtone volume from the Ringtone section and set your ringtone profile to Ring, Vibrate All, or Silent All.

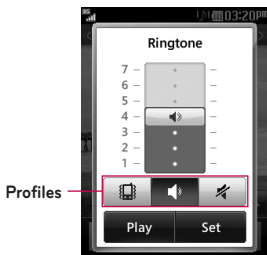

## Vibration Mode (Quick)

Vibration Mode can be activated by touching and holding **[\*#]** on the dial pad. You can also set Vibration Mode by pressing and holding the Volume Down Key from the Home screen.

The phone will display 'Vibrating Mode On!'. If you would like to turn Vibration mode off, touch and hold **[\*#]** again or press and hold the Volume Down Key.

## General Functions



### Signal Strength

If you are inside a building, being near a window may give you better reception. You can see the strength of your signal by the signal indicator on your phone's display screen.

### Entering Text

You can enter alphanumeric characters by using the phone's touch pad. The following text input modes are available on the phone.

### Changing Between Letters and Symbols/Numbers Mode

You can change the text input mode by touching  and  on the keyboard.

### Letters Mode





This mode allows you to enter letters by touching the key labeled with the required letter until the letter is displayed, depending on your input method settings. To change the input method, touch , then select **Input Method** and choose from **Keyboard** or **Keypad**.

### Symbols/Numbers Mode



This mode allows you to enter symbols and numbers. To change to symbols/numbers mode in a text entry field, touch .

## Using the T9 Predictive Text Input Mode

The T9 predictive text input mode allows you to enter words easily with a minimum number of key presses. As you touch each key, the phone begins to display the characters that it thinks you are typing based on a built-in dictionary. As new letters are added, the word changes to reflect the most likely candidate from the dictionary.

1. When you are in the T9 predictive text input mode, begin entering a word using the keypad. Touch one key per letter.
  - ▶ To enable the T9 predictive text input mode, touch  > **Text Entry Settings** > **Show Next Word**.
  - ▶ The word changes as letters are typed - ignore what is displayed on the screen until the word is typed completely.
  - ▶ If the word is still incorrect after typing completely, touch  to see the available options. Then select the word you want. (To display the word candidates, first you need to select the Show Candidate option. Touch  > **Text Entry Settings** > **Show Candidate**.)
  - ▶ If the desired word is missing from the word choices list, add it by touching  and selecting **Add Word** to enter the new word. Then touch **Save** to save the word into the built-in dictionary.
2. Enter the whole word before editing or deleting any letters.
3. Complete each word with a space by touching .



## General Functions

To delete letters, touch . Touch and hold  to erase the entire text entry.

**NOTE:** Touching the **End Key**  will save your unsaved message in the Drafts folder.

### Using the ABC Mode

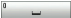
Use the touch pad keys to enter your text.

1. Touch the touch key labeled with the required letter, depending on your input method settings. To change the input method, touch , then select **Input Method** and choose from **Keyboard** or **Keypad**.
  - ▶ Using the Keypad, touch the desired letter until the letter is displayed.
  - ▶ Using the Keyboard, hold the phone horizontally and touch the desired letters.
2. To insert a space, touch . To delete letters, touch . Touch and hold  to erase the entire text entry.

**NOTE:** Refer to the table below for more information on the characters available using the Keypad input method.



## Available characters using Keypad

Key	Characters in order displayed	
	Upper Case	Lower Case
1	., '@?!-:/1	., '@?!-:/1
2	A B C 2	a b c 2
3	D E F 3	d e f 3
4	G H I 4	g h i 4
5	J K L 5	j k l 5
6	M N O 6	m n o 6
7	P Q R S 7	p q r s 7
8	T U V 8	t u v 8
9	W X Y Z 9	w x y z 9
0	Space Key, 0 (Long press)	Space Key, 0 (Long press)

## General Functions

### My Dictionary

The My Dictionary feature allows the user to add any unique or personal words to the standard language database. My Dictionary can be selected by touching  and selecting **Text Entry Settings**. Within the My Dictionary function, the user can add, modify, delete or reset personal words.



**NOTE:** You can select a different language from the same Options menu. By default, entry modes are set to off.

# Prepaid

For prepaid services, this menu provides shortcut access to the following items among others:

## Add Airtime

Allows you to add airtime.

1. From the Home screen, touch  > .
2. Enter airtime PIN and touch .
3. Read the displayed message, then select **Yes** or **No**.

## Buy Airtime

You can choose 4 types of Airtime.

## My Phone Number

Allows you to view the device's phone number.

## My Airtime (Balance) Info

Allows you to check your minutes, messages, data, and service end date.

## Airtime Display

Allows you to select if you want to display the Balance and/or Service End Date on the Home screen.

## Prepaid

### Serial Number

Serial Number simply displays the information of your phone's IMEI.

### SIM Number

This menu simply displays the information of your phone's Sim Number.

### Code Entry Mode

Code Entry Mode will allow the phone to accept TracFone-related codes in order to add units, modify specific data and troubleshoot the phone. In using the Code Entry Mode, you can't receive incoming calls or use events alert.

## In-Call Menu

Your phone provides a number of control functions that you can use during a call. To access these functions during a call, touch .



### During a Call

#### Making a Second Call

You can select a number you wish to dial, to make a second call.

Touch , enter the second phone number and touch .

or



Touch  to select a contact from your Contacts list and then touch .

#### Swapping Between Two Calls

Once the second call has been dialed (and answered), you can switch between the two on-going calls.



Touch the **Send Key**  or touch .

#### Answering an Incoming Call

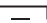

To answer an incoming call when the handset is ringing, simply touch the **Send Key**  or touch . The handset is also able to warn you of an incoming call while you are already on a call. Two tones will sound in the earpiece, and the display will show that a second call is waiting. This feature, known as Call Waiting, is only available if your network supports it. If Call Waiting is turned on, you can put the first call on hold and answer the second call by touching the **Send Key** .

## In-Call Menu

### Rejecting an Incoming Call

You can reject an incoming call without answering by simply touching the **End Key**  or touching .

### Muting the Microphone

You can mute the microphone during a call by touching . The handset can be unmuted by touching  again. When the handset is muted, the caller cannot hear you, but you can still hear the caller.

### Using the Speakerphone

You can use the integrated Speakerphone during a call by touching . The loudspeaker is automatically deactivated when you end the call.

#### **WARNING**

Due to increased volume levels, do not place the phone near your ear while the speakerphone is enabled.

## Your Home Screen

From the Home screen, you can access all menu options, make a quick call and view the status of your phone - as well as many other things.





### Touch Screen Tips

- ▶ The Home screen is also a great place to get accustomed to the touch screen.
- ▶ To select an item, touch the icon accurately.
- ▶ To scroll through lists, touch the last item visible and slide your finger up the screen. The list will move up so more items are visible.
- ▶ There's no need to press hard, the touchscreen is sensitive enough to pick up on a light yet firm touch.
- ▶ Use the tip of your finger to touch the desired option. Do not use your fingernail.
- ▶ When the screen light is off, press the **Power/Lock Key**  on the top side once to turn it on.
- ▶ Don't cover the phone with a case or cover as the touch screen will not work with any material covering it.

# Your Home Screen

## The Quick Keys

The Quick Keys on your Home screen provide easy, one-touch access to your most used functions.

	Touch to bring up the dial pad to make a call. Enter the number and touch <b>Call</b> or touch the <b>Send Key</b>  .
	Touch to open your contacts and search for the number you want to call. You can also create new contacts and edit existing ones.
	Touch to access the Messages menu. From here you can view and create messages.
	Touch to open the main menu. Swipe the screen to the left or right to view additional options.

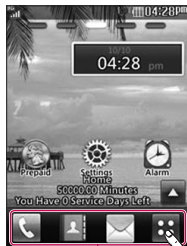

Quick Keys





## Home Screen

Your phone provides five Home screen panels. To view the Home screen panels, just swipe the screen from left to right and vice versa.

### Widget

You can use Widgets and even add them to your Home screen for a personalized feel.

1. Touch  at the bottom right corner of the Home screen to view the available options.
  2. Touch the **Widget** button.
  3. Drag a widget from the widget panel to the screen. Touch  to close the widget panel.
- ▶ You can play songs, add memos, check the calendar, play a slide show, set an alarm, set second city or add calendar events directly from the Home screen using the available widgets.



Widget panel

# Your Home Screen

## Favorite Contacts



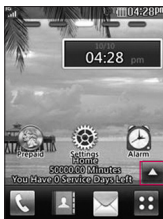

Allows you to easily contact your friends and family by displaying your favorite contacts on the Home screen.

1. Touch  at the bottom right corner of the Home screen, then touch the **Contact** button.



2. Touch the contacts you want to add, then touch  to register your favorite contacts.



- ▶ If you want to delete a contact from this screen, touch .
- 3. Touch  to finish editing the Contacts on this screen.
- ▶ To access your Contacts, simply touch their corresponding icon. Touch  to call,  to send a message and  to edit contact information.

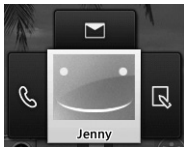

## Shortcuts

Add your favorite menus on the Home screen.

1. Touch  at the bottom right corner of the Home screen, then touch the **Shortcut** button.

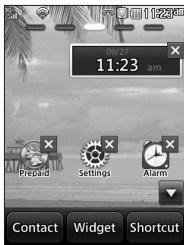

## Your Home Screen

2. Touch **+** next to the desired shortcut to add it to the Home screen.  
▶ If you want to delete a shortcut, touch **x**.
3. Touch **▾** to finish editing the shortcuts on this screen.

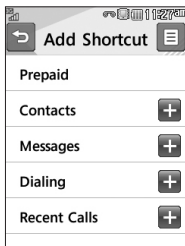

# Contacts

From the Home screen, touch  to open your Contacts list.

## Contact List

This menu allows you to save and manage contact information. You can add a new address or search saved contacts by name. To search for a contact, touch  and enter the contact's name. If you enter 'At', it will show all contacts that contain those letters in their names.

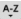

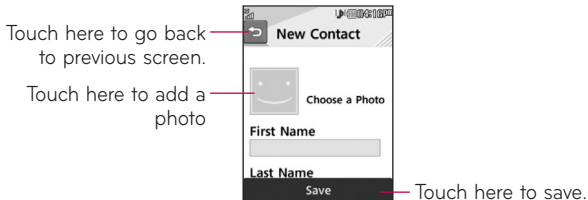

- ▶ : Search a contact.
- ▶ : Allows you to quickly jump to a contact name starting with a specific letter.

## Add New

This option allows you to add a new contact. You can enter contact information, including name, phone numbers, email addresses, group information, pictures, ringtone, memo and etc.





## Contacts

1. From the Home screen, touch  and touch **Add New**.
2. Touch  to set a Picture ID for a contact by using a saved picture or taking a new picture. Choose from **No Picture**, **Pictures** or **Take New Picture**. After you take a new picture, touch  to set it as the Contact Picture ID.
  - ▶ Enter the first name, last name or both.
  - ▶ Enter a phone number. Touch  so you can set that number as a Speed Dial. For more information, see the “**Speed Dial**” section.
  - ▶ Enter an email address.
  - ▶ Select a Group for the contact.
  - ▶ Set the ringtone for the contact or leave it as the default ringtone.
  - ▶ Add a memo if necessary.
  - ▶ Choose whether to save the contact to Phone or SIM Card memory.
3. Touch **Save** to save the contact.

## Groups



This menu allows you to manage group information. You can also configure a ringtone for phone group except SIM group so that the group ringtone sounds when a call from a specific contact address within that group is received and there is no ringtone configured for the specific contact address.

1. From the Home screen, touch  and touch .
2. A drop-down menu will appear. Touch **Groups**.

3. Touch **New Group** to create a new group. Or touch an existing group, then touch **Add Member** to add contacts to that group.

## Speed Dial

You can assign a frequently-called contact to a speed dial list. You can select a number from 2 to 9 as a speed dial.

1. From the Home screen, touch .
2. Touch **All Contacts** > **Speed Dial**.
3. Touch the desired Speed Dial location from 2 through 9 and select the contact.
  - ▶ Your Voicemail is already set to speed dial 1. This is a default setting and cannot be changed.
  - ▶ To call an assigned speed dial number, touch  from the Home screen. Then touch and hold the assigned number; the call will be placed to the assigned number automatically.

### To see your Speed Dial entries:

1. From the Home screen, touch  and touch **All Contacts**.
2. A drop-down menu will appear. Touch **Speed Dial**.

# Contacts

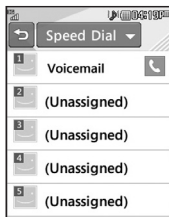



## SIM Management

This menu allows you to copy contacts from your SIM card to your handset. If a name is duplicated during the copying operation, the information is also duplicated.

You can also copy entries from the SIM card to the phone memory and vice versa (not all the data will be copied).

From this menu, you are also able to delete entries in the SIM card.

1. From the Home screen, touch  and touch .
2. A drop-down menu will appear. Touch **SIM Management**.
3. Choose from the following options: **Copy Contacts to SIM**, **Copy Contacts From SIM**, and **Delete Contacts From SIM**.

### WARNING



Changing your phone number can cause usability problems.



# Messages



This section includes functions related to text (SMS, Short Message Service) and multimedia (MMS, Multimedia Message Service) messages, Voicemail as well as the network's service messages.

## Create Message

1. From the Home screen, touch .
2. Touch .

## Editing a message

The following options are available when editing a message.

- ▶ **Symbol:** You can insert symbols ranging from punctuation to emoticons. Touch  twice to select the symbols you want. You can touch  and  to scroll through the various pages of symbols.

## Inserting Multimedia Files

Inserting multimedia files in outgoing messages is easy. While editing a message, touch  and select an option from below:

- ▶ **Picture:** Allows you to insert a picture.
- ▶ **Audio:** Allows you to insert audio files.
- ▶ **Video:** Allows you to insert video clips.
- ▶ **Slide:** Allows you to insert another slide.
- ▶ **Take New Picture:** Allows you to insert a new image taken from the camera.

# Messages



- ▶ **Record New Audio:** Allows you to record a new audio clip.
  - **Recording mode:** MMS mode will limit the recording length so that it can be sent by MMS. General mode will record as long as memory is available.
  - **Quality:** Allows you to select between **Normal**, **Economy** or **Fine**.
  - **Storage:** Allows you to save the recording to **External** memory or **Phone** memory.
- ▶ **Record New Video:** Allows you to record a new video.
- ▶ **More:** Allows you to insert **Template**, **vCard**, **vCalendar**, **vNote**, **vTask** or **Contact**.

**NOTE:** vCard, vCalendar, vNote, vTask and Contact are created by Contacts, Calendar, Notepad and Tasks functions. Go to the corresponding sections for more detailed information.

## Using Options

While entering a text message, touch  to use the options below.

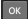
- **Input Method:** Allows you to select between **Keypad** and **Keyboard**.
- **Text Entry Settings**
  - **Languages:** Allows you to set the text entry language to English or Español.
  - **Show/Hide Candidate:** Allows you to display suggested words when using T9 mode.

- **Show/Hide Next Word:** Allows the phone to predict what the next word you will enter is using previously entered words.
  - **My Dictionary:** Allows you to add, edit, and delete words from your personalized dictionary.
  - **Copy & Paste:** Allows you to copy and paste text.
  - **Cancel Message:** Allows you to exit the message without saving it.
- If you complete input a message, touch  button. Then, touch  to choose an option from below.
- **Save to Drafts:** Saves the selected message to Drafts.
  - **Cancel Message:** Allows you to exit the message without saving it.

## Sending a Message

After completing a message, touch **Send To** to select recipients.

- Select the recipient(s). Touch  to choose an option from below.
  - **Enter Number:** Allows you to enter a phone number.
  - **Enter Email:** Allows you to enter an Email address instead of a phone number.
  - **Enter Recipient:** Allows you to enter recipients.
  - **Caller Groups:** Allows you to add contact groups.
  - **Recent Recipients:** Choose a contact from recent messages.
  - **Recent Calls:** Choose a contact from recent calls.
  - **Delivery Options:** Allows you to set Add Cc and Add Bcc.

## Messages

- **Save to Drafts:** Saves the message to Drafts.
- **Cancel Message:** Allows you to cancel the message.

### Message folders

The folder structure on your phone was designed to be fast and easy to use.

- ▶ **Inbox:** All the messages you receive are placed into your Inbox.
- ▶ **Drafts:** If you don't have time to finish writing a message, you can save it as a draft.
- ▶ **Outbox:** All currently sending and sent messages are placed into your Outbox.

**NOTE:** If you see the message "Message box full. Delete old messages," then you should delete some messages from your Inbox.

## Inbox

You will be notified when you receive a message. They will be stored in the Inbox. Each message can be identified by icons. Touch  for the options below.

- ▶ **Delete:** Allows you to delete messages.
- ▶ **Sort By:** You can sort all messages by Date, From, Read/Unread and Subject.
- ▶ **Message Settings:** Allows you to set messaging settings.
- ▶ **Delete All Read Msg:** Allows you to delete all read messages.

The following view modes are available for your Inbox.

### Standard View



Allows you to view messages individually. When viewing a message, the following options are available in standard view after touching :

- ▶ **Add to Contacts:** You can save the sender's phone number in the Contact List.
- ▶ **Select Slide:** If the multimedia message has more than one slide, you can select and move to the desired slide.
- ▶ **Extract Data:** You can make a voice call or send a message. You can save the number as a new contact or update an existing one.
- ▶ **View Attachment:** Allows you to view the message's attachments.



## Messages

- ▶ **Copy to SIM/Phone:** Allows you to copy the message to the SIM card or the phone.
- ▶ **Move to SIM/Phone:** Allows you to move the message to the SIM card or the phone.
- ▶ **Message Details:** You can view information about received messages; message Type, Subject, Sender's address, and message Time.

## Drafts

You can view the messages saved as drafts. To see the Drafts folder, touch  from the Home screen, then touch  and touch **Drafts** from the drop-down menu.

## Outbox

The Outbox is a place where you can find your sent messages. To see the Outbox folder, touch  from the Home screen, then touch  and touch **Outbox** from the drop-down menu.

When you touch the **Send Key**  you can make a call to the number of the recipient number of the selected message.

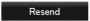
If a message is not successfully sent, you will receive a Message Sending Failure notification on the screen. In order to send the message that has failed, you must touch  to resend the message.



The Outbox will display all failed, sent and pending messages in the order in which they are sent. Touch  to use the options below.

- ▶ **Delete:** Deletes the selected message.
- ▶ **Sort by:** Sorts by Date, To and Subject.
- ▶ **Message Settings:** Allows you to set messaging settings.
- ▶ **Delete All:** Delete all messages.

The following options are available when you select a message in Outbox and touch .

- ▶ **View Status:** Shows the message status.
- ▶ **Edit:** Allows you to edit the message.
- ▶ **Copy to SIM/Phone:** Allows you to copy the message to the SIM card or the phone.
- ▶ **Move to SIM/Phone:** Allows you to move the message to the SIM card or the phone.
- ▶ **Select Slide:** If the multimedia message has more than one slide, you can select and move to the desired slide.
- ▶ **View Attachment:** To view the message attachment.
- ▶ **Message Details:** Allows you to view the message information.

## Message Settings

To configure Messaging settings, touch  from the Home screen, touch , then select **Message Settings** for the following options.

# Messages

## Message Alert

You can set the Sounds, Volume, Alert Type, and Alert Interval.

## Save To

Choose a default save location between Phone and SIM Card.

## Signature

This feature allows you to create your signature.

## Text Message

### ► Text Templates

There are 6 predefined messages in the list. You can view and edit the template messages or create new ones. These templates allow you to quickly respond to messages. To edit an existing Template, touch it (to open) then touch the text.

The following options are available when you touch .

- **Delete:** Allows you to delete the selected template message.
- **Delete All:** Deletes all text message templates in the folder.
- **Message Center Number:** The details for the Message Center are pre-loaded onto your phone and should not be changed.
- **Insert Signature:** Allows you to choose if you want to include the signature you created in your messages.



## Multimedia Message

▶ **Multimedia Templates:** Multimedia templates are available and can be created here.

## Voicemail Number

This menu allows you to set the voicemail center number if this feature is supported by your service provider.



## Service Message

You can set the Service option to determine whether or not you will receive service messages.

## Email

Email allows you to access your Yahoo! Mail, AOL Mail, AIM Mail, Windows Live Hotmail, Gmail and other provider accounts on your phone. So now you can quickly and easily check your email while you are away from your computer.

## To Set Up Email

▶ **Open Email:** From the Home screen, touch  and touch .



### ▶ Sign In

1. Touch the **Email Address** field, then type in your existing email address and touch **OK**.
2. Touch the **Password** field, enter your password, then touch **OK**.
3. Touch **Save**.



# Messages

## Sending an email using your account

To send/receive an email, you should set up an email account.

1. From the Home screen, touch  then touch  and choose the account you want to use.
2. Touch **New Email** to create a new email.
3. Enter the recipient's address in the **To** field and enter a subject in the **Subject** field.
4. Enter your message and touch **OK**.
5. Touch **Send** to send the email.

## Retrieving your email

1. From the Home screen, touch  then touch .
2. Touch the account you want to use.
3. Touch **Inbox**.
4. Touch  and touch **Update** to connect to your email account and retrieve your new messages.

## Message folders



From the Home screen, touch  then touch .

The account's folders will be displayed.

- ▶ **New Email:** Create a new message.
- ▶ **Inbox:** All the e-mails you receive are placed into your Inbox. From here you can reply, forward and more.

- ▶ **Drafts:** If you don't have time to finish writing a e-mail, you can save what you have written so far in here.
- ▶ **Outbox:** This is a temporary storage folder while e-mail are being sent or stores the messages that failed to send.
- ▶ **Sentbox:** Copies of all the e-mail you send are kept into your Sentbox folder.
- ▶ **Trash:** The e-mail you delete are placed into your Trash.

### Changing your email settings

1. From the Home screen, touch  , then touch  .
2. Touch  , then touch **Email Settings** to configure the following settings.
  - ▶ **Email Accounts:** Allows you to add or delete accounts and edit account server information.
  - ▶ **Default Email:** Choose which account to compose e-mail by default.
  - ▶ **Show Predictive Address List:** Choose whether or not to be shown your contacts when entering recipients.
  - ▶ **New Email Notification:** Choose whether or not to be alerted to new emails.
  - ▶ **Signature:** Create an email signature and turn this feature on and off.

# Multimedia

## Games & Apps

Allows you to download and play Java games and applications to your enjoyment.

To access Games & Apps from the Home screen, touch  and then .

## Facebook

Allows you to access Facebook and keep in touch with family and friends.

To access Facebook from the Home screen, touch  and then .

## Camera

From the Home screen, touch  and then  to access the Camera function.

### Take Photo

Using the camera module in your phone, you can take pictures of people or events while on the move. Additionally, you can send photos to other people in a picture message.

1. Open the **Camera** and center the subject in the viewfinder.
2. Touch  to take the picture.

## Getting to know the viewfinder

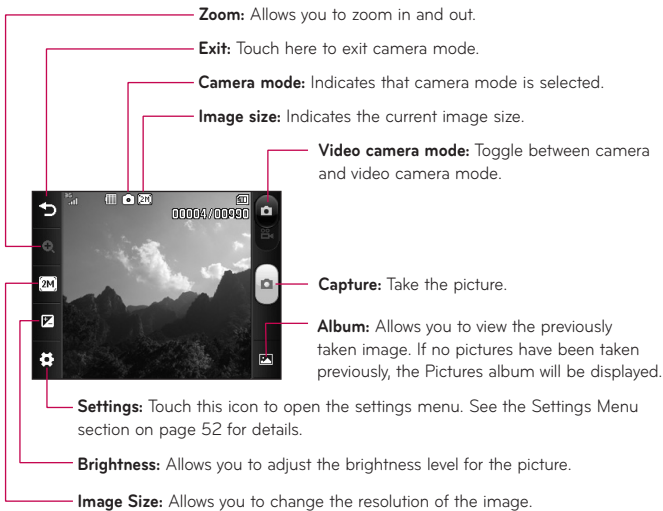

**NOTE:** To remove the options from the screen, or display them, simply touch the viewfinder.

# Multimedia

## Settings Menu



- ▶ **White Balance:** Choose between **Auto**, **Daylight**, **Cloudy**, **Illuminate** and **Indoors**.
- ▶ **Night Mode:** Allows you to set night mode **On** and **Off**.
- ▶ **Shot Mode:** Choose between **Normal** and **Continuous Shot**. This is great for taking photos of moving objects or at sporting events.
- ▶ **Color Effects:** Choose between **Color**, **Mono**, **Sepia**, **Negative**, and **Blue**.
- ▶ **Timer:** Set the timer to **Off**, **3 Seconds**, **5 Seconds**, or **10 Seconds**.
- ▶ **View Mode:** Choose between **Full Image** and **Full Screen**.
- ▶ **Image Review:** Choose if you want to display the image immediately after taking it.
- ▶ **Shutter Tones:** Allows you to select between 3 different tones or turn it off.
- ▶ **Primary Storage:** Choose to save a photo to **Phone Memory** or **Memory Card**.
- ▶ **Reset Settings:** Allows you to set to the default settings.

**NOTE:** You can adjust the zoom scale by moving the slider. The maximum zoom levels depend on the resolution as follows.

Resolution	Zoom scale
2M (1600x1200)	Level 1
1M (1280x960)	Level 1
VGA (640x480)	Level 1 ~ Level 10
QVGA (320x240)	Level 1 ~ Level 10

## Record Video

When recording video, you have many of the same Settings options as with taking a photo.

1. Open the **Video Camera** and center the subject in the viewfinder.
2. Touch  to start recording the video.
3. To pause the video, touch . To stop the recording, touch .

## Getting to know the viewfinder

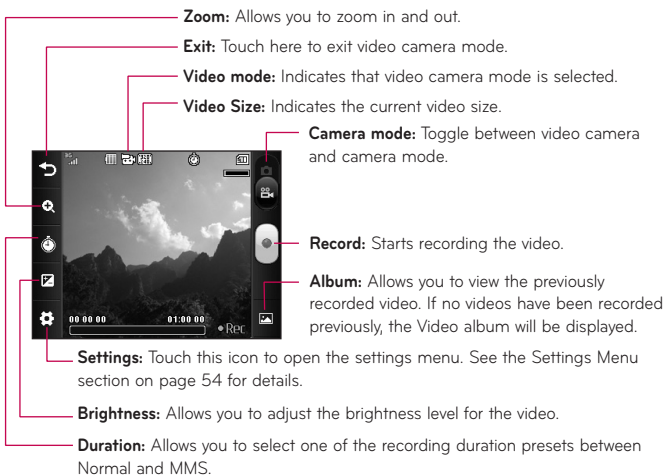

# Multimedia

## Settings Menu

- ▶ **White Balance:** Choose between **Auto**, **Daylight**, **Cloudy**, **Illuminate** and **Indoors**.
- ▶ **Color Effects:** Choose between **Color**, **Mono**, **Sepia**, **Negative** and **Blue**.
- ▶ **Video Size:** Sets the size of video to **QVGA (320x240)** and **QCIF (176x144)**. The selected size appears on the viewfinder screen.
- ▶ **Primary Storage:** Choose to save a video clip to **Phone Memory** or **Memory Card**.
- ▶ **Recording Tones:** Set Recording Tones **On** or **Off**.
- ▶ **Reset Settings:** Allows you to set to the default settings.

**NOTE:** You adjust the zoom scale by moving the slider. The maximum zoom levels depend on the resolution as follows.

Resolution	Zoom scale
QVGA (320x240)	Level 1 ~ Level 10
QCIF (176x144)	Level 1 ~ Level 10



# Music Player

## Music Player

To launch Music Player while in the Home screen, touch  and select .



- ▶ **Now Playing:** Shows the currently playing screen.
- ▶ **All Songs:** Allows you to view all the songs in your music library.
- ▶ **Playlists:** Allows you to view and create your own playlists.
- ▶ **Artist:** Allows you to view the list of artists of all the songs in your music library.
- ▶ **Album:** Allows you to view the list of albums of all the songs in your music library.
- ▶ **Genre:** Allows you to view the list of genres of all the songs in your music library.
- ▶ **Favorites:** Shows the music list set as your favorite music.
- ▶ **Shuffle:** Allows you to play all the songs in your music library with shuffle.

**NOTE:** Copyrights of music files may be protected by copyright and intellectual property laws. Please ensure that you adhere to the applicable Terms of Use of materials laws prior to downloading or copying files.





# Music Player

## Playing Music

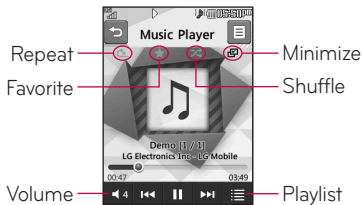
To listen to music in your phone or the external memory, follow these quick easy steps:

1. From the Home screen, touch  then open the Music Player by touching .
2. You can select from **All Songs**, **Playlists**, **Artist**, **Album**, **Genre**, **Favorites**, and **Shuffle** to play your music. The Now Playing button will only be available when music is playing.
3. Touch the song you wish to play.



- ▶ Touch  to pause the selected song. While playing, touch  to adjust the volume. Touch  and  to skip to the next song or previous song.
- ▶ Touch  to minimize the Music Player and access other phone functions while music is playing.



**NOTE:** Files under 300 kb may not be displayed in this function and may be categorized as Ringtones.

## Adding music to your phone

Music files can be added to your phone by using one or more of the following methods:

- ▶ Download ringtones over the network directly to your device via the Buy Ringtones link in the Audio menu.
- ▶ From your existing digital media collection on your PC via Windows Explorer.

## Purchasing and downloading ringtones directly to your phone

1. From the Home screen, touch  and then  to access the Audio menu.
2. Select **Buy Ringtone**.

**NOTE:** Some sites are data intensive (i.e. previews via streaming) so the user should be enrolled in an unlimited data plan before using these services to avoid per-use data charges. Additional charges may apply when downloading music, ringtones etc.

## Music Player

### Drag and drop music using your phone as a mass storage device

1. Make sure the microSD™ card is inserted properly into the phone.
2. Connect the phone to a PC using a USB data cable.
3. Your computer will detect and install the phone automatically.
4. Touch **OK** when the prompted on the device and access **My Computer** on the PC.
5. The phone's memory card will be listed under "Removable Disk" in the same location as an optical drive.

**NOTE:** The PC will automatically assign a drive letter.

6. Browse in a new window for desired music files.
7. Drag and drop the desired music content from the PC window to the "Removable Disk" window.
8. Touch **Exit** on the phone and disconnect the USB cable.



## Deleting Music Files

The following are the three options available to delete music from your phone:

- Delete a file using Mass Storage.
- Delete a file by directly inserting the microSD™ external memory onto the PC.
- Delete a file using delete function on the phone.

**NOTE:** If you delete a playlist from the phone, the songs in the playlist will not be removed and remain in All Songs folder.

Be aware that all of the existing data will be erased on microSD™ card if you use the below process.

- Use the Reset Memory Card function in the Settings menu (  >  > **Phone > Reset Settings > Master Clear > Memory Card** ).
- Format external memory using Mass Storage.

# Utilities

## Audio

From the Home screen, touch  and then  to access the Audio menu.

- ▶ **Buy Ringtones:** Allows you to buy ringtones for your phone.
- ▶ **Voice Recorder:** Allows you to record your own audio.
- ▶ A list of your audio files is listed.

## Pictures

From the Home screen, touch  and then  to access the Pictures menu.

- ▶ **Buy Graphics:** Allows you to buy graphics for your phone.
- ▶ **Take Picture:** Starts up the camera and allows you to take pictures.
- ▶ A list of your image files is listed.



## Video

From the Home screen, touch  and then  to access the Video menu.

- ▶ **Record Video:** Starts up the video camera and allows you to record videos.
- ▶ A list of your video files is listed.

**NOTE:** DRM sometimes restricts some functions, such as sending to others.

## Voice Recorder

Use the Voice Recorder to record voice memos or other sounds. From the Home screen, touch  and then  to access the Voice Recorder.

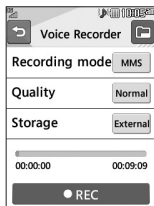





### ► Settings





- **Recording Mode:** MMS mode shortens the time so that the recording can fit in an MMS message and General mode provides longer recording time.
- **Quality:** You can assign the default quality to the **Normal**, **Economy** or **Fine**.
- **Storage:** Allows you to save the recording to **External** memory or **Phone** memory.

## Utilities

### Recording a voice memo

- ▶ Touch  to start recording.
- ▶ Touch  to pause recording. To continue recording, touch .
- ▶ To stop recording, touch . The recording will be saved automatically.





- ▶ To start a new recording, touch .
- ▶ To play the recording, touch .
- ▶ To send the recording by Message or Bluetooth, touch  or .
- ▶ To delete the recording, touch , then touch **Yes** to confirm.

### Calendar

When you enter this menu, a calendar will be displayed. The blue square cursor is used to locate a particular day. The day highlighted in green indicates today's date. Days highlighted in yellow indicate that events exist on those days. The phone will sound an alarm tone if it has been set for a specific schedule item.





From the Home screen, touch  then touch  to access the Calendar. The following options are available when you open the Calendar function and touch .

- ▶ **New Schedule:** Allows you to add a new schedule on the date you select.
- ▶ **Search:** Allows you to search the saved schedule(s).
- ▶ **Set Holiday:** Allows you to set your personal holiday for the selected date.
- ▶ **View All:** Allows you to view all saved schedules.
- ▶ **Week View:** Allows you to change Calendar view mode from Month View to Week View and vice versa.
- ▶ **Go to Date:** Allows you to jump to a specific date.
- ▶ **Selective Delete:** Allows you to delete Old Schedules or All Schedules selectively.
- ▶ **Settings:** Allows you set Default View and Weekly Begin day.

## Notepad

You can create up to a maximum of 30 memos.

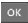

1. From the Home screen, touch  then touch  to access the Notepad.
2. To create a new note, touch **New Note**, enter the memo and touch  to save.

# Utilities

## Tasks

This feature allows you to save and manage a task.

### To add a New Task

1. From the Home screen, touch  then touch  to access Tasks.
2. Touch **New Task**.
3. Enter the **Due Date**, **Note** and **Priority** for the new Task.
4. Touch **Save** to save the Task item.

The following options are available by touching  in the main Tasks menu:

- ▶ **New Task:** Allows you to create a new task.
- ▶ **Delete:** Allows you to delete any tasks created.
- ▶ **Delete All:** Allows you to delete all tasks.
- ▶ **Send Task Via:** Allows you to send tasks via Multimedia Message, Email and Bluetooth.
- ▶ **Sort By:** Allows you to sort tasks by Date, Status, and Priority.
- ▶ **View Calendar:** Allows you to view the Calendar.

## Stopwatch

This menu allows you to record the elapsed time of an event. The duration of an individual lap time (up to 99 times) and the total time can also be displayed.

### ► **New Time**

1. From the Home screen, touch  >  or  >  >  to access the Stopwatch.

2. Select **New Time**.

3. To start timing, touch .

The running time is displayed as HH.MM.SS.hh (hours, minutes, seconds, hundredths of a second).

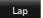
4. During the timing, you can record an individual lap time by touching . Up to 99 lap times can be recorded.

5. You can stop timing by touching  or restart by touching .

6. To reset the stop watch, touch .

► **Saved Times:** You can see the saved recorded times.

► **Show Last:** Displays the last time taken with the Stopwatch.

## Utilities

### Calculator

The calculator function allows you to calculate simple mathematical equations.



#### To access the Calculator

1. From the Home screen, touch  then touch  to access the Calculator.

### Tip Calculator

This feature allows you to quickly and easily calculate the tip amount based on the total bill as well as the split of the total bill based on the number of people.

#### To access Tip Calculator



1. From the Home screen, touch  then touch  to access the Tip Calculator.
2. Enter the **Total Bill (\$)**, **Tip (%)**, and **Split** quantities.
3. The **Tip (\$)** and **You Owe (\$)** fields will be automatically calculated.

### Unit Converter

This function converts any measurement into a unit you want.

There are 6 types of units that can be converted: Area, Length, Weight, Temperature, Volume and Velocity.





## To access Unit Converter

1. From the Home screen, touch  then touch  to access the Unit Converter.
2. Touch **Area** at the top of the screen and select an option from the drop-down menu.
3. Choose the known unit and enter the quantity.
4. The quantities below will automatically be calculated.

## Alarm

The alarm function allows you to set up multiple separate alarms. You can set the time, repetition interval and desired alarm tone.

### To set a New Alarm

1. From the Home screen, touch  then touch  to access the Alarm.
2. Select **New Alarm**.
3. Configure the following settings:
  - ▶ **Time:** Input your desired alarm time by specifying the hour and minutes. If the time is in the 12 hour format, you have to select either  or  by touching it. You can also choose a predefined amount of time (15 Minutes Later, 30 Minutes Later, 45 Minutes Later, 1 Hour Later, Off).
  - ▶ **Repeat:** Select the desired repeat mode from Once, Daily, Mon ~ Fri, Sat ~ Sun, Select Weekday, and Except Holiday.

## Utilities

- ▶ **Alarm Tone:** Select the desired alarm tone to use for the set alarm.
  - ▶ **Alarm Volume:** Allows you to adjust the alarm volume.
  - ▶ **Alarm Type:** Select the desired alarm type. Choose from Sound, Vibration, Sound and Vibration, and Vibration after Sound.
  - ▶ **Memo:** Enter the alarm name.
  - ▶ **Snooze Interval:** You can set the snooze interval at 5 Minutes, 15 Minutes, 30 Minutes, 45 Minutes, 1 Hour, or Off.
4. Touch **Save** to save your alarm.

### Quick alarm

In the Alarm menu, touch **Quick Alarm** to set a Quick Alarm.

1. Drag the bar from left to right to set the time; 60 minutes is maximum set value.
2. Scroll down to configure the options Alarm Tone, Alarm Volume, Alarm Type, Memo and Snooze Interval.
3. Touch **Save** to save the alarm.

### File Manager

From the Home screen, touch  then touch  to access the File Manager.

This allows you to view all types of contents files in the internal phone memory and the external memory card.

Touch  for the following options:

- ▶ **Send Via:** Send the selected file via Message, Email, or Bluetooth.
- ▶ **Delete:** Allows you to delete the selected file.
- ▶ **Move:** Allows you to move selected files to the Phone Memory or Memory Card.
- ▶ **Copy:** Allows you to copy selected files to the Phone Memory or Memory Card.
- ▶ **New Folder:** Allows you to create a new folder manually.
- ▶ **Sort By:** Allows you to sort the folders by name, date, and type.
- ▶ **Delete All:** Allows you to delete all files and folders.
- ▶ **Rename:** Allows you to edit the name of the selected file.



**NOTE:** Limits - System files/folders cannot be listed.

# Browser

This application connects you to the Internet. Browser is one of the services provided by TracFone and it gives you access to all the cool things you can do with your wireless phone.

**NOTE:** Check the availability of data services, pricing and tariffs with your network operator and/or the service provider whose service you wish to use. Service providers will also give you instructions on how to use their services. Please contact your service provider to open an Internet account.

## Launch the Browser

To launch the Browser from the Home screen, touch  then touch . Once connected, the homepage is displayed.

To exit the browser at any time, touch the **End Key** .

## Menus for the Browser

You can surf the Internet using either the phone keys or the Browser tool bar.

## Using the Browser Menu

### Online menu

Once you are connected to the Internet, the following menu options are available when you touch :

▶ **Home:** Moves to the initial homepage.



- ▶ **Windows:** You can have several browser windows to navigate different web pages at the same time.
- ▶ **Enter URL:** Connects to a specific URL.
- ▶ **Bookmarks:** You can add or save the current page to Bookmark or view the list saved under Bookmark.
- ▶ **Landscape View:** Allows you to view broad web pages easily in landscape view.
- ▶ **View Full Screen:** View the current page in full screen.
- ▶ **Search Text:** Allows you to find text in the current page.
- ▶ **Recent Pages:** Allows you to see a list of recently visited web pages.
- ▶ **Send URL:** Allows the current page URL via message to another person.
- ▶ **Settings:** Allow you to set options such as Cache, Cookie and other Browser Settings.
- ▶ **Browser Help:** Opens Help Overview to help make your browsing experience easier.
- ▶ **Exit:** Exits the browser.

# Settings

## Display

From the Home screen, touch  , and then **Display** to access the Display settings menu.

## Wallpapers

This menu allows you to set a picture or color as your background. You may also choose to have no background wallpaper.

## Fonts

You can configure the font size and color of the numbers which appear in the Dialing screen when you make a call. You can also set the font size for menus and lists.

## Brightness

You can set the brightness of the display screen.

## Backlight Timer

Use this to set the duration of the touch screen backlight and keypad.

## Transition Effect

If you set the transition effect, you can see the display change effect.

**NOTE:** When you set the **Settings > Accessibility > Menu Readout** on, then transition effect doesn't work.

## Phone

From the Home screen, touch  , and then **Phone** to access the Phone settings menu.

## Languages

You can change the language for the display text on your phone. This change will also affect the Language Input mode.

## Auto Screen Lock

This allows you to set the amount of time before your screen locks automatically.



## Pattern Lock

If you choose pattern lock, you have to draw pattern twice to confirm. Next, enter the security code.

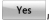
## Set Airplane Mode

This allows you to use only the phone's features that do not require the use of the wireless network when you are in an airplane or in places where the wireless network is prohibited. If you set the Airplane mode, you will be prompted to confirm your selection. After you confirm it by touching , the Airplane mode icon will be displayed on the screen instead of the network signal icon.

## Settings

- ▶  **ON:** You cannot make (or receive) any calls, including emergency calls or use other features that require network coverage.
- ▶  **OFF:** Deactivates Airplane mode and re-establishes your wireless connections.

## Security

Various codes and passwords are used to protect the features and settings of your phone. They are described in the following sections.

- ▶ **Phone Lock:** You can use a security code to avoid unauthorized use of the phone. If you set phone lock to **When Power On**, the phone will request a security code whenever you switch the phone on. If you set the phone lock to **Lock Phone Now**, your phone will lock immediately.
- ▶ **Change Codes:** The Change Codes menu allows you to change your current security code to a new one. You must enter the current security code before you can specify a new one.

## Memory

This menu allows you to view your memory information.

- ▶ **Used Space:** Displays the memory space used for Phone Common, Memory Card, Phone Reserved and SIM Card.
- ▶ **Set Storage Default:** Allows you to set the storage default locations for various types of features.

## Reset Settings

This function allows you to restore factory settings. To do this, you need the security code.

- ▶ **Master Reset:** Restores the settings (e.g.: Audio, Display, Language, Bluetooth Settings) stored in the phone memory to default values.
- ▶ **Master Clear:** Deletes downloaded or user created contents (e.g.: images, videos) from the phone and the external memory card.

### Phone

- Deletes all downloaded or user images, videos and sounds from the phone memory.
- Deletes personal information stored in the phone memory (e.g.: address book, messages, tasks, alarm, Calendar schedules) to default values.

**Memory Card:** Deletes all contents from the external memory card.

## Phone Information

This menu is used to view My Numbers, Manufacturer, Model Name, Device ID, Hardware Version, Software Version and Language.

# Settings

## Call





From the Home screen, touch  , and then **Call** to access the Call settings menu.

### Send My Number

This network service allows you to set your phone number to be displayed (**On**) or hidden (**Off**) from the person you are calling. You can select **Set by Network** if you prefer to have different settings for different service providers.

### Answer Mode

This allows you to determine how to answer the phone.

- ▶ **Any Key:** You can answer an incoming call by also using the **Clear/Back Key** . However, the **End Key** , **Volume Keys**  and **Power/Lock Key**  cannot be used to answer a call.
- ▶ **Send Key Only:** You can only answer an incoming call by touching the **Send Key** .

### Call Duration

You can check Last Call, Received Calls, Dialed Calls and All Calls.

### TTY

A TTY (also known as a TDD or Text Telephone) is a telecommunications phone that allows people who are deaf, hard of hearing, or who have speech or language disabilities, to communicate by telephone. Select from TTY Full, TTY Talk, TTY Hear, and TTY Off.

### ▶ **TTY Full**

Enables all TTY settings.

### ▶ **TTY Talk**

Enables VCO (Voice Carry Over).

### ▶ **TTY Hear**

Enables HCO (Hearing Carry Over).

### ▶ **TTY Off**

Disables all TTY settings

## Touch

From the Home screen, touch  , then touch **Touch** to access the Touch settings menu.

You can customize the Touch settings by setting the Touch Sound option. When you activate the Touch Sound option, you can choose your desired sound type and adjust its volume.

## Accessibility

This menu allows you to manage accessibility options.

- ▶ **Menu Readout:** If you activate this menu, selected menus will be read out loud.
- ▶ **Dial Readout:** If you activate this menu, the numbers you dial will be read out loud.

## Settings

- ▶ **Large Text:** If you activate this menu, a larger text font size will be displayed for menus.
- ▶ **Invert Color:** If you activate this menu, the phone's screen color will be inverted.
- ▶ **Mono Sound:** If you activate this menu, your phone's sound type changes to mono tone.
- ▶ **TTY:** Please refer to page 76 for more information.
- ▶ **Voice Command:** This menu allows you to adjust various settings for Voice Command.

## Sound Settings

From the Home screen, touch  and then  to access the Sound Settings menu.

### Ringtone

This menu allows you to adjust various settings for your ringtone.

- ▶ **Sounds:** Allows you to choose your ringtone. You can preview each ringtone before setting it.
- ▶ **Volume:** Allows you to adjust your ringtone volume.
- ▶ **Alert Type:** Supports 3 ring alert types: Ring, Ring and Vibration, and Ring after Vibration.



## Message Tone

This menu allows you to adjust various settings for your message tone.

- ▶ **Sounds:** Allows you to choose your message tone. You can preview each message tone before setting it.
- ▶ **Volume:** Allows you to adjust your new message alert tone volume.
- ▶ **Alert Type:** Supports 4 message alert types: Ring, Ring & Vibrate, Vibrate, and Silent.
- ▶ **Alert Interval:** Supports 5 message alert interval: Once, Every 2 Min., Every 5 Min., Every 10 Min. and Every 15 Min.

**NOTE:** Full length music tracks cannot be set as either ringtones or message tones.

## Alert Tone

This menu allows you to adjust various settings for your alert tone.

- ▶ **Sounds:** Allows you to select a set an alert tone. Supports 2 alert tone types: Alert Tone 1 and Alert Tone 2.
- ▶ **Volume:** Allows you to adjust your alert tone volume.
- ▶ **Alert Type:** You can select to set Alert Tones to Ring or Silent.

## Dial Readout

Slide  to the right to activate the dial readout function. When activated, the digits you enter when using the dial pad will be read out loud.

# Settings

## Keypad Tone

This menu option allows you to select a tone that the phone sounds when a key is pressed.

- ▶ **Sounds:** Allows you to select a set a keypad tone. Supports 3 keypad tone types: Tone 1, Tone 2 and Tone 3.
- ▶ **Volume:** Allows you to adjust your keypad tone volume.

## Multimedia

This menu allows you to adjust your multimedia volume.

## Call

This menu allows you to adjust your call volume.

## Bluetooth

From the Home screen, touch  and  to access the Bluetooth function settings menu.

Your phone has built-in Bluetooth® wireless technology, which makes it possible for you to connect your phone wirelessly to other Bluetooth® devices such as a hands-free device, PC, PDA, a remote screen or other phones. The devices registered in your phone can only be connected one at a time.

You can have a conversation via a cordless Bluetooth® hands-free phone or browse the Internet, wirelessly connected, via a mobile phone.

You can also exchange, for example, business cards, calendar items and pictures.

Music playing is supported through a Bluetooth® headset.

### **Hands-free profile**

This icon appears when the hands-free profile is used between the hands-free device. This allows you to call using a Bluetooth® connection.

### **A2DP profile**

This icon appears when the A2DP profile is used between the stereo headset device and the phone. This allows you to listen to an audio clip. A2DP is the Advanced Audio Distribution Profile, which provides support for streaming either mono or stereo audio using Bluetooth®.

### **Hands-free + A2DP profile**

This icon appears when both profiles of the hands-free and the A2DP are used between the compatible device and the phone. This allows you to call and listen to an audio clip using a Bluetooth® connection.

### **Object Push Profile**

This icon appears when you send one file(mp3, avi, jpg etc.) to other device.





When using each device, see the user manual that comes with the device.

## Settings

**NOTE:** We recommend that your phone and the Bluetooth® device you are communicating with should be no more than 10 meters apart. The connection may be improved if there are no solid objects between your phone and the other Bluetooth® device.

- ▶ **Bluetooth:** This menu allows you to turn Bluetooth on and off.
- ▶ **Search New Device:** This function allows you to search for and add new devices.
- ▶ **My Devices:** Allows you to view the list of all devices that are paired with your phone.
- ▶ **My Bluetooth Info:** Allows you to view information about your device's Bluetooth profile.
  - **My Device Visibility:** Allows you to set your device to visible so that other Bluetooth devices can find it. Choose from **My handset hidden** and **Visible for 3 Min.**
  - **My Device Name:** Allows you to change the phone's name so other Bluetooth devices trying to pair with you can easily find it.
  - **Supported Services:** Shows you all Bluetooth services that the phone supports.
  - **My Bluetooth Address:** Shows you the Bluetooth address of your device.

## To pair with another device

1. From the Home screen, touch  and then .
2. Make sure Bluetooth is on and touch **Search New Device** to search for the device you wish to pair.
3. If you want to stop searching, touch .
4. All of the devices found are displayed.
5. Touch the desired device. Depending on the type of device you will have to enter a passcode, verify matching passcodes, or the device will pair automatically. If you would like to search again, touch .

## Accessories

There are a variety of accessories available for your mobile phone, some of which may be sold separately. You can select these options according to your personal communication requirements. Consult your local dealer for availability.

### Travel Adapter

This adapter allows you to charge the battery.



### USB cable

This cable allows you to charge the battery.



### Battery

Standard battery is available.



### microSD™ Memory Card

4 GB  
microSD™  
memory card  
provided.



#### NOTE:

- ▶ Always use genuine LG accessories. Failure to do this may invalidate your warranty.
- ▶ Accessories may be different in different regions; please check with our regional service company or agent for further enquiries.

# Safety

**WARNING:** This product contains chemicals known to the State of California to cause cancer and birth defects or other reproductive harm.

***Wash hands after handling.***

## Part 15.19 statement

This device complies with part 15 of FCC rules. Operation is subject to the following two conditions:

(1) This device may not cause harmful interference, and (2) this device must accept any interference received, including interference that causes undesired operation.

## Bodily Contact During Operation

This device was tested for typical use with the back of the phone kept 0.59 inches (1.5 cm) from the body. To comply with FCC RF exposure requirements, a minimum separation distance of 0.59 inches (1.5 cm) must be maintained between the user's body and the back of the phone. Third-party belt-clips, holsters, and similar accessories containing metallic components may not be used. Avoid the use of accessories that cannot maintain 0.59 inches (1.5 cm) distance between the user's body and the back of the phone and have not been tested for compliance with FCC RF exposure limits.

## Consumer Information About Radio Frequency Emissions

Your wireless phone, which contains a radio transmitter and receiver, emits radio frequency energy during use. The following consumer information addresses commonly asked questions about the health effects of wireless phones.

### Are wireless phones safe?

Scientific research on the subject of wireless phones and radio frequency ("RF") energy has been conducted worldwide for many years, and continues. In the United States, the Food and Drug Administration ("FDA") and the Federal Communications Commission ("FCC") set policies and procedures for wireless phones. The FDA issued a website publication on health issues related to cell phone usage where it states, "The scientific community at large ...believes that the weight of scientific evidence does not show an association between exposure to radiofrequency (RF) from cell phones and adverse health outcomes. Still the scientific community does recommend conducting additional research to address gaps in knowledge. That research is being conducted around the world and FDA continues to monitor developments in this field. You can access the joint FDA/FCC website at <http://www.fda.gov> (under "c" in the subject index, select Cell Phones > Research). You can also contact the FDA toll-free at (888) 463-6332 or (888) INFO-FDA. In June 2000,

the FDA entered into a cooperative research and development agreement through which additional scientific research is being conducted. The FCC issued its own website publication stating that "there is no scientific evidence that proves that wireless phone usage can lead to cancer or a variety of other problems, including headaches, dizziness or memory loss." This publication is available at <http://www.fcc.gov/cgb/cellular.html> or through the FCC at (888) 225-5322 or (888) CALL-FCC.

### What does "SAR" mean?

In 1996, the FCC, working with the FDA, the U.S. Environmental Protection Agency, and other agencies, established RF exposure safety guidelines for wireless phones in the United States. Before a wireless phone model is available for sale to the public, it must be tested by the manufacturer and certified to the FCC that it does not exceed limits established by the FCC. One of these limits is expressed as a Specific Absorption Rate, or "SAR." SAR is a measure of the rate of absorption of RF energy in the body. Tests for SAR are conducted with the phone transmitting at its highest power level in all tested frequency bands. Since 1996, the FCC has required that the SAR of handheld wireless phones not exceed 1.6 watts per kilogram, averaged over one gram of tissue. Although the SAR is determined at the highest power level, the actual SAR value of a wireless phone while operating can be less than the reported SAR value. This is because the SAR value may vary from call to call, depending on factors such as proximity to

a cell site, the proximity of the phone to the body while in use, and the use of hands-free devices. For more information about SARs, see the FCC's OET Bulletins 56 and 65 at [http://www.fcc.gov/Bureaus/Engineering\\_Technology/Doc uments/bulletins](http://www.fcc.gov/Bureaus/Engineering_Technology/Doc%20uments/bulletins) or visit the Cellular Telecommunications Industry Association website at [http://www.ctia.org/consumer\\_info/index.cfm/AID/10371](http://www.ctia.org/consumer_info/index.cfm/AID/10371). You may also wish to contact the manufacturer of your phone.

### Can I minimize my RF exposure?

If you are concerned about RF, there are several simple steps you can take to minimize your RF exposure. You can, of course, reduce your talk time. You can place more distance between your body and the source of the RF, as the exposure level drops off dramatically with distance. The FDA/FCC website states that "hands-free kits can be used with wireless phones for convenience and comfort. These systems reduce the absorption of RF energy in the head because the phone, which is the source of the RF emissions, will not be placed against the head. On the other hand, if the phone is mounted against the waist or other part of the body during use, then that part of the body will absorb more RF energy. Wireless phones marketed in the U.S. are required to meet safety requirements regardless of whether they are used against the head or against the body. Either configuration should result in compliance with the safety limit." Also, if you use your wireless phone while in a car, you can use a phone with an antenna on the outside of the vehicle. You



should also read and follow your wireless phone manufacturer's instructions for the safe operation of your phone.

### **Do wireless phones pose any special risks to children?**

The FDA/FCC website states that "the scientific evidence does not show a danger to users of wireless communication devices, including children." The FDA/FCC website further states that "some groups sponsored by other national governments have advised that children be discouraged from using wireless phones at all". For example, the Stewart Report from the United Kingdom ["UK"] made such a recommendation in December 2000. In this report a group of independent experts noted that no evidence exists that using a cell phone causes brain tumors or other ill effects. [The UK's] recommendation to limit cell phone use by children was strictly precautionary; it was not based on scientific evidence that any health hazard exists. A copy of the UK's leaflet is available at <http://www.dh.gov.uk> (search "mobile"), or you can write to: NRPB, Chilton, Didcot, Oxon OX11 0RQ, United Kingdom. Copies of the UK's annual reports on mobile phones and RF are available online at [www.iegmp.org.uk](http://www.iegmp.org.uk) and <http://www.hpa.org.uk/radiation/> (search "mobile"). Parents who wish to reduce their children's RF exposure may choose to restrict their children's wireless phone use.

### **Where can I get further information about RF emissions?**

For further information, see the following additional resources (websites current as of April 2005):

#### **U.S. Food and Drug Administration**

FDA Consumer magazine November-December 2000 Telephone: (888) INFO-FDA <http://www.fda.gov> (Under "c" in the subject index, select Cell Phones > Research.)

#### **U.S. Federal Communications Commission**

445 12th Street, S.W. Washington, D.C. 20554 Telephone: (888) 225-5322 <http://www.fcc.gov/oet/rfsafety>

#### **Independent Expert Group on Mobile Phones**

<http://www.iegmp.org.uk>

#### **Royal Society of Canada Expert Panels on Potential Health Risks of Radio Frequency Fields from Wireless Telecommunication Devices**

283 Sparks Street Ottawa, Ontario K1R 7X9 Canada Telephone: (613) 991-6990 [http://www.rsc.ca/index.php?page=Expert\\_Panels\\_RF&Lang\\_id=120](http://www.rsc.ca/index.php?page=Expert_Panels_RF&Lang_id=120)

## World Health Organization

Avenue Appia 20  
1211 Geneva 27  
Switzerland  
Telephone: 011 41 22 791 21 11  
<http://www.who.int/mediacentre/factsheets/fs193/en/>

## International Commission on Non-Ionizing

Radiation Protection c/o Bundesamt für Strahlenschutz  
Ingolstaedter Landstr. 1  
85764 Oberschleissheim  
Germany  
Telephone: 011 49 1888 333 2156  
<http://www.icnirp.de>

## American National Standards Institute

1819 L Street, N.W., 6th Floor  
Washington, D.C. 20036  
Telephone: (202) 293-8020  
<http://www.ansi.org>

## National Council on Radiation Protection and Measurements

7910 Woodmont Avenue, Suite 800  
Bethesda, MD 20814-3095  
Telephone: (301) 657-2652  
<http://www.ncrponline.org>

## Engineering in Medicine and Biology Society, Committee on Man and Radiation (COMAR) of the Institute of Electrical and Electronics Engineers

<http://ewh.ieee.org/soc/embs/comar/>

## Consumer Information on SAR (Specific Absorption Rate)

This model phone meets the Government's requirements for exposure to radio waves. Your wireless phone is a radio transmitter and receiver. It is designed and manufactured not to exceed the emission limits for exposure to radiofrequency (RF) energy set by the Federal Communications Commission (FCC) of the U.S. Government. These FCC exposure limits are derived from the recommendations of two expert organizations, the National Counsel on Radiation Protection and Measurement (NCRP) and the Institute of Electrical and Electronics Engineers (IEEE). In both cases, the recommendations were developed by scientific and engineering experts drawn from industry, government, and academia after extensive reviews of the scientific literature related to the biological effects of RF energy.

The exposure limit for wireless mobile phones employs a unit of measurement known as the Specific Absorption Rate, or SAR. The SAR is a measure of the rate of absorption of RF energy by the human body expressed in units of watts per kilogram (W/kg). The FCC requires wireless phones to comply with a safety limit of 1.6 watts per kilogram (1.6 W/

kg). The FCC exposure limit incorporates a substantial margin of safety to give additional protection to the public and to account for any variations in measurements.

Tests for SAR are conducted using standard operating positions specified by the FCC with the phone transmitting at its highest certified power level in all tested frequency bands. Although SAR is determined at the highest certified power level, the actual SAR level of the phone while operating can be well below the maximum value. Because the phone is designed to operate at multiple power levels to use only the power required to reach the network, in general, the closer you are to a wireless base station antenna, the lower the power output.

Before a phone model is available for sale to the public, it must be tested and certified to the FCC that it does not exceed the limit established by the government adopted requirement for safe exposure. The tests are performed in positions and locations (e.g., at the ear and worn on the body) as required by the FCC for each model.

The FCC has granted an Equipment Authorization for this model phone with all reported SAR levels evaluated as in compliance with the FCC RF emission guidelines.

The highest SAR value for this model phone when tested for use at the ear is 1.12 W/kg and when worn on the body, as described in this user's manual, is 0.94 W/kg. While there may be differences between SAR levels of various phones and at various positions, they all meet the government requirement for

safe exposure.

SAR information on this model phone is on file with the FCC and can be found under the Display Grant section of <http://www.fcc.gov/oet/ea/fccid/> after searching on FCC ID ZNF306G.

To find information that pertains to a particular model phone, this site uses the phone FCC ID number which is usually printed somewhere on the case of the phone. Sometimes it may be necessary to remove the battery pack to find the number. Once you have the FCC ID number for a particular phone, follow the instructions on the website and it should provide values for typical or maximum SAR for a particular phone.

Additional information on Specific Absorption Rates (SAR) can be found on the Cellular Telecommunications Industry Association (CTIA) website at <http://www.ctia.org/>

\*In the United States and Canada, the SAR limit for mobile phones used by the public is 1.6 watts/kg (W/kg) averaged over one gram of tissue. The standard incorporates a substantial margin of safety to give additional protection for the public and to account for any variations in measurements.

## Part 15.105 statement

This equipment has been tested and found to comply with the limits for a class B digital device, pursuant to Part 15 of the FCC rules. These limits are designed to provide reasonable protection against harmful interference in a residential installation.

This equipment generates, uses, and can radiate radio frequency energy and, if not installed and used in accordance with the instructions, may cause harmful interference to radio communications. However, there is no guarantee that interference will not occur in a particular installation. If this equipment does cause harmful interference or television reception, which can be determined by turning the equipment off and on, the user is encouraged to try to correct the interference by one or more of the following measures:

- Reorient or relocate the receiving antenna.
- Increase the separation between the equipment and receiver.
- Connect the equipment into an outlet on a circuit different from that to which the receiver is connected.
- Consult the dealer or an experienced radio/TV technician for help.

\* Service not available everywhere.

\* Information subject to change.

## Part 15.21 statement

Changes or modifications that are not expressly approved by the manufacturer could void the user's authority to operate the equipment.

## Battery information and care

Always unplug the charger from the wall socket after the phone is fully charged to save unnecessary power consumption of the charger.