

# Party Speaker

User's Guide for Model PT860



## Important Safety Instructions

- Read these Instructions.
- Keep these Instructions.
- Heed all Warnings.
- Follow all instructions.
- Do not use this apparatus near water.
- Clean only with a dry cloth.
- Do not block any ventilation openings. Install in accordance with the manufacturer's instructions.
- Do not install near any heat sources such as radiators, heat registers, stoves, or other apparatus (including amplifiers) that produce heat.
- Do not defeat the safety purpose of the polarized or grounding-type plug. A polarized plug has two blades with one wider than the other. A grounding type plug has two blades and a third grounding prong. The wide blade or the third prong are provided for your safety. When the provided plug does not fit into your outlet, consult an electrician for replacement of the obsolete outlet.
- Protect the power cord from being walked on or pinched particularly at plugs, convenience receptacles, and the point where they exit from the apparatus.
- Only use attachments/accessories specified by the manufacturer.
- Unplug this apparatus during lightning storms or when unused for long periods of time.
- Refer all servicing to qualified service personnel. Servicing is required when the apparatus has been damaged in any way, such as power-supply cord or plug is damaged, liquid has been spilled or objects have fallen into the apparatus, the apparatus has been exposed to rain or moisture, does not operate normally, or has been dropped.
- Use only with a cart, stand, tripod, bracket, or table specified by the manufacturer, or sold with the apparatus. When a cart is used, use caution when moving the cart/apparatus combination to avoid injury from tip-over.



## FCC Warnings

Warning: Changes or modifications to this unit not expressly approved by the party responsible for compliance could void the user's authority to operate the equipment.

NOTE: This equipment has been tested and found to comply with the limits for a Class B digital device, pursuant to Part 15 of the FCC Rules. These limits are designed to provide reasonable protection against harmful interference in

a residential installation. This equipment generates, uses, and can radiate radio frequency energy and, if not installed and used in accordance with the instructions, may cause harmful interference to radio communications. However, there is no guarantee that interference will not occur in a particular installation. If this equipment does cause harmful interference to radio or television reception, which can be determined by turning the equipment off and on, the user is encouraged to try to correct the interference by one or more of the following measures:

- Reorient or relocate the receiving antenna.
- Increase the separation between the equipment and receiver.
- Connect the equipment into an outlet on a circuit different from that to which the receiver is connected.
- Consult the dealer or an experienced radio/TV technician for help.

## Additional Warnings and Precautions

- **CAUTION: TO PREVENT ELECTRIC SHOCK, MATCH WIDE BLADE OF PLUG TO WIDE SLOT, FULLY INSERT.**
- Mains plug is used as disconnect device and it should remain readily operable during intended use. In order to disconnect the apparatus from the mains completely, the mains plug should be disconnected from the mains socket outlet completely.
- **WARNING: Shock hazard - Do Not Open.**
- **CAUTION:** Use of controls or adjustments or performance of procedures other than those specified may result in hazardous radiation exposure.
- **WARNING:** Changes or modifications to this unit not expressly approved by the party responsible for compliance could void the user's authority to operate the equipment.
- **WARNING:** Do not place this unit directly onto furniture surfaces with any type of soft, porous, or sensitive finish. As with any rubber compound made with oils, the feet could cause marks or staining where the feet reside. We recommend using a protective barrier such as a cloth or a piece of glass between the unit and the surface to reduce the risk of damage and/or staining.
- **WARNING:** Do not ingest battery, chemical burn hazard.
- Battery shall not be exposed to excessive heat such as sunshine, fire or the like.
- Lithium batteries, like all rechargeable batteries, are recyclable and should be recycled or disposed of according to state and local guidelines. They should never be disposed of in normal household waste and they should never be incinerated, as they might explode. Contact your local government for disposal or recycling practices in your area.



**WARNING:** To reduce the risk of electric shock, do not remove cover (or back). No user-serviceable parts inside. Refer servicing to qualified service personnel.



The exclamation point within an equilateral triangle is intended to alert the user to the presence of important operating and maintenance (servicing) instructions in the literature accompanying the appliance.



The lightning flash with arrowhead symbol, within an equilateral triangle, is intended to alert the user to the presence of un-insulated "dangerous voltage" within the product's enclosure that may be of sufficient magnitude to constitute a risk of electric shock to persons.



This symbol indicates that this product incorporates double insulation between hazardous mains voltage and user accessible parts.



**WARNING:** This product can expose you to chemicals including lead, which is known to the State of California to cause cancer. For more information go to: [www.P65Warnings.ca.gov](http://www.P65Warnings.ca.gov) This product meets and complies with all Federal regulations.

## Overview

### Features

- Bluetooth wireless - range 60 ft.
- Voice prompts announce speaker functions
- Single 8" speaker and single 2" high pitch speaker
- Built-in amplifier
- LED display
- Digital FM radio
- 2x Microphone input
- 3.5mm Aux In
- USB port - supports MP3 file format
- USB port for mobile device charging (5V 1A)
- Built-in rechargeable battery
- Battery life: approx. 3 hrs playtime

### Includes

- 3.5mm audio cable (doubles as FM antenna)
- AC/DC power adapter (included) for internal battery recharge
- User's Guide

### Control Panel

1. **Battery Charge LED (red):** Light is solid when battery is charging, and Green when the battery is fully charged.
2. **Power ON/OFF:** Press and hold to power the speaker ON or OFF.
3. **USB Media Port**
4. **USB Power Port (5V 1A):** Charge devices.
5. **Aux In (3.5mm Audio Input)**
6. **Microphone Jacks:** When in use, the microphones will always be heard, regardless of the source input.
7. **DC Power Input:** Use to charge the internal battery and power the speaker.
8. **Bluetooth Indicator LED (blue):** Light will flash when connecting and turn solid when connected.
9. **Source:** Press to change audio source between Bluetooth, Line In, and FM.
10. **Mic Vol:** Press to adjust Microphone Volume (n), Echo (E), and Speaker Volume (v). Use the Volume buttons to adjust each setting.
11. **◀▶/10±/M±:** Short press to skip audio tracks (BLUETOOTH/USB) or radio presets (FM). Long press to scan for the next available FM radio station (FM). Long press and hold to skip 10 audio tracks (USB).
12. **Display:** Shows battery level, FM radio frequency or audio track info, and volume settings for the speaker and microphones.
13. **Pair/▶||:** Press and hold to begin pairing to a Bluetooth device (BLUETOOTH). Press to play or pause tracks (BLUETOOTH, USB).
14. **Scan:** Press and hold to scan FM radio stations and automatically save them as presets (FM).
15. **Equalizer:** Press to adjust between Pop, Classical, Jazz, Flat, and Rock.
16. **Volume:** Press to adjust the volume of the speaker or the volume of the microphones in Mic Vol settings.

### Lift Handle (rear view)

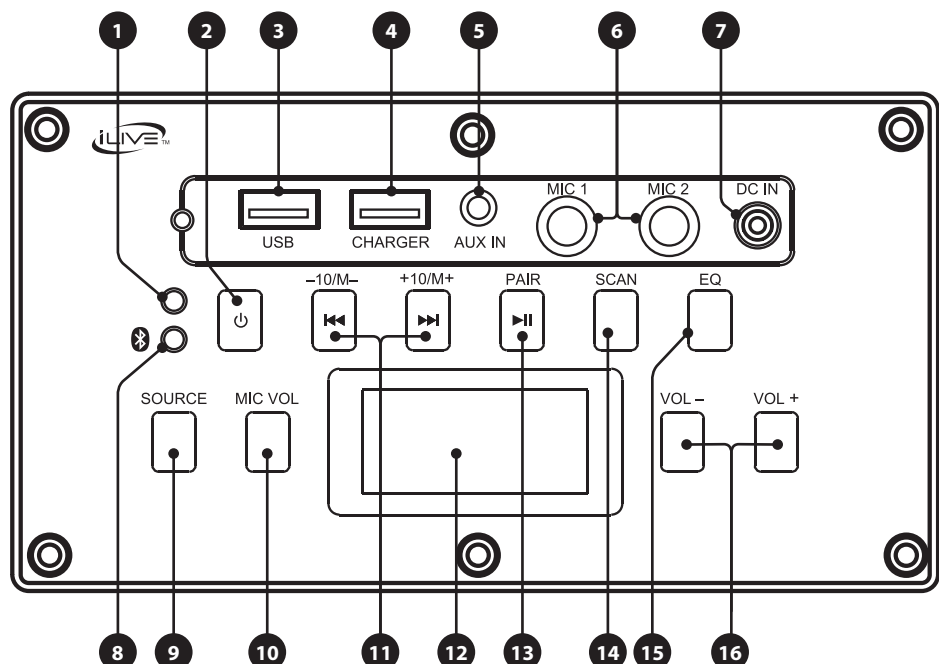
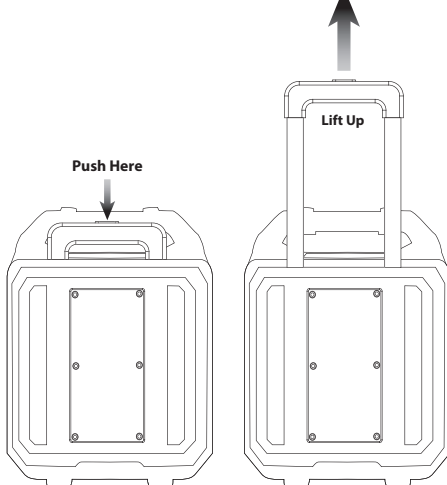

## Charging the Battery

To power the unit or charge the internal battery, plug the AC/DC power adapter into the DC Power Input on the speaker and a standard power outlet. **Battery life is approximately 3 hours.**

To charge mobile devices, use an appropriate USB charging cable (not included) to connect the USB charging plug on the unit and the device you wish to charge.

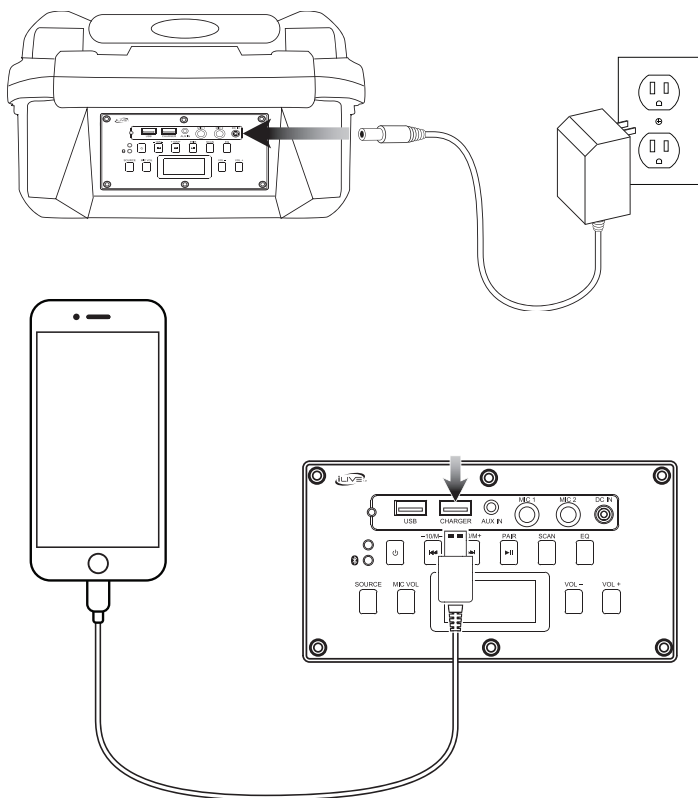

## Bluetooth Wireless

### Pairing & Playing Audio

After initial pairing, the unit will stay paired unless unpaired manually by the user or erased due to a reset of the device. If your device should become unpaired or you find it is unable to connect, repeat the steps listed here.

1. Press the **Source** button to select **Bluetooth Mode**. The **pairing indicator** will begin slowly flashing and a voice will announce "Bluetooth Mode".
2. Press and hold **▶||** to begin pairing. The **pairing indicator** will begin quickly flashing. *Remain within 3 feet of the unit.*
3. Using the controls on your Bluetooth device, scan for and select **ISB659** in your Bluetooth settings to pair. If your device requests a password, enter the default password **0000**. *Refer to the user's manual for your specific device for instructions on pairing and connecting Bluetooth devices.*
4. When successfully paired, the **pairing indicator** will turn solid, a voice will announce the connection, and an audible chime will sound from the unit.
5. Use the controls on the connected device to select and begin playing audio. Audio played through the connected Bluetooth device will now be heard through the speaker. Use the controls on the speaker or the connected device to play, pause, and adjust volume.

## USB

1. Load a USB drive into the USB Media port.
2. Press **Source** to switch to **USB Mode** ("USB" on the display).
3. Use the controls on the speaker to select and play audio from the connected drive.

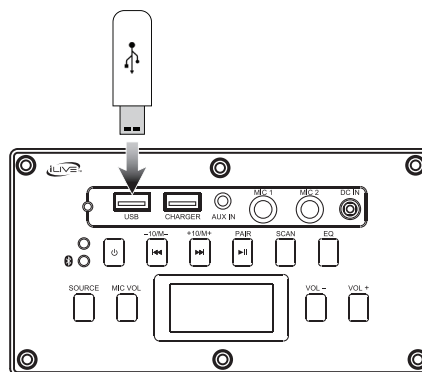

## Aux In

Requires a 3.5mm audio cable (included).

1. Connect a 3.5mm audio cable to the **Aux In** on the unit and the **audio output/headphone jack** on an audio device.
2. Press **Source** to switch to **Line In Mode** ("LINE" on the display).
3. Use the controls on the connected device to select and play audio.

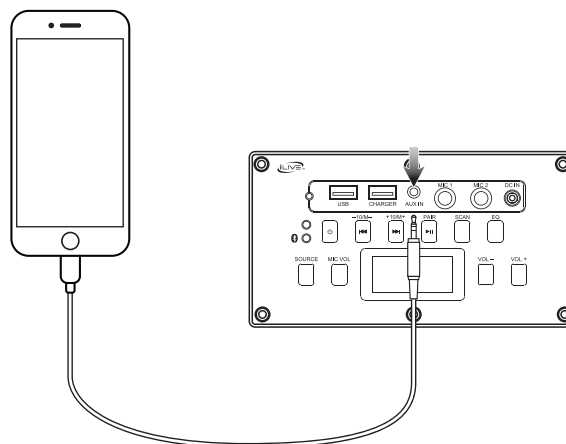

## FM Radio

### Radio Reception and the 3.5mm Audio Cable

An FM receiver is built into the speaker but functions best when a 3.5mm audio cable (included) is connected to the speaker. Adjust the position of the cable and the speaker to improve FM radio reception.

### Radio Tuning and Saving Station Presets

1. Press the **Source** button to switch to **FM Radio Mode**. *The display will show the station frequency, Ex: 101.1.*
2. Press and hold **Scan** to scan and save radio stations automatically. Radio stations will be assigned a "Pxx" number.
3. Press and hold **◀◀ ▶▶** to tune the frequency manually.

## Customer Support

To download this User's Guide in English, Spanish, or French, or to get answers to frequently asked questions, visit the support section at: [www.iLiveElectronics.com](http://www.iLiveElectronics.com)

Para descargar este Manual del Usuario en inglés, español y francés, o para obtener respuestas a preguntas frecuentes, visite la sección de apoyo en: [www.iLiveElectronics.com](http://www.iLiveElectronics.com)

Pour télécharger ce guide de l'utilisateur en anglais, espagnol ou français, ou pour obtenir des réponses à des questions fréquemment posées, consultez la rubrique d'assistance sur: [www.iLiveElectronics.com](http://www.iLiveElectronics.com)

For Warranty Information and the most up-to-date version of this User's Guide, go to [www.iLiveElectronics.com](http://www.iLiveElectronics.com)

Customer Service: **1-888-999-4215** | Email Support: [prodinfo@dpiinc.com](mailto:prodinfo@dpiinc.com) | Email Parts: [partsinfo@dpiinc.com](mailto:partsinfo@dpiinc.com)

Copyright © 2018 Digital Products International (DPI, Inc.) All other trademarks appearing herein are the property of their respective owners. Specifications are subject to change without notice.



FCC ID: ZJP-RD0605

Changes or modifications not expressly approved by the party responsible for compliance could void the user's authority to operate the equipment.

This device complies with Part 15 of the FCC Rules. Operation is subject to the following two conditions: (1) this device may not cause harmful interference, and (2) this device must accept any interference received, including interference that may cause undesired operation.

This equipment has been tested and found to comply with the limits for a Class B digital device, pursuant to Part 15 of the FCC Rules. These limits are designed to provide reasonable protection against harmful interference in a residential installation. This equipment generates, uses and can radiate radio frequency energy and, if not installed and used in accordance with the instructions, may cause harmful interference to radio communications. However, there is no guarantee that interference will not occur in a particular installation.

If this equipment does cause harmful interference to radio or television reception, which can be determined by turning the equipment off and on, the user is encouraged to try to correct the interference by one or more of the following measures:

- Reorient or relocate the receiving antenna.
- Increase the separation between the equipment and receiver.
- Connect the equipment into an outlet on a circuit different from that to which the receiver is connected.
- Consult the dealer or an experienced radio/TV technician for help.

This device complies with FCC RF radiation exposure limits set forth for an uncontrolled environment. This transmitter must not be co-located or operating in conjunction with any other antenna or transmitter