

Step 1: Activate Your Ethernet Tag Manager

Use the 12 digit serial numbers on your Ethernet Tag Manager to create a login. Keep the serial number in a safe place.

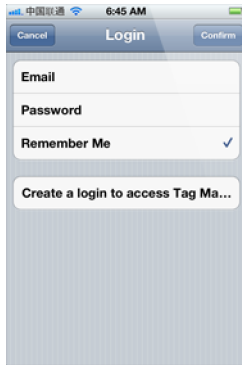

In the login screen, tap "Create a login to access Tag Manager" button.

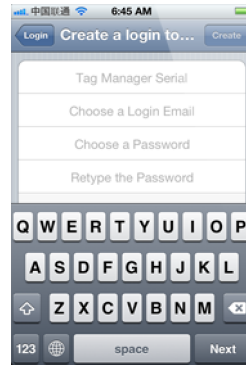

Fill in the serial number (case insensitive), login email (used to recover password), and choose a password.

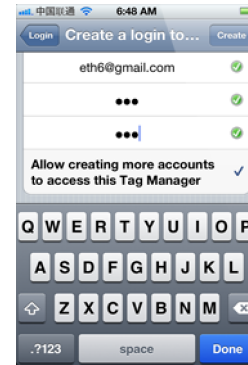

Tap "Create" button in the upper right corner to create an account. Uncheck "Allow creating more accounts..." unless you plan to create multiple logins to access the same Tag Manager.

Step 2: Associate New Wireless Sensor Tags (If Necessary)

If your Ethernet Tag Manager came with Wireless Sensor Tag(s) as a set, the Tags are already associated with the Tag Manager. In this case, you will see a list of tags immediately after Step 1, and you can skip this step.

If you purchased new Wireless Sensor Tags separately from the Tag Manager, follow this step to associate the new Tags with your Tag Manager.

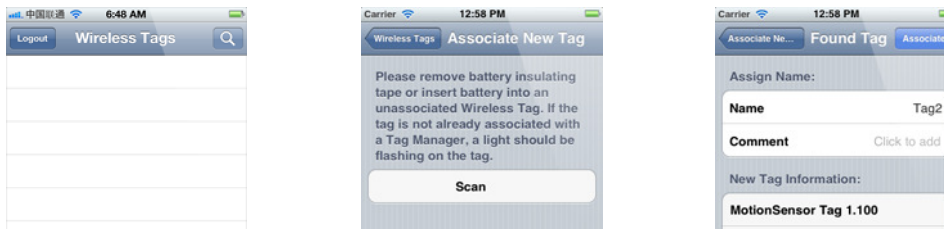
[Pictures](#)
[Demo \(iPhone\)](#)
[Demo \(iPad\)](#)

Step 3: Assign Tag Names and Pictures As Needed

You can edit tag names, comments and assign pictures to each Wireless Sensor Tag.



Tap the picture icon in each Tag's screen to bring up the camera, or delete the picture if you already have one for the tag.

Take the picture and use finger to move or scale.

The picture is now assign to the tag, and will be automatically visible on other devices accessing the same tag list in a few seconds.

[Assign Picture](#)
[Edit Name](#)
[Demo](#)

Step 4: Arm/Disarm Motion Sensor, Temperature Monitoring, or Out-of-Range Notification

Motion sensor, temperature monitoring, and out-of-range notification are turned off until they are needed to conserve battery. Follow the steps below to turn them on/off as needed.



Tap the tag of interest on the list screen to open the details screen, and tap the keypad icon at the bottom.

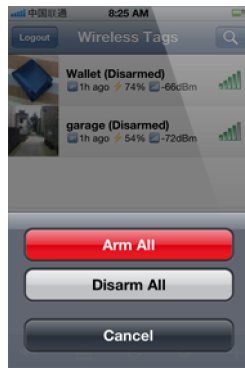

Instead of arming/disarming motion sensor for each tag individually, you can also tap the keypad icon in the tag list screen to arm/diarm all motion sensor tags.

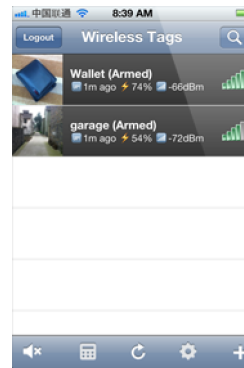

When motion sensor is armed, the tag on the list will have a black background.

- Motion Sensor
- Temperature Monitoring
- Out-of-Range Notification

Motion Sensor Options:

Sensitivity, Responsiveness, Notification Settings and Scheduling

Tune the sensitivity and responsiveness of the motion sensor to suit your application. In motion detection mode, choose to remember moved state indefinitely or reset to armed state after a while. In door/gate mode, choose the threshold angle (23 degree is recommended for automatic garage doors, 2~5 degree for regular doors), or choose to get notified only when door is opened for too long. Choose to get notified by emails, tweets, speech, or whether to make tag beep upon motion. Set the schedule to automatically arm or disarm the motion sensor at certain time of the day, and days of the week.

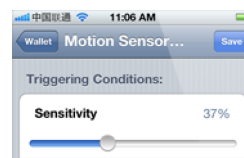
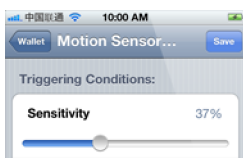

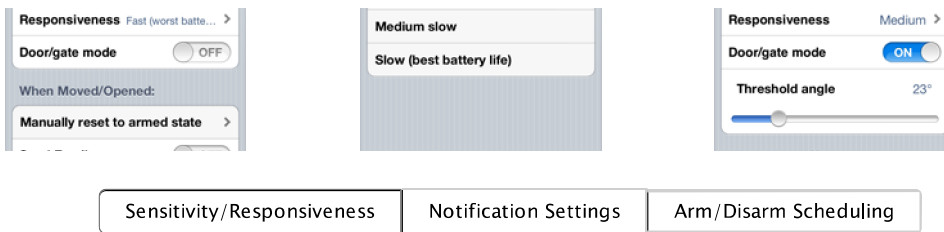

Sensitivity/Responsiveness Notification Settings Arm/Disarm Scheduling

Beeping a Tag, Stop Beeping, and Beep Options

Every wireless sensor tag has a beeping function to help you find missing tags. Attach the tag to key chains, put inside your wallet, or strap to TV remote controls, and never waste time looking for these items again.



In the tag list screen, tap on the tag you want to beep. The tag details screen opens.

Beep the tag by tapping on the speaker button at the upper right corner. To change beep options, scroll down until you see "Beep option". Tap on it to choose the option.

You can choose beep until moved, for 5,10,15,20,30 seconds, or indefinitely beep until stopped by the stop beep button at the bottom of the tag details screen.

Pictures Demo

Door Stats and Temperature Stats

Each tag automatically logs temperature and each time it is moved, opened or closed, so you can always check what happened while you were away.

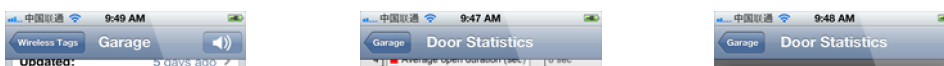

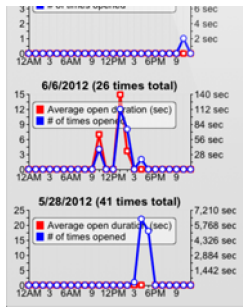
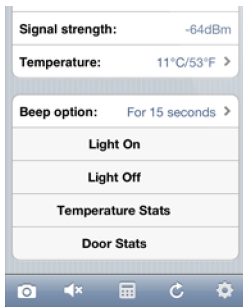

Time	Type	How Long
10:25 AM	Opened	2 minutes 16 seconds
10:29 AM	Opened	24 seconds
10:30 AM	Opened	25 seconds
10:32 AM	Opened	1 minutes 16 seconds
1:12 PM	Opened	18 minutes 10 seconds
1:31 PM	Opened	22 seconds
1:34 PM	Opened	17 seconds

In the tag detail screen, scroll down and tap on "Door Stats" button.

For every day in the last 2 months (when there is data available), number of times door is opened and average duration vs. time of the day are displayed.

When you tap on anywhere on the graph for a particular date, a detail history for that date is displayed. You can sort by time of the day, how long the door has been open, or event type (opened or moved)

