

BLUETOOTH CAR KIT
 WIRELESS BACK-UP CAMERA SYSTEM

Dear Customer
 CONGRATULATIONS: The system, when used as described, will give you years of dependable services in your car, truck, RV or minivan. We have taken numerous measures in quality control to ensure that your product arrives in top condition and will perform to your satisfaction.

Before You Start

SAFETY FIRST
 Completely read and understand all the instructions in this manual before using the system while operating a motor vehicle. All wireless devices are susceptible to interference or may cause interference, which could affect usability. If you are in an area where cell phone use is prohibited, or if it causes any interference of danger, switch your cell phone and the system to OFF mode. When using your cell phone with this unit, it will be secured at all times. When re-fueling always turn off your cell phone and the system. Do not use them near any fuel or chemicals. When pairing to any other devices, read and follow all instructions and safety guidelines provided by the manufacturer of the device. Do not pair it with incompatible devices

Features & Specifications

- Features:**
- Super light and thin-the thinnest and lightest Bluetooth rearview mirror car kit with monitoring camera on the market
 - Discreet-blends into your car’ s interior whilst providing wireless handsfree functionality and monitoring
 - Built-in microphone with DSP(Digital Signal Processing) noise and echo cancellation
 - Two speakers so you can hear callers loud and clear
 - High quality 3.5’ ’ TFT LCD color display caller’ s ID and name
 - Display outgoing call number
 - Report caller ID(language optional)
 - Sync with your mobile’ s phonebook (500 contacts)
 - Wireless backup camera, visual angle 120°, waterproof design
 - Camera color CMOS(CCD optional)
 - FM modulation to transfer voice and music to car radio(87. 5–108MHZ)
 - Wireless earphone
 - Play SD Card music

- Specifications:**
- Bluetooth Specification: Version 2.1
 - Support profiles: HSP/HFP1.5, A2DP, OPP
 - Camera range: 100 meters
 - Charging iuput voltage: DC5V, 1A



Controls

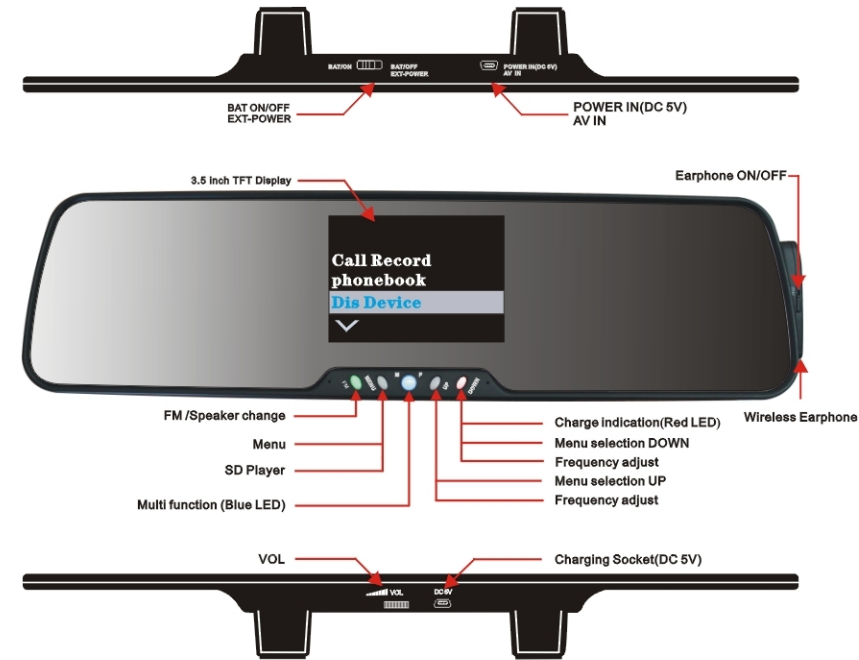



- 1: BUTTON (FM)**
 -Short press
 Change the FM frequency between (88.1 94.3 97.7 102.5 106.1 106.9MHZ)
 -Long press
 Switch between FM mode and Speaker mode
2: BUTTON (MENU)
 -Short press
 Enter/exit menu
3: BUTTON (MF)
 -Long press
 Play SD card music:
 - Display Title
 - The song array
 - Song name
 - Sort Press
 Long press again to off the SD player
4: BUTTON (DOWN)
 -Short press
 view bluetooth car kit work state
 -Long press
 Select the song Title
5: BUTTON (UP)
 -Short press
 View audio mode and increase frequency by 0.1MHZ when adjusting FM frequency
 -Long press
 Increase frequency by 1MHZ when adjusting FM frequency
6: EXTERNAL POWER AND AV INPUT SOCKET(POWER IN(DC 5V 1A) , AV IN)
7: ON/OFF SWITCH(BAT ON/OFF, EXT-POWER)
8: 3.5 INCH TFT DISPLAY
9: CHARGING SOCKET(DC 5V 1A)
10: VOLUME CONTROL (VOL)
11: WIRELESS EARPHONE
12: EARPHONE ON/OFF

Indicator Light

Blue Light: Bluetooth Car Kit work state (Connected/ Active/ Standby)
Red Light: Charging
Green Light: The parking monitor work state (Active/ Standby)

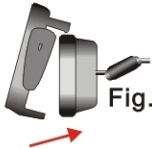
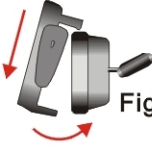
Main unit Installation

- 
Fig.1
 1、 Place the spring loaded top clips over the existing rear view mirror of the car. (Fig.1)
- 
Fig.2
 2、 Pull down the Car Kit and Media Player, extend the top clips, and then tilt the mirror towards the existing rear view mirror.(Fig.2)
- 
Fig.3
 3、 Let the spring loaded clips close around the mirror. Adjust the Car Kit and the Media player for the best rear view.(Fig.3)

Camera Installation

The reverse light sockets on most vehicles have two wires connected to them. Usually the negative wire is black and the positive wire is a colored wire. If you are uncertain about the wiring, you can use a 12 volt multimeter available at most auto parts stores to determine which is the positive wire. Follow the manufacturer’s instructions for the safe use of the multimeter.

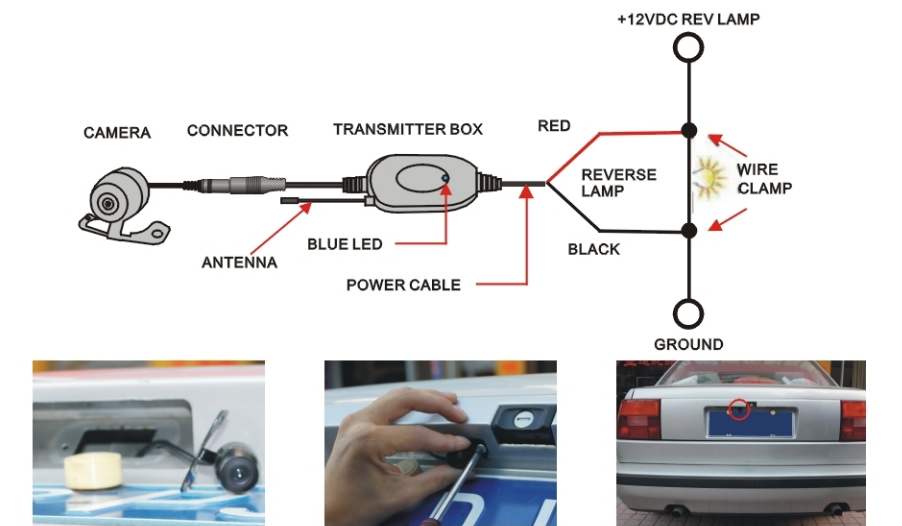

Turning On and Off

- Turning On**
 Move the ON/OFF Switch to the side BAT OFF.
- Turning On**
 Move the ON/OFF Switch to the side BAT ON.
- Using External Power**
 Move the ON/OFF Switch to the side EXT-POWER(Just BAT OFF) . Insert the small USB plug of the 5V DC adapter into the external power socket (POWER IN) and the 5V DC adapter into the 12V DC power port of the vehicle, and then the system works in external power mode. In this mode, the system works once the vehicle is launched.

Play SD card music

Long press the MF button to play SD card music: the screen will display The Title/the song array /song name. this time you can short press MF key to select the function .and short press up & down button to play next song. Long press MF button again to off the SD player. Long press the DOWN button to select the song Title

Pairing

- Prior to using the Bluetooth function of the system for the first time you must pair it with a Bluetooth enabled cell phone. The pairing procedure is different between models of cell phones. Please refer to the user manual of your cell phone for specific details on Bluetooth connectivity.**
- 1.Turn on the system. It enters pairing mode directly when it ends connecting last connected cell phone. The blue light flashes shortly.
 - 2.Activate your cell phone’ s Bluetooth function and search for Bluetooth devices. A list of enabled devices within range of the cell phone will be shown.
 - 3.Select your system. Enter passkey “0000” and press “OK” .
 - 4.Connect your system after paring is finished. When connected successfully, the system plays beep tone and your cell phone’ s name is displayed. In a few seconds, a Bluetooth logo is displayed on the right side of the LCD and the blue light flashes long.
- Once connected, it connects the last connected cell phone automatically every time when the system is turned on. If cell phone is disconnected, press MF once and the Bluetooth Car Kit also connects the last connected cell phone automatically.

Using the System

Using the Menu
 Press Menu Button to enter main menu. There are eleven menu items. Press Up Button or Down Button to browse up or down and press MF to implement the function of the selected menu item:

- 1. Call Record**
 Press Up Button or Down Button to browse up or down. Press MF shortly to dial the current selected number. If you want to exit browsing mode, press Menu Button to return to the main menu. Browsing can only be allowed in connected mode.
 If there’ s no call record number, the LCD displays “No Record” and then returns to the main interface.
- 2. Phonebook**
 Press Up Button or Down Button to browse up or down. Press MF shortly to dial the current selected number. If you want to exit browsing mode, press Menu Button to return to the main menu. Browsing can only be allowed in connected mode.
 If there’ s no contact, the LCD displays “No Phonebook” and then returns to the main interface.
- 3. Dis Device**
 Disconnect all devices connected with the system.
- 4. Download Phonebook**
 Make sure your cell phone is connected with the system before you implement the operation.
 - Download phonebook in cell phone to the system automatically. During downloading, the LCD displays both the name and the number. When downloading is finished, the LCD displays “Completed Total XXX” (XXX is contact number).

- To cancel the downloading operation, press and hold MF Button until the LCD displays “Canceled” and then displays “Completed Total XXX” . Some models of cell phones do not support downloading phonebook automatically and the system shows “Pls Send Pb” . Please refer to **Sending Phonebook**.

5. TTS Set

Press MF Button to select the language type of reporting caller ID. If “No TTS” is selected, the system plays beep. When there’s an incoming call, the caller number won’t be reported.

6. Delete Phonebook

Delete all contacts.

7. Delete Record

Delete all call record numbers.

8. Brightness

Press MF Button to see the brightness and press Up Button or Down Button to increase or reduce the brightness of LCD. After you finished adjusting brightness, press Menu Button to return to the main menu.

9. Play SD card music

Long press MF button to play SD card music.

The screen will display : * Title / The song array/ Song name

Long press MF button again to off SD player

10. Back

Return to the main interface.You can also return to the main interface by pressing Menu Button

Using Work Mode

There’re two work modes, PARK and AVIN. Press MF Button to set the mode in menu item Work Mode. You can also switch between PARK and AVIN by pressing and holding Park Button.

In PARK mode, the LCD displays reversing video .

In AVIN mode, the system plays external input AV, the LCD displays external input video and the speaker plays external input audio.

Selecting Audio Mode

There’re three audio modes, speaker mode, FM mode and earphone mode. See the current audio mode by pressing Up Button if you are not using menu. Press and hold Menu Button to switch between speaker mode and FM mode. Take off the earphone to use earphone mode in either speaker mode or FM mode.

1. Speaker Mode

Press and hold Menu Button to choose speaker mode. In speaker mode, the system plays audio via the two internal speakers.

2. FM Mode

You can use your car’s FM radio receiver speakers to listen to the audio the system plays.

- (1) Press and hold Menu Button to choose FM mode. The LCD displays “FM Mode” . The system will transmit the audio via FM.
- (2) Set the Car’s FM Receiver to any frequency and it can receive the audio transmitted from system.
- (3) To change the FM channel being used by the system, press the Up Button to see the FM frequency and then press Up Button or Down Button to increase or decrease frequency. In adjusting frequency mode, press and hold UP Button or DOWN Button to increase or decrease frequency more quickly.

3. Earphone Mode

To begin a conversation with the earphone :

- (1) Turn it on.
- (2) Remove the earphone from the main unit, the red light will be on.
- (3) Place the earphone’s speaker in your ear.

The LCD displays “Earphone Mode” .
To switch conversation from the earphone to FM or Internal Speaker Mode, just replace the earphone into the main unit. The LCD displays “Speaker Mode” or “FM Mode” .

NOTE: In earphone mode, the earphone and the main unit works normally only when the earphone is on. Once you turn on the earphone, you don’t need to turn it off even if you don’t use it. The earphone is turned off automatically when it’s placed into the main unit

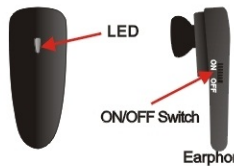

Answering a Call

When there is an incoming call, you will hear ring tone or number voice. The LCD displays either the number or the name of the calling person. Press MF once to accept the call or answer the call via your mobile phone in the normal way.

Rejecting a Call

Press MF twice quickly to reject the call or reject the call via your mobile phone in the normal way.

Ending a Call

Press MF once to end a call or end a call via your mobile phone in the normal way.

Adjusting the Volume

Use the Volume Control knob to adjust the volume.

Redialing the Last Dialed Number

Press MF twice quickly to redial the last dialed number.

Calling Back

In browsing call record mode, press MF shortly to dial the current selected number.

Dialing from the Contact

In browsing contact mode, press MF shortly to dial the current selected number.

Voice Dialing

Press MF shortly to activate the voice dialing function in connected mode. The LCD shows “Voice Dial” . Say the Voice Tag clearly and the call will be made. This function only works with cell phone equipped with voice dialing.

For voice dialing, you must record the voice tag (the person’s name) into your mobile phone before using the voice dialing function. Please refer to your mobile phone user guide on how to record the voice tag.

Sending Phonebook

1. Select “Send contact” in your cell phone and choose sending via Bluetooth.
2. Search the device, select the system in the searched devices and connect it. The number or name will be displayed on the LCD.
3. To browse the phonebook, enter menu item “Phonebook”

Troubleshooting

The system is compliant with, and adopts to the Bluetooth Specification 2.1. Compatability between the system and other Bluetooth enabled devices is not guaranteed. Compatability depends on the devices used.

1. If you are unable to connect your system to the cell phone, check and try the following ways:

- Reboot the system.
- Delete the pairing records on your cell phone and then search and pair again.
- Reboot your cell phone and start pairing again.

2. If you have connected your system to the cell phone, but do not hear anything, check and try the following ways :

- Ensure the volume of the cell phone and the system is not minimum.
- Your current location may not provide good call quality. Move to a location where there’s stronger radio signal and less interference.
- Your cell phone may work abnormally. Reboot your cell phone.

3. If caller ID cannot be displayed, check and try the following ways:

- Some telecom service providers do not support caller ID, especially international calls. In this case, the caller ID will not be displayed on your cell phone.
- The system is compliant with, and adopts to the Bluetooth Specification 2.1. Compatability between the system and other Bluetooth enabled devices is not guaranteed. Compatability depends on the devices used. For specific information on the compatability between the system and other Bluetooth enabled products, please check with manufacturer.

Note: Please note that it is possible that the system buttons might not operate according to the instructions in this user guide if your cell phone has an unusual wireless interface. In this case, please reset both the system and cell phone.

4. If you have downloaded or sent phonebook to the system, but caller name cannot be displayed, check and try the following ways:

- Ensure the caller ID has been displayed. If not, please refer to troubleshooting that caller ID cannot be displayed.
- Ensure the contact with the caller name exists in the phonebook of the system.

5. If your vehicle is in reverse gear, but the LCD doesn’t display reversing video:

- Ensure the system works in PARK mode by looking at the word on the upper right corner of the LCD.
- If the system works in PARK mode and displays “No Signal” , ensure the camera is installed normally.
- If the system doesn’t display “No Signal” , enter menu to see Park Mode menu item. If it’s Manual, press Park Button.

Care & Maintenance

- Do not expose your device to liquid, moisture and humidity as it is not waterproof.
- Do not use abrasive cleaners or solvents to clean the device.
- Do not expose the device to extremely high or low temperatures.
- Do not dispose the device in fire as it will result in an explosion.
- Do not disassemble the device as it does not contain serviceable components.

Safety Information

- Check local hands-free laws on using mobile phone and the system while driving. If you use the system while driving, ensure your full attention and focus. It is your responsibility to drive safely.
- The system not a toy, please keep children away from it. Small parts may be a choking hazard.
- Observe all signs that require an electronic device or RF Radio to be switched off in designated areas. These could include hospitals, blasting areas and potential explosive environments.
- Never leave the system above any airbag deployment area inside your car, as it may result in serious injury when an airbag deploys.

Warranty

The product are designed and manufacture to provide a high level of trouble-free performance. We warrants, to the original purchaser, that their products are free from defects in material and workmanship for 30 days from the date of original purchase. Becasuse it is impractical to publicize all changes in every product, we reserve the right to make such changes without notice.

- All repairs must be performed by us.
- The equipment must not have been altered or been damaged through negligence, accident, or improper operation.
- The replacement of parts are exempted from this warranty when replacement is necessary due to normal wear and tear.
- All warranty claims must be accompanied by a copy of the sales receipt or bill of sale.
- Repair or replacement parts supplied by us under this warranty are protected only for the unexpired portion of the original warranty.
- In the case of car stereos, this warranty does not extend to the elimination of car static or motor noise, correction of antenna problems, costs incurred in the removal or reinstallation of the product, damage to tapes, speakers, accessories or car electrical systems.

Warning

This device complies with part 15 of the FCC rules. Operation is subject to the following two conditions: (1) this device may not cause harmful interference, and (2) this device must accept any interference received, including interference that may cause undesired operation. NOTE: The manufacturer is not responsible for any radio or TV interference caused by unauthorized changes and modifications to this equipment. Such changes and modifications could void the user's authority to operate the equipment.

NOTE: This equipment has been tested and found to comply with the limits for a Class B digital device, pursuant to part 15 of the FCC Rules. These limits are designed to provide reasonable protection against harmful interference in a residential installation. This equipment generates uses and can radiate radio frequency energy and, if not installed and used in accordance with the instructions, may cause harmful interference to radio communications. However, there is no guarantee that interference will not occur in a particular installation.

If this equipment does cause harmful interference to radio or television reception, which can be determined by turning the equipment off and on, the user is encouraged to try to correct the interference by one or more of the following measures:

- Reorient or relocate the receiving antenna.
- Increase the separation between the equipment and receiver.
- Connect the equipment into an outlet on a circuit different from that to which the receiver is connected.
- Consult the dealer or an experienced radio/TV technician for help.

Optional Function

Photos of camera and radars mirror installation:



1. Horizontal distance



0. 3-0. 4m
Four sensors

2. Height

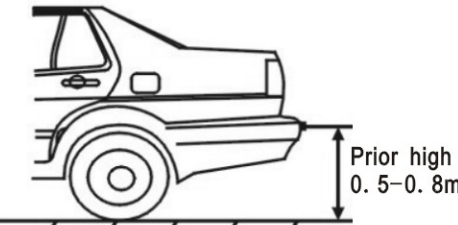

3. surface must be vertical and smooth

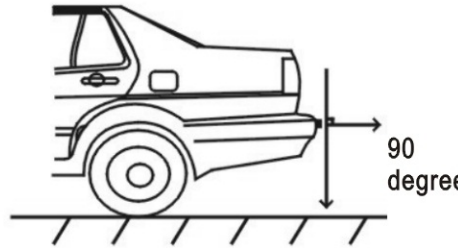

4. angle adjust of sensor

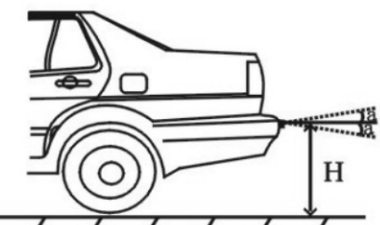

Connection method

As the follow figure, connet sensor A to channel A, sensor B to channel B and so on.

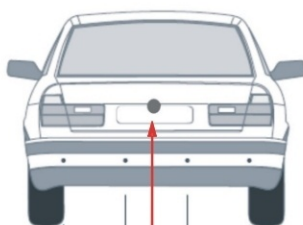

Wireless camera and radars rearview mirror, working theory is that use power from car back-light, while back-driving start camera and radar function, so the photos will be transferred via wirless trasnfer moduel to rearview mirror LCD screen, it automatically display image, so help driver to note the situation of road, easy installation and use conveniently.