



NT14W

USER GUIDE

14" Ultra Slim Laptop



Thank you for purchasing this EPIK Learning™ product.
For more information, or to learn about other EPIK Learning products,
please visit us at: www.epiklearning.com.

Introduction and Table of Contents

1.0 INTRODUCTION

This User Guide is designed to guide you through the key functions and features of your new Ultra Slim Laptop. Please read carefully to ensure an optimal user experience and keep it handy for future reference.

NOTE:

To change from English language prompts to Spanish language prompts, please go to “Control Panel,” then to “Clock, Language and Region,” and then to “Language” to change from English to Spanish.

1.1 TABLE OF CONTENTS

Page

| | |
|---|----|
| 1.0 Introduction..... | 1 |
| 1.1 Table of Contents | 2 |
| 1.2 Overview | 2 |
| 2.0 Appearance and Buttons..... | 3 |
| 2.1 Introduction to Desktop..... | 4 |
| 2.2 Windows Start Menu | 4 |
| 2.3 Introduction to App Interface | 4 |
| 3.0 Basic Operations..... | 6 |
| 3.1 Sleep, Restart and Shut Down | 6 |
| 3.2 Recovery..... | 6 |
| 3.3 Bluetooth..... | 7 |
| 3.4 Security Management | 8 |
| 4.0 Features | 9 |
| 5.0 Warranty Information | 10 |
| 6.0 More Epik Products | 12 |

Overview and Notes

1.2 OVERVIEW

The new 14" Epik Ultra Slim Laptop (ELL1401-BK) from EPIK Learning™ features Windows 10, a standard resolution screen of 1920 x 1080 and boasts a 1.8GHz Intel Charry Trail Quad Core Processor. With the Ultra Slim Laptop you can access the web, news, local business information and the Windows Store, where you can download your favorite apps, games, movies and more! With the built-in Bluetooth function you can seamlessly pair your Ultra Slim Laptop with any Bluetooth compatible devices. You can store all your important documents, pictures and movies with its 32 GB of memory. The storage capacity can also be expanded up to 160 GB using the Micro-Card Reader slot. The Epik Ultra Slim Laptop is your answer for a full-featured, all-in-one laptop.

NOTES

- The Epik Ultra Slim Laptop is a high-density electronic product. DO NOT attempt to disassemble the device.
- Please do not drop or bang the device.
- Avoid using this product in the following environments: Extremely hot or cold places, high humidity, dusty areas, direct sunlight or long-term exposure to the sun.
- The product may be cleaned with a damp cotton cloth; the use of any chemical cleaning fluid is prohibited. Please keep the product away from water at all times.
- If you use headphones, DO NOT use them while crossing the street, riding a bicycle or driving a motorcycle.
- Please use approved battery, battery charger and accessories only. The use of any other type of products would be a breach of warranty and may be dangerous.
- If you have any questions regarding the use of this product, please contact your local dealer or contact the Epik Learning customer service center directly at support@epiklearning.com or call (888) 999-1244.
- Epik Learning will not be held responsible for any files lost due to product damage, repair or other causes. Please be sure to follow instructions in the User Guide and backup your files in a timely manner.

Appearance and Buttons

2.0 APPEARANCE AND BUTTONS





- ❶ 1. USB Port
- ❷ 2. Headphone Jack
- ❸ 3. Micro SD Slot
- ❹ 4. DC Jack
- ❺ 5. USB Port
- ❻ 6. HDMI Port
- ❼ 7. Speakers
- ❽ 8. Camera
- ❾ 9. LCD
- ❿ 10. Mic
- ⓫ 11. Touch Pad
- ⓬ 12. Keyboard

Introduction to Desktop

2.1 INTRODUCTION TO THE DESKTOP

You must log on to your Microsoft account before the start up application can run.

2.2 WINDOWS START MENU

Press the key  on the keyboard or click the icon  on the screen until you see the Start Menu. All applications/programs are displayed in the form of “magnets” listed on the screen. Click on any of the icons to open.

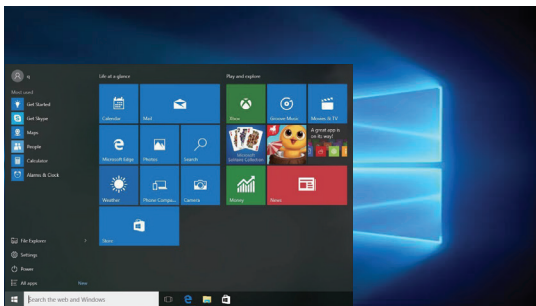

2.3 INTRODUCTION TO APP INTERFACE

If you want to pin more application programs on the Start interface, press and hold the application program for about one second, and release the magnet until the pop-up option appears and select “Pin to Start” to fix to the start screen, or just press and move to the start screen. (Screen 1).

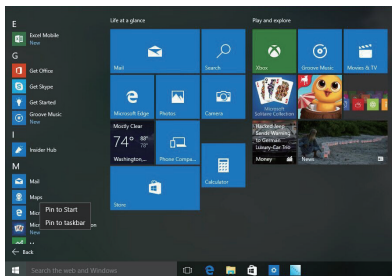

Introduction to Desktop (Cont'd)

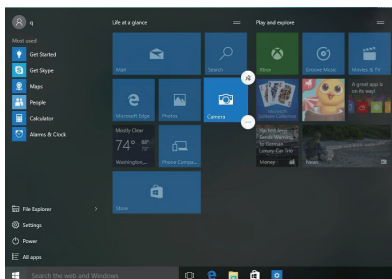

(Screen 1)



(Screen 2)

Conversely, if you want to cancel or delete a certain application in the Start screen, press and hold the application program magnet for about one second and click . You can also click  to check more menu options, such as resizing the magnet you want. (Screen 2) Slide it to the left from the right side of the screen to start Action Center to check the laptop status: Rotation lock, Bluetooth, Brightness, etc.

Basic Operations

3.0 BASIC OPERATIONS

3.1 Sleep, Restart and Shutdown

Force Reset / Shutdown

If the laptop freezes, you can press and hold the Power button for 8~12 seconds, then the laptop will shutdown.

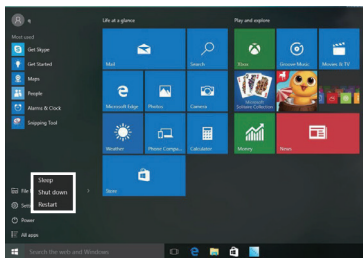

3.2 RECOVERY

Follow the steps below

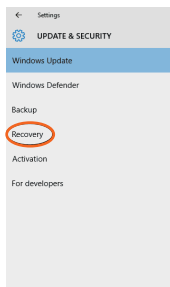
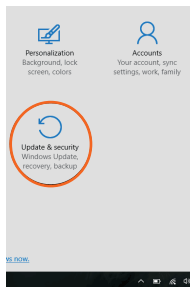
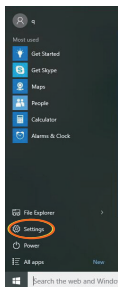

- Click the  button in the lower left corner of screen.
- Select “Settings”
- Select “Update & Security”, click on “Recovery”.





The program will walk you through simple steps necessary to recover your system.

Basic Operations (Cont'd)

3.3 BLUETOOTH

- Click the  button in the lower left corner of screen.
 - Select “Settings”
 - Select “Devices”, click on “Bluetooth”.
- a) Make sure the Bluetooth switch is set to “On”
After you turn on Bluetooth, the laptop will auto-search other devices you can pair with your device.

Send or Receive Files via Bluetooth

- b) Send a File: Before sending files, you should open the window, "Select where to send your files": Click the icon  at lower right corner of desktop -  - Send a File.
- c) Receive a File: Before receiving the files, you should open the window "Waiting for a connection": Click the icon  at lower right corner of desktop -  - Receive a File.

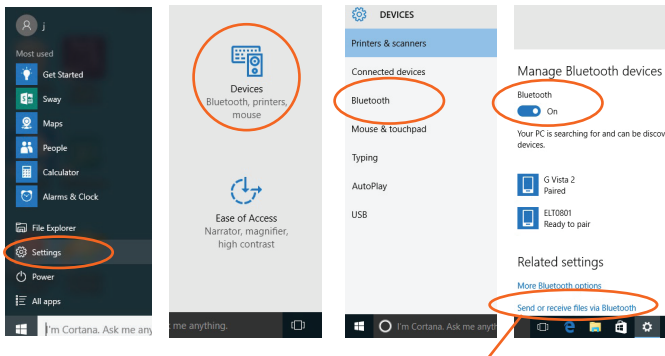

Send or Receive Files via Bluetooth



Basic Operations (Cont'd)

3.4 SECURITY MANAGEMENT

Method for quick setup:

Click the  button in the lower left corner of screen and select “Settings”.

Select “Accounts” on the right and click “Create local account” in “Your account” on the right side. After creating a user name and a password for Windows Live ID Account, input username, password, confirm password and password prompt.

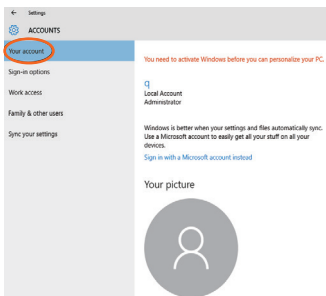
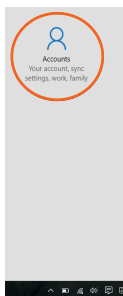
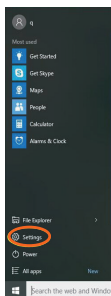

Features

4.0 FEATURES

| | |
|--------------------|--------------------|
| • Screen Size | 14" |
| • Resolution | 1920 x 1080 |
| • Panel Type | IPS - FULL HD |
| • Design | Clamshell |
| • Operating System | Windows 10 |
| • Processor | Intel Cherry Trail |
| • Processor | Quad Core |
| • Processor | 1.8 GHz |
| • Storage | 32GB |
| • Memory (RAM) | 2GB |
| • Expansion Slot | Micro SD |
| • Front camera | .3 MP |
| • Rear camera | n/a |
| • Battery | 10,000 mAH Lithium |
| • micro USB | n/a |
| • HDMI | 1 x micro |
| • USB 2.0 | 2 |

Items are included in your package:

- * Laptop
- * Power Adapter
- * Carrying Case
- * User Manual

Warranty

5.0 EPIK LIMITED WARRANTY

EPIK Learning stands behind its Products and proudly offers the following “Limited Warranty” policy: This Epik Learning branded Product, purchased and delivered new in the original package to the original purchaser, is warranted for personal use by EPIK Learning against manufacturing defects in materials and workmanship for a limited warranty period of Ninety (90) Days for Labor and One (1) Year hardware. However, the warranty on this Product is limited to a Ninety (90) day hardware and labor limited warranty for commercial use. EPIK Learning is not responsible for Software defects. Please refer to your Owner’s Manual for Software Provider contact information. This Limited Warranty does not apply to store display Products, Products sold as a “marked down” special, in “as is” condition, “close outs,” “liquidation and clearance sales”, “open box”, products missing accessories with no fault found or damaged at time of delivery to EPIK Learning authorized service center listed below. Proof of purchase in the form of a Bill of Sale, Receipt or Receipted Invoice is evidence the Product is within the limited warranty period. The Bill of Sale, Receipt or Receipted Invoice must be presented as a condition to obtaining the limited warranty service. This Limited Warranty begins on the original date of purchase, and is valid only on Products purchased through EPIK Learning authorized dealers and used in the United States, Canada and Puerto Rico by the original purchaser. To receive warranty service, the purchaser must contact EPIK Learning for problem determination and service procedures. Warranty service may only be performed by Epik Learning authorized service center. The original dated

bill of sale, receipt or receipted invoice must be presented upon request as proof of purchase. The EPIK Learning service center listed below will repair your Product or if repairs cannot be made, EPIK Learning will replace this Product at no charge with the same or similar Product. If the Product is defective as specified in this Limited Warranty during the Limited Warranty period, Epik Learning may use new or remanufactured hardware or products to repair or replace the Product with a similar Product at its sole discretion. All Products delivered to EPIK Learning for warranty service or replacement that EPIK Learning then determines to replace with the same or similar Products will become the sole property of Epik Learning. Replacement hardware and Products assume the remaining original Limited Warranty, or Ninety (90) days, whichever is longer. Product freight must be prepaid by original purchaser and shipped in either its original packaging or packaging affording an equal degree of protection. EPIK Learning shall not be responsible for or obligated to replace damaged goods. If the product is received damaged by The EPIK Learning service center, it is the responsibility of the consumer to file a claim against the carrier. The EPIK Learning service center will only store the damaged product for 30 days and reserves the right within its sole discretion, to dispose of the damaged product or ship it back to the consumer at consumer’s expense after 30 days. This Limited Warranty covers manufacturing defects in materials and workmanship encountered in normal, and except to the extent otherwise expressly provided for in this statement, noncommercial

use of this product, and shall not apply to the following: damage occurring in shipment; delivery and installation; applications and uses for which this product was not intended; altered product or serial numbers; cosmetic damage or exterior finish; accidents, abuse, neglect, fire, water, lightning or other acts of nature; use of products, equipment, systems, utilities, services, hardware, supplies, accessories, applications, installations, repairs, external wiring or connectors not supplied or authorized by EPIK Learning which damage this Product or result in service problems; incorrect electrical line voltage, fluctuations and surges; customer adjustments and failure to follow operating instructions, cleaning, maintenance and environmental instructions that are covered and prescribed in the instruction book; reception problems and distortion related to noise, echo, interference or other signal transmission and delivery problems; burned-in images. EPIK Learning does not warrant uninterrupted or error-free operation of the Product.

THERE ARE NO EXPRESS OR IMPLIED WARRANTIES OTHER THAN THOSE LISTED AND DESCRIBED ABOVE, AND NO WARRANTIES WHETHER EXPRESS OR IMPLIED, INCLUDING, BUT NOT LIMITED TO, ANY IMPLIED WARRANTIES OF MERCHANTABILITY OR FITNESS FOR A PARTICULAR PURPOSE, SHALL APPLY AFTER THE EXPRESS WARRANTY PERIODS STATED ABOVE, AND NO OTHER EXPRESS WARRANTY OR GUARANTY GIVEN BY ANY PERSON, FIRM OR CORPORATION WITH RESPECT TO THIS PRODUCT SHALL BE BINDING ON EPIK. REPAIR OR REPLACEMENT AS PROVIDED UNDER THIS LIMITED

WARRANTY IS THE EXCLUSIVE REMEDY OF THE CONSUMER. EPIK LEARNING SHALL NOT BE LIABLE FOR ANY INCIDENTAL, OR CONSEQUENTIAL DAMAGES FOR BREACH OF ANY EXPRESS OR IMPLIED WARRANTY ON THIS PRODUCT; EXCEPT TO THE EXTENT PROHIBITED BY APPLICABLE LAW, ANY IMPLIED WARRANTY OF MERCHANTABILITY OR FITNESS FOR A PARTICULAR PURPOSE ON THIS PRODUCT IS LIMITED FOR THE DURATION OF THIS LIMITED WARRANTY. THIS LIMITED WARRANTY SHALL NOT EXTEND TO ANYONE OTHER THAN THE ORIGINAL PURCHASER OF THIS PRODUCT, IS NONTRANSFERABLE AND STATES YOUR EXCLUSIVE REMEDY.

Some states do not allow limitations on how long an implied warranty lasts, or the exclusion or limitation of incidental or consequential damages, so the above limitations or exclusions may not apply to you. This warranty gives you specific legal rights, and you may also have other rights which vary from state to state. Any provision contained herein which is found contrary to state or local laws shall be deemed null and void and the remaining provisions shall continue in full force and effect. To obtain warranty service, please contact EPIK at:

support@epiklearning.com
or call (888) 999-1244.

More Epik Products

For more information, or to learn about other EPIK Learning products, please visit us at:
www.epiklearning.com.



EPIK Learning Tab Jr. 7" Screen

- 7" touch screen, 1024 x 600, TN panel, 16:9
- 1.2 GHZ - QUAD core processor
- 8GB storage with 1GB memory
- Front facing .3 MP with 2MP rear cameras



EPIK Learning Tab 7" Screen

- 7" touch screen, 1024 x 600, IPS panel, 16:9
- 1.2 GHZ Intel Sofia 3GR - QUAD core processor
- 16GB storage with 1GB memory
- Front facing .3 MP with 2MP rear cameras
- Up to 6 hours of battery life (3600 mAh battery)



EPIK Learning Tab 8" Screen

- 8" touchscreen, 800 x 1280, IPS panel, 16:9
- 1.2 GHZ Intel Sofia 3GR - QUAD core processor
- 16GB storage with 1GB memory
- Front facing .3 MP with 2MP rear cameras
- Up to 6 hours of battery life (4000 mAh battery)
- Water resistant



11

Epik Learning Tab Carrying Case

Carry your EPIK Learning Tab safely with this colorful Carrying Case.

This protective case features a padded device compartment with Velcro closure, handles and shoulder strap. Available in Blue and Pink.

More Epik Products

For more information, or to learn about other EPIK Learning products, please visit us at:
www.epiklearning.com.



EPIK Ultra Slim Laptop

- 10.1" Touch Screen, 1024 x 600, TN panel, 16:9
- Front facing .3 MP
- 8GB storage with 1GB memory
- Micro HDMI port, USB 2.0 port and USB 3.0 port
- Up to 10 hours of battery life



EPIK Learning Convertible Touchscreen Laptop

- 11.6" Touch Screen, 1366 x 768, TN panel, 16:9
- Convertible Design
- 1.8 GHZ Intel Cherry Trail - QUAD core processor
- 32GB storage with 2GB memory
- Expandable storage via micro SD card slot
- Front facing .3 MP and 2MP rear cameras
- Micro HDMI port, USB 2.0 port and USB 3.0 port
- Up to 10 hours of battery life once fully charged (10,000)



EPIK Ultra Slim Laptop

- 14" 1920 x 1080, IPS panel, 16:9 – Full HD
- Intel Atom:
- 1.8 GHZ Intel Cherry Trail - QUAD core processor
- 32GB storage with 2GB memory
- Bluetooth 4.0
- Front facing .3 MP VGA camera

FCC NOTE

This device complies with Part 15 of the FCC rules. Operation is subject to the following two conditions: 1) this device may not cause harmful interference, and 2) this device must accept any interference received, including interference that may cause undesired operation.

Note: This equipment has been tested and found to comply with the limits for a Class B digital device, pursuant to part 15 of the FCC Rules. These limits are designed to provide reasonable protection against harmful interference in a residential installation. This equipment generates, uses and can radiate radio frequency energy and, if not installed and used in accordance with the instructions, may cause harmful interference to radio communications. However, there is no guarantee that interference will not occur in a particular installation. If this equipment does cause harmful interference to radio or television reception, which can be determined by turning the equipment off and on, the user is encouraged to try to correct the interference by one or more of the following measures:

- Reorient or relocate the receiving antenna.
- Increase the separation between the equipment and receiver.
- Connect the equipment into an outlet on a circuit different from that to which the receiver is connected.
- Consult the dealer or an experienced radio/TV technician for help.

Changes or modifications not expressly approved by the party responsible for compliance could void the user's authority to operate the equipment.

