

ELL1103T

# TEQNO<sup>TM</sup>

## USER GUIDE

### Laptop



Designed by  
the EPIK Learning Company  
California, USA

[www.epiklearning.com](http://www.epiklearning.com)

# Introduction and Table of Contents

---

## 1 INTRODUCTION

Thank you for purchasing this TEQNIO™ Convertible Touchscreen Laptop. For more information, or to learn about other EPIK Learning Company products, please visit us at: [www.epiklearning.com](http://www.epiklearning.com)

This User Guide is designed to guide you through the key functions and features of your TEQNIO™ Convertible Touchscreen Laptop. Please read carefully to ensure an optimal user experience and keep it handy for future reference.

### NOTE:

To change from English language prompts to Spanish language prompts, please go to “Control Panel,” then to “Clock, Language and Region,” and then to “Language” to change from English to Spanish.

## 1.1 TABLE OF CONTENTS

### Page

1. Introduction.....	1
1.1 Table of Contents .....	2
1.2 Overview .....	3
2. Appearance and Buttons.....	3
2.1 Introduction to Desktop.....	4
2.2 Windows Start Menu .....	4
2.3 Image Slide Applications.....	4
2.4 Introduction to App Interface .....	5
2.5 Dual Screen App .....	5
2.6 Running Programs .....	6
3. Basic Operations.....	7
3.1 Sleep, Restart and Shut Down .....	7
3.2 Recovery.....	7
3.3 Bluetooth.....	8
3.4 Security Management .....	8
4. Features .....	9

# Overview and Notes

---

## 1.2 OVERVIEW

The TEQNIO™ Convertible Touchscreen Laptop from The EPIK Learning Company is a next-generation 2-in-1 laptop featuring Windows 10. It also features a 11.6" High Resolution Screen (1920 x 1080) and boasts a 1.44 GHz Intel Quad Core Atom Processor. The screen can be easily rotated to be used as a laptop or tablet. With the Convertible Laptop you can access the web, news, local business information and the Windows Store, where you can download your favorite apps, games, movies, music and more! With a built-in Bluetooth function you can seamlessly pair your Convertible Laptop with Bluetooth compatible devices. You can store all your important documents, pictures and movies with its 32 GB of memory. The storage capacity can also be expanded to up to 128 GB using the Micro Card Reader slot. The TEQNIO™ Convertible Touchscreen Laptop is your answer for a full-featured, all-in-one laptop.

## NOTES

- \* The TEQNIO™ Learning Convertible Touchscreen Laptop is a high-density electronic product. DO NOT attempt disassemble the device.
- \* Please do not drop or bang the device.
- \* Avoid using this product in the following environments: extreme high or low temperatures, high humidity, dusty areas, long-term exposure to the sun.
- \* The product may be cleaned with a damp cotton cloth; the use of any chemical cleaning fluid is prohibited. Please keep the product away from water at all times.
- \* Using the headphones for long periods of time at high volume may cause permanent hearing damage.
- \* DO NOT use headphones while crossing the street, riding a bicycle or driving a motorcycle or bicycle, in order to avoid traffic accidents.
- \* Please use approved battery, battery charger and accessories only. The use of any other type of products would be a breach of warranty and may be dangerous.
- \* If you have any questions regarding the use of this product, please contact your local dealer or contact the Epik Learning Company customer service center directly at support@epiklearning.com or call (888) 999-1244.
- \* Epik Learning will not be held responsible for any files lost due to product damage, repair or other causes. Please be sure to follow instructions in the User Guide and backup your files in a timely manner.

# Appearance and Buttons

---

## 2.0 APPEARANCE AND BUTTONS

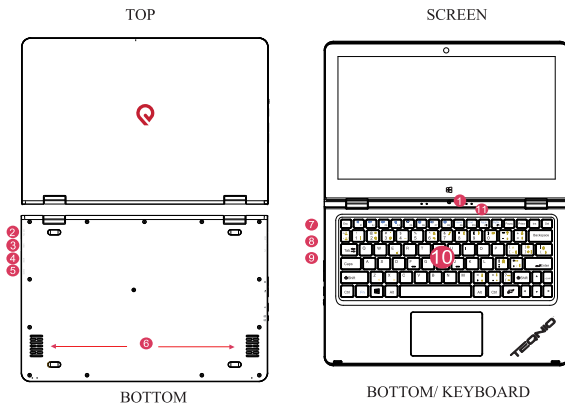

- ❶ Front Camera: Take photos and record video.
- ❷ Earphone Jack: 3.5mm standard earphone jack.
- ❸ USB 2.0 port: Connect an external USB device.
- ❹ Micro SD Card Slot: Supports Micro SD and Micro SDHC format.
- ❺ Power Button.
- ❻ Loudspeaker: enables audio without having to link an additional device.
- ❼ DC Jack: Connect the adapter for charging.
- ❽ USB 3.0 Jack: Connect the external USB device.
- ❾ Mini HDMI output.
- ❿ Keyboard
- ⓫ MIC: Microphone.



# Introduction to Desktop

---

## 2.1 INTRODUCTION TO THE DESKTOP

You must log on to your Microsoft account before the start up application can run.

## 2.2 WINDOWS START MENU

Press the key  on the keyboard or click the icon  on the screen until you see the Start Menu. All applications/programs are displayed in the form of “magnets” listed on the screen. Click on any of the icons to open.

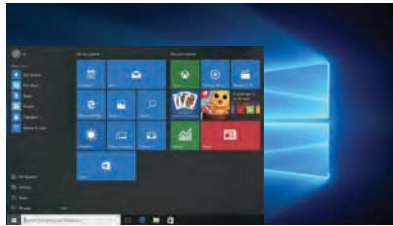

## 2.3 IMAGE SLIDE APPLICATIONS

**Slide to right/Slide to left.**

Slide to the right from the left side of the screen to start the desktop application.  
Slide to the left from the right side of the screen to start the Charm menu column.

Slide to right



Slide to left



## Introduction to Desktop (Cont'd)

---

### 2.4 INTRODUCTION TO APP INTERFACE



If you want to pin more application programs on the Start interface, press and hold the application program for about one second, and release the magnet until the pop-up option appears and select “Pin to Start” to fix to the start screen, or just press and move to the start screen. (Screen 1).



(Screen 1)



(Screen 2)

Conversely, if you want to cancel or delete a certain application in the Start screen, press and hold the application program magnet for about one second and click . You can also click  to check more menu options, such as resizing the magnet you want. (Screen 2) Slide it to the left from the right side of the screen to start Action Center to check the laptop status: Rotation lock, Bluetooth, Brightness, etc.

### 2.5 DUAL SCREEN APPLICATION

On My Computer in (Figure 1), slide inward from the left side of the screen, drag it and hold. Let go when the double interfaces appears. In (Figure 2), press the partition button on the middle partition line and drag right and left to partition the display proportion of the double screens.



(Figure 1)



(Figure 2)

## Introduction to Desktop (Cont'd)

---

### 2.5 DUAL SCREEN APPLICATION (CONT'D)

Slide fingers to the right from the left side of the screen to scan the running program, and you can close it via single click.

### 2.6 RUNNING PROGRAMS

Follow the instructions below to operate programs correctly.

Reduce



On the touch screen, narrow two fingers to reduce the image.

Enlarge



On the touch screen, widen two fingers to enlarge the image.

Move Downward



In start screen, slide from the top of the screen to view all applications/programs.

Move Right/Left



In start screen, slide finger right and left to move the image.

Move Upward



In the start screen, slide upward from the bottom of the screen to visit all applications/programs.

# Basic Operations

---

## 3.0 BASIC OPERATIONS

### 3.1 Sleep, Restart and Shutdown

#### Force Reset / Shutdown

If the laptop freezes, you can press and hold the Power button for 8~12 seconds, then the laptop will shutdown.

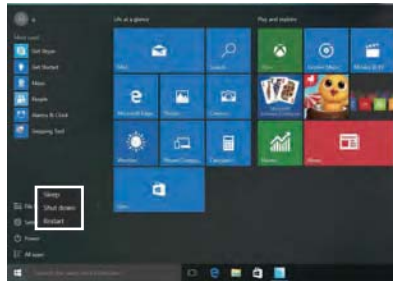

### 3.2 RECOVERY

Follow the steps below







Click the  button in the lower left corner of screen and select “Settings” then select “Update & Security”, click on “Recovery”. The program will walk you through simple steps necessary to recover your system.



## Basic Operations (Cont'd)

---

### 3.3 BLUETOOTH

- Turn on Bluetooth: Start Menu - Settings - Devices - Bluetooth.  
After you turn on Bluetooth, the laptop will auto-search other devices you can pair with your device.
- Send a File: Before sending files, you should open the window, "Select where to send your files": Click the icon  at lower right corner of desktop -  Send a File.
- Receive a File: Before receiving the files, you should open the window "Waiting for a connection": Click the icon  at lower right corner of desktop -  Receive a File.

### 3.4 SECURITY MANAGEMENT

Method for quick setup:

Click the  button in the lower left corner of screen and select **"Settings"**.

Select **"Accounts"** on the right and click **"Create local account"** in "Your account" on the right side. After creating a user name and a password for Windows Live ID Account, input username, password, confirm password and password prompt.

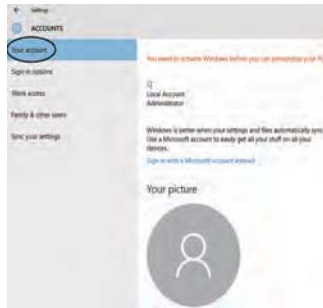

# Features

---

## 4.0 FEATURES

- \* Screen: 11.6" HD Touch Screen, IPS, 1920 x 1080 High Resolution
- \* Processor: Intel® Atom™ Processor Z8350, Quad Core, 1.44GHz
- \* OS: Windows 10
- \* Memory: 2GB
- \* Storage: 32GB
- \* Wireless Connection: WIFI 802.11 b/g/n
- \* Build in Bluetooth 4.0
- \* Front Camera: 0.3MP
- \* Supports Skype Video Call
- \* Supports 1080P Full HD Video
- \* USB 2.0 x 1 and USB 3.0 x1
- \* Card Slot: Micro SD Card (Max: 128GB)
- \* Audio Output: Stereo Speaker (8Ω 1.0w) / 3.5MM Stereo Headphone Jack
- \* Windows Store, Office Work, Internet Browser, Calendar, Calculator, E-mail, etc.
- \* Picture Viewing, Music / Video Playback, Games, etc.
- \* Supports Multi Languages
- \* Battery: Built in 9300 mAh / 3.7V Li-ion, Rechargeable
- \* Power Source: 5V 3A

### **Items are included in your package:**

- \* Laptop
- \* Power Adapter
- \* User Manual

#### FCC Warning:

This equipment has been tested and found to comply with the limits for a Class B digital device, pursuant to part 15 of the FCC Rules. These limits are designed to provide reasonable protection against harmful interference in a residential installation. This equipment generates, uses and can radiate radio frequency energy and, if not installed and used in accordance with the instructions, may cause harmful interference to radio communications. However, there is no guarantee that interference will not occur in a particular installation. If this equipment does cause harmful interference to radio or television reception, which can be determined by turning the equipment off and on, the user is encouraged to try to correct the interference by one or more of the following measures:

- o Reorient or relocate the receiving antenna.
- o Increase the separation between the equipment and receiver.
- o Connect the equipment into an outlet on a circuit different from that to which the receiver is connected.
- o Consult the dealer or an experienced radio/TV technician for help.

Caution: Any changes or modifications to this device not explicitly approved by manufacturer could void your authority to operate this equipment.

This device complies with part 15 of the FCC Rules. Operation is subject to the following two conditions: (1) This device may not cause harmful interference, and (2) this device must accept any interference received, including interference that may cause undesired operation.

The device has been evaluated to meet general RF exposure requirement. The device can be used in portable exposure condition without restriction.



EPIK Learning Company

California - USA

[www.epiklearning.com](http://www.epiklearning.com)