

Dimension: 65 x 130 mm

OUTSIDE

IMPORTANT

IMPORTANT | IMPORTANTE | WICHTIG | IMPORTANTE
| ÖNEMLİ | WAŻNY | IMPORTANTE | ВАЖНО | 重要 |
중요한 | 重要訊息 | 重要信息

- Do not place any metallic objects onto the charger.
- Ne placez aucun objet métallique sur le chargeur.
- No coloque objetos metálicos sobre el cargador.
- Platzieren Sie keine metallischen Gegenstände auf dem Ladegerät.
- Non collocare oggetti metallici sul caricatore.
- Şarj cihazı üzerine hiçbir metal obje koymayın.
- Nie kładź żadnych metalowych przedmiotów na ładowarce.
- Não coloque objetos metálicos sobre o carregador.
- Не кладите на зарядное устройство какие-либо металлические предметы.
- 充電器の上に金属を置かないで下さい。
- 충전기 위에 금속을 올려 놓지 마십시오.
- 請勿將任何金屬物體放置在充電器上。
- 請勿將任何金屬物體放置在充電器上。

• For fast charging to be supported, the connected power source must provide a minimum of 5W to the cable.

• Pour que la charge rapide soit prise en charge, la source d'alimentation connectée doit fournir un minimum de 5W au câble.

• Para que la carga rápida sea compatible, la fuente de alimentación conectada debe proporcionar un mínimo de 5W al cable.

• Zur Unterstützung der Schnelllade-Funktion muss die

angeschlossene Stromquelle mindestens 5W an das Kabel liefern.

• Per avere la ricarica rapida, il caricatore collegato deve fornire minimo 5W al cavo.

• Hızlı şarjın desteklenebilmesi için bağlı güç kaynağının kabloya minimum 5W sağlaması gerekir.

• Dla szybkiego ładowania podłączone źródło energii musi dostarczać przynajmniej 5W do kabla.

• Para que o carregamento rápido seja suportado, a fonte de energia conectada deve fornecer um mínimo de 5W ao cabo.

• Для поддержки быстрой зарядки подключенный источник питания должен обеспечивать по кабелю мощность не менее 5 Вт.

• 急速充電に対応するには、接続された電源がケーブルに5W以上出力できる必要があります。

• 고속 충전을 지원하려면 연결된 전원 공급 장치가 케이블에 5W 이상의 출력을 제공할 수 있어야 합니다.

• 為了支援快速充電，連接的電源必須為電纜提供至少5W的功率。

• 為了支持快速充電，连接的电源必须为电缆提供至少5W的功率。

• This cable is only compatible with Apple Watch. It is not compatible with any other smart watch.

• Ce câble est uniquement compatible avec l'Apple Watch. Il n'est pas compatible avec une autre montre intelligente.

• Este cable sólo es compatible con Apple Watch. No es compatible con ningún otro reloj inteligente.

• Dieses Kabel ist ausschließlich mit der Apple Watch kompatibel. Es ist nicht mit anderen Smartwatches kompatibel.

• Cavo compatibile solo con Apple Watch. Non compatibile con altri smart watch.

• Bu kablo yalnızca Apple Watch ile uyumludur. Başka hiçbir akıllı saate uyumlu değildir.

• Ten kabel jest kompatybilny tylko z zegarkami Apple. Nie jest kompatybilny z żadnymi innymi smartwatchami.

• Este cabo é compatível apenas com Apple Watch. Não é compatível com nenhum outro Smart Watch.

• Этот кабель совместим только с Apple Watch. Он не совместим ни с какими другими умными часами.

• このケーブルはApple Watchのみに対応しています。他のスマートフォンには非対応です。

• 이 케이블은 Apple Watch에만 호환됩니다. 다른 스마트폰은 지원하지 않습니다.

• 該電纜僅與Apple Watch相容。它不相容於任何其他智慧手錶。

• 该电缆仅与Apple Watch兼容。它不兼容任何其他智能手表。

• Apple Watch Charger can only fast-charge at 5W with Apple Watch Ultra 2, Apple Watch Ultra, Apple Watch Series 9, Apple Watch Series 8, and Apple Watch Series 7.

• Le chargeur pour Apple Watch ne peut charger rapidement qu'à 5W avec Apple Watch Ultra 2, Apple Watch Ultra, Apple Watch Series 9, Apple Watch Series 8 et Apple Watch Series 7.

• El cargador de Apple Watch sólo puede cargar rápidamente a 5W con Apple Watch Ultra 2, Apple Watch Ultra, Apple Watch Series 9, Apple Watch Series 8 y Apple Watch Series 7.

• Apple Watch Ladegerät kann nur mit 5W mit Apple Watch Ultra 2, Apple Watch Ultra, Apple Watch Series 9, Apple Watch Series 8 und Apple Watch Series 7.

• Il caricatore Apple Watch può caricare velocemente a 5 W solo con Apple Watch Ultra 2, Apple Watch Ultra, Apple Watch Series 9, Apple Watch Series 8 e Apple Watch Series 7.

• Apple Watch Şarj Cihazı yalnızca Apple Watch Ultra 2, Apple Watch Ultra, Apple Watch Series 9, Apple Watch Series 8 ve Apple Watch Series 7 ile 5 W'ta hızlı şarj edebilir.

• Ładowarka do Apple Watch umożliwia szybkie ładowanie z mocą 5 W tylko zegarków Apple Watch Ultra 2, Apple Watch Ultra, Apple Watch Series 9, Apple Watch Series 8 i Apple Watch Series 7.

• O carregador Apple Watch só possui carga rápida a 5 W com o Apple Watch Ultra 2, Apple Watch Ultra, Apple Watch Series 9, Apple Watch Series 8 e Apple Watch Series 7.

• Зарядное устройство Apple Watch поддерживает быструю зарядку мощностью 5 Вт только для Apple Watch Ultra 2, Apple Watch Ultra, Apple Watch Series 9, Apple Watch Series 8 и Apple Watch Series 7.

• Apple Watch 充電器はApple Watch Ultra 2、Apple Watch Ultra、Apple Watch Series 9、Apple Watch Series 8、Apple Watch Series 7のみ5Wで急速充電できます。

• Apple Watch 충전기는 Apple Watch Ultra 2, Apple Watch Ultra, Apple Watch Series 9, Apple Watch Series 8, Apple Watch Series 7에 한해 5W로 고속 충전할 수 있다.

• Apple Watch 充電器只能以 5 W 的功率為 Apple Watch Ultra 2、Apple Watch Ultra、Apple Watch Series 9、Apple Watch Series 8 和 Apple Watch Series 7 快速充電。

• Apple Watch 充电器只能以 5 W 的功率为 Apple Watch Ultra 2、Apple Watch Ultra、Apple Watch Series 9、Apple Watch Series 8 和 Apple Watch Series 7 快速充电。

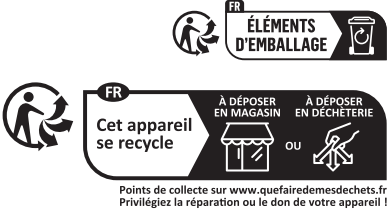

S A T E C H I

USB-C Fast Charging Cable for Apple Watch

User Manual



Manuel de l'utilisateur | Manual de usuario | Benutzerhandbuch | Manuale utente | Kullanım kılavuzu | Instrukcja obsługi | Manual de usuário | Руководство пользователя | ユーザーマニュアル | 사용자 매뉴얼 | 使用者說明 | 用戶說明

INSIDE

PLUG & PLAY

BRANCHEZ & JOUEZ | CONECTAR Y USAR | STECKEN & SPIELEN | COLLEGARE E GIOCARE | TAK VE ÇALIŞTIR | PODŁĄCZ I UŻYWAJ | CONECTE E USE | ПОДКЛЮЧИ И РАБОТАЙ | プラグ&プレイ | 플러그 앤 플레이 | 即插即用 | 即插即用

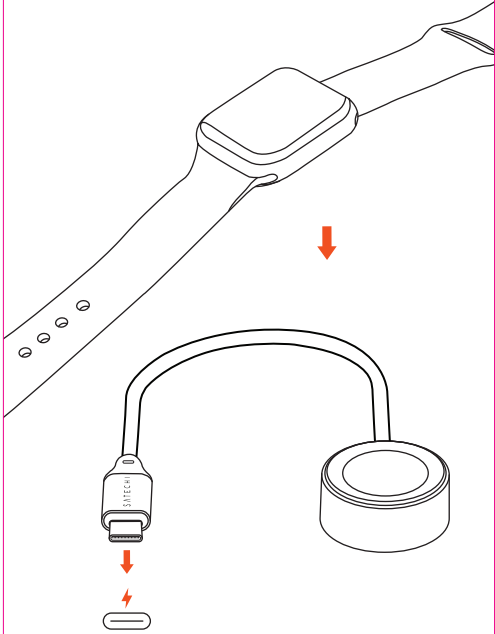

*Compatible with AirPods with MagSafe Charging Case | Compatible avec les AirPods avec étui de chargement MagSafe.

FUNCTIONS

FONCTIONS | FUNCIONES | FUNKTIONEN | FUNZIONI | FONKSIYONLAR | FUNKCJE | FUNÇÕES | ФУНКЦИИ | 機能 | 기능 | 功能 | 功能

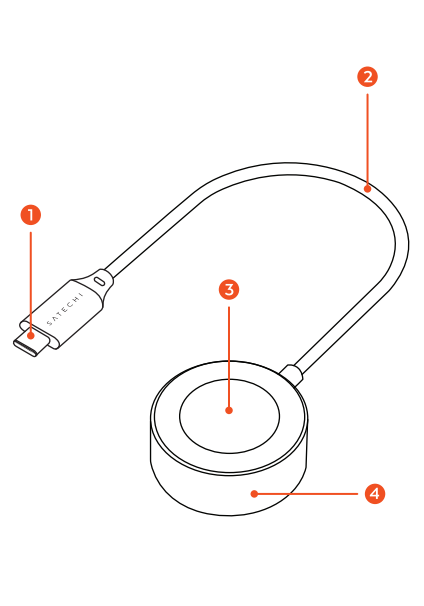

1. USB-C Connector

Connecteur USB-C | Conector USB-C | USB-C-Anschluss | Connettore USB-C | USB-C Konektörü | Złącze USB-C | Conector USB-C | Разъем USB-C | USB-C コネクタ | USB-C 커넥터 | USB-C连接器 | USB-C连接器

2. Durable Braided Cable

Câble Tressé Durable | Cable Trenzado Duradero | Strapazierfähiges Flechtkabel | Cavo Intrecciato Resistente | Dayanıklı Örgülü Kablo | Trwały Kabel w Oplocie | Cabo Trançado Durável | Прочный Плетеный Кабель | 丈夫な編み込みケーブル | 튠튼한 뜨개질 케이블 | 耐用的編制線 | 耐用的編制線

3. Magnetic Charger (5W Max)

Chargeur Magnétique (Max. 5W) | Cargador Magnético (Máx. 5W) | Magnetisches Ladegerät (Max. 5W) | Caricabatterie Magnetico (massimo 5W) | Manyetik Şarj Cihazı (Maks. 5W) | Ładowarka Magnetyczna (maks. 5W) | Carregador Magnético (Máx. 5W) | Магнитное Зарядное Устройство (Макс. 5 Вт) | 磁気充電器 (最大 5W) | 마그네틱 충전기 (최대 5W) | 磁力充電器 (最大 5W) | 磁力充电器 (最大 5W)

4. Aluminum Construction

Conception en Aluminium | Construcción de Aluminio | Aluminium-Konstruktion | Realizzato in Alluminio | Aluminiyum Konstrüksiyon | Aluminiowa Konstrukcja | Construção em Alumínio | Алюминиевая Конструкция | アルミニウム構造 | 알루미늄 구조 | 鋁結構 | 铝结构



This device complies with part 15 of the FCC results. Operation is subject to the following two conditions:
1. This device may not cause harmful interference and
2. This device must accept any interference received, including interference that may cause undesired operation.
Note: This Equipment has been tested and found to comply with the limits for a class B digital device, pursuant to Part 15 of the Federal Communications Commission (FCC) rules. These limits are designed to provide reasonable protection against harmful interference in a residential installation. This equipment generates, uses, and can radiate radio frequency energy and, if not installed and used in accordance with the instructions, may cause harmful interference to radio communications. However, there is no guarantee that interference will not occur in a particular installation. If this equipment does cause harmful interference to radio or television reception, which can be determined by turning the equipment off and on, the user is encouraged to try to correct the interference by one or more of the following measures:
1.1. Reorient or relocate the receiving antenna
1.2. Increase the separation between the equipment and receiver
1.3. Connect the equipment into and outlet on a circuit different from that to which the receiver is connected
1.4. Consult the dealer or an experienced radio/TV technician for help
Changes or modifications not expressly approved by the manufacturer could void the user's authority to operate the equipment.
FCC Radiation Exposure Statement:
This equipment complies with FCC radiation exposure limits set forth for an uncontrolled environment. This equipment should be installed and operated with minimum distance 20 cm between the radiator & your body.



CE DECLARATION OF CONFORMITY
Satechi declares that this product is in compliance with the essential requirements and other relevant provisions of applicable EC directives. For Europe, a copy of the Declaration of Conformity for this product may be obtained by visiting <https://satechi.net/support/doc>

IC: 24917-STOCAWM
This device contains licence-exempt transmitter(s)/receiver(s) that comply with Innovation, Science and Economic Development Canada's licence-exempt RSS(s). Operation is subject to the following two conditions:
(1) This device may not cause interference.
(2) This device must accept any interference, including interference that may cause undesired operation of the device.
Cet appareil contient des émetteurs / récepteurs exemptés de licence conformes aux RSS (RSS(s) d'Innovation, Sciences et Développement économique Canada. Le fonctionnement est soumis aux deux conditions suivantes :
(1) Cet appareil ne doit pas causer d'interférences.
(2) Cet appareil doit accepter toutes les interférences, y compris celles susceptibles de provoquer un fonctionnement indésirable de l'appareil.

Use of the Made for Apple badge means that an accessory has been designed to connect specifically to the Apple product(s) identified in the badge and has been certified by the developer to meet Apple performance standards. Apple is not responsible for the operation of this device or its compliance with safety and regulatory standards. Please note that the use of this accessory with an Apple product may affect wireless performance.

L'utilisation du badge "Made for Apple" signifie qu'un accessoire a été conçu pour se connecter spécifiquement au(x) produit(s) Apple identifié(s) dans le badge et a été certifié par le développeur pour répondre aux normes de performance d'Apple. Apple n'est pas responsable du fonctionnement de cet appareil ni de sa conformité aux normes de sécurité et de réglementation. Veuillez noter que l'utilisation de cet accessoire avec un produit Apple peut affecter les performances sans fil.

NEED HELP?

BESOIN D'AIDE? | ¿NECESITA AYUDA? | BENÖTIGEN SIE HILFE? | HAI BISOGNO DI AIUTO? | YARDIMA MI İHTİYACINIZ VAR? | POTRZEBUJĘ POMOCY? | PRECISA DE AJUDA? | НУЖНА ПОМОЩЬ? | 助けが必要ですか? | 도움이 필요하신가요? | 需要幫助? | 需要幫助?

Manufacturer:
7365 Mission Gorge Rd. Ste. G
San Diego, CA 92120, USA
+1 858 268 1800
support@satechi.com
www.satechi.net

EU Authorized Representative:
Chemical Inspection and Regulation
Service Limited
CIRS, Regus Harcourt Centre
Dublin, Ireland, D02 HW77
+353 1 477 3710

UK Representative:
Chemical Inspection and Regulation
Service UK Ltd.
Unit 536, Salisbury House
London Wall, London, EC2M 5SQ
+44 20 3289 6395

PKG TEAM

Designer: Gabriela Ramirez

Product: USB-C Fast Charging Cable for Apple Watch

Project: Product Manual Design

Date: FEB / 29 / 24

Scale: 100%



COMMENTS

Please do not print this layer!!!

- 100% actual size
- All print should be matte except where indicated

SPECIFICATIONS



Printing Information



Paper Material + Specs



128G铜板纸 过光油 (Vanish)



Folding

5-PANEL
ZIG-ZAG FOLD

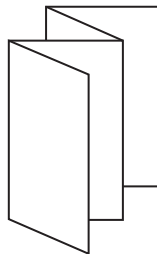

Product Info

SKU: ST-QCAWM

FCC ID: N/A