



Wireless Security Battery IP Camera

Quick Installation Guide



We keep improving the app, if the app interface is not accordance with the instructions, please go to AJCloud website: <http://cd.ipcamdata.com> for the latest instructions

Product Description

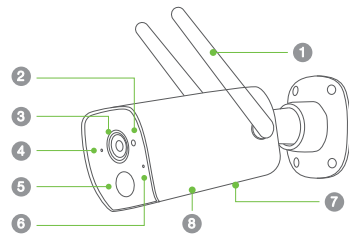

1	Antenna	5	PIR sensor
2	Photoresistance	6	Microphone
3	lens	7	Speaker
4	Indicator light	8	Waterproof Cover

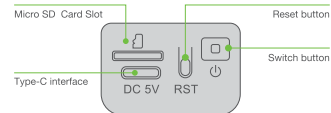

Indicator lights status

Light Status	Device status
Red light on	Camera is powered on
Red and Blue light alternately flashing	Waiting to connect now
Blue light flashing	Camera is connecting Wi-Fi
Blue light solid	Succeeded to connect Wi-Fi
Red light quickly flashing	1.Reset camera to factory setting 2.Camera is upgrading firmware

When the machine is on but without the pairing, after a few seconds, the indicating lights will be off and the machine enter the "Dormancy" status

Button Controls

Button	Function	Operation Manual
RST	Enter into the network configuration status	Press and hold the RST button 3-4S, the device will play a beep sound, release the button, the red and blue lights flash alternately
	Reset	Press and hold the button for about 8s, the device will play the prompt sound of "DIDI", the red light will flash quickly, and the device will sleep after 2S
Switch ON/OFF button	Switch ON	Press the "power button" to start the machine. And the machine starting music will play in 2 seconds.
	Switch OFF	When the power button spring up, the machine in "OFF" status.

Preparations

Check whether the wireless router is in normal use, and then connect the mobile phone to the WiFi network. If it is a dual-band router, please connect to a 2.4G WiFi network.



Download and Install

1. Go to the App Store or Google Play to search and download "AJCloud" APP to your supported devices. Or please scan below QR code to download "AJCloud" to your Android or Apple device.



Download APP

2. Open the "AJCloud" APP and register an account using your email. Tips: Your password must be 8-16 characters, and at least contain the following three categories: numbers, uppercase letters, lowercase letters, special characters.

Wireless access method

The device is placed from a position close to the router.

- Click "Add Device" or "+"
- Select device type
- Confirm starting
- Camera setup
- Wi-Fi setup
- Wi-Fi setup

*Tips:
If the wireless network connection fails, please follow the APP guide to reconfigure the network.

Advanced Features



Cloud storage

After cloud storage is turned on, emergency video information can be saved in a cloud server. Avoid data loss or damage.



Smart power-saving

Software and hardware intelligent power saving processing. Support auto hibernation, when someone enters into the PIR detecting range, the machine will wake up automatically.



Motion Detection

Support to capture moving objects and automatically trigger recording of 10S short video. Push APP alarm information in realtime.



Two-way voice

Support voice function while watching videos online. Also available online two-way conversation.



24/7 monitoring

Built-in IRCUT device, coupled with photosensitive components, to achieve 24/7 HD video viewing.



TF card local storage

Built-in TF card slot, users can also save the recorded video on the local TF card.



Device sharing

You can share the device bound to your account to family and friends for common use. Can be revoked at any time share, you are an administrator.

Precautions

1. The use of unauthorized or incompatible power supply may cause fire, explosion, or other hazards.
2. This product and accessories include some small accessories. Keep the product and its accessories out of the reach of children. Prevent children from inadvertently damaging products and accessories. Or swallowing small parts causing suffocation or other hazards.
3. This product is not a toy, children should use the product under adult supervision.
4. Please use this product within the temperature range of -10° C - 50°C. When the ambient temperature is too high or too low, it may cause product failure.
5. Do not use this product in thunderstorm weather. Thunderstorm weather may cause product malfunction or electric shock hazard.
6. When using this product, Please stay away from electrical appliances with strong magnetic and electric fields, such as microwave ovens, refrigerators, etc.

The product spec and product information mentioned in the using manual just for reference. If any modified, won't give notice separately. And the product function will be different based on different product model. This using manual just for the using guide purpose.

NB Warning:

Manufacturer's Name: Shenzhen Smarteye Digital Electronics Co., Ltd

Sample Description: Battery IP Camera

Trade Mark: /

Model number: 804RTD, 805RTD, 806RTD, 801RTD, 808RTD, 820RTD, 821RTD, 803RTD, 830RTD, 831RTD

Operating Temperature: - 10° C to 50° C

Wireless specification:

2.4G Wi-Fi; Max power 18.41dbm in frequency band 2412 - 2472MHz, Limit 20dBm.

This product is a fixed location. To comply with RF exposure requirements, a minimum separation distance of 20cm must be maintained between the user's body and the device, including the antenna. Use only the supplied or an approved antenna.

This device in compliance with the essential requirements and other relevant provisions of Directive 2014/53/EU. All essential radio test suites have been carried out.

1. CAUTION: RISK OF EXPLOSION IF BATTERY IS REPLACED BY AN INCORRECT TYPE. DI SPOSE OF USED BATTERIES ACCORDING TO THE INSTRUCTIONS.

2. The device complies with RF specifications when the device used at 20cm from your body.

This product can be used across EU member states.

This device was tested for typical fixed location operations. To comply with RF exposure requirements, a minimum separation distance of 20cm must be maintained between the user's body and the IP camera, including the antenna.

This device in compliance with the essential requirements and other relevant provisions of UK Radio Equipment Regulations (SI 2017/1206); UK Electrical Equipment (Safety) Regulations (SI 2016/1101); and UK Electromagnetic Compatibility Regulations (SI 2016/1091). All essential radio test suites have been carried out.

FCC Warning

This device complies with part 15 of the FCC Rules. Operation is subject to the following two conditions: (1) this device may not cause harmful interference, and (2) this device must accept any interference received, including interference that may cause undesired operation.

Any changes or modifications not expressly approved by the party responsible for compliance

could void the user's authority to operate the equipment.

NOTE: This equipment has been tested and found to comply with the limits for a Class B digital device, pursuant to Part 15 of the FCC Rules. These limits are designed to provide reasonable protection against harmful interference in a residential installation. This equipment generates, uses and can radiate radio frequency energy and, if not installed and used in accordance with the instructions, may cause harmful interference to radio communications. However, there is no guarantee that interference will not occur in a particular installation.

If this equipment does cause harmful interference to radio or television reception,

which can be determined by turning the equipment off and on, the user is encouraged to try to correct the interference by one or more of the following measures:

-- Reorient or relocate the receiving antenna.

-- Increase the separation between the equipment and receiver.

-- Connect the equipment into an outlet on a circuit different from that to which the receiver is connected.

-- Consult the dealer or an experienced radio/TV technician for help.

FCC RF exposure statement:

The equipment complies with FCC Radiation exposure limit set forth for an uncontrolled environment. The equipment should be installed and operated with a minimum distance of 20cm between the product and your body.