

User' s Manual

RH750 USER GUIDE





RH750 USER GUIDE

User' s Manual

Table of Contents

1. Cautions for Safety	5
2. Components.....	7
3. Nomenclature.....	8
4. Operation.....	9
5. Troubleshooting.....	19
6. Specification.....	19

Cautions for Safety

The instructions with the following caution marks must be carefully read and followed in order to use the product properly and to prevent accident or damage which may occur during the operation of the product.

Meanings of caution icons



Important

It refers to important information, definitions, general knowledge and references.



Warning

If you do not follow the instruction with this warning icon, a serious injury or property loss may occur.



Danger

If you do not follow the instruction with this danger icon, a serious injury, death, or property loss may occur.

Safety Instructions

- If you feel fatigue or have any trouble with hands or arms, manipulating the remote controller may worsen the symptom. Consult with a doctor before using the product.
- When you feel fatigue in your hands or arms during using the product, make sure to take a rest. If pain or discomfort is sustained, immediately stop using the product and consult a doctor.
- Do not throw or drop the product. When hit by a person or an object, accident, injury, damage or failure may be caused.
- If the product is wet with liquid such as water or beverage, remove the batteries and contract the service center. Using the product with the battery wet may cause product failure.
- Do not disassemble, revise or repair the product. Electric shock or failure may be caused.
- If anomalies such as unusual sound, smoke, smell, etc. are found, immediately remove the batteries and contact the service center.
- Never use the product at places (hospital, public organizations, etc.) where radio communication is prohibited. Radio Frequency may affect operation of devices.
- For a person equipped with a pacemaker, maintain the product more than 22 centimeters away from the pacemaker-mounted part. Radio Frequency may affect operation of the pacemaker.
- Do not leave the product in the middle of floor. A person may be injured by stumbling over it.
- Keep the product out of reach of children and do not place it at an unstable place. The product may fall off, resulting in injuries or failures.
- The Handle Remote Controller is composed of plastic and metal components. Burning the product may be dangerous. Discard the product in compliance with the applicable local recycling regulations.
- Do not use or store the product in a wet or dusty place. Product failure may be caused.
- Do not let the Handle Remote Controller make contact with a magnet. Operation error may be caused.
- When the Handle Remote Controller gets dirty, wipe it with soft cloth. Do not clean it with thinner, benzene, alcohol, etc. Surface damage may be caused.
- Do not use batteries other than the standard batteries. Product trouble or operation error may be caused.
- If you do not use the product for a long time, remove the batteries. Battery may be discharged over time.
- Do not use the product in a place exposed to flammable materials such as alcohol, gasoline, distillation materials, thinner, etc. or in a place where smoke, ashtray, candle light, stove, etc. are present.

Components

- Handle Remote Controller 1 EA
- Handle Remote Controller holder 1 EA
- AA batteries 2 EA
- User' s Manual 1 Copy

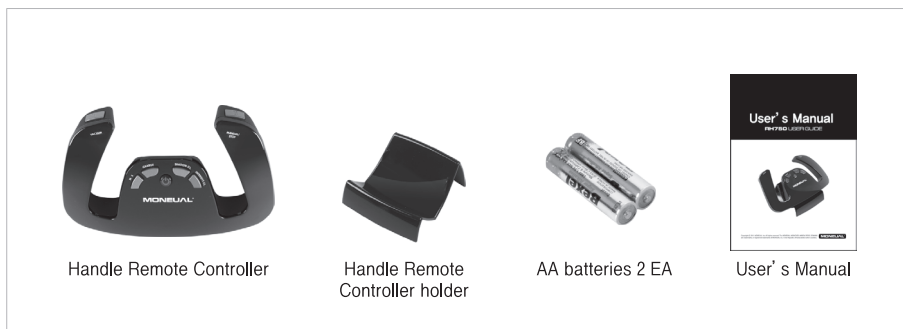

The appearance and specifications are subject to change without prior notice for better product functions or performance.



Make sure to use expendables in standard. For inquires for appropriate standards, please

Nomenclature

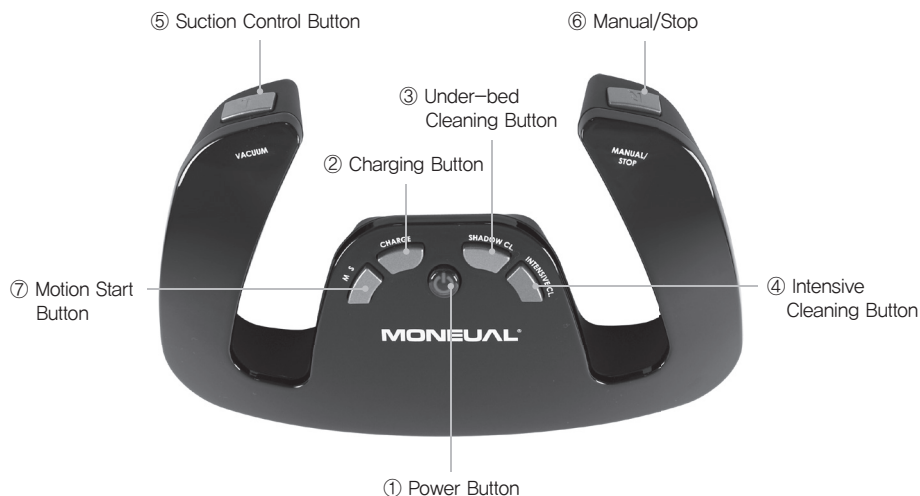

Button Description

1. Power Button: Turns on or off the body of the robot cleaner.
2. Charging Button: Charges the robot cleaner on the charger.
 - When you press the Power button, the charging can be cancelled.
3. Under-bed Cleaning Button: Sets the robot cleaner to the under-bed cleaning mode.
 - For details, see the manual on the robot cleaner.
 - When you press the Manual/Stop button, the Under-bed cleaning will be cancelled and the robot cleaner will work in the Manual mode.
4. Intensive Cleaning Button: Sets the robot cleaner to the intensive cleaning mode at the current position.
 - For details, see the manual on the robot cleaner.
 - When you press the Manual/Stop button, the Intensive cleaning will be cancelled and the robot cleaner will work in the Manual mode.
5. Suction Button: Changes the suction force of the robot cleaner to Weak → Middle → Strong whenever the button is pressed.
6. Manual/Stop: Runs the robot cleaner in manual cleaning mode or stops the robot cleaner.
7. Motion Play Button: Activates the motion play function to run the robot cleaner using the internal motion sensor. Press this button again to disable the motion play function.
 - When the motion function is activated, the green LED will be lit. Without any move for around ten seconds, in this state, the motion function will be automatically released.
 - Once the motion play function is stopped, the red LED will be lit. If the robot cleaner remains unmoved for around five seconds, the red LED will be automatically turned off.

Operation

Installing the batteries to the Handle Remote Controller

1. Press the hook of the rear cover and open the cover.



2. Open the battery cover and insert the two AA batteries starting from the negative pole, as seen in the figure.



3. Close the battery cover.



- When rechargeable batteries are used, use rechargeable Ni-MH batteries. Do not use lithium batteries.
- It is recommended to use AA alkaline batteries.

4. When the battery is initially inserted and the red LED of the Power button is lit, it means the sensor of the Handle Remote Controller is being initialized; put it on the cradle for around 10 seconds.



5. Once the motion sensor is completely initialized, the red LED will be turned off.



The Handle Remote Controller is not ready to be used before the initialization is completed.



| Holding the Handle Remote Controller |

- ⦿ Do not apply an excessive force but lightly hold the Handle Remote Controller as shown in the figure.
- ⦿ If held reversely or incorrectly, the robot may not move in a desired direction.



| Storing the Handle Remote Controller |

- ⦿ Store the Handle Remote Controller on the Handle Remote Controller holder provided.



Motion Handler Operation(1)

1. Turn on the power of the robot cleaner body.

- Press the power button of the body or turn on the power button from the remote controller.
- The buttons would not work if the main power switch is not on.

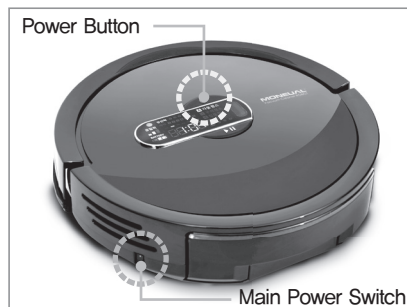

2. Press the Motion Play Button of the Handle Remote Controller. The motion function starts along with the voice “Starting Motion Play” delivered from the body.

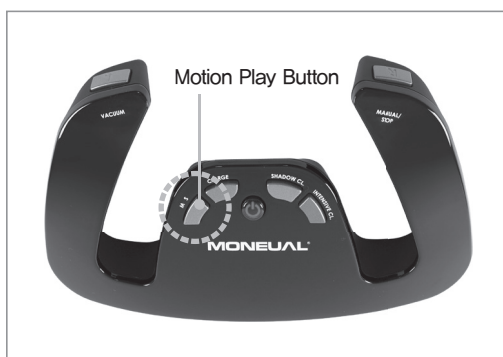

- When you press the Power button, the internal sensor of the robot cleaner goes through the initialization process for around 0.5 ~ 1 second once the robot is powered on. If you activate the motion with the MS button during the time, the motion function may not work normally.
- When the main power switch is turned on, the robot cleaner may not smoothly communicate with the handle remote controller for around 2 ~ 3 seconds due to booting of the internal program and initialization of the sensor.
- While the robot cleaner is being charged through adaptor at the charging terminal at the rear of the robot, it will not work with voice messages heard. To use the motion function, remove the adaptor from the charging terminal.

3. Manipulate the robot cleaner using the Handle Remote Controller.

- ④ Lean the Handle Remote Controller forward to move the robot cleaner forward.



- ④ Lean the Handle Remote Controller backward to reverse the robot cleaner.



- ④ Lean the Handle Remote Controller to the left to turn the robot cleaner to the left at the forwarding or reversing speed.



- ④ Lean the Handle Remote Controller to the right to turn the robot cleaner to the right at the forwarding or reversing speed.



For basic operating angles, you can use the front/rear pitch angles and the left/right roll angles to operate the robot cleaner. In some cases, you may need to learn how to make the operation.

4. Press the Motion Play Button again during motion play operation.
The robot cleaner will stop along with the voice "Stopping Motion Play."



If the red LED is lit on the Power button while the motion play is stopped, put the Handle Remote Controller holder or on a flat floor and wait until the LED gets turned off.

- ⦿ You can manually clean dust and waste using Manual Cleaning during Motion Play.
- ⦿ You can move the robot cleaner to clean the space under the bed or sofa using the Motion Play button.
- ⦿ You can operate the robot cleaner in various ways using the Motion Play button.
- ⦿ When the robot cleaner is manipulated using the Handle Remote Controller, it may strongly hit the furniture or wall because it cannot detect obstacles while moving at a high speed.
- ⦿ Pay attention to the objects which are fragile or may be easily fell down, and remove such objects wherever possible.
- ⦿ The operation distance of the Handle Remote Controller is about 10 meters, which depends on wireless circumstance and environment.
- ⦿ With no operations made for 10 seconds in the motion play status, the robot will automatically stop the motion play function.

Motion Handler Operation(2)

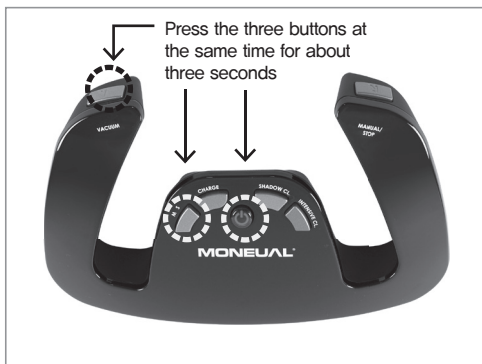

1. Press "Power Button + Suction Control Button + Motion Play Button" of the Handle Remote Controller at the same for about three seconds.
2. After about three seconds, the Power LED blinks once and the Handle Remote Controller is reset.
3. The enhanced Handle Remote Controller is available when the sensor is initialized after reset.
4. To change from the enhanced Handle Remote Controller to the existing system, press "Power Button + Suction Control Button + Intensive Cleaning Button" at the same for about three seconds.



- In using the improved motion handle remote controller, you will see it different from exiting method in many parts. If you move the controller abruptly, the motion sensor will have wrong values, which can prevent the robot from working normally.
- The improved motion handle remote controller also makes precise control using the front/rear pitch angles and the left/right yaw angles. And so, you may feel it difficult to control it and may need to learn the controlling method in some level.

◎ When you press the motion play button of the enhanced handle remote controller, do not move yourself or the handle remote controller. This may change the reference point, resulting in abnormal operation.

◎ The enhanced handle remote controller may not work normally if you change the position where the motion play button is pressed.



- If you have any difficulty or trouble with motion play operation, press "Suction Control Button + Power Button" for three seconds to initialize it (10 sec).
- If it continues abnormal operation after initialization, replace the battery.

| Synchronizing the Handle Remote Controller with the Body |

An existing remote controller can be used for the Handle Remote Controller but a receiving error may be caused by interference if used concurrently.

1. Turn off and on (OFF → ON) the main power switch on the rear side with the power button of the robot cleaner pressed at the same time.

- ⦿ Body synchronization is ready.
- ⦿ The display sequentially flashes from the bottom to the top and the other buttons of the body are disabled.

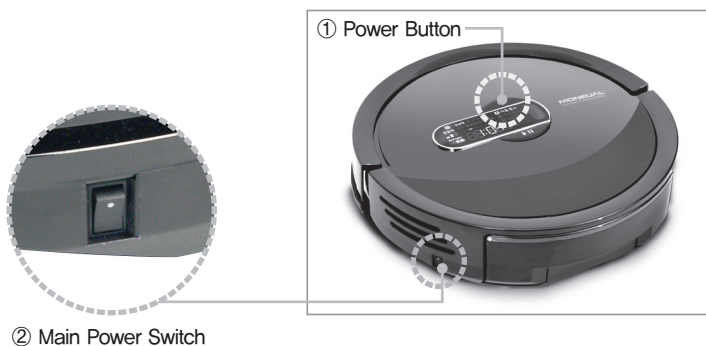

2. Open the battery cover of the Handle Remote Controller and remove one of the AA batteries.

- ⦿ Remove the positive (+) polarity of the battery first.

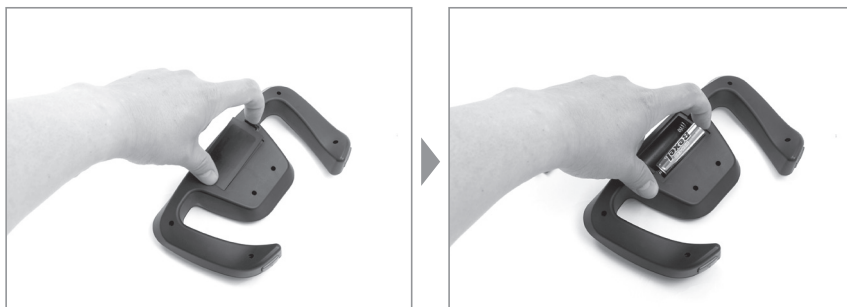

3. Re-insert the battery with the Charging button being pressed.

- ⦿ The body display flashes and the red LED and blue LED of the power button of the Handle Remote Controller concurrently flash, indicating that synchronization is complete.
- ⦿ If the red LED and the blue LED of the Handle Remote Controller flash alternately, repeat from 1 to 4.



4. When synchronization is complete, take out and insert one of the batteries of the Handle Remote Controller.

- ⦿ Turn off and on the main power switch of the body.

| Another synchronization method |

1. Turn off and then on (OFF → ON) the main power switch at the rear part with the Power button of the robot cleaner being pressed.
 - ⊙ The main body will be ready for synchronization.
 - ⊙ Now, the display will be turned on and off from the bottom to the top in order, and so, you cannot use the other buttons of the main body.

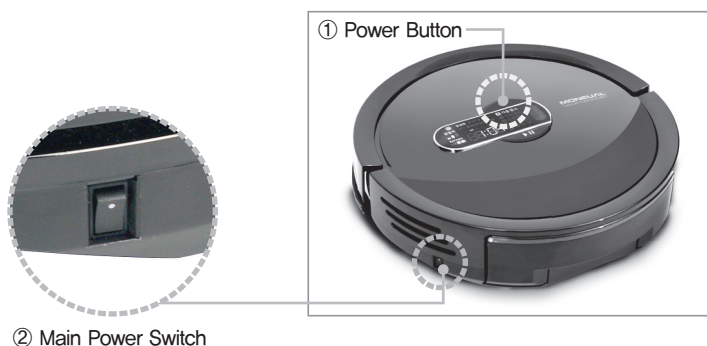

2. When you press the Power button + the Suction button + the Charging button at the same time for 3 seconds with the battery inserted into the Handle Remote Controller, the Handle Remote Controller will go into the synchronization mode.

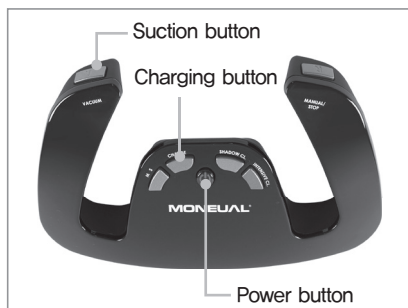

3. After the synchronization, when you press the Power button + the Suction button at the same time for 3 seconds, the remote controller will be reset.
4. When you put the Handle Remote Controller holder for 10 seconds with the red LED turned on, the LED will be turned off, and so, you can use the device.

Troubleshooting

Error	Checkpoints
The Handle Remote Controller does not work.	<ol style="list-style-type: none"> 1. Check that the batteries are inserted exactly. 2. Check the battery level. <ul style="list-style-type: none"> ☉ In the event of low battery power, the red LED and the blue LED concurrently flash for about 5 seconds after the button is pressed.
The robot cleaner does not response while the Handle Remote Controller is working.	<ol style="list-style-type: none"> 1. Match the Handle Remote Controller with the robot cleaner. 2. Check the battery level.
Response of the Handle Remote Controller is abnormal.	<ol style="list-style-type: none"> 1. Check if the remaining battery power is sufficient. 2. Press the Power button and the Suction button of the Handle Remote Controller at the same time for around 3 seconds and put it on the holder for 10 seconds.

Specification

Handle Remote Controller

Model No.	RYDIS RH750
Dimension	L 199mm x W 120mm x H 58mm
Weight	About 115g (Without battery)
Power Consumption	About 70mW
Power Supply	AA alkaline batteries (LR6) 2 EA
Radio Frequency	2.4GHz ISM BAND
Signal Transmission Distance (RF)	About 10 meters (variable depending on environment.)
Sensor	3-axis acceleration sensor, 3-axis gyroscope
Motion recognition	Embedded digital motion processor

Handle Remote Controller Holder

Model No.	RYDIS RK750
Dimension	L 100mm x W 117mm x H 54mm
Material	ABS
Weight	About 57g



This wireless system can cause interference of radio waves, it should not be used for services related to safety.

Company name: Moneual, Inc.

● Product name: Wireless device for wireless data communication systems

● Authentication No.: KCC-CRM-MOL-RH750-P

[illegible]

PRODUCT WARRANTY

The warranty period for the product and the battery is one (1) year.

We, Moneual, offer the following warranty service to our consumers based on the customer compensation regulation. By the request for the warranty service, DAEWOO Elec Service Co., Ltd. will provide the service. The company will let the customer notified of whether to be compensated and the details within seven (7) business days after the requested day and offer the compensation within fourteen (14) business days after the notified day. We do not offer any paid/unpaid service for parallel imports.

Product name		Model name	
Purchased date	month date, year	Serial No.	
Dealer		Price	

UNPAID SERVICE

※ If products for general users are used for sale purpose, unpaid service may not be offered.

Type of damages to customers		Compensation details		
		Within the warranty period	After the warranty period	
Malfunctions in performance and functions during normal use within the period when related parts are being stored	Essential repairing is required within ten (10) days after the purchase.		Replace the product with a new one or refund the product at the purchased price.	Not applicable
	Essential repairing is required within one (1) month after the purchase.		Replace the product with a new one or offer unpaid repairing.	
	A replaced product gets faulty, requiring essential repairing within one (1) month after the replacement.		Refund the product at the purchased price.	
	No replacement is available.			
	Repairing is available.	Malfunctions are generated for three (3) times due to the same defects.	Unpaid Repair	Paid repair
		Malfunctions are generated for four (4) times due to the same defects.	Replace the product with a new one.	Paid repair
		Malfunctions are generated for five (5) times due to different defects.		Paid repair
	The repairing company has lost the product requested for repairing by the customer.		Replace the product with a new one or refund the product at the purchased price.	Refund the product at the fixed depreciated price added with 10% of the fixed depreciated amount.
	Repairing is NOT available as no parts for repairing are put in stock within the period when related parts should be stored.			Refund the product after the fixed depreciation.
Repairing is NOT available although parts for repairing are stored.		Replace the product by applying fixed depreciation, after the expenses for paid repairing is paid.		
Malfunctions caused from intension or negligence of customers	Repairing is NOT available.		Replace the product after the amount corresponding to the expenses for paid repairing is paid.	
	Repairing is available.	Paid repair	Paid repair	

PAID SERVICE

※ If you ask for the after-sales service and the product is not found faulty, you need to pay the service fee. Therefore, please read through the Users' manual before.

Cases when the product is not faulty

- Users ask for the after-sales service before fully understanding the Users' manual.
- Problems in external environments including propagation of radio waves and wired signals
- Initial installation for the supplied product
- Treatment of the filter and removal of foreign substances from accessories
- Malfunctions caused from other companies' products (including software)

Malfunctions due to customers' negligence

- Malfunctions caused from wrong power capacity
- Malfunctions caused from external shock or fall
- Malfunctions due to use of consumables or optional devices not specified by our company
- Malfunctions caused from the repairing person, who is not from our partner companies specified by our company
- Malfunctions caused from ignorance of "Cautions for safety" described in the Users' manual

Other cases

- Malfunctions caused from natural disasters (Lightning, fire, salt damage and water damage)
- The life of consumables comes to an end.

MONEUAL

www.moneual.co.kr



