

InRouter 6X5 Series

Smart 4 Ethernet LAN/ Serial to Ethernet WAN/HSPA+/UMTS Router



- Compact Design:** 4 Ethernet LAN switch ports, RS232/485 DB9), 3G/UMTS or Ethernet WAN connection
- Power supply:** 9-26V DC Power Terminal
- High security:** Advanced VPN (IPSec/SSL/GRE/L2TP/PPTP)
- Centralized management platform:** InHand Device Manager Cloud
- Reliable for almost all industrial conditions**



Overview

InRouter6X5 series are compact designed industrial cellular routers which can help users to quickly access to high-speed Internet and support secure and reliable data transmission. The products combine together with the functions of unmanaged switch, serial server, 3G Router, IP modem, Advanced VPN client and provide with high cost-effective solution for applications in industrial automation and control, fleet monitoring, video surveillance, advertising media, and outlets networking. You can even configure it easily through the browser on your IOS or Android terminals without connection to the router by cable.

Besides flexibility, InRouter6X5 series can provide reliable data link. For example, the multi-level linkage detection ensures linkage stability especially for applications in unattended areas. The outstanding performance under wide temperature and harsh electromagnetic field enables the capability to work under harsh conditions.

Specification

Interfaces

WAN Interfaces

Ethernet WAN: Static IP/PPPoE/DHCP Client
 Cellular WAN: HSPA+: 21Mbps (DL)/5.76Mbps (UL)
 GSM/GPRS/EDGE: 850/900/1800/1900 MHz
 UMTS /HSPA/HSPA+: 850/900/1900/2100 MHz

LAN Interfaces

Auto Adaption: 4 10M/100M Ethernet ports, auto-adaptive MDI/MDI-X auto crossover
 Isolation Protection: 1.5KV isolation protection

Power supply

9-26V DC 5.08mm 2pin Terminal power supply

Serial ports

Number: 1 RS232/RS485 DB9
 Protocol: Modbus RTU, Transparent TCP, Virtual COM

Environmental

Operating temperature: -20°C~70°C

Storage temperature: -40°C ~85°C

Humidity: 5%~95%, no-condensing

Protection grade: IP40

EMC

ESD: EN61000-4-2

Surge: EN61000-4-5

EFT: EN61000-4-4

RF: EN61000-4-3

RC: EN61000-4-6

Oscillatory Wave Immunity: EN61000-4-12

Variation Magnetic Field Immunity: EN61000-4-8

Safety

Anti-shock: IEC60068-2-27

Anti-drop: IEC60068-2-32

Anti-vibration: IEC60068-2-6

Reliable Network Link

Built-in hardware watchdog, self-recovery

PPP link detection disaster self-recovery

Professional upgrades mechanism, assure upgrade safety

Firewall security service

State Packet Inspection, anti-DoS attacks, Filter multicast
Filter ping, Access control list

Configuration

DB9 Console port, Telnet, and Web configuration

Upgrade

Remote upgrade and web upgrade, utilizing redundant backup mechanism for worry-free upgrade

Network Function

Network Address Translation (NAT) and Port Address Translation (PAT)
Deny illegitimate host access

TCP/IP Protocols

ICMP, IP, TCP, UDP, DHCP, PPP, ARP, Telnet, DNS, VRRP, HTTP, HTTPS, VPN
(IPSec/SSL/PPTP/L2TP/GRE)

Installation

Optional Wall mounting kits or DIN mounting Kits

Warranty

Warranty Period: 1 year, for more period please contact InHand sales

Dimensions (Unit: mm)

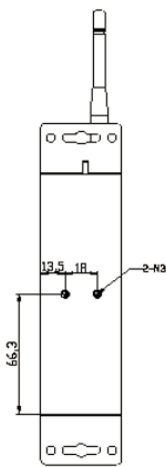

Back View

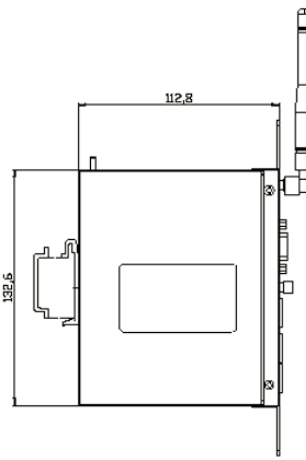

Side View

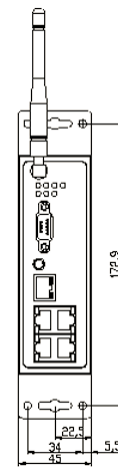

Front View

DB9 RS232 /RS485 Port

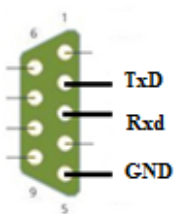

RS232

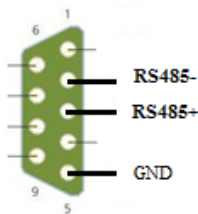

RS485

Device Manager Cloud

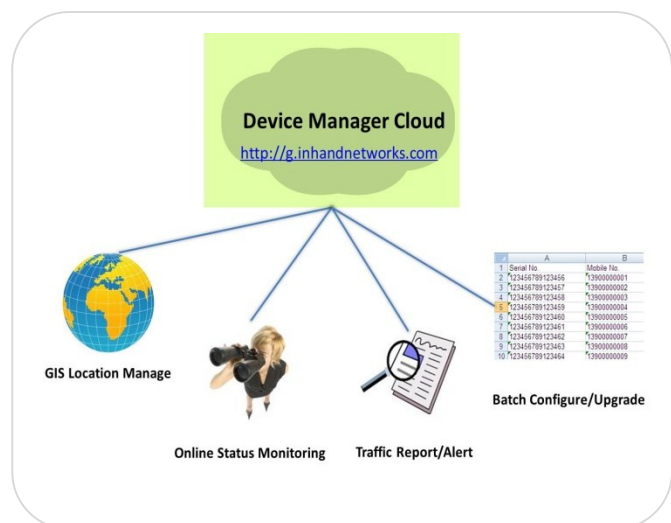

Order Information

Model	IR6x5
Part Number	IR6<X>5-<N>-<P>-<S>
X (Option VPN)	0 : standard router; 9 : VPN, support IPSec/SSL/PPTP/L2TP/GRE
N (Network)	UE00 : No wireless module WH01 : UMTS/HSDPA (850/900/1900/2100 MHz) VZ16 :CDMA2000 EVDO\1X(800MHz/1900MHz/2100MHz) VZ01 : EVDO(800MHz/1900MHz. for China/India only) PH01 :HSPA+ (850/900/1900/2100 MHz)
S (Serial port)	<NA> : RS232 485 : RS485
Example	IR6 9 5 WH01 : UMTS/HSDPA, Support VPN(IPSec/SSL/PPTP/L2TP/GRE) , RS232 serial port

FCC Warning Statement

FCC STATEMENT

1. This device complies with Part 15 of the FCC Rules. Operation is subject to the following two conditions:

- (1) This device may not cause harmful interference.
- (2) This device must accept any interference received, including interference that may cause undesired operation.

2. Changes or modifications not expressly approved by the party responsible for compliance could void the user's authority to operate the equipment.

NOTE: This equipment has been tested and found to comply with the limits for a Class B digital device, pursuant to Part 15 of the FCC Rules. These limits are designed to provide reasonable protection against harmful interference in a residential installation.

This equipment generates uses and can radiate radio frequency energy and, if not installed and used in accordance with the instructions, may cause harmful interference to radio communications. However, there is no guarantee that interference will not occur in a particular installation. If this equipment does cause harmful interference to radio or television reception, which can be determined by turning the equipment off and on, the user is encouraged to try to correct the interference by one or more of the following measures:

- Reorient or relocate the receiving antenna.
- Increase the separation between the equipment and receiver.
- Connect the equipment into an outlet on a circuit different from that to which the receiver is

connected.

Consult the dealer or an experienced radio/TV technician for help.

FCC Radiation Exposure Statement

This equipment complies with FCC radiation exposure limits set forth for an uncontrolled environment. This equipment should be installed and operated with minimum distance 20cm between the radiator & your body



Connecting Devices, Enabling Services

info@inhandnetworks.com