

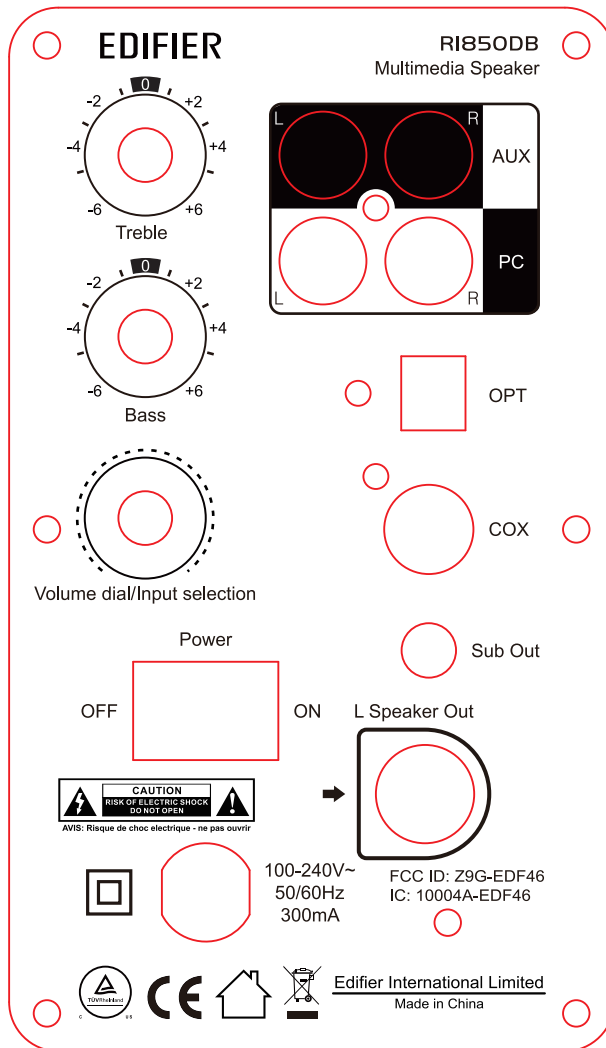

FCC statement:

"This device complies with Part 15 of the FCC Rules. Operation is subject to the following two conditions: (1) this device may not cause harmful interference, and (2) this device must accept any interference received, including interference that may cause undesired operation."

IC statement: CAN ICES-3(B)/NMB-3(B).



黑色, 丝印PAN 425C

物料名称	物料编码	版本号
R1850DB出口后面板	MP-001-R1850D-00	V1.0

文件编号	EDF/JS-TSY-	版次	A0
文件名称	R1850DB出口后面板		
绘制			
审核			
批准			

东莞市漫步者  
科技有限公司