

TOSHIBA

TY-SBX130B

Sound Bar

Operation Manual

5020501



Safety precautions

The information you need to prevent danger to the user and other people as well as property damage is described below. “Description of signs” shows different categories of the degree of danger or damage that may occur due to wrong handling. “Description of symbols” shows the meaning of the symbols.

Important notes

- This book is only a guide for user's operation, not a criterion for configuration.
- Only use attachments/accessories specified by the manufacturer.



The lightning flash is intended to alert the user to the presence of dangerous voltage within the product's enclosure, and touching the internal components may result in a risk of electric shock to persons.



The exclamatory mark is intended to alert the user to the presence of important operating instructions.



To reduce the risk of electric shock or fire, do not open the cover. Refer servicing to qualified service personnel.

Description of signs



WARNING

Indicates that there is a risk of death or serious injury.



CAUTION

Indicates that there is a risk of light injury or property damage.

Description of symbols



Indicates “Prohibition” or “You must not do” with pictures and text.



Indicates “Mandatory Action” or “Do as indicated” with pictures and text.

What to do in the case of an abnormality

WARNING

- **Stop using the device immediately in case of an abnormality or failure.**
- **Remove the USB cable immediately when water or any foreign object enters the interior of the device. It may cause a fire or electric shock. Remove the USB cable immediately, and contact your dealer for a repair.**

Usage

WARNING

To reduce the risk of fire, electric shock or product damage,

- **Do not disassemble, repair, or modify the unit. Refer servicing to qualified service personnel.**
- **Do not step on, throw, or drop battery or the power supply or unit, or expose them to a strong shock.**



- **Do not throw the unit into fire. The battery could explode causing injury or death.**
- **Do not install this unit in a confined or built-in space such as a book case or similar unit, and keep well-ventilated conditions. The ventilation should not be impeded by covering the ventilation openings with items such as newspaper, table-cloths, curtains etc.**
- **Do not expose this unit to rain, moisture, dripping or splashing.**
- **Do not place objects filled with liquids, such as vases, on this unit.**



- **Place the unit on a flat surface away from sources of direct sunlight or excessive heat.**
- **The unit is not for use by children, and keep it out of reach of children.**

Battery

WARNING



DO NOT INGEST BATTERY, CHEMICAL BURN HAZARD

- **The remote control supplied with this product contains a coin/button cell battery. If the coin/button cell battery is swallowed, it can cause severe internal burns in just 2 hours and lead to death. Keep new and used batteries away from children. If the battery compartment does not close securely, stop using the product and keep it away from children. If you think batteries might have been swallowed or placed inside any part of the body, seek immediate medical attention.**



- **Danger of explosion if battery is incorrectly replaced.**
- **Replace only with the same or equivalent type.**
- **The battery (batteries or battery pack) must not be exposed to excessive heat such as sunshine, fire or the like.**

Important Safety Instructions

- 1 **Read these instructions** - All the safety and operating instructions should be read before this product is operated.
- 2 **Keep these instructions** - The safety and operating instructions should be retained for future reference.
- 3 **Heed all warnings** - All warnings on the appliance and in the operating instructions should be adhered to.
- 4 **Follow all instructions** - All operating and use instructions should be followed.
- 5 **Do not use this apparatus near water** - The appliance should not be used near water or moisture - for example, in a wet basement or near a swimming pool and the like.
- 6 Clean only with a dry cloth.
- 7 Do not block any ventilation openings. Install in accordance with the manufacturer's instructions.
- 8 Do not install near any heat sources such as radiators, heaters, stoves, or other apparatus (including amplifiers) that produce heat.
- 9 Do not defeat the safety purpose of the polarized or grounding-type plug. A polarized plug has two blades with one wider than the other. A grounding type plug has two blades and a third grounding prong. The wide blade or the third prong is provided for your safety. If the provided plug does not fit into your outlet, consult an electrician for replacement of the obsolete outlet.
- 10 Protect the power cord from being walked on or pinched, particularly at plugs, convenience receptacles and at the point where they exit from the apparatus.
- 11 Only use attachments/accessories specified by the manufacturer.
- 12 Use only with the cart, stand, tripod, bracket, or table specified by the manufacturer, or sold with the apparatus. When a cart or rack is used, use caution when moving the cart/apparatus combination to avoid injury from tip-over. 
- 13 Unplug the apparatus during lightning storms or when unused for long periods of time.
- 14 Refer all servicing to qualified personnel. Servicing is required when the apparatus has been damaged in any way, such as power supply cord or plug is damaged, liquid has been spilled or objects have fallen into the apparatus, the unit has been exposed to rain or moisture, does not operate normally, or has been dropped.
- 15  This equipment is a Class II or double insulated electrical appliance. It has been designed in such a way that it does not require a safety connection to electrical earth.
- 16 The apparatus shall not be exposed to dripping or splashing. No objects filled with liquids, such as vases, shall be placed on the apparatus.
- 17 Minimum distance around the apparatus for sufficient ventilation is 5 cm.
- 18 The ventilation should not be impeded by covering the ventilation openings with items, such as newspapers, table-cloths, curtains, etc...
- 19 No naked flame sources, such as lighted candles, should be placed on the apparatus.

- **The mains plug/appliance coupler is used as the disconnect device, the disconnect device must remain readily operable.**
- **The rating label is pasted on the bottom or back of the equipment.**

FCC Statement :

This device complies with Part 15 of the FCC Rules. Operation is subject to the following two conditions:

1) This device may not cause harmful interference, and 2) This device must accept any interference received, including interference that may cause undesired operation.

Note: This equipment has been tested and found to comply with the limits for a Class B digital device, pursuant to part 15 of the FCC Rules. These limits are designed to provide reasonable protection against harmful interference in a residential installation. This equipment generates, uses, and can radiate radio frequency energy and, if not installed and used in accordance with the instructions, may cause harmful interference to radio communication. However, there is no guarantee that interference will not occur in a particular installation. If this equipment does cause harmful interference to radio or television reception, which can be determined by turning the equipment off and on, the user is encouraged to try to correct the interference by one or more of the following measures:

- Reorient or relocate the receiving antenna.
- Increase the separation between the equipment and receiver.
- Connect the equipment into an outlet on a circuit different from that to which the receiver is connected.
- Consult the dealer or an experienced radio/TV technician for help.

IC-CANADA :

This device contains licence-exempt transmitter(s)/receiver(s) that comply with Innovation, Science and Economic Development Canada's licence-exempt RSS(s). Operation is subject to the following two conditions:

- (1) This device may not cause interference.
- (2) This device must accept any interference, including interference that may cause undesired operation of the device.

FCC&IC-Caution:

- **Changes or modifications not expressly approved by the party responsible for compliance could void the user's authority to operate the equipment.**
- **This equipment complies with FCC and IC radiation exposure limits set forth for an uncontrolled environment. This equipment should be installed and operated with minimum distance 20cm between the radiator & your body.**

California Prop 65 Warning :



This product can expose you to chemicals including Lead, which is known to the State of California to cause cancer. For more information go to: www.P65Warnings.ca.gov.

Disclaimer

- Toshiba shall not be responsible for any damage caused by an earthquake, thunderstorm, flood damage, fire for which Toshiba is not responsible, acts of a third party, other accidents, or damages caused by the user's willful acts or negligence, misuse, or use in abnormal conditions.
- Toshiba shall not be responsible for any damage caused by failure to observe the information described in the operation manual.

Disposal

- **When disposing of this device, observe the laws, or ordinances and rules of the local government.**
- **When disposing of the battery, make a request to a recycle agency for disposal.**

About using Bluetooth®

This unit is designed for use with Bluetooth® wireless devices compatible with the HFP, HSP, A2DP and AVRCP streaming audio profiles. Refer to your Bluetooth® device's user manual or technical support to determine if your Bluetooth® device supports these profiles.

Frequency band used

This unit uses the 2.4 GHz frequency band. However other wireless devices may use 2.4 GHz frequency band as well and may cause interference with each other. To avoid interference, please refrain from the use of the unit at the same time with other wireless devices.

Certification of this device

This unit conforms to frequency restrictions and has received certification based on frequency laws, so a wireless permit is not necessary.

However, the following action is punishable by law in some countries:

- Taking apart/modifying the unit.

Usage restrictions

- Wireless transmission and/or use with all Bluetooth® equipped devices is not guaranteed.
- A device featuring the Bluetooth® function is required to conform to the Bluetooth® standard specified by Bluetooth SIG, and be authenticated. Even if the connected device conforms to the above mentioned Bluetooth® standard, some devices may not be connected or work correctly, depending on the features or specifications of the device.

Range of use

Use this device within an unobstructed 10 m range. The range of use or perimeter may be shortened depending on any obstructions, devices causing interference, other people in the room, or the construction of the building. Please note that the range mentioned above is not guaranteed.

The Bluetooth® word mark and logos are owned by the Bluetooth SIG, Inc. and are used under license.

Note

- This unit may receive radio interference caused by mobile telephones during use. If such interference occurs, please increase separation between this unit and the mobile telephone.

Placement and mounting

Wall mounting

Note

- Installation must be carried out by qualified personnel. Incorrect assembly can result in severe personal injury and property damage (if you intend to install this product yourself, you must check for installations such as electrical wiring and plumbing that may be buried inside the wall). It is the installer's responsibility to verify that the wall will safely support the total load of the Main Unit and wall brackets.
- Additional tools (not included) are required for the installation.
- Do not overtighten screws.
- Keep this operation manual for future reference.
- Use an electronic stud finder to check the wall type before drilling and mounting.

1. Remove the screws from the Main Unit.

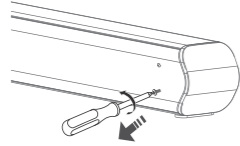

2. Attach the wall brackets to the Main Unit with the screws removed from the Main Unit.

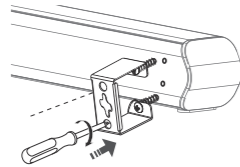

3. Drill 2 parallel holes (Ø 3 - 8 mm each according to wall type) in the wall. The distance between the holes should be 760 mm.

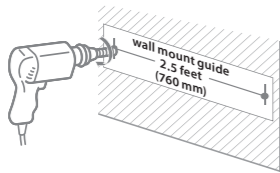

4. Firmly fix 1 dowel into each hole in the wall if necessary.

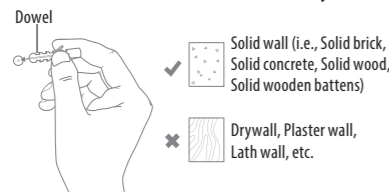

5. Leave a 5 mm gap between the wall and the screw's head. Lift the Main Unit with the attached wall brackets over the heads of the screws and slot into place.

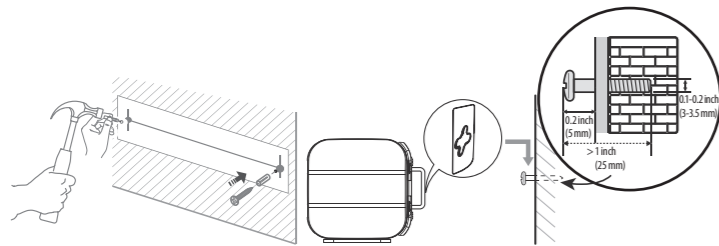

Identifying the parts

Terminals of the Main Unit

AC~	AC power plug	Connect an AC power cord.
AUX 1	AUX socket	Connect to an external audio device.
OPTICAL	OPTICAL socket	Connect a digital optical cable.
SERVICE ONLY	SERVICE ONLY socket	The USB socket is for service only. It is not designed to charge smartphones, tablets or similar devices.

Indicators and buttons of the Main Unit

LED indicators		Indicates the current mode. Indicator color: STANDBY : Red AUX : Green OPTICAL : Orange Bluetooth® : Blue
	Power button	Switch the unit between ON and STANDBY mode.
	Function button	Select a mode AUX, OPTICAL or Bluetooth.
	EQ button	Select a preset sound effect (NEWS, MOVIE, or MUSIC)
	Volume +/- buttons	Increase/decrease the volume level.

Remote control

	Power button	Switch the unit between ON and STANDBY mode.
	MUTE button	Mute or resume the sound.
	Function buttons	Select the play function.
	Volume +/- buttons	Increase/decrease the volume level.
	EQ buttons	Select a preset sound effect.
	Play/Pause/Pairing button	Play/pause playback in Bluetooth® mode. Press and hold to activate the pairing function in Bluetooth® mode or disconnect the existing paired Bluetooth® device.
	Fast forward/backward buttons	Skip to next/previous track in Bluetooth® mode.

Information:

- Remove the protective tab to activate the remote control battery before use.
- Use a CR2025 lithium battery for the remote control. When replacing the battery, remove it and place a CR2025 lithium battery into the battery tray with correct polarity (+/-) as engraved on the remote control rear panel. There is a risk of injury due to fire, explosion or leakage if the battery is not replaced, used, handled or disposed of properly. Dispose of the used battery immediately as required by local regulations. Do not disassemble, charge, crush the battery or expose it to fire or high temperature.

Power supply

1. Insert the supply plug of the attached AC power cord fully into AC power plug on the back.
2. Insert the power plug into an AC outlet.

Basic operation

Information:

- The operations of the buttons on the remote control are explained in this manual. Refer to "Identifying the parts" in "Indicators and buttons of the Main Unit", regarding the operation buttons on the main unit.

Turning on/off the power

Press the button.

When the power is on, the standby indicator (red) will go off and one of the function indicators will light up.

When the power is off, the standby indicator (red) will light up.

Information:

- **Auto power off**
When the unit has no input signal (or weak input signal) for over 30 minutes, it will automatically switch off.

Adjusting the volume

Press VOL +/VOL - button.
Press MUTE button.

Select a mode

Press Function button, or Press the AUX, OPTICAL, or BT (Bluetooth®) button to select the desired mode.

Select a preset sound effect

While playing, press the EQ button, or press the NEWS, MOVIE, or MUSIC button to select the desired sound effect.

AUX/OPTICAL operation

1. Ensure that the unit is connected to the TV or audio device.
2. Press the AUX or OPTICAL button to select the desired mode.

Note

- While the unit is in OPTICAL mode, if there is no sound output and the OPTICAL indicator on the unit flashes, you may need to activate PCM signal output on your source device (e.g. TV, DVD or Blu-ray player).

Information:

- Operate your audio device directly for playback features.

Bluetooth® operation

Pairing:

1. Press the BT button to select Bluetooth® mode.

The blue indicator will light flash.

2. The unit has entered pairing mode.

- Or press and hold the button.

The blue indicator will flash rapidly and the unit has entered pairing mode.

3. Activate your Bluetooth® device and select the search mode.

"TY-SBX130B" will appear on your Bluetooth® device list.

4. Select "TY-SBX130B" in the pairing list.

After the "Pairing" voice prompt, the unit is successfully connected and the blue indicator will light up solidly.

Information:

- Enter "0000" for the password if necessary.

Playing Bluetooth® music:

1. Pair your device with the unit.
2. Play music via your device (by pressing the , , or button).

Specifications

Bluetooth®	
Bluetooth® spec.	Version 5.1
Wireless equipment classification	Class 2
Supported profile	A2DP, AVRCP
Frequency range	2.402 - 2.480 GHz (2.4 GHz ISM Segment)
Service distance	Up to 10 m
Main Unit	
Power supply	AC 100-240 V~ 50/60 Hz
Power consumption	15 W
Output power	13 W x 2
Audio input sensitivity	500 mV
Frequency response	40 Hz - 20 kHz
Speaker impedance	8 Ω x 2
Dimension (W x H x D)	800 x 60 x 63 mm
Weight	1.3 kg

Accessories

AC power cord x 1, Remote control x 1, 3.5 mm to 3.5 mm audio cable x 1, 3.5 mm - RCA audio cable x 1, Wall bracket x 2, Screw x 2, Dowel x 2, Operation manual x 1

The specifications may be changed without prior notice to improve product performance. The images included in this guide may differ from the actual image and may change without notice.