

onn.TM

USER GUIDE

2.1CH Soundbar with Subwoofer

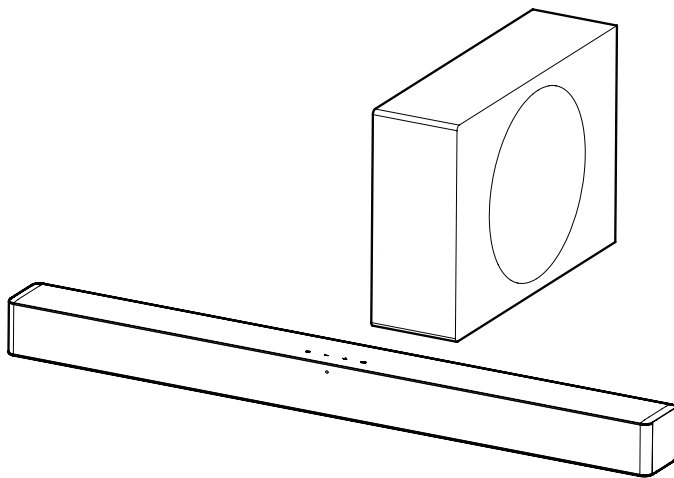

100130683_EN_06072023

Contents & Information

Contents & Information

Overview

Safety Precautions

Unpacking

Wall Mounting Setup (Optional)

Assembly

Operation

Cleaning & Care

Specifications

Troubleshooting

Features

- 2.1 Channels
- Roku TV Ready™
- Bluetooth®
- 2 Internal speakers + 1 wireless subwoofer
- 120 W RMS output / 480 W peak output (4 x RMS)
- Dolby Audio™ (supporting Dolby Digital Plus™)

Connections

- 1 x HDMI® (ARC)
- 1 x Optical
- 1 x AUX
- 1 x USB

Overview

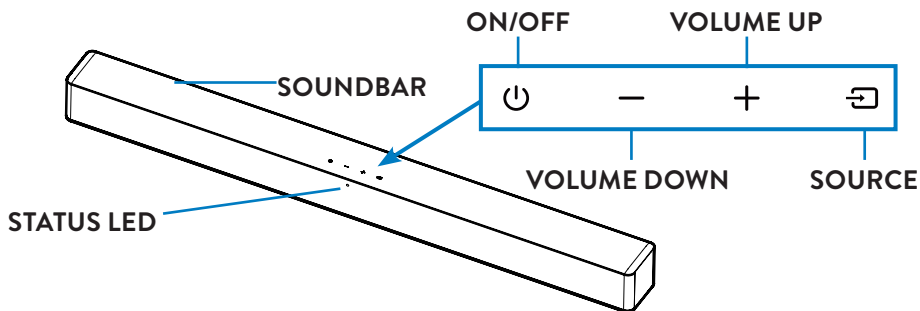

Standby	Solid Red
HDMI (ARC)	Solid Yellow
Optical	Solid Purple
Aux in	Solid White
USB	Solid Green
Bluetooth pairing mode	Flashing Blue
Bluetooth device connected	Solid Blue
Volume up/down	Corresponding source color flash 1 time
Maximum/minimum volume	Corresponding source color flash 3 times
Mute	Flashing Red
Talk	Corresponding source color flash 1 time
Music	Corresponding source color flash 3 times
Movie	Corresponding source color flash 5 times
Bass +/-	White Status LED flash 2 times

SUBWOOFER BACK

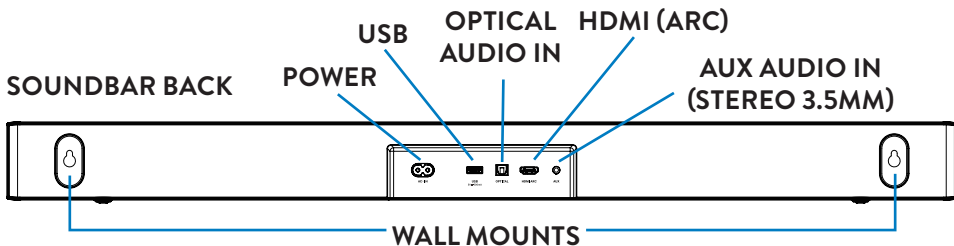
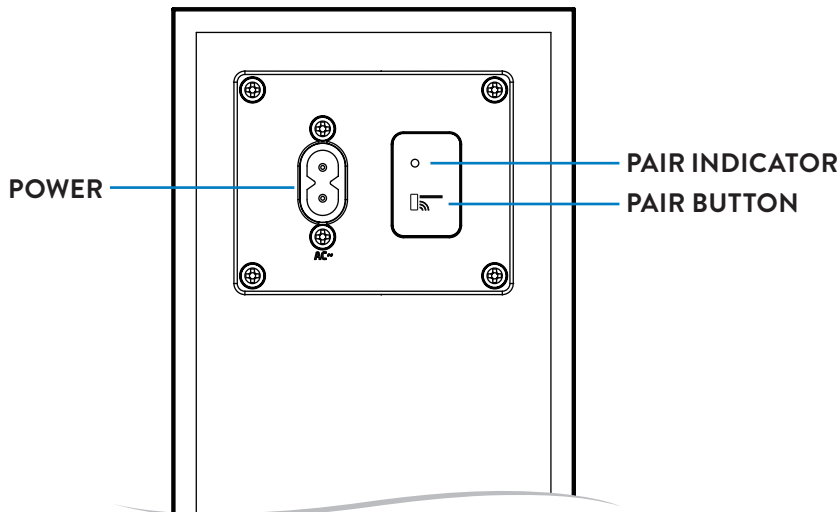

REMOTE CONTROL

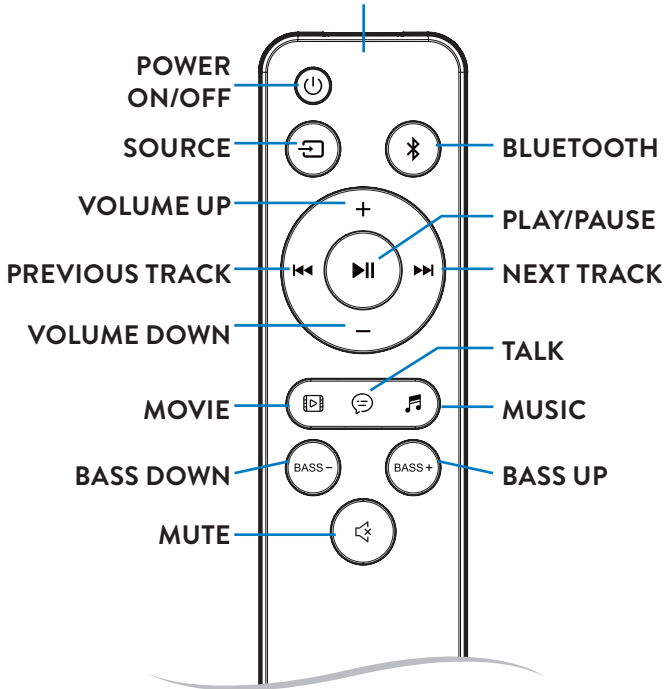

Safety Precautions



WARNING

- Read these instructions – All safety and operating instructions should be read before product is operated.
- Keep these instructions – The safety and operating instructions should be retained for future reference.
- Heed all warnings – All warnings on appliance and in operating instructions should be adhered to.
- All operating and use instructions should be followed.
- Do not use this apparatus near water – Appliance should not be used near water or moisture – for example, in a wet basement or near a swimming pool, etc.
- Do not block any ventilation openings. Install in accordance with manufacturer's instructions.
- Do not install near any heat sources such as radiators, heat registers, stoves, or other apparatus (including amplifiers) that produce heat.
- Do not defeat the safety purpose of the polarized or grounding plug. A polarized plug has two blades with one wider than the other. A grounding plug has two blades and a third grounding prong. The wide blade or the third prong is provided for your safety. If the provided plug does not fit into your outlet, consult an electrician for replacement of the obsolete outlet.
- Protect power cord from being walked on or pinched particularly at the plugs, convenience receptacles, and at the point where they exit from the apparatus.
- Only use attachments/accessories specified by the manufacturer.
- Use only with the cart, stand, tripod, bracket, or table specified by the manufacturer, or sold with the apparatus. When a cart or rack is used, use caution when moving the cart/ apparatus combination to avoid injury from tip-over.
- Unplug apparatus during lightning storms or when unused for long periods of time.

- Refer all servicing to qualified personnel. Servicing is required when apparatus has been damaged in any way, such as power supply cord or plug is damaged, liquid has been spilled or objects have fallen into apparatus. Apparatus has been exposed to rain or moisture, does not operate normally, or has been dropped.
- Maintain ventilation around equipment. Do not install in a confined space such as a book case or similar unit. Do not cover the ventilation openings with items such as newspaper, table-cloths, curtains etc.
- This equipment is a Class II or double insulated electrical appliance. It has been designed in such a way that it does not require a safety connection to electrical earth.
- The equipment shall be used at maximum 35 degree C ambient temperature.
- Do not replace a battery with an incorrect type that can defeat a safeguard (for example, in the case of some lithium battery types).
- Do not dispose of a battery in a fire or a hot oven. Do not mechanically crush or cut a battery. These conditions can result in an explosion.
- Leaving a battery in an extremely high temperature environment can result in an explosion or the leakage of flammable liquid or gas.
- A battery subjected to extremely low air pressure may result in an explosion or the leakage of flammable liquid or gas. To reduce the risk of fire or electric shock, do not expose this apparatus to rain or moisture. The apparatus shall not be exposed to dripping, splashing or objects filled with liquids, such as vases, etc.
- The mains plug is used as disconnect device, the disconnect device shall remain readily operable.
- To reduce the risk of electric shock, do not remove cover (or back) as there are no user-serviceable parts inside. Refer servicing to qualified personnel.
- To prevent injury, this apparatus must be securely attached to the floor/ wall in accordance with the installation instructions.
- Danger of explosion if the remote control batteries are incorrectly replaced. Replace only with the same or equivalent type.

FCC Statement :

This device complies with Part 15 of the FCC Rules. Operation is subject to the following two conditions: 1) This device may not cause harmful interference, and 2) This device must accept any interference received, including interference that may cause undesired operation.

Note: This equipment has been tested and found to comply with the limits for a Class B digital device, pursuant to part 15 of the FCC Rules. These limits are designed to provide reasonable protection against harmful interference in a residential installation. This equipment generates, uses and can radiate radio frequency energy and, if not installed and used in accordance with the instructions, may cause harmful interference to radio communication. However, there is no guarantee that interference will not occur in a particular installation. If this equipment does cause harmful interference to radio or television reception, which can be determined by turning the equipment off and on, the user is encouraged to try to correct the interference by one or more of the following measures:

- Reorient or relocate the receiving antenna.
- Increase the separation between the equipment and receiver.
- Connect the equipment into an outlet on a circuit different from that to which the receiver is connected.
- Consult the dealer or an experienced radio/TV technician for help.

IC-CANADA: CAN ICES-3(B)/NMB-3(B):

This device contains licence-exempt transmitter(s)/receiver(s) that comply with Innovation, Science and Economic Development Canada's licence-exempt RSS(s). Operation is subject to the following two conditions:

- This device may not cause interference.
- This device must accept any interference, including interference that may cause undesired operation of the device.

FCC Caution:

- Changes or modifications not expressly approved by the party responsible for compliance could void the user's authority to operate the equipment.
- This equipment complies with FCC and IC radiation exposure limits set forth for an uncontrolled environment. This equipment should be installed and operated with minimum distance 20cm between the radiator & your body.
- Shielded cables must be used with this unit to ensure compliance with the Class B FCC limits.

California Prop 65 Warning :

 **WARNING**

This product can expose you to chemicals including Lead, which is known to the State of California to cause cancer.

For more information go to: www.P65Warnings.ca.gov.

AVERTISSEMENTS

- Lire ces consignes – Lire toutes les consignes de sécurité et de fonctionnement avant d'utiliser cet appareil.
- Conserver ces consignes – Conserver les consignes de sécurité et de fonctionnement pour référence ultérieure.
- Respecter tous les avertissements – Respecter tous les avertissements sur l'appareil et toutes les consignes de fonctionnement.
- Suivre toutes les consignes – Suivre toutes les consignes d'utilisation et de fonctionnement.
- Ne pas utiliser cet appareil à proximité de l'eau – Ne pas utiliser cet appareil à proximité de l'eau ou près de toute source d'humidité comme un sous-sol humide ou à proximité d'une piscine ou de tout autre endroit similaire.
- Ne pas obstruer les ouvertures de ventilation. Installer l'appareil selon les consignes du fabricant.
- Ne pas installer près d'une source de chaleur comme un radiateur, un appareil de chauffage, une cuisinière ou tout autre appareil (dont les amplificateurs) produisant de la chaleur.
- Ne pas neutraliser le dispositif de sécurité de la fiche polarisée ou de la fiche de mise à la terre. Une fiche polarisée comprend deux lames dont l'une est plus large que l'autre. Une fiche de mise à la terre a deux lames et une broche de terre. La large lame ou la troisième broche sont fournies pour votre sécurité. Si la fiche fournie ne s'insère pas dans votre prise, consulter un électricien pour remplacer la prise obsolète.
- Pour éviter que le cordon d'alimentation ne se fasse piétiner ou coincer, porter une attention particulière aux fiches, à la proximité des prises de courant et aux points de sortie de l'appareil.
- Utiliser uniquement les ajouts / accessoires spécifiés par le fabricant.
- Utiliser uniquement avec les chariots, socles, trépieds, supports, ou tables recommandés par le fabricant ou vendus avec l'appareil. Si un chariot ou un support est utilisé, s'assurer d'effectuer le déplacement avec précaution pour éviter des blessures dues au basculement de l'une ou l'autre des unités.
- Débrancher l'appareil pendant les orages ou lorsqu'il n'est pas utilisé pendant de longues périodes.

- Confier toute réparation à un personnel qualifié. Une réparation est requise si l'appareil est endommagé d'une quelconque façon, lorsque le cordon d'alimentation ou la fiche sont endommagés, si du liquide s'est déversé ou si un objet est tombé sur l'appareil, si l'appareil a été exposé à la pluie ou à l'humidité, si l'appareil ne fonctionne pas normalement ou s'il est tombé.
- Ne pas obstruer les ouvertures d'aération en plaçant des objets comme des journaux, des nappes, des rideaux, etc., sur l'appareil ou à proximité de celui-ci.
- Cet équipement est un appareil électrique à double isolation de catégorie II. Il a été conçu de manière à ne pas nécessiter de branchement de sécurité de mise à la terre.
- L'équipement doit être utilisé à une température ambiante maximale de 35 degrés C.
- Ne remplacez pas une batterie par un type incorrect qui peut mettre en échec une sauvegarde (par exemple, dans le cas de certains types de batteries au lithium).
- Ne jetez pas de batterie dans un feu ou un four chaud. Ne pas écraser ou couper mécaniquement une batterie. Ces conditions peuvent entraîner une explosion.
- Laisser une batterie dans un environnement à température extrêmement élevée peut entraîner une explosion ou la fuite de liquide ou de gaz inflammable.
- Une batterie soumise à une pression d'air extrêmement basse peut entraîner une explosion ou la fuite de liquide inflammable ou de gaz. To réduire le risque d'incendie ou de décharge électrique, ne pas exposer cet appareil à la pluie ou à l'humidité. L'appareil ne doit pas être exposé à l'égouttement, aux éclaboussures ou aux objets remplis de liquides, tels que des vases, etc.
- La prise électrique ou le coupleur de l'appareil sont utilisés comme dispositif de débranchement, ils doivent toujours être facilement manœuvrables.
- Pour réduire le risque de choc électrique, ne retirez pas le couvercle (ou le dos) car il n'y a pas de pièces utilisables à l'intérieur. Référez l'entretien à du personnel qualifié.
- Pour éviter les blessures, cet appareil doit être solidement fixé au sol/ mur conformément aux instructions d'installation.
- Danger d'explosion si la pile est remplacée incorrectement. Remplacer uniquement par une pile identique ou de type équivalent.

Déclaration de la FCC :

Cet appareil est conforme à la section 15 des normes de la FCC. Le fonctionnement est soumis aux deux conditions suivantes : 1) cet appareil ne doit pas causer d'interférences nuisibles, et 2) cet appareil doit accepter toute interférence reçue, y compris celles pouvant entraîner un fonctionnement indésirable.

Remarque: Cet équipement a été testé et déclaré conforme aux limitations pour appareils numériques de classe B selon la section 15 des règlements de la FCC. Ces limitations sont destinées à assurer une protection raisonnable contre les interférences nuisibles dans une installation résidentielle. Cet équipement génère, utilise et peut émettre de l'énergie de fréquence radio et, s'il n'est pas installé et utilisé conformément aux présentes instructions, il peut causer des interférences nuisibles aux communications radio. Toutefois, rien ne garantit l'absence d'interférences dans une installation particulière. Si cet appareil cause des interférences nuisibles à la réception des signaux de radio ou de télévision, ce qui peut être détecté en allumant et en éteignant l'appareil, on encourage l'utilisateur d'essayer de corriger ces interférences par l'un des moyens suivants:

- Réorientez ou déplacez l'antenne de réception.
- Augmentez la distance séparant l'équipement et le récepteur.
- Branchez l'équipement sur une prise se trouvant sur un circuit différent de celui sur lequel le récepteur est branché.
- Consultez le détaillant ou un technicien radio/télévision pour obtenir de l'aide.

IC-CANADA : CAN ICES-3(B)/NMB-3(B):

L'émetteur/récepteur exempt de licence contenu dans le présent appareil est conforme aux CNR d'Innovation, Sciences et Développement économique Canada applicables aux appareils radio exempts de licence. L'exploitation est autorisée aux deux conditions suivantes:

- L'appareil ne doit pas produire de brouillage.
- L'appareil doit accepter tout brouillage radioélectrique subi, même si le brouillage est susceptible d'en compromettre le fonctionnement.

Mise en garde de FCC et IC:

- Toute modification ou tout changement non expressément approuvés par la partie responsable de la conformité pourraient annuler le droit de l'utilisateur d'utiliser l'équipement.
- Cet équipement est conforme aux limitations d'exposition aux radiations fixées par la FCC et IC pour un environnement non contrôlé. Cet équipement doit être installé et utilisé avec une distance minimale de 20 cm entre le radiateur et votre corps.
- Des câbles blindés doivent être utilisés avec cet appareil pour garantir la conformité aux limitations de la classe B de la FCC.

Avertissement California Prop 65 :

 **AVERTISSEMENT**

Ce produit peut vous exposer à des produits chimiques, dont le plomb, qui est reconnu par l'État de la Californie pour causer le cancer. Pour de plus amples informations, consultez le site: www.P65Warnings.ca.gov.

CAUTION

- Batteries should not be exposed to excessive heat such as sunshine, fire, etc.
- Keep new and used batteries away from children.
- If the battery compartment does not close securely, stop using the product and keep it away from children.
- If you think batteries might have been swallowed or placed inside any part of the body, seek immediate medical attention.

Dolby Audio

- Manufactured under license from Dolby Laboratories. Dolby, Dolby Audio, and the double-D symbol are trademarks of Dolby Laboratories Licensing Corporation.

HDMI[®] HIGH-DEFINITION MULTIMEDIA INTERFACE

- The Adopted Trademarks HDMI, HDMI High-Definition Multimedia Interface, HDMI trade dress and the HDMI Logos are trademarks or registered trademarks of HDMI Licensing Administrator, Inc. in the United States and other countries.

Bluetooth[®]

- The Bluetooth[®] word mark and logos are registered trademarks owned by the Bluetooth SIG, Inc. and any use of such marks by Walmart Inc. is under license. Other trademarks and trade names are those of their respective owners.



- Roku TV, Roku TV Ready, and the Roku TV Ready logo are trademarks of Roku, Inc. This product is Roku TV Ready-supported in the United States. Countries are subject to change. For the most current list of countries in which this product is Roku TV Ready-supported, please email rokutvready@roku.com.

Unpacking

PARTS

Part	Description	Qty
1	Soundbar	1
2	Subwoofer	1
3	HDMI cable	1
4	Optical cable	1

Part	Description	Qty
5	Power cable	2
6	3.5mm AUX cable	1
7	Remote control (AAA batteries x2)	1
8	Wall mounting kit	1

PARTS DIAGRAM

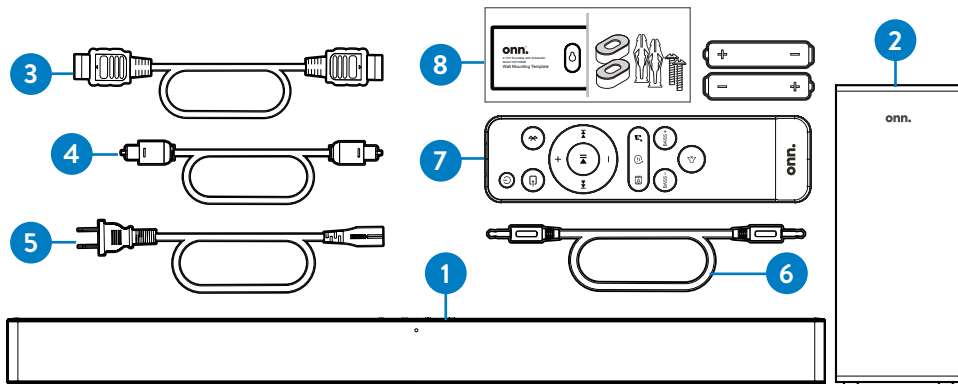

Wall Mounting Setup (Optional)

SETUP

TOOLS NEEDED (NOT SUPPLIED)



Drill bit



Drill



Cross Head Screwdriver

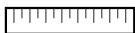

Ruler



Level



Hammer

HARDWARE

Part	Description	Picture	Qty
A	Anchor		2
B	Screws		2
C	Rubber pads		2

onn.
ONN BRAND™
Wall Mounting Template



Wall mounting template



(Wall mounting, optional)

Assembly

ON A SURFACE



1A. CENTER

1. Below TV, close to ear level
2. Go to step 4

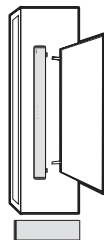
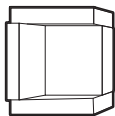

ON A WALL



1B. PLACE

1. Wall mount template on wall under TV.
2. Mark Bracket holes (Ensure enough space between Soundbar and TV) See 3B. HANG.

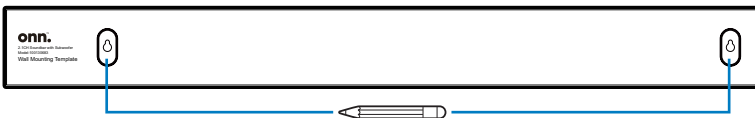
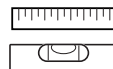

- Be sure screws will be attached to wood studs or use anchors for drywall, or anchors for concrete or brick walls.

ON A WALL



2B. INSTALL

Wallmounts Screws and Anchors (if required)



1. Drill holes

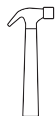

2. Hammer in anchors



3. Screw in screws into anchors

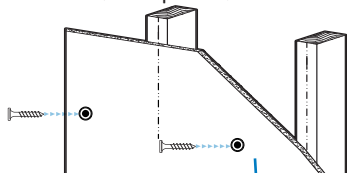

Anchors not needed if screwed into Studs

REQUIRED

(A) Anchors x2



(B) Screws x2



(C) Rubber pads x2

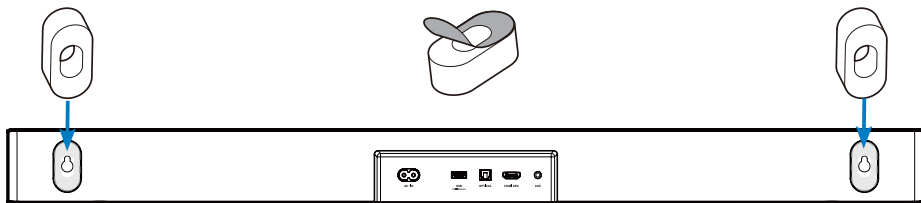

Remove the backing paper from the backs of the rubber pads and stick them to the back of the sound bar in the position shown in the diagram.

CAUTION

If you are unfamiliar with power tools or layout of electrical wiring in the walls of your home, consult a professional installer.

3B. HANG

Mounting hooks on screws then slide down to lock in place.

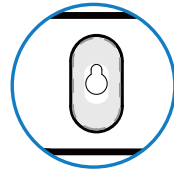
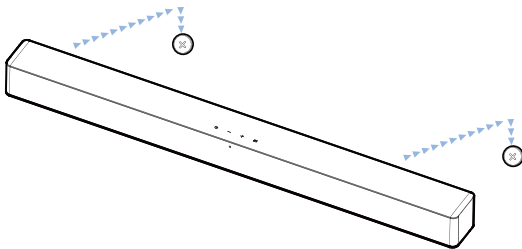

Note: Make sure wall mount orientation matches example

4. CHOOSE CABLE

Connect one cable to Soundbar and TV

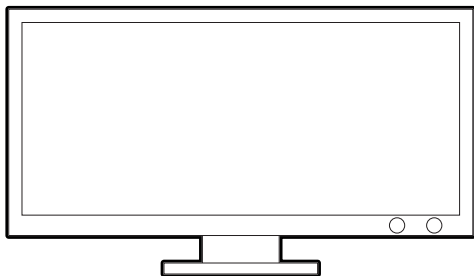
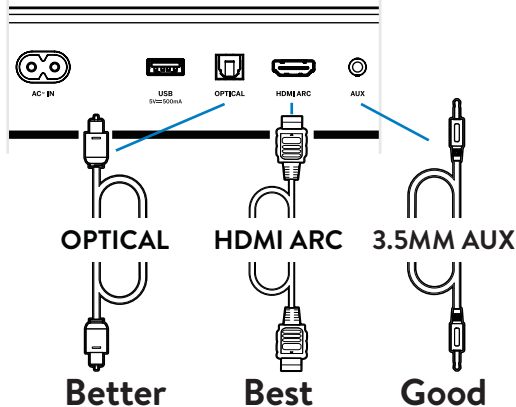

- To Enjoy **Dolby** Audio content, your TV must support the HDMI-CEC and Audio Return Channel (ARC) function.
- Enable CEC and ARC on TV
- Settings for CEC and ARC may differ by TV manufacturer. See TV's user guide for more.
- To control soundbar volume on TV remote, enable System Audio Control in CEC menu.
- CEC Function naming may differ by TV Manufacture. See TV's user guide for more.
- Only HDMI 1.4 cables (and higher) support ARC.
- * If no Audio using Digital Inputs See troubleshooting.

Tip: If you have a Roku TV™, setup is easy. Just use the included cable to connect your soundbar to the HDMI ARC port on your TV and follow the on-screen instructions.

5. CONNECT POWER

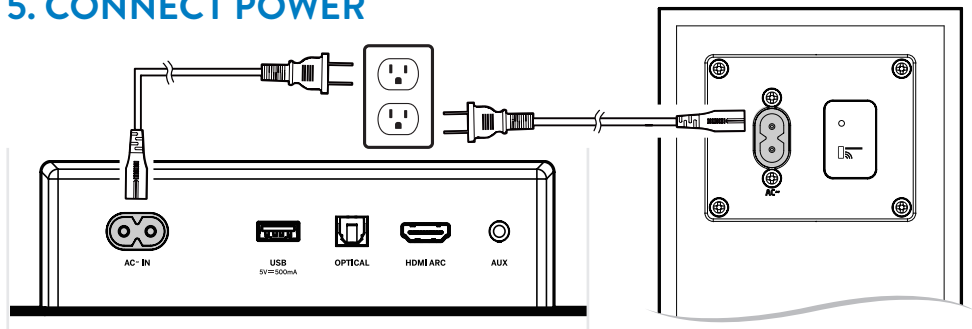

6. INSTALL BATTERIES

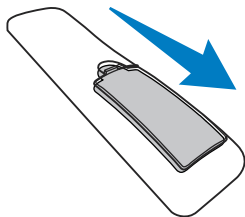

Remove battery door

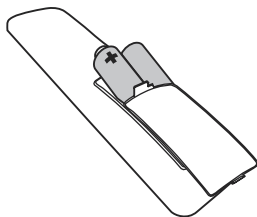

Insert batteries

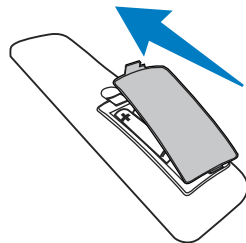

Replace battery door



WARNING

Do not mix old and new batteries.



WARNING

Do not mix alkaline, standard (carbon-zinc) or rechargeable (ni-cad, ni-mh, etc.) batteries.

Operation

Connect Subwoofer



1A. AUTOMATIC PAIRING

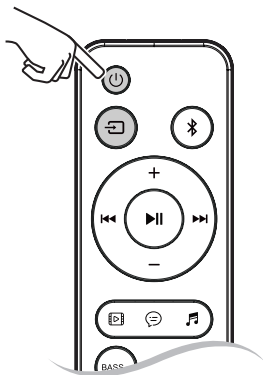

-OR-

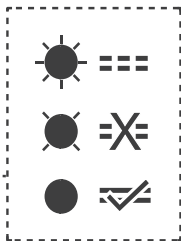
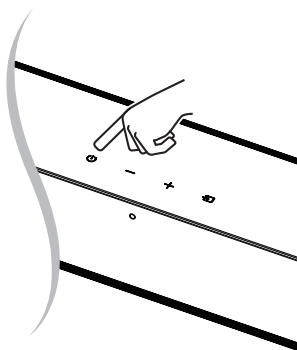

LED State

Status

Quick flash

Subwoofer in pairing mode

Slow flash

Connection/Pairing Failed

Solid

Connected/Pairing successful

Connect Subwoofer



2A. MANUAL PAIRING (IF AUTOMATIC PAIRING FAILED)

A: Press and hold the PAIR button () of the subwoofer.

B: Press the Power button () on the soundbar or on the remote control.

C: When wireless connection is successful, the indicator will be solid orange.

The indicator will flash rapidly.

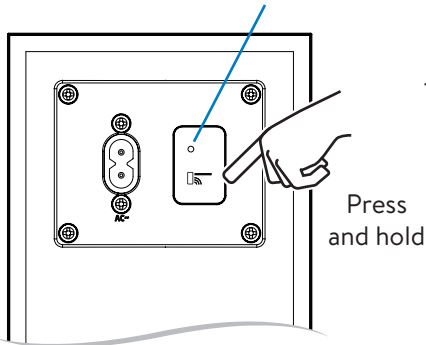

WARNING

The subwoofer is within 5m of the soundbar.

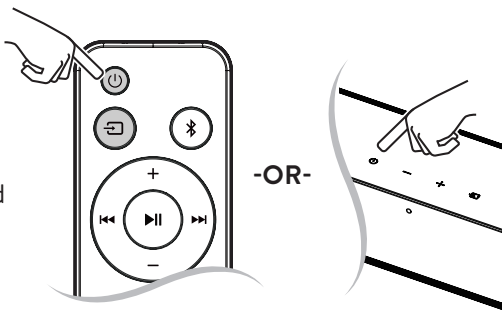

USB Operation



1B. INSERT THE USB DEVICE

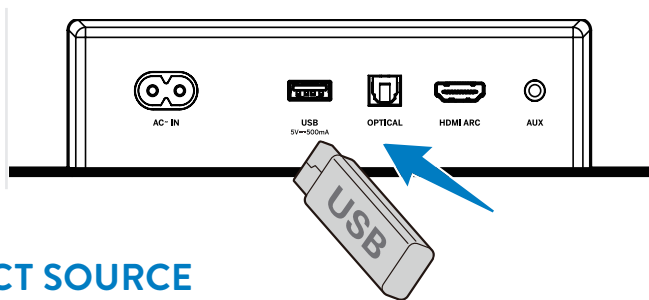



2B. SELECT SOURCE

Select USB Mode

(Remote or Soundbar  button)

3B. PLAY AUDIO

Tip: Support the USB music file format of MP3.

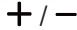
Button	Action
	Play, pause or resume play.
	Skip to the previous or next track.
	Increase/decrease the volume.

Bluetooth® Operation



1C. POWER ON/OFF

Soundbar (Remote or Bar)

ON/OFF

SOURCE

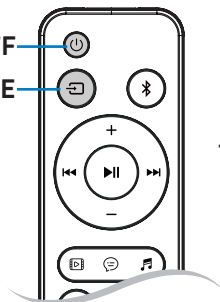

-OR-

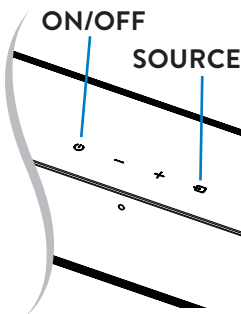

2C. SELECT SOURCE

To switch between audio sources
(Remote or Bar)

3C. PAIR DEVICE

Press and hold the  button on remote.

Press and hold

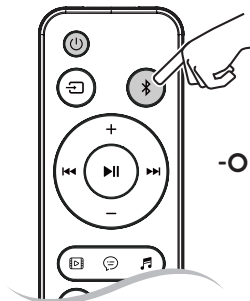

-OR-

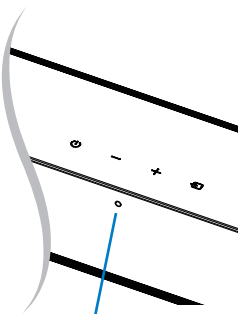

LED flashing blue

4C. SEARCH ON DEVICE

Select “onn. 2.1 Soundbar” on device

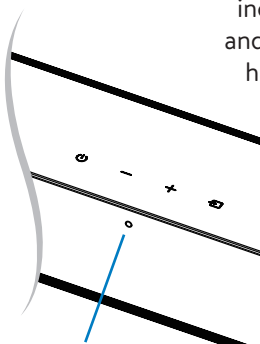
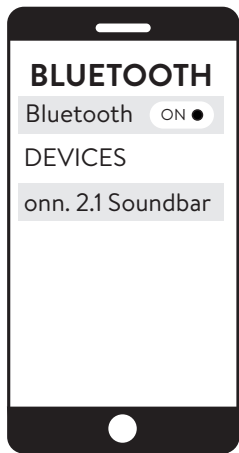

Device is connected when
Blue LED stops flashing
and becomes solid.



IMPORTANT

Soundbar does not
include microphone
and cannot operate as a
hands-free device.



WARNING

High volume levels can
damage your hearing.
Reduce the volume levels
before pressing Play.

5C. PLAY AUDIO

From device

6C. VOLUME

Controlled by Device, Remote or Soundbar

Remark: In the power on, press and hold the  button to select the test mode, this mode is without DRC and the sound setting is **FLAT**. It's not a mode that customer use.

Bluetooth use

Your Soundbar supports music streaming from smartphones, tablets, and computers with Bluetooth capability.

Device compatibility will vary, see your device's documentation for more information. Once you have paired your source device to the Soundbar, as long as you stay within range of the Soundbar, your device should remain paired.

If the input is changed, the Bluetooth device will disconnect. If the source is changed back to Bluetooth, any paired Bluetooth device will reconnect automatically.

A Bluetooth signal has a range of up to 27 feet. Keep in mind that Bluetooth is a compressed audio format, so streamed music may lose some integrity when compared to a wired connection.

Cleaning & Care

CLEANING

- Wipe down surfaces with a light cloth.
- Never use abrasive pads to clean device.
- Avoid using liquids to clean device.



CAUTION

Ensure the unit is fully unplugged from the power supply before cleaning.

Specifications

Soundbar	
Power	100-240V~ 50/60Hz 30 W / < 0.5 W (StandBy)
USB	5V --- 500mA Hi-Speed USB (2.0) / FAT32 / FAT16, MP3
Dimension (WxHxD)	31.57" x 2.62" x 3.09" (802 x 66.5 x 78.5 mm)
Net weight	2.64 lbs (1.2 kg)
Audio input sensitivity	500mV
Frequency Response	120Hz - 20KHz
Wireless Specification	
Bluetooth version/profiles Bluetooth frequency range	V 5.3 (A2DP, AVRCP) 2402 MHz ~ 2480 MHz
Modulation Type	GFSK, $\pi/4$ DQPSK, 8DPSK
Subwoofer	
Power	100-240V~ 50/60Hz 30 W / < 0.5 W (StandBy)
Dimension (WxHxD)	4.13" x 14.56" x 10.16" (105 x 370 x 258 mm)
Net weight	7.7 lbs (3.5 kg)
Frequency Response	40Hz - 120Hz
Remote Control	
Distance/Angle	19.7 feet (6m) / 30°
Battery type	AAA (1.5V x 2)

Troubleshooting

Problem	Cause	Solution
No power	Power off	Press “⏻” button on remote control or on Soundbar.
	Loose power cord	Ensure the power cord is securely connected.
	Faulty outlet	Plug a different device into the electrical outlet to verify that the outlet is working correctly
No audio	Low Volume / Mute	Press “🔊” Increase volume
	Some TVs do not Pass through Digital Audio	Change TV output to PCM
	Input source	Select different Input source
	Not All TVs have Audio outputs listed.	Connect directly to another device (Blu-Ray, Game System, etc.)
	TV set to variable audio output	Set audio output to fixed or standard, NOT variable.

- Input LEDs will flash rapidly if an unsupported format is present.
- Consult your TV's user manual for more detailed information.

Problem	Cause	Solution
No audio	Bluetooth source device	Increase volume / unmute source device
	Subwoofer and soundbar too far	The subwoofer is out of range, please move the subwoofer closer to the soundbar. Make sure the subwoofer is within 5m of the soundbar.
Bluetooth break-up or disconnect	Source too far	Move the source device closer to soundbar
	Solid obstruction	Move source device into line-of-site of soundbar
	Other wireless devices	Turn off / move devices away (wireless security cameras, wireless video baby monitors, cordless phones, and microwave ovens)

onn.TM

For product assistance:
WE CAN HELP

1-888-516-2630

7 DAYS/WEEK 7:00am- 9:00pm CST

**THIS GUIDE CONTAINS
IMPORTANT SAFETY
INFORMATION.**

PLEASE READ AND KEEP
FOR FUTURE REFERENCE.

Find more at **Walmart.com**

Manufactured in China for Walmart Inc.

