

Placing your soundbar

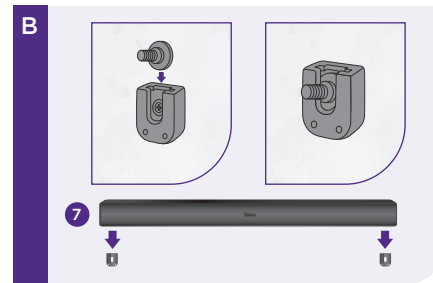

7. Plug in your soundbar using the AC power cord, then hang it on the wall brackets.

8. Power on your Roku TV, then refer back to Step 1 to pair your soundbar.

Tips and tricks

Using sound settings

While streaming, press ***** to view sound settings, like:

- **Volume leveling**
Helps keep your volume consistent and quiets loud commercials.
- **Speech clarity**
Improves clarity of voices so your favorite TV is easier to hear.
- **Night mode**
Lowers loud scenes while boosting quiet ones so you don't wake the house.

Pairing a Bluetooth® device

- From the home screen, go to **Settings > Remotes & devices > Smartphones & tablets**.
- Then choose **Add a new smartphone or tablet** and follow the instructions.

Visit go.roku.com/soundbar for more information

Easily expandable

Roku Wireless Bass



Add even deeper, richer bass

Sold separately.

Need more help?
support.roku.com



Video
tutorials



Wi-Fi®
help

See what's
streaming for free,
tips, and more
roku.com/blog

Follow us



ROKU

© 2023 Roku, Inc. All rights reserved. Roku, Roku TV, and the Roku logo are the trademarks of Roku, Inc. All other logos and trademarks herein are the property of their respective owners.



Just wait until you hear this

ROKU TV™ Wireless Soundbar

Quick Start Guide

What's included

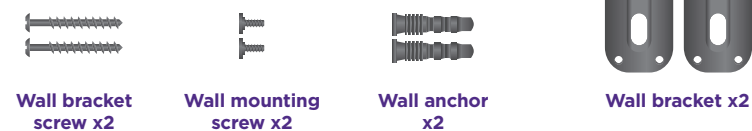
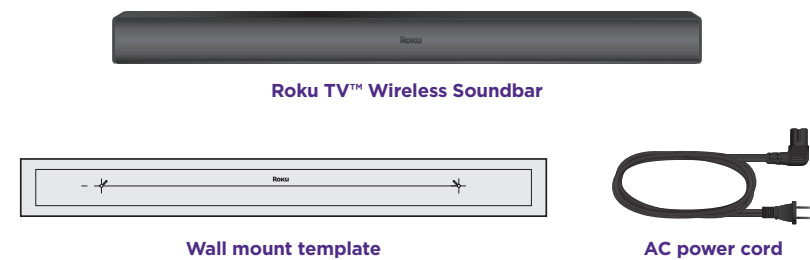

Details

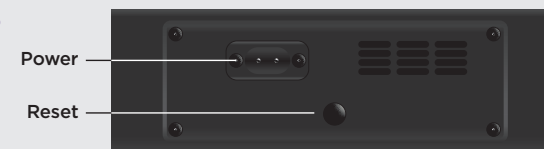

Let's get started



STEP 1: Prepare your Roku TV

Connect your TV to your wireless network and the internet, if it isn't already.

Visit **Settings > System > Software update** to ensure your software is up to date.

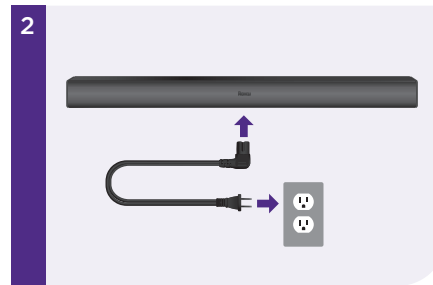

STEP 2: Connect your soundbar to power

Plug in your soundbar using the AC power cord and wait for the voice prompt.

The LED light on the front of the soundbar should illuminate.



STEP 3: Pair your soundbar

Using your Roku TV remote, press and hold the  button for 5 seconds to enter pairing mode. Choose **Wireless soundbar** from the on-screen options and select **Continue** to begin the pairing process.

Placing your soundbar

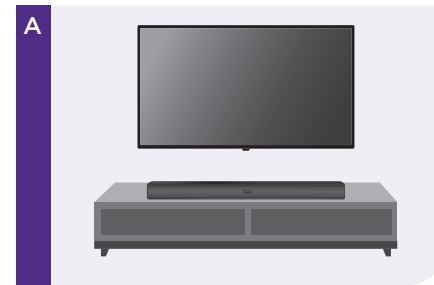

Below your TV

Place your soundbar at the front edge of your TV stand for the best sound experience.

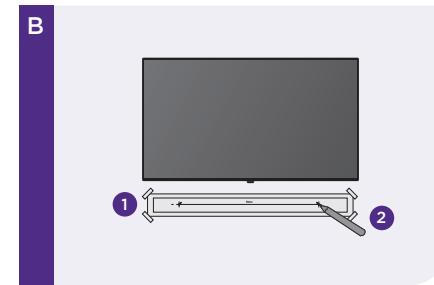

Wall mounting

You can wall mount your soundbar with the included hardware and wall mount template.

1. Stick the wall mount template on the wall with tape, leaving at least 2 inches below the center of your TV. Use a level to ensure the template is positioned accurately.

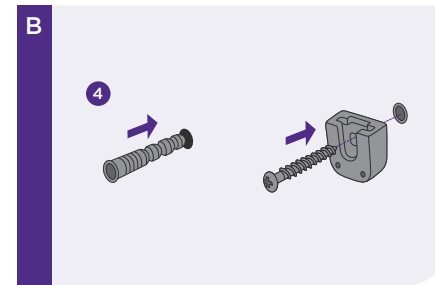

2. Mark where you'll be drilling using the mounting holes on the template, then remove the template.

3. Drill screw holes at the markings and insert the wall anchors.
4. Insert the wall bracket screws through the wall brackets and into the wall anchors. Fix and tighten.

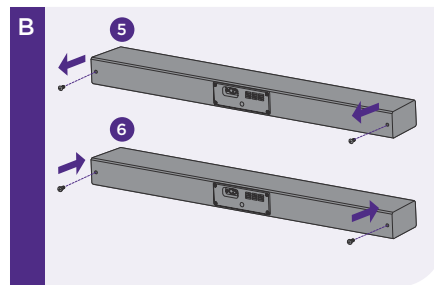

5. Remove the screws from the back of the soundbar and set them aside.
6. Tighten the wall mounting screws into the screw holes in the back of the soundbar.

Flip to continue wall mount ➔

Tools you'll need: Phillips screwdriver, drill, pencil, tape, and level

Roku TV™ Wireless Soundbar ("Product")

Please read and keep all safety and use instructions.

Important Product Information Safety Precautions

⚠ Any electrical device, if used improperly, has the potential for causing fire, electrical shock, property damage or personal injury. To help ensure accident-free and enjoyable operation, follow these guidelines:

- Observe all warnings, precautions and instructions.
- Observe all signs and displays that require an electrical device or RF radio product to be switched off in designated areas.
- For more information on product safety and troubleshooting, please go to support.roku.com

Use and Handling

- The Product contains magnetic material. Contact your physician if you have questions on whether this might affect the operation of your implantable medical device.
- ⚠ The Product is not a toy. Keep out of reach of children and pets. The Product packaging may include plastic bags, cable ties and fasteners. Dispose of these properly and keep them out of reach of children, as they could present a choking hazard.
- The Product should not be exposed to dripping, spraying, or splashing.
- Do not submerge in water or allow liquid to get into the Product.
- Do not touch the Product or connected cables during an electrical storm.
- Do not allow small particles or other foreign objects to get into the Product.
- Do not expose the Product to high temperatures, high humidity, direct sunlight, heat sources, smoke or steam.
- Do not place naked flame sources, such as lighted candles, on or near the Product.
- Do not place anything on top of your Product or cover or place it in an enclosed cabinet or on a soft surface; it may cause the Product to get hot or overheat.

- Do not drop, crush or disassemble the Product.
- Do not clean with chemical based cleaner. Use a soft, dry cloth.
- Do not place Product directly on oil or wax based wood finished surfaces.
- Never attempt to repair or disassemble the Product yourself due to the danger of electric shock/injury. Any modification to the Product may cause damage not covered by the warranty.
- Use intended for indoors only.
- Dispose of the Product according to local standards and regulations.
- Permanent hearing loss may occur if the Product is used at high volume. To prevent possible hearing loss, limit the amount of time you use the Product at high volume.



Class II Equipment

This device meets the safety requirements specified for Class II equipment.



Warning Signs: If your Product gets warm/hot during use, discontinue use and contact Roku Customer Support immediately at support.roku.com

License and Warranty

Use of the Product constitutes your agreement with the End User License Agreement set forth herein and at roku.com/legal and the limited warranty set forth below.

If you disagree and you are within the allowable time period for returns under the return policy applicable to your Product, you may return the Product to the place where you obtained it for a refund, subject to the terms of the applicable return policy.

Limited Warranty & Warranty Service Process Limited Warranty

For any Product purchased and delivered to end users in the US, go to support.roku.com for the warranty terms and conditions. You may also request a copy of such terms by mail by contacting us at 1155 Coleman Ave, San Jose, CA 95110.

Additional Legal Notices

Federal Communication Commission Interference Statement

This equipment has been tested and found to comply with the limits for a Class B digital device, pursuant to Part 15 of the FCC Rules. These limits are designed to provide reasonable protection against harmful interference in a residential installation. This equipment generates, uses and can radiate radio frequency energy and, if not installed and used in accordance with the instructions, may cause harmful interference to radio communications. However, there is no guarantee that interference will not occur in a particular installation. If this equipment does cause harmful interference to radio or television reception, which can be determined by turning the equipment off and on, the user is encouraged to try to correct the interference by one of the following measures:

- Reorient or relocate the receiving antenna.
- Increase the separation between the equipment and receiver.

- Connect the equipment into an outlet on a circuit different from that to which the receiver is connected.
- Consult the dealer or an experienced radio/TV technician for help.

This device complies with Part 15 of the FCC Rules. Operation is subject to the following two conditions: (1) This device may not cause harmful interference, and (2) this device must accept any interference received, including interference that may cause undesired operation.

FCC Caution: Any changes or modifications not expressly approved by Roku, Inc. could void the user's authority to operate this equipment.

2.4 GHz band operation of this product in the US is firmware-limited to channels 1 through 11.

For 5G WIFI Device

The device for operation in the band 5150-5250 MHz is only for indoor use to reduce the potential for harmful interference to co-channel mobile satellite systems.

IMPORTANT NOTE:

FCC Radiation Exposure Statement: This equipment complies with FCC radiation exposure limits set forth for an uncontrolled environment. This equipment should be installed and operated with a minimum distance of 20 cm between the radiator and your body. This transmitter must not be co-located or operating in conjunction with any other antenna or transmitter. The availability of some specific channels and/or operational frequency bands are country dependent and are firmware programmed at the factory to match the intended destination. The firmware setting is not accessible by the end user.

The Bluetooth® word mark and logos are registered trademarks owned by Bluetooth SIG, Inc. and any use of such marks by Roku is under license.

Copyright © 2023 Roku, Inc. All rights reserved.

IC-CANADA: CAN ICES-3(B)/NMB-3(B)

This device contains licence-exempt transmitter(s)/receiver(s) that comply with Innovation, Science and Economic Development Canada's licence-exempt RSS(s). Operation is subject to the following two conditions:

1. This device may not cause interference.
2. This device must accept any interference, including interference that may cause undesired operation of the device. This equipment complies with ISED RSS-102 radiation exposure limits set forth for an uncontrolled environment. This equipment should be installed and operated with a minimum distance of 20cm between the radiator and any part of your body.

Avis d'Industrie Canada: CAN ICES-3(B)/NMB-3(B)

L'émetteur/récepteur exempt de licence contenu dans le présent appareil est conforme aux CNR d'Innovation, Sciences et Développement économique Canada applicables aux appareils radio exempts de licence. L'exploitation est autorisée aux deux conditions suivantes:

1. L'appareil ne doit pas produire de brouillage;
 2. L'appareil doit accepter tout brouillage radioélectrique subi, même si le brouillage est susceptible d'en compromettre le fonctionnement.
- Pour se conformer aux exigences de conformité CNR 102 RF exposition, une distance de séparation d'au moins 20 cm doit être maintenue entre l'antenne de cet appareil et toutes les personnes.



430001002_01