

Diversity Video RF Mucking System

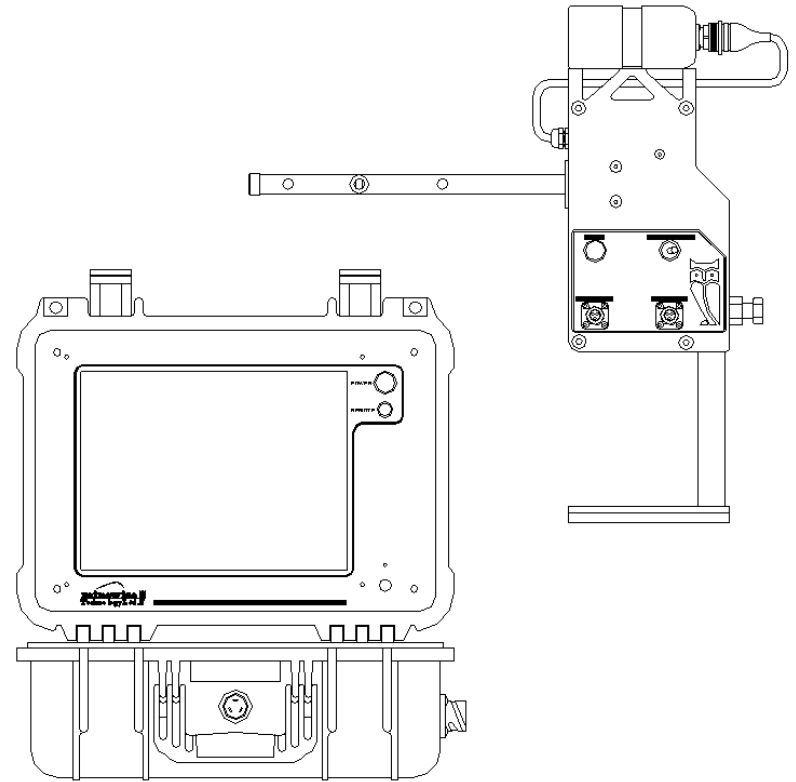

Model #: DVLINK



Minewise Technology Ltd.

**727 Lorne St
Sudbury Ontario
P3C 4R5**

Ph. (705) 674-3332 fax. (705) 674-2221

'Technology that pays its way'



THIS DEVICE COMPLIES WITH PART 15 OF THE FCC RULES. OPERATION IS SUBJECT TO THE FOLLOWING TWO CONDITIONS:

- (1) THIS DEVICE MAY NOT CAUSE HARMFUL INTERFERENCE, AND
 (2) THIS DEVICE MUST ACCEPT ANY INTERFERENCE RECEIVED, INCLUDING INTERFERENCE THAT MAY CAUSE UNDESIRE OPERATION. THIS DEVICE COMPLIES WITH INDUSTRY CANADA LICENSE-EXEMPT RSS STANDARD(S). OPERATION IS SUBJECT TO THE FOLLOWING TWO CONDITIONS: (1) THIS DEVICE MAY NOT CAUSE INTERFERENCE, AND (2) THIS DEVICE MUST ACCEPT ANY INTERFERENCE, INCLUDING INTERFERENCE THAT MAY CAUSE UNDESIRE OPERATION OF THE DEVICE.

NOTE: THE MANUFACTURER IS NOT RESPONSIBLE FOR ANY RADIO OR TV INTERFERENCE CAUSED BY UNAUTHORIZED MODIFICATIONS TO THIS EQUIPMENT. SUCH MODIFICATIONS COULD VOID THE USER'S AUTHORITY TO OPERATE THE EQUIPMENT

THIS DEVICE COMPLIES WITH INDUSTRY CANADA LICENSE-EXEMPT RSS STANDARD(S). OPERATION IS SUBJECT TO THE FOLLOWING TWO CONDITIONS:

- (1) THIS DEVICE MAY NOT CAUSE INTERFERENCE, AND
 (2) THIS DEVICE MUST ACCEPT ANY INTERFERENCE, INCLUDING INTERFERENCE THAT MAY CAUSE UNDESIRE OPERATION OF THE DEVICE.

NOTE: THE MANUFACTURER IS NOT RESPONSIBLE FOR ANY RADIO OR TV INTERFERENCE CAUSED BY UNAUTHORIZED MODIFICATIONS TO THIS EQUIPMENT. SUCH MODIFICATIONS COULD VOID THE USER'S AUTHORITY TO OPERATE THE EQUIPMENT

THE ANTENNA(S) USED FOR THIS TRANSMITTER MUST BE INSTALLED TO PROVIDE A SEPARATION DISTANCE OF AT LEAST 20 CM FROM ALL PERSONS.

Connecting power to the RRC power is preferential. Connecting the "Reverse" lead to the reverse signal generated by the RRC allows the Video system to automatically select the reverse signal (while the mode selector is in the "Auto" position).

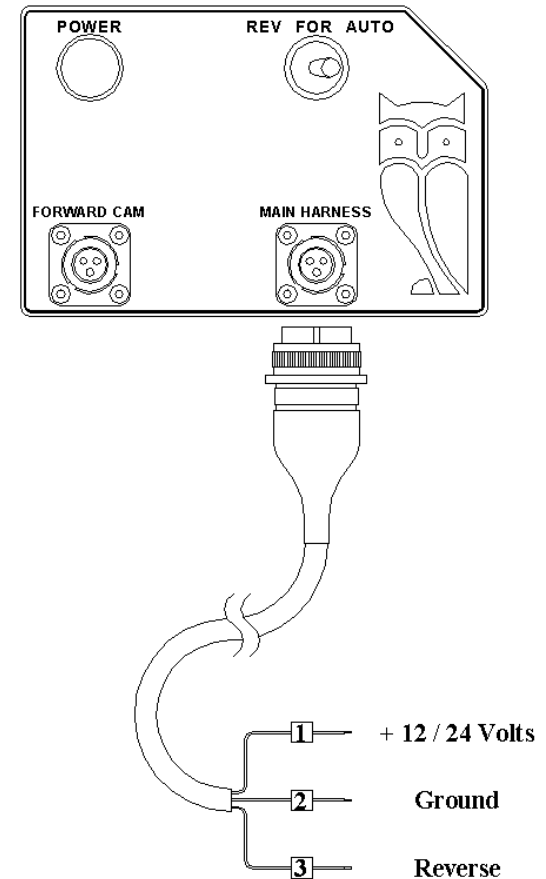

System Layout

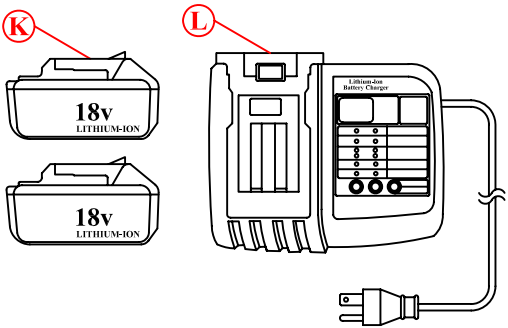

Item	Description	Part No.
A	Diversity Video Receiver c/w 10.4" Display	N55-0277
B	Pedestal mount Transmitter c/w Rear Camera	N55-0239
C	Forward Camera c/w Gymbal Magnetic Mount	N55-0240
D	Forward Camera Harness (25ft)	N55-0206
E	Main Power Harness	N55-0207
F	110vac Power adapter	N55-0263
G	Remote Receiver Pod	N55-0205
H	Remote Receiver Pod Harness (200ft)	N55-XXXX
J	Remote Receiver Pod Patch Cable	N55-XXXX
K	Receiver Lithium-Ion Battery Pack	N55-0246
L	Lithium-Ion Battery Charger	N55-0233

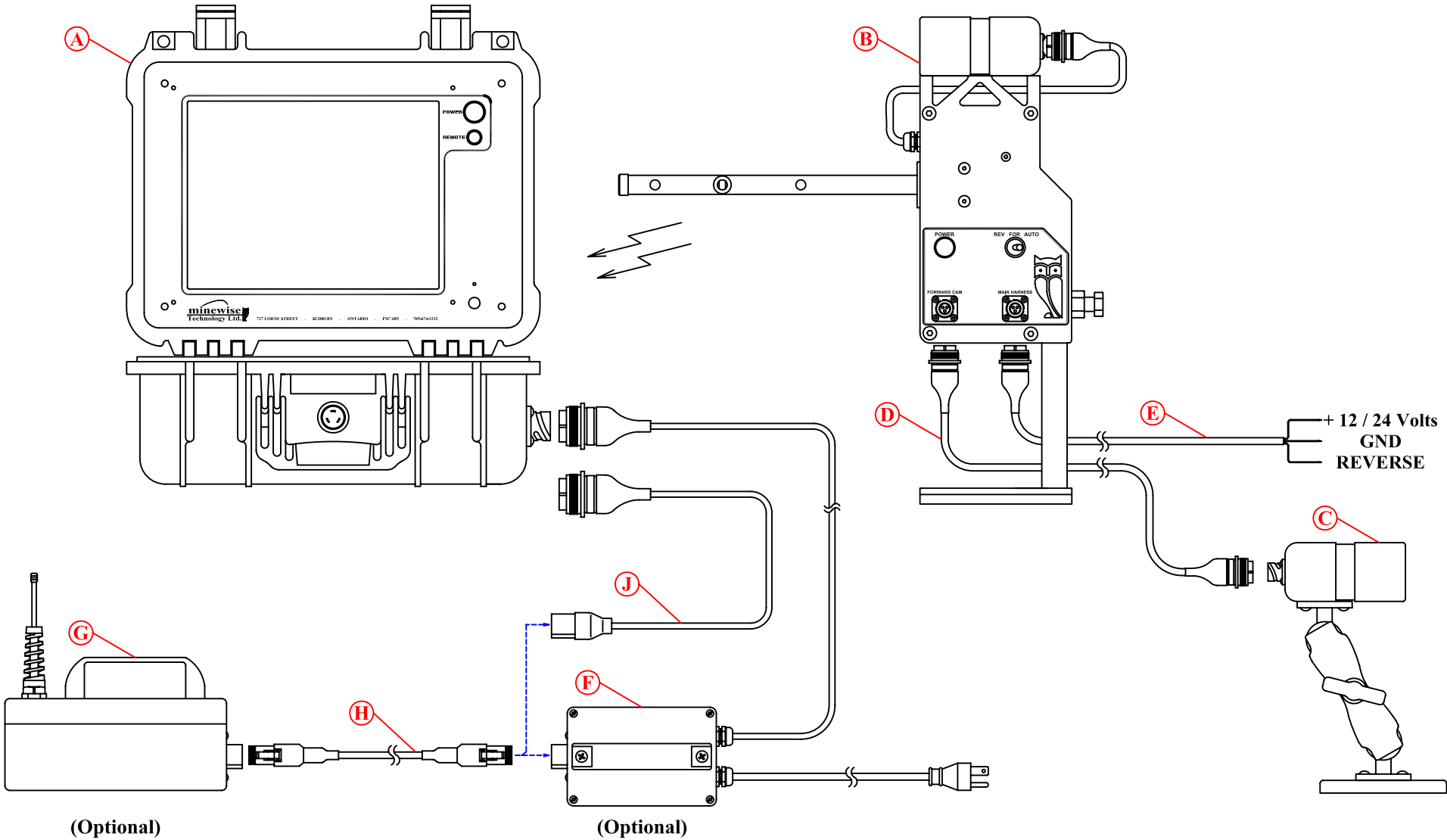

Installation:

The rear camera/transmitter ships with a pedestal mount which can be welded or bolted to your piece of mobile equipment. The front camera mounts simply with a magnetic base and the view angle can be adjusted with the gymbal mount.

Camera placement is key to achieving optimal use of the system. The forward facing camera needs to be placed ahead of the midship in order to maintain view of the bucket while cornering. Typical placement is on top of a headlight housing to the left of the boom (simulating the view from the operators cab). The rear camera should be mounted on the center line of the machine and placed just ahead of the rear axle. (Shown below)

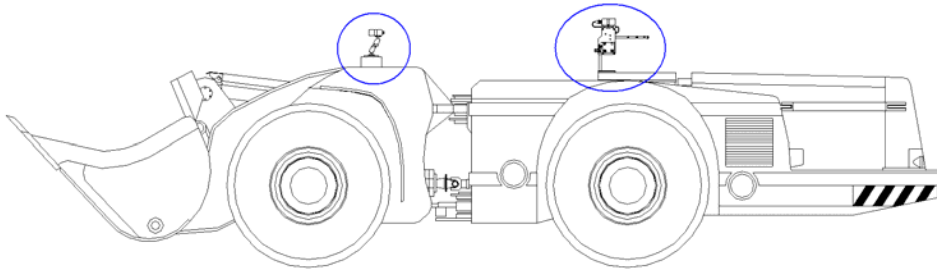
**Power:**

The Main harness consists of 3 conductors.

- 1) 12 / 24 volts
- 2) Vehicle Ground
- 3) RRC Reverse signal

DVLINK**Installation Guide****Introduction:**

Thank you for purchasing a Diversity Video RF Mucking System (Model #: DVLINK). This booklet describes the steps necessary for installing the DVLINK on your piece of mobile equipment.

Unpacking the System:

Carefully unpack the system. Please read any instructions or cautions that appear on the shipping container. Check all material in the container against the packing list. Minewise Technology will not accept responsibility for shortages against the packing list unless notified within 30 days. The equipment and accessories were inspected and tested by Minewise Technology before shipment; all of the equipment should be in good working order. Examine the equipment carefully; if any shipping damage is evident, notify the carrier immediately. You are responsible for claim negotiations with the carrier. Save the shipping container and packing material in case the equipment needs to be stored, returned to Minewise Technology, or transported for any reason.

Parts:

See pages 4 and 5 for parts list.