

Bluetooth Stereo Headset

Quick Start Guide

HS-BT04



WELCOME

Congratulations on your purchase of the HS-BT04 Bluetooth Stereo Headset. Now you can enjoy superb quality music streamed wirelessly from your Bluetooth compatible music player and make and receive hands-free calls using your mobile phone without having to switch devices. The music player can be the music player feature of your mobile phone or a separate compatible device that supports Bluetooth wireless technology. The Bluetooth Stereo Headset features DSP (Digital Signal Processing) technology with noise reduction and echo cancellation and has been designed for comfort, featuring soft ear cushions, adjustable headband, and lightweight design. Powered by a highly efficient lithium-ion battery capable of providing up to 15 hours working time and 360 hours stand-by time, the Bluetooth Stereo Headset is perfect for business and daily use. The headset is compliant with Bluetooth Specification 2.1 + EDR supporting the following profiles: Headset Profile (HFP), Advanced Audio Distribution Profile (A2DP), and Audio Video Remote Control Profile (AVRP) Check with the manufacturers of other devices to determine their compatibility with this device Before using your headset, it is recommended that you familiarize yourself with the features, functions, and operating procedures described in this manual. Due to slight modifications in production, the instructions, features, and/or descriptions found in this manual might be slightly different from your product.

IN THE BOX

1. Bluetooth Stereo Headset
2. Micro USB cable for charging
3. Quick Start Guide
4. Carrying case

LAYOUT AND CONTROLS

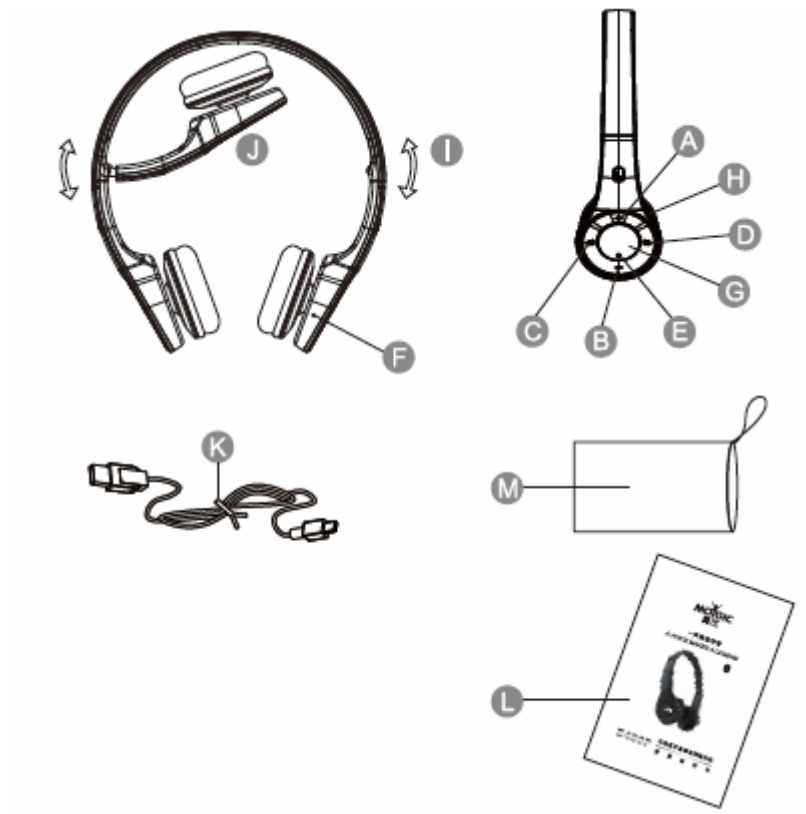

- A. Volume up button
- B. Volume down button
- C. Last track button
- D. Next track button
- E. Blue/Red LED
- F. Omni-directional microphone
- G. Multifunction button (Answer call/End call/Reject call, Play/pause, Power on/off, Pairing)
- H. Micro USB jack for charging
- I. Adjustable headband
- J. Foldable design
- K. Micro USB cable (charging cable)
- L. Quick Start Guide
- M. Carrying case

BASIC OPERATIONS

Follow these tips and safety instructions to preserve the operational lifespan of your Bluetooth Stereo Headset:

1. Do not use this headset in extreme temperatures. Keep away from extreme hot, cold, dry, or damp areas. Also keep away from water, fire, and radiation.
2. It is recommended that you allow the battery to fully charge before using the device for the first time (approximately 3 to 4 hours. Do not recharge unattended for longer than 5 hours.
3. The effective range for this wireless device is 10 Meters. Performance may be affected by distance and interference from other devices or conditions within the operating environment.
4. Barriers and other wireless devices may affect the performance of headset.
5. Check the laws and regulations on the use of mobile phones and hands-free equipment in areas you intend to use this product.

Warning!!

1. Permanent hearing damage or hearing loss may occur if earphones are used at a high volume. Hearing experts suggest not continuously listening to music at a high volume. If you hear a “hissing” noise in your ears, or if you experience discomfort, lower the volume, or temporarily discontinue use of this product until discomfort subsides.
2. Do not disassemble your Bluetooth Stereo Headset.
3. Do not allow young children to use your player unsupervised.
4. Observe all signs and instructions that require an electrical device or radio product to be switched off in designated areas, such as petrol/refueling stations, hospitals, blasting areas, potentially explosive atmospheres or aircraft.
5. Do not use or connect adaptors and/or chargers to this product that are not approved of or specified in this quick start guide.

CHARGING THE BATTERY

The LED will continually flash when battery power is low. When the battery is completely drained, no indicator light will work. Before using, allow the battery to charge for at least 3 to 4 hours.

1. Connect the micro USB cable to the USB Jack on your headset.
2. Connect the larger end of the USB cable to a USB port on your PC or Laptop.
3. The LED will flash like breathing during charging.
4. When charging has finished, the Blue LED will stop lighting.

POWER ON/OFF

To switch the device on, press and hold the multifunction button for about **4 seconds** and then release.

Note: If the Bluetooth Stereo Headset has already been paired or connected to another Bluetooth device before, the Blue LED light will slowly flash as the headset automatically attempts to reconnect to the paired device. If the headset is unable to locate a formerly paired device within 30 minutes, it will shut down automatically.

To turn the power off, press and hold the multifunction button for about **3 seconds** and then release. All LED light will go off.

When the headset is connected to a paired device and is ready for use, the blue indicator light slowly flashes. If the headset has not been paired with a device, it automatically enters the pairing mode.

PAIRING HEADSET WITH BLUETOOTH-ENABLED DEVICES

Pair and connect the headset with a mobile phone that has a music player feature

If your phone supports the A2DP Bluetooth profile and has a music player feature, you can use the phone to dial out or pick calls and to play music with the headset.

1. Ensure that your phone is switched on.
1. If the headset has not been previously paired with a device, press and hold the multifunction button for about **6 seconds** until the blue LED light flashes quickly, indicating that the device is in 'pairing' mode.

Note: If the headset has been previously paired with the device, you just need to press and hold the multifunction button for about **4 seconds** until the blue indicator light is on and flashes slowly which indicates standby mode, and then headset could connect to the device (its Bluetooth function should be turned on) automatically (depends on the Bluetooth software of the cell phone or dongle of PC part too).

3. Activate the Bluetooth feature on the phone, and set it to search for Bluetooth devices. See the user guide of your phone for instructions.
4. Select the headset from the list of found devices. It should show up as "HS-BT04".
5. You may need to enter the pass code "**0000**" to pair and connect the headset to your phone. Some devices don't have keyboard, it will automatically use this password without input.

Pair and connect the headset with a music player

If your phone does not support the A2DP Bluetooth profile (seldom Bluetooth chip can not support A2DP profile). You can connect the headset to some other device which can support A2DP profile to play music.

If you have paired and connected the headset with your phone, disconnect the headset from it before pairing the headset with a music player. To pair the headset with a music player, follow the instructions in the section above. If your music player does not have a keypad, it may use the Bluetooth pass code "**0000**" by default. Refer to the user's guide of your music player for further instruction.

Disconnect the headset

To disconnect the headset from your device, switch off the headset, or disconnect it in the Bluetooth menu of your device. You do not need to delete pairing with the headset to disconnect it.

Reconnect the headset

To connect the headset to the phone or music player that you have last used with it, switch on the headset, or make the connection in the Bluetooth menu of your device. In your device, you may be able to allow the headset to connect to it automatically whenever the headset is switched on. For further instructions, refer to your device's user's guide.

USING THE HEADSET

Place the headset over your ears, the pad indicated with L is on the left ear and the pad with R is on the right ear. Adjust the length of the headband until the speaker pads rest comfortably on your ears.

Warning: When using the headset, your ability to hear external sounds may be affected. Do not use the headset in areas [where accident may happen](#). You need to pay attention to surrounding environment such as walking on the street or similar place).

Adjust the volume

To adjust the headset volume, press the volume up button to increase or the volume down button to decrease the volume during a call or while listening to music.

Call handling

To make a call, while connected to the headset, use your mobile phone and dial as you normally would.

To answer a call, press the multifunction button or use the keys on the phone.

To reject the call, press and hold the multifunction button for about **3 seconds**.

To end a call, press the multifunction button or use the keys on the phone.

Listen to music

To listen to music, connect the headset to a compatible music player such as a mobile phone with a music player feature or other music device and then press the multifunction button. The music player must support the A2DP Bluetooth profile. The music functions available depend on your music player.

Note: If you receive or make a call while listening to music, the music will stop automatically until the call is ending. To pause or resume playing, press the multifunction button. To stop playing music, press the multifunction button again.

MULTIFUNCTION BUTTON CHART

Function	Button	Operation
Turn on	Multifunction Button	Press and hold (Approximately 4s)
Pair	Multifunction Button	Press and hold (Approximately 6s)
Turn off	Multifunction Button	Press and hold (Approximately 3s)

Answer Call	Multifunction Button	Single Press
End Call	Multifunction Button	Single Press
Refuse Call	Multifunction Button	Press and hold (Approximately 3s)
Last Call redial	Multifunction Button	Double Press (quickly)
Transfer music playing on handset and Headset	Skip Forward& Skip Backward	Long Press at the same time
Play (Music Mode)	Multifunction Button	Single Press
Pause (Music Mode)	Multifunction Button	Single Press

TROUBLE SHOOTING

See below for solutions to common problems.

Symptom	Solution
LEDs are not light	Power button is not turned on. The battery is out of power.
Connection failure	Verify the Bluetooth function of smart phone or other device is turned on.
	Don't turn on too many headsets and Bluetooth devices at the same time when connecting. Please turn off other headsets and turn on the paired headset in order to avoid interference.
	Failed to pair successfully within 3 minutes. Please repeat the pairing procedure.
	Make sure the blue LED is flashing quickly(under pairing mode)
	Make sure the input password is right if required.
Sound is distortion	Check whether the red LED is flashing (the battery is in low voltage). If yes, please charge the battery immediately
	Check whether the sound is too loud and decrease volume if necessary

SPECIFICATIONS (Headset)

- RF transmit power: 4.71dBm
- Working current: 25mA
- Signal-to-noise ratio: ≥83dB
- Frequency response: 40Hz - 20kHz
- 10m, 360°Bluetooth working range
- Drivers: 30mm x 2 drivers
- Headset dimension (W x D x H): 153 x 54.5 x 169.5mm

SPECIFICATIONS (Microphone)

- Omni-directional microphone

SPECIFICATIONS (Battery)

- Operating current/voltage: 25mA@3.7V
- Li-ion battery capacity: 320mAh
- Call time: 15 hour
- Music playing time: 12 hour
- Charging time: Approx. 3.5 hrs from empty to full charge

FCC Warning:

- This device complies with Part 15 of the FCC Rules. Operation is subject to the following two conditions:
 - (1) this device may not cause harmful interference, and
 - (2) this device must accept any interference received, including interference that may cause undesired operation.
- Changes or modifications not expressly approved by the party responsible for compliance could void the user's authority to operate the equipment.
- NOTE: This equipment has been tested and found to comply with the limits for a Class B digital device, pursuant to Part 15 of the FCC Rules. These limits are designed to provide reasonable protection against harmful interference in a residential installation. This equipment generates, uses and can radiate radio frequency energy and, if not installed and used in accordance with the instructions, may cause harmful interference to radio communications. However, there is no guarantee that interference will not occur in a particular installation. If this equipment does cause harmful interference to radio or television reception, which can be determined by turning the equipment off and on, the user is encouraged to try to correct the interference by one or more of the following measures:
 - -- Reorient or relocate the receiving antenna.
 - -- Increase the separation between the equipment and receiver.
 - -- Connect the equipment into an outlet on a circuit different from that to which the receiver is connected.
 - -- Consult the dealer or an experienced radio/TV technician for help.

FCC RF warning statement:

The device has been evaluated to meet general RF exposure requirement. The device can be used in portable exposure condition without restriction.