

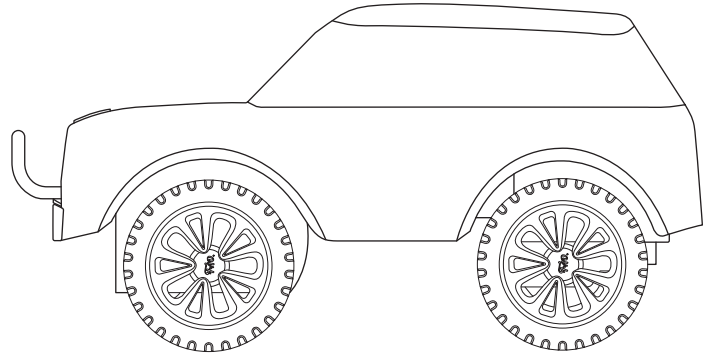

MELROSE THE SUV REMOTE CONTROL CAR

AGES
6+

CONTENTS

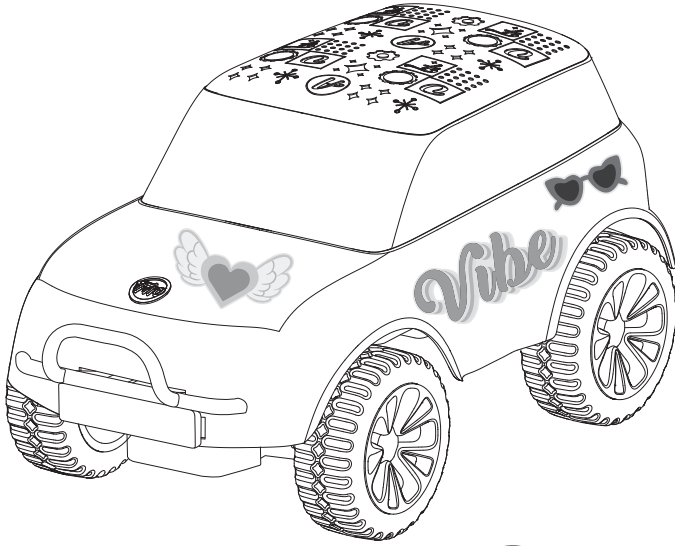

1 Melrose the SUV

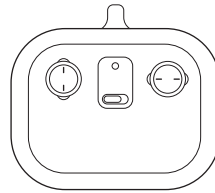
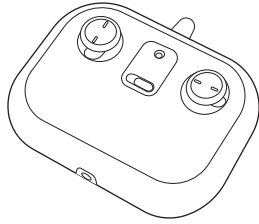

1 Remote Control



1 Removable License Plate



1 Sheet of Stickers

SAFETY WARNINGS

- Adult supervision recommended. Always drive responsibly.
- Do not drive the vehicle in confined or crowded areas.
- Do not drive the vehicle towards or in close proximity to people or animals. Impacts may cause unintended harm or injury.
- Avoid driving the vehicle into furniture or other objects. Impacts may permanently damage the vehicle or other property.
- Never drive the vehicle on public streets or roadways.
- Do not drive the vehicle outdoors during rain or adverse weather conditions.
- Do not drive the vehicle through water, sand, or snow. Moisture or excessive dust may damage the vehicle.
- Never submerge the vehicle or remote control in water or other liquids.
- Keep fingers, hair, and loose clothing away from moving parts on the vehicle.
- Do not leave the vehicle or remote control near sources of heat or in direct sunlight for extended periods.
- Always store the vehicle and remote control indoors in a dry area when not in use. Do not leave unattended outdoors.
- Remove all batteries when not in use.
- Inspect product before every use. If product appears damaged in any manner, discontinue use and discard immediately.
- Put this product into its package when not in use and store in a cool, dry location protected from direct sunlight.
- Use this product only for its intended purpose. Do not use attachments of any kind.

BATTERY WARNINGS

- Do not mix old and new batteries. (if more than one batteries are used).
- Do not mix alkaline, standard (carbon-zinc), or rechargeable batteries.
- Alkaline batteries are recommended. Use only the specified voltage.
- Insert batteries using the correct polarity. Always use, replace, and recharge (if applicable) batteries under adult supervision.
- Do not attempt to charge non-rechargeable batteries.
- Do not short-circuit the battery supply terminals.
- Do not dispose of batteries in fire: batteries may explode or leak.
- Remove batteries before storing.
- Recycle or dispose of batteries according to federal, state, and local laws.
- Keep these instructions for future reference.

This device complies with Part 15 of the FCC Rules. Operation is subject to the following two conditions: (1) this device may not cause harmful interference, and (2) this device must accept any interference received, including interference that may cause undesired operation.

NOTE: This equipment has been tested and found to comply with the limits for a Class B digital device, pursuant to Part 15 of the FCC Rules. These limits are designed to provide reasonable protection against harmful interference in a residential installation. This equipment generates, uses and can radiate radio frequency energy and, if not installed and used in accordance with the instructions, may cause harmful interference to radio communications. However, there is no guarantee that interference will not occur in a particular installation. If this equipment does cause harmful interference to radio or television reception, which can be determined by turning the equipment off and on, the user is encouraged to try to correct the interference by one or more of the following measures:

- Reorient or relocate the receiving antenna.
- Increase the separation between the equipment and receiver.
- Connect the equipment into an outlet on a circuit different from that to which the receiver is connected.
- the dealer or an experienced radio/ TV technician for help.

Warning: Changes or modifications to this unit not expressly approved by the party responsible for compliance could void the user's authority to operate the equipment.

Model No.: 1017673

FAO® and FAO Schwarz® names and logos are trademarks or registered trademarks. www.fao.com © 2023 MerchSource LLC. All rights reserved. Distributed by and © 2023 MerchSource, Irvine, CA 92618. For customer support, please call 1-888-987-6533. Printed in China

KEEP THIS INSTRUCTION MANUAL AS IT CONTAINS IMPORTANT INFORMATION FOR FUTURE REFERENCE. Due to continuous product improvements, the pictures on this manual may differ slightly from the actual product.



WARNING:
CHOKING HAZARD - Small Parts.
Not for Children under 3 years of age.



MELROSE THE SUV REMOTE CONTROL CAR

AGES
6+

BATTERY INSTALLATION

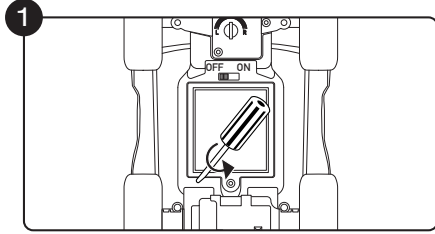

Using a Phillips-head screwdriver, remove the screw by turning it counterclockwise and remove the battery cover from the SUV.

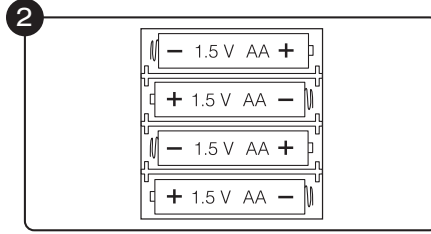

Insert 4 AA 1.5V batteries (not included) in the orientation shown.

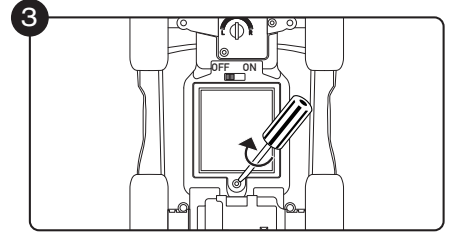

Replace the battery cover and screw by turning it clockwise.

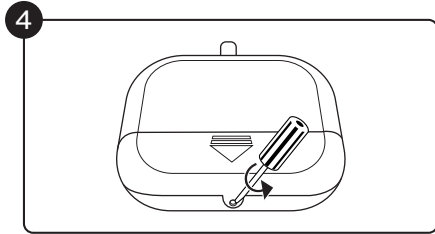

Using a Phillips-head screwdriver, remove the screw by turning it counterclockwise and remove the battery cover from the remote.

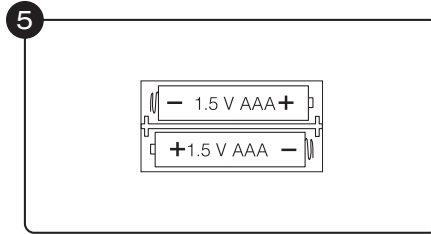

Insert 2 AAA 1.5V batteries (not included) in the orientation shown.

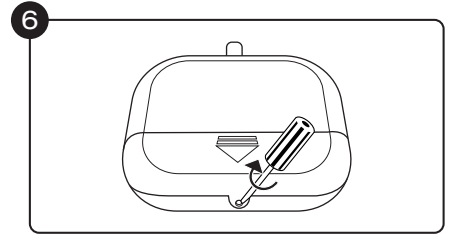

Replace the battery cover and screw by turning it clockwise.

LICENSED TO CUSTOMIZE

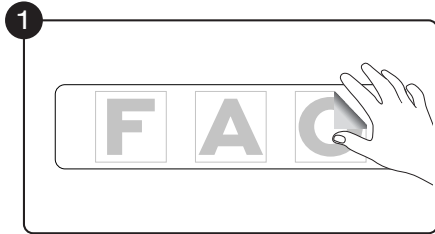

Use the included sticker sheet to customize your license plate and SUV.

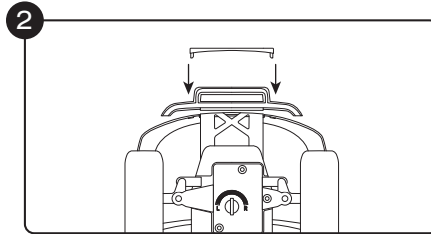

Attach the license plate to the SUV by pressing the tabs on the license plate with the openings on the front of the SUV.

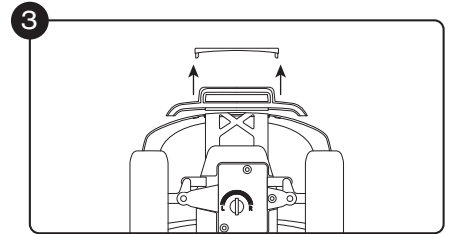

To create a new customized license plate, gently pull it off of the SUV and peel off the stickers to start fresh.

CRUISING IN STYLE

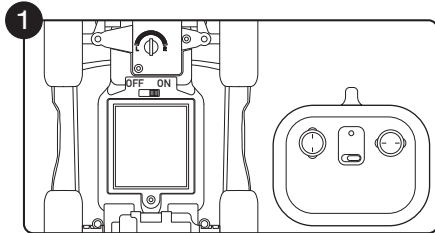

Slide the on/off switch on the remote and car to the on position. The LED on the remote should turn on.

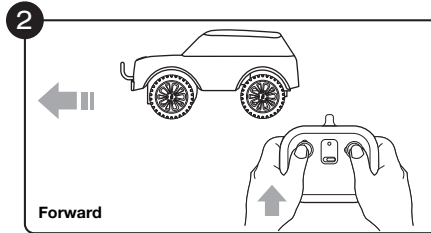

Forward

Push the left joystick forwards to drive straight forward.

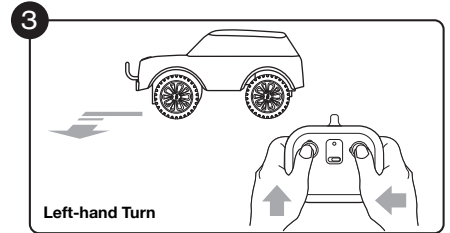

Left-hand Turn

Press the left joystick forward and press the right joystick to the left to make a left-hand turn.

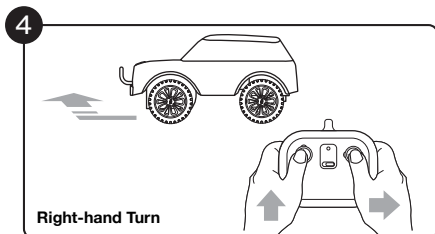

Right-hand Turn

Press the left joystick forward and press the right joystick to the right to make a right-hand turn.

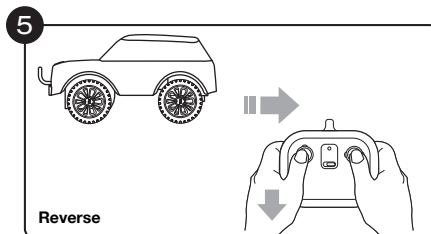

Reverse

Push the left joystick backward to drive straight backward.

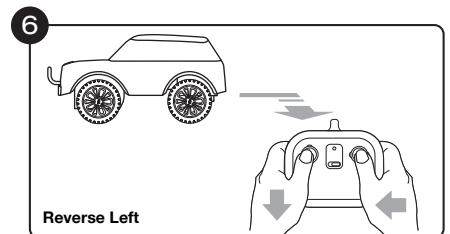

Reverse Left

Press the left joystick backward and press the right joystick to the left to reverse towards the left.

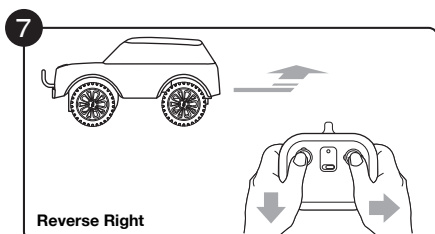

Reverse Right

Press the left joystick backward and press the right joystick to the right to reverse towards the right.

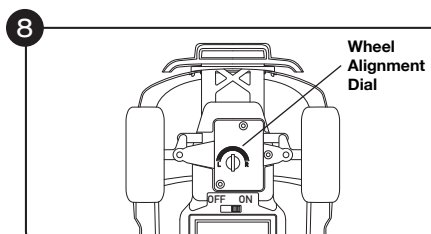

Wheel Alignment Dial

If the Melrose SUV does not drive straight while only pressing the left joystick forward, adjust the wheel alignment with the dial on the front underside of the vehicle and align it to the center as shown.

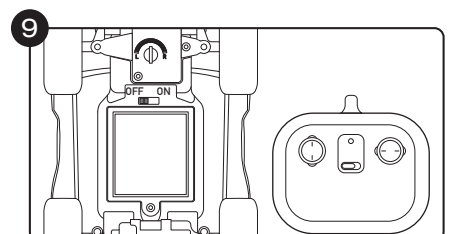

Slide the on/off switch on the remote and car to the off position to turn off. The LED on the remote should turn off.