

Manual

Product Instruction

For your safety, please read this manual carefully before using this product.

First: In order to protect you from injury and property damage, we clearly explain what you should follow.

- A) Warning! It may cause serious injuries or even casualties. People should consult the doctor before using implantable medical devices (such as using pacemaker). Please install your equipment 50 centimeters away from this product because it may influence the operation of implantable medical device.
- B) Attention! It may cause fever, fire and electric shock.
 - 1) This product is for indoor use only;
 - 2) Do not put the product in water or other liquids, avoid water into the product.
 - 3) This product is not intended for use in or around wet or potentially wet areas including but not limited to aquariums, saunas, showers and fountains.
 - 4) Do not touch the product with wet hands to ensure the safety and integrity of the product;
 - 5) Do not let dust accumulate on this product;
 - 6) Do not use this product under ambient -10 degree C and over 40 degree C;
 - 7) Do not charge too close to magnetic sheets, magnetic recording media and precision instruments;
 - 8) Do not put anything between the wireless charging transmitter board and the charging mobile phone, Especially don't put any metal objects between the wireless charger and phone;
 - 9) Do not use it in the places of direct sunlight or high temperature;
 - 10) Do not decompose and transform this product.
 - 11) But when using this product, do not exceed the rated value of the product.
 - 12) Do not let your children use it until they know how to use it;

Second: This power strip is an ideal product for use wherever needed at your home, office and hotel.

- A) For Use with Various Electric and Electronic Appliances, Devices and Equipment such as Computers, Audio/Video, Lighting, Power Tools, Instruments and soon.
- B) Two USB ports (USB-A) can charge smartphones, tablets, and other USB interface devices;
- C) The wireless charging area on the top of the product can charge the phone with wireless charging function;

D) Diagram for using and installing:

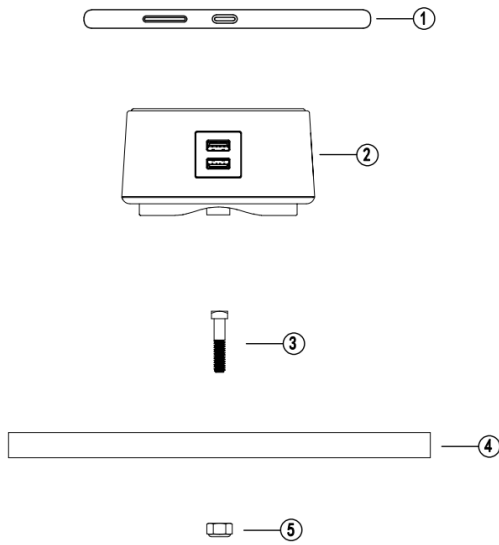

1:MOBILE PHONE; 2. ACC PS2 QU2 01; 3. SCREW; 4. BOARD; 5;SCREW NUT

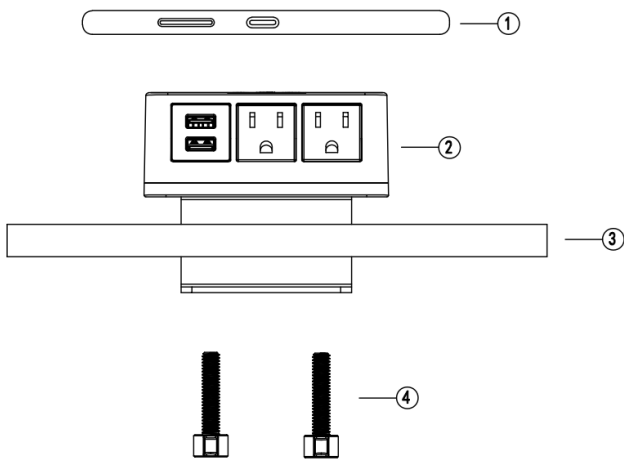
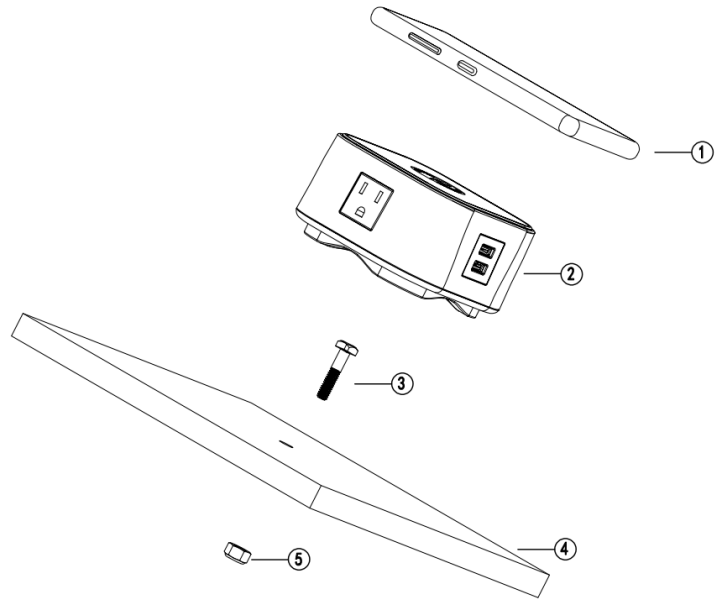

1:MOBILE PHONE; 2. ACC PS2 QU2 02; 3. BOARD; 4;SCREW NUT

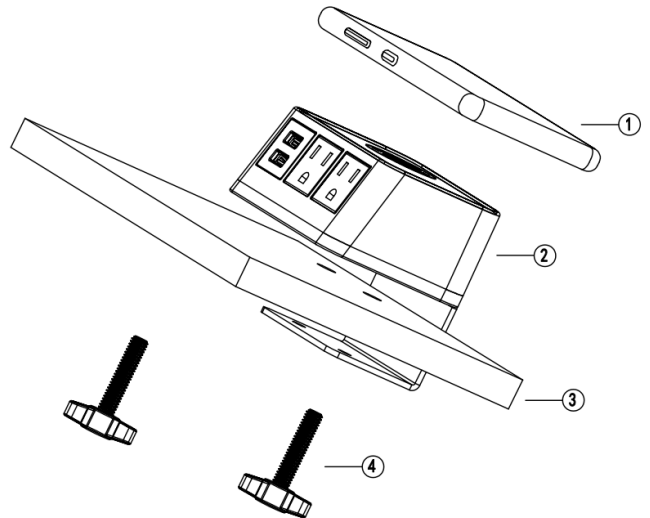

Third: Product parameter:

Product Name	Power Strip	
Model	ACC PS2 QU2 01	ACC PS2 QU2 02
Dimension(L*W*H)	114.3*114.3*63.2mm	113.2*83.9*48.3mm
Input Parameter	120VAC 50/60Hz	
Single AC Outlet Output Parameter	120VAC 15A (Max)	
USB Port Output Parameter	Single USB-A Port	5VDC 2A (Max)
	Double USB-A Port	5VDC 2A (Max)
Wireless charging Parameter	Charging Power	5W (Max)
	Operating Frequency	110.5-205KHz
Note: if USB and wireless charging working at the same time, the max output power is 10W		
Cable Spec	14AWG*3C	

FCC COMPLIANCE STATEMENT:

This device complies with part 15 of the FCC Rules.

Operation is subject to the following two conditions: (1) This device may not cause harmful interference, and (2) this device must accept any interference received, including interference that may cause undesired operation.

Note: This equipment has been tested and found to comply with the limits for a Class B digital device, pursuant to Part 15 of the FCC Rules. These limits are designed to provide reasonable protection against harmful interference in a residential installation. This equipment generates, uses and can radiate radio frequency energy and, if not installed and used in accordance with the instructions, may cause harmful interference to radio communications.

However, there is no guarantee that interference will not occur in a particular installation. If this equipment does cause harmful interference to radio or television reception, which can be determined by turning the equipment off and on, the user is encouraged to try to correct the interference by one or more of the following measures:

- Reorient or relocate the receiving antenna.

- Increase the separation between the equipment and receiver.

- Connect the equipment into an outlet on a circuit different from that to which the receiver is connected.

- Consult the dealer or an experienced radio/TV technician for help.

Warning: Changes or modifications to this unit not expressly approved by the part responsible for compliance could void the user's authority to operate the equipment.

FCC Radiation Exposure Statement

This equipment complied with FCC radiation exposure limits set forth for an uncontrolled environment. This equipment should be installed and operated with minimum distance 20cm between the radiator & your body.