

Thank you for buying product of our company, please make sure that you read the instruction carefully so as to get the right way to use the product.

Smart Plug

User Manual



FC ✓ RoHS REACH



I Overview

The smart plug should be used in conjunction with free Weconn Plug APP, The device allows you to power on or off your home electronics appliances anytime and anywhere, making your home more secure and more convenient.

II Main Function

- ▶ Easy to install and use, no hub required.
- ▶ Control your lamp and appliance from anywhere
- ▶ Energy saving: reduce energy use, eliminate wasteful standby power.
- ▶ Set schedule: turn on/off your devices based on time you set.
- ▶ Group control
- ▶ Multiple users control
- ▶ Power and energy monitoring
- ▶ Support 2.4GHz WiFi



APP control



WiFi



Set Schedule

III Operation Instruction

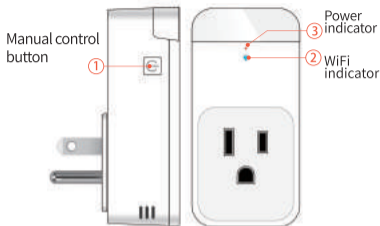

IV Product Details

Input Voltage	100-130V
IRated Current	16A
Max output power	2000W
Plug Output	Type B
Standard	US
Dimension	30*42*85 mm
Wireless mode	WiFi
Working temperature	-10°C-+50°C
Working humidity	20%-85%

V Operation Instruction

No.	Function	Description
1	Manual control button	<ol style="list-style-type: none">1. Click the button to power on or power off.2. Restore factory settings: Long press the button 10 seconds till WiFi indicator flashes quickly.3. Switch work mode(WiFi/Direct Control):Long press the button 5 seconds till WiFi indicator flashes slowly.
2	WiFi indicator (Blue)	<ol style="list-style-type: none">1. WiFi indicator keeps on when WiFi connected successfully.2. WiFi indicator flashes quickly when WiFi connection failed or connected abnormal.
3	Power indicator (Red)	<ol style="list-style-type: none">1. Power indicator keeps on when power on the plug.2. Power indicator is off when power off the plug.

VI Set “Weconn Plug” APP

Download and scan QR code and install “Weconn Plug” APP for iOS or Android.

Users could search APP in App Store or Google Play by APP name: “Weconn Plug”



iOS
(App Store)



Android
(Google Play)



Weconn Plug

- APP supports: Android4.0 and iOS8.0 or above.
- For Android users, please scan QR code by QR scanner or browser.

VII Register and Log in

Once install the APP, the APP will ask you to register, select language and enter your email, input verification code and create a password. If you could not see the verification code well, you can click the code button to refresh and input again.

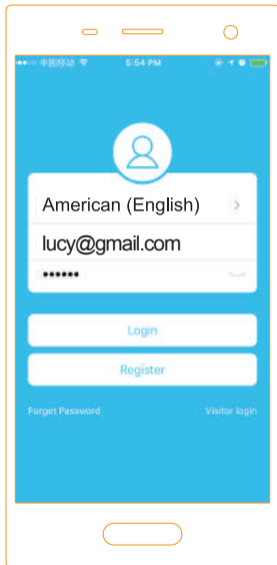

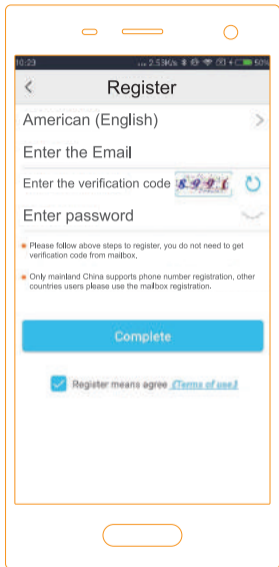

VIII Add New Device in WiFi control

- ▶ Make sure the WiFi smart plug is standby after plug in socket. (The smart plug only supports 2.4GHz WiFi router)
- ▶ Open “Weconn Plug” APP and click “+” to add device
Select WiFi network, input WiFi password, click “Next Step”



- ▶ You should reset the devices, long press the manual control button 10 seconds till the blue indicator flashes quickly. Confirm and click next step to start connection.

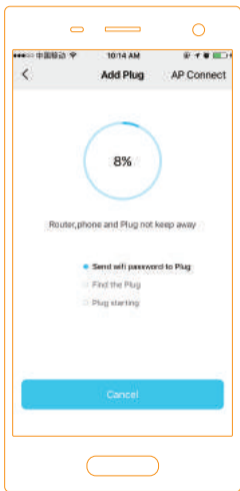

Once devices configured successfully, set a suitable name such as "COCO" for your device,

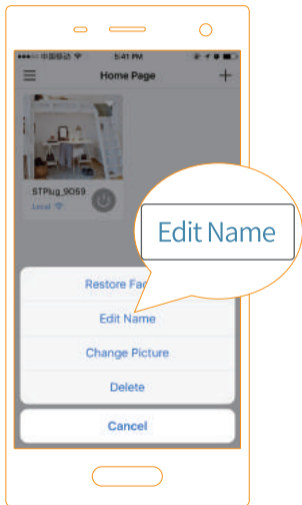

Without unique names, you will be difficult to control the device via your voice with Alexa.

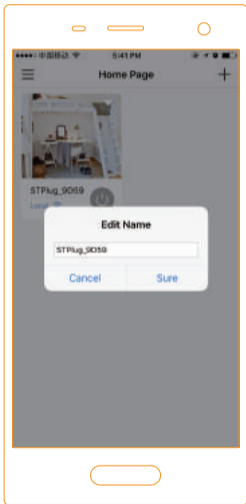

IX Add New Device in Direct control



- ▶ If there is no WiFi network around the smart plug, long press manual control button till WiFi indicator flashes slowly. Go to WLAN setting in your smart phone and select the "STPlug_XXXX" for your WIFI, no need to input password.



- ▶ Once you select the “STPlug_XXXX”, go back to app, and you can use “Weconn plug” APP to control the device directly.

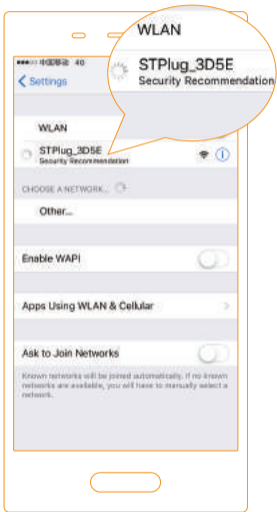

X FAQ



- ▶ 1. Please check whether the device is powered one.
- ▶ 2. Please check whether the phone is connected via WiFi.
- ▶ 3. Check routers or related: If router is dual-band router, select 2.4GHz network and add device.
- ▶ 4. Make sure the password entered in APP is correct when adding new device
- ▶ 5. Make sure the device reset successfully in WiFi control, long press manual control button till blue indicator flashes quickly.
- ▶ 6. If the connection with Alexa is not successful, please try again according to this manual, thanks for your support.

XI Set Alexa APP

1. Open "Alexa APP", Click **Home** . (As below highlighted)

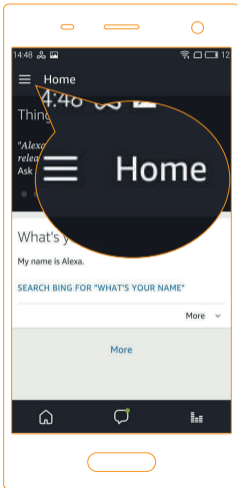

2. click **Skills** . (As below highlighted)

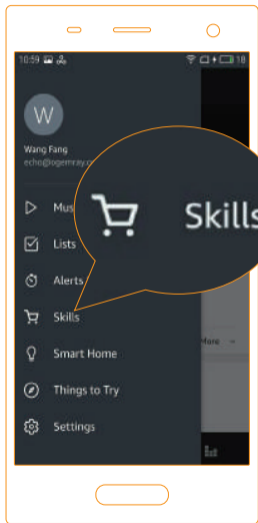

3. Input **“seetime”** to search skills, click search 
(See below highlighted)

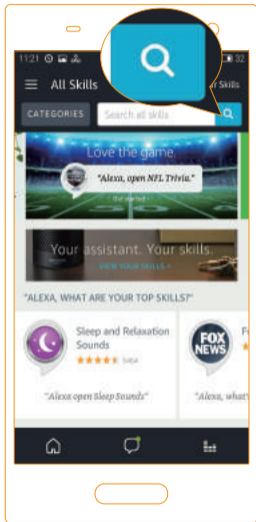

4. Click **“seetime”**  and enter.



5. Click **ENABLE**

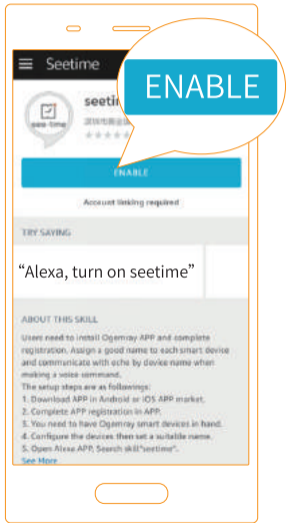

6. Input your "Weconn Plug" APP account and password (Attention: this is not the account and password of Alexa APP). Click **Authorization**

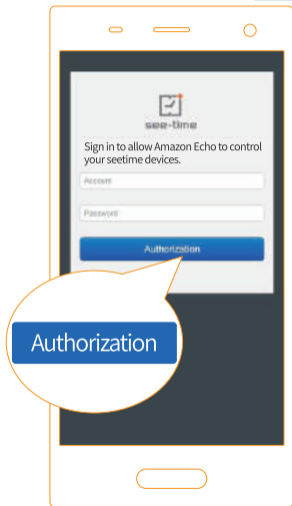

7. Setting finished, click

To continue, close this window to discover devices you can control with Alexa.

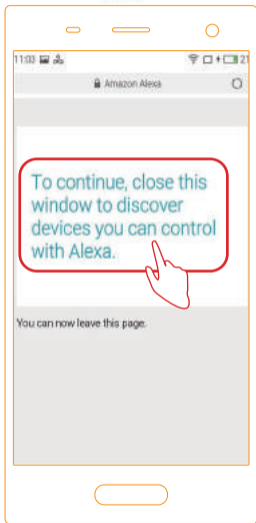

8. Click **DISCOVER DEVICES**, then looking for devices.



9. Alexa is looking for devices.

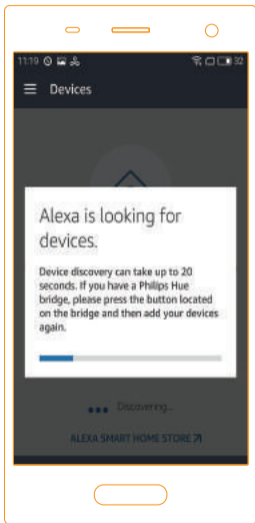

10. If successful, you will find the device list, then you can voice control the smart plug with Alexa.

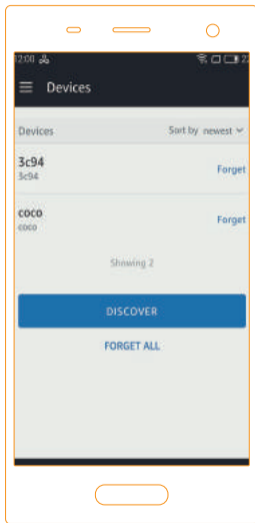

11. If failed, you will not find device list, please check FAQs to find out reasons, then discover devices again in the following interface. Click **DISCOVER**, Alexa will help you discover devices again.



12. If users do not find the interface of discover above, they need to enter Smart Home interface, click Smart Home.

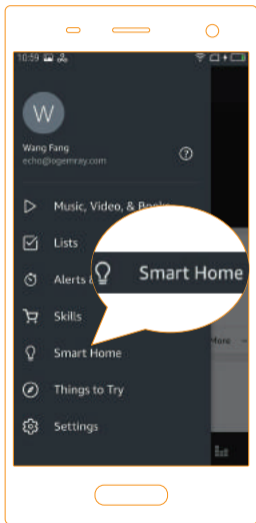

13. Click **Devices**

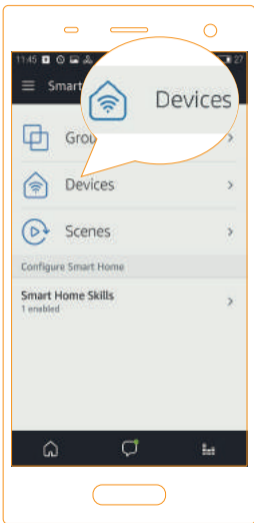

14. Scroll to the Devices page bottom to click **DISCOVER**, Alexa will help you discover devices again.

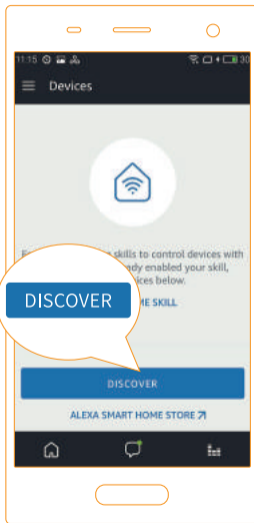

15. After connection, try saying following commands to control the plug.

Alexa, turn on the “COCO”

Alexa, turn off the “COCO”



FCC STATEMENT:

This device complies with Part 15 of the FCC Rules. Operation is subject to the following two conditions:

- (1) This device may not cause harmful interference, and
- (2) This device must accept any interference received, including interference that may cause undesired operation.

Warning: Changes or modifications not expressly approved by the party responsible for compliance could void the user's authority to operate the equipment.

NOTE: This equipment has been tested and found to comply with the limits for a Class B digital device, pursuant to Part 15 of the FCC Rules. These limits are designed to provide reasonable protection against harmful interference in a residential installation. This equipment generates uses and can radiate radio frequency energy and, if not installed and used in accordance with the instructions, may cause harmful interference to radio communications. However, there is no guarantee that interference will not occur in a particular installation. If this equipment does cause harmful interference

to radio or television reception, which can be determined by turning the equipment off and on, the user is encouraged to try to correct the interference by one or more of the following measures:

- Reorient or relocate the receiving antenna.
- Increase the separation between the equipment and receiver.
- Connect the equipment into an outlet on a circuit different from that to which the receiver is connected.
- Consult the dealer or an experienced radio/TV technician for help.

FCC Radiation Exposure Statement:

This equipment complies with FCC radiation exposure limits set forth for an uncontrolled environment. This equipment should be installed and operated with minimum distance 20cm between the radiator & your body.

Disclaimer

1. Thank you for buying product of our company, please make sure that you read the instruction carefully so as to get the right way to use the product
2. If the problem of use is caused by earthquakes, volcanos, electromagnetic force, force majeure, excessively high temperature/humidity, the responsibility should not be borne by our company.