

# SAMPLE



## User Manual

**M-XGM15BB series, M-XGL15BB series  
M-XGM15BBS series, M-XGL15BBS series  
Wireless Mouse**

Thank you very much for purchasing this product.

\* In this manual, "M-XGM15BB(S)" or "M-XGL(S)15BB" series is referred to as "this product" except in some cases.

## Precautions



This manual describes the necessary precautions you should take for safe operation of this product.

Observe these precautions carefully to avoid personal injury, damage, fire, and other problems.

### ■ Meaning of symbols

 **Warning**

## Warning

Failure to observe precautions carries the possibility of serious personal injury or death due to fire, electric shock, or other causes.

## Caution

Failure to observe precautions may result in personal injury due to electric shock or other causes, and may damage other equipment.

 Prohibited action

 Mandatory action

 Situation that needs attention

 Notes and reference information

## Warning

 **If a foreign object (water, metal chips) enters this product, stop using immediately and remove the battery.**

If used as is, it may cause a fire or electric shock.

 **If this product behaves abnormally, such as by generating heat or smoke, or giving off strange smells, cease usage immediately and shut down the connected device. After confirming that the product is not generating heat that will cause burns, remove the batteries from the product. Please contact your dealer after that.**

If used as is, it may cause a fire or electric shock.

 **Please do not drop or hit this product.**

**In the event that the product is damaged, cease usage immediately. Turn OFF the power and remove the battery from the mouse. Please contact your dealer after that.**

Fires or electric shocks may occur if this product is used when damaged.

 **Do not attempt to disassemble, modify or repair this product.**

Doing so may cause a fire, electric shock, or product damage.

Malfunctioning is not covered under warranty.

 **Do not put this product in fire.**

Breakage may cause fire or injury.

## Caution

 **Do not place this product in any of the following environments:**

- \* In a car exposed to sunlight or a place exposed to direct sunlight.
- \* In a place that becomes hot, such as around a heater.
- \* In a moist place or a place where condensation may occur.
- \* In an uneven place or a place exposed to vibration.
- \* In a place where a magnetic field is generated (such as near a magnet.)
- \* In a dusty place.

 **This product does not have a waterproof structure. Use or store in a place not exposed to liquids such as water.**

Rain, water spray, juice, coffee, steam, sweat and other liquids may cause a breakdown.

- 
- \* Only use this product with PCs, smartphones, tablets, and video game systems.
  - \* Do not use this product with any device that may significantly be affected in the case of this product malfunctioning.
  - \* If this product is used on a transparent surface such as glass or a highly reflective surface such as a mirror, the optical sensor will not function correctly and the mouse cursor movement will become unstable.
  - \* Although the sensor light is not visible, please note that looking directly into the sensor may hurt your eyes.
  - \* When you no longer need to use this product and the battery, be sure to dispose of them in accordance with the local ordinances and laws of your area.

## ■ Batteries

 **Caution**

-  **Please use either AA alkaline batteries, AA manganese batteries or AA nickel-metal hydride rechargeable batteries.**

-  **Remove the batteries when you are not using this product for long periods of time.**  
This may cause fluid leak or malfunction.

## ■ Cleaning the Product

If the body of this product becomes dirty, wipe with a soft, dry cloth.

- 
- \* Using a volatile liquid (such as paint thinner, benzene or alcohol) may affect the material quality and/or discolor this product.

## Cautions for Wireless Equipment

This product is a wireless device that can use the entire 2.4 GHz band, and is able to avoid the mobile entity identification device range. The GFSK method is adopted as the radio wave method, and the interference distance is 10 m. The 2.4 GHz band is also used in medical devices, Bluetooth, and wireless LAN devices of the IEEE 802.11b/11g/11n standards.

• Before using this product, check that there are no other "radio stations"\* operating nearby.

• If electromagnetic interference occurs between this product and other "radio stations"\*, move this product to another location or stop using this product.

\* Other "radio stations" refer to industrial, scientific and medical devices using the 2.4 GHz band, the same as this product, other radio stations of this type, licensed radio station premises for a mobile object identification system that is used in factory production lines, certain non-licensed low power radio stations, and amateur radio stations.

### Warning

-  Do not use in equipment which may cause serious effects due to it malfunctioning. There are rare cases in which an external radio wave at the same frequency, or the radio wave emitted from a mobile phone, causes this product to malfunction, slow down, or fail to operate.
  - Do not use this product in places where radio wave usage is prohibited, such as hospitals. Radio waves of this product may affect electronic devices and medical devices (for example pacemakers).
  - Due to the possibility of hindering safe navigation of aircraft, use of wireless mouse in aircraft is prohibited by the Civil Aeronautics Act. Turn off the power of the wireless mouse before boarding and do not use after boarding.
- \* ELECOM is not liable for any accidents or any indirect or consequential damage incurred due to the failure of this product.

## How to use

### Check items included in this package

The following are included in this package. Verify the package to ensure all items are accounted for prior to using this product. Every effort has been made to ensure proper packaging. However, in the event that any part is missing or damaged, please contact the retailer where this product was purchased or the ELECOM General Information Centre.

- Mouse x 1
- AA alkaline dry cell batteries for confirming operability x 1

## Name and function of each part ☐

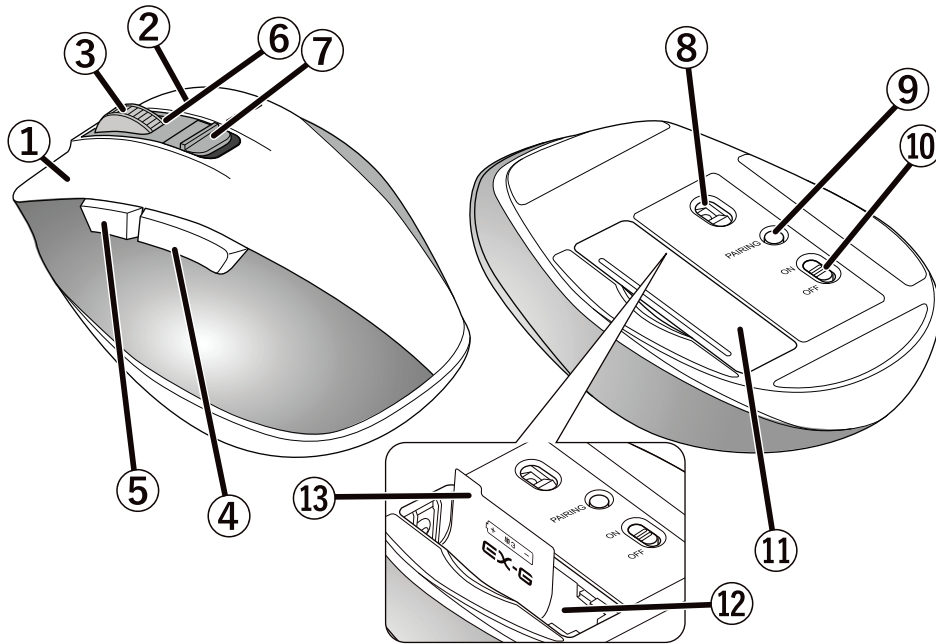

**① Left button**

To left click on your PC.

**② Right button**

To right click on your PC.

**③ Wheel**

Rotate forward and backward or click like a button to operate your PC.

**④ "Back" button**

Performs the "Back" function on the Web browser.

**⑤ "Forward" button**

Performs the "Forward" function on the Web browser.

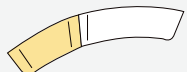
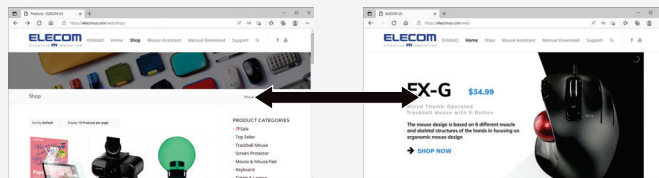

"Forward" button  
Continue to next page.

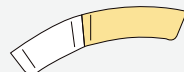

"Back" button  
Return to previous page.

You will need to install the ELECOM Mouse Assistant for Mac from our website to use the "Back" and "Forward" button on Mac. Refer to ["Install ELECOM Mouse Assistant"](#).

#### ⑥ LED light

- The light underneath the wheel flashes in red when the mouse is in a pairing standby state.
- The base of the wheel illuminates in red for a few seconds when the power is turned on.
- The light around the mouse will start to blink red when the battery level is low.

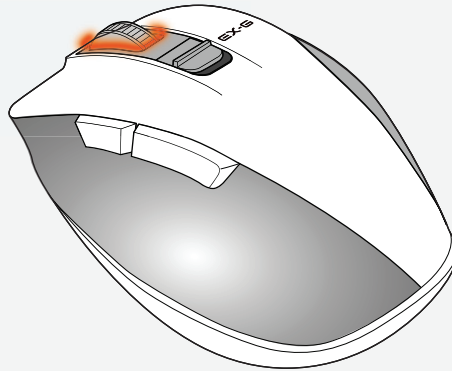

#### ⑦ To switch devices

Use to switch between devices connected to this product.

Please refer to ["Switch connected device"](#).

#### ⑧ Optical sensor

The light will turn green when the battery is put into the mouse.

This sensor will detect the mouse movements when you move the mouse.

\* Please note that looking directly into the sensor light may hurt your eyes.

#### ⑨ Pairing button

Pair the mouse with your device's Bluetooth module or a Bluetooth adapter.

#### ⑩ Power switch

Turns the mouse power on (ON) and off (OFF).

#### ⑪ Battery cover

Remove this cover and put in the battery.

#### ⑫ Battery storage compartment

Holds the battery.

#### ⑬ Battery removal sheet

Used to remove the battery from the battery storage compartment.

## Switch connected device

This product can be used to switch between two Bluetooth devices.

This product can be used to switch between two Bluetooth devices.  
Switch between connected Bluetooth devices in the following way.

## ■ Switch when pairing

1) Slide the switch to switch between "PC1" and "PC2".

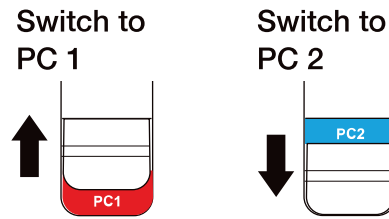

2) Pair with the selected connected device.



To pair, please refer to "How to use" → "Connecting and setting up the mouse" → (OS specific) → "3. Pairing with a PC".

## ■ Switch during use

1) Slide the switch to switch between "PC1" and "PC2".

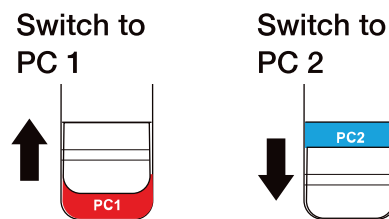

2) When the device to be switched is connected, the LED lamp will blink for about 3 seconds.

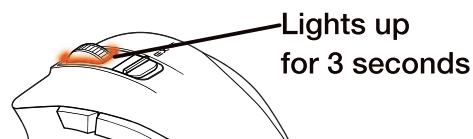

When paired with only one of either "PC1" or "PC2", the current connection will be cut off when the switch is slid to the other side that is not paired. Sliding the switch to the side paired with the connected device will restore the connection.

Connecting and setting up the mouse



Windows



1. Insert battery

1) Remove the battery cover.

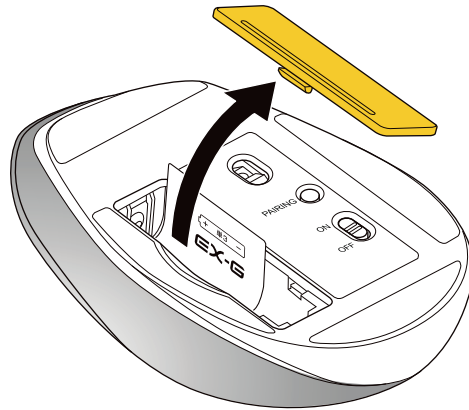

2) Insert the battery as instructed on the battery removal sheet.

Insert the battery in with the battery removal sheet below it.

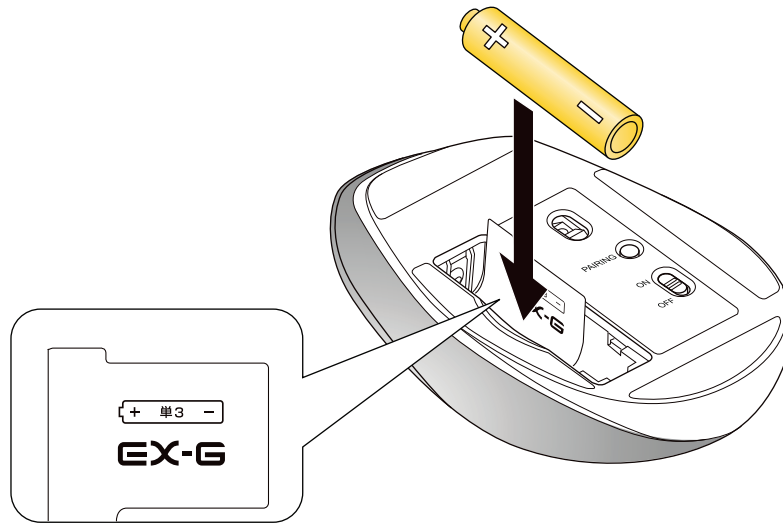

Ensure that the battery is inserted with its positive (+) and negative (-) ends oriented correctly.

3) Re-attach the battery cover to its original state.

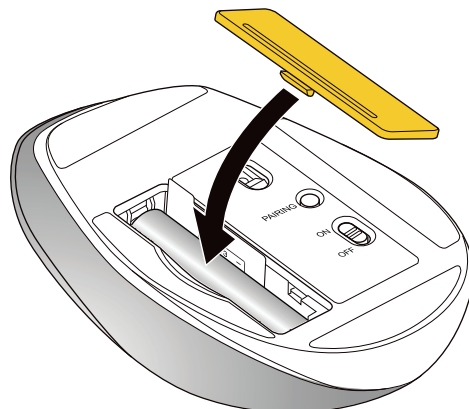

Replacing the batteries...

Pull the battery removal sheet to remove the battery and replace it with a new one.



Pull the battery removal sheet to remove the battery and replace it with a new one.

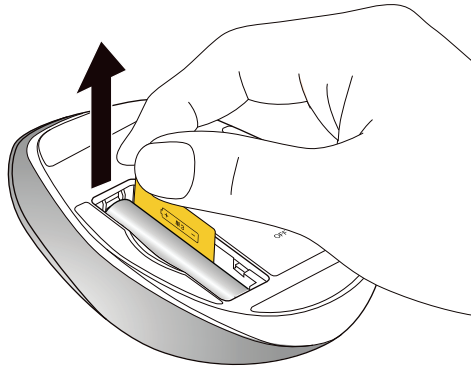

## 2. Turn the power ON

1) Slide the power switch on the underside of the product to the ON position.

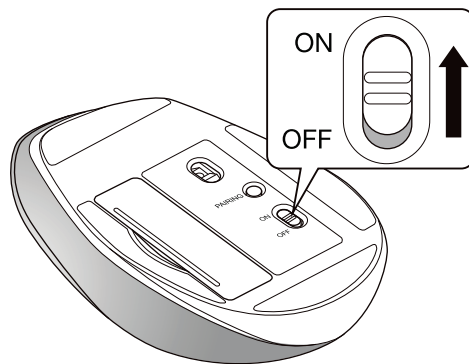

The LED lamp will blink periodically according to the amount of battery left.

\* When the battery level is low, the number of times the LED lamp blinks will decrease.



### Power-saving mode

When the mouse is left untouched for a fixed period of time while the power is ON, it automatically shifts to power-saving mode.

The mouse returns from power-saving mode when it is moved.

\* Mouse operation may be unstable for 2-3 seconds after returning from the power-saving mode.

## 3. Pairing with a PC

- Pairing involves registering Bluetooth devices (in this case, this product and your device) with each other, and authorizing a connection between them.
- This section covers Windows standard Bluetooth functions. Depending on your device or Bluetooth adaptor, unique Bluetooth functions may be used. Please read the respective manuals for each function.
- Please carry out the pairing operation using your current mouse or touchpad on your device.
- The following instructions are for Windows 11 (21H2).

1) Click on “Start” on the bottom of the screen and right click on “Settings”.

The “Settings” page will appear.

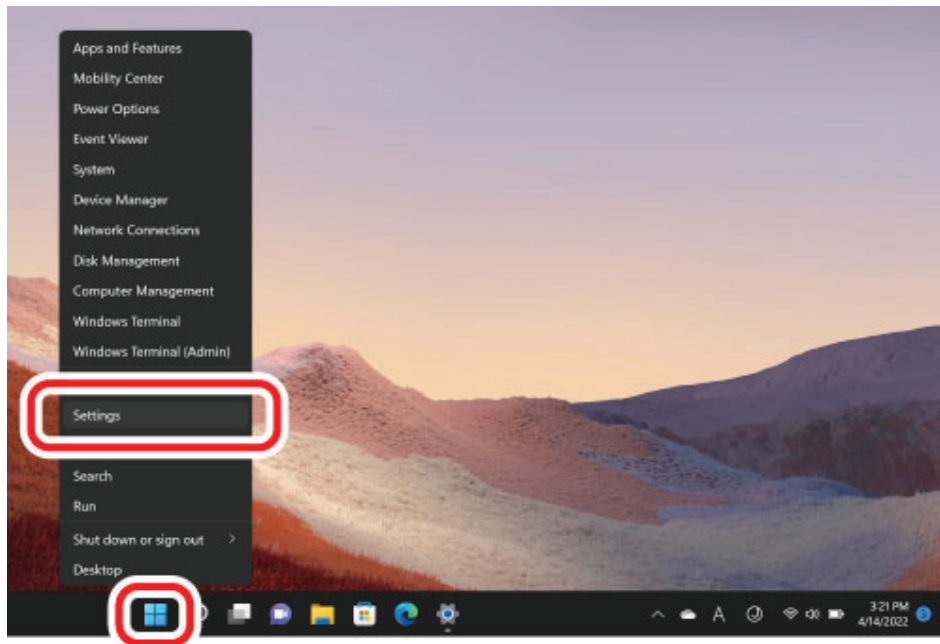

2) Click on "Bluetooth & devices".

The "Bluetooth & Devices" page will appear.

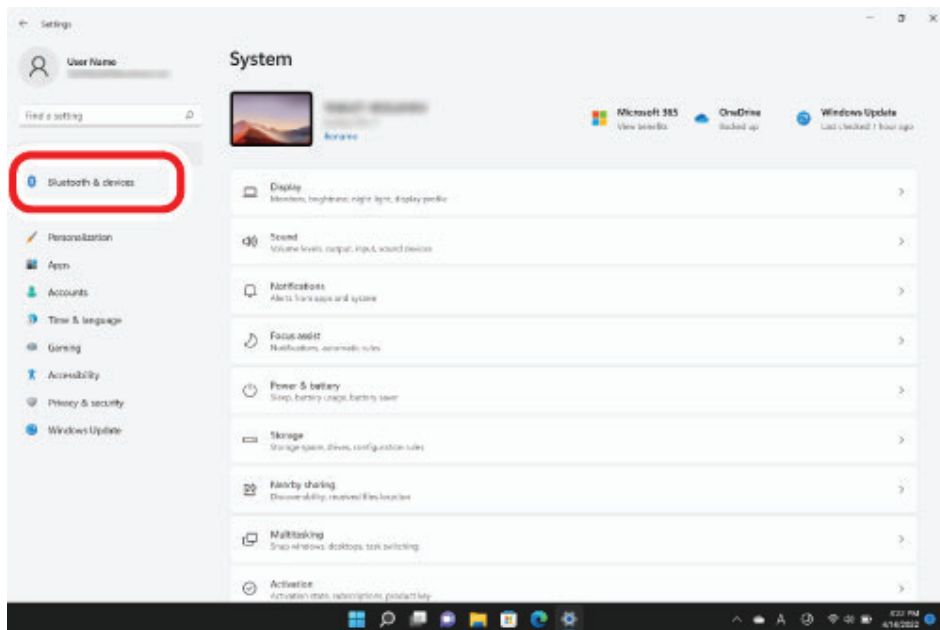

If "Bluetooth" is off, turn it on.

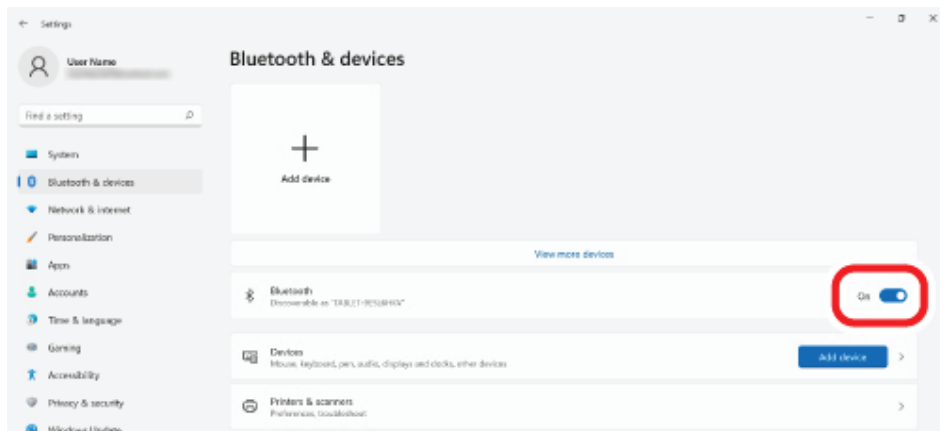



3) Click on "Add devices".

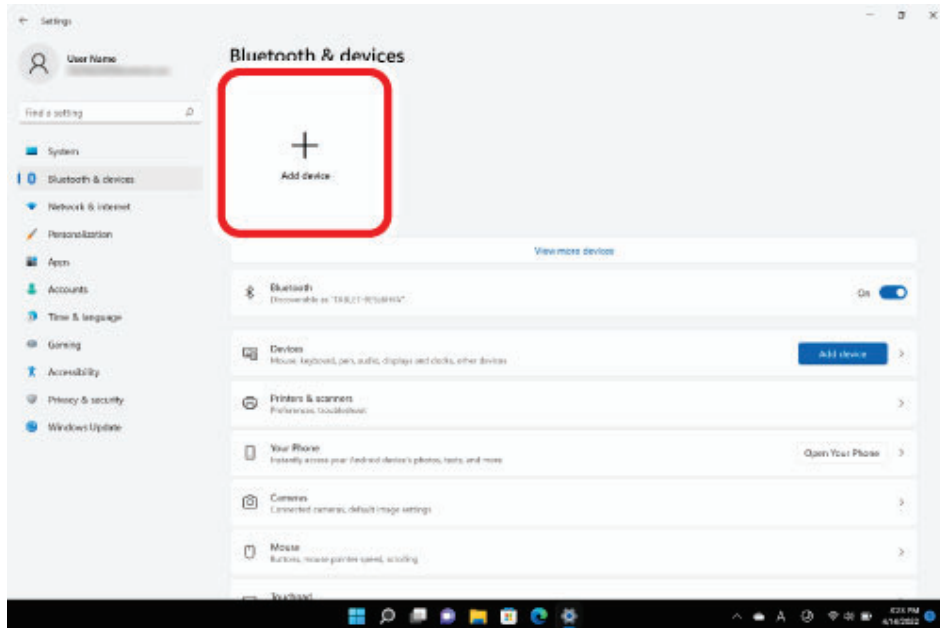

4) Slide the switch to choose the connected device.



- Please refer to **"Switch connected device"** to choose between connected devices.
- The currently pairing Bluetooth device is registered to the connected device selected here.

5) Click "Bluetooth".

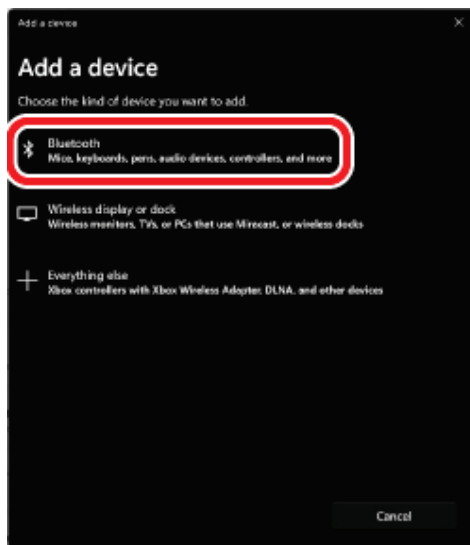

6) When the add device screen is displayed, hold down the pairing button on the

**bottom for 2-3 seconds, and then release.**

Pairing mode is activated, and the LED lamp blinks red.



**Pairing button**

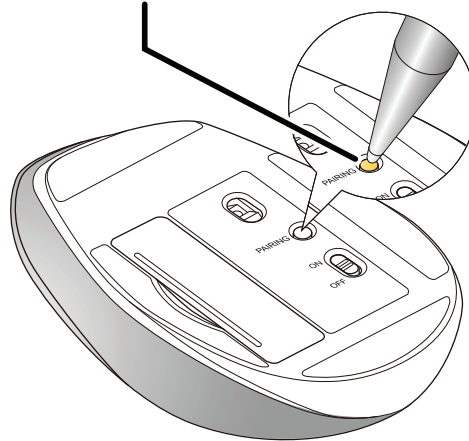

**7) Click "ELECOM EX-G".**

Pairing begins.

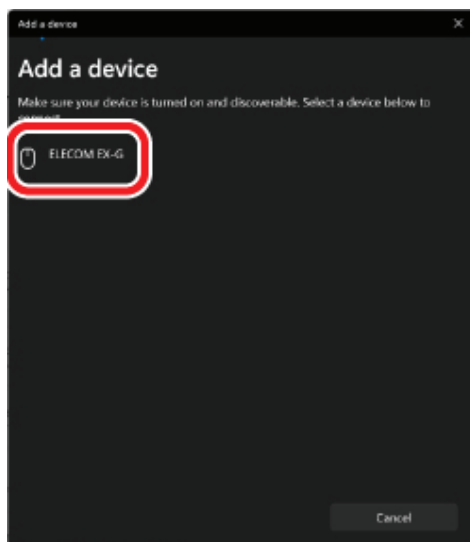

8) When the message changes to “The device is ready!”, click “Done”.

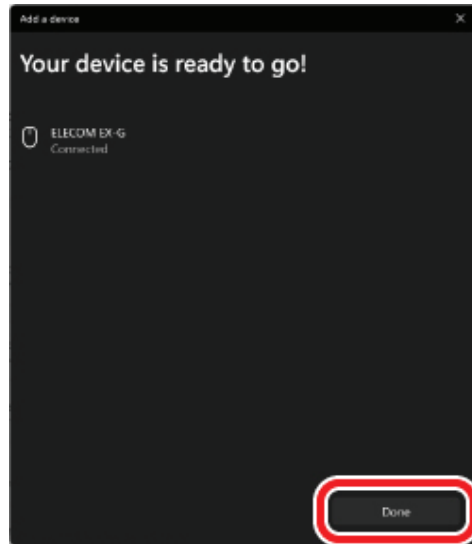

9) Pairing is complete when this product is added to “Bluetooth & devices” and the status is “Connected”.

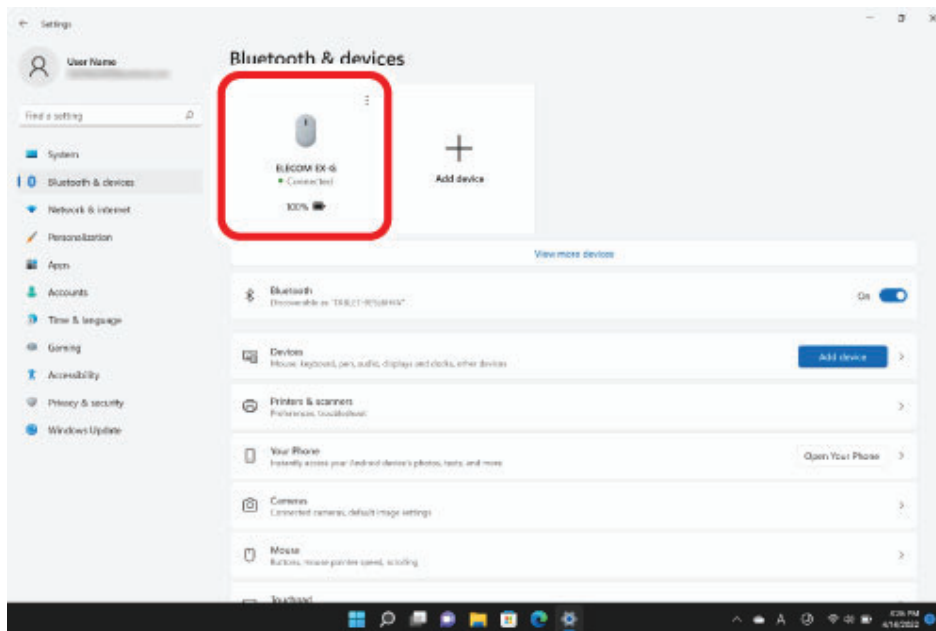

You can now use the mouse.

## Change the mouse pointer speed

Adjust the mouse pointer movement speed on your PC if the mouse pointer moves too fast or too slow.

### ■ For Windows 11

1) Click on “Start” on the bottom of the screen and right click on “Settings”.

The “Settings” page will appear.

2) Click on “Bluetooth & Devices” and then “Mouse”.

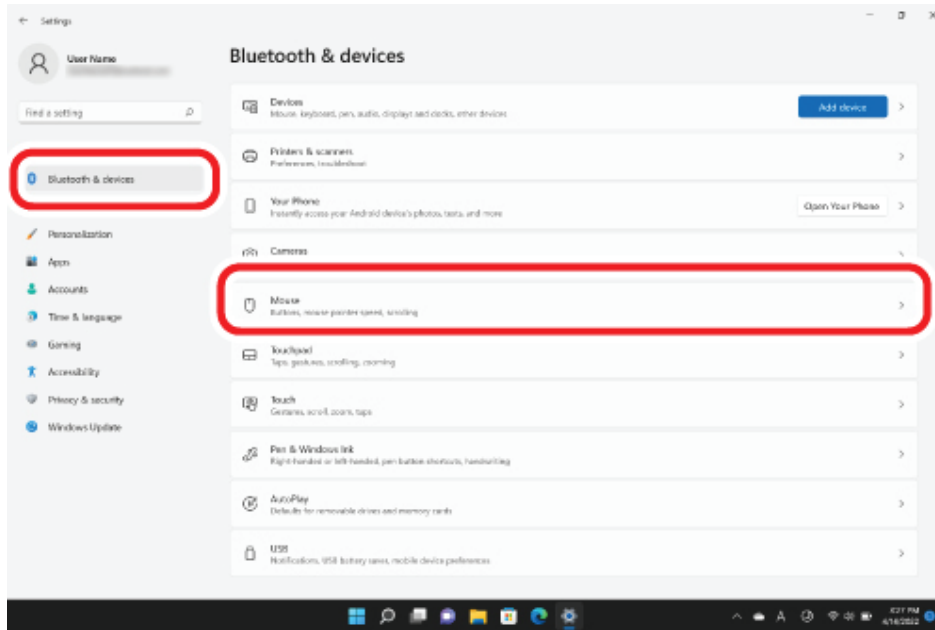

3) Adjust the “Mouse pointer speed” slider bar to adjust the mouse pointer movement speed.

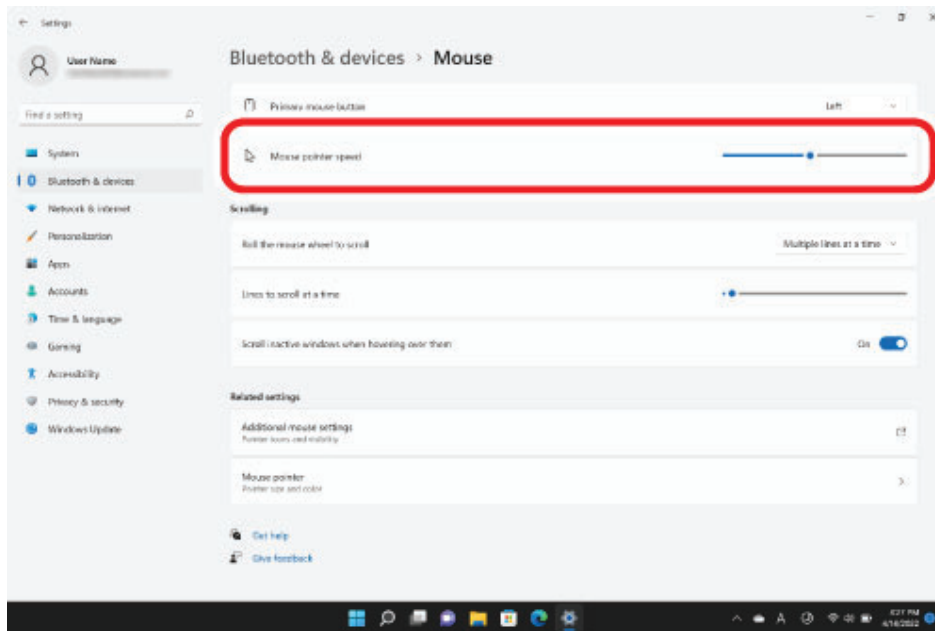

### ■ For Windows 10/8.1

1) Open “Mouse” properties.

• For Windows 10

From the start menu, click the Settings icon, select “Devices” → “Mouse”, then click “Additional mouse options” under “Related settings”.

• For Windows 8.1

Right-click the Start button in the bottom left-hand corner of the screen and select "Control

Panel" → "Hardware and Sound" → "Devices and Printers", then click on "Mouse" under "Devices and Printers".

2) Select the "Pointer Options" tab.

3) Adjust the "Select a pointer speed" slider bar to adjust the mouse pointer movement speed.

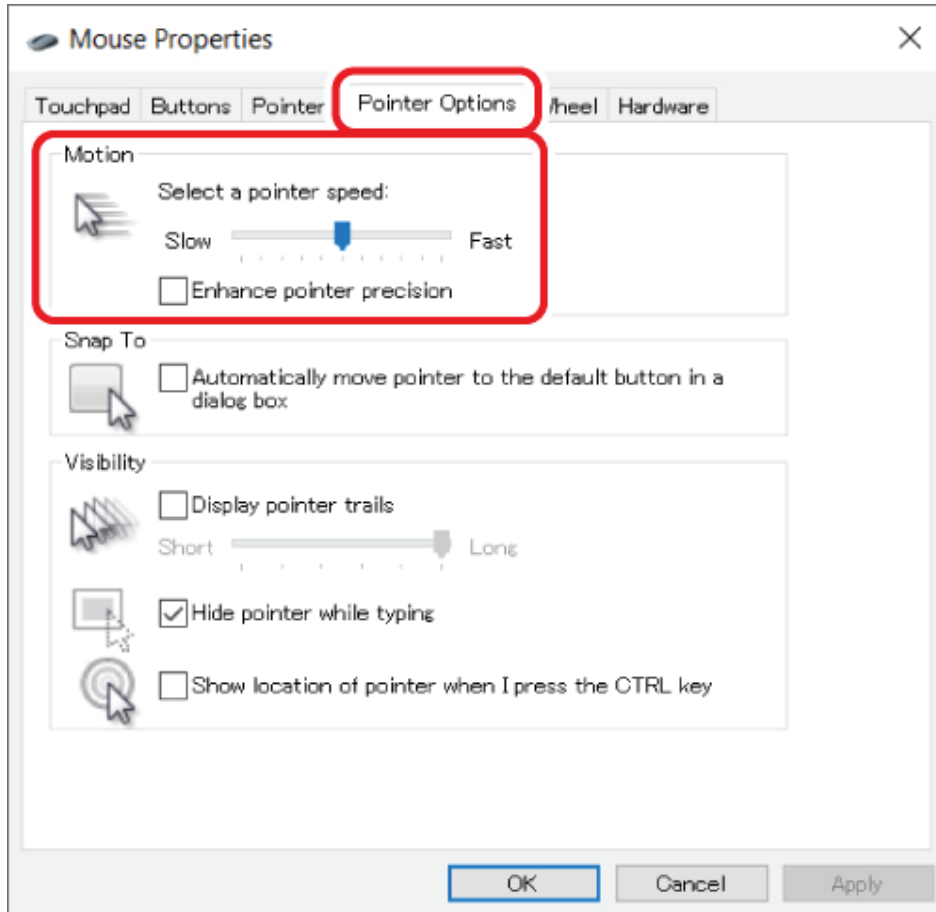

## Change the number of lines scrolled in one wheel turn

### ■ For Windows 11

1) Click on "Start" on the bottom of the screen and right click on "Settings".

The "Settings" page will appear.

2) Click on "Bluetooth & devices" and then "Mouse".

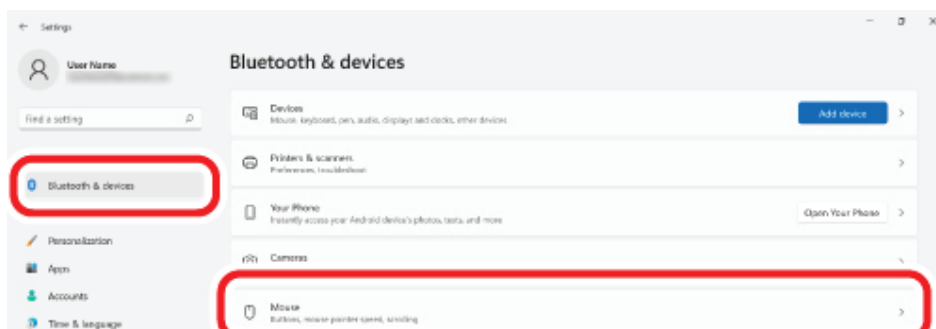

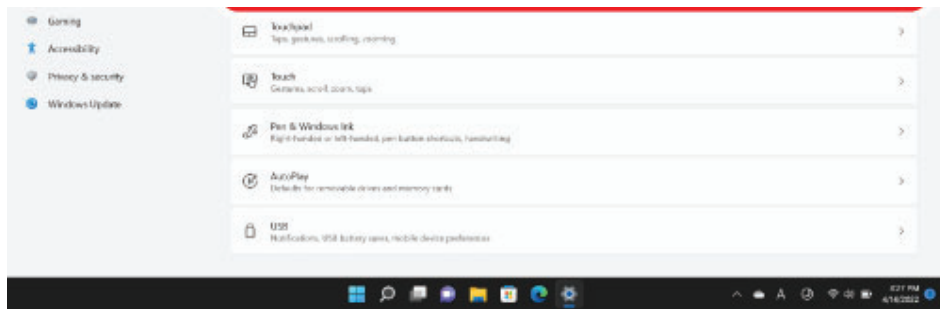

3) Adjust the “Lines to scroll at a time” slider bar to adjust the number of lines per scroll.

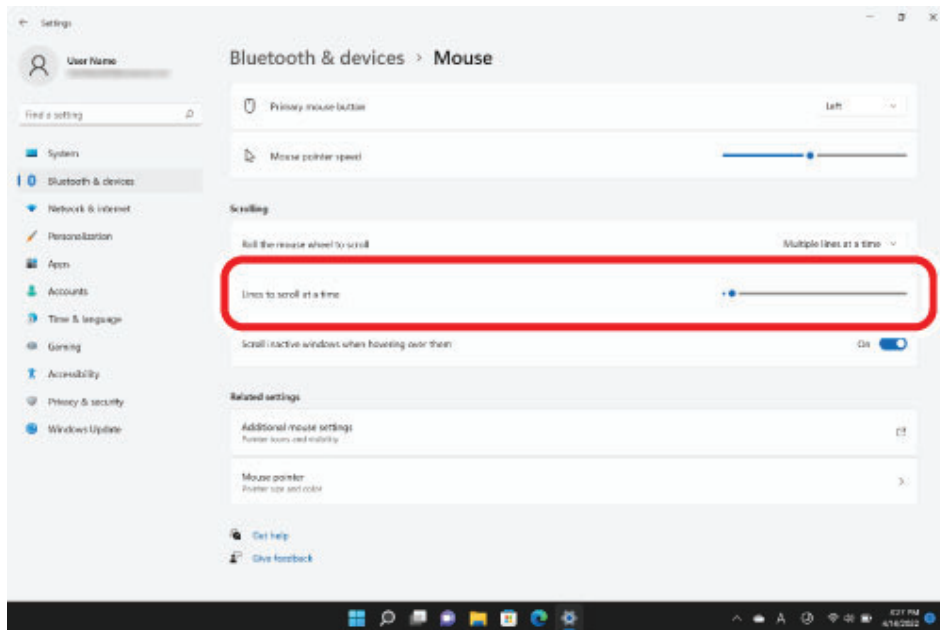

### ■ For Windows 10/8.1

1) Open “Mouse” properties.

#### • For Windows 10

From the start menu, click the Settings icon, select “Devices” → “Mouse”, then click “Additional mouse options” under “Related settings”.

#### • For Windows 8.1

Right-click the Start button in the bottom left-hand corner of the screen and select "Control Panel" → "Hardware and Sound" → "Devices and Printers", then click on "Mouse" under “Devices and Printers”.

2) Select the “Wheel” tab.

3) Change the value of “The following number of lines at a time” under “Roll the wheel one notch to scroll”





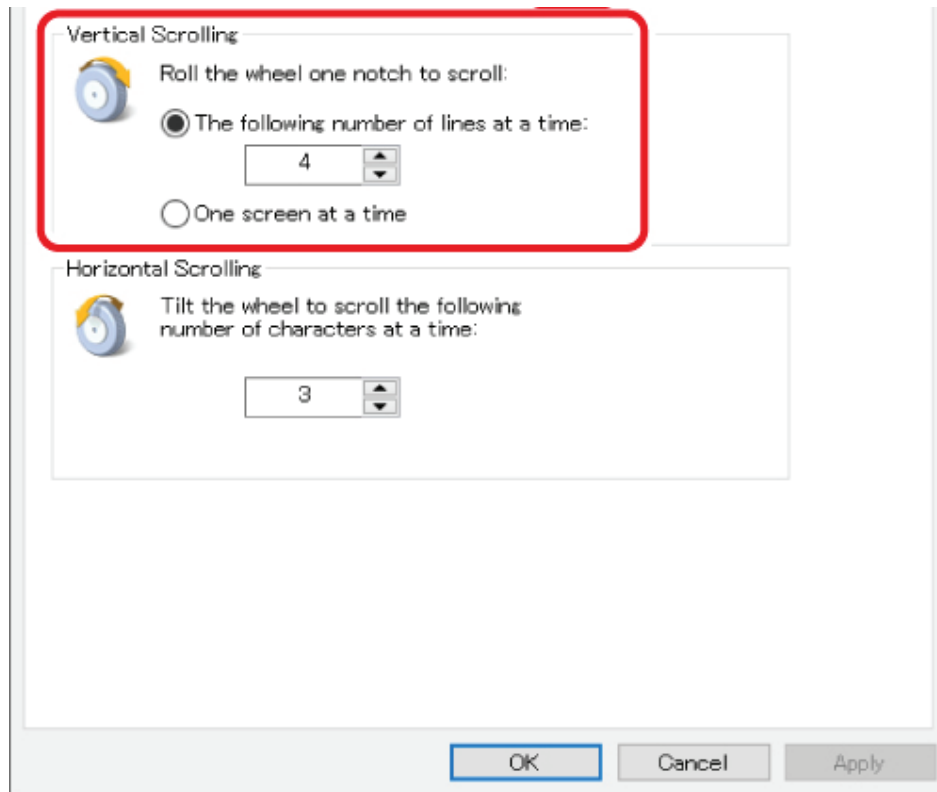

## Mac



### 1. Insert battery

1) Remove the battery cover.

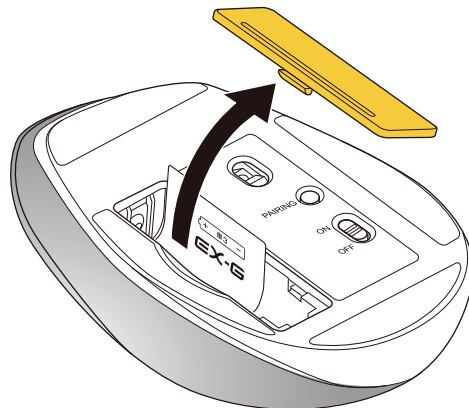

2) Insert the battery as instructed on the battery removal sheet.

Insert the battery in with the battery removal sheet below it.

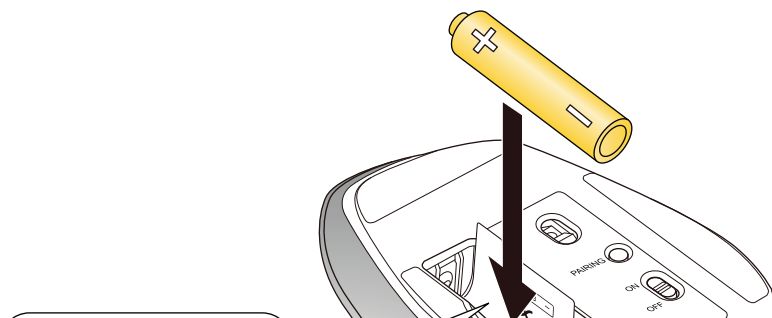

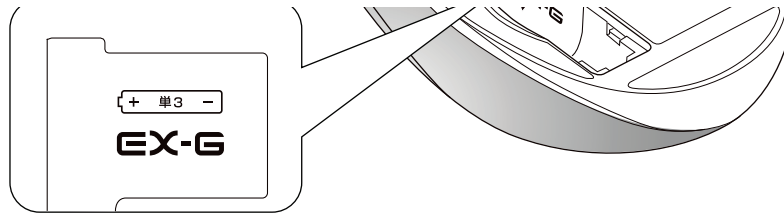

Ensure that the battery is inserted with its positive (+) and negative (-) ends oriented correctly.

### 3) Re-attach the battery cover to its original state.

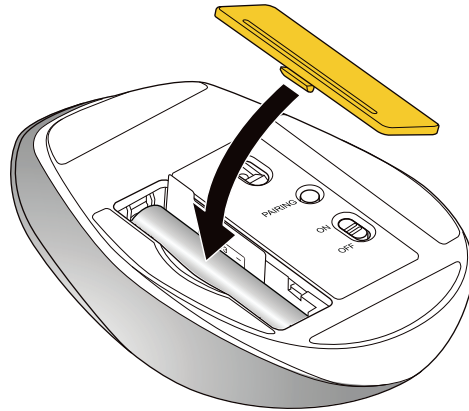

### Replacing the batteries...

Pull the battery removal sheet to remove the battery and replace it with a new one.

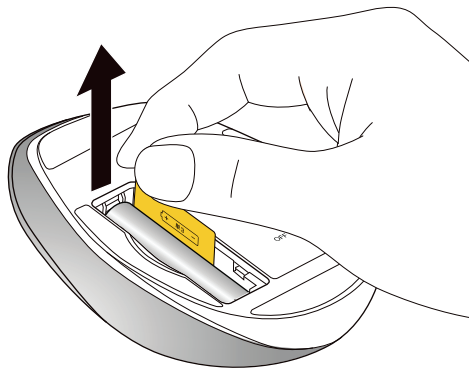

## 2. Turn the power ON

1) Slide the power switch on the underside of the product to the ON position.

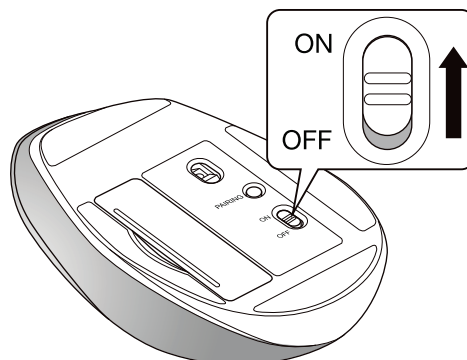

The LED lamp will blink periodically according to the amount of battery left.

\* When the battery level is low, the number of times the LED lamp blinks will decrease.



### Power-saving mode

When the mouse is left untouched for a fixed period of time while the power is ON, it automatically shifts to power-saving mode.

The mouse returns from power-saving mode when it is moved.

\* Mouse operation may be unstable for 2-3 seconds after returning from the power-saving mode.

## 3. Pairing with a PC

- Pairing involves registering Bluetooth devices (in this case, this product and your device) with each other, and authorizing a connection between them.
- This section covers macOS standard Bluetooth functions. Depending on your device or Bluetooth adaptor, unique Bluetooth functions may be used. Please read the respective manuals for each function.
- Please carry out the pairing operation using your current mouse or touchpad on your device.
- The following instructions are for macOS Monterey (12).

### 1) From the Apple menu, click on “System Preferences...”.

The System Preferences window will appear.

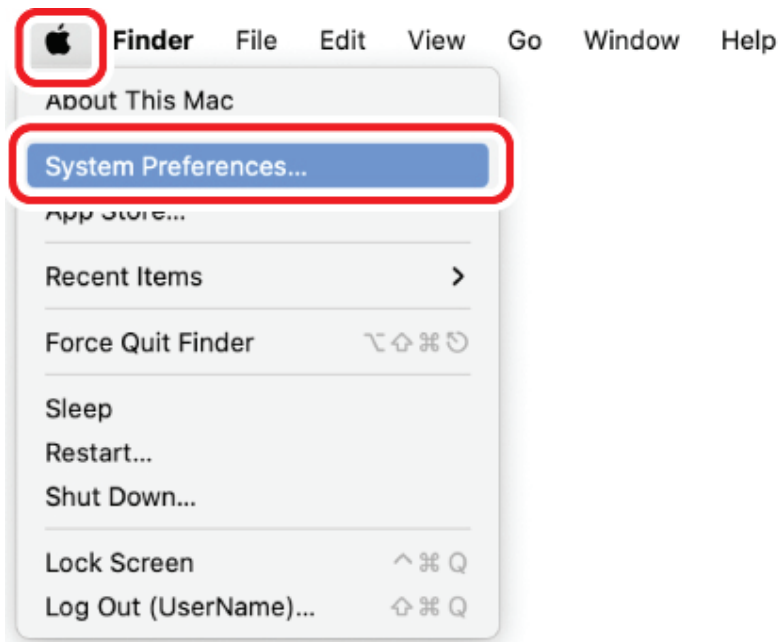

### 2) Click “Bluetooth”.

The “Bluetooth” system setting page will appear.

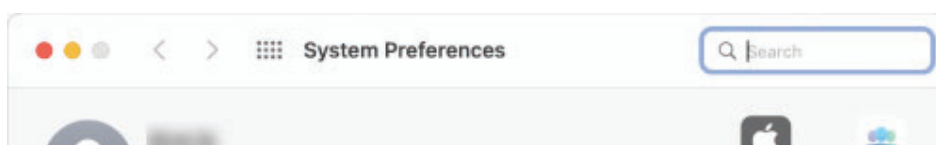



**3) Slide the switch to choose between the connected devices.**



- \* Please refer to **“Switch connected device”** to choose between connected devices.
- \* The currently pairing Bluetooth device is registered to the connected device selected here.

**4) During the device search, hold down the pairing button on the bottom surface for 2-3 seconds, and then release.**

Pairing mode is activated, and the LED lamp blinks red.

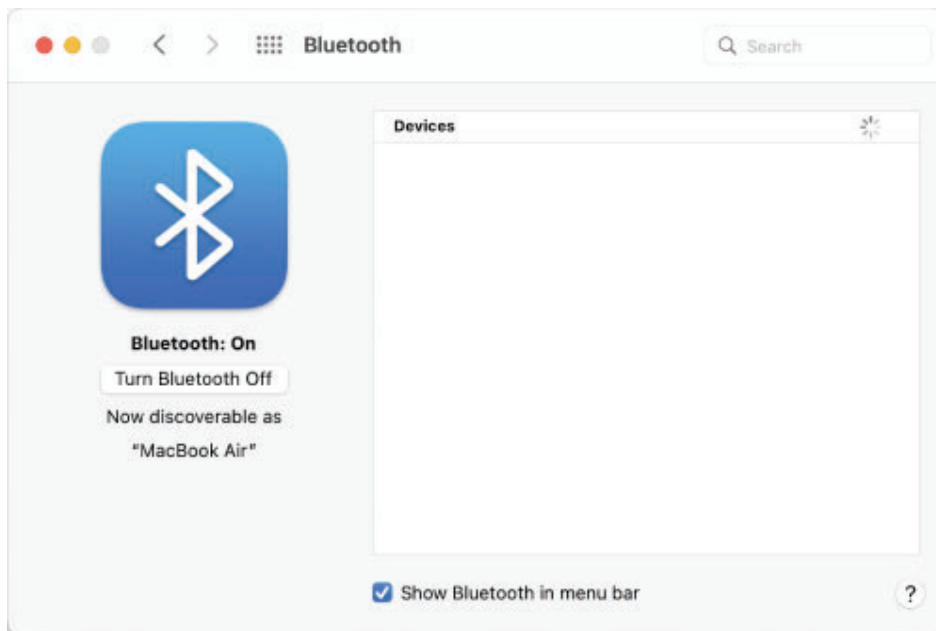

Pairing button



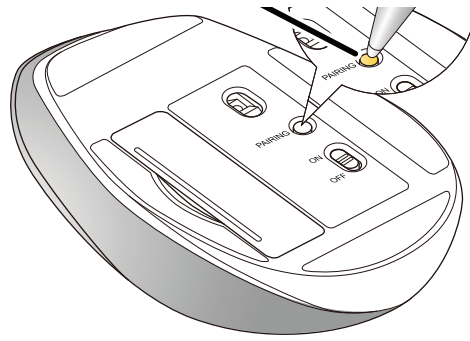

5) Select "ELECOM EX-G" and click on "Connect".

Pairing begins.

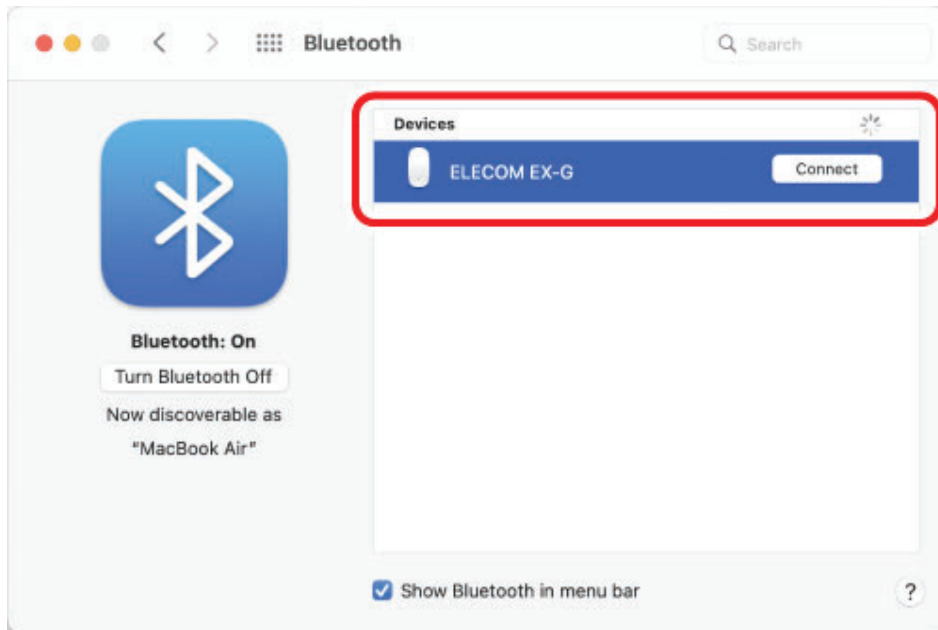

6) Pairing is complete when the status of "ELECOM EX-G" changes to "Connected".

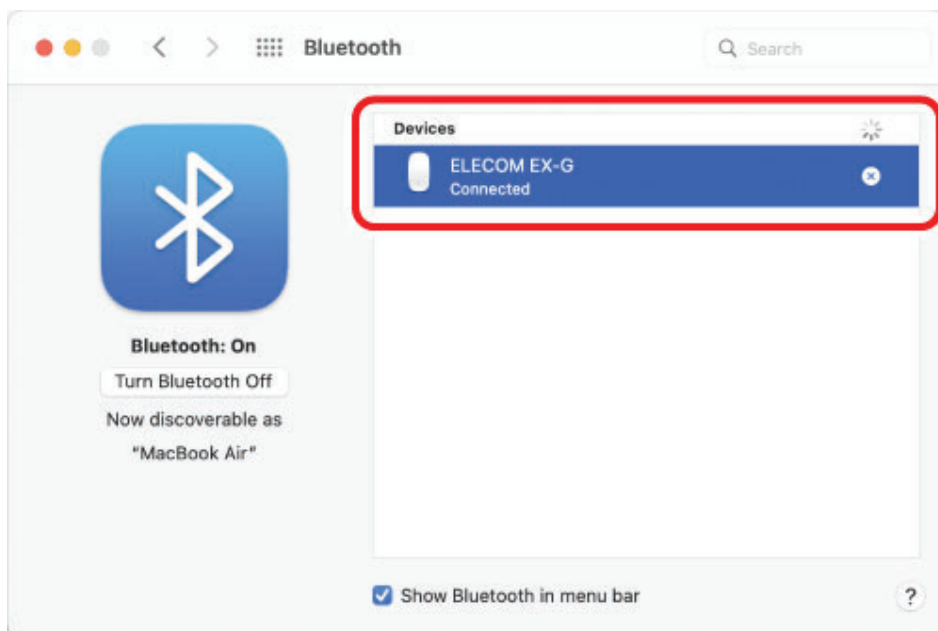

You can now use the mouse.

## Change the mouse pointer speed

Adjust the mouse pointer movement speed on your PC if the mouse pointer moves too fast or too slow.

### 1) Click “Mouse” under “System Preferences”.

The “Mouse” settings page will load up.

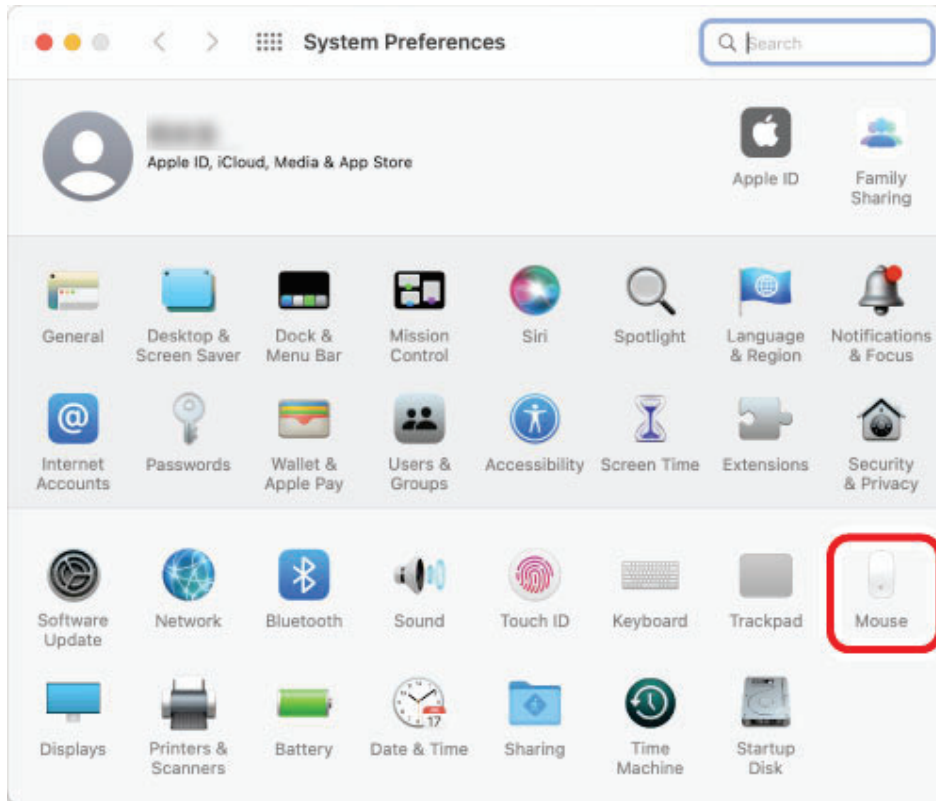

### 2) Adjust the “Tracking speed” slider to adjust the speed of the mouse pointer.

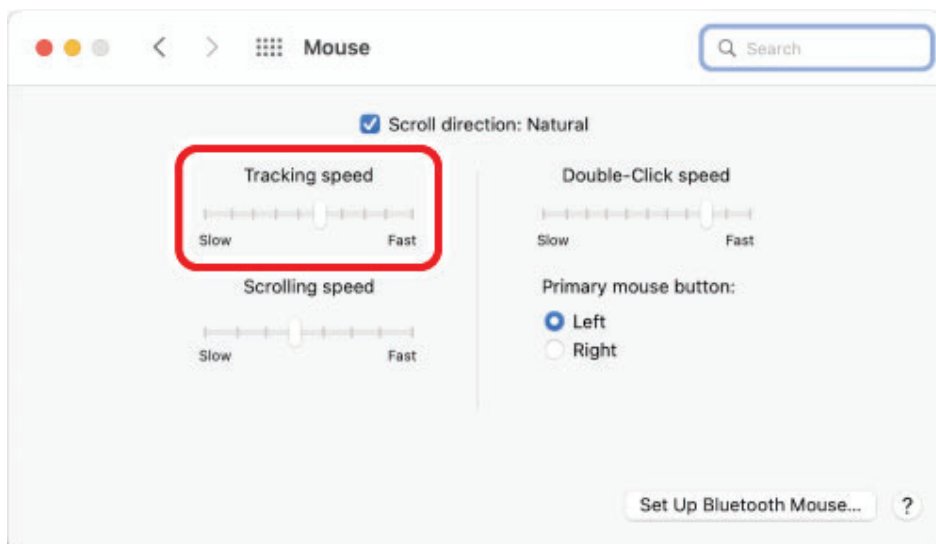

Unchecking “Scroll direction: Natural” will cause the scroll direction to be inverted



## iPhone, iPad



### 1. Insert battery

1) Remove the battery cover.

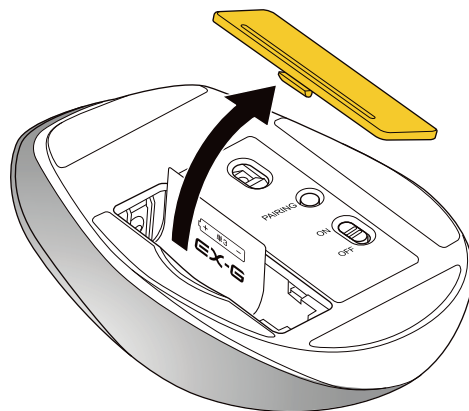

2) Insert the battery as instructed on the battery removal sheet.

Insert the battery in with the battery removal sheet below it.

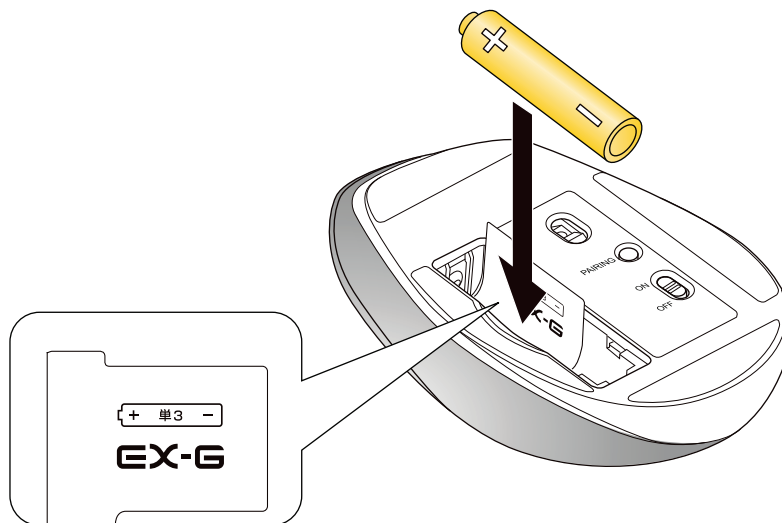

Ensure that the battery is inserted with its positive (+) and negative (-) ends oriented correctly.

3) Re-attach the battery cover to its original state.

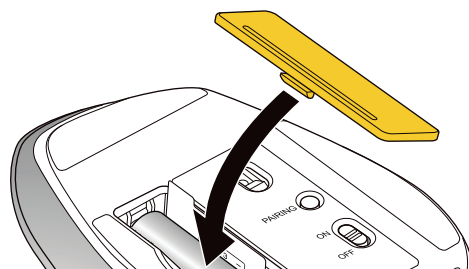

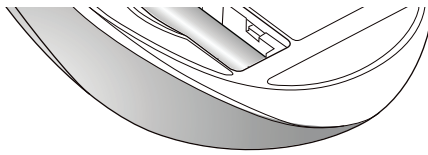

### Replacing the batteries...

Pull the battery removal sheet to remove the battery and replace it with a new one.

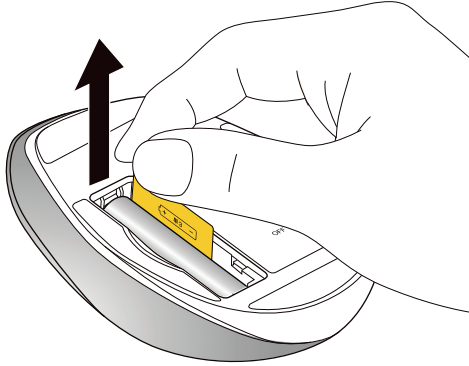

## 2. Turn the power ON

1) Slide the power switch on the underside of the product to the ON position.

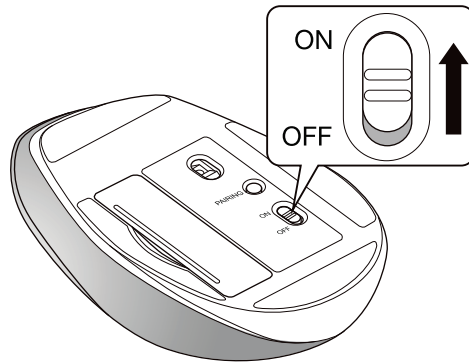

The LED lamp will blink periodically according to the amount of battery left.

\* When the battery level is low, the number of times the LED lamp blinks will decrease.



### Power-saving mode

When the mouse is left untouched for a fixed period of time while the power is ON, it automatically shifts to power-saving mode.

The mouse returns from power-saving mode when it is moved.

\* Mouse operation may be unstable for 2-3 seconds after returning from the power-saving mode.

## 3. Pairing with an iPad or an iPhone

- Pairing involves registering Bluetooth devices (in this case, this product and an iPad or an iPhone) with each other, and authorizing a connection between them.
- Tapping is required to operate the iPad or iPhone device until pairing is complete.
- The following instructions are for iPadOS Ver.14.8.



1) Tap on "Settings" from the home page.



2) Tap on "Bluetooth" to turn on the "Bluetooth".

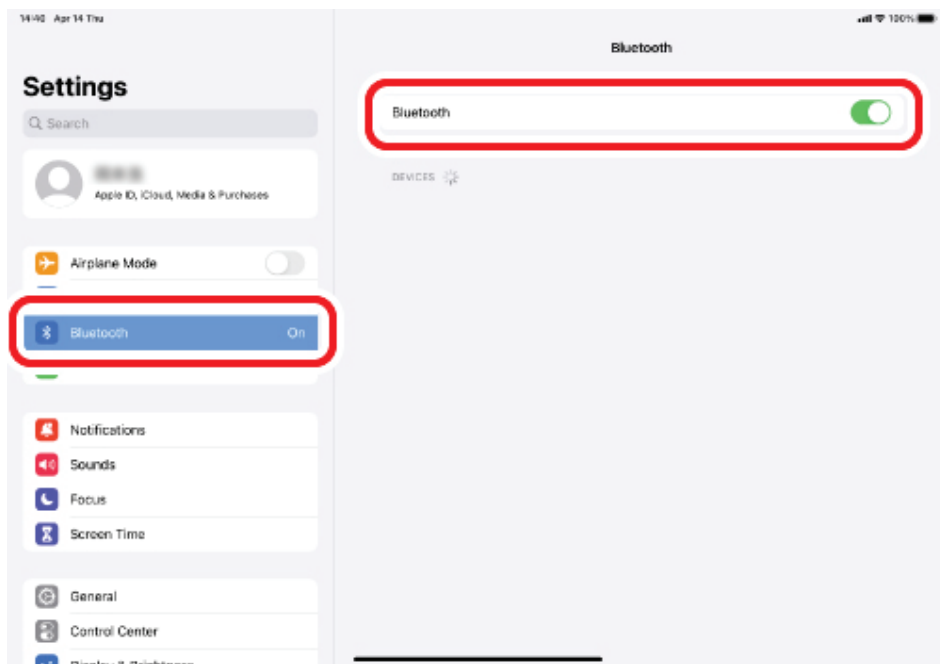

3) Slide the switch to choose between the connected devices.



- Please refer to "**Switch connected device**" to choose between connected devices.
- The currently pairing Bluetooth device is registered to the connected device selected here.

4) During the device search, hold down the pairing button on the bottom surface for 2-3 seconds, and then release.

Pairing mode is activated. and the I FD lamp blinks red.

Pairing mode is activated, and the LED lamp blinks red.

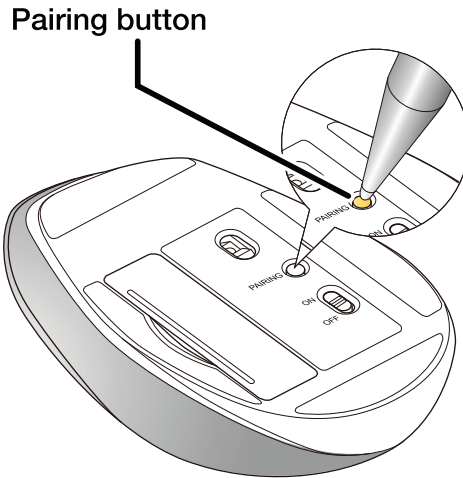

5) Tap on “ELECOM EX-G” when it is detected under “DEVICES”.  
Pairing begins.

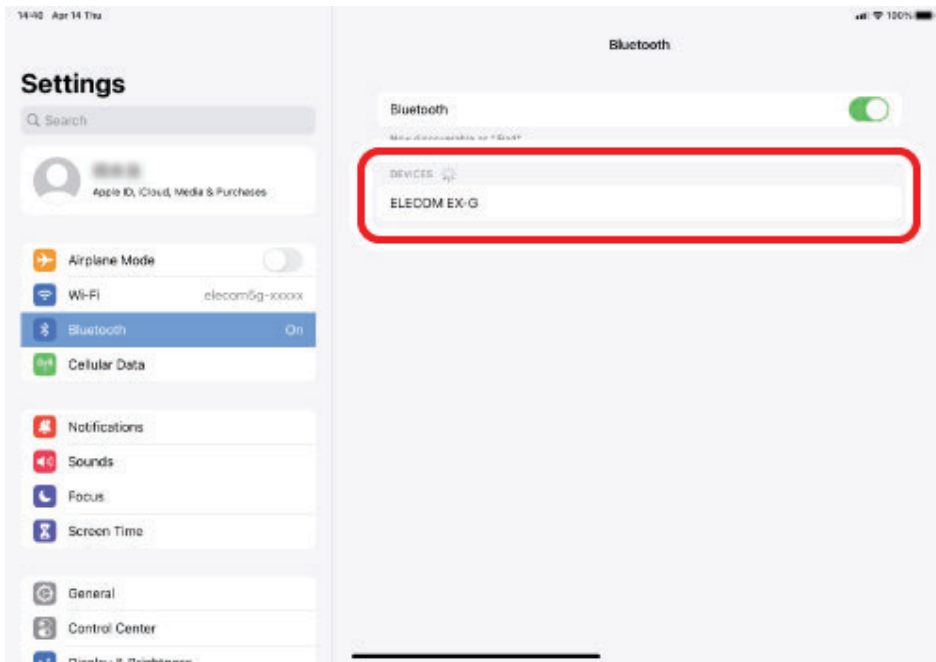

6) When the “Bluetooth Pairing Request” page loads, tap on “Pair”.

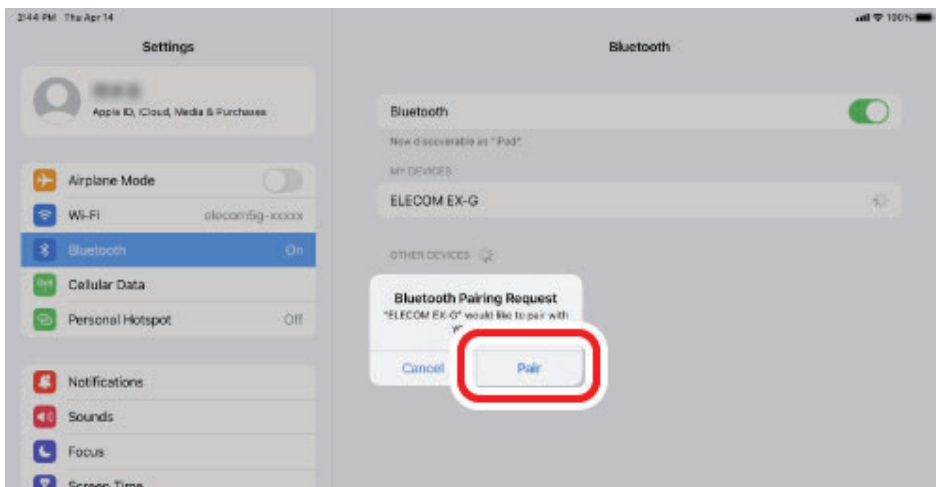



7) When the device is “Connected”, the mouse is connected.

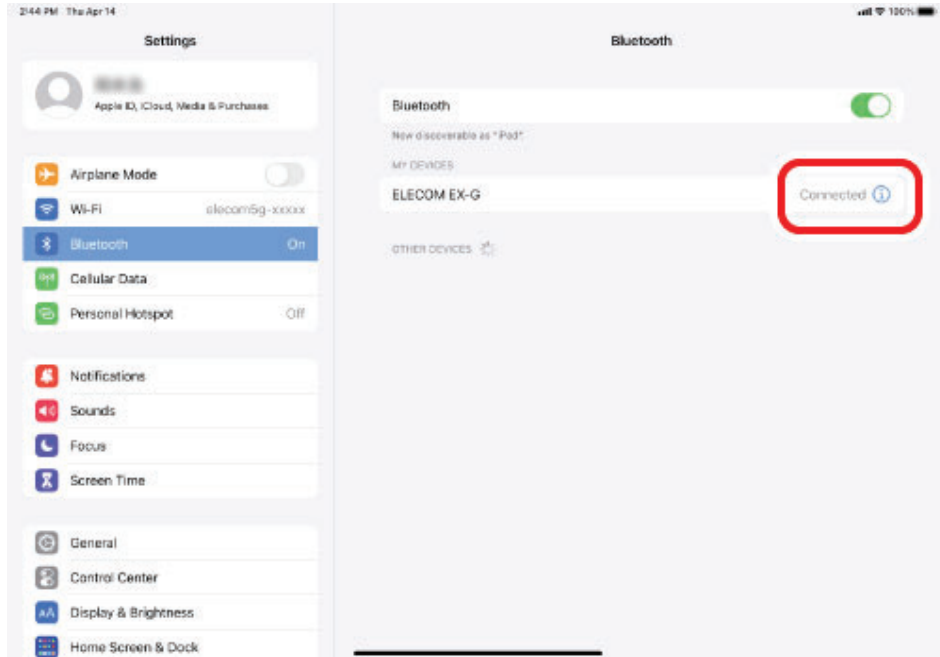

You can now use the mouse.

## Register custom actions to the buttons

Only the 2 buttons and the wheel can be used under the initial settings.

- Button 1: Single-Tap
- Button 2: Secondary Click

Follow the steps below to assign all other button functions.

### 1. Turn ON AssistiveTouch

1) Tap on “Accessibility” under “Settings”.

2) Tap on “Touch”.

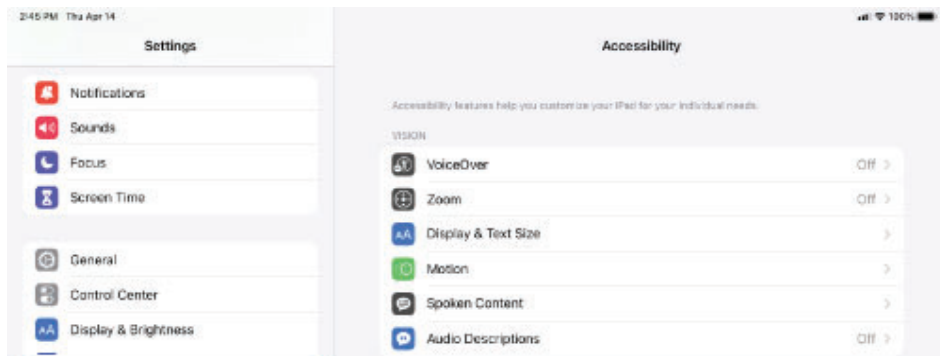

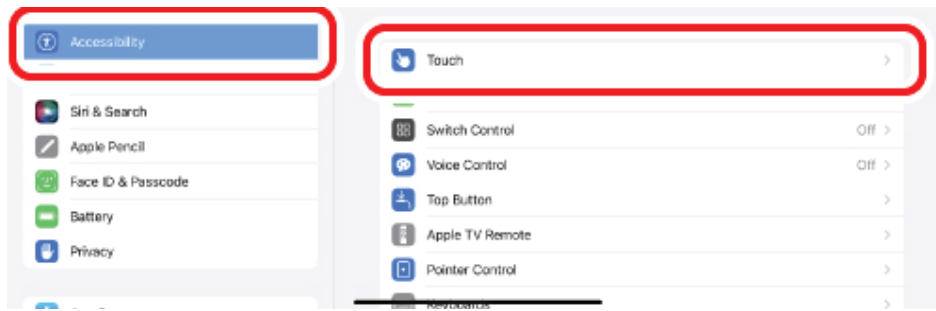

3. Tap on "AssistiveTouch".

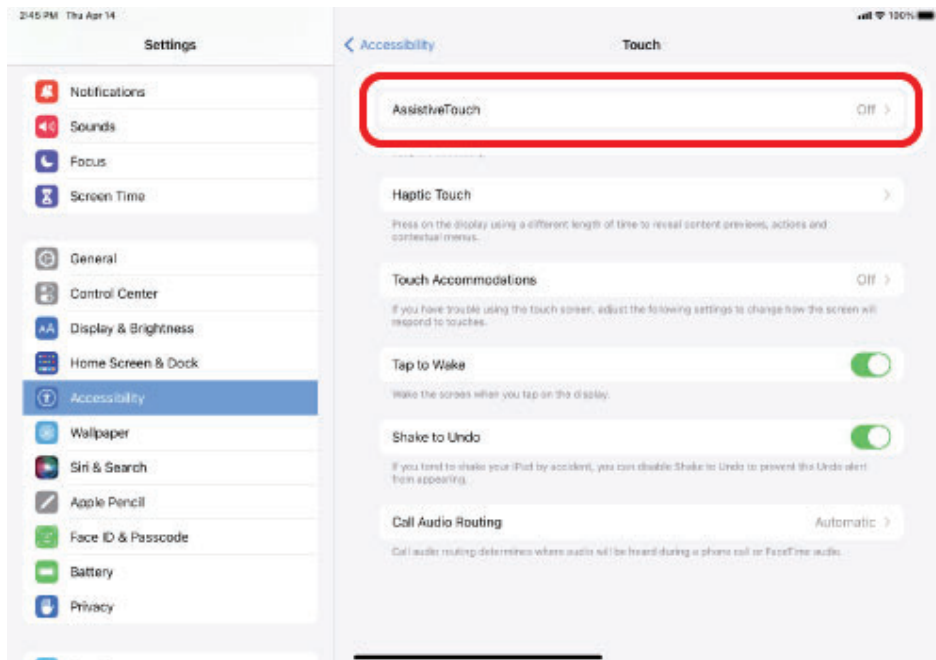

4. Tap on "AssistiveTouch" to turn ON.

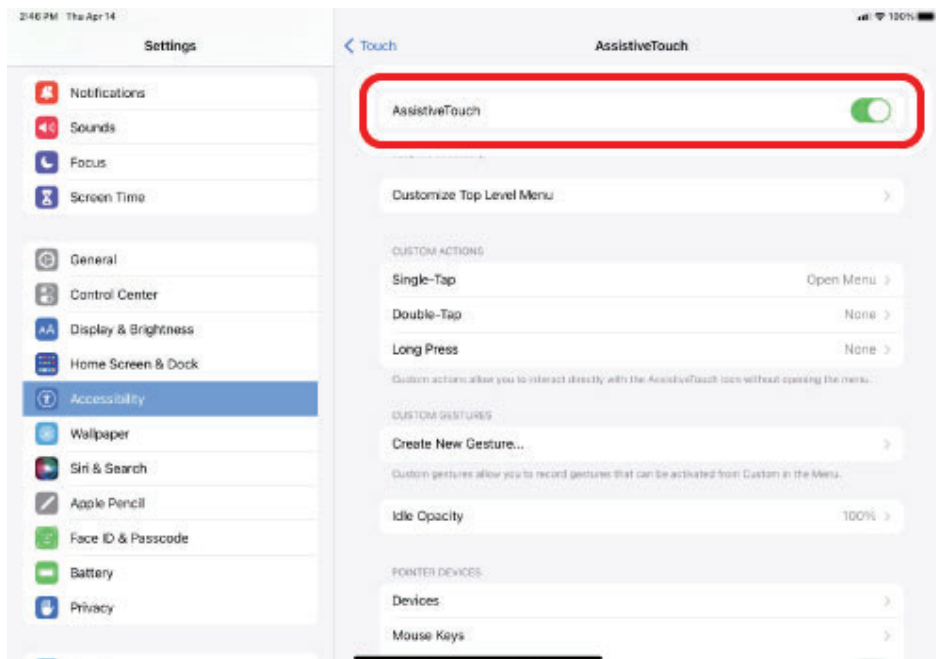

2. Assign custom actions to the buttons

1) Tap on "Devices" under "POINTING DEVICES".

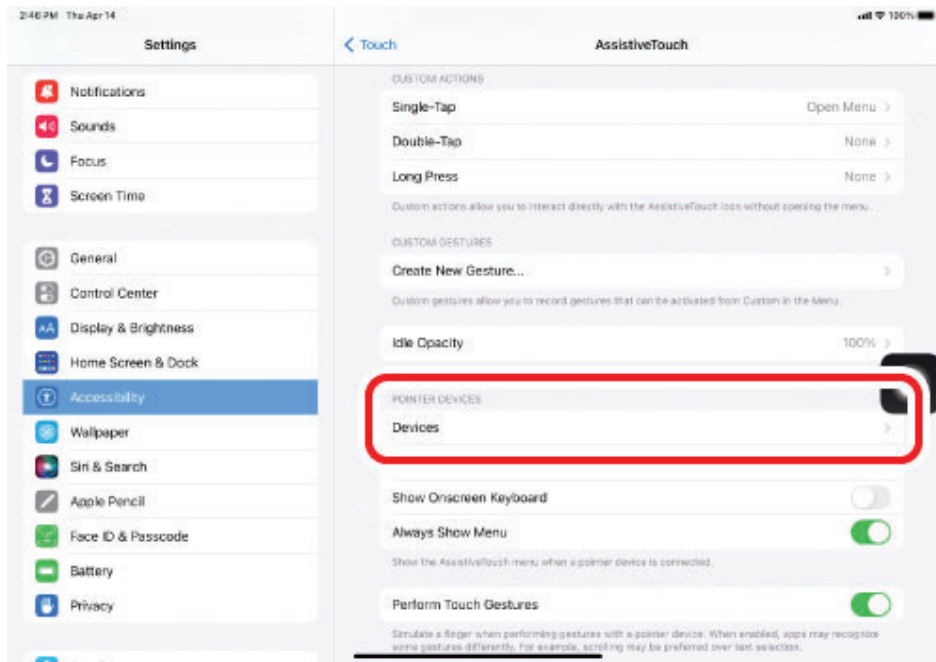

2) Tap "ELECOM EX-G".

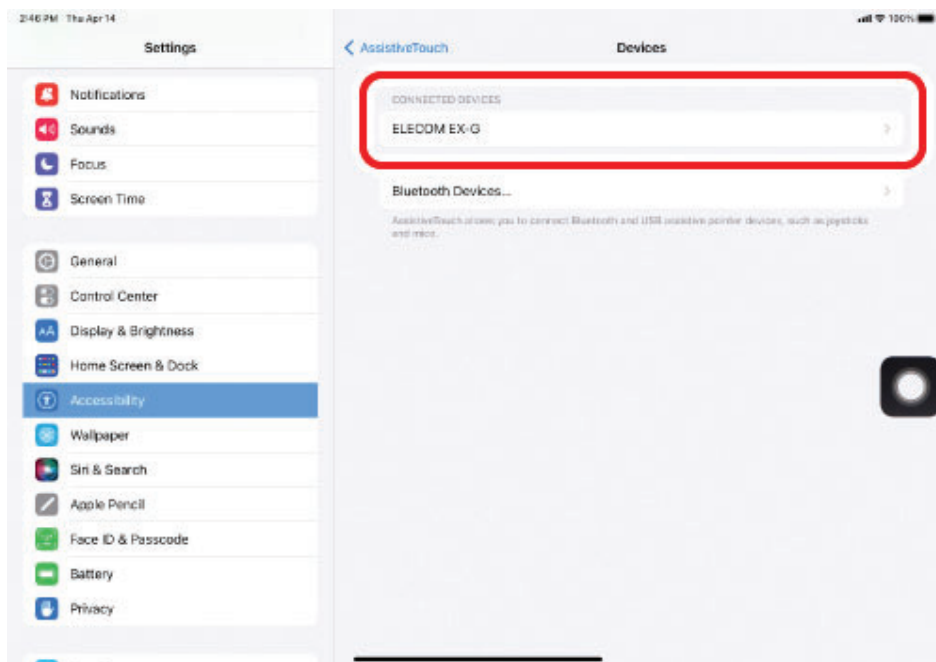

3) Tap on "Customize Additional Buttons...".

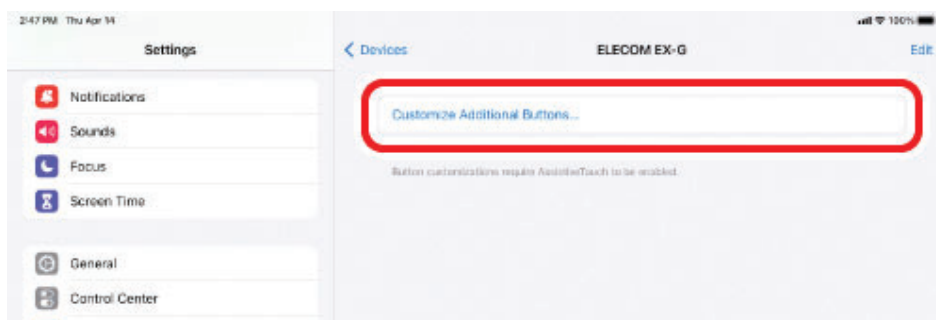

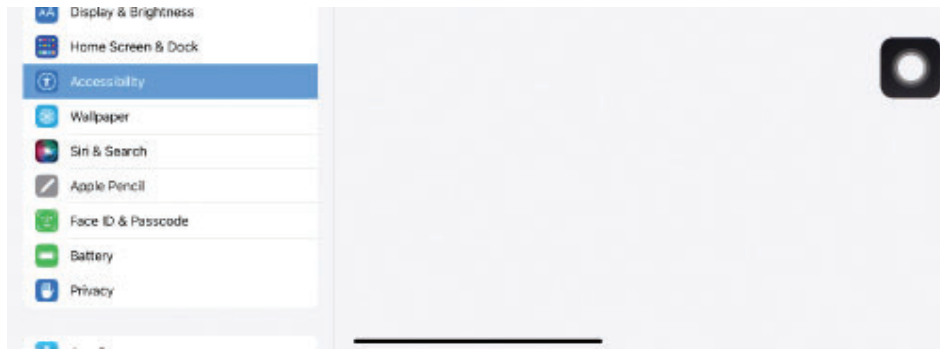

4) When the "Customize Button" page loads, click on the button on the mouse to be added.

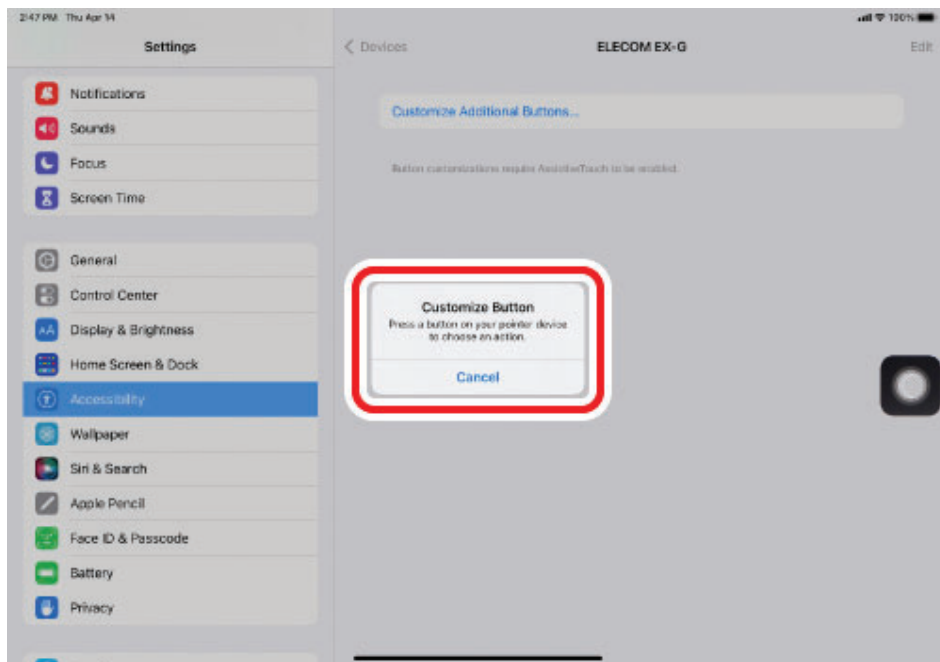

\* When adding "Button 3".

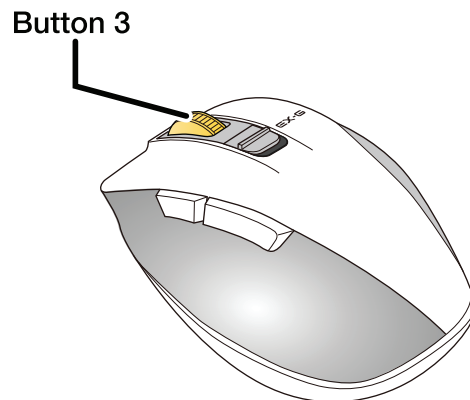

5) A list of all assignable functions will load. Tap on the desired function to assign.

\* When assigning "Screenshot" to "Button 3".

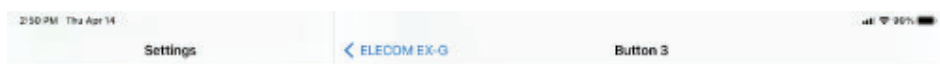

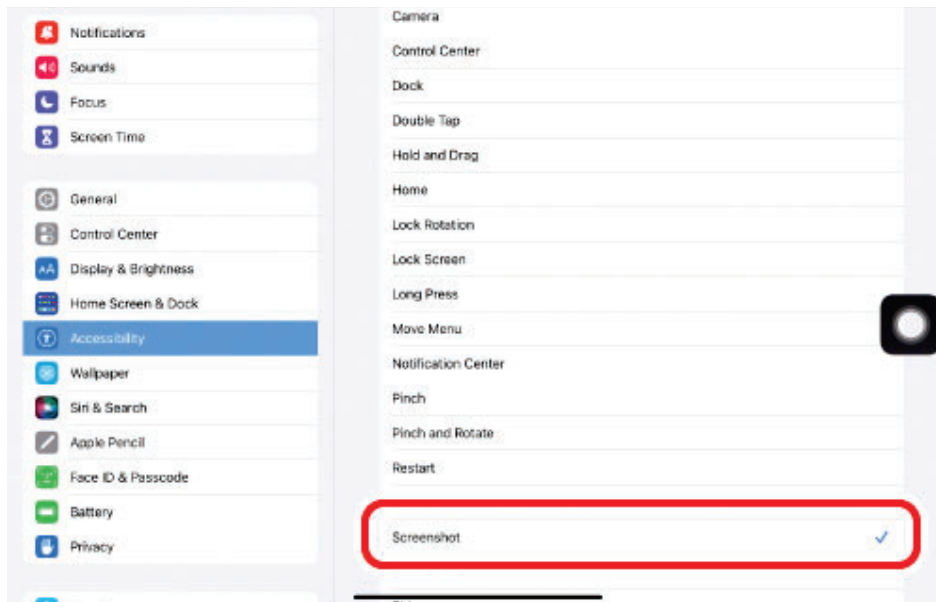

6) A function is assigned to the button. To assign other buttons, repeat the steps above.

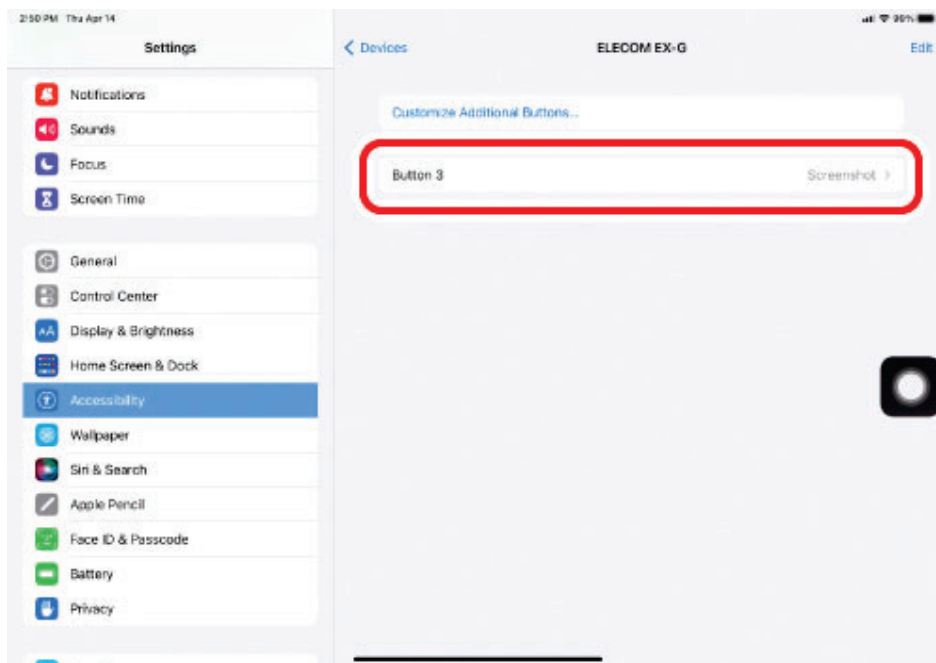

When AssistiveTouch is ON, the Custom Action function is disabled and only the initial right click, left click and wheel scroll functions may be used.

## Android



### 1. Insert battery

1) Remove the battery cover.





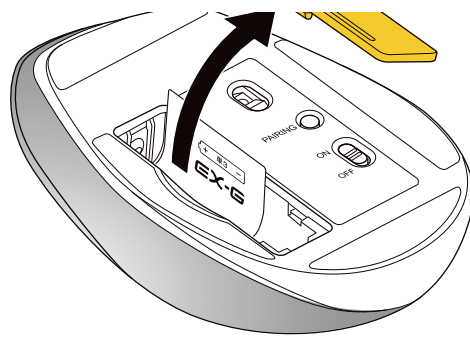

## 2) Insert the battery as instructed on the battery removal sheet.

Insert the battery in with the battery removal sheet below it.

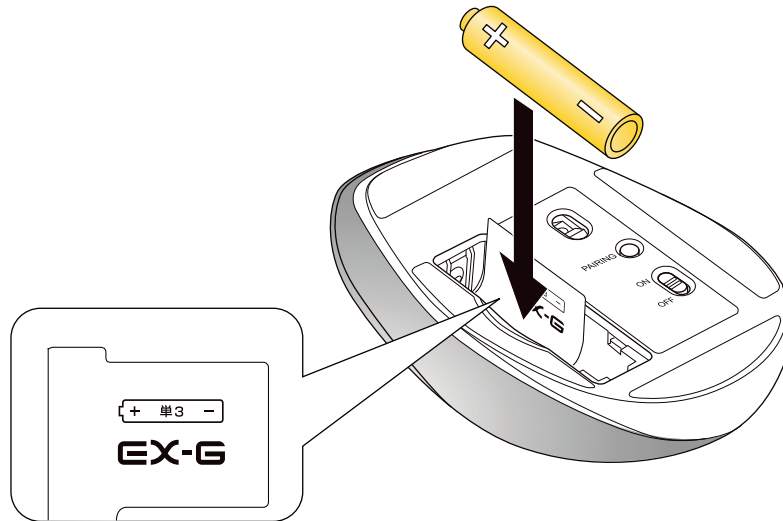

Ensure that the battery is inserted with its positive (+) and negative (-) ends oriented correctly.

## 3) Re-attach the battery cover to its original state.

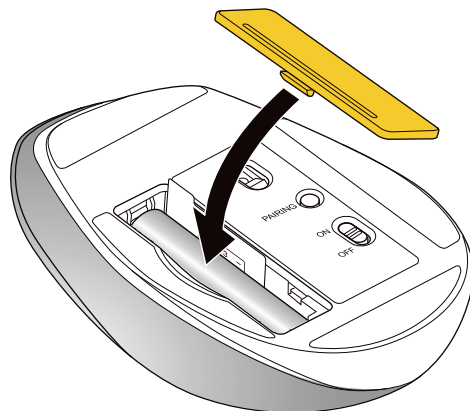

### Replacing the batteries...

Pull the battery removal sheet to remove the battery and replace it with a new one.





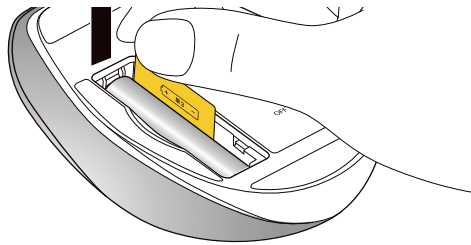

## 2. Turn the power ON

1) Slide the power switch on the underside of the product to the ON position.

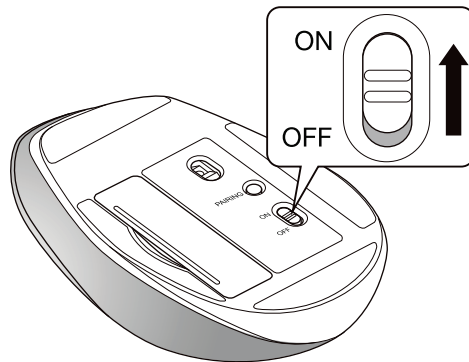

The LED lamp will blink periodically according to the amount of battery left.

\* When the battery level is low, the number of times the LED lamp blinks will decrease.



### Power-saving mode

When the mouse is left untouched for a fixed period of time while the power is ON, it automatically shifts to power-saving mode.

The mouse returns from power-saving mode when it is moved.

\* Mouse operation may be unstable for 2-3 seconds after returning from the power-saving mode.

## 3. Pairing with an Android device.

- Pairing involves registering Bluetooth devices (in this case, this product and an Android device) with each other, and authorizing a connection between them.
- Tapping is required to operate the Android device until pairing is complete.
- The following instructions are based on the Galaxy Tab A7 Lite (Android 11.0) screen and may vary based on the device type or OS version.

1) Tap on "Settings".

2) Tap "Connect"



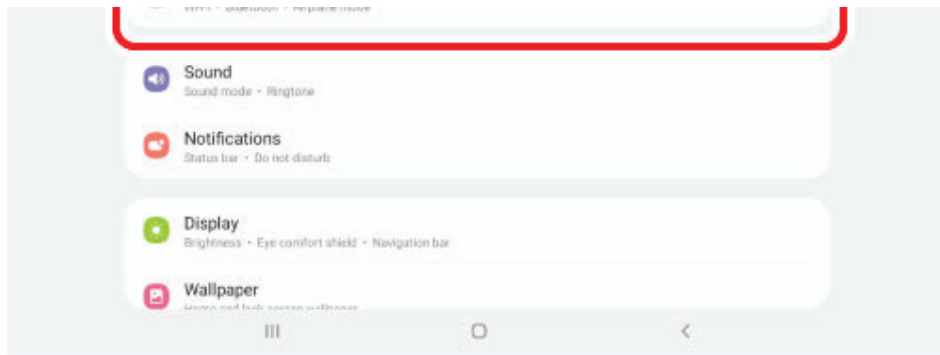

### 3) Tap "Bluetooth".

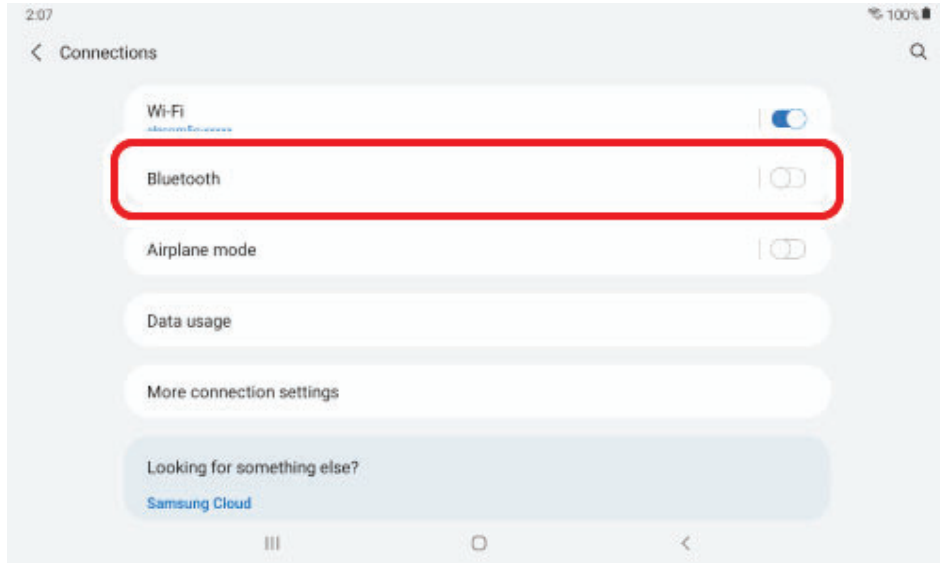

### 4) Make sure "Bluetooth" is switched "ON".

If it is disabled, tap to switch it "ON".

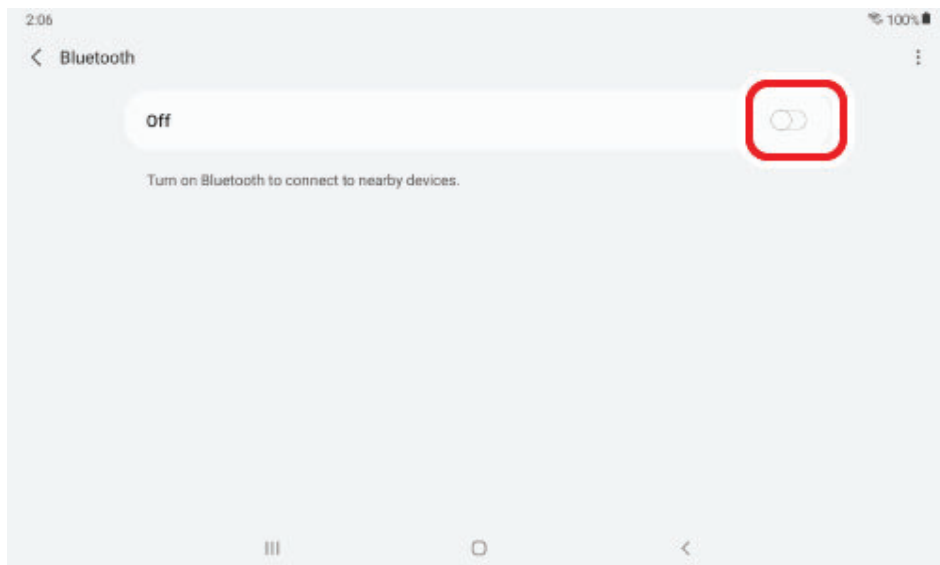

### 5) Slide the switch to choose between the connected devices.



- Please refer to **"Switch connected device"** to choose between connected devices.
- The currently pairing Bluetooth device is registered to the connected device selected

here.

**6) Hold down the pairing button at the bottom of the product for around 2 to 3 seconds and then release.**

Pairing mode is activated, and the LED lamp blinks red.

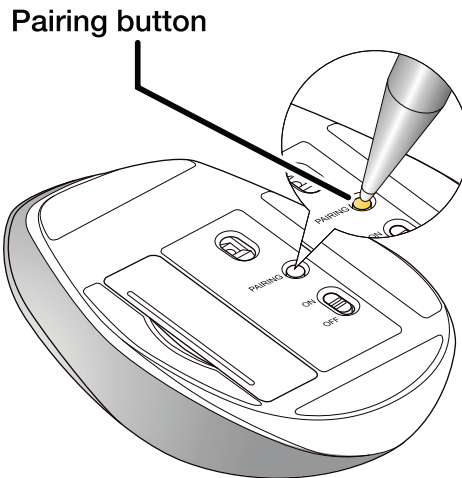

**7) Tap "ELECOM EX-G" from the listed devices.**

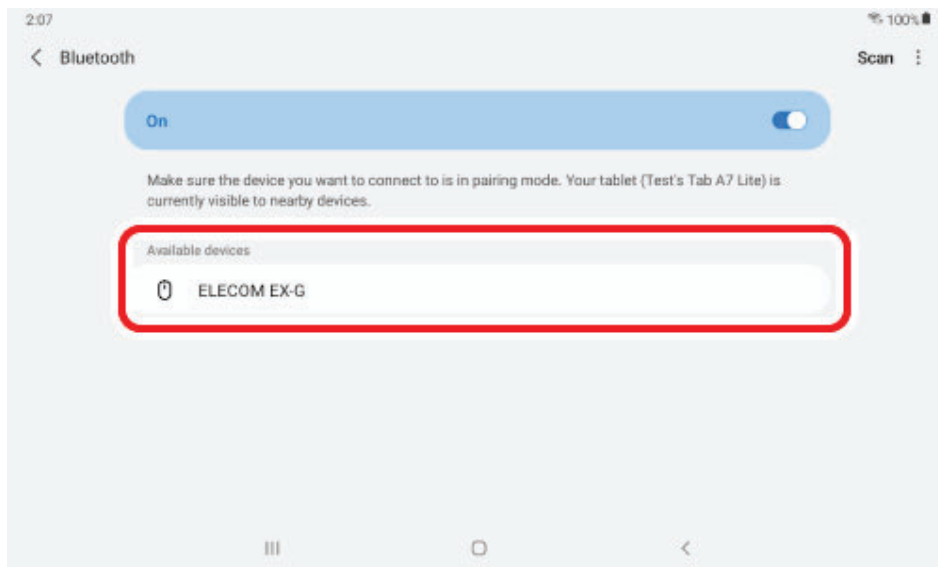

Pairing begins.



If "ELECOM EX-G" is not listed in the devices, tap the "Scan" button in the upper-right corner.

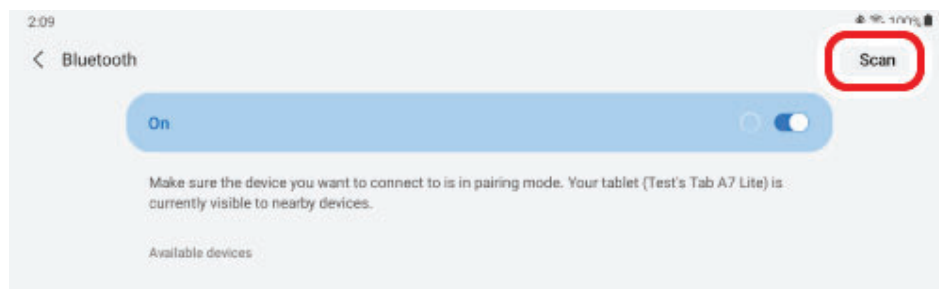

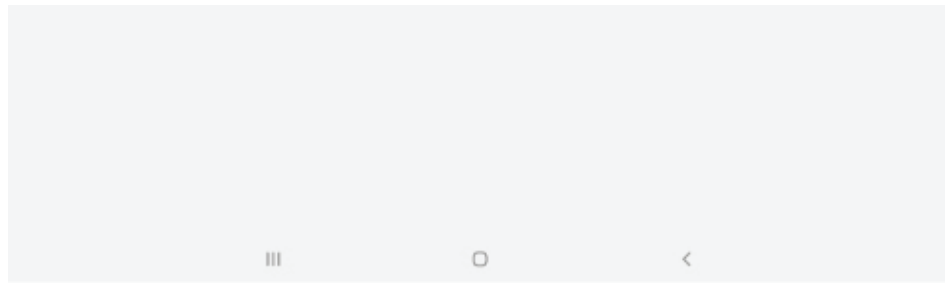

8) Tap the "Pair" button.

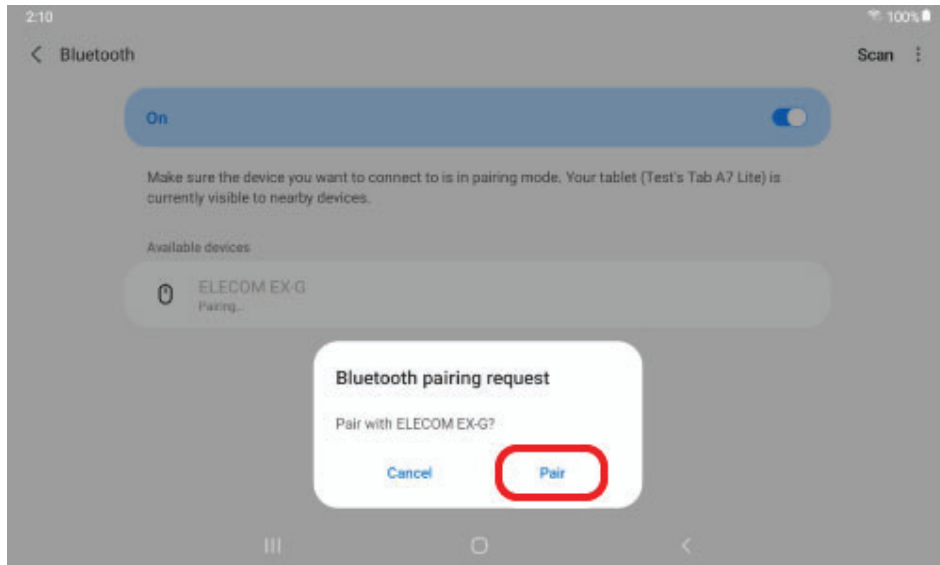

9) If the LED lights up, the pairing has been completed.

If the "ELECOM EX-G" is displayed in the "Paired devices", it has been correctly paired with your device.

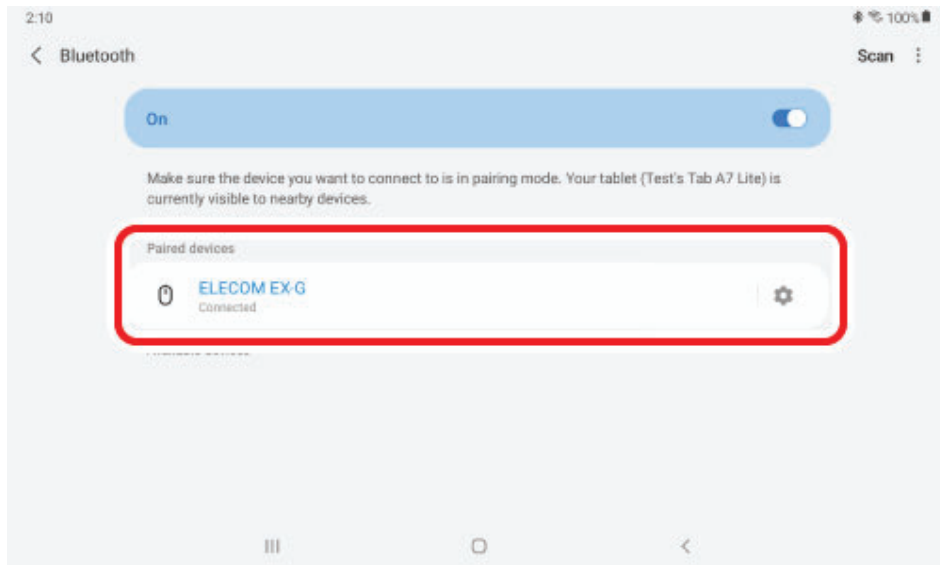

You can now use the mouse.

# 1. Insert battery

1) Remove the battery cover.

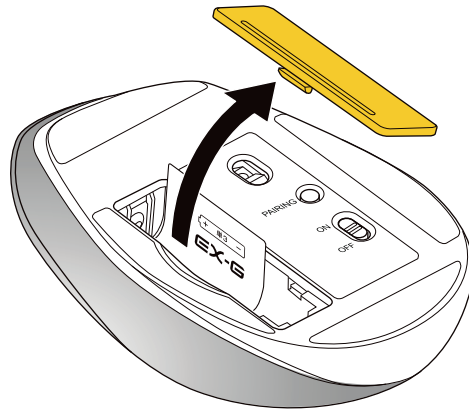

2) Insert the battery as instructed on the battery removal sheet.

Insert the battery in with the battery removal sheet below it.

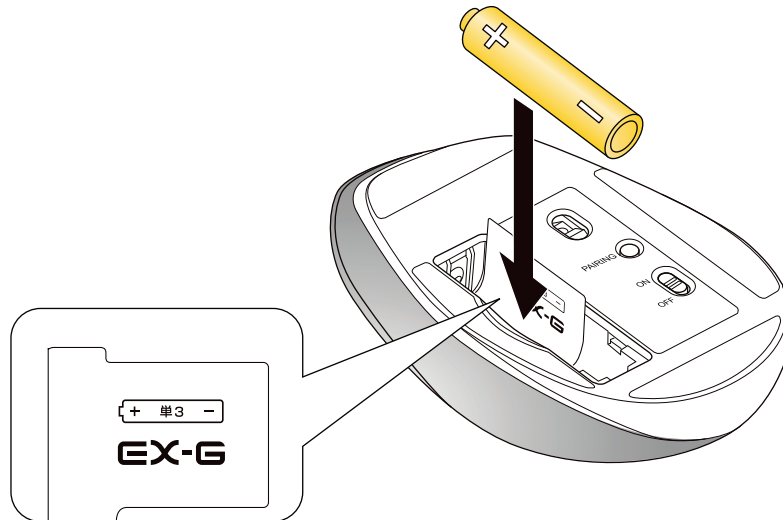

Ensure that the battery is inserted with its positive (+) and negative (-) ends oriented correctly.

3) Re-attach the battery cover to its original state.

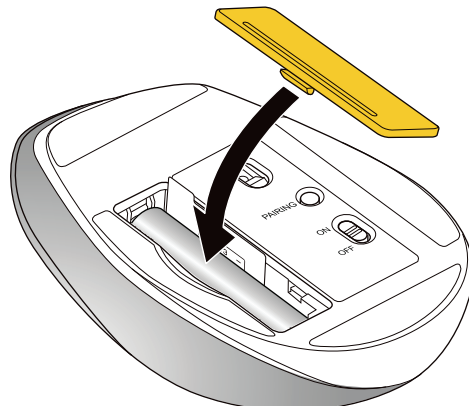



### Replacing the batteries...

Pull the battery removal sheet to remove the battery and replace it with a new one.

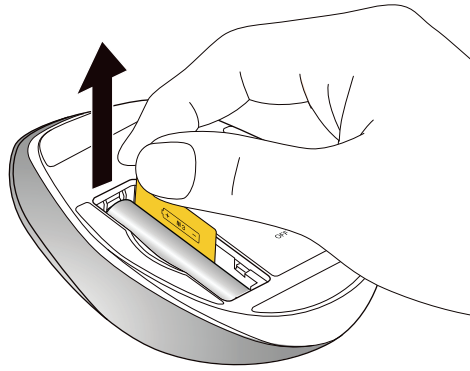

## 2. Turn the power ON

1) Slide the power switch on the underside of the product to the ON position.

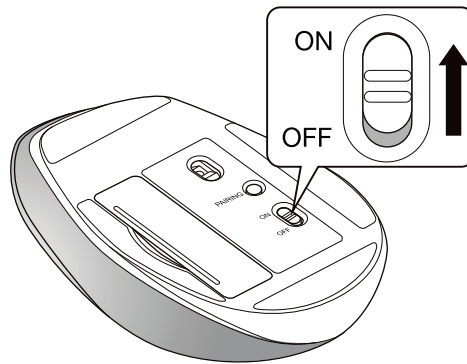

The LED lamp will blink periodically according to the amount of battery left.

\* When the battery level is low, the number of times the LED lamp blinks will decrease.



### Power-saving mode

When the mouse is left untouched for a fixed period of time while the power is ON, it automatically shifts to power-saving mode.

The mouse returns from power-saving mode when it is moved.

\* Mouse operation may be unstable for 2-3 seconds after returning from the power-saving mode.

## 3. Pairing with a PC

- Pairing involves registering Bluetooth devices (in this case, this product and your device) with each other, and authorizing a connection between them.
- This section covers Chrome OS standard Bluetooth functions. Depending on your device, unique Bluetooth functions may be used. Please read the respective manuals for each function.
- Please carry out the pairing operation using your current mouse or touchpad on your device.
- The following instructions are for Chrome OS (97.0.4692.77).

1) Click on the quick settings panel at the bottom right.

## 2) Click "Bluetooth".

If "Bluetooth" is off, turn it on.

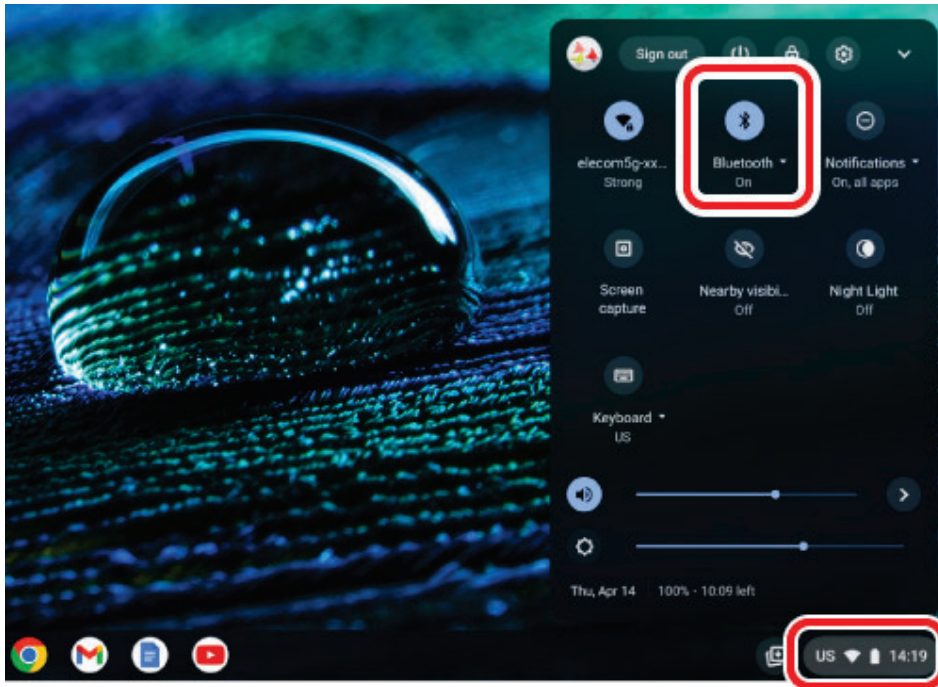

## 3) Slide the switch to choose between the connected devices.



- Please refer to **"Switch connected device"** to choose between connected devices.
- The currently pairing Bluetooth device is registered to the connected device selected here.

## 4) During the device search, hold down the pairing button on the bottom surface for 2 to 3 seconds, and then release.

Pairing mode is activated, and the LED lamp blinks red.

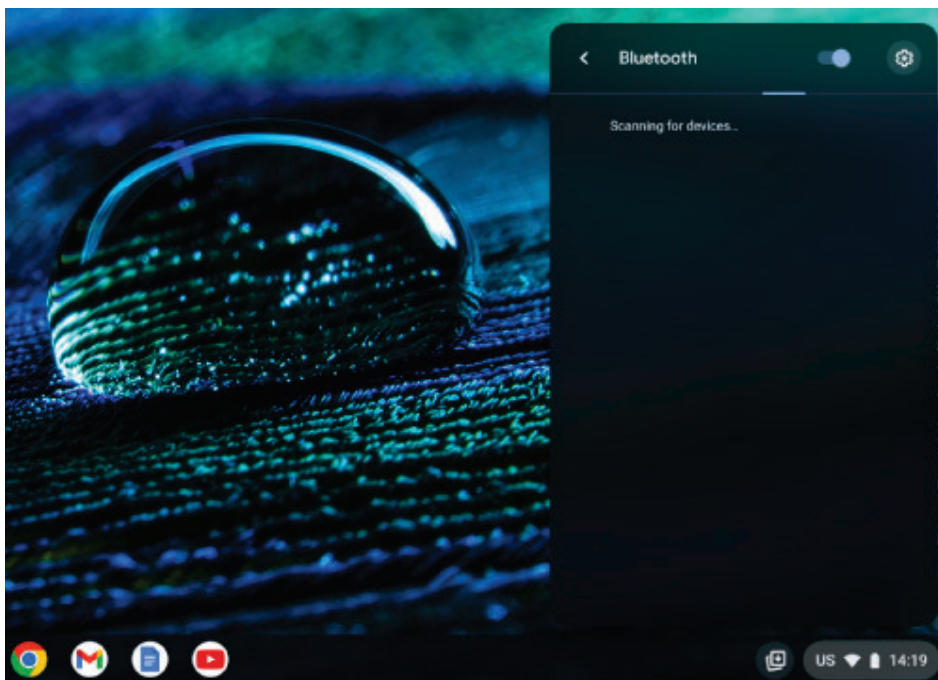



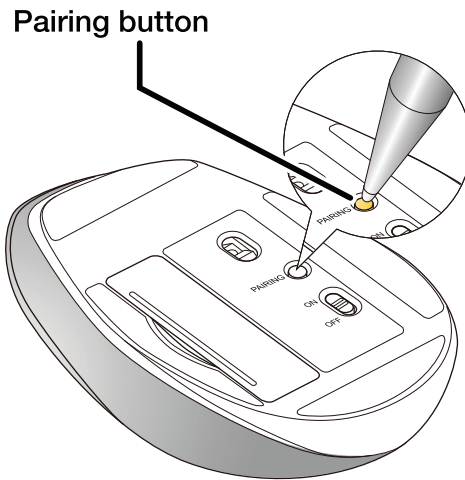

**5) Click "ELECOM EX-G".**

Pairing begins.

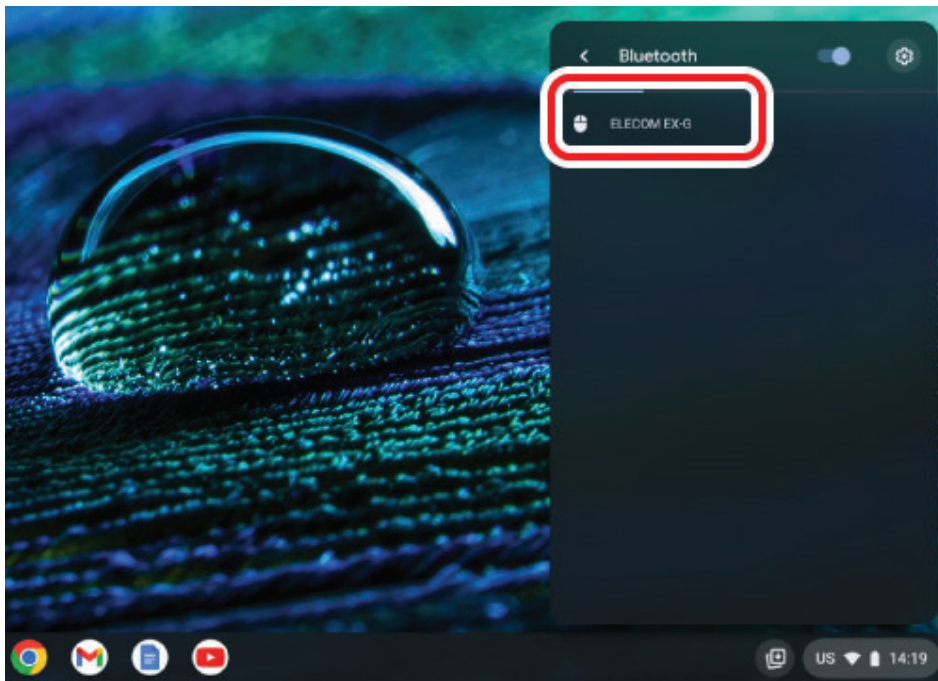

**6) "Bluetooth device "ELECOM EX-G" has been paired..." message will appear.**

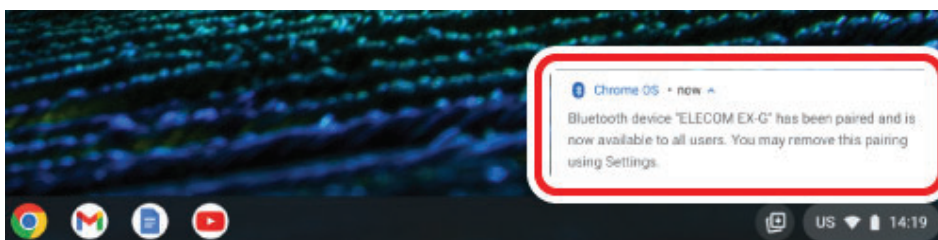

This product is properly paired when the "ELECOM EX-G" status is "Connected" under "Paired devices".





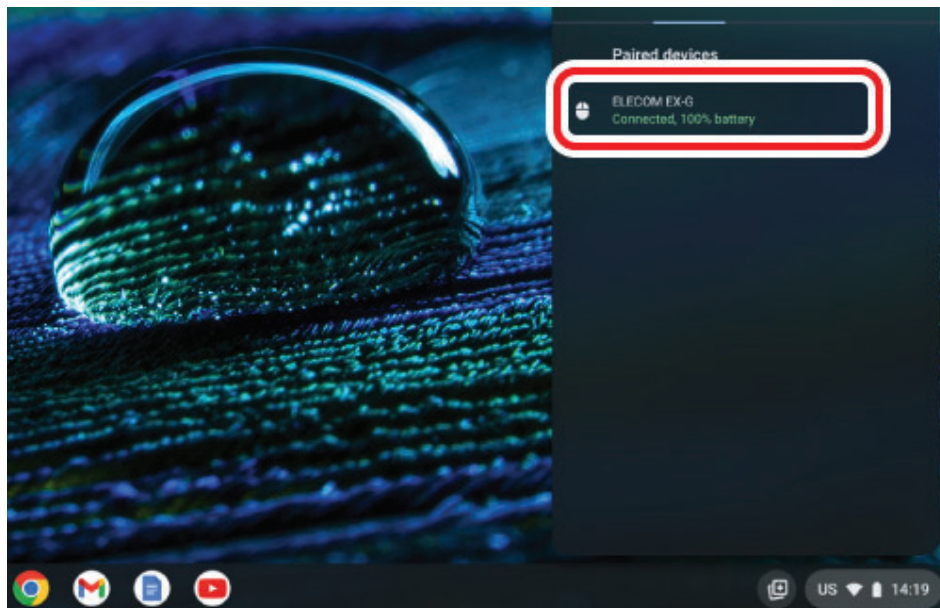

You can now use the mouse.

## Change the mouse pointer speed

Adjust the mouse pointer movement speed on your PC if the mouse pointer moves too fast or too slow.

1) Click on the quick settings panel at the bottom right.

2) Click on "Settings".

The settings page will appear.

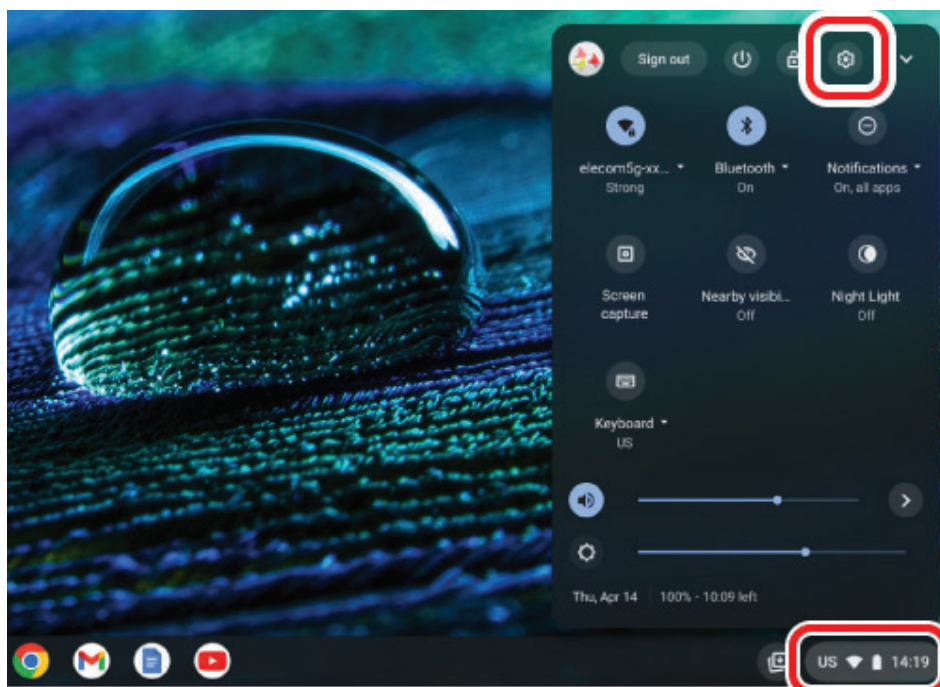

3) Click on "Mouse and touchpad" under "Devices".

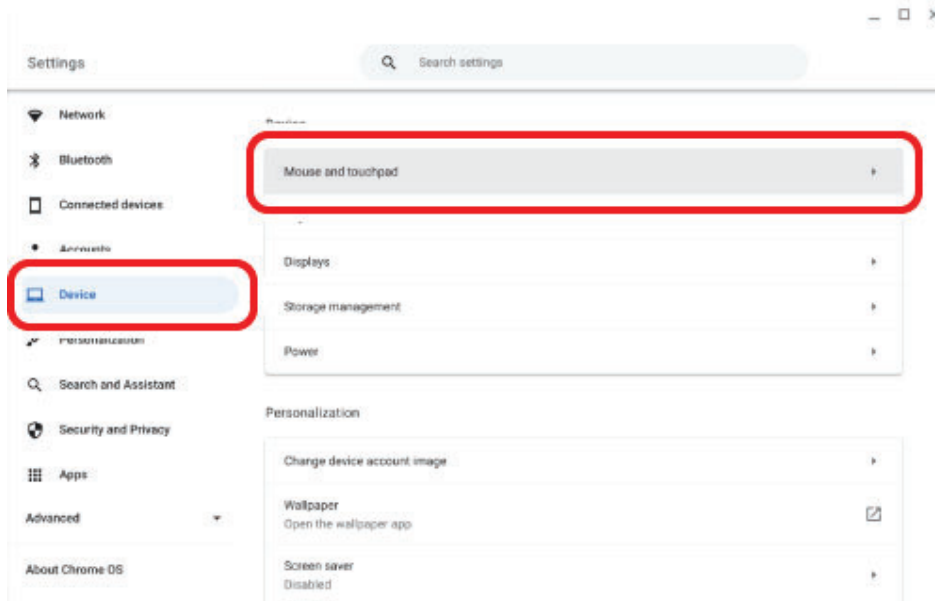

4) Adjust the “Mouse speed” slider to adjust the speed of the mouse pointer.

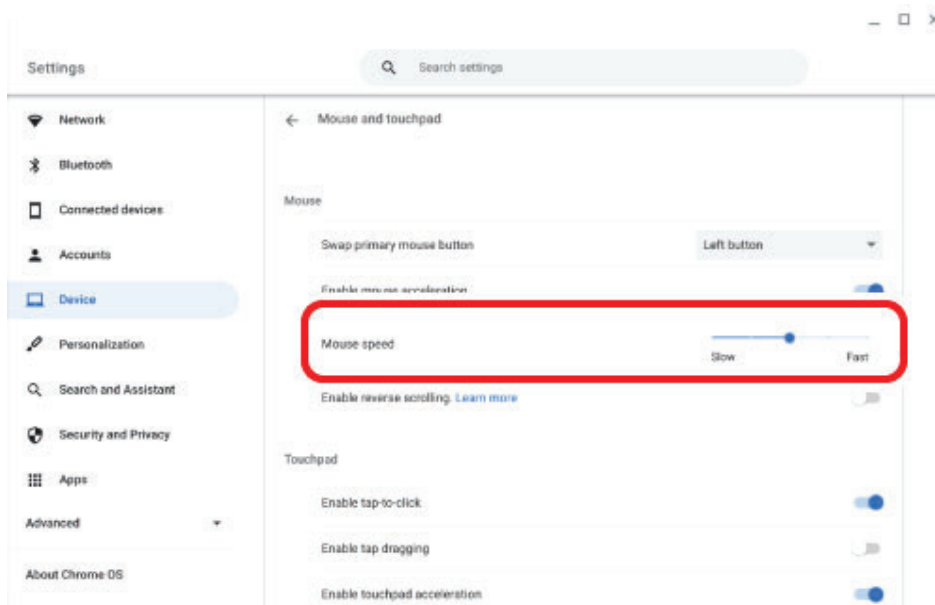

## Install ELECOM Mouse Assistant



To use the function assignment function, fast scroll function and presentation mode with this product, the ELECOM Mouse Assistant must be installed.

“ELECOM Mouse Assistant” is a software that allows you to use the mouse more effectively. Using ELECOM Mouse Assistant, users can set the functions they want to the unique buttons and use them to perform the operations they want.

### ■ Get ELECOM Mouse Assistant

Access ELECOM’s website as shown below and download the latest version of the application.

> The download page is [here](#)

# Specifications



Compatible models	Windows OS, macOS, Chrome OS, Android, iOS and iPadOS-based devices that support Bluetooth®HOGP.
Supported OS	Windows 11, Windows 10, Windows 8.1, Android 7 to 12, macOS Monterey 12, Chrome OS, iOS 15 and iPadOS 15 * Update for each new version of the OS or the installation of a service pack might be required. * Please see the table of supported devices for the latest information.
Conformity standards	Bluetooth 5.0Class2 / profile: HOGP (HID Over GATT Profile)
Resolution	2000 DPI
Communication method	GFSK
Radio frequency	2.4GHz
Radio wave range	Approx. 10 m on non-magnetic surfaces (wooden desks, etc.), approx. 3m on magnetic surfaces (steel desks, etc.)
Sensor Type	IR optical sensor
LED color	Blue
Buttons	5 * including wheel button
Wheel	1
Continuous operating time:	Approx. 363 hours
Continuous standby time:	Approx. 833 days
Projected battery lifespan	Approx. 675 days
Power supply (mouse)	Any 1 of AA alkaline dry-cell batteries, AA manganese dry-cell batteries or AA nickel-metal hydride batteries
Rated voltage (main unit)	1.5V

External dimensions (main unit)	M-XGM15BB(S) series: Approximately W 74 × D 110 × H 41 mm M-XGL15BB(S) series: Approximately W 82 × D 110 × H 42 mm
Size category	M-XGM15BB(S) series: M size, M-XGL15BB(S) series: L Size
Weight (main unit)	M-XGM15BB(S) series: Approximately 81 g *excluding batteries M-XGL15BB(S) series: Approximately 95 g *excluding batteries
Operating environment conditions	Temperature: +5°C to 40°C / 41°F to 104°F; humidity: up to 90% RH (without condensation)
Storage environment conditions	Temperature: -10°C to +60°C / 140°F to 104°F; humidity: up to 90% RH (without condensation)
Accessories	AA alkaline dry cell batteries for confirming operability x 1

## Troubleshooting



Try the following if the mouse operates abnormally or the connection is unstable.

**① Check that the mouse is turned ON.**

**② Check that the battery is inserted correctly or that the battery is not depleted.**

- The protective film may have been left on the battery. Remove the protective film from the battery before reinserting the battery.
- Ensure that the battery is inserted with the terminals in the right orientation.
- The mouse operation will become unstable when the battery is low. 1. Refer to “Insert battery” and replace with a new battery as soon as possible.

The battery included with this product is only for confirming operability. The battery will naturally discharge energy during the distribution process of the product.

\* Turning off the power when the mouse is not used for a long period of time can extend the battery life.

**③ Check the Bluetooth connection.**

- Check that the Bluetooth function or the Bluetooth adapter on your PC is turned on.
- Check pairing status to ensure that this product is paired correctly with your PC and that pairing has not been cancelled.

**④ Change the usage distance between the PC and the mouse.**

This wireless device uses the 2.4GHz band. Please use the mouse within range of the PC.



### **Average radio wave range**

Non-magnetic surface (e.g. wooden desk): approx. 10 m

Magnetic surface (e.g. steel desk): approx. 3 m

\* These values were obtained in ELECOM's test environment and are not guaranteed. The 2.4GHz band signal may be shorter depending on the environment you use it in.

### **⑤ Reboot the PC.**

\* The mouse may become unstable depending on the PC. Please restart the PC.

### **⑥ Please update your PC's OS to the latest version.**

\* The mouse may become unstable when the PC version is old. Please update your PC's OS to the latest version.

### **⑦ Update the Bluetooth driver. (When using Windows PC)**

\* The mouse may not work normally when the PC's Bluetooth driver is not the latest version. Check the manufacturer of the Bluetooth function installed on your PC and update the driver.

#### **1) Right click "Start" and open "Device Manager".**

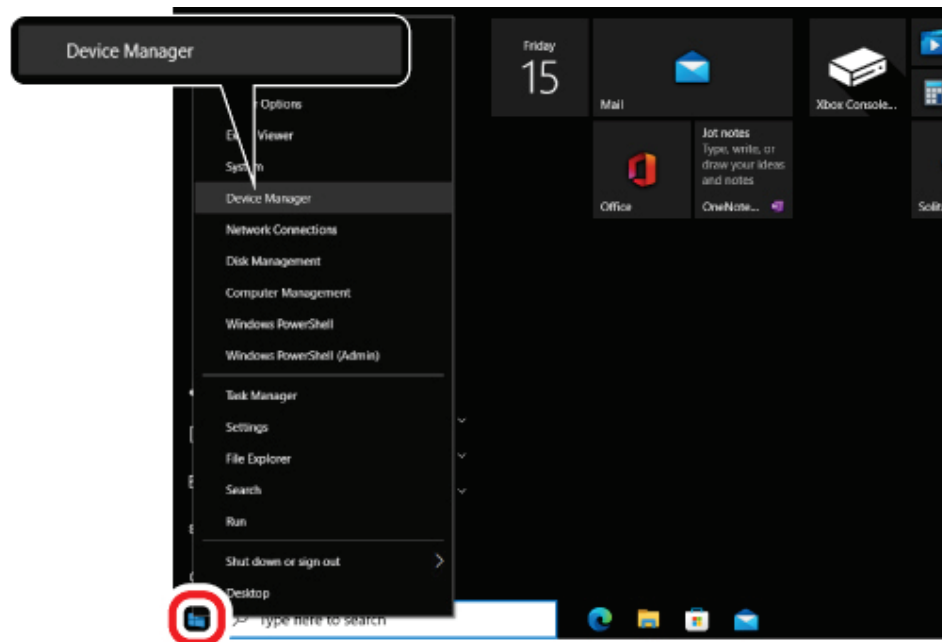

#### **2) Click "Bluetooth".**

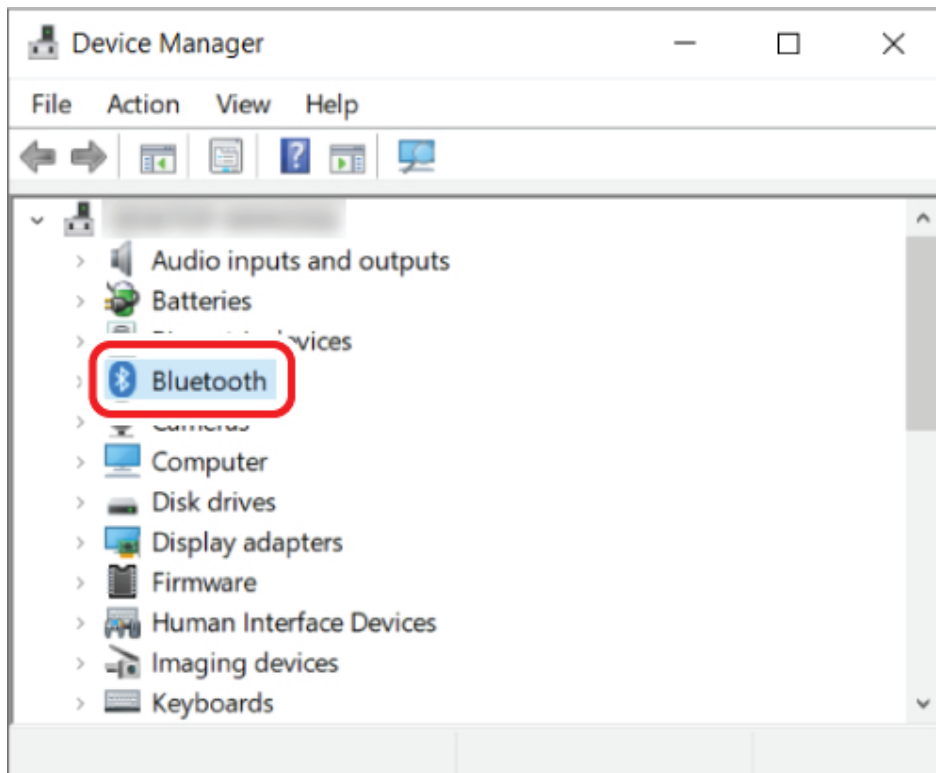

3) Check the manufacturer of the Bluetooth function installed on your PC.

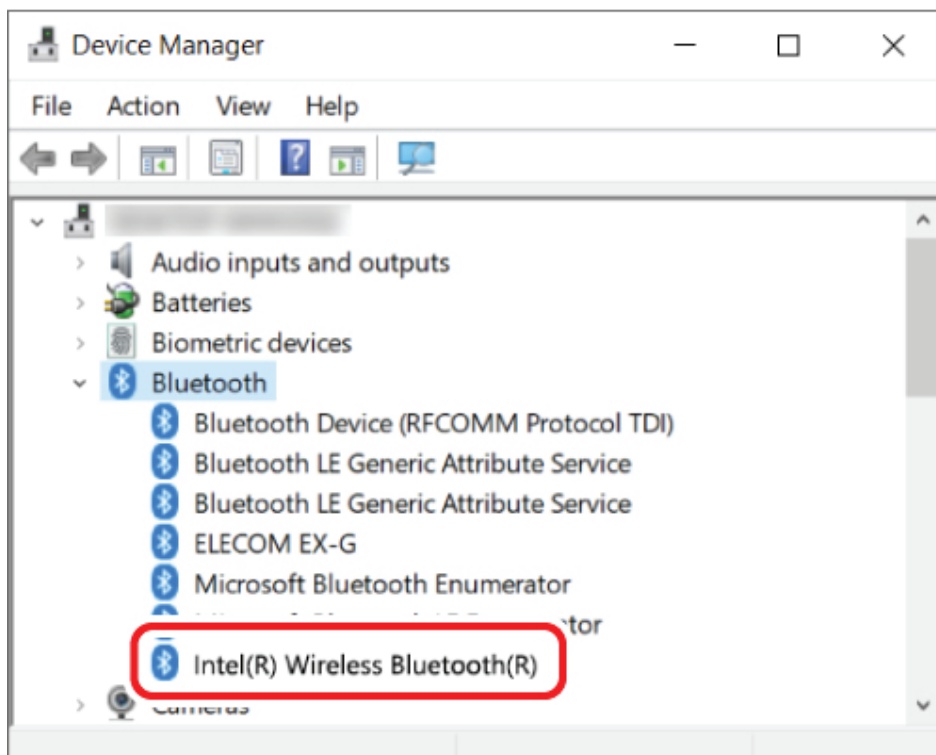

The following steps illustrate the procedure when the Bluetooth function is manufactured by Intel® Corporation.

For other manufacturers or if you do not know the manufacturer, check the user manual of your PC or contact the manufacturer of your PC for instructions on how to update the Bluetooth driver.

- 4) Search for “Intel® Driver & Support Assistant” on your browser and download the installer from Intel’s website.
- 5) Follow the instructions of the downloaded installer to install “Intel® Driver & Support Assistant”.
- 6) Click “Start” to open “Intel Driver & Support Assistant” after installation.

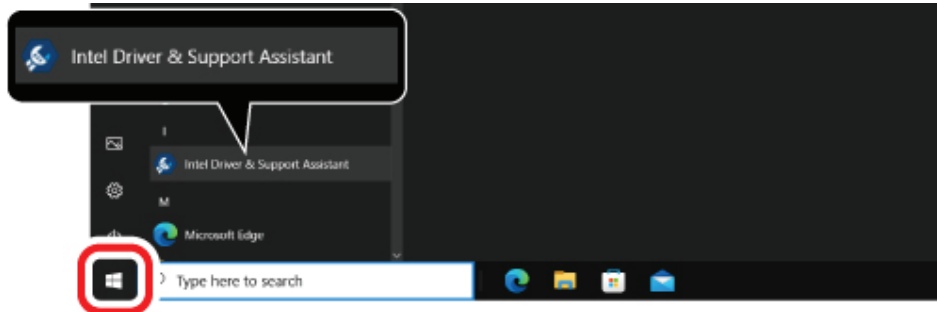

- 7) The Intel support page will automatically open on your browser and a list of drivers and software updates that can be used on your PC will be displayed.
- 8) Download “Intel® Wireless Bluetooth” from the list if available.

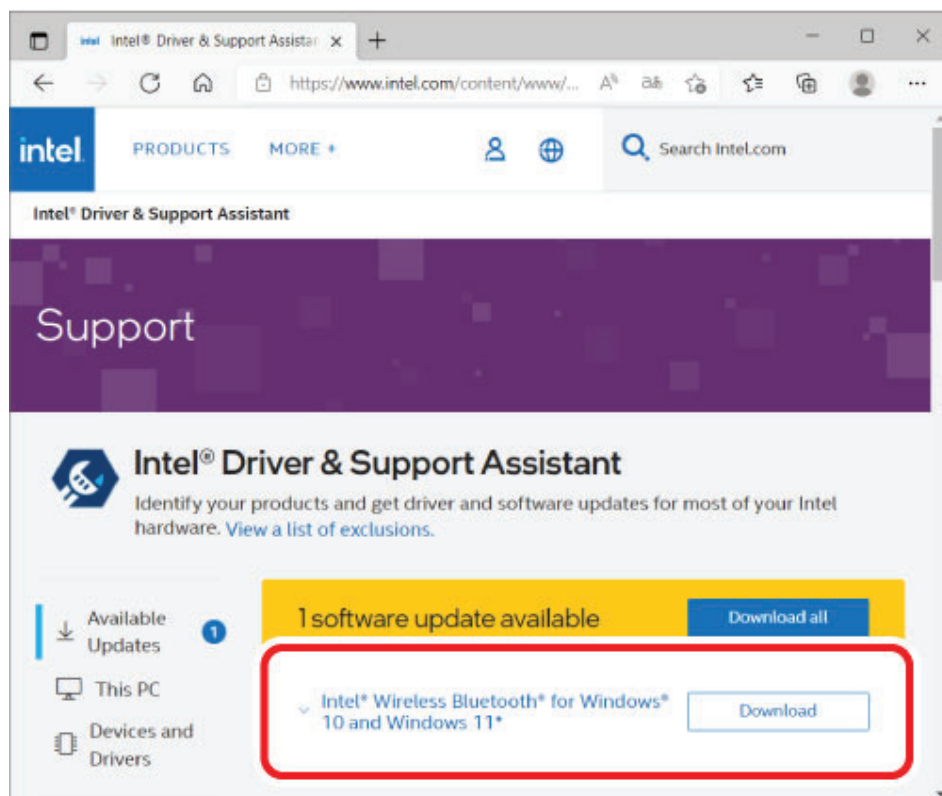

\* The displayed list on your browser may change depending on your PC environment and support page updates.

- 9) Follow the instructions of the downloaded installer to install the Bluetooth driver. With this, the Bluetooth driver is updated.

⑧ **When using a USB Bluetooth receiver, change the connection on the receiver.**

Depending on the specifications of the PC's USB port or USB hub, other USB 3.0 devices used simultaneously with the mouse may generate noise that can worsen the 2.4 GHz signal in the vicinity.



**Examples of USB devices that may degrade the 2.4 GHz band signal**

- \* USB memory
- \* Hard disk or SSD
- \* Optical disk drive
- \* Card reader / writer
- \* LAN adapter
- \* Others, all devices communicating data with a PC via USB 3.0.

You may be able to improve the situation with the following method.

- **Connect the Bluetooth receiver to another USB port away from other USB3.0 devices that are in use simultaneously.**



- **Connect the Bluetooth receiver to a USB2.0 hub or to an extension cable.**

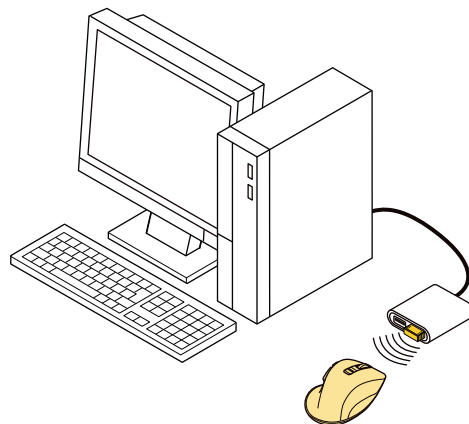



Model/모델명/设备型号/型号: M-XGL15BB

▼ China / 中国

CMIIT ID: XXXXXXXXXXX

RoHS Compliance (产品中有害有毒物质或元素的名称及含量)

▼ EU



CE Declaration of Conformity

RoHS Compliance

**Importer EU Contact** (For CE matters only)

Around the World Trading, Ltd.

5th floor, Koenigsallee 2b, Dusseldorf, Nordrhein-Westfalen, 40212, Germany



**WEEE Disposal and Recycling Information**

This symbol means that waste of electrical and electronic equipment (WEEE) should not be disposed as general household waste. WEEE should be treated separately to prevent possible harm to the environment or human health. Consult your retailer or local municipal office for collection, return, recycle or reuse of WEEE.

▼ Korea / 대한민국



인증번호: R-R-ELJ-M-XGL15BB

제작자 및 설치자는 해당 무선설비가 전파혼신 가능성이 있으므로 인명안전과 관련된 서비스는 할 수 없습니다.

## ▼ Singapore

Complies with  
IMDA standards  
DA106058.

## ▼ Taiwan / 台灣



BSMI RoHS statement (限用物質含有情況標示聲明書)



XXXXXXXXXXXXXXXXXX

取得審驗證明之低功率射頻器材，非經核准，公司、商號或使用者均不得擅自變更頻率、加大功率或變更原設計之特性及功能。低功率射頻器材之使用不得影響飛航安全及干擾合法通信；經發現有干擾現象時，應立即停用，並改善至無干擾時方得繼續使用。前述合法通信，指依電信管理法規定作業之無線電通信。低功率射頻器材須忍受合法通信或工業、科學及醫療用電波輻射性電機設備之干擾。

## ▼ UK



UK Declaration of Conformity

RoHS Compliance

**Importer UK Contact** (For UKCA matters only)

Around the World Trading, Ltd.

25 Clarendon Road Redhill, Surrey RH1 1QZ, United Kingdom



**FCC ID:** YWO-M-XGL15BB

This device complies with Part 15 of the FCC Rules. Operation is subject to the following two conditions: (1) this device may not cause harmful interference, and (2) this device must accept any interference received, including interference that may cause undesired operation.

NOTE; This equipment has been tested and found to comply with the limits for a Class B Digital Device, pursuant to part 15 of the FCC Rules. These limits are designed to provide reasonable protection against harmful interference in a residential installation. This equipment generates, uses and can radiated radio frequency energy and, if not installed and used in accordance with the instruction, may cause harmful interference to radio communication. However, there is no grantee that interference will not occur in a particular installation. If this equipment does cause harmful interference to radio or television reception, which can be determined by tuning the equipment off and on, the user is encouraged to try to correct the interference by one or more of the following measures:

- Reorient or relocate the receiving antenna
- Increase the separation between the equipment and receiver
- Connect the equipment into an outlet on a circuit different from that to which the receiver is connected
- Consult the dealer or an experienced radio/TV technician for help

NOTICE: The manufacture is not responsible for any radio or TV interference caused by unauthorized modification to this equipment. Such modifications could void the user's authority to operate the equipment.

In order to make improvements to this product, the design and specifications are subject to change without prior notice.

## **FCC Radiation Exposure Statement**

This equipment complies with FCC RF radiation exposure limits set forth for an uncontrolled environment. This equipment should be installed and operated with a minimum distance of 0.5 cm between the radiator and your body.

This transmitter must not be co-located or operating in conjunction with any other antenna or transmitter.

The antennas used for this transmitter must be installed to provide a separation distance of at least 0.5 cm from all persons and must not be co-located or operating in conjunction with any other antenna or transmitter.

### **Responsible party** (For FCC matters only)

Around The World Trading Inc.,  
7636 Miramar Rd #1300, San Diego, CA 92126  
elecomus.com

## **▼ Vietnam / Việt Nam**

RoHS compliant list (Chứng Nhận Đạt Tiêu Chuẩn RoHS)

## Intellectual property rights



- ELECOM CO., LTD. owns the copyright to this manual.
- Duplicating and transferring this document in part or whole is prohibited.
- When exporting this product, check the export regulations for the country of origin.
- Windows is a trademark belonging to Microsoft Corporation in the USA and other countries.
- macOS, iPhone and iPad are trademarks of Apple Inc., registered in the U.S. and other countries and regions.
- Chrome OS and Android are trademarks of Google LLC.
- The Bluetooth® word mark and logos are registered trademarks owned by Bluetooth SIG, Inc. and any use of such marks by ELECOM CO., LTD. is under license.
- All products and company names on this product and the package are trademarks or registered trademarks of their respective owners.

## Support information



### **ELECOM CO., LTD.**

[www.elecom.co.jp/global/](http://www.elecom.co.jp/global/)

Please contact the shop where you purchased this product if you have any feedback or questions about the contents of this manual.

Specifications and external appearance of this product may be changed without prior notice for the purpose of product improvement.

ELECOM is not responsible for any damages to, or failure of other devices caused by using this product.

A customer who purchases outside Japan should contact the local retailer in the country of purchase for enquiries. In “ELECOM CO., LTD. (Japan)”, no customer support is available for enquiries about purchases or usage in/from any countries other than Japan. Also, no language other than Japanese is available. Replacements will be made under stipulation of the Elecom warranty, but are not available from outside of Japan.

▼ **ELECOM (SEOUL) CO., LTD.**

Dome-Bldg 5F, 60, Nambusunhwan-ro 347-gil, Seocho-gu, Seoul, 06730, South Korea

TEL : +82 (0) 2 - 1588 - 9514

FAX : +82 (0) 2 - 3472 - 5533

[www.elecom.co.kr](http://www.elecom.co.kr)

▼ **ELECOM (SHANGHAI) TRADING Co.,Ltd**

Room 208-A21, 2nd floor, 1602 Zhongshanxi Road, Xuhui District, Shanghai, China, 200235

TEL : +86 021-33680011

FAX : +86 755 83698064

▼ **ELECOM Sales Hong Kong Ltd.**

2/F, Block A, 2-8 Watson Road, Causeway Bay, Hong Kong

TEL : +852 2806 - 3600

FAX : +852 2806 - 3300

email : [info@elecom.asia](mailto:info@elecom.asia)

▼ **ELECOM Singapore Pte. Ltd**

Blk 10, Kaki Bukit Avenue 1, #02-04 Kaki Bukit Industrial Estate, Singapore 417942

TEL : +65 6347 - 7747

FAX : +65 6753 - 1791