



MiFi LTE

Quick start guide

Ver1.0



Manual Version

Date	Contents	Remarks
2012.01.19		

Manual Cover Page

Cautions for Safety

This is for how to use the product safely and normally in order to protect the user and user's properties. Please read user guide carefully and put it near to you.

Warning Misusage of the product may harm you severely

Please keep it to room temperature all the time

It may cause defect or explosion of battery when you put the device and its battery to high temperature or humid place, in the car under direct sun light for a long time. Also, there might be a problem to use the product when it is kept in very cold place for a long time.

Please do not use power adapter when your hand is wet and do not place it into water or humid place

When the device or battery is sodden by water, please do not use it and visit service center. Please note that if you are using it when it is still wet, it may damage to its circuit parts and it may cause electric shock and defect of the product

When it is sodden by water, please remove the battery and do not turn it on

When AMR510 is wet, please do not dry it by heating appliance

If you dry wet AMR510 or its battery by stove/microwave oven/dryer/etc, it may cause a strain of the product, defect and explosion. When AMR510 and its batter is sodden, wet indications label color is changed and user is responsible the defect which is caused by his/her misusage

Warning Misusage of the product may harm you severely

Please do not use it where electromagnetic devices are not allowed or exposure of explosion area

Please do not use it in a place like hospital or plane, it may cause radio interference to surrounding equipments there. Please turn it off when you are in the area of using high frequency for explosion, it may be exploded.

When there is storm, lighting severely, please do not use it and disconnect its power cables

Using the device under this condition may exposure yourself to lighting and it cause severe damage to your body

When the defect is caused by natural disasters, free warranty service is not provided

Please do not bend power adapter port and cables too much

Please do not use damaged power adapter and cables

When you remove power adapter from outlet, please hold its head all the time to prevent defect

Warning Misusage of the product may harm you severely

Please use its original battery and accessories all the time and do not try to change its SW

If you use non-genuine battery and accessories, it may shorten the product life and explode. If you try illegal SW, it may cause defect. Defect caused by your misusage is not covered by warranty service

Strong impact on the product and battery may cause defect

It may cause defect and explosion when it is receiving strong impact

Please do not place metal object to battery connecting ports and do not prod the battery by sharp objects

Please keep it out of Children and animals

If children put the product or battery into his/her mouth, it may harm his/her body or it cause electric shock or exposure of explosion and electromagnetic waves. Also, if children swallow it, suffocation may happen

Caution Misusage of the product may harm you or cause defect

When battery is not used for a long time, it is recommended to charge it full and keep it in room temperature

It is recommended to charge it fully when you are not using it long time before doing so. In case, when the battery shape is stained, please remove the battery. Battery using time may be getting shortened.

Please keep it away from magnetism

If the product is near to magnetic object, it may cause malfunction and drain out battery power. If you pair "credit card, phone card, bankbook, etc" with the product, its magnetic power may damage those items.

Please keep it away from heating appliances and dirty places

Heat may become a reason of strain or explosion of the product. Please keep battery connecting port clean all the time and if there is dirt, please clean it by dry fabric. It is not recommended to clean it by wet fabric or chemical or alcohol

Caution Misusage of the product may harm you or cause defect

Other electric appliances may interfere each other

Electric appliance's electromagnetic may interfere each other, it may cause malfunction

Please do not modify or disassemble or repair it by yourself

It may cause defect, damage, electric shock, fire. Under this condition, user can't get warranty service. Please visit service center for repair

Please follow below guide when you clean the device

When you clean the device or adapter, please turn it off and remove it from power outlet first. Please use dry and soft fabric to clean the device and power adapter. When you clean connecting port of product, battery or power adapter, please use cotton swap or soft fabric. It is not recommended to use chemical cleaner or strong detergent or tough polishing object.

What it is

**This product is making mobile WiFi hotspot by receiving and through LTE and WCDMA networks
All WiFi enabled devices such as PC, game devices, tablet PC can be connected for packet communications**

- ✓ All manual contents and images are drafted for user guide
- ✓ Product specifications and manual contents may be changed or updated without prior notice
- ✓ When there is too many WiFi access devices near, normal packet communication may be interfered

Basic Package



< AMR510 >



< Power Adapter >



< USB Cable >

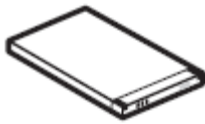

< Battery >



< Quick Start Guide >

✓ Actual product may look different from above images or changed

Name of each parts

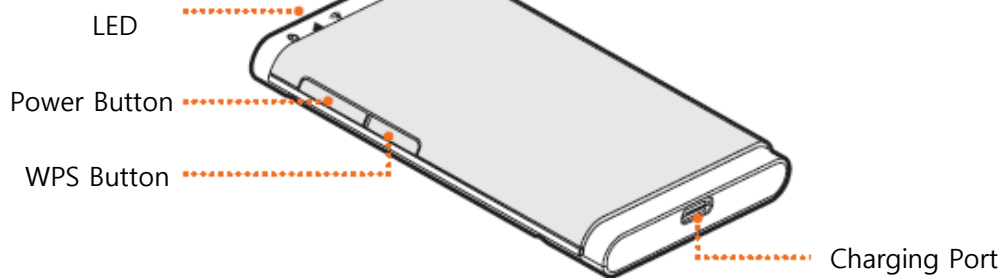

How to remove and assemble battery

How to remove battery cover

Please use your finger tip to lift up the battery cover. You can use batter cover lift hole at bottom side

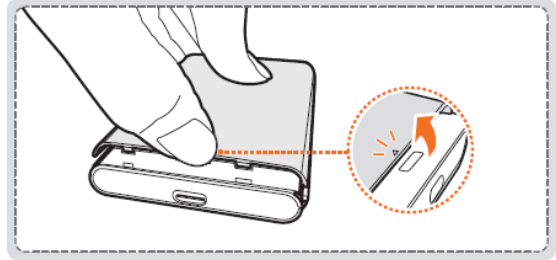

How to remove battery

Please remove battery as shown on the photo

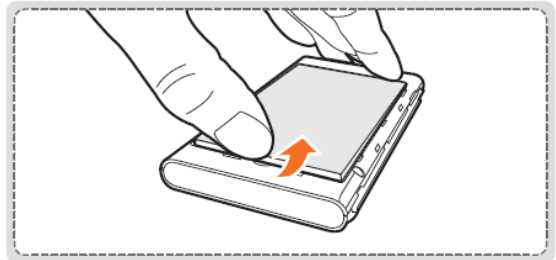

How to assemble battery back in

Please put battery connecting port first to the device side correctly and push down

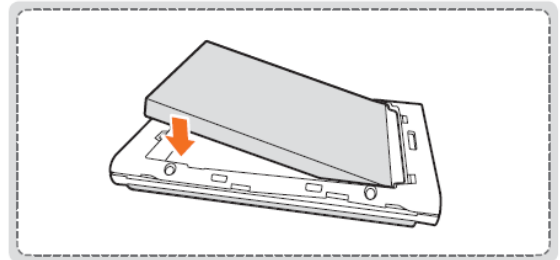

How to assemble battery cover

Please place 2 lugs in rear side into the holes in the device side first and press it down complete as shown on the photo

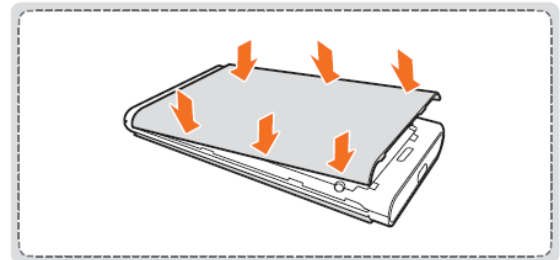

How to insert USIM Card

Open battery cover and battery

Please open battery cover and battery first

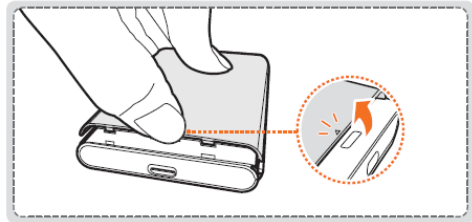

Insert USIM card

Insert USIM card to its slot. Please insert USIM by IC chip side to bottom

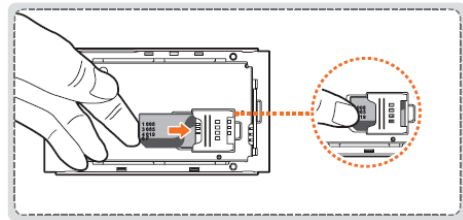

How to remove USIM card

Please use your finger tip to push it out from its socket

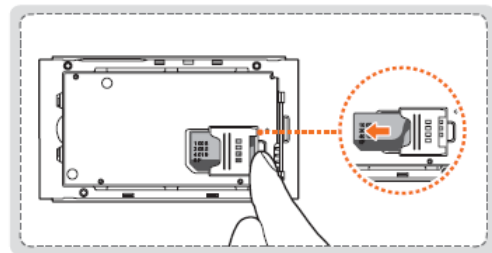

- ✓ In order to use the device, user is required to subscribe first to operator. Please ask operator for services
- ✓ For wireless service activation and recognition, USIM stores personal data of user. Please keep it safe not to be stolen or rent to 3rd party. Manufacturer is not responsible of user's miscarriage
- ✓ Stored data in USIM card may be damaged if it is scratched or bent

How to recharge the Battery

Recharging can be done through the connection to PC by USB cable or power adaptor

by USB cable to PC

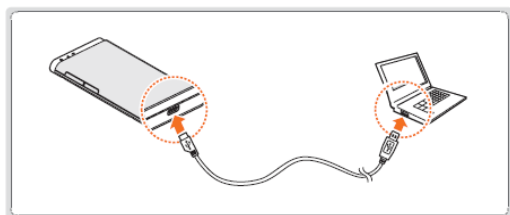

by AC adaptor

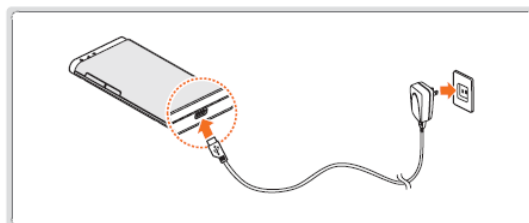

- When USB cable is connected correctly, 3 LED are blinking for 2 seconds in white color
- When power LED  is blinking in yellow color, please plug out and in again

Battery charging and using time

Battery (2,100mAh)

<Based on New Battery>

Recharging time	By USB cable	5hrs
	By AC adaptor	4hrs
Using time	Standby time on WCDMA	150hrs
	Running time on WCDMA	6hrs 30mins
	Standby time on LTE	150hrs
	Running time on LTE	5hrs

- ✓ Battery is not fully charged when it is purchased. Please use it after full recharge
- ✓ Battery charging time is different according to its charged battery level
- ✓ Battery using time is getting shorter
- ✓ Even user is not using battery, batter power level still reduce. Also, when user is using the device in weak signal area, battery consumption is going high under this weak signal condition
- ✓ Battery running/using time is calculated on power save mode setting

Power on / off

Power on

- Please press power button
- When power is on, 3 LED are blinking in a turn of "Red-Blue-White"

Power off

- Please press long the power button

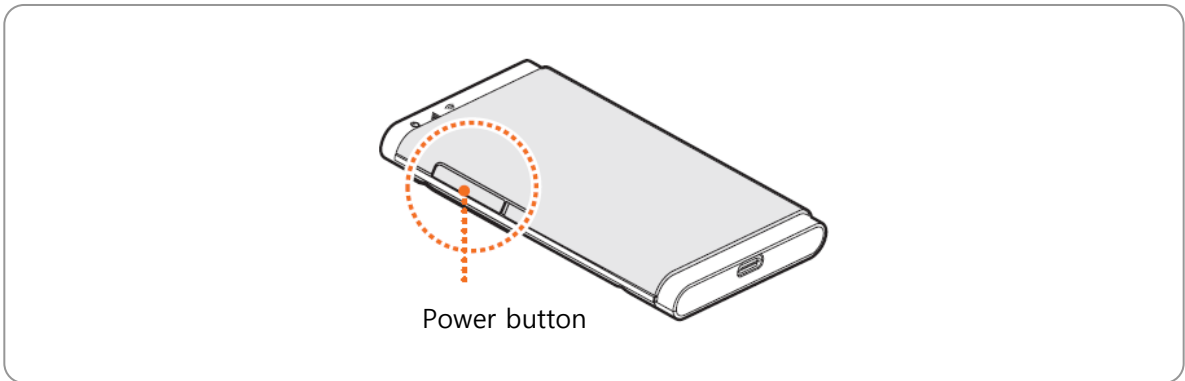

LED Indications

LED	LED Color	
Power	Standby Mode	<ul style="list-style-type: none"> ▪ Green: Battery power level remains 51% ~ 100% ▪ Yellow: Battery power level remains 16% ~ 40% ▪ Red: Battery power level remains 6% ~ 15% ▪ Blinking in Red: Battery power level is below 5%
	Charging in Progress	<ul style="list-style-type: none"> ▪ Green: Charging complete ▪ Blinking in Green: Charging level is between 51% ~ 99% ▪ Blinking in Yellow: Charging level is between 16% ~ 50% ▪ Blinking in Red: Charging level is below 15% ▪ Blinking in Yellow: Charging Error
Signal Strength	<ul style="list-style-type: none"> ▪ Green: 4G network ▪ Blue: 3G network ▪ Blinking in Purple: WPS mode ▪ Red: Can't get signal or Service connection fail 	
Wi-Fi	<ul style="list-style-type: none"> ▪ Green LED is on: 4G connected, Wi-Fi on ▪ Green LED Blinks: 4G connected, Wi-Fi on, Packet in transmission ▪ Blue LED is on : 3G connected, Wi-Fi on ▪ Blue LED Blinks : 3G connected, Wi-Fi on, Packet in transmission ▪ Red LED is on : Wi-Fi on, Wi-Fi isn't connected ▪ Yellow LED Blinks : Wi-Fi is turning on ▪ No LED : Wi-Fi off(when Wi-Fi auto off mode is set) 	
Power/Signal Strength/Wi-Fi	<ul style="list-style-type: none"> ▪ Red LED Blinks : Device is not in normal stage(ex: No USIM, Pin lock, Registration fail, etc) ▪ Green LED Blinks : Factory Reset is in progress 	

How to connect WiFi enabled devices

You can connect PC, Game devices or tablet PC

- Please connect SSID of MiFi LTE from your Wireless LAN enabled device
- Please enter SSID of MiFi LTE
- Enter now for pairing



- ✓ Wireless network setting may be different on each devices and its OS
- ✓ When MiFi LTE is purchased, its network name(SSID) is "AM_LTE_Serial#" and Network Key is "Aserial#" of your product
Ex) When product serial number is '123456',
SSID is 'AM_LTE_A123456'

How to use Web CM(connection manager)

You can check your current program setting by Web CM and you can also change your program setting on Web CM

You can get into Web CM in internet through connected device like PC

How to connect Web CM

- Connect PC to MiFi LTE
- Open internet
- Getting into the web address of 'http://192.168.2.1'
- Put ID & PW on Web CM login in window

- ✓ Default ID & PW of Web CM is "admin"



Web CM Home

You can set advanced setting of Router

- Basic Information
- APN Setting
- Router Setting
- Wi-Fi Setting
- Firewall Setting
- Device Information

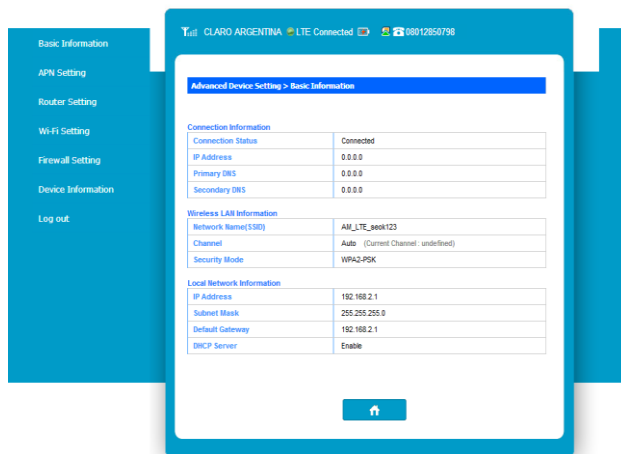

Copyright © 2013 Nyx mobile Co., Ltd.

How to change SSID

- Home > Wi-Fi Setting > Select default setting
- Type new SSID and apply

How to change Encryption setting

- Home > Wi-Fi Setting > Select Encryption setting
- Set as desired encryption setting
- Type WEP Key or Password and apply

✓ Please set SSID and network key when you use it first for security issue

Wi-Fi auto off Setting

When the devices are connected through WiFi for pre-set time, MiFi LTE will turn off WiFi and devices are disconnected. Please press WPS button for 3 seconds to turn on WiFi again

- HOME > Wi-Fi Setting > Select default setting
- Set to Wi-Fi auto off enable
- Set Wi-Fi auto off time and apply

Wi-Fi power save mode Setting

Once WiFi power save mode is on, WiFi output is getting reduce than normal mode. Please locate your WiFi enabled device near to MiFi LTE.

- HOME > Wi-Fi Setting > Select default setting
- Set to Wi-Fi power save mode enable and apply

Specifications and Features

MTiFi LTE

Frequency Range	WCDMA(HSDPA,HSUPA) <ul style="list-style-type: none"> ▪ TX: 824 ~ 849MHz, 1850 ~ 1910MHz ▪ RX: 869 ~ 894MHz,1930 ~ 1990MHz LTE <ul style="list-style-type: none"> ▪ TX: 1710MHz ~ 1755MHz ▪ RX: 2110MHz ~ 2155MHz
Frequency Accuracy	WCDMA: within ± 0.1 PPM LTE: within ± 0.1 PPM + 15Hz
Transmit Power	WCDMA: 0.25W LTE: 0.16W
Data Speed	WCDMA RX: 384Kbps/ TX: 384Kbps HSDPA RX: 7.2Mbps/ HSUPA TX: 5.76Mbps LTE RX: 100Mbps/ LTE TX 50Mbps
Size	99mm x 55.3mm x 11.2mm
Weight	97g (Including Battery)
Temperature/Humid	Temp: -10°C ~ +55°C
	Humid: 5% ~ 95%
Max Device Connection Q'ty	10

WiFi

Frequency Range	2400MHz ~ 2483.5MHz
Transmit Power	≤ 20 dBm under
WiFi Spec	IEEE802.11 b/g/n
Security	WEP/ WPA-PSK/ WPA2-PSK/ WPA/WPA2-PSK mixed

Battery and Adapter

Battery	Li-Polymer 2100mAh(3.7V)
Charging Adapter	Input : 100~240V, 0.15A Output : 5V, 1A
Charging Cable	Micro-USB-B(USB2.0)

Warranty

Warranty service shall be provided free of charge when defect is caused by product itself

- ▶ Warranty Period
Device and Adapter : 1 year
Battery : 6 months

Serial Number	
Customer Name	
Address	
Phone	
Shop Name	
Purchasing Day	

* Please complete this form when you purchase the product and keep it together with warranty policy paper in order to be served well on warranty service

Warranty Policy

FCC Caution

Any Changes or modifications not expressly approved by the party responsible for compliance could void the user's authority to operate the equipment.

This device complies with part 15 of the FCC Rules. Operation is subject to the following two conditions: (1) This device may not cause harmful interference, and (2) this device must accept any interference received, including interference that may cause undesired operation.

Note: This equipment has been tested and found to comply with the limits for a Class B digital device, pursuant to part 15 of the FCC Rules. These limits are designed to provide reasonable protection against harmful interference in a residential installation. This equipment generates uses and can radiate radio frequency energy and, if not installed and used in accordance with the instructions, may cause harmful interference to radio communications. However, there is no guarantee that interference will not occur in a particular installation. If this equipment does cause harmful interference to radio or television reception, which can be determined by turning the equipment off and on, the user is encouraged to try to correct the interference by one or more of the following measures:

- Reorient or relocate the receiving antenna.
- Increase the separation between the equipment and receiver.
- Connect the equipment into an outlet on a circuit different from that to which the receiver is connected.
- Consult the dealer or an experienced radio/TV technician for help.

SAR tests are conducted using standard operating positions accepted by the FCC with the phone transmitting at its highest certified power level in all tested frequency bands, although the SAR is determined at the highest certified power level, the actual SAR level of the phone while operating can be well below the maximum value, in general, the closer you are to a wireless base station antenna, the lower the power output.

Before a new model phone is available for sale to the public, it must be tested and certified to the FCC that it does not exceed the exposure limit established by the FCC, Tests for each phone are performed in positions and locations (e.g. at the ear and worn on the body) as required by the FCC.

For body worn operation, this model phone has been tested and meets the FCC RF exposure guidelines when used with an accessory designated for this product or when used with an accessory that

Contains no metal and that positions the handset a minimum of 1.5 cm from the body.

Non-compliance with the above restrictions may result in violation of RF exposure guidelines.