

User Manual

ilo Speaker
Wireless Speaker
Model : XP81025

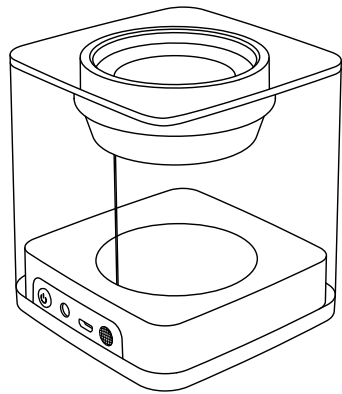

Compatible with all smart devices!

Specification and appearance subject to change without notice.
All trademarks and registered trademarks are the property of their
respective owners © 2018 Xoopar Ltd.



- Wireless Speaker with stereo sound (10W), up to 6 hrs of play time. Visible speaker through high gloss acrylic body. Trigger party mode button and enjoy changing LED lights.
- Akku-Lautsprecher mit Stereoklang (10 W), bis zu 6 Stunden Laufzeit. Lautsprecher durch Hochglanz-Acrylgehäuse sichtbar. Die Taste Party-Modus sorgt für wechselndes LED-Licht.
- Draadloze luidspreker met stereo geluid (10W), tot wel 6 uur speelduur. Zichtbare luidspreker dankzij hoogglans acryle behuizing. Druk op de feestmodus-knop en geniet van de wisselende led-lampjes.
- Haut-parleur sans fil avec son stéréo (10 W), jusqu'à 6 heures de lecture. Haut-parleur visible à travers un boîtier en acrylique brillant. Activez le mode fête et profitez du changement des lumières LED.
- Altavoz inalámbrico con sonido estéreo (10W), hasta 6 horas de tiempo de reproducción. Altavoz visible gracias a su cuerpo acrílico de alto brillo. Active el botón de modo de fiesta y disfrute de las luces LED cambiantes.
- Altifalante sem fios com som estéreo (10W), até 6 horas de reprodução. Altifalante visível através de estrutura de acrílico brilhante. Botão de modo de festa para desfrutar de luzes LED que alternam.
- Altoparlante wireless con suono stereo (10 W), fino a 6 ore di autonomia in riproduzione. Altoparlante visibile attraverso il corpo acrilico di elevata lucentezza. Premi il pulsante modalità party per attivare l'illuminazione LED multicolore

Specifications:

Wireless transmission distance: Up to 10m
Speaker music play time: up to 6 hours
Battery Capacity: 1200 mAh
Battery Type: Rechargeable Li-Ion
Support iPhone, iPad, most smartphones & tablets
Patented Product

Caution:

Each tablet and smartphone may apply different default volume-level setting. This is not a defect. After connecting wirelessly simply use physical volume setting to adjust volume level.

① Configuration

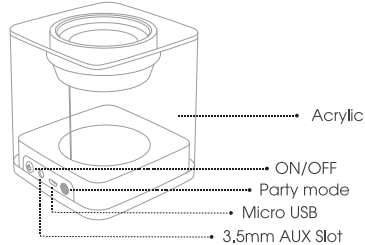

③ Connection

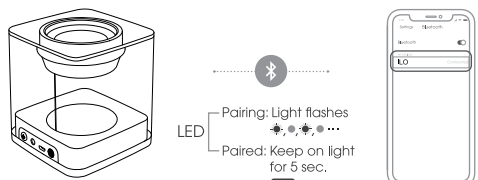

To reset the speaker's Bluetooth setting press 10 seconds to power button.

⑤ Party Mode ON/OFF

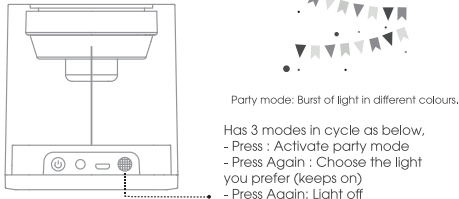

② Power ON/OFF

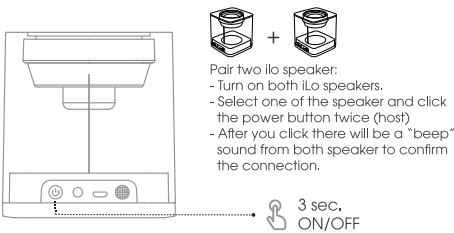

④ Play music

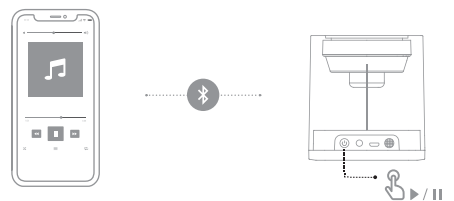

⑥ Charging

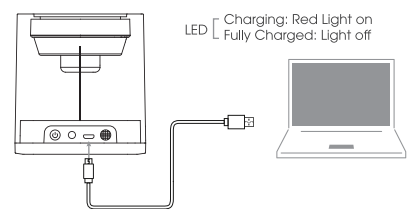

FCC Warning :

Any Changes or modifications not expressly approved by the party responsible for compliance could void the user's authority to operate the equipment.

This device complies with part 15 of the FCC Rules. Operation is subject to the following two conditions: (1) This device may not cause harmful interference, and (2) this device must accept any interference received, including interference that may cause undesired operation.

This equipment complies with FCC radiation exposure limits set forth for an uncontrolled environment .

Note: This equipment has been tested and found to comply with the limits for a Class B digital device, pursuant to part 15 of the FCC Rules. These limits are designed to provide reasonable protection against harmful interference in a residential installation. This equipment generates, uses and can radiate radio frequency energy and, if not installed and used in accordance with the instructions, may cause harmful interference to radio communications. However, there is no guarantee that interference will not occur in a particular installation. If this equipment does cause harmful interference to radio or television reception, which can be determined by turning the equipment off and on, the user is encouraged to try to correct the interference by one or more of the following measures:

- Reorient or relocate the receiving antenna.
- Increase the separation between the equipment and receiver.
- Connect the equipment into an outlet on a circuit different from that to which the receiver is connected.
- Consult the dealer or an experienced radio/TV technician for help.