

2.4G Wireless Mouse User Manual

Button

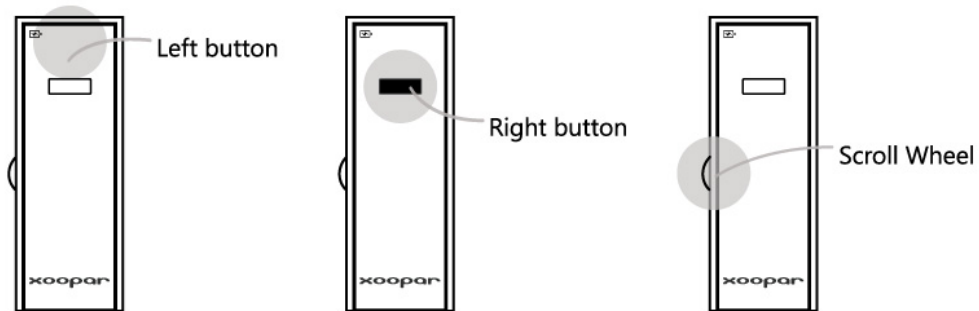

Nano Receiver

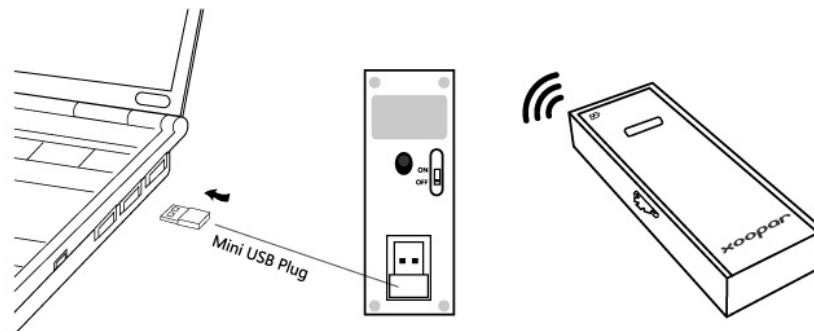

USB Cable & Icon Indication (Mouse can be used during charging mode)

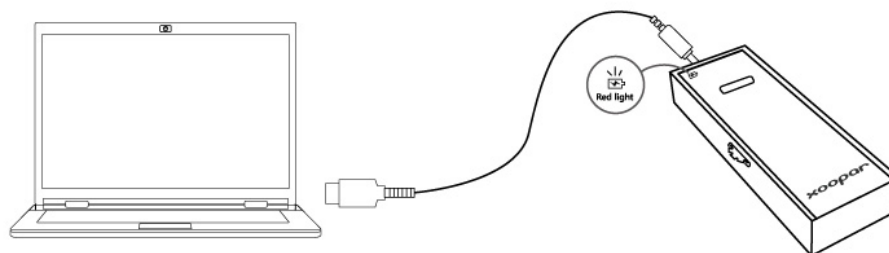

Packaging Icon

Super Mini, (=Left button, =Right button, Scroll Wheel)

2.4GHz wireless (interference-free)

Nano Receiver (plug and stay)

1000dpi,

Built-In Rechargeable Battery

3-min auto sleep

Drawing on Instruction Manual

right button, left button, scroll wheel

Nano Receiver

USB Charging Cable & Icon Indication (Mouse can be used during charging mode)

Description on Packaging Backcard / Instruction Manual

Super Mini Size

2.4GHz wireless(up to 10M working distance)
Nano Receiver (plug and stay)
1000dpi,
Built-In Rechargeable Battery (100 mA, battery life up to one month)
3-min auto sleep
Plug and Play, Win & Mac

Accessories included: Velvet Pouch, USB Charging Cable

FCC STATEMENT

1. This device complies with Part 15 of the FCC Rules.
Operation is subject to the following two conditions:
 - (1) This device may not cause harmful interference, and
 - (2) This device must accept any interference received, including interference that may cause undesired operation.
2. Changes or modifications not expressly approved by the party responsible for compliance could void the user's authority to operate the equipment.

FCC ID: YOA-XP51001

This device complies with Part 15 of the FCC Rules. Operation is subject to the following two conditions: (1) This device may not cause harmful interference, and (2) This device must accept any interference received, including interference that may cause undesired operation.

NOTE: This equipment has been tested and found to comply with the limits for a Class B digital device, pursuant to Part 15 of the FCC Rules. These limits are designed to provide reasonable protection against harmful interference in a residential installation. This equipment generates, uses and can radiate radio frequency energy and, if not installed and used in accordance with the instructions, may cause harmful interference to radio communications. However, there is no guarantee that interference will not occur in a particular installation. If this equipment does cause harmful interference to radio or television reception, which can be determined by turning the equipment off and on, the user is encouraged to try to correct the interference by one or more of the following measures:

- Reorient or relocate the receiving antenna.
- Increase the separation between the equipment and receiver.
- Connect the equipment into an outlet on a circuit different from that to which the receiver is connected.
- Consult the dealer or an experienced radio/TV technician for help.