

TROUBLESHOOTING

PROBLEM	SOLUTION
Vehicle will not START	<ol style="list-style-type: none"> 1. Power switch is off. Make sure to turn it on. 2. Batteries are installed with incorrect polarities. Check the + and - markings to make sure the batteries are properly aligned. 3. Batteries are drained. Charge batteries and/or install new batteries.
Vehicle does not respond to controls.	<ol style="list-style-type: none"> 1. Transmitter controller battery is drained. Replace the controller battery. 2. The vehicle is likely out of range. Bring controller closer to the vehicle. If problem persists, remove the controller batteries and replace with new batteries, then restart (ON/OFF) the vehicle. 3. Interference from surrounding electrical machinery. Bring to a wide open space.
Vehicle does not drive straight.	<ol style="list-style-type: none"> 1. Adjust the steering dial underneath the front axle, left or right, until the wheels point straight forward.
Vehicle does not move	<ol style="list-style-type: none"> 1. Stop operation, switch off the power and rest your vehicle a few minutes. 2. Check the position of the batteries in the vehicle, they may have been knocked loose during play.
Vehicle does not respond properly	The vehicle is likely out of range. Bring controller closer to the vehicle. If problem persists, remove the controller batteries and replace with new batteries and restart (ON/OFF) the vehicle.
Transmitter controller does not work	If the controller light is off, its battery is drained. Replace the controller batteries.

BATTERY WARNINGS:

1. Batteries are to be replaced by an adult.
2. Non-rechargeable batteries are not to be recharged.
3. Rechargeable batteries are to be removed from the toy before being charged.
4. Rechargeable batteries are only to be charged under adult supervision.
5. For best performance, only the recommended batteries or their equivalent are to be used.
6. Batteries must be inserted with correct polarity.
7. Do not mix new and used batteries.
8. Do not mix different types of batteries.
9. Exhausted batteries are to be removed from the toy.
10. The supply terminals are not to be short-circuited.

FCC ID for Vehicle: YNIJAZWARES733
FCC ID for Controller: YNIJAZWARES73A

This device complies with Part 15 of the FCC Rules. Operation is subject to the following two conditions: (1) This device may not cause harmful interference, and (2) this device must accept any interference received, including interference that may cause undesired operation.

WARNING! Changes or modifications not expressly approved by the party responsible for compliance could void the user's authority to operate the equipment.

NOTE: This equipment has been tested and found to comply with the limits for a Class B digital device, pursuant to Part 15 of the FCC rules. These limits are designed to provide reasonable protection against harmful interference in a residential installation. This equipment generates, uses, and can radiate radio frequency energy and, if not installed and used in accordance with the instructions, may cause harmful interference to radio communications. However, there is no guarantee that interference will not occur in a particular installation. If this equipment does cause harmful interference to radio or television reception, which can be determined by turning the equipment off and on, the user is encouraged to try to correct the interference by one or more of the following measures:

- Reorient or relocate the receiving antenna.
- Increase the separation between the equipment and receiver.
- Connect the equipment into an outlet on a circuit different from that to which the receive is connected.
- Consult the dealer or an experienced radio/TV technician for help.

PROBLEMS?
DO NOT RETURN TO STORE
Please Call Us: 1.800.370.1827
(U.S. Customers Only)

IMPORTANT:
Please save this instruction sheet.
It contains valuable product information.

WARNING: This toy produces flashes that may trigger epilepsy in sensitised individuals.

WARNING! All of the packaging, such as tape, plastic sheets, wire ties, stickers and tags, are not part of this product. Please discard for your child's safety. Retain package for future reference as it contains important information. Conforms to toy safety standards CPSIA, ASTM-F963 and EN71. Product appearance and colors may vary from shown.

HOW TO CLEAN MUDFLAP
- TO CLEAN, WIPE WITH A CLOTH.
- DO NOT SUBMERGE IN WATER.
- DO NOT USE CHEMICAL OR ABRASIVE CLEANERS.



Protect the environment by not disposing of this product with household waste (2012/19/EU). Check your local authority for recycling advice and facilities.



Made in China
Used with permission. Manufactured and Distributed by:
Jazwares, LLC, Sunrise, FL 33326, USA
Jazwares, 16A Crane Grove, London, N7 8LE, United Kingdom
Jazwares GmbH, Mina-Rees-Str. 8, 64295 Darmstadt, Germany
www.jazwares.com / www.jazwares.de

© 2021 Epic Games, Inc. Fortnite and its logo are trademarks of Epic Games, Inc. in the USA (Reg. U.S. Pat. & Tm. Off.) and elsewhere.

FORTNITE

MUDFLAP INSTRUCTION MANUAL

8+

CONTENTS:

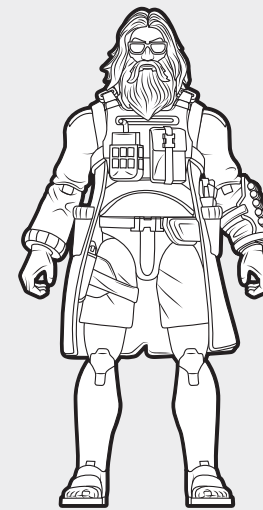

RELAXED FIT
JONESY

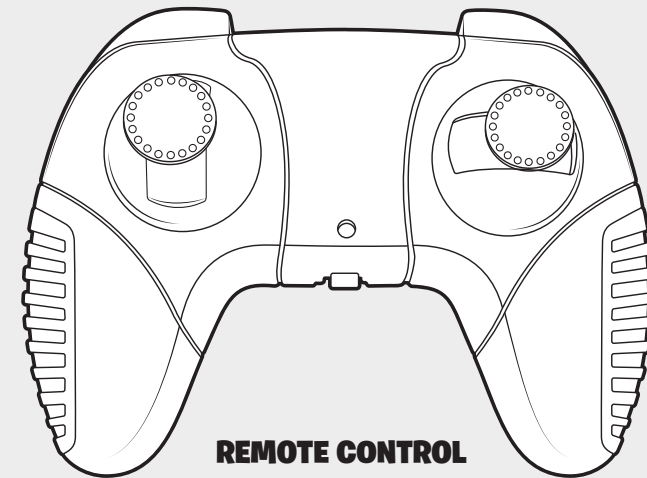

REMOTE CONTROL



REUSABLE DECALS

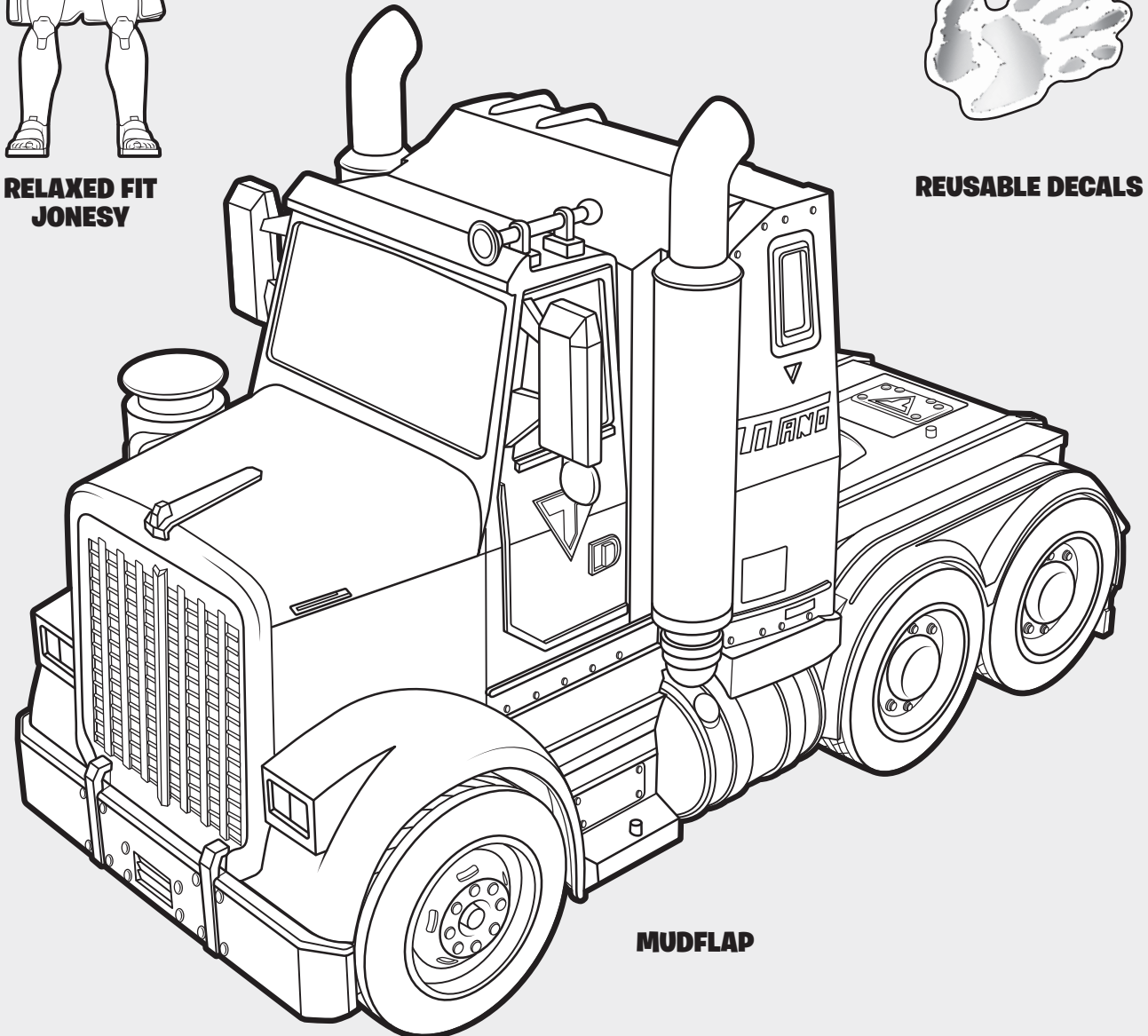

MUDFLAP

BATTERY INSTALLATION INSTRUCTIONS

ADULT INSTALLATION REQUIRED

MUDFLAP

- 1 Move the switch at the bottom of the Mudflap to the OFF mode. Use a Phillips Head screwdriver (not included) to remove the cover.

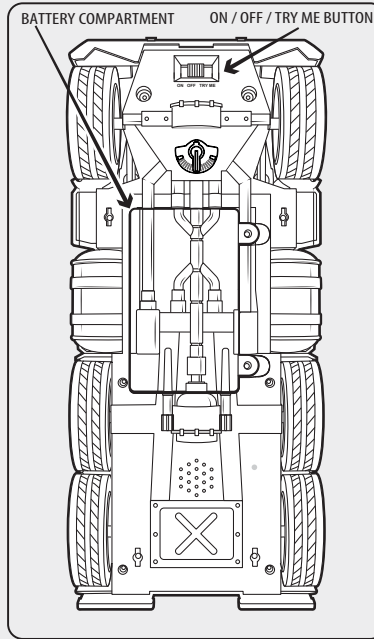

- 2 Remove the old batteries and insert the new (6 X 1.5V AA Size (LR6)) batteries with the correct polarity indicated inside the box. Screw the cover back in.

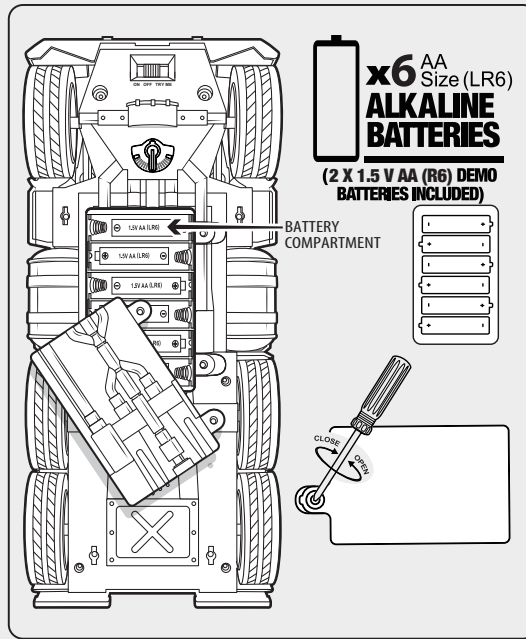

- 3 Move the switch to the ON mode to activate all play features of the Mudflap. Move the switch to the OFF mode when not in use to help save battery life.

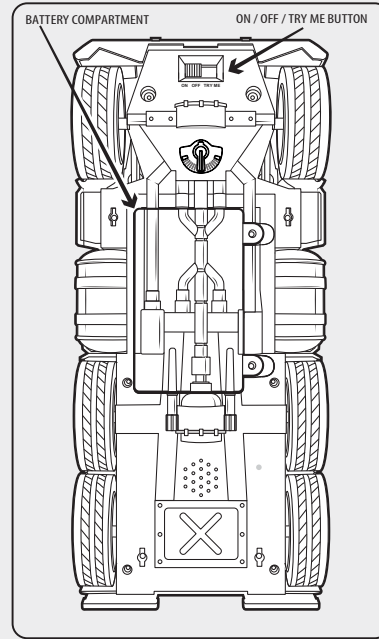

REMOTE CONTROL

- 1 Move the switch at the bottom of the Remote Control to the OFF mode. Use a Phillips Head screwdriver (not included) to remove the cover.

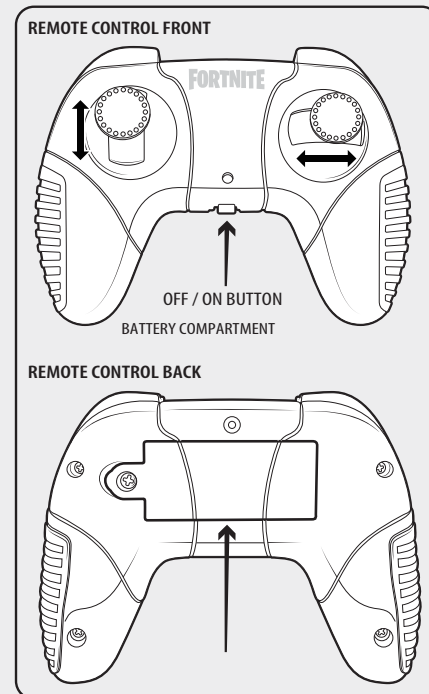

- 2 Remove the old batteries and insert the new (2 X 1.5V AAA Size (LR03)) batteries (not included) with the correct polarity indicated inside the box. Screw the cover back in.

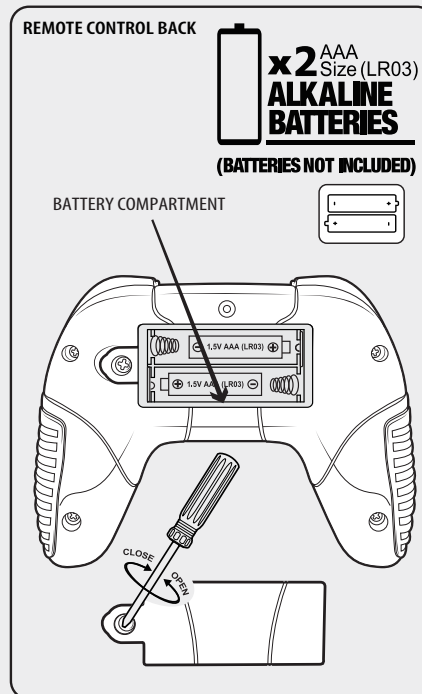

- 3 Move the switch to the ON mode to activate all play features of the Mudflap. Move the switch to the OFF mode when not in use to help save battery life.

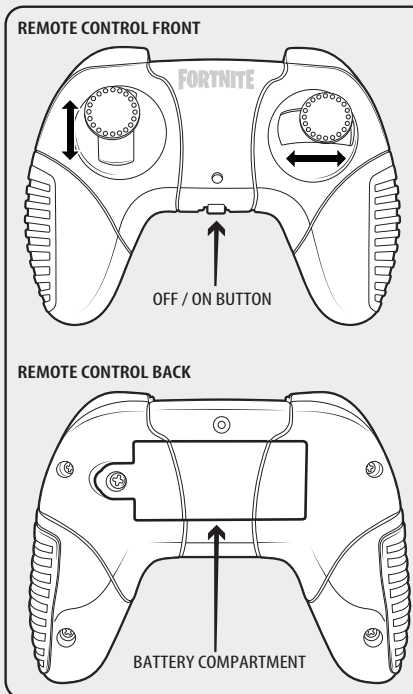

HOW TO PLAY

Switch mode from TRY ME to ON at the bottom of the Mudflap for full features. Do not operate your vehicle on the street or on wet surfaces. For best results, operate on smooth surfaces and avoid water and other liquids.

REMOTE CONTROL PAIRING

- 1 Turn the vehicle ON, then turn the transmitter controller ON within 30 seconds.*
*Do not press any buttons or switches on the controller while pairing, this may cause interference.
- 2 The LED light on controller will start blinking.
- 3 Once the pairing is successful, the LED light on controller will stop blinking and stay on.
- 4 If pairing is unsuccessful, turn the vehicle and controller OFF and try again.
- 5 NOTE: The vehicle will enter sleep mode after approximately 2 minutes of inactivity. If the vehicle enters sleep mode, turn the vehicle and controller off, then back on to continue operating with full capabilities.

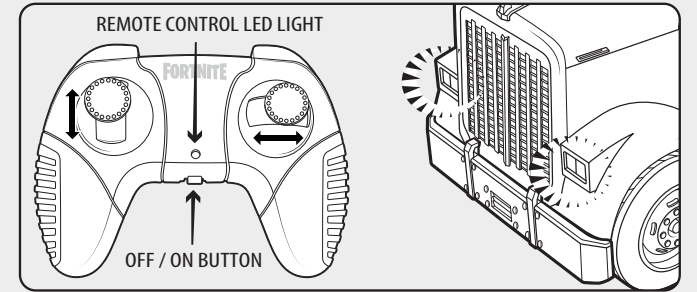

RANGE OF PLAY: approx. 80 feet (24 meters).
CONTROLLER FREQUENCY BAND : 2410 MHz - 2473 MHz, MAXIMUM POWER : 0.457mW
RECEIVER FREQUENCY BAND : 2410 MHz - 2473 MHz, MAXIMUM POWER : 0.120mW

ADJUST STEERING ALIGNMENT

If the vehicle doesn't move forward in a straight direction, adjust the steering alignment lever on the underside of the vehicle.

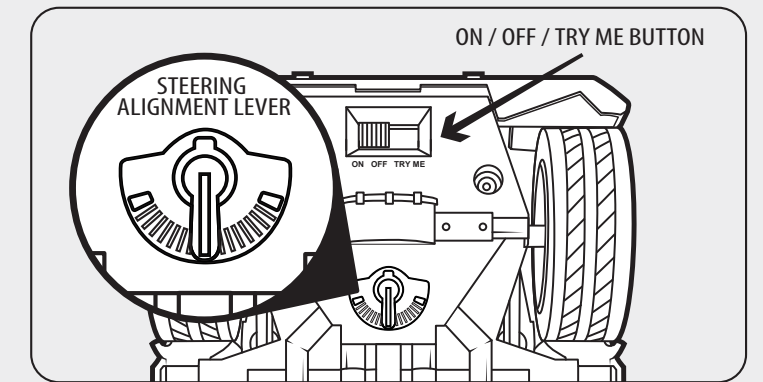
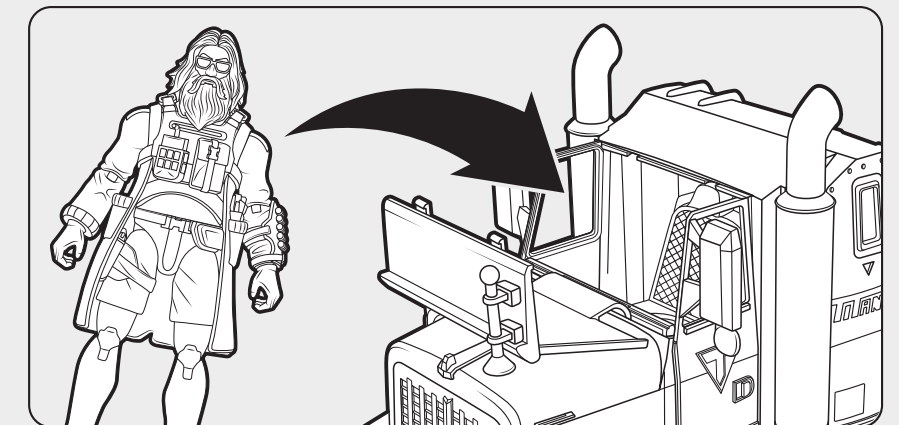

FIGURE PLACEMENT

Front of Cab opens to allow easy figure placement.



SOUND ACTIVATION

Collision sounds activate by pressing front bumper.

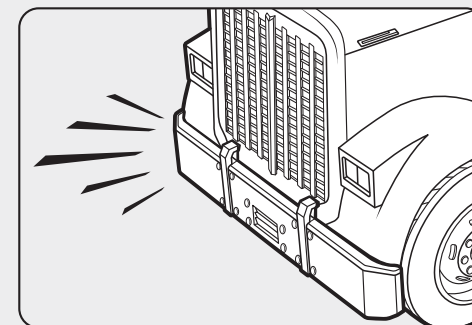

LIGHT ACTIVATION

While turned ON, Mudflap lights will remain illuminated.

