

FORTNITE

THE BALLER

INSTRUCTION MANUAL

CONTENTS:

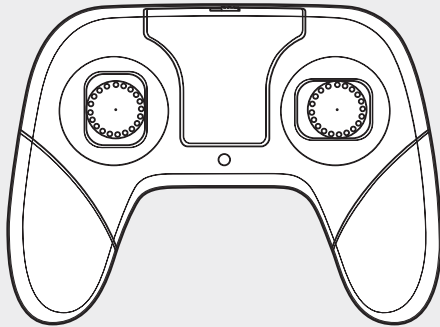

REMOTE CONTROL



HYBRID (STAGE 2)

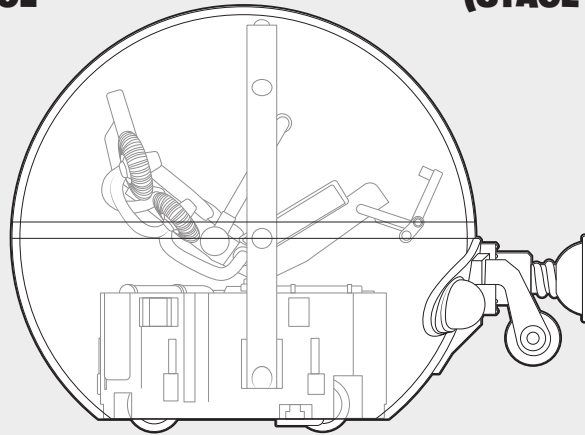

THE BALLER

FCC ID: YN1JAZWARES381 FCC ID: YN1JAZWARES117

This device complies with Part 15 of the FCC Rules. Operation is subject to the following two conditions: (1) This device may not cause harmful interference, and (2) this device must accept any interference received, including interference that may cause undesired operation.

WARNING! Changes or modifications not expressly approved by the manufacturer responsible for compliance could void the user's authority to operate the equipment.

NOTE: This equipment has been tested and found to comply with the limits for a Class B digital device, pursuant to Part 15 of the FCC rules. These limits are designed to provide reasonable protection against harmful interference in a residential installation. This equipment generates uses and can radiate radio frequency energy and, if not installed and used in accordance with the instructions, may cause harmful interference to radio communications. However, there is no guarantee that interference will not occur in a particular installation. If this equipment does cause harmful interference to radio or television reception, which can be determined by turning the equipment off and on, the user is encouraged to try to correct the interference by one or more of the following measures:

- Reorient or relocate the receiving antenna.
- Increase the separation between the equipment and receiver.
- Connect the equipment into an outlet on a circuit different from that to which the receiver is connected.
- Consult the dealer or an experienced radio/TV technician for help.

Conforms to toy safety standards CPSIA, ASTM-F963 and EN71.

Made in China

Used with permission. Manufactured and Distributed by:
Jazwares, LLC, Sunrise, FL 33326, USA
Jazwares, 16A Crane Grove, London, N7 8LE, United Kingdom
Jazwares GmbH, Mina-Rees-Str. 8, 64295 Darmstadt, Germany
www.jazwares.com / www.jazwares.de

© 2020 Epic Games, Inc. Fortnite and its logo are registered trademarks of Epic Games, Inc. in the USA (Reg. U.S. Pat. & Tm. Off.) and elsewhere. All rights reserved.

BATTERY WARNINGS:

1. Batteries are to be replaced by an adult.
2. Non-rechargeable batteries are not to be recharged.
3. Rechargeable batteries are to be removed from the toy before being charged.
4. Rechargeable batteries are only to be charged under adult supervision.
5. For best performance, only the recommended batteries or their equivalent are to be used.
6. Batteries must be inserted with correct polarity.
7. Do not mix new and used batteries.
8. Do not mix different types of batteries.
9. Exhausted batteries are to be removed from the toy.
10. The supply terminals are not to be short-circuited.

HOW TO CLEAN YOUR BALLER DELUXE VEHICLE

- To clean, wipe with a dry cloth.
- Do not submerge in water.
- Do not use chemical or abrasive cleaners.

PROBLEMS?

DO NOT RETURN TO STORE
Please Call Us: 1.800.370.1827
(U.S. Customers Only)

IMPORTANT:

Please save this instruction sheet.
It contains valuable product information.



Protect the environment by not disposing of this product with household waste (2012/19/EU). Check your local authority for recycling advice and facilities.

ADJUSTING STEERING ALIGNMENT

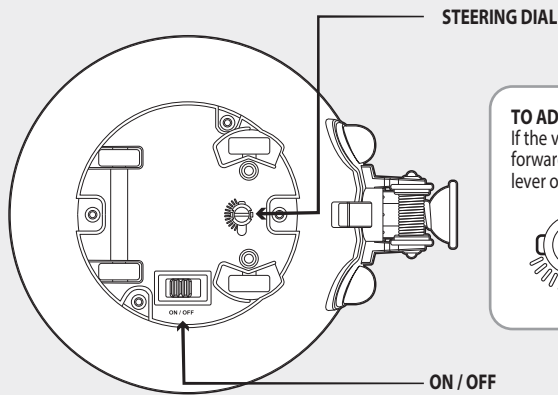

TO ADJUST STEERING ALIGNMENT
If the vehicle doesn't run straight forward, adjust the steering alignment lever on the underside of the vehicle.

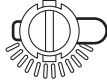

STEERING ALIGNMENT LEVER

FIGURE PLACEMENT

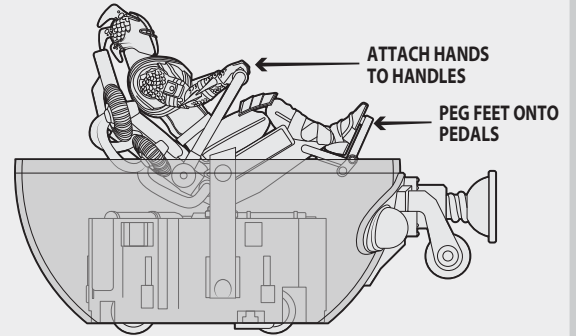

BATTERY REPLACEMENT

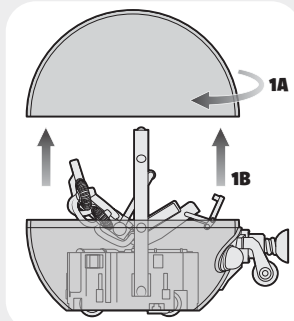

1 TWIST THEN PULL TO REMOVE CAP.

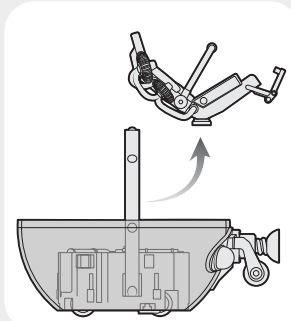

2 REMOVE SEAT TO ACCESS BATTERY COMPARTMENT.

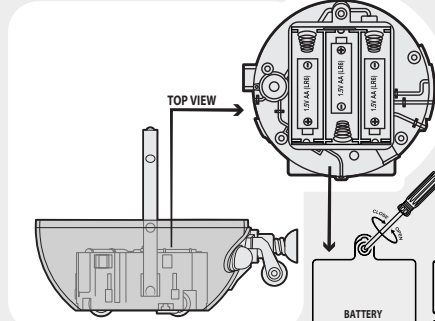

3 OPEN AND CLOSE BATTERY COVER WITH A PHILLIPS SCREWDRIVER. (NOT INCLUDED)

4 AFTER INSERTING BATTERIES, CLOSE THE BATTERY COMPARTMENT. PEG THE SEAT BACK ONTO THE BASE, AND PUT THE CAP ONTO THE VEHICLE.



REMOTE CONTROLLER

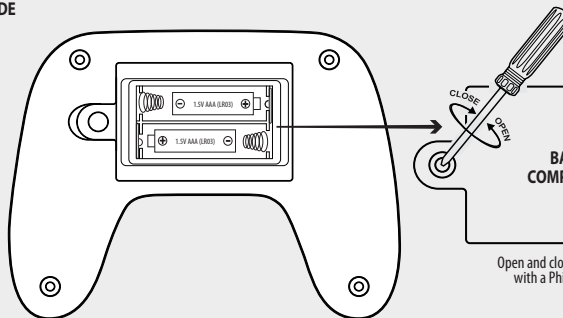
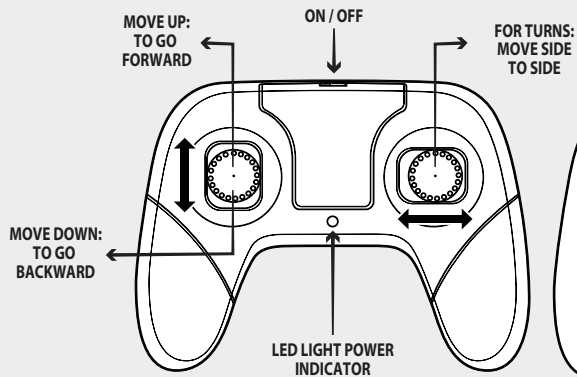

HOW TO PAIR

- Turn the vehicle ON, then turn the transmitter controller ON within 30 seconds.
*Do not press any buttons or switches on the controller while pairing, this may cause interference.
- The LED light on controller will start blinking.
- Once the pairing is successful, the LED light on controller will stop blinking and stay on.
- If pairing is unsuccessful, turn the vehicle and controller OFF and try again.
- If vehicle enters sleep mode, turn the vehicle and controller off, then back on and try again.

RANGE OF PLAY: 25 METERS/82 FEET.
CONTROLLER FREQUENCY BAND : 2410 MHz - 2473 MHz, MAXIMUM POWER : 1.56 mW
RECEIVER FREQUENCY BAND : 2410 MHz - 2473 MHz, MAXIMUM POWER : 0.06 mW

TROUBLESHOOTING

PROBLEM	SOLUTION
Vehicle will not START	<ol style="list-style-type: none"> Power switch is off. Make sure to turn it on. Batteries are installed with incorrect polarities. Check the + and - markings to make sure the batteries are properly aligned. Batteries are drained. Charge batteries, then re-install or install new batteries.
Vehicle does not respond to controls	<ol style="list-style-type: none"> Transmitter controller battery is drained. Replace the controller battery. Vehicle is out of range. Bring controller closer to the vehicle. Interference from surrounding electrical machinery. Bring to a wide open space.
Vehicle does not drive straight	<ol style="list-style-type: none"> Adjust the steering dial underneath the front axle, left or right, until the wheels point straight forward.
Vehicle does not move	<ol style="list-style-type: none"> Stop operation, switch off the power and rest your vehicle for a few minutes. Check the position of the batteries in the vehicle, they may have been knocked loose during play.
Vehicle does not respond properly	The vehicle is likely out of range. Bring controller closer to the vehicle. If problem persists, remove the controller batteries and replace with new batteries, then restart (ON/OFF) the vehicle.
Transmitter controller does not work	If the controller light is off, its batteries are drained. Replace the controller batteries.

REQUIRES BATTERIES, BATTERIES NOT INCLUDED.
THE PRODUCTS CAN BE SOLD IN ALL EU COUNTRIES