

# FZW0001 Fuzzibles Assortment

## [FZW0002 / FZW0003 / FZW0004 / FZW0005]

### Instruction Sheet

#### 42cm(L) x 29.7cm(H) (A3)

Material Code 包裝編號: FZW0001-IMUS  
 Blank Size: 16.5" W x 11.6"H  
 Color: 1C + 1C  
 Material: WF paper

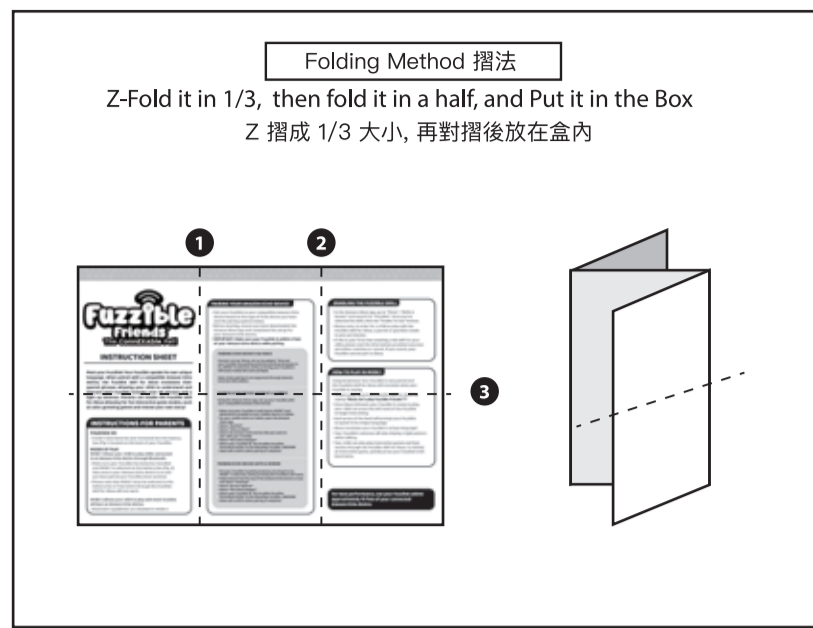

Product No. 產品編號	: FZW0002 / FZW0003 / FZW0004 / FZW0005	Page 1 of 1
Item No. 總產品編號	: FZW0001	
Material Code 物料編號	: FZW0001-IMUS	
Description 產品名稱	: FZW - Little Feature Plush (Cubby the Fox) - (AMZ)	
Language 語言	: [001] English (Universal) 英文	
Factory 生產廠	: [KA] Kai Sing = Dongguan Tianyu 天宇	
Packaging Type 包裝類別	: [---] Instruction Sheet 說明書	
Client 客戶	: Amazon	
Dimension 尺寸	: 5.5" L x 11.6" H	
Paper Size 展開尺寸	: 42cm (L) x 29.7cm (H)	
Material 材質	: WF Paper	
Color 顏色	: 1C + 1C	
Revision 版本	: 0.0	
Artwork Release Date 放稿日	: 2020 / 07 / 10	
Drawn by	: Brittany Altmann	
Edited by	: KinNa Lam	
Remark 備註	: FZW0002 - Cubby the Fox 小小狐狸 / FZW0003 - Fluff the Bunny 鬆鬆兔 / FZW0004 - Sparkles the Unicorn 閃閃獨角馬 / FZW0005 - Cuddles the Puppy 攏攏狗	

BLACK + DieCut

This drawing contains confidential information and is proprietary to Jazwares, LLC. The information may not be used, disclosed or reproduced without the prior written authorization of Jazwares, LLC and those so authorized may only use the information for the purpose of evaluation consistent with authorization.

**Jazwares**

Copyright © 2020 Jazwares, LLC. All rights reserved.



# Fuzzible Friends™

## The ConnEXable Pet!

### INSTRUCTION SHEET

Meet your Fuzzible! Your Fuzzible speaks its own unique language. When paired with a compatible Amazon Echo device, the Fuzzible skill for Alexa translates their special phrases allowing your child to understand and interact! Each Fuzzible includes over 40 phrases and a light up antenna. Parents can enable the Fuzzible skill for Alexa allowing for fun interactive game modes, such as color guessing games and choose your own story!

### INSTRUCTIONS FOR PARENTS

#### POWERING ON

• Install 3 AAA batteries (not included) into the battery box (Fig 1.) located on the back of your Fuzzible.

#### MODES OF PLAY

**MODE 1** allows your child to play while connected to an Amazon Echo device through Bluetooth.

- Make sure your Fuzzible has batteries installed and **MODE 1** is selected on the battery box (Fig. 2). Also ensure your Amazon Echo device is on and you have paired your Fuzzible (next section).
- Please note that **MODE 1** must be selected on the battery box or interaction through the Fuzzible skill for Alexa will not work.

**MODE 2** allows your child to play with their Fuzzible without an Amazon Echo device.

- Bluetooth capabilities are disabled in **MODE 2**

### PAIRING YOUR AMAZON ECHO DEVICE

- Pair your Fuzzible to your compatible Amazon Echo device based on the type of Echo device you have and the pairing options below.
- Before starting, ensure you have downloaded the Amazon Alexa app and completed the setup for your Amazon Echo device.
- **IMPORTANT: Make sure your Fuzzible is within 2 feet of your Amazon Echo device while pairing.**

#### PAIRING ECHO DEVICE VIA VOICE

Parents can say "Alexa, set up my gadget," then put your Fuzzible into pairing mode by ensuring the power is on, **MODE 1** is selected, and by pressing your Fuzzible's left hand. Follow the voice prompts.

Note: Voice pairing is not supported through Amazon Echo Dot Kids Edition.

#### PAIRING ECHO DEVICE WITHOUT A SCREEN

Using the Amazon Alexa app, set up your Fuzzible with your compatible Amazon Echo device.

- Make sure your Fuzzible is switched to **MODE 1** and Bluetooth is enabled on your mobile device or tablet.
- On your mobile device or tablet, open the Amazon Alexa app.
- Select "Devices".
- Select "Echo & Alexa".
- Select the Amazon Echo device that you want to pair with your Fuzzible.
- Select "Pair Alexa Gadget".
- Select your Fuzzible ID. The Fuzzible ID will be formatted similar to the following: Fuzzible\_#####
- Alexa will confirm when pairing is complete.

#### PAIRING ECHO DEVICE WITH A SCREEN

- Put your Fuzzible in pairing mode by ensuring it is on, **MODE 1** is selected, and by pressing the Fuzzible's left hand.
- Swipe down from the top of the Amazon Echo device screen and select "Settings".
- Select "Device Options".
- Select "Pair Alexa Gadget".
- Select your Fuzzible ID. The Fuzzible ID will be formatted similar to the following: Fuzzible\_#####
- Alexa will confirm when pairing is complete.

### ENABLING THE FUZZIBLE SKILL

- In the Amazon Alexa app, go to "Menu", "Skills & Games" and search for "Fuzzible". Once you've selected the skill, click the "Enable To Use" button.
- Please note, in order for a child to play with the Fuzzible skill for Alexa, a parent or guardian needs to give permission.
- If this is your first time enabling a kid skill for your child, please read the information provided onscreen and either continue or cancel. If you cancel, your Fuzzible cannot pair to Alexa.

### HOW TO PLAY IN MODE 1

Congratulations! Your Fuzzible is now paired and the Fuzzible skill for Alexa will translate what your Fuzzible is saying.

- To start play, launch the Fuzzible skill for Alexa by saying "Alexa, let's play Fuzzible Friends™!"
- Once Alexa indicates your Fuzzible is ready to play, your child can press the left hand of the Fuzzible to begin interacting.
- Each press of the hand will prompt your Fuzzible to speak in its unique language.
- Alexa translates your Fuzzible's unique language!
- Your Fuzzible's antenna will also display a light pattern while talking.
- Your child can also play interactive games and hear stories through the Fuzzible skill for Alexa. To initiate an interactive game, quickly press your Fuzzible's left hand twice.

For best performance, use your Fuzzible within approximately 10 feet of your connected Amazon Echo device.

### MODE 1 PLAY EXAMPLE



### STARTING PLAY

- Your child can press the left hand of the Fuzzible to begin interacting.
- To initiate an interactive game, quickly press your Fuzzible's left hand twice.

### HOW TO PLAY IN MODE 2

- Select **MODE 2** from the battery box and have your child press the Fuzzible's left hand.
- Each hand press will prompt the Fuzzible to speak.
- Your Fuzzible's antenna will still display a light pattern while talking.
- Translations and interactive game-play are not available in **MODE 2**.

### TROUBLESHOOTING AND TIPS

#### Trouble pairing?

- Ensure you have fresh batteries, and that they are aligned per the engraved orientation on the battery box.
- Make sure your Amazon Echo device is powered on and connected to Wi-Fi. Check your Alexa app to ensure you have the latest version and your Echo device has the latest software.
- Make sure your Fuzzible is within 2 feet of your Amazon Echo device while pairing.
- Ensure that **MODE 1** is selected on the battery box.
- If your Fuzzible cannot successfully pair with your Amazon Echo device while in **MODE 1**, it will automatically default to **MODE 2**.
- If you are using your Fuzzible with your child's FreeTime profile, please visit [fuzziblefriends.com](http://fuzziblefriends.com) for detailed instructions.
- For additional help setting up your Fuzzible and a list of compatible Amazon Echo devices, please visit [fuzziblefriends.com](http://fuzziblefriends.com).

#### Want to play a game?

Quickly press your Fuzzible's left hand TWICE while in **MODE 1** and your Fuzzible will choose a game or story. Have your child double press its left hand at the beginning of the interaction to skip to the next game mode.

#### Sleep mode

After 30 seconds of inactivity, your Fuzzible will let you know he or she is becoming sleepy. After this, they will soon go into sleep mode to conserve battery life. If your Fuzzible has fallen asleep, simply have your child press its left hand to wake up, then say "Alexa, let's play Fuzzible Friends™!" to play in **MODE 1** again.

#### Software updates

Your Fuzzible will automatically receive a software update when available and when your Fuzzible is connected to your Amazon Echo device. The update will occur in the background. You will be able to continue playing while the download is occurring behind the scenes! If the update occurs while playing in **MODE 1**, Alexa will notify you that the download is starting. After a successful update, your Fuzzible will restart, and you'll have the latest software.

### BATTERY AND SWITCH

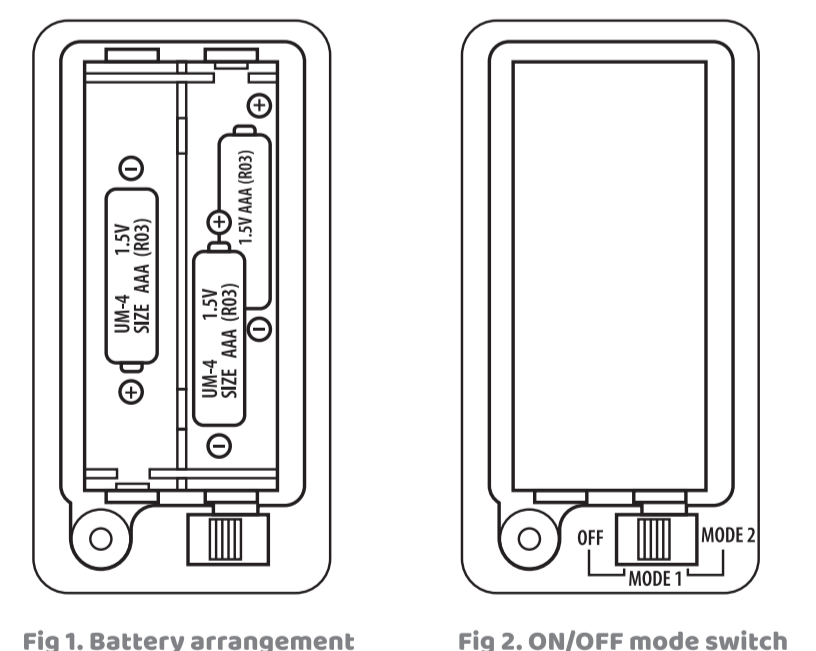

- Do not mix new and used batteries.
- Do not mix alkaline, standard or rechargeable batteries.
- Alkaline batteries are recommended.
- Non-rechargeable batteries are not to be recharged.
- Only batteries of the same or equivalent type as recommended are to be used.
- Batteries are to be inserted with the correct polarity.
- Requires 3 AAA batteries (Not included). Use a Phillips screwdriver to unscrew cover; note polarity of batteries, remove and replace with new ones as shown. Attach the cover and fasten screw. Never let a child use this product unless battery door is secure. Batteries are small objects and could be ingested.
- Dispose of used batteries immediately. Keep all batteries away from small children. If you think batteries might have been swallowed or placed inside any part of the body, seek immediate medical attention. This device complies with Part 15 of the FCC Rules.
- Operation is subject to the following two conditions: (1) this device may not cause harmful interference, and (2) this device must accept any interference received, including interference that may cause undesired operation.
- Warning: Changes or modifications to this unit not expressly approved by the party responsible for compliance could void the user's authority to operate the equipment.
- NOTE: This equipment has been tested and found to comply with the limits for a Class B digital device, pursuant to Part 15 of the FCC Rules. These limits are designed to provide reasonable protection against harmful interference in a residential installation. This equipment generates, uses, and can radiate radio frequency energy and, if not installed and used in accordance with the instructions, may cause harmful interference to radio communications. However, there is no guarantee that interference will not occur in a particular installation. If this equipment does cause harmful interference to radio or television reception, which can be determined by turning the equipment off and on, the user is encouraged to try to correct the interference by one or more of the following measures:
  - Reorient or relocate the receiving antenna.
  - Increase the separation between the equipment and receiver.
  - Connect the equipment into an outlet on a circuit different from that to which the receiver is connected.
  - Consult the dealer or an experienced radio/TV technician for help.
- Used with permission. Manufactured and Distributed by: Jazwares, LLC, Sunrise, FL 33326, USA
- Jazwares, 1&K Crane Grove, London, N7 8LE, United Kingdom
- Jazwares GmbH, Mima-Bees-Str. 8, 64295 Darmstadt, Germany
- www.jazwares.com
- Fuzzible Friends is a trademark of Jazwares, LLC.
- Amazon and all related marks are trademarks of Amazon.com, Inc. or its affiliates.
- © 2020 Jazwares, LLC

**DO NOT SUBMERGE YOUR FUZZIBLE FRIENDS™ IN WATER.**  
 Do not play around water as this is a hazard and can cause a malfunction or damage the electronic assemblies.

**PRESERVE BATTERY LIFE!**  
 TURN YOUR FUZZIBLE FRIENDS™ OFF USING THE SWITCH ON ITS BACK WHEN NOT IN USE!

