

KICHLER®

56" ICON CEILING FAN

Product images may vary slightly from actual product.

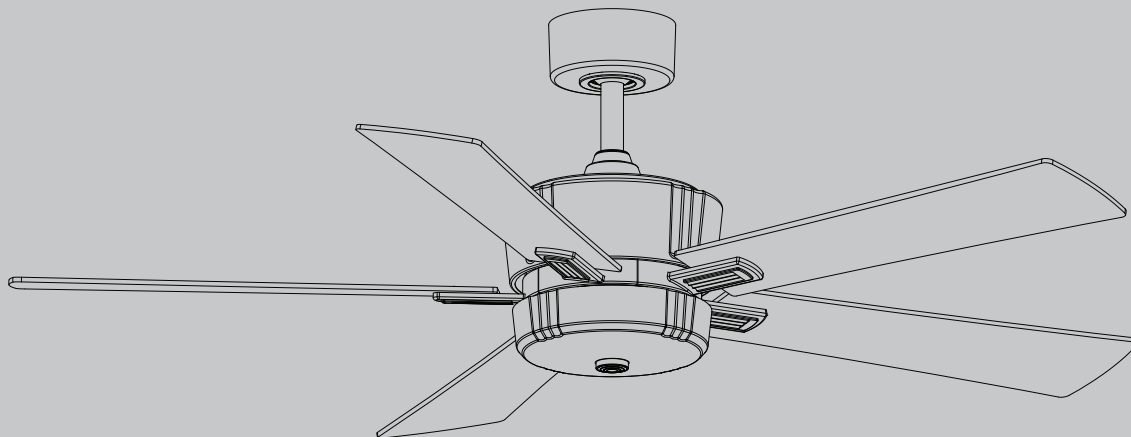

READ AND SAVE THESE INSTRUCTIONS

INSTRUCTION MANUAL

Model #300395

REV 01-MAR-2022

Net Weight: 8.63 kg (19.02 lb)
Gross weight: 10.45 kg (23.04 lb)

TABLE OF CONTENTS

| | | | |
|--|----|---------------------------------------|----|
| SAFETY RULES..... | 4 | INSTALLING THE LIGHT KIT FIXTURE..... | 16 |
| TOOLS AND MATERIALS REQUIRED..... | 6 | INSTALLING GLASS SHADE..... | 16 |
| PACKAGE CONTENTS..... | 6 | CONTROL SYSTEM SET-UP..... | 17 |
| MOUNTING OPTIONS..... | 7 | BUTTON INSTRUCTIONS..... | 19 |
| HANGING THE FAN..... | 8 | INSTALLING WALL PLATE..... | 20 |
| INSTALLATION OF SAFETY SUPPORT (CANADA ONLY)..... | 11 | INSTALLING THE TRANSMITTER..... | 21 |
| ELECTRICAL CONNECTIONS..... | 12 | OPERATING INSTRUCTIONS..... | 22 |
| FINISHING THE INSTALLATION..... | 14 | TROUBLESHOOTING..... | 23 |
| ATTACHING THE FAN BLADE ARMS..... | 15 | FCC INFORMATION..... | 24 |
| ATTACHING THE FAN BLADES..... | 15 | | |

Read all instructions BEFORE assembly and USE of product
KEEP INSTRUCTIONS FOR FUTURE USE

SAFETY RULES

READ AND SAVE THESE INSTRUCTIONS

WARNING: FOR CANADA, THIS FAN MUST BE SECURED DIRECTLY TO THE BUILDING STRUCTURE/CEILING JOIST. DON'T SECURE THIS FAN TO AN OUTLET BOX.

1. CAUTION - RISK OF SHOCK -

Disconnect power at the main circuit breaker panel or main fusebox before starting and during the installation.

2. WARNING: This fixture is intended for installation in accordance with the National Electrical Code (NEC) and all local code specifications. If you are not familiar with code requirements, installation by a certified electrician is recommended.

3. WARNING: To reduce the risk of fire, electric shock, only use the control provided with fan.

4. WARNING: To reduce the risk of fire, electric shock, or Personal Injury mount to an outlet box marked "Acceptable For Fan Support of up to 15.9 kg (35 lb)". For outlet box mounting, use mounting screws (and lock washers) provided with the outlet box. Most outlet boxes commonly used for the support of light fixtures are not acceptable for fan support and may need to be replaced. Due to the complexity of the installation of this fan, a qualified licensed electrician is strongly recommended."

5. All wiring must be in accordance with the National Electrical Code ANSI/NFPA 70 and local electrical codes. Electrical installation should be performed by a qualified licensed electrician.

6. The outlet box and support structure must be securely mounted and capable of reliably supporting a minimum of 15.9 kg (35 lb). Use only CUL Listed outlet boxes marked "FOR FAN SUPPORT".

WARNING: TO REDUCE THE RISK OF FIRE, ELECTRIC SHOCK OR PERSONAL INJURY, MOUNT FAN TO OUTLET BOX MARKED "ACCEPTABLE FOR FAN SUPPORT".

7. CAUTION: The fan must be mounted with a minimum of 2.1m (7 feet) clearance from the trailing edge of the blades to the floor.

8. To operate the reverse function on this fan, press the reverse button while the fan is running.

9. Avoid placing objects in the path of the blades.

10. To avoid personal injury or damage to the fan and other items, be cautious when working around or cleaning the fan.

11. WARNING: Make sure the power is disconnected before cleaning the fan.

SAFETY RULES (continued)

12. Do not use water or detergents when cleaning the fan or fan blades. A dry dust cloth or lightly dampened cloth will be suitable for most cleaning.
13. After marking electrical connections, spliced conductors should be turned upward and pushed carefully up into outlet box. The wires should be spread apart with the grounded conductor and the equipment-grounding conductor on one side of the outlet box and the ungrounded conductor on the other side of the outlet box.
14. Electrical diagrams are reference only. Light Kits that are not packed with the fan must be cULus listed and marked suitable for use with the model fan you are installing. Switches must be cULus General Use Switches. Refer to the Instructions packaged with the light kits and switches for proper assembly.
15. All set screws must be checked, and re-tightened where necessary, before installation.

WARNING: TO REDUCE THE RISK OF PERSONAL INJURY, DO NOT BEND THE BLADE BRACKETS (ALSO REFERRED TO AS BLADE ARMS) DURING ASSEMBLY OR AFTER INSTALLATION. DO NOT INSERT OBJECTS IN THE PATH OF BLADES.



16. **WARNING: Chemical Burn Hazard.** Keep batteries away from children.; and

This product contains a lithium button/coin cell battery. If a new or used lithium button/coin cell battery is swallowed or enters the body, it can cause severe internal burns and can lead to death in as little as 2 hours. Always completely secure the battery compartment. If the battery compartment does not close securely, stop using the product, remove the batteries, and keep it away from children. If you think batteries might have been swallowed or placed inside any part of the body, seek immediate medical attention.

- a) The cells shall be disposed of properly, including keeping them away from children; and
- b) Even used cells may cause injury.

TOOLS REQUIRED

- Philips screw driver
- Blade screw driver
- 11mm wrench
- Step ladder
- Wire cutters

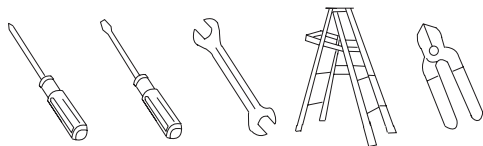

PACKAGE CONTENTS

Unpack your fan and check the contents.
You should have the following items:

- Fan blades (5)
- Canopy
- Ball/Downrod assembly
- Coupling cover
- Fan motor assembly
- Blade arms (5)
- Light kit assembly
- Glass shade assembly
- Receiver
- Wall transmitter
- Parts bag contents:

- 1) Mounting hardware:
Star washers (2), wire nuts (3),
machine screws (2), washers (2),
wood screws (2)
- 2) Blade attachment hardware:
blade screws (16), blade arm
screws (11), fiber washers (16)
- 3) Safety cable hardware:
wood screw, lock washer, flat
washer
- 4) Balancing kit

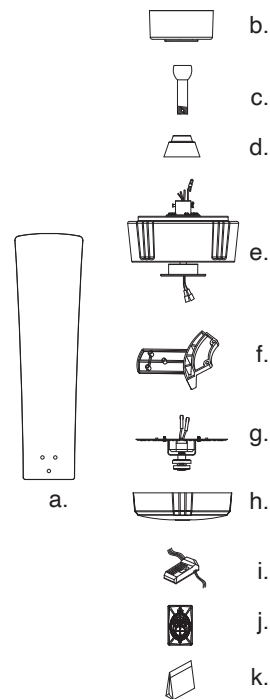

MOUNTING OPTIONS

If there isn't an existing UL (cUL for Canadian Installation) listed mounting box, then read the following instructions. Disconnect the power by removing fuses or turning off circuit breakers.

Secure the outlet box directly to the building structure. Use appropriate fasteners and building materials. The outlet box and its support must be able to fully support the full weight of the fan (up to 15.9 kg (35 lb)). Do not use plastic outlet boxes.

Figures 1, 2, and 3 are examples of different ways to mount the outlet box.

NOTE: If you are installing the ceiling fan on a sloped (vaulted) ceiling, you may need a longer downrod to maintain proper clearance between the tip of the blade and the ceiling. A minimum clearance of 12" is suggested for optimal operation.

NOTE: Depending on the location you have selected for installation, you may need to purchase and install a "Joist Hanger" for the support of the outlet box. Make sure the joist hanger you purchase has been designed for use with ceiling fans. (Fig. 4)

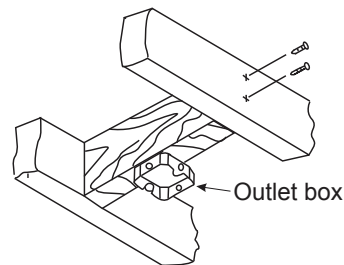

Fig. 1

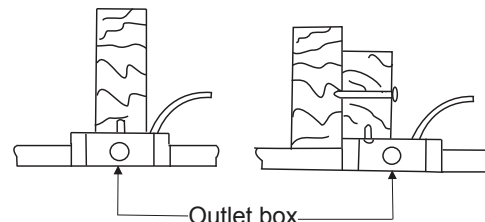

Fig. 2

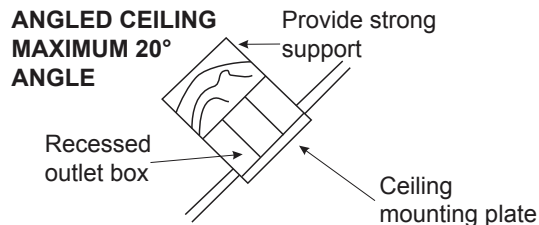

Fig. 3

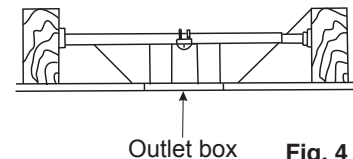

Fig. 4

HANGING THE FAN

NOTE: FOR CANADA, THIS FAN MUST BE SECURED DIRECTLY TO THE BUILDING STRUCTURE/CEILING JOIST. DON'T SECURE THIS FAN TO AN OUTLET BOX. (see Fig. 6A)

REMEMBER to turn off the power before you begin.

To properly install your ceiling fan, follow the steps below.

Step 1. Remove the decorative canopy bottom cover from the canopy by turning the cover counterclockwise. (Fig. 5)

Step 2. Remove the ceiling mounting bracket from the canopy by removing (and save) one of the two screws. Loosen the remaining screw by a half turn. (Fig. 5)

Step 3. Pass the 120 volt supply wires from the ceiling outlet box through the center of the ceiling mounting bracket. (Fig. 6)

Step 4. Attach the ceiling mounting bracket to the outlet box using the screws and washers included with the outlet box. (Fig. 6)

Step 4A. Secure the mounting bracket directly to a joist from the building structure. Use only the appropriate wood screws and lock washers included with your fan. (Fig. 7)

NOTE: THIS STEP IS ONLY FOR CANADA.

CAUTION: The hanger bracket must be installed directly to the building joist using the two wood screws and washers provided. (Fig. 7)

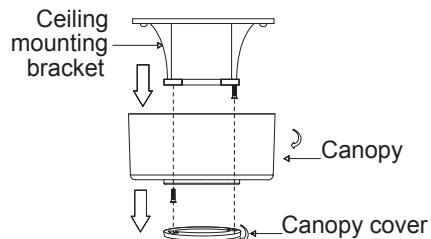

Fig. 5

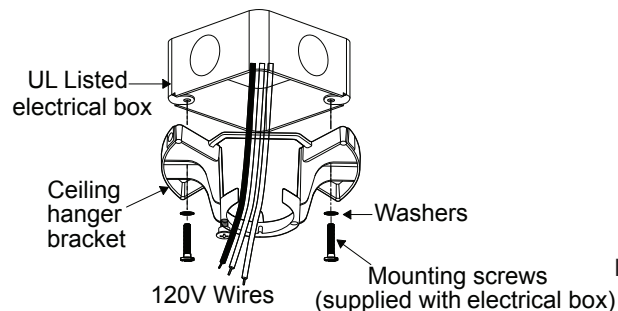

Fig. 6

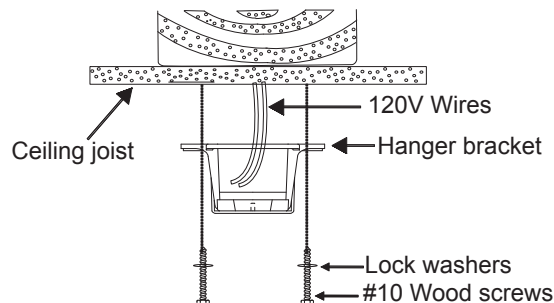

Fig. 7

HANGING THE FAN (continued)

Step 5. Remove the hanger ball from the downrod assembly by loosening the set screw, unscrewing and removing the cross pin and unscrewing the ball off the rod. (Fig. 8)

Step 6. Loosen the two set screws and remove the hitch pin and retaining clip from the coupling on top of the motor assembly. (Fig. 9)

Step 7. Carefully feed the electrical lead wires from the fan up through the downrod. Thread the downrod into the coupling until the hitch pin holes align.

Next, replace the hitch pin and retaining clip. Tighten both set screws. (Fig. 9)

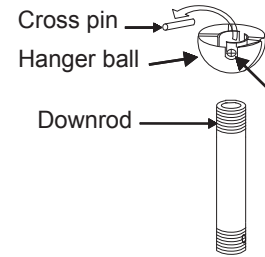

Fig. 8

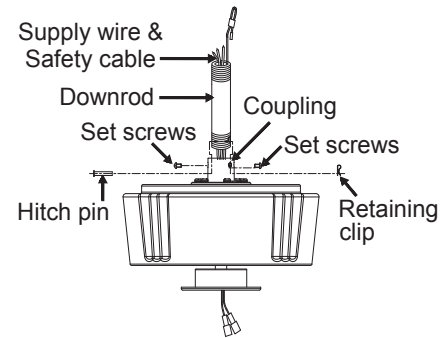

Fig. 9

HANGING THE FAN (continued)

Step 8. Slip the coupling cover, canopy cover and canopy onto the downrod. (Fig. 10)

Thread the hanger ball onto the downrod, insert the cross pin through the downrod and tighten. Tighten the set screw.

Step 9. Lift the motor assembly into position and place the hanger ball into the ceiling mounting bracket.

Rotate the entire assembly until the “Check Tab” has dropped into the “Registration Slot” and seats firmly. (Fig. 11)

The entire motor assembly should not rotate (left or right) when seated properly.

WARNING: Failure to reattach the cross pin and seat the “Check Tab” can cause the fan to fall from the ceiling during operation. Take special care to make sure this pin is reattached.

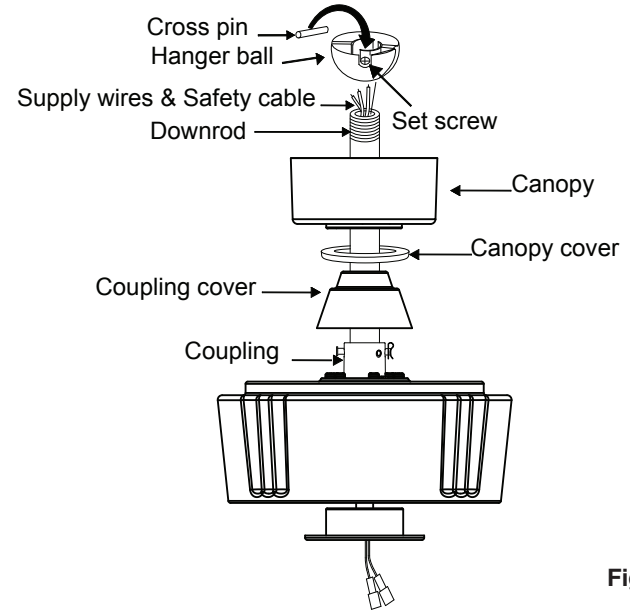

Fig. 10

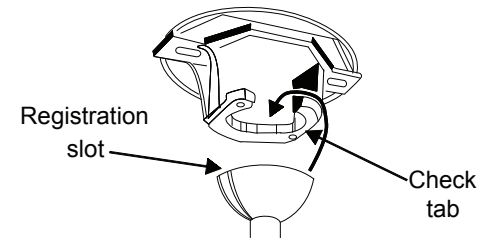

Fig. 11

INSTALLATION OF SAFETY SUPPORT (Required for Canadian installation ONLY)

A safety support cable is provided to help prevent the ceiling fan from falling, please install it as follows.

Step 1. Attach the provided wood screw and washers to the ceiling joist next to the mounting bracket but do not tighten. (Fig. 12)

Step 2. Adjust the length of the safety cable to reach the screw and washers by pulling the extra cable through the cable clamp until the overall length is correct, put the end of the cable back through the cable clamp, forming a loop at the end of the cable. Tighten the cable clamp securely. Now, put the loop in the end of the safety cable over the wood screw securely.

NOTE: Although the safety support cable is required for Canadian installations only, it's a good idea to make the attachment with any installation.

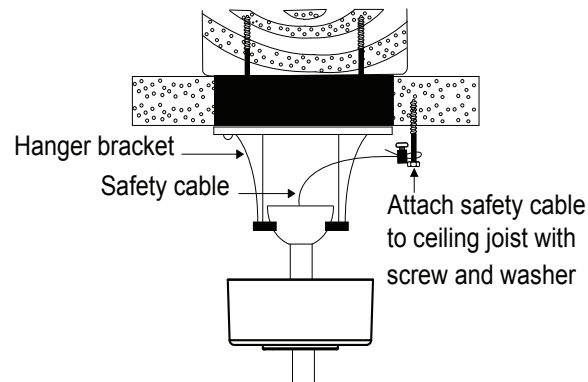

Fig. 12

ELECTRICAL CONNECTIONS

WARNING: Carefully read and retain this Instruction Manual for future reference.

WARNING: To avoid possible electrical shock, be sure the electricity is turned off at the main panel by removing the fuse or opening the circuit breaker.

WARNING: This control is designed for use with “DC Motor Ceiling Fans” ONLY. DO NOT use with any other type of electrical appliance.

WARNING: All wiring must conform to national and local electrical codes. If you feel you do not have enough electrical knowledge, have a licensed electrician install the control.

Step 1. Insert the receiver into the ceiling mounting bracket with the flat side of the receiver facing the ceiling. (Fig. 13)

For best performance, make sure the Black antenna, on the end of the receiver, remains extended and not tangled with any of the electrical wires.

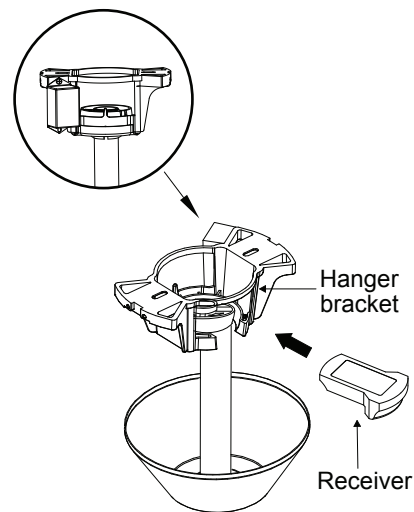

Fig. 13

ELECTRICAL CONNECTIONS (continued)

A. Fan wire connection (Fig. 14)

Connect the orange wire from the fan to the orange wire on the receiver.

Connect the brown wire from the fan to the brown wire on the receiver.

Connect the grey wire from the fan to the grey wire on the receiver.

Connect the blue wire from the fan to the blue wire on the receiver.

Connect the white wire from the fan to the white wire on the receiver.

Secure the wire connections with the plastic wire nuts provided.

Align the black wire from the receiver to the brown wire from the filter, align the white wire from the receiver to the blue wire from the filter, then connecting the molded adaptor together.

Connect the black (hot) wire from the ceiling to the brown wire from the filter box.

Connect the white (Neutral) wire from the ceiling to the blue wire from the filter box.

Secure the wire connections with the plastic wire nuts provided.

If your outlet box has a ground wire (green or bare copper) connect it to the fan ground wires; otherwise connect the hanging bracket ground wire to the mounting bracket. Secure the wire connection with a plastic nut provided. After connecting the wires, spread them apart so that the green and white wires are on one side of the outlet box and black and blue wires are on the other side. Carefully tuck the wire connections up into the outlet box.

NOTE: Remember to cut off excess lead wire from fan body before wiring in order to install receiver and canopy easily.

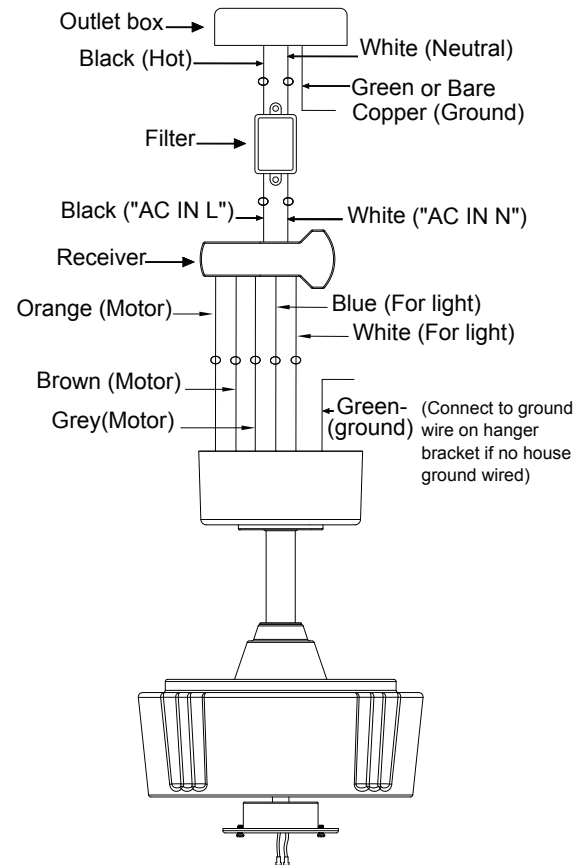

Fig. 14

FINISHING THE INSTALLATION

Step 1. Tuck all the connections neatly into the ceiling outlet box.

Step 2. Slide the canopy up to the mounting bracket and place one of the key hole slots over the mounting screw on the mounting bracket. Rotate the canopy until the screw head locks in place at the narrow section of the key hole. (Fig.15)

Step 3. Align the remaining circular hole on the canopy with the remaining hole on the Ceiling Mounting Bracket. Insert and tighten the mounting screw you removed earlier and the mounting screw from step 2 above. Now, attach the canopy cover to the mounting screw heads by inserting the screw heads into the bottom side of the canopy cover and rotating the cover clockwise.

NOTE: Adjust the canopy screws as necessary until the canopy and canopy cover are snug.

WARNING: Make sure the “Check Tab” at the bottom of the hanger bracket is properly seated in the “Registration Slot” on the side of the hanger ball before attaching the canopy to the bracket. Failure to properly seat the “Check Tab” could damage the electrical wires when the ceiling fan blade direction is changed while the fan is running.

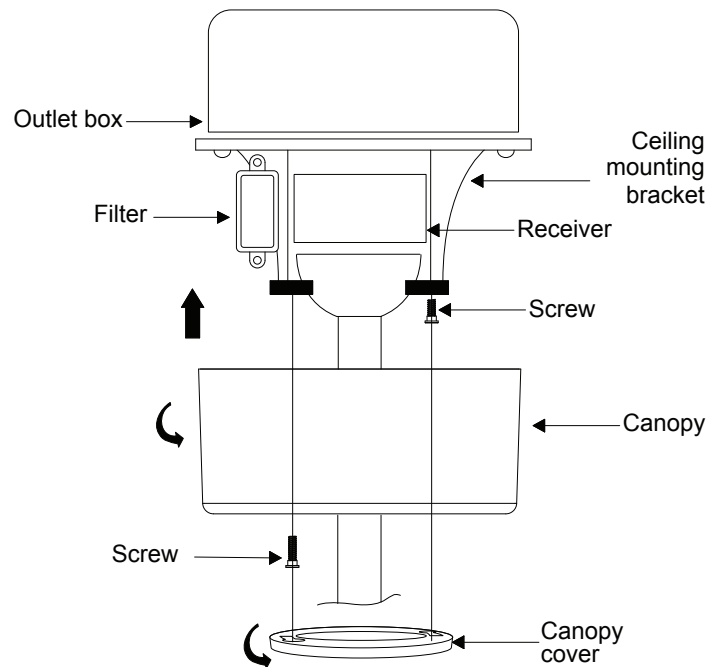

Fig. 15

ATTACHING THE FAN BLADE ARMS

Step 1. Fasten the blade arm to the fan motor assembly by tightening the blade arm screw onto the fan motor assembly. (Fig. 16)

Step 2. Repeat this procedure for the remaining four blade arms.

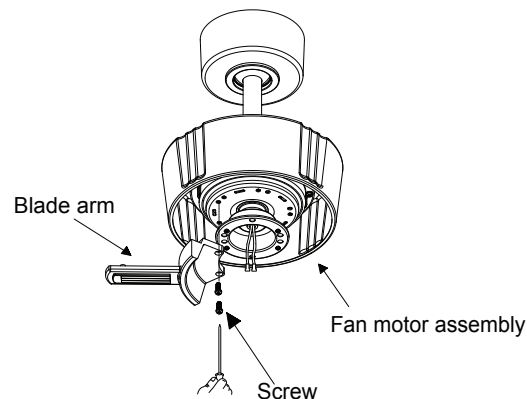

Fig. 16

ATTACHING THE FAN BLADES

Step 1. Align the holes from the blade and washer to the holes from the blade arms, and secure the blade in place with screws provided. (Fig. 17)

Step 2. Repeat these steps for the remaining four blades.

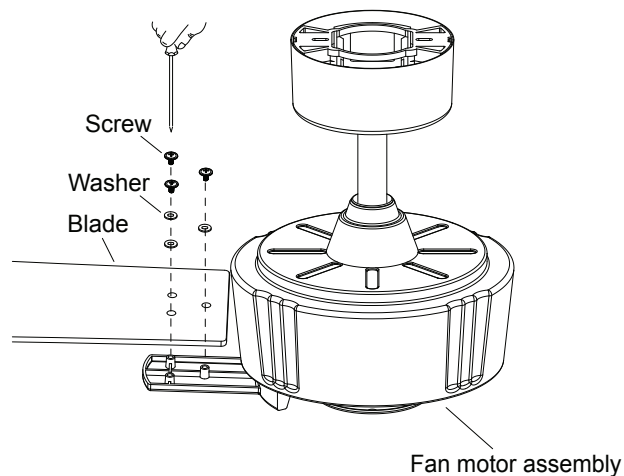

Fig. 17

INSTALLING THE LIGHT KIT FIXTURE

CAUTION: “To reduce the risk of electric shock, disconnect the electrical supply circuit to the fan before installing light kit.”

Step 1. Remove the finial, and nut from the threaded nipple of the light kit fixture assembly. (Fig. 18)

Step 2. Loosen, remove, and save the four screws on the mounting ring, attached to the motor shaft. Connect the wire from the light kit fixture assembly to the wire from the fan motor assembly by connecting the molded adaptor plug together.

Step 3. Align the screw holes from the light kit pan with the screw holes on the mounting ring of the fan motor assembly. Reinstall and tighten the four screws previously removed in step 2 securely. (Fig. 19)

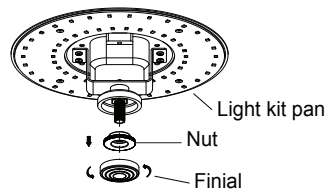

Fig. 18

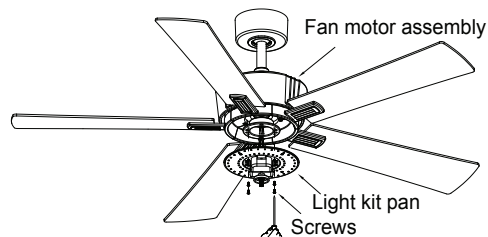

Fig. 19

INSTALLING THE GLASS SHADE

Raise the glass shade against the light plate and secure by tightening the nut and finial. (Fig. 20)

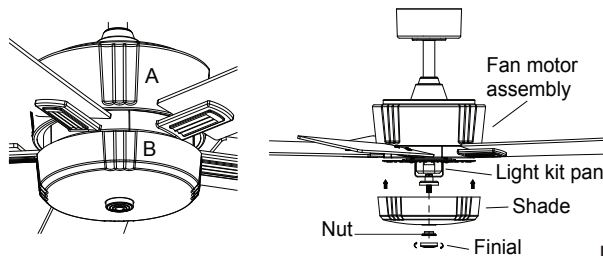



Fig. 20

CONTROL SYSTEM SET-UP

 **WARNING: Chemical Burn Hazard. Keep batteries away from children.**

 **WARNING: Make sure the power is completely disconnected before you begin this procedure.**

SPECIAL NOTE: Your new Kichler® Ceiling Fan is state of the art and employs a high efficiency DC (direct current) motor with an advanced CoolTouch™ remote control system. The DC motor uses 70% less energy than a conventional ceiling fan AC induction motor. The DC motor is “digitally” controlled and operates differently than conventional ceiling fan motors.

Please read this portion of the manual completely before proceeding.

Our CoolTouch™ Control System includes an “automatic frequency selection” feature. To set the control frequency and program the control system, follow these steps:

Open the back of the transmitter by loosening the screw (figure 21). The frequency selector is a “dip switch block” inside the battery compartment of the transmitter (see figure 22). You change frequencies by arranging the small switches numbered 1 through 4 in a up or down position. 16 Possible frequencies or combinations are possible. The fifth switch, marked D and X sets the system for operation with incandescent or fluorescent lamps. It is essential to set this switch correctly. If your ceiling fan is equipped with incandescent lamps set this switch to the D position, for fluorescent lamps, set the switch to the X position. If these settings are reversed, the lighting control system will operate erratically and could damage your ceiling fan.

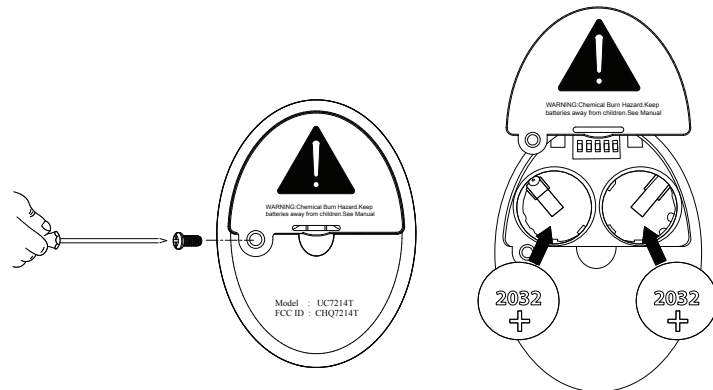

Fig. 21

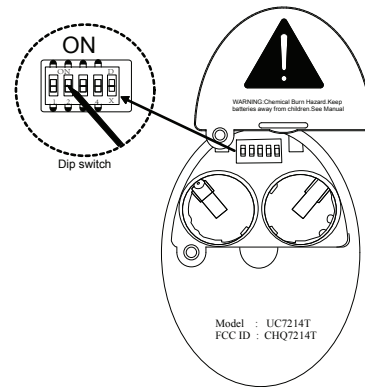

Fig. 22

System programing: Read all of these steps before proceeding.

Each step must be followed exactly to properly program the control system.

1. You can leave the frequency switches at the factory setting or move them to any combination of up or down. Use a small flat bladed screwdriver to move the switches.
2. Insert both batteries and make sure they are seated correctly in each recess with the positive + sign facing up. Replace the battery cover. (Figure 21)
3. Test the transmitter by pushing and releasing ANY button briefly. A Blue Light should illuminate under the 3-4 buttons. (Fig. 23) If not, check to make sure the batteries are inserted and seated correctly.

Power Up and Programming:

4. Follow the below steps to set the remote control:

The auto learning function will only mandate within 60 seconds when turning the fan's AC power ON. (Figure 24)

5. Select desired frequency from the back of transmitter.
6. From the back of the transmitter, press and hold the "hold" button for 5+ seconds. Once the receiver has detected the frequency, the light will flash twice, and the fan will automatically begin to operate and start to rotate in the counter clockwise direction and on the highest RPM for 3 minutes. When counterclockwise rotation has finished, the fan will automatically reverse to clockwise direction again to the highest RPM for 3 minutes. Fan will shut off when the self calibration test has finished. The total self calibration test will last about 6 minutes.

NOTE: If the self calibration test failed, turn the AC power off; restore power and process the self calibration test again.

NOTE: During self calibration test, the remote is non-fuctional.

NOTE: The learning frequency function and self calibration test will continue to retain the last set frequency and calibration set even when the AC power is shut off. If the frequency is changed the self calibration test will occur again.

7. Your CoolTouch™ Control System is now programmed and ready for use. Please see the Operating Instructions.

The receiver provides the following protective function:

1. Lock position: The DC motor has a built-in safety against obstruction during operation. If there is an obstruction, the motor will stop and then the power will automatically go off in 30 seconds. Remove the obstruction and reset.
2. Over 80W protection: When the receiver detects motor power consumption which is greater than 80W, the receiver power will be stopped and operation will immediately discontinue. Wait for 5 seconds and then turn the receiver power back on.

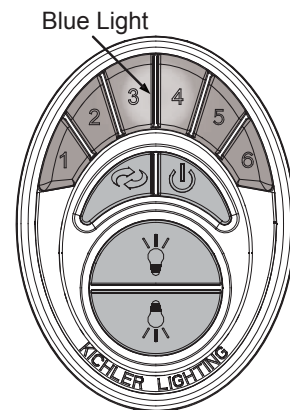

Fig. 23

Press/hold  Button

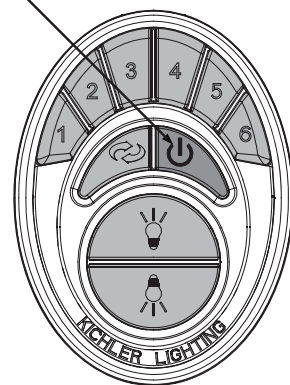

Fig. 24

BUTTON INSTRUCTIONS

Figure 25

Buttons 1, 2, 3, 4, 5 and 6 are used to set the blade speed as follows:

- 1 = Low Speed
- 2 = Medium Low Speed
- 3 = Medium Speed
- 4 = Medium High Speed
- 5 = High Speed
- 6 = Extra High Speed

Figure 26

The “MOTOR OFF” button:

This button turns the fan motor off and is also used in the program procedure.

The “LIGHT CONTROL “ button:

This button turns the bottom light ON or OFF and also controls the brightness setting. Press and hold either button to set the desired brightness level. The next time you turn the light on, the system will remember this setting. Press and release either button to turn the light ON or OFF.

Figure 27

The “FORWARD/REVERSE “ button is used to set the fan in forward or reverse operation. Each time you press this button the fan blades will reverse direction. This button functions ONLY when the fan blades are in motion.

OPERATIONAL NOTE: Each time you start the blades rotating, at any speed or reverse, the direction of the blades the Control System will do a “Self Check” to ensure operational integrity. The blades will rotate slowly a short distance ($\frac{1}{4}$ turn), pause, change directions, rotate $\frac{1}{4}$ turn, then build up RPM'S to the selected speed. This is a perfectly normal procedure and ensures normal operating performance

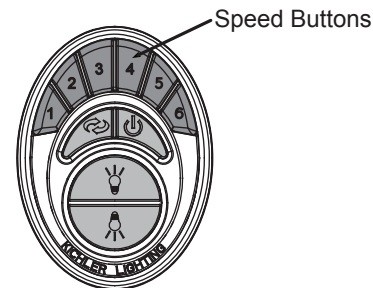

Fig. 25

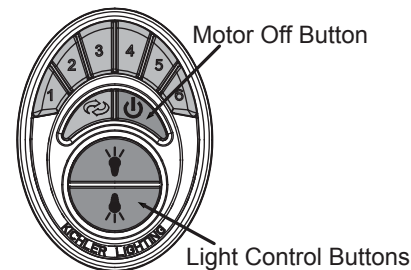

Fig. 26

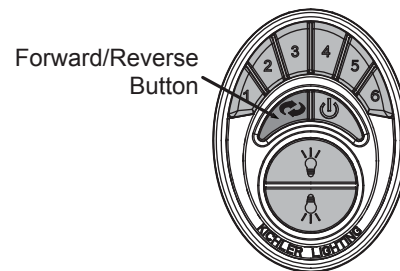

Fig. 27

INSTALLING THE COOL TOUCH™ CONTROL SYSTEM WALL PLATE

Select a location to install the Wall Control System Transmitter and Wall Plate.

WARNING: All wiring must be in accordance with the National Electrical Code and local electrical codes. Electrical installation should be performed by a qualified licensed electrician.

Select a location to install your CoolTouch™ Control System Transmitter. You can replace an existing wall switch or, install the transmitter on ANY flat surface.

Option 1: Install the control system using an existing wall switch outlet box. Make sure the electrical power is TURNED OFF at the main panel before continuing.

NOTE: Switch installation must comply with all local and national electric codes.

Step 1. Remove the existing wall plate and the old switch from the wall outlet box. Wire nut the BLACK leads (hot) together and push back inside the outlet box. (Fig. 28)

Step 2. Install the metal plate and CoolTouch™ wall plate to the existing wall outlet box with 4 screws provided. Then place the two plastic plugs into the wall plate. (Fig. 29)

Option 2: Install the control system on ANY flat surface.

Select the desired location and use the CoolTouch™ wall plate to mark the location for the mounting holes. Use the dry wall anchors and/or screws provided and finish the installation.

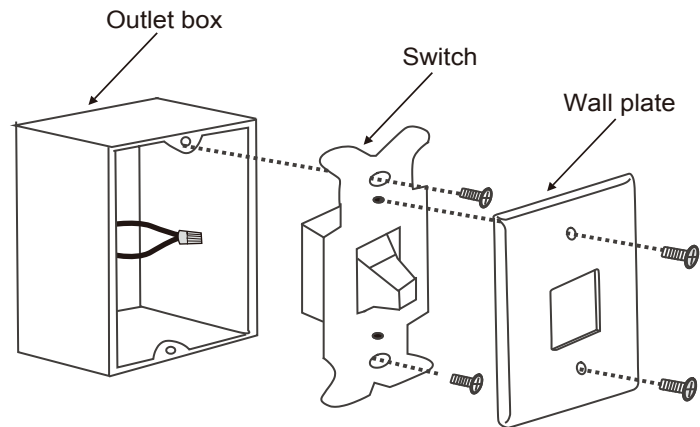

Fig. 28

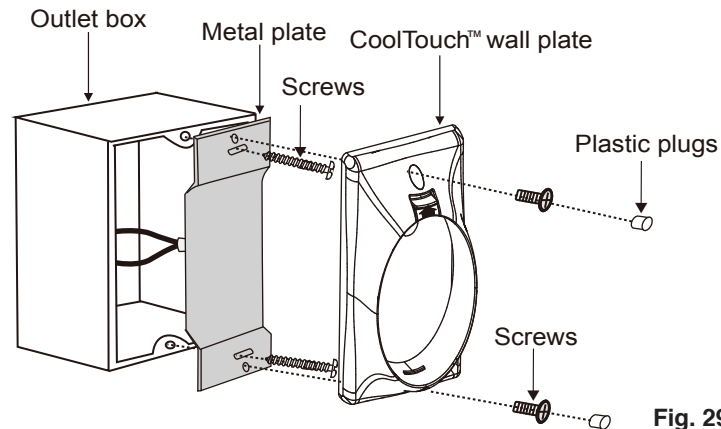

Fig. 29

INSTALLING THE TRANSMITTER

1. Insert the transmitter into the wall plate by inserting the bottom of the transmitter first and then press the top of the transmitter into the pocket. The transmitter will fully function from this location or you can remove the transmitter and use as a “Hand Held” device. (Fig. 30)
2. Press the release button to remove the transmitter from the wall plate.

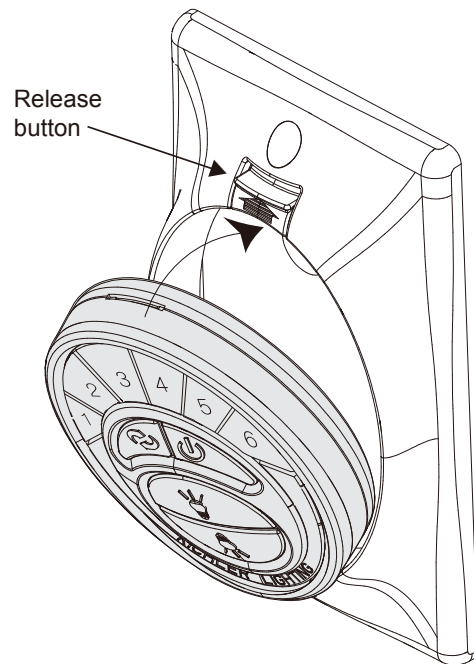

Fig. 30

OPERATING INSTRUCTIONS

Warm weather - Forward (counter clockwise).

A downward airflow creates a cooling effect as shown in Fig. 31. This allows you to set your air conditioner on a warmer setting without affecting your comfort.

Cool weather - Reverse (clockwise).

An upward airflow moves warm air from the ceiling as shown in Fig. 32. This allows you to set your heating unit on a cooler setting without affecting your comfort.

NOTE: To operate the reverse function on this fan, press the reverse button while the fan is running.

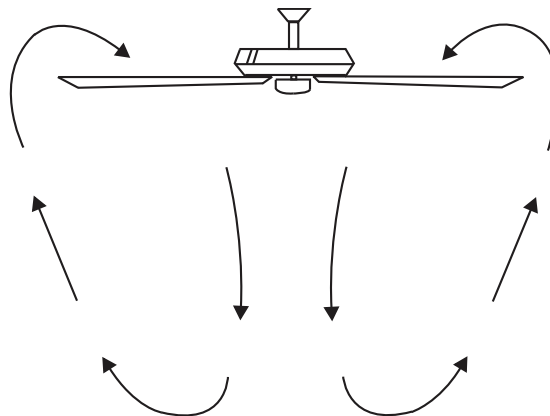

Fig. 31

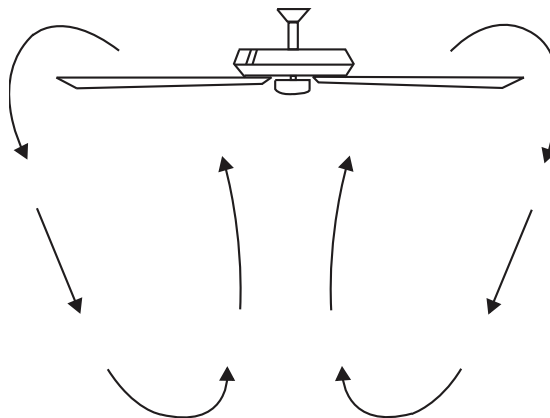

Fig. 32

TROUBLESHOOTING

| Problem | Solution |
|-----------------------------|---|
| Fan will not start. | <div><div><div>1.</div><div>Check circuit fuses or breakers.</div></div><div><div>2.</div><div>Check all electrical connections to ensure proper contact.</div></div></div> <div>CAUTION: Make sure the main power is OFF when checking any electrical connection.</div> |
| Fan sounds noisy. | <div><div><div>1.</div><div>Make sure all motor housing screws are snug.</div></div><div><div>2.</div><div>Make sure the screws that attach the fan blade brackets to the motor are tight.</div></div><div><div>3.</div><div>Make sure wire nut connections are not rubbing against each other or the interior wall of the switch housing.</div></div></div> <div>CAUTION: Make sure main power is off.</div> <div><div><div>4.</div><div>Allow a 24-hour “breaking-in period. Most noise associated with a new fan disappears during this time.</div></div><div><div>5.</div><div>If using an optional light kit, make sure the screws securing the glassware are tight. Make sure the light bulbs are not touching any other component.</div></div><div><div>6.</div><div>Do not connect this fan to wall mounted variable speed control(s). They are not compatible with ceiling fan motors or remote controls.</div></div><div><div>7.</div><div>Make sure the upper canopy is a short distance from the ceiling. It should not touch the ceiling.</div></div></div> |
| Fan wobbles. | <div><div><div>1.</div><div>Check that all blade and blade arm screws are secure.</div></div><div><div>2.</div><div>Most fan wobbling problems are caused when blade levels are unequal. Check this level by selecting a point on the ceiling above the tip of one of the blades. Measure this distance. Rotate the fan until the next blade is positioned for measurement. Repeat for each blade. The distance deviation should be equal within 1/8”.</div></div><div><div>3.</div><div>If the blade wobble is still noticeable, interchanging two adjacent (side by side) blades can redistribute the weight and possibly result in smoother operation.</div></div></div> |
| Remote control malfunction. | <div><div><div>1.</div><div>Ceiling fans with remote control systems CAN NOT be operated in conjunction with any other control system EXCEPT a basic On/Off wall switch, if desired.</div></div></div> |

FCC INFORMATION

This device complies with part 15 of the FCC Rules. Operation is subject to the following two conditions:

- 1) This device may not cause harmful interference, and
- 2) This device must accept any interference received, including interference that may cause undesired operation.

Note: This equipment has been tested and found to comply with the limits for a Class B digital device, pursuant to part 15 of the FCC Rules. These limits are designed to provide reasonable protection against harmful interference in a residential installation. This equipment generates, uses and can radiate radio frequency energy and, if not installed and used in accordance with the instructions, may cause harmful interference to radio communications. However, there is no guarantee that interference will not occur in a particular installation. If this equipment does cause harmful interference to radio or television reception, which can be determined by turning the equipment off and on, the user is encouraged to try to correct the interference by one or more of the following measures:

- Reorient or relocate the receiving antenna.
- Increase the separation between the equipment and receiver.
- Connect the equipment into an outlet on a circuit different from that to which the receiver is connected.
- Consult the dealer or an experienced radio/TV technician for help.

Changes or modifications not expressly approved by the party responsible for compliance could void your authority to operate the equipment.

KICHLER®

www.kichler.com

KICHLER® LIGHTING LLC

30455 SOLON ROAD

SOLON, OHIO 44139

CUSTOMER SERVICE 866.558.5706

8:00 AM TO 5:00 PM EST, MONDAY - FRIDAY