



Excellence in Compliance Testing

Certification Exhibit

FCC ID: YNE-12357

FCC Rule Part: 15.249

ACS Report Number: 10-0107.W03.11.A

Manufacturer: Kichler Lighting
Model: 12357BK, 12357WH

Label Information

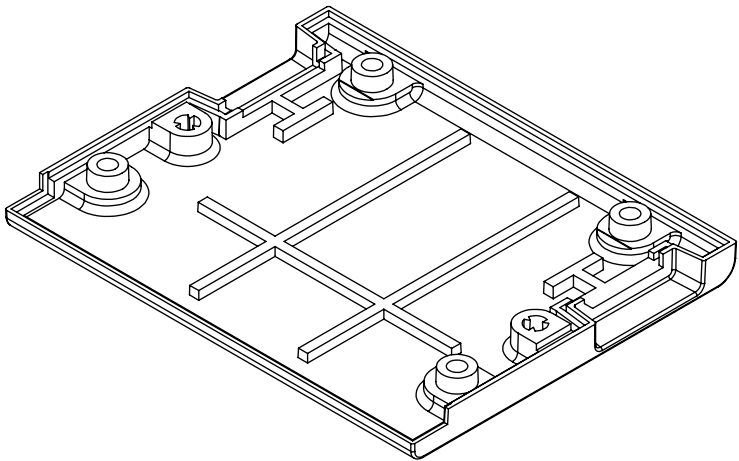

- NOTES:
- 1. MATERIAL:POLYCARBONATE
TEIJIN L-1225Y, UL FILE NUMBER E50075
 - 2. COLOR: FOR PL114331BK COLOR IS BLACK
FOR PL114331WH COLOR IS WHITE
 - 3. WALL THICKNESS .070 [1.7]
 - 4. DRAFT: 0.5°
 - 5. FINISHES: COSMETIC SURFACE: MOLD-TECH MT 11000 (0.0004" DEEP)
 - 6. SEE 3D CAD FILE FOR DIMENSIONS NOT SHOWN
AND TOOL BUILD INFORMATION.
 - 7. THIS COMPONENT IS TO BE RoHS COMPLIANT.

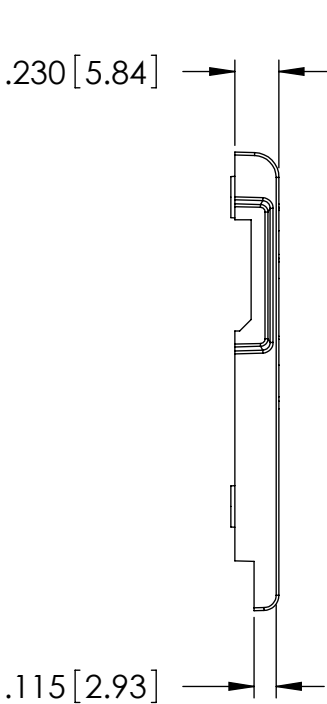
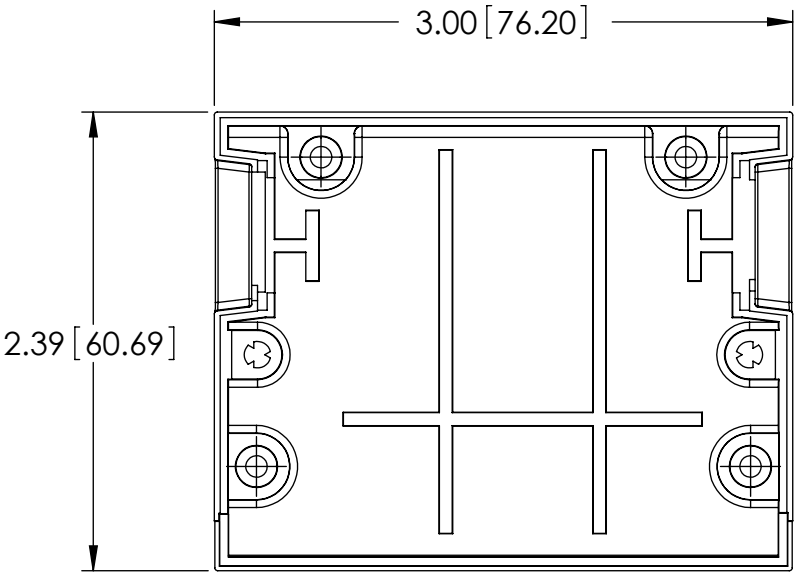

SCREEN PRINT MARKINGS
FOR PL114331BK PRINT COLOR WHITE
FOR PL114331WH RPINT COLOR BLACK

FONT: ARIAL, BOLD
CHARACTER HEIGHT: .093"

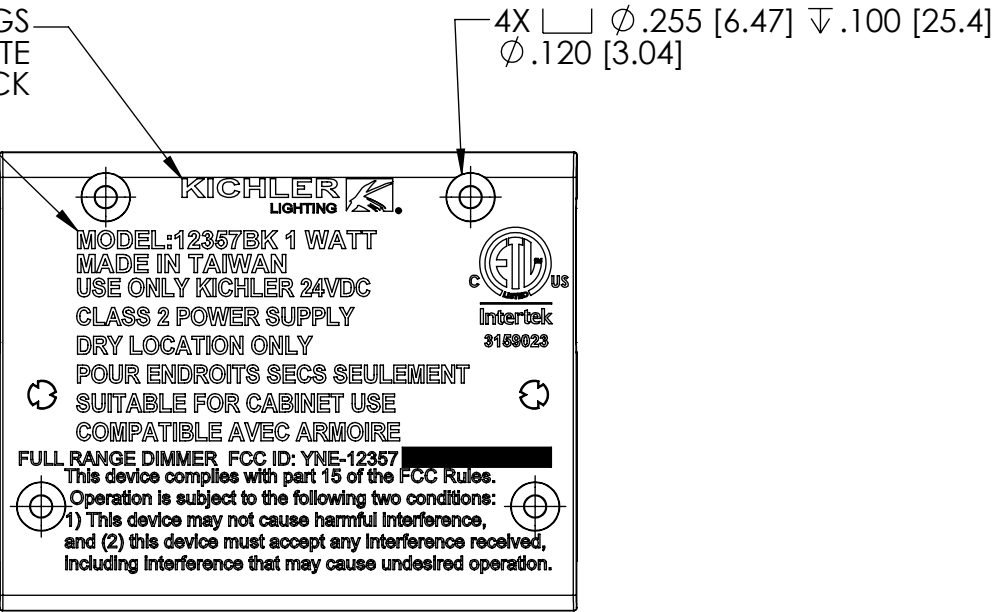

NOTICE: ANY DESIGN OR OTHER INFORMATION HEREON DEVELOPED BY THIS COMPANY IS CONFIDENTIAL MATERIAL AND EXCLUSIVE PROPERTY OF THE L.D. KICHLER CO. DISCLOSURE OR REPRODUCTION REQUIRES THE WRITTEN CONSENT OF THE L.D. KICHLER CO.

ENG

K

TITLE - B

HOUSING LOWER

EXP NO. REV.

PART NO. **PL114331BK/WH** REV. **A**

D					
C					
B					
A	RELEASED FOR PRODUCTION	5/24/10	LP	LP	
REV	REVISION RECORD	DATE	REV BY	CHK BY	ECO

DRAWN IN THIRD ANGLE PROJECTION	"mm" DIMENSION INDICATED IN [] DIMENSION IN [] OR () IS FOR REF. ONLY				
	TOLERANCES (EXCEPT AS NOTED)				
	DECIMAL	ANGULAR	FRACTIONAL	SCALE	
	NONE ±.031 .X ±.015 .XX ±.010 .XXX ±.005	± 1/2° DATE 3/8/10	± 1/32 DRAWN BY TJT	CHECKED BY LP	APPROVED BY LP

xx DENOTES A INSPECTION ITEM

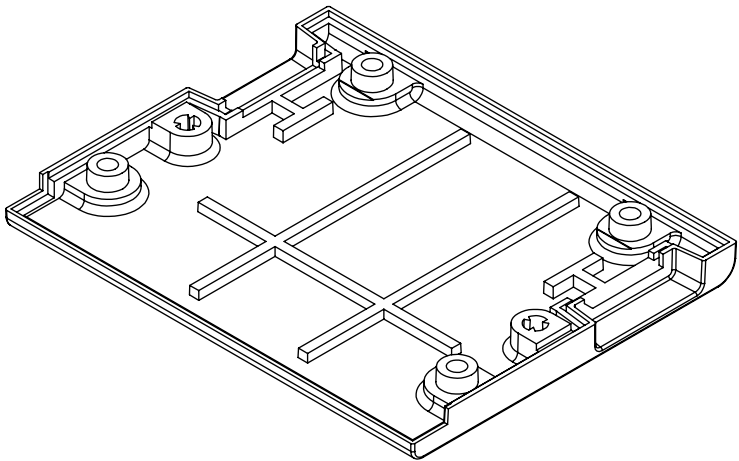

- NOTES:
1. MATERIAL:POLYCARBONATE
TEIJIN L-1225Y, UL FILE NUMBER E50075
 2. COLOR: FOR PL114331BK COLOR IS BLACK
FOR PL114331WH COLOR IS WHITE
 3. WALL THICKNESS .070 [1.7]
 4. DRAFT: 0.5°
 5. FINISHES: COSMETIC SURFACE: MOLD-TECH MT 11000 (0.0004" DEEP)
 6. SEE 3D CAD FILE FOR DIMENSIONS NOT SHOWN
AND TOOL BUILD INFORMATION.
 7. THIS COMPONENT IS TO BE RoHS COMPLIANT.

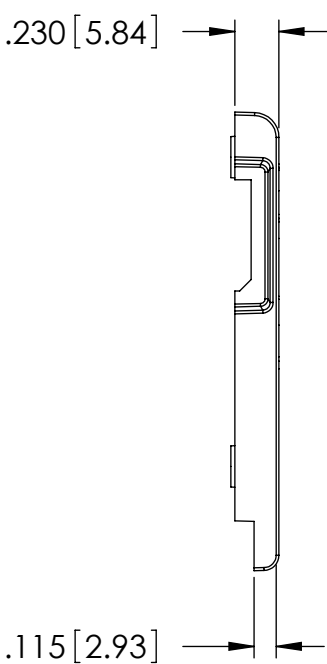
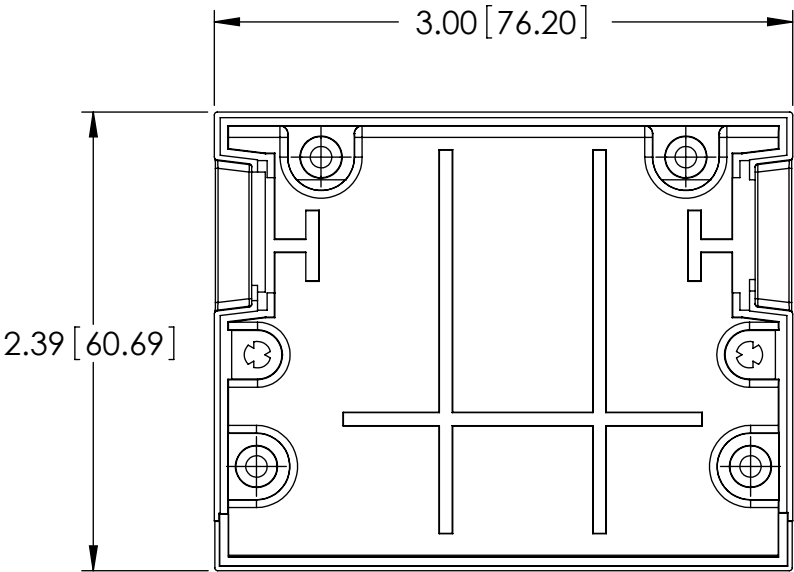

SCREEN PRINT MARKINGS
FOR PL114331BK PRINT COLOR WHITE
FOR PL114331WH RPINT COLOR BLACK

FONT: ARIAL, BOLD
CHARACTER HEIGHT: .093"

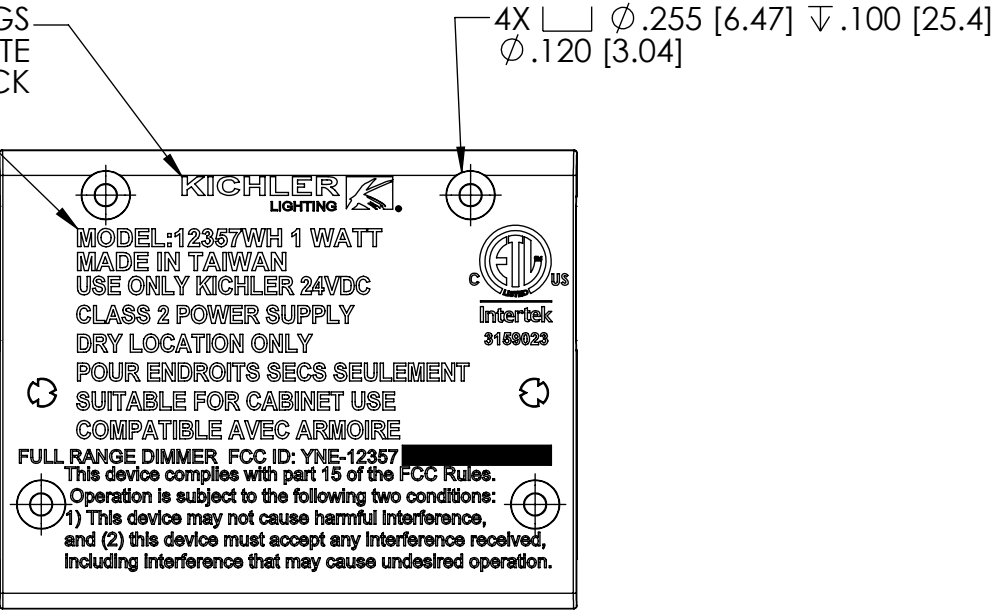

NOTICE: ANY DESIGN OR OTHER INFORMATION HEREON DEVELOPED BY THIS COMPANY IS CONFIDENTIAL MATERIAL AND EXCLUSIVE PROPERTY OF THE L.D. KICHLER CO. DISCLOSURE OR REPRODUCTION REQUIRES THE WRITTEN CONSENT OF THE L.D. KICHLER CO.



©

TITLE - B	
HOUSING LOWER	
EXP NO.	REV.
PART NO. PL114331BK/WH	REV. A

D					
C					
B					
A	RELEASED FOR PRODUCTION	5/24/10	LP	LP	
REV	REVISION RECORD	DATE	REV BY	CHK BY	ECO



"mm" DIMENSION INDICATED IN [] DIMENSION IN [] OR () IS FOR REF. ONLY					
TOLERANCES (EXCEPT AS NOTED)					
DECIMAL	ANGULAR	FRACTIONAL	SCALE		
NONE ±.031	± 1/2°	± 1/32	FULL		
.X ±.015	DATE 3/8/10	DRAWN BY TJT	CHECKED BY LP	APPROVED BY LP	
.XX ±.010					
.XXX ±.005					



DENOTES A INSPECTION ITEM

ENG