

3. Air massage

- Touch the (Air Massage) icon and the screen will turn to the according page.
- There are 4 programs to select from.
- Select the program you prefer to start the massage.
- There are 5 different levels of air intensity available for adjustment.

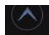

4. Position

- Users can adjust the reclination of the backrest and the footrest by touching the icon  .
When you think that is the position you want, then touch the icon again to stop the adjustment.
- The button of the legrest allows you to extend or retract the length of the legrest.
- Touch the (Zero Gravity) icon to adjust the chair's zero-gravity position. Press the button again to return to the original position.
- Touch the (LED) icon to control the light under the side panels.
Touch the (Home) icon to return the chair to its original position.

NOTE:

The (Zero Gravity) icon is NOT controllable in the massage programs with angle adjustment. And when you touch the (Home) icon and during the process when the chair starts to return to the original position, you can still experience all the auto massage programs except the (Swing) and the (Stretch) massage modes. Once you are at the original position, you can use these two modes again.

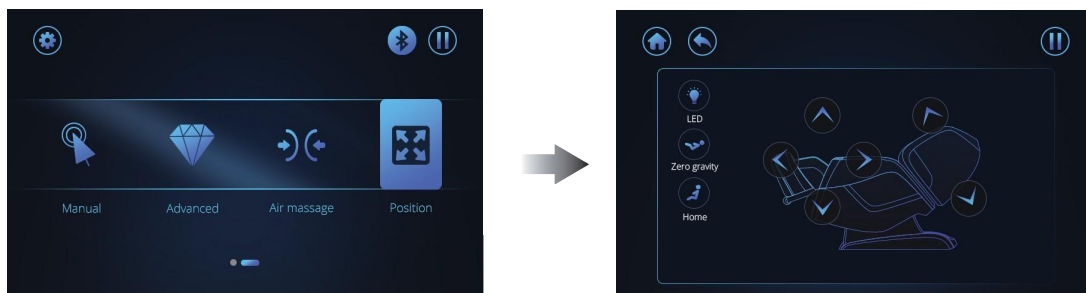

5. Neck/ Shoulder

- Touch this icon, the screen will turn to the page of (Neck/ Shoulder) .
- There are 4 auto massage programs. Press any one of these 4 programs, the chair will automatically perform a shoulder high scanning. And the screen will turn to the (Shoulder Scanning) mode.
- When the (Shoulder Scanning) starts, it will turn to another page showing that you need to lean back against the chair, and hold the body pain sensor making sure all the testing points are covered, and last press the button to start detection.
- Make your palm press against the electro plate and do not move away from the plate until it finally shows your health pro over your back area.
- There are two extents of your health pro, fatigue extent and ache extent. And it will also show what extent of your health pro, light, medium or heavy. The chair will generate massage programs automatically according to your health pro scanning status.

NOTE:

- In order to scan your health pro and know how your back area feels, you should keep pressing against the electro plate of the body pain detector or it will stop scanning.



6. Lower Back

- Touch the icon, the screen will turn to the corresponding (Lower Back) page.
- There are 4 auto massage programs. Select any one to start massage.



7. Auto

- Touch this icon, the screen will turn to the (Auto) page.
- There are 8 auto massage programs. Select one of them to start the massage.

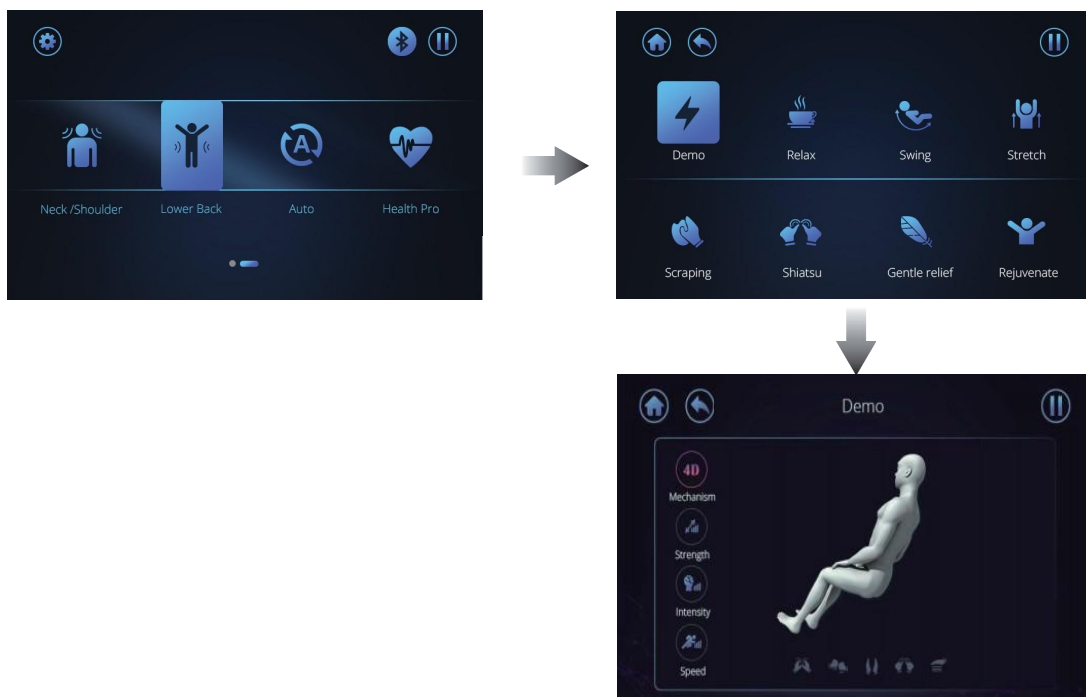

8. Health Pro

- Touch the (Health Pro) icon and the screen will turn to the next page showing you how to detect your health pro.
- You need to lean back and hold the body against the pain sensors to make sure all the testing points are covered. Press the button to start detection.
- It tells that you should make your palm press against the electro plate and do not move away from the plate until it finally shows your health pro over your back area.
- There are two extents of your health pro, fatigue extent and ache extent. And it will also show what extent of your health pro, light, medium or heavy. The chair will generate massage programs automatically according to your health pro scanning status.

NOTE:

- In order to use health pro properly to scan your body, you must lean against and make good contact with the electro plates of the body pain detector or it will stop and scanning will fail.



9. Settings

- Touch the  icon on the top left corner, the screen will change to the (Setting) menu.
- Users can select language, touch volume, screen sleep and screen brightness in this page.
For language, users can select English or Chinese by their own.
For touch volume, users can slide it from the left to the right to adjust the screen touch volume.
For screen sleep, users can select time for the screen sleep with their preferation.
For screen brightness, users can adjust it by sliding the button from the left to the right as they like.

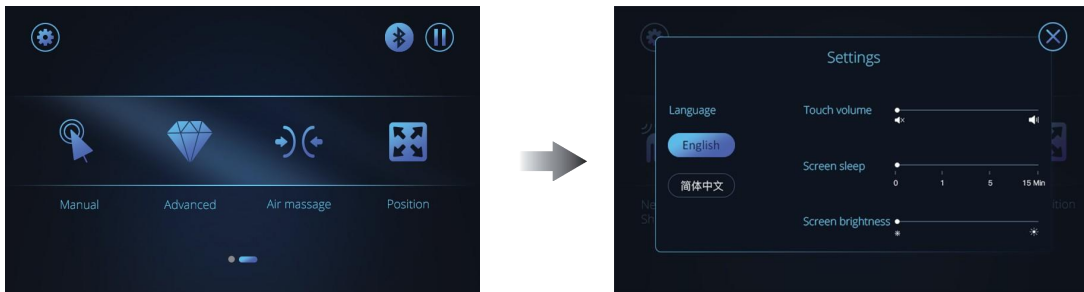

10. Bluetooth

- Touch the  icon to control the Bluetooth. When you press it and find the icon lighting up, that means the Bluetooth of the chair has been turned on and you can connect the Bluetooth by your phone. Also, you can touch the icon again to turn the Bluetooth off.

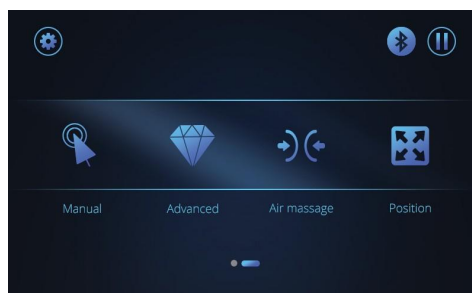

NOTE:

Sometimes, you will find a warning sign shown like below. That means a foreign subject is preventing the footrest from functioning properly. And users should remove the obstruction and then press "OK" to continue to massage.

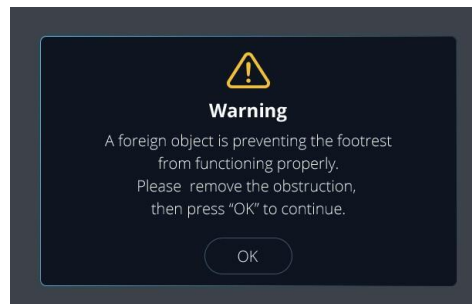

Voice control

- Make sure the plug is fully inserted and turn on the chair, then you can use the chair by voice control.
- When you make the commands as what it shows in the form (See in the next page), the chair will react accordingly.

Command	Reaction
"Hi Osaki Pro"	I am here
Power off	Sure, I hope you enjoyed your massage
End Massage	
Pause Massage	Your session is on hold
Higher	As you wish
Raise Up	
Lower	I have reached the maximum angle
Put Down	
Increase Strength	Sure, increasing intensity
Stronger	I have reached my maximum strength
Decrease Strength	Alright, adjusting for you
Too strong	Sorry, I am unable to go any lighter
Give me a massage	Sure, I recommend the xxx for you. (1. Demo 2. Relax 3. Swing 4. Stretch 5. Scraping 6. Shiatsu 7. Gentle relief 8. Rejuvenate 9. Neck and Shoulder 10. Upper back 11. Lower Back 12. Full Back)
I need a Massage	
Massage	
Start Massage	
Change program	Sure, I recommend the xxx for you. (1. Demo 2. Relax 3. Swing 4. Stretch 5. Scraping 6. Shiatsu 7. Gentle relief 8. Rejuvenate 9. Neck and Shoulder 10. Upper back 11. Lower Back 12. Full Back)
Change Massage	
Neck Massage please	Alright, right away
My Neck hurts	
Massage my neck	
Neck Massage	
I need a neck massage	
Shoulder Massage please	Okay, let me help you out
My shoulder hurts	
Massage my shoulders	
I need a shoulder massage	
Shoulder Massage	

Command	Reaction
Back massage please	Alright, right away
My back hurts	
Massage my back	
I need a Back Massage	
Back massage	
Waist massage please	Sure, at once
My waist hurts	
Massage my waist	
I need a waist Massage	
Hip massage please	
Massage my buttock	
My Hip hurts	
Massage my buttocks	
Hip massage	
Buttock massage	Okay, let me help you out
Knee massage please	
My Knee hurts	
Massage my knees	
I need a knee Massage	
Knee massage	Okay, let me give you a good stretch
I need a stretch	
Help me stretch	Let me give you a foot massage
Foot massage please	
My feet hurts	
Massage my feet	
I need a foot Massage	
Foot massage	Sure, right away
Leg massage please	
My leg hurts	
Massage my legs	
I need a leg Massage	
Leg massage	Okay, let me help you out
Hand massage please	
My hand hurts	
Massage my hands	
I need a hand Massage	
Hand massage	Okay, turning off Back Heater
Switch off Back Heater	
Turn off Back Heater	

Command	Reaction
Switch on Back Heater	Turning on Back Heater
Turn on Back Heater	
Increase the volume; Louder	Okay, increasing the volume; Sorry, I can't go any louder
Too loud; Decrease the volume	Okay, decreasing the volume; I am at my lowest volume

App control

- Install the app through below QR code. It is available for both IOS and Google shop.
- Make sure the plug is fully inserted and turn on the chair.
- Enjoy and explore your massage chair with application.



Control Buttons on the side panel

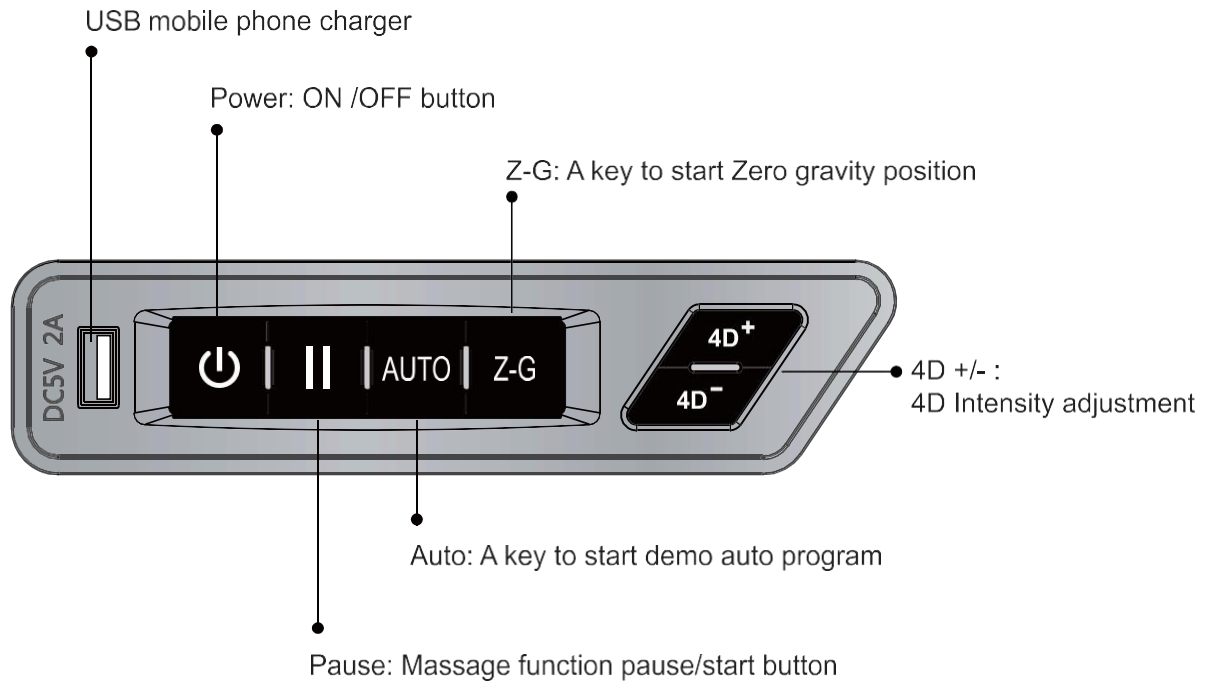

After massage

- 1 Turn off the power switch on the controller.
- 2 Pull the power switch to "O" position.
- 3 Pull out the power plug.



Warning

- **After using, it is recommended to put the power switch to the OFF position and pull out the power plug;**
Otherwise accidents and injuries by playing with them by children may happen.

Cleaning and maintenance

Cleaning of the synthetic leather

Wipe the synthetic leather with a soft dry cloth.

- Do not clean the product with solutions containing chemicals such as thinners, gasoline and alcohol.
- Be sure that leather cleaner will not harm the synthetic leather by reading the label.
- If the synthetic leather is very dirty, wipe it with the method below.
 - ① Wet a soft cloth into water or 3% to 5% neutral detergent containing hot water and wring it out.
 - ② Be sure the soft cloth is well wrung out till there is NO water dripping from the cloth.
 - ③ Wipe surface of the synthetic leather with the soft cloth.
 - ④ Be sure to rinse out the cloth multiple times when wiping down.
 - ⑤ Have the synthetic leather dry naturally. Do not use dryer.
- If it is difficult to remove the stains on the synthetic leather, try soak a piece of melamine foam into a neutral detergent to wipe down several times.
- Do not dry the surface by a hair dryer.
- Surface of the synthetic leather may fade or discolor if an inappropriate detergent is used. Test the cleaning solution in small section prior to fully applying.
- Do not clean the hard plastic parts with any alcohol, thinner or benzene based agents. This may cause discoloring or removal of the color all together.



Cleaning of the plastic parts

1 Put a piece of soft cloth into water mixed with a neutral detergent contained hot water, wring it out and wipe the plastic parts.

- Do not clean the product with chemicals such as thinners, gasoline and alcohol.

2 Wipe down with a microfiber or soft cloth wrung out in clean water.

- Be sure the cloth is well wrung out with no water dripping, leaving the cloth damp.

3 Have the plastic parts dry naturally.



Questions and answers (Q&A)

Q Can someone with a medical condition or disease use this product?

A They must consult with their physicians before using the product.

Massage can aggravate or worsen muscle injuries, bone disease, spinal abnormalities, skin disease and kill ones with medical devices implanted in their body.

Q Is there a restriction body height and weight to use this chair?

A The recommended min. height is 4'9" with a max. height of 6'4". The max. weight capacity is 260 lbs.

If the user is shorter or taller than the height range, They will not fit comfortably in the chair and may even cause injury. The maximum weight limit must be followed to avoid damaging the chair and also possibly seriously injuring yourself while using the device. The limits are in place for the users safety.

For a taller person with knee bending when using the product:

Tilt the backrest and lower the Lower Leg/Foot massager to the down position, elongating the length from top to bottom.

For a short person difficult to touch the foot massage section:

Raise the backrest and raise the legrest to shorten the distance from the top to bottom.

Q Where is serial number of the product?

A It is located at behind the backrest at the back of the chair by the power cord.



Q When I use the chair it makes noise .

A It is part of the normal function of the chair.

The chair is equipped with an air pump and multiple motors. The sounds are part of chair when being operated.

Q How long should I use the massage chair each day?

A 20 minutes per day with no medical conditions.

For the 1st week of using the chair, use only for 20 minutes at most assuming the user is in good medical condition. If there is any discomfort stop using and consult with your doctor. The first few days of using you may experience mild soreness. Be sure to monitor the pain levels and if the soreness does no diminish after the following day consult with your doctor before using again.

BE SURE TO DRINK PLENTY OF WATER AFTER EACH MASSAGE.

Troubleshooting

If an issue occurs, inspect and trouble shoot according to the corresponding method below.

If the problem is not solved, contact the manufacturer for further instructions or service.

Fault	Cause and elimination method
<p>The massage wheels stop during use (The product beeps and all icons and buttons on the remote controller flicker and then go out.)</p>	<p><u>As a safety protocol the massage heads will stop if pressure/weight load has exceeded its limit.</u></p> <p>To avoid potentially over heating or damaging the massage mechanism the chair is designed to automatically shut off if over strained or over heated. The remote will flash a few times and then shut off as a safety measure. If this has occurred turn off the power switch from the back, allow for 30 sec. And power back on. If the weight capacity of 260 lbs is not exceeded, unplug from the outlet and notify the manufacturer.</p>
<p>The product cannot tilt, or the footrest cannot be raised or lowered (The product beeps, the running light on the remote controller go out and the product stops)</p>	<p><u>This product will stop upon any obstruction or a too large of a force preventing from operating.</u></p> <p>If all screen and buttons are flickering and the backrest or the footrest has stopped, turn off the power supply and turn back on 10 seconds. Be sure there are no obstructions in the way of the footrest or the backrest rolling mechanism.</p>
<p>The massage wheels cannot reach the shoulders or the neck</p>	<p>If your head is not properly placed against the backrest during the computer body scan, it may result in an incorrect reading, causing the rollers to start a lower position causing the massage to be inaccurate. If this occurs turn off the power from the remote and start over again to get a proper reading.</p>
<p>The left and right massage wheels have different heights (intensities)</p>	<p>This is a normal function of the massage mechanism as it programmed to massage alternating locations from the right side during certain intervals of the program.</p>
<p>The chair is not functioning (massaging).</p> <ul style="list-style-type: none"> ● Upper body (the neck to the waist) massage ● Lower leg/foot massage 	<ul style="list-style-type: none"> ● The power line is disconnected. ● The power switch is not turned on. ● If no program is selected after turning, the chair will pause and shut down. Turn off and restart.
<p>The roller heads are still warm after turning off the heat. Or the product is damaged.</p>	<ul style="list-style-type: none"> ● Because the roller heads heat up it will take some time for the residual heat to dissipate. ● If the massage heads are mildly warm, the rollers may be admitting heat created by the friction from the massage.
<p>The power line or the power plug is abnormally warm to hot.</p>	<p>To avoid accidents, contact an authorized service center.</p>

If above solutions are not applicable, kindly refer to "Product Warranty Card" and contact service center.

Troubleshooting (Continued)

Expected sounds and feelings when using the massage chair.

You will hear or have the following feelings when using the product. These are not defective indicators but a normal function of the chair.

- When chair extends or retracts you will hear gears moving and clicking.
- A rubbing sound will be mildly heard when the massage heads are activated.
- When the massage heads are tapping you may hear a mild clicking sound.
- Friction sounds will be experienced as the rollers are activated.
- As the rollers move up and down the motor produces a sound.
- As the rollers are activated you will hear spinning of belts rotating.
- Motor sounds will be experienced.
- As the massage heads are squeezing, a mild squeaking sound will be heard.
- When sitting in the chair as the roller heads are tapping and rolling a mild squeaking sound may be produced from the joints.
- Common joints that may squeak would be from the side panels.
- Friction sound between the massage wheels and the fabric.
- Motors will be heard from the pump when the airbags deflate.
- While the airbags are activated you will hear air valves alternating. When the legrest is moving, you will hear mild squeak and a motor operating.



If the sound is loud, it is also possible that the product has failed.

- In this case, have the product inspected and repaired by an authorized service center.

Warning

- **Do not refit, disassemble or repair the product without permission.** Otherwise fires, abnormal movements or personal injuries may happen.

Warning

- **In the case of any abnormality or fault, stop the product immediately and pull out the power plug to avoid fuming, fires and electric shocks.**

<Abnormality and fault example>

- The product fails to work after the power switch is turned to the ON position;
 - When the power cable is moved the chair will turn off and on.
 - In use, the product gives off a burning smell or an abnormal sound;
- The product upholstery is deformed or abnormally hot.

If any of these symptoms occur, have the product inspected and repaired by an authorized service center immediately.

Specifications

Product name		Osaki Maestro LE 2.0
Rated Voltage		110 -120V 60Hz
Current		1.5A
Working time		15min
Guide		L Shape 52.8"
4D Massage Roller	Forward arc distance	7 Levels Approx 4.96"
	Speed	5 levels
Airbag		5 levels
Angle Adjustment		Approx 128° - 155° (Ground Angle)
	Footrest	Approx 9° - 75° (Wall Angle)
size	Upright	61.1" × 31.9" × 48.1"
		79.5" × 31.9" × 46.9"
Extension of Footrest		Approx 7.1"
Dimensions of Packing (L*W*H)		BOX 1: 58.5" × 30.7" × 41.7" BOX 2: 43.5" × 14.2" × 30.7" BOX 3: 23.2" × 20.1" × 21.7"
N.W./ G.W.		BOX 1: 163.1lbs/204.1lbs BOX 2: 37.5lbs/46.3lbs BOX 3: 46.3lbs/52.9lbs
Weight of Chair		Approx 246.96lbs
Usage Condition		Environment temperature : "32°F~95°F" Contrasting humidity : "20-80RH"
Storage Condition		Storage temperature : "23°F~95°F" Storage humidity : "20-80RH"
Maximum body weight of user		260 lbs



FCC Radiation Exposure Statement

FCC Radiation Exposure Statement: (mobile device)

This equipment complies with FCC radiation exposure limits set forth for an uncontrolled environment. In order to avoid the possibility of exceeding the FCC radio frequency exposure limits, Human proximity to the antenna shall not be less than 20cm (8 inches) during normal operation.

FCC STATEMENT

1. This device complies with Part 15 of the FCC Rules. Operation is subject to the following two conditions:

- (1) This device may not cause harmful interference, and
- (2) This device must accept any interference received, including interference that may cause undesired operation.

2. Changes or modifications not expressly approved by the party responsible for compliance could void the user's authority to operate the equipment.

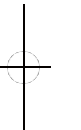
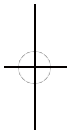

This equipment has been tested and found to comply with the limits for a Class B digital device, pursuant to part 15 of the FCC Rules. These limits are designed to provide reasonable protection against harmful interference in a residential installation. This equipment generates, uses and can radiate radio frequency energy and, if not installed and used in accordance with the instructions, may cause harmful interference to radio communications. However, there is no guarantee that interference will not occur in a particular installation. If this equipment does cause harmful interference to radio or television reception, which can be determined by turning the equipment off and on, the user is encouraged to try to correct the interference by one or more of the following measures:

- Reorient or relocate the receiving antenna.
- Increase the separation between the equipment and receiver.
- Connect the equipment into an outlet on a circuit different from that to which the receiver is connected.
- Consult the dealer or an experienced radio/ TV technician for help.

This equipment should be installed and operated with minimum distance 20cm between the radiator & your body.



ISED Statement

English: This device contains licence-exempt transmitter(s)/receiver(s) that comply with Innovation, Science and Economic Development Canada's licence-exempt RSS(s).

Operation is subject to the following two conditions:

- (1) This device may not cause interference.
- (2) This device must accept any interference, including interference that may cause undesired operation of the device.

The digital apparatus complies with Canadian CAN ICES-3 (B)/NMB-3(B).

French: Cet appareil contient des émetteurs/récepteurs exempts de licence qui sont conformes aux RSS exemptés de licence d'Innovation, Sciences et Développement économique Canada.

L'exploitation est soumise aux deux conditions suivantes :

- (1) Cet appareil ne doit pas provoquer d'interférences.
- (2) Cet appareil doit accepter toute interférence, y compris les interférences susceptibles de provoquer un fonctionnement indésirable de l'appareil.

L'appareil numérique du ciem conforme canadien peut - 3 (b) / nmb - 3 (b).

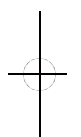
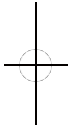

This device meets the exemption from the routine evaluation limits in section 2.5 of RSS 102 and compliance with RSS 102 RF exposure, users can obtain Canadian information on RF exposure and compliance.

cet appareil est conforme à l'exemption des limites d'évaluation courante dans la section 2.5 du cnr - 102 et conformité avec rss 102 de l'exposition aux rf, les utilisateurs peuvent obtenir des données canadiennes sur l'exposition aux champs rf et la conformité.

This equipment complies with Canada radiation exposure limits set forth for an uncontrolled environment.

Cet équipement est conforme aux limites d'exposition aux rayonnements du Canada établies pour un environnement non contrôlé.

RF Exposure Statement

The device has been evaluated to meet general RF exposure requirement. The device can be used in portable exposure condition without restriction.

L'appareil a été évalué pour répondre aux exigences générales d'exposition aux radiofréquences.

L'appareil peut être utilisé en condition d'exposition portable sans restriction.

This equipment should be installed and operated with minimum distance 10cm between the radiator & your body.

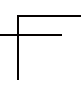
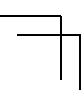

Cet équipement doit être installé et utilisé à une distance minimale de 10cm entre le radiateur et votre corps.

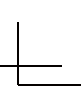
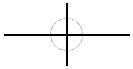
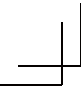

This device contains licence-exempt transmitter(s)/receiver(s) that comply with Innovation, Science and Economic Development Canada's licence-exempt RSS(s). Operation is subject to the following two conditions:

1. This device may not cause interference.
2. This device must accept any interference, including interference that may cause undesired operation of the device.

Cet appareil contient des émetteurs/récepteurs exempts de licence qui sont conformes aux RSS sans licence d'Innovation, Sciences et Développement économique Canada.

L'exploitation est soumise aux deux conditions suivantes :

1. Cet appareil ne doit pas provoquer d'interférences.
2. Cet appareil doit accepter toute interférence, y compris les interférences qui peut entraîner un fonctionnement indésirable de l'appareil.

HVIN:EC-806R, Osaki - 4D Maestro LE 2.0

