

# DUAL LANE POLICE CHASE

CONTAINS LED LIGHTS

Ages 3 to Adult

NEON GLOW  
**TWISTER TRACKS™**  
DUAL LANE



LEAVES GLOW IN THE DARK TRACERS!

EXCITING SIDE-BY-SIDE R/C RACING

ENDLESS TRACK COMBINATIONS!

MINDSCOPE PRODUCTS™

SET INCLUDES:  
1 Light Up LED Police Car  
1 Light Up LED Race Car  
2x Remote Controls (27 MHz + 49MHz)  
11 Feet of Dual Lane Track (220 Pieces)  
22 feet of side by side track

NEON GLOW  
**TWISTER TRACKS™**  
DUAL LANE



Flexible Assembly Track System



Side-By-Side Racing



Hands On Construction

**POLICE CHASE**

changes or modifications not expressly approved by the party responsible for compliance could void the user's authority to operate the equipment.

This equipment has been tested and found to comply with the limits for a Class B digital device, pursuant to Part 15 of the FCC Rules. These limits are designed to provide reasonable protection against harmful interference in a residential installation. This equipment generates, uses and can radiate radio frequency energy and, if not installed and used in accordance with the instructions, may cause harmful interference to radio communications. However, there is no guarantee that interference will not occur in a particular installation. If this equipment does cause harmful interference to radio or television reception, which can be determined by turning the equipment off and on, the user is encouraged to try to correct the interference by one or more of the following measures:

- Reorient or relocate the receiving antenna.
- Increase the separation between the equipment and receiver.
- Connect the equipment into an outlet on a circuit different from that to which the receiver is connected.
- Consult the dealer or an experienced radio/TV technician for help.

**POLICE CHASE**

NEON GLOW  
**TWISTER TRACKS™**  
DUAL LANE POLICE CHASE

INCLUDES 11 FT. OF DUAL LANE NEON GLOW TRACK



FLEXIBLE AND BENDABLE!

ENDLESS TRACK COMBINATIONS!

EXCITING SIDE-BY-SIDE R/C RACING

- 11 ft (220 Pieces) of Neon Glow Flexible Dual Lane Track
- Includes 2 Radio Controlled Vehicles (1 Police Car & 1 Race Car)
- Includes 2 Compatibility Piece
- Black lights on vehicles leave GLOW TRACERS
- Remote Controls can change light patterns
- Compatible with Twister Tracks
- Patent Pending

COMPATIBLE WITH TWISTER TRACK SETS

Original TWISTER TRACKS  
360 LASER

CONTAINS LED LIGHTS  
226 Pieces Total  
Ages 3 to Adult

Includes:

- x 2 Radio Controls
- x 2 Light Up Cars (1 Police Car, 1 Race Car)
- x 2 Compatibility Piece
- x 220 Dual Lane Track Pieces (11 Ft.)

BLACK LIGHTS UNDER CAR LEAVE GLOW TRACERS!



6 03625 40609 9  
Batch #: 050118 Item #: TDL11  
Date of Manufacture: 05/01/2018  
Made in Shantou Guangdong, China  
Glendale, CA 91226  
Mindscope Products Inc PO Box 9525



Controller Batteries:  
4x 1.5 AA (Not Included)  
6x 1.5 AAA (Not Included)  
Total 10 Batteries Required

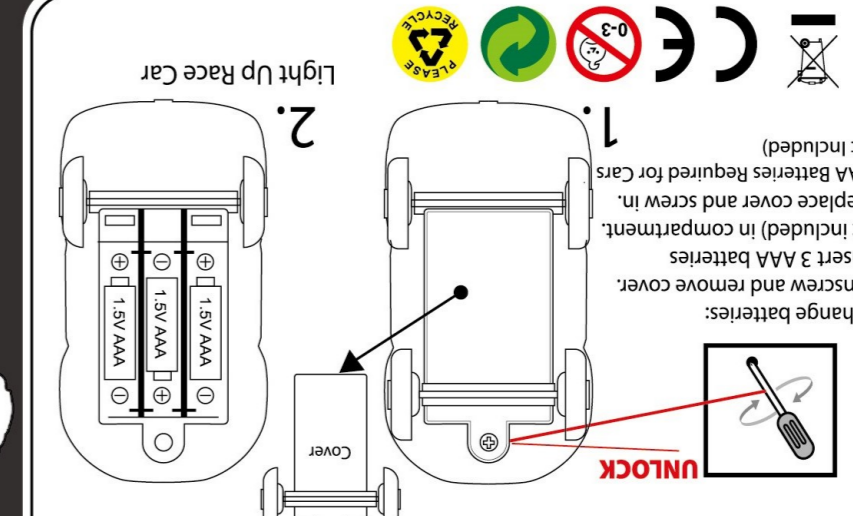
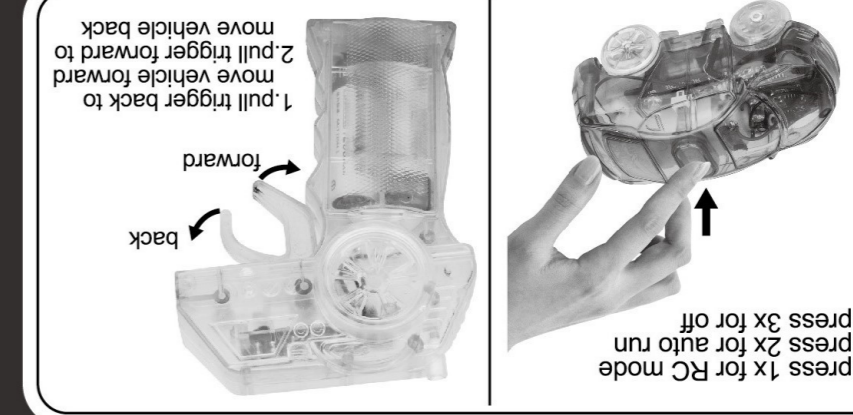

**CAUTION:**  
- Remove old batteries and replace with new batteries. Be sure to insert batteries correctly according to (+) and (-) symbols located in the battery compartment.  
- Be sure to insert batteries correctly with adult supervision and always follow the toy and battery manufacturer's instructions.  
- Do not mix old and new batteries.  
- Do not mix alkaline, standard (carbon-zinc), or rechargeable (nickel-cadmium) batteries.  
- Rechargeable batteries are not to be recharged.  
- Do not dispose of batteries in the fire.  
- Rechargeable batteries are only to be charged under adult supervision.  
- Only batteries of the same equivalent type as recommended are to be used.  
- Always remove weak or dead batteries from the product.  
- The supply terminals are not to be short-circuited.  
- Remove batteries from the product for an extended period of time.  
- For best results use alkaline batteries.  
- Remove batteries if the product will be stored for an extended period of time.  
- Please read these instructions for future reference.  
The product is protected by Intellectual Property laws of the United States including:  
U.S. Trademark Nos. 4900465, 4900465, 4900465, and 4900467 for track color and design.  
U.S. Trademark No. 4691912 for TWISTER TRACKS.  
U.S. Trademark Nos. 1-959-011, VA 1-959-008, VA 1-959-009, and VA 1-959-010.  
VA 1-959-011, VA 1-959-008, VA 1-959-009, VA 1-957-728, VA 1-956-536, VA 1-956-646, Copyright registrations numbers VA 1-959-005, VA 1-957-728, and VA 1-956-646.  
Connect with us:  
Pinterest: @mindscope  
Facebook: facebook.com/mindscopeproducts  
YouTube: youtube.com/mindscope  
PLEASE VISIT: www.mindscopeproducts.com  
The device complies with Part 15 of the FCC Rules.  
Operation is subject to the following two conditions:  
(1) This device may not cause harmful interference, and  
(2) This device must accept any interference received, including interference that may cause undesired operation.