

Quick Start Guide

Placement

The TVB2 soundbar can be fixed to a wall under your TV or placed on a stable surface in front of it.

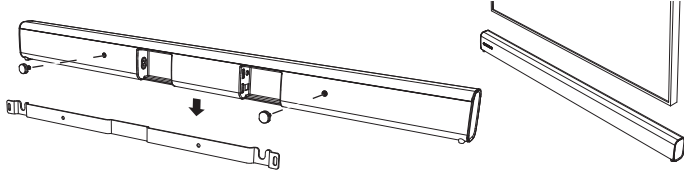

Subwoofer Connection

The wireless subwoofer will automatically connect to the TVB2 soundbar. Simply plug in the subwoofer and turn on the sound bar – initial connection will take around 20 seconds. If the TVB2 soundbar is unable to connect to the subwoofer 'NOSUB' will be shown on the display.

TV Connections

Only one audio connection to your TV is required, in order of preference:

1. HDMI Out (ARC): If your TV has a HDMI socket labelled ARC use this connection.
2. Optical: Use this as an alternative digital connection if HDMI ARC is not available on your TV.
3. AUX In: Connect to the headphone output of your TV if neither HDMI ARC or optical outputs are available on your TV.

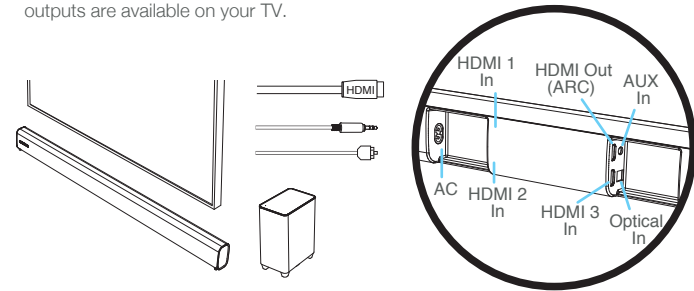

HDMI Connections.

TVB2 has three 4K compatible HDMI inputs. Connect your set-top box, Blu-ray player or other HDMI source here.

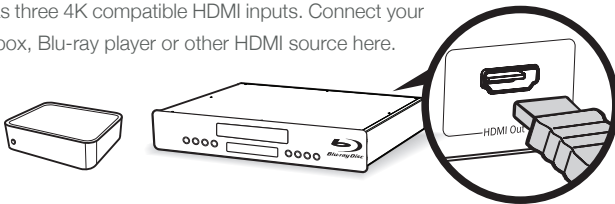

Learning your TV remote

1. To learn the Vol+ button on your TV remote, press and hold the and + button on TVB2 for 2 seconds. 'LEARN' and 'VOL +' will flash on the display. Then double press the Vol+ button on your TV remote remembering to point it at TVB2's display.
2. To learn the Vol- button on your TV remote, press and hold the and - button on TVB2 for 2 seconds. 'LEARN' and 'VOL -' will flash on the display. Then double press the Vol- button on your TV remote remembering to point it at TVB2's display.

When successfully learned, 'OK' will be shown on the display.

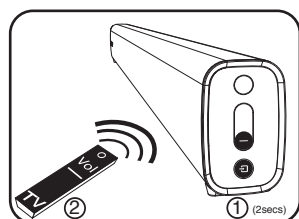
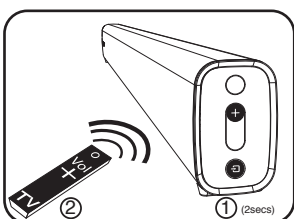

To talk to us, call +44 (0)203 514 1521 (UK Local)
or 1-877-357-8204 (USA)

Bluetooth set-up

TVB2 is equipped with Bluetooth to allow wireless playback from any Bluetooth equipped phone, tablet or computer.

1. Select the Bluetooth on the remote and will flash on the display.
2. To connect a Bluetooth device to TVB2, press and hold the button. Consult the instructions of the Bluetooth device to connect to TVB2. When successfully connected, will stop flashing.

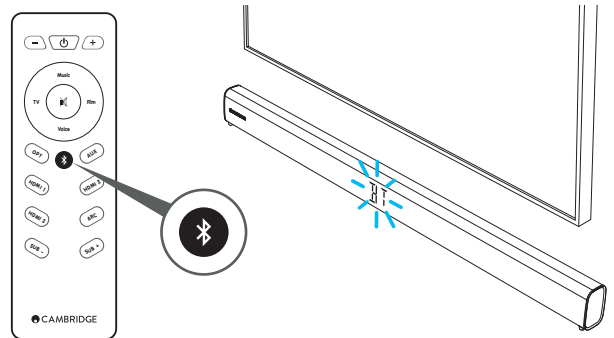

Once paired, music from your device will play through TVB2. To add another Bluetooth device, repeat from step 2. TVB2 will store up to 99 paired devices in memory.

If your Bluetooth device is NFC enabled

You may need to ensure Bluetooth is enabled on your device. Touch your NFC device against the logo on the side of TVB2. TVB2 will enter automatic pairing mode and 'TVB2 Cambridge' should appear on your device.

TOP TIPS

Auto power down

To save power, TVB2 will automatically turn off after a few seconds if no sound is playing from your TV.

Auto Power On

When you turn on your TV, TVB2 will detect the sound and automatically turn on.

Subwoofer level

You can adjust the subwoofer level to suit your preference using the SUB+/- buttons on the remote.

Sound Modes

There are 4 different modes that can be selected to enhance your sound experience.

- TV : Greatly improved TV sound
- Music : Enhances stereo music and music videos.
- Film : Designed to get the best sound from movies.
- Voice : Enhances voices to improve intelligibility.

