

WWW.CAMBRIDGEAUDIO.COM

Gallery Court, Hankey Place
London SE1 4BB
United Kingdom

Cambridge Audio is a brand of Audio Partnership Plc.
Registered in England No. 2953313

AP36043/B

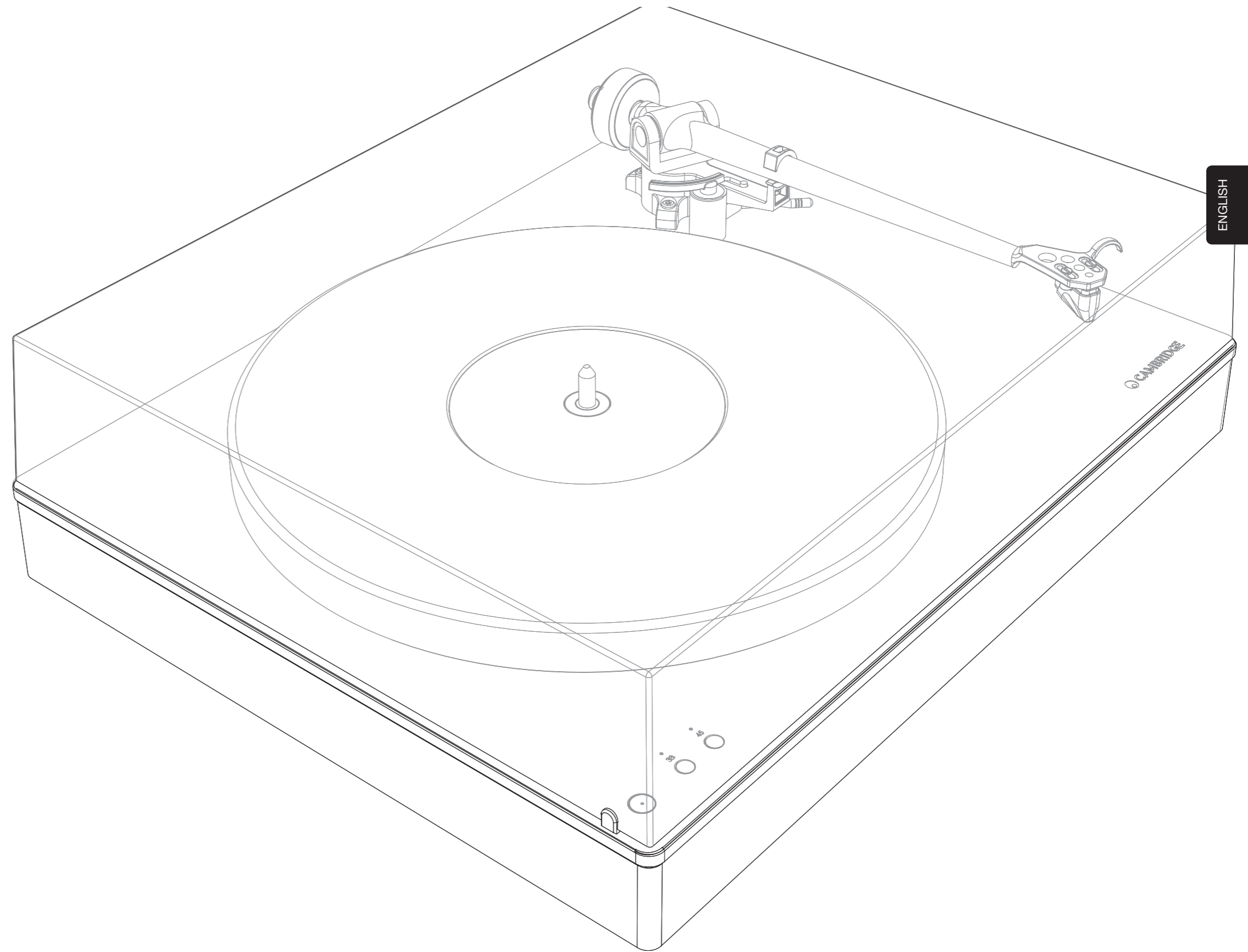

ENGLISH

 **CAMBRIDGE
AUDIO**

ALVA TT
DIRECT DRIVE TURNTABLE



Contents

IMPORTANT SAFETY INSTRUCTIONS	3
ASSEMBLY/SETUP	5
TOP VIEW	8
REAR PANEL	9
OPERATING INSTRUCTIONS	10
TECHNICAL SPECIFICATIONS	12
TROUBLESHOOTING	13

This guide is designed to make installing and using this product as easy as possible. Information in this document has been carefully checked for accuracy at the time of printing; however, Cambridge Audio's policy is one of continuous improvement, therefore design and specifications are subject to change without prior notice.

This document contains proprietary information protected by copyright. All rights are reserved. No part of this manual may be reproduced by any mechanical, electronic or other means, in any form, without prior written permission of the manufacturer. All trademarks and registered trademarks are the property of their respective owners.

© Copyright Cambridge Audio Ltd 2018.

Qualcomm is a trademark of Qualcomm Incorporated, registered in the United States and other countries, used with permission. aptX is a trademark of Qualcomm Technologies International, Ltd., registered in the United States and other countries, used with permission.

Qualcomm aptX is a product of Qualcomm Technologies International, Ltd.

The Bluetooth® word mark and logos are registered trademarks owned by the Bluetooth SIG, Inc. and any use of such marks by Audio Partnership Plc is under license. Other trademarks and trade names are those of their respective owners.

Make sure you register your product at:
WWW.CAMBRIDGEAUDIO.COM/REGISTER

For upcoming news on future products, software updates and exclusive offers.

What's in the box

1. Turntable lid
2. Documentation
3. Tonearm force gauge
4. Turntable
5. Platter
6. Power cable
7. Analogue interconnect
8. Turntable lid hinges
9. Counterweight

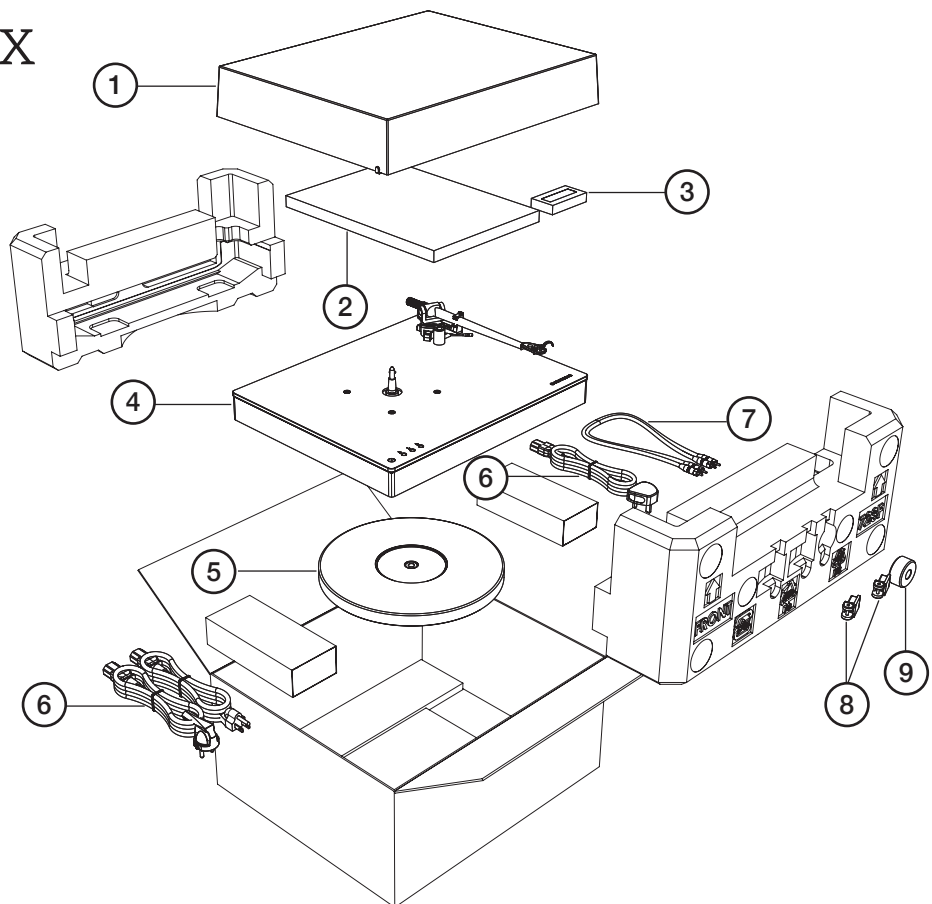

Important safety instructions

For your own safety please read the following important safety instructions carefully before attempting to connect this unit to the mains power supply. They will also enable you to get the best performance from and prolong the life of the unit:

1. Read these instructions.
2. Keep these instructions.
3. Heed all warnings.
4. Follow all instructions.
5. Do not use this apparatus near water.
6. Do not block any ventilation openings. Install in accordance with the manufacturer's instructions.
7. Do not install near any heat sources such as radiators, heat registers, stoves, or other apparatus (including amplifiers) that produce heat.
8. Do not defeat the safety purpose of the polarized or grounding-type plug. A polarized plug has two blades with one wider than the other. A grounding-type plug has two blades and a third grounding prong. The wide blade or the third prong are provided for your safety. If the provided plug does not fit into your outlet, consult an electrician for replacement of the obsolete outlet.
9. Protect the power cord from being walked on or pinched, particularly at plugs, convenience receptacles and the point where they exit from the apparatus.
10. Only use attachments/accessories specified by the manufacturer.
11. Unplug this apparatus during lightning storms or when unused for long periods of time.
12. Refer all servicing to qualified service personnel. Servicing is required when the apparatus has been damaged in any way, such as the power-supply cord or plug having been damaged, liquid has been spilled or objects have fallen into the apparatus, the apparatus has been exposed to rain or moisture, does not operate normally, or has been dropped.

Warning:

To reduce the risk of fire or electric shock, do not expose this apparatus to rain or moisture and objects filled with liquids, such as vases, should not be placed on this apparatus.

Batteries (battery pack or batteries installed) shall not be exposed to excessive heat such as sunshine, fire or the like.

To completely disconnect this apparatus from the ac mains, disconnect the power supply cord plug from the ac receptacle.

Pour deconnecter completement l'appareil du reseau d'alimentation, deconnecter le cordon d'alimentation de la prise murale.

The mains plug of the power supply cord shall remain readily accessible. La prise du reseau d'alimentation doit demeurer aisement accessible"

Only use the mains cord supplied with this unit.

Use of the apparatus in tropical climates (the equipment shall be used at maximum 45 degree c ambient temperature)

Warning: please refer the information on exterior bottom enclosure for electrical and safety information before installing or operating the apparatus.

To prevent injury, this apparatus must be securely attached to the floor/wall in accordance with the installation instructions.



The lightning flash with the arrowhead symbol within an equilateral triangle is intended to alert the user to the presence of un-insulated 'dangerous voltage' within the product's enclosure that may be of sufficient magnitude to constitute a risk of electric shock to persons.

The exclamation point within an equilateral triangle is intended to alert the user to the presence of important operating and maintenance instructions in the service literature relevant to this appliance.



WEEE SYMBOL

The crossed-out wheeled bin is the European Union symbol for indicating separate collection for electrical and electronic equipment. This product contains electrical and electronic equipment which should be reused, recycled or recovered and should not be disposed of with unsorted regular waste. Please return the unit or contact the authorised dealer from whom you purchased this product for more information.



CE MARK

This product complies with European Low Voltage (2014/35/EU), Electromagnetic Compatibility (2014/30/EU) and Environmentally-friendly design of Energy-related Products (2009/125/EC) Directives when used and installed according to this instruction manual. For continued compliance only Cambridge Audio accessories should be used with this product and servicing must be referred to qualified service personnel.



RCM (REGULATORY COMPLIANCE MARK)

This product meets Australia, New Zealand Safety, EMC and Radio Communications requirements of the ERAC and ACMA.



CU-TR MARK

This product meets Russia, Byelorussia and Kazakhstan electronic safety approvals.

VENTILATION

Important – The unit will become hot when in use. Do not stack multiple units on top of each other. Do not place in an enclosed area such as a bookcase or in a cabinet without sufficient ventilation.

Ensure that small objects do not fall through any ventilation grille. If this happens, switch off immediately, disconnect from the mains supply and contact your dealer for advice.

Please ensure there is ample ventilation (at least 20cm clearance on the top, side and rear). Do not put any objects on top of this unit. Do not situate it on a rug or other soft surface and do not obstruct any air inlets or outlet grilles. Do not cover the ventilation grilles with items such as newspapers, tablecloths, curtains, etc.

POSITIONING

Choose the installation location carefully. Avoid placing it in direct sunlight or close to a source of heat. No naked flame sources, such as lighted candles, should be placed on the unit. Also avoid locations subject to vibration and excessive dust, cold or moisture. The unit can be used in a moderate climate.

This unit must be installed on a sturdy, level surface. Do not place in a sealed area such as a bookcase or in a cabinet. Do not place the unit on an unstable surface or shelf. The unit may fall, causing serious injury to a child or adult as well as serious damage to the product. Do not place other equipment on top of the unit.

Due to stray magnetic fields, turntables or CRT TVs should not be located nearby due to possible interference.

Electronic audio components have a running in period of around a week (if used several hours per day). This will allow the new components to settle down and the sonic properties will improve over this time.

POWER SOURCES

The unit should be operated only from the type of power source indicated on the marking label. If you are not sure of the type of power-supply to your home, consult your product dealer or local power company.

If you do not intend to use this unit for a long period of time, unplug it from the mains socket.

OVERLOADING

Do not overload wall outlets or extension cords as this can result in a risk of fire or electric shock. Overloaded AC outlets, extension cords, frayed power cords, damaged or cracked wire insulation and broken plugs are dangerous. They may result in a shock or fire hazard.

Be sure to insert each power cord securely. To prevent hum and noise, do not bundle the interconnect leads with the power cord or speaker leads.

SERVICING

These units are not user serviceable. Never attempt to repair, disassemble or reconstruct the unit if there seems to be a problem. A serious electric shock could result if this precautionary measure is ignored. In the event of a problem or failure, please contact your dealer.

FCC STATEMENT

This device complies with Part 15 of the FCC Rules. Operation is subject to the following two conditions: (1) this device may not cause harmful interference, and (2) this device must accept any interference received, including interference that may cause undesired operation.

Caution: Exposure to radio frequency radiation.

The device shall be used in such a manner that the potential for human contact during normal operation is minimized.

FEDERAL COMMUNICATIONS COMMISSION NOTICE

This equipment has been tested and found to comply with the limits for a Class B digital device, pursuant to Part 15 of the FCC Rules. These limits are designed to provide reasonable protection against harmful interference in a residential installation.

This equipment generates, uses, and can radiate radio frequency energy, and if not installed and used in accordance with the instructions, may cause harmful interference to radio communications. However, there is no guarantee that interference will not occur in a particular installation. If this equipment does cause harmful interference to radio or television reception, which can be determined by turning the equipment off and on, the user is encouraged to try and correct the interference by one or more of the following measures:

- Reorient or relocate the receiving antenna.
- Increase the distance between the equipment and the receiver.
- Connect the equipment to an outlet on a circuit different from that to which the receiver is connected.
- Consult the dealer or an experienced radio/TV technician for help.

FCC Caution: Any changes or modifications not expressly approved by the party responsible for compliance could void the user's authority to operate this equipment.

FCC RADIATION EXPOSURE STATEMENT:

This equipment complies with FCC radiation exposure limits set forth for an uncontrolled environment. This equipment should be installed and operated with a minimum distance of 20cm between the radiator and your body.

This transmitter must not be co-located or operating in conjunction with any other antenna or transmitter.

MODIFICATIONS

The FCC requires the user to be notified that any changes or modifications to this device that are not expressly approved by Cambridge Audio, may void the user's authority to operate the equipment.

CANADA-INDUSTRY CANADA (IC)

This radio transmitter has been approved by Industry Canada.

This Class B digital apparatus complies with Canadian standard ICES-003. This device complies with Industry Canada License exempt RSS standard(s). Operation is subject to the following two conditions.

(1) this device may not cause interference and (2) this device must accept any interference, including interference that may cause undesired operation of the device.

This equipment complies with FCC RF radiation exposure limits set forth for an uncontrolled environment. This equipment should be installed and operated with a minimum distance of 20 centimeters between the radiator and your body

INDUSTRIE CANADA (IC)

Le présent appareil est conforme aux CNR d'Industrie Canada applicables

aux appareils radio exempts de licence. L'exploitation est autorisée aux deux conditions suivantes :

(1) l'appareil ne doit pas produire de brouillage, et (2) l'utilisateur de l'appareil doit accepter tout brouillage radioélectrique subi, même si le brouillage est susceptible d'en compromettre le fonctionnement.

ce matériel est conforme aux limites d'exposition aux rayonnements rf de fac énoncés dans un autre environnement. ce matériel doit être installé et exploité à une distance minimale de 20 cm entre le radiateur et votre corps. .

EUROPE-EUROPEAN UNION NOTICE

Radio products with the CE alert marking comply with the RED Directive (2014/53/EU) issued by the Commission of the European Community.

Radio Frequency: 2.402GHz-2.48GHz

The Max. transmit power: 10 dBm

This product can be used across EU member states

Compliance with this directive implies conformity to the following European Norms.

- EN 62368-1 – Product Safety.
- EN 300 328 – Technical requirement for radio equipment.
- EN 301 489 – General EMC requirements for radio equipment.

Assembly/setup

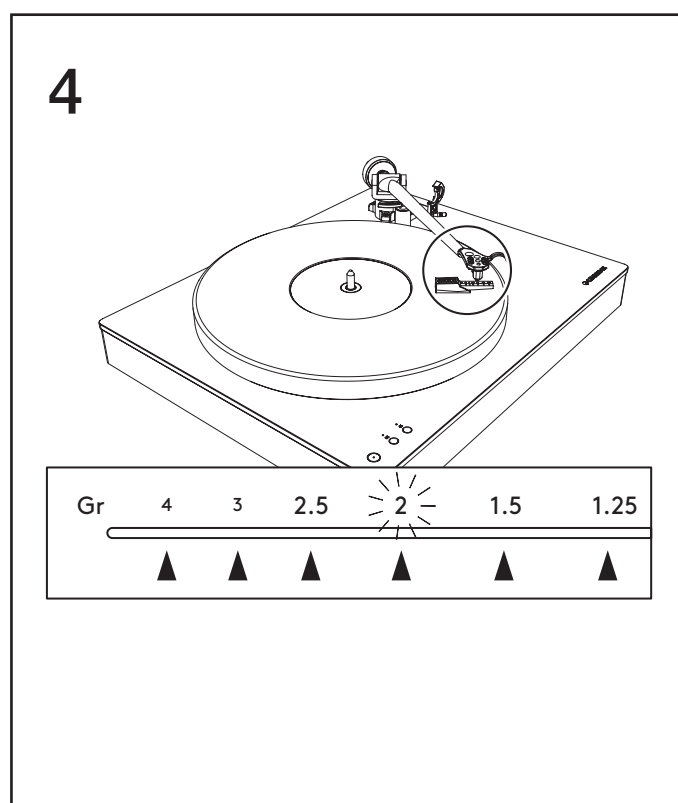
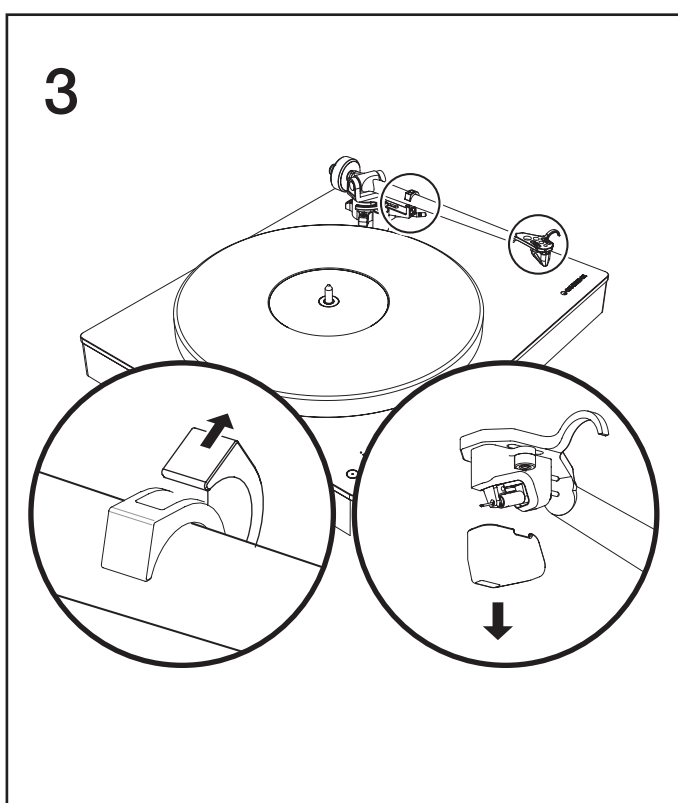
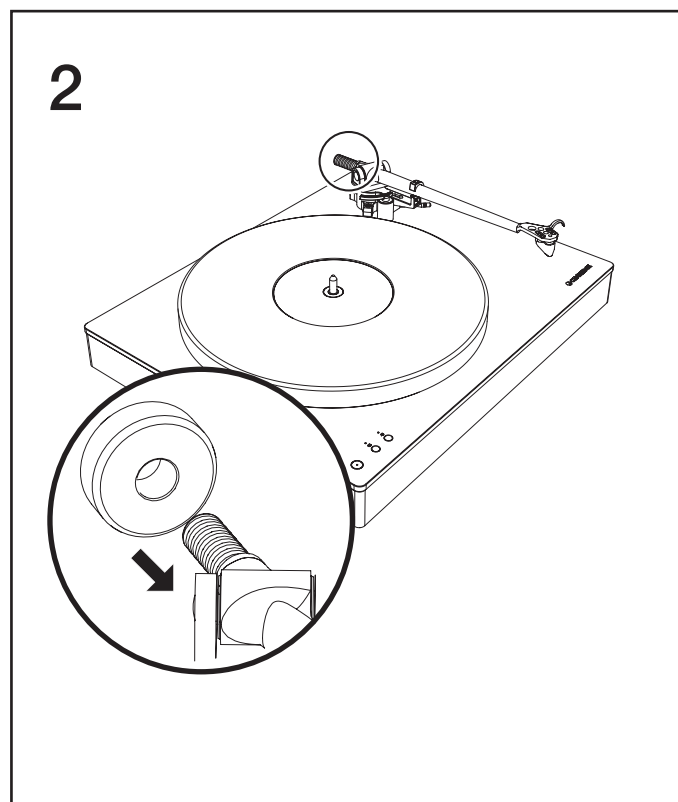
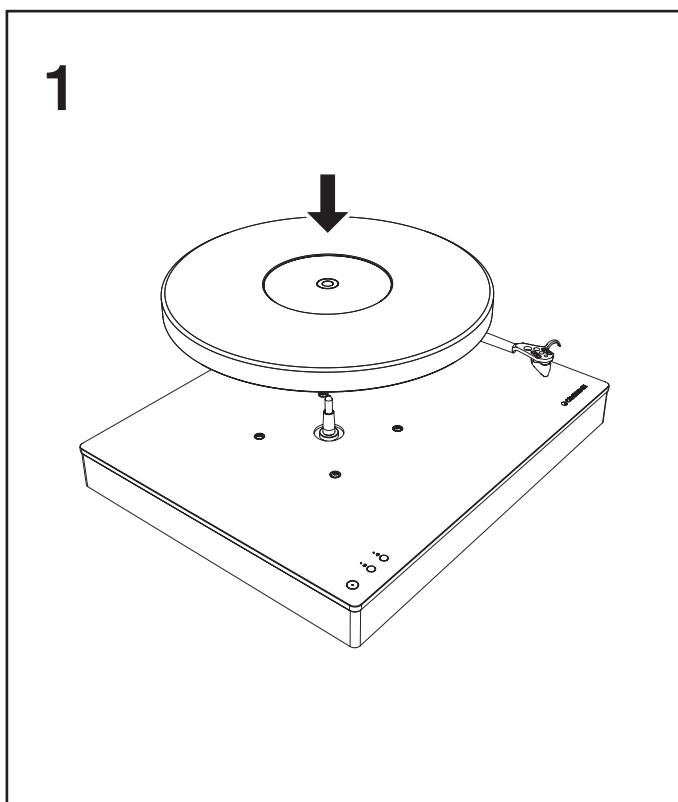

Assembly/setup

5

Counterweight
adjustment

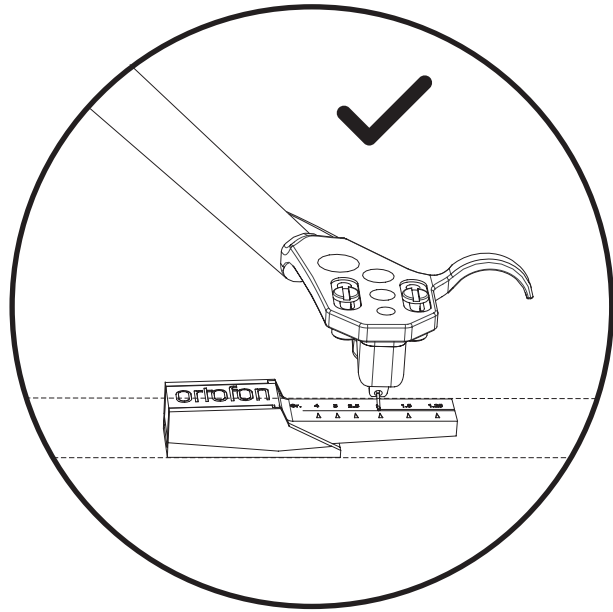
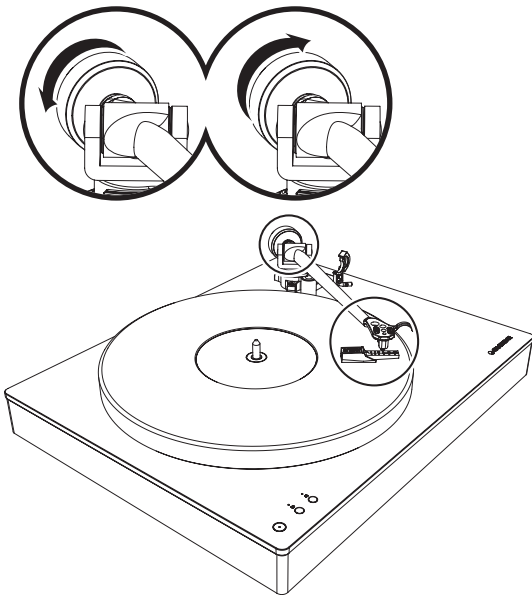

Return the arm to its arm rest to adjust the counterweight.
This part of the process requires care and patience

With the tonearm on the stylus force gauge, adjust the counterweight until the stylus force gauge
is parallel to the surface of the platter.

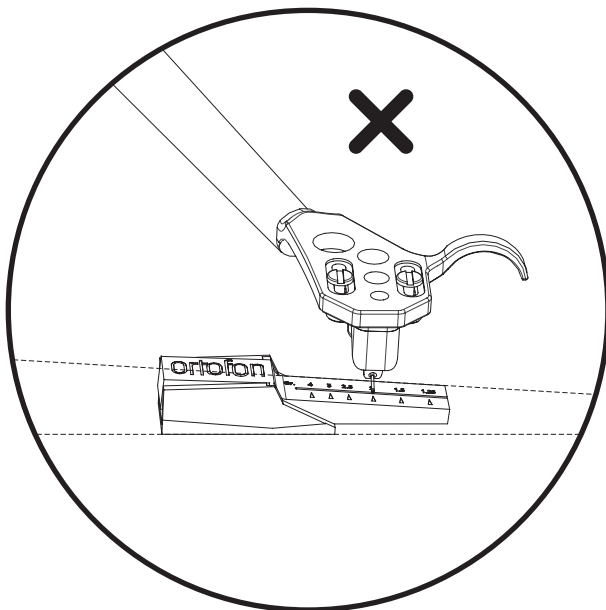

This indicates that the tonearm is heavy and the counterweight should be adjusted accordingly.

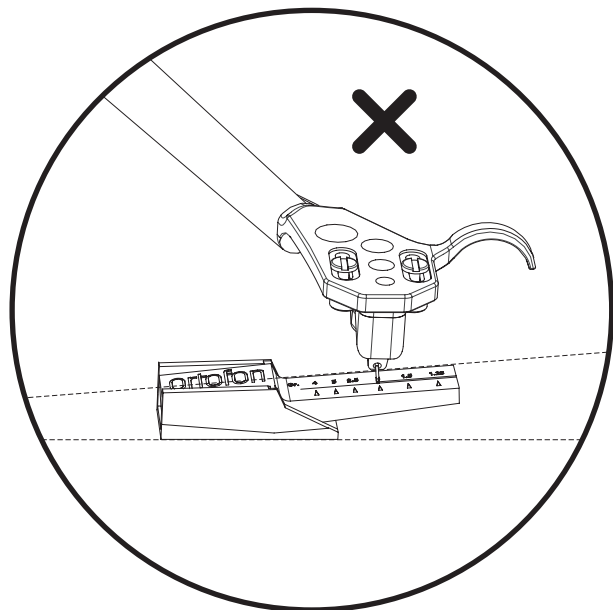

This indicates that the tonearm is too light and the counterweight should be adjusted accordingly.

6 Anti-skating (bias) adjustment

The bias should be adjusted to match the tracking force.
For the Cambridge Audio Moving Coil cartridge, the bias should be set to 2.

7

8

Top view

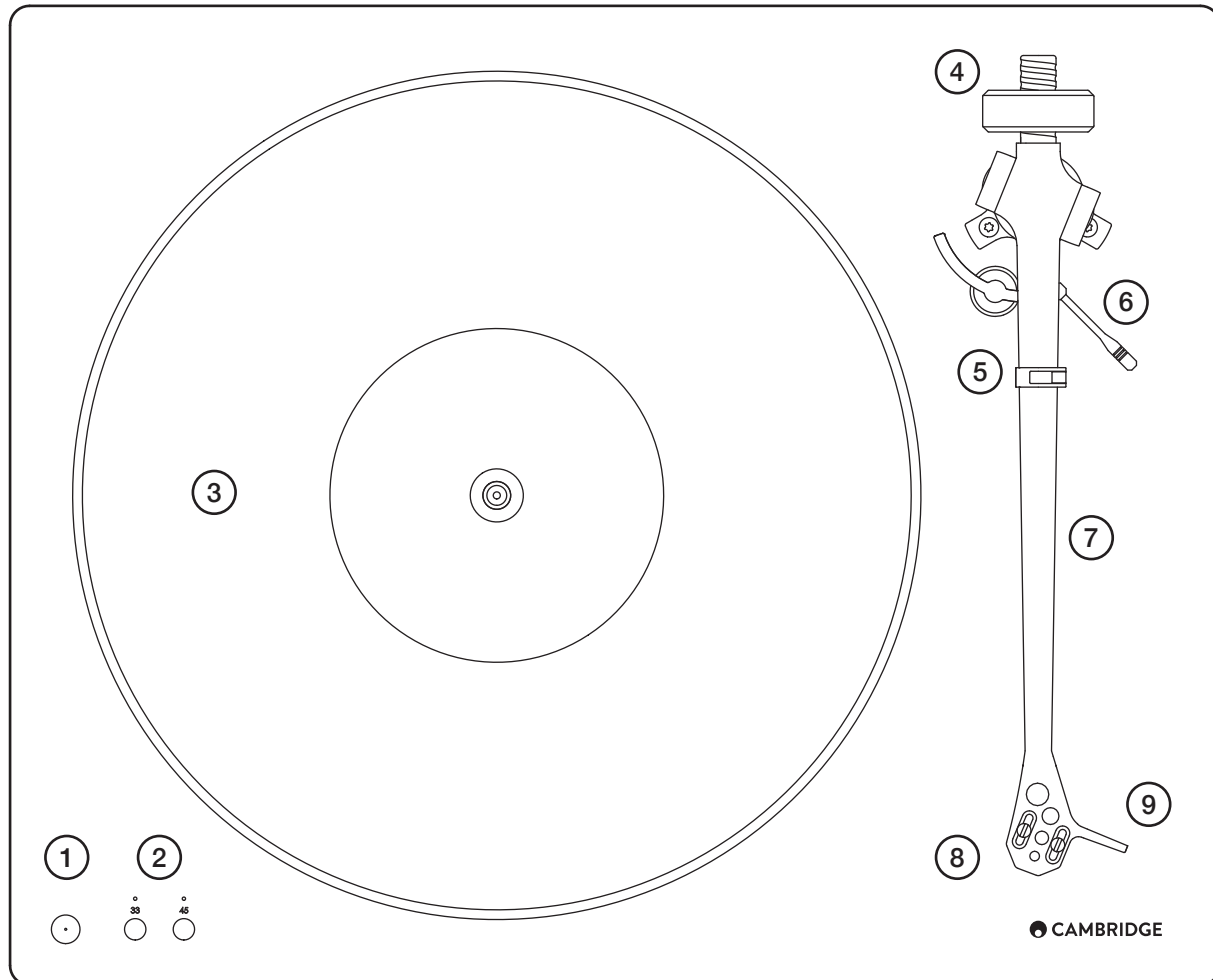

1. STANDBY/ON

Switches the unit between Standby mode (indicated by dim LED) and On (indicated by bright LED). Standby mode is a low power mode where the power consumption is less than 0.5 Watts.

2. RECORD SPEED BUTTONS AND START/STOP

To start the motor running, press the speed button according to the record being played. Press again to stop.

3. MAIN PLATTER

4. TONEARM COUNTERWEIGHT

Used to adjust tracking force (downforce).

5. TONEARM REST

6. TONEARM LIFT LEVER

Raises and lowers the arm onto the record to be played.

7. TONEARM

8. FITTED CAMBRIDGE AUDIO MC CARTRIDGE

9. HEADSHELL WITH FINGER LIFT

Rear panel

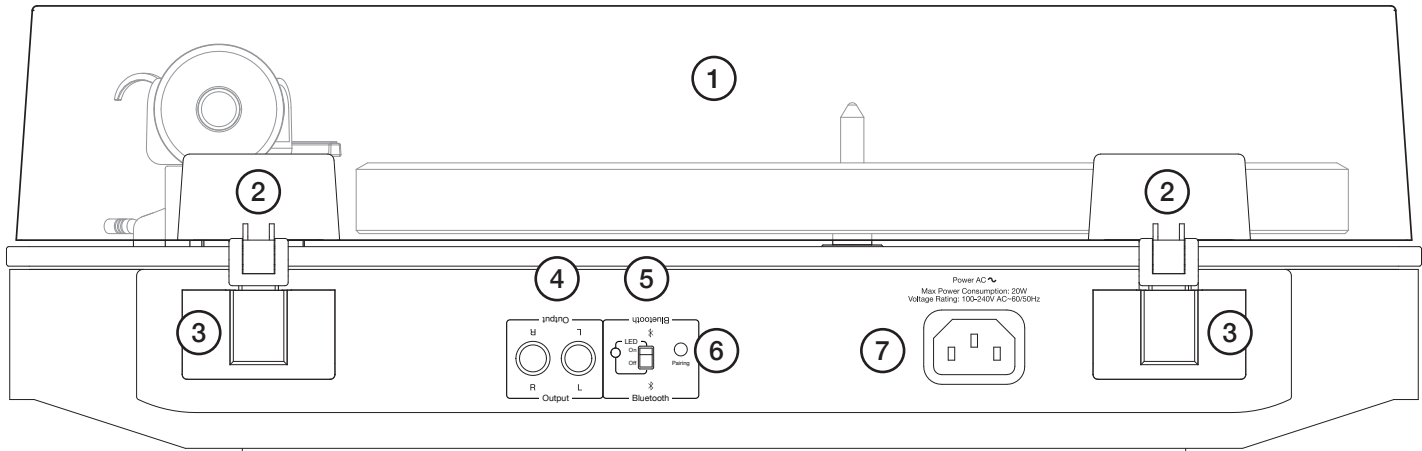

1. LID

Turntable cover.

2. LID HINGES

3. HINGE FASTENERS

4. SIGNAL OUTPUT SOCKETS

The turntable must be connected to the line in of an amplifier using the supplied RCA cable.

5. BLUETOOTH STATUS LED WITH ON/OFF SWITCH

To turn the Bluetooth LED light off or on, set the LED switch to your desired position.

6. BLUETOOTH PAIRING BUTTON

7. AC POWER SOCKET

Operating instructions

AUTO POWER DOWN (APD)

This unit has an Auto Power Down function. The product will automatically switch to standby mode after inactivity of 20 minutes.

DISABLING THE AUTO POWER DOWN

If you wish to disable the APD function, then press and hold the standby button for 5 seconds when in standby. This can then be reset to factory defaults by plugging in the mains lead with the standby button held down.

PLAYING RECORDS

The record player is compatible with 33 1/3rpm and 45rpm records.

Place the record over the spindle holding the record only by its outermost edge.

Note: Before playing, it is a good idea to clean the record using an appropriate cleaning brush designed specifically for use with records. We particularly recommend the type with soft carbon fibre bristles which also reduce static charge on the record surface.

Move the tonearm so that the stylus is over the start of the record and then switch the motor on. Now use the tonearm lift lever to lower the stylus onto the record.

When finished, lift the stylus from the record using the tonearm lift lever before turning the motor off. Return the arm to the tonearm rest.

Note: To prevent dust on the record, always return records to their sleeves.

CHANGING REPLAY SPEED

Turn on the unit. Press the appropriate speed button according to the record being played. Press the speed button again to stop the platter.

MAINTENANCE AND CLEANING

Your record player requires little or no regular maintenance. Remove dust with a slightly moistened antistatic cloth. Never use a dry cloth because this will create static electricity which attract more dust. Antistatic cleaning fluids are available at specialist stores. It is recommended to fit the stylus cover before cleaning or maintenance is carried out to avoid damage.

CARTRIDGE REPLACEMENT/ ADJUSTMENT

The record player is supplied with a factory fitted and adjusted Cambridge Audio high output moving coil cartridge fully aligned and setup at the factory. The following instructions for adjusting the cartridge are provided in case the cartridge is replaced by a different model at a later date.

Note: It is not necessary to adjust the factory fitted cartridge.

The supplied cartridge has a lifespan of approximately 1000-2000 hours.

CARTRIDGE FITTING

Only use a Moving Magnet (MM) or high output Moving Coil (MC) cartridge. All cartridges with half inch mounting holes can be fitted. Leaving the needle's protection cover on, fit the cartridge to the headshell using the screws supplied with the cartridge by passing one screw through each slot in the headshell. Do not tighten the nuts yet.

Connect the tonearm wires to the cartridge pins as follows:

White – Left channel positive (L+)

Red – Right channel positive. (R+)

Green – Right channel return (R-)

Blue – Left channel return (L-)

CARTRIDGE ALIGNMENT

Because a normal tonearm pivots about its bearing point as it traverses a record, the angle between the cartridge body and record groove will gradually vary as the record is played.

The idea of cartridge alignment is to minimise this inherent error. A simple alignment protractor is included. Follow the instruction on the Alignment Protractor.

Note: The record player is fully aligned at the factory for the supplied Cambridge Audio MC cartridge and does not require this adjustment to be made.

CARTRIDGE DOWNFORCE ADJUSTMENT

Refer to the 'Assembly/setup' section of this manual.

ANTI-SKATING (BIAS) ADJUSTMENT

The bias should be adjusted to match the tracking force. For the Cambridge Audio Moving Coil cartridge, the bias should be set to 2. See below diagram.

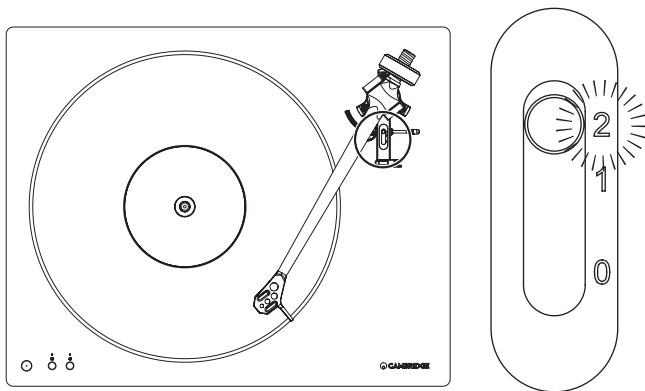

BLUETOOTH

This product is a Bluetooth transmitter only and transmits high definition Bluetooth audio. Supports SBC, Qualcomm® aptX™ and aptX™ HD audio codecs.

Note: Do not pair this product with your portable devices such as smartphones or tablets, as these devices are also transmitters.

BLUETOOTH PAIRING

Note: Before pairing this product, It is highly recommended to only turn on the Bluetooth device you want to pair and activate its pairing mode.

To start pairing with your Bluetooth device such as a pair of wireless Bluetooth headphones, press the Bluetooth pairing button located on the rear of the unit for 2 seconds. Once successful, the Blue LED will stop flashing and will enter paired mode. Refer to your Bluetooth device for more information.

BLUETOOTH LED STATUS

Note: Please make sure that the LED switch is set to 'on' position.

Slowly flashing – Searching for a paired device.

Fast flashing – In pairing mode.

Solid – Paired to a device using SBC codec.

Long solid intervals – Paired to a device using aptX/aptX HD codec.

REMOVING PAIRED DEVICES

To clear all paired devices, press and hold the Bluetooth pairing button for approximately 20 seconds. Once successful, the Bluetooth LED will go off for approximately 3 seconds before reverting back to 'searching' mode.

Technical specifications

TURNTABLE

Type	Direct Drive
Turntable Speeds	33 1/3, 45rpm
Motor Torque	1.6kg/cm
Wow & Flutter	0.06%
Turntable Platter	POM (Polyoxymethylene)
Diameter	305mm

TO NEARM

Type	One piece aluminium casting
Effective Length	238mm
Overhang	17.2mm
Effective mass	11g

INTERNAL PHONO STAGE

Gain @ 1kHz	42dB
Nominal output (with CA cartridge)	250mVrms
Equivalent input noise (A-Weighted)	0.1uVrms
RIAA Curve Accuracy	+/-0.3dB 30Hz-20kHz
Signal/Noise ratio (ref 1V out, 20-20K BW)	>90dB
THD+N 1kHz	0.0025%
Input Impedance	47kΩ
Input Capacitance	320pF

OUTPUTS

Audio Output	RCA line level
Bluetooth	SBC/aptX/aptX HD

GENERAL

Power Supply	100-240V
Power Consumption	5W Approx., 20W max, <0.5W (Standby)
Dimensions (W x H x D)	435 x 138 x 370mm
Weight	10 kg

CARTRIDGE

Type	High Output Moving Coil
Frequency response	+/- 1dB 30Hz-20kHz
Stylus	Elliptical
Cantilever	Aluminium
Output level	2mV @ 1kHz
Tracking force	2g
Recommended load	47kΩ

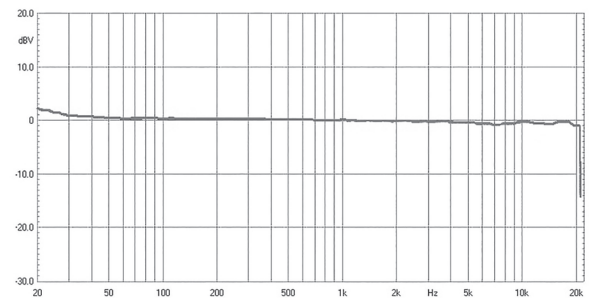

Troubleshooting

NO SIGNAL THROUGH ONE OR OTHER CHANNEL OR BOTH CHANNELS

Possible Wiring fault. Check that there are connections from the cartridge to the internal tonearm wiring.

Amplifier not switched on.

Amplifier or speakers defective or muted.

No connection to the loudspeakers.

DISTORTED OR INCONSISTENT SOUND FROM ONE OR BOTH CHANNELS

Record player is connected to wrong input of amplifier.

Stylus/needle or cantilever damaged.

Wrong rpm used for record.

Bad connections, plugs not fully pushed home.

Tracking force and/or anti-skate incorrectly adjusted.

Record player is connected to phono input or phono stage.

If you experience any trouble with your product, visit the help section on our webpage at <http://techsupport.cambridgeaudio.com>